

SOUTH FACE
(Looking North)

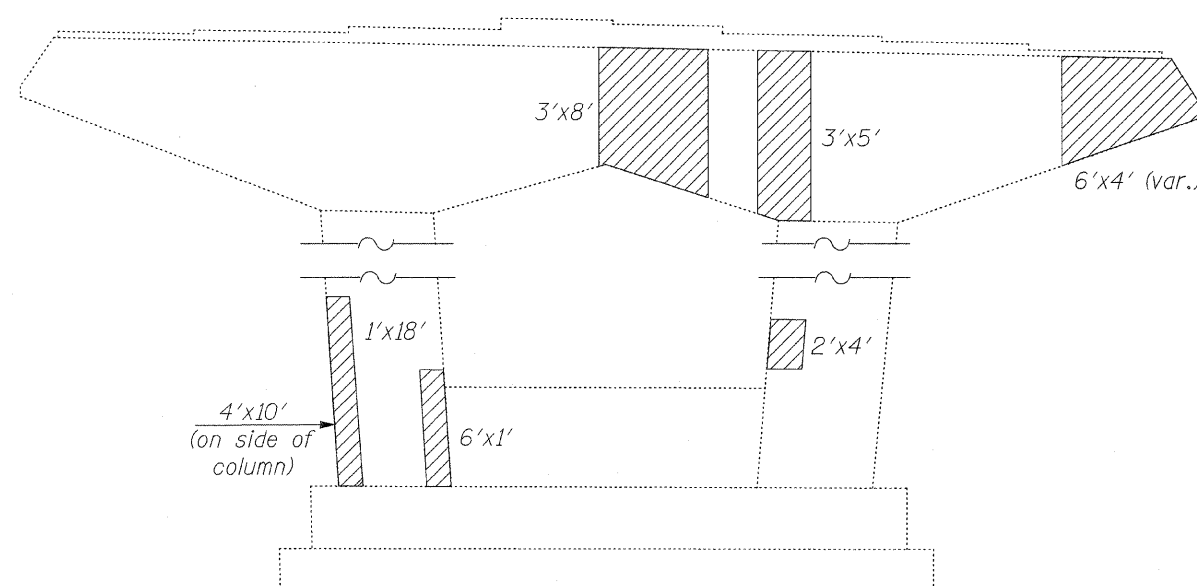

SOUTH FACE
(Looking North)

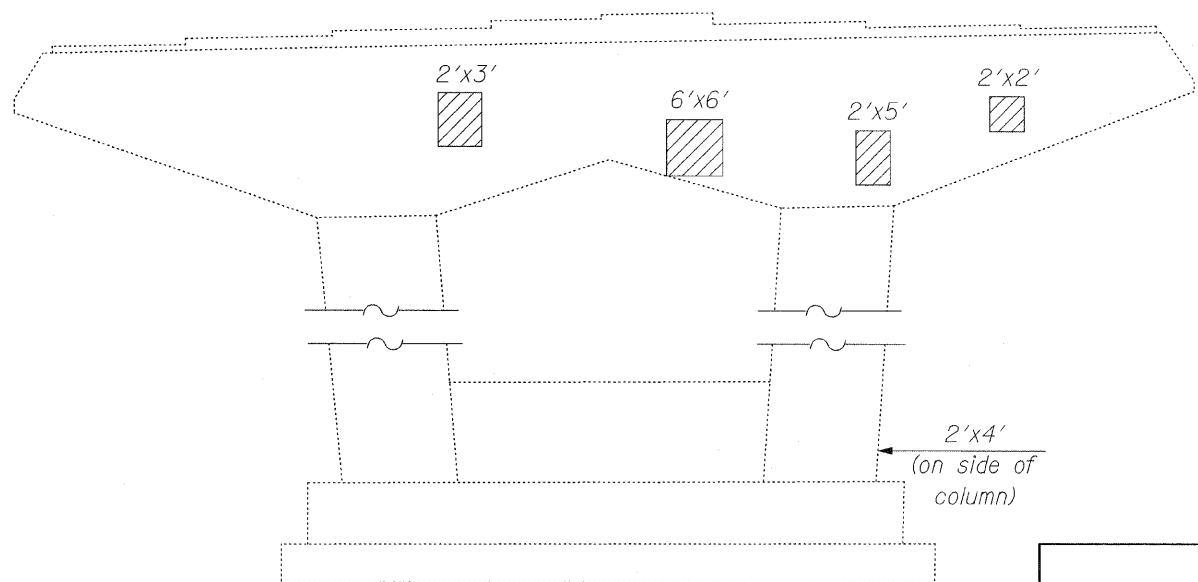

NORTH FACE
(Looking South)

PIER NO. 2

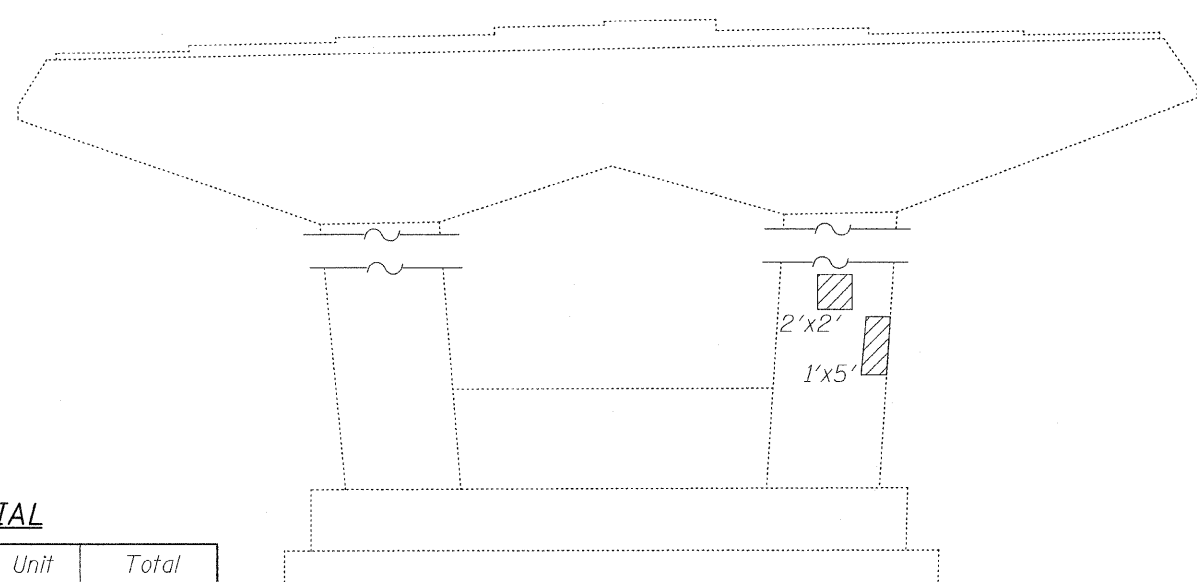

NORTH FACE
(Looking South)

PIER NO. 5

BILL OF MATERIAL

| Item | Unit | Total |
|--|---------|-------|
| Structural Repair of Concrete (Depth Equal to or Less Than 5 In.) | Sq. Ft. | 238 |
| | | |

LEGEND:

Structural Repair of Concrete
(Depth Equal to or Less Than 5 In.)



CHRISTIAN-ROGE & ASSOCIATES, INC.
ENGINEERS / PLANNERS / SURVEYORS
211 W. WACKER DRIVE CHICAGO, IL. 60606
PHONE: (312)372-2023 FAX: (312)372-5274

| | | | |
|----------------------------------|------------------|--------------------------|-----------|
| FILE NAME = pier_2-5-elev.dgn | USER NAME = IDOT | DESIGNED - B.N.S. | REVISED - |
| | | DRAWN - R.E.S./D.L./F.M. | REVISED - |
| | | CHECKED - B.N.S./J.C.N. | REVISED - |
| | | DATE - JANUARY, 2009 | REVISED - |

STATE OF ILLINOIS
DEPARTMENT OF TRANSPORTATION

PIER NO. 2 & PIER NO. 5 REPAIRS
LEMONT ROAD OVER DES PLAINES RIVER S.N. 016-2504

SCALE: SHEET NO. 536 OF 541 SHEETS STA. TO STA.

| | | | | |
|---|-------------------------|----------------|--------------------|-----------------|
| F.A.U. RTE. 2612 | SECTION 3104 B-1-I-2 | COUNTY COOK | TOTAL SHEETS 80 | SHEET NO. 72 |
| FED. ROAD DIST. NO. ILLINOIS FED. AID PROJECT | | | CONTRACT NO. 60D76 | |