

SOUTH FACE
(Looking North)

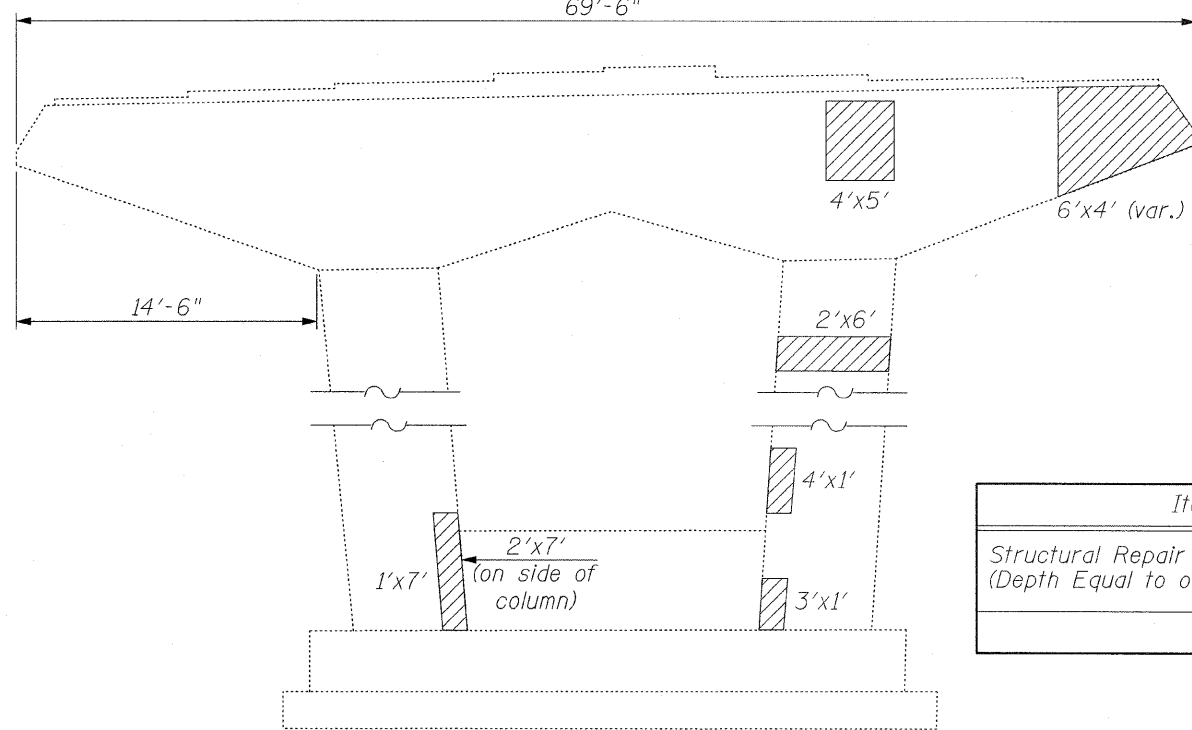

NORTH FACE
(Looking South)

PIER NO. 9

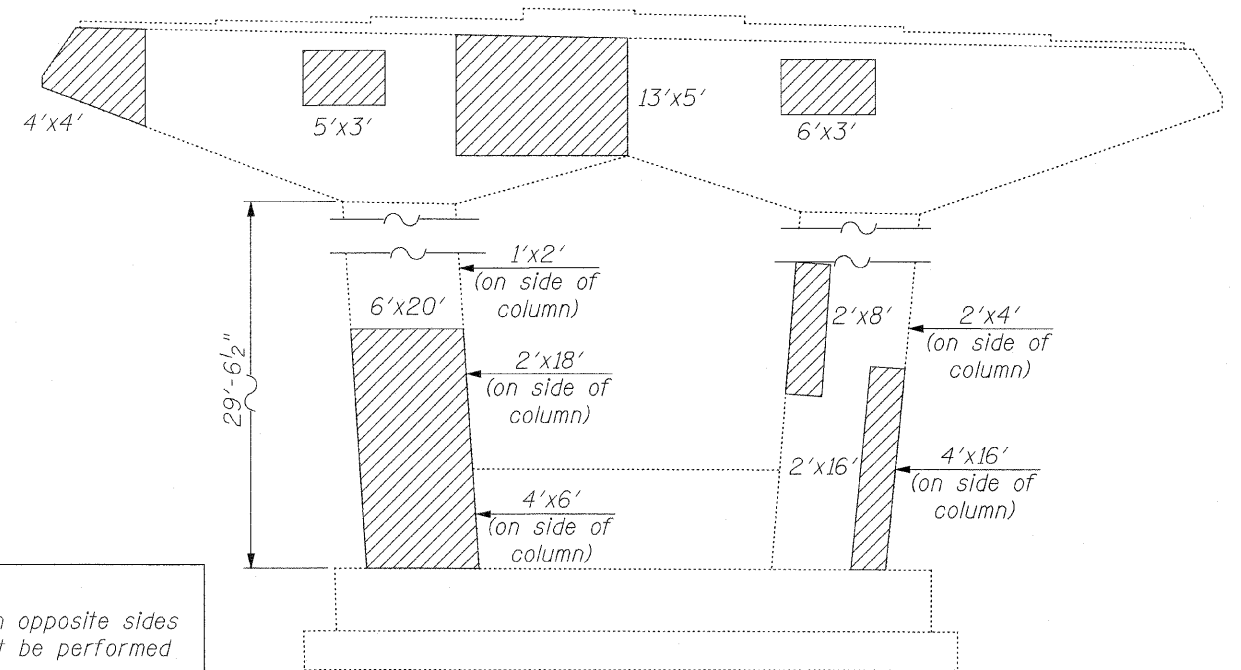

SOUTH FACE
(Looking North)

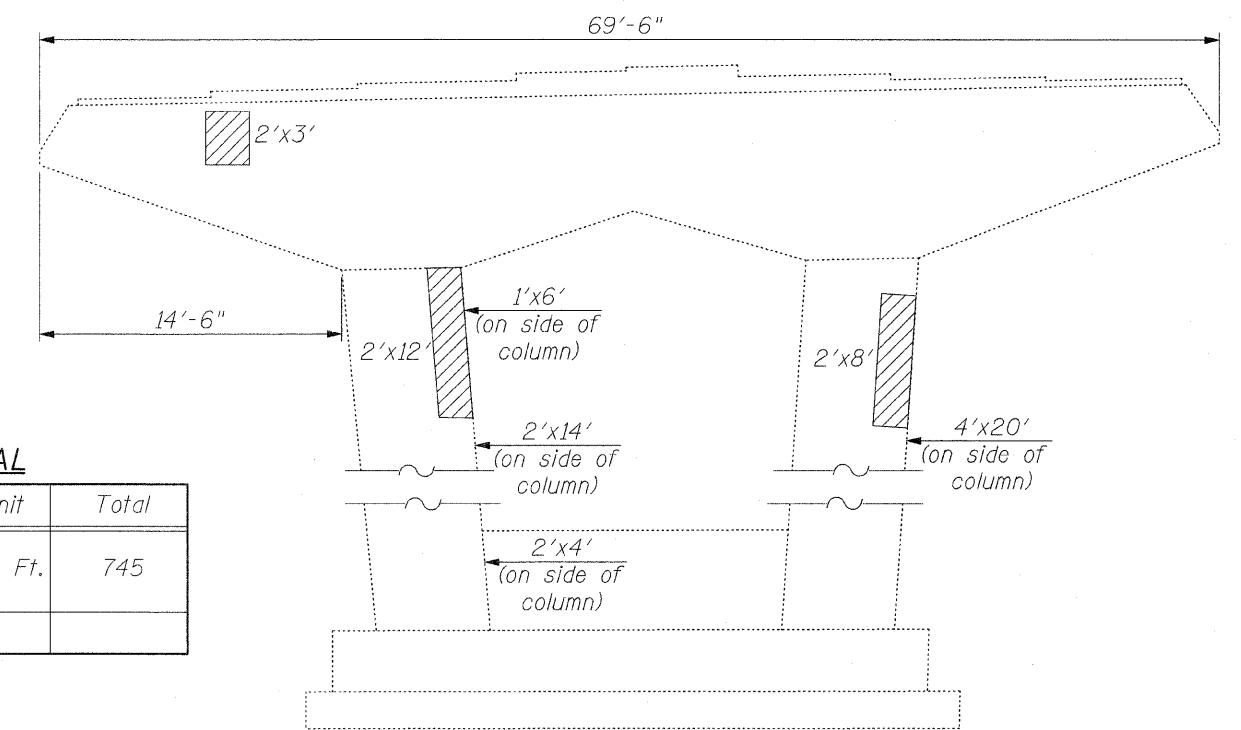

NORTH FACE
(Looking South)

PIER NO. 12

NOTE:
Any work needed on opposite sides of Columns shall not be performed at the same time

BILL OF MATERIAL

| Item | Unit | Total |
|---|---------|-------|
| Structural Repair of Concrete (Depth Equal to or Less Than 5 In.) | Sq. Ft. | 745 |

LEGEND:

Structural Repair of Concrete (Depth Equal to or Less Than 5 In.)

| | | | |
|--------------------------------|------------------|--------------------------|-----------|
| FILE NAME = pier-9-12-elev.dgn | USER NAME = IDOT | DESIGNED - B.N.S. | REVISED - |
| | | DRAWN - R.E.S./D.L./F.M. | REVISED - |
| | | CHECKED - B.N.S./J.C.N. | REVISED - |
| | | DATE - JANUARY, 2009 | REVISED - |

STATE OF ILLINOIS
DEPARTMENT OF TRANSPORTATION

| | | | | | | |
|---|-----------------------------|------------------|----------------------|---|-----------------|--------------|
| PIER NO. 9 & PIER NO. 12 REPAIRS | | F.A.U. RTE. 2612 | SECTION 3104 B-1-1-2 | COUNTY COOK | TOTAL SHEETS 80 | SHEET NO. 73 |
| LEMONT ROAD OVER DES PLAINES RIVER | | S.N. 016-2504 | | CONTRACT NO. 60D76 | | |
| SCALE: | SHEET NO. 537 OF 541 SHEETS | STA. | TO STA. | FED. ROAD DIST. NO. ILLINOIS FED. AID PROJECT | | |

CR & A
CHRISTIAN-ROGE & ASSOCIATES, INC.
ENGINEERS / PLANNERS / SURVEYORS
211 W. WACKER DRIVE CHICAGO, IL. 60606
PHONE: (312)372-2023 FAX: (312)372-5274