

**SOUTH FACE**  
(Looking North)

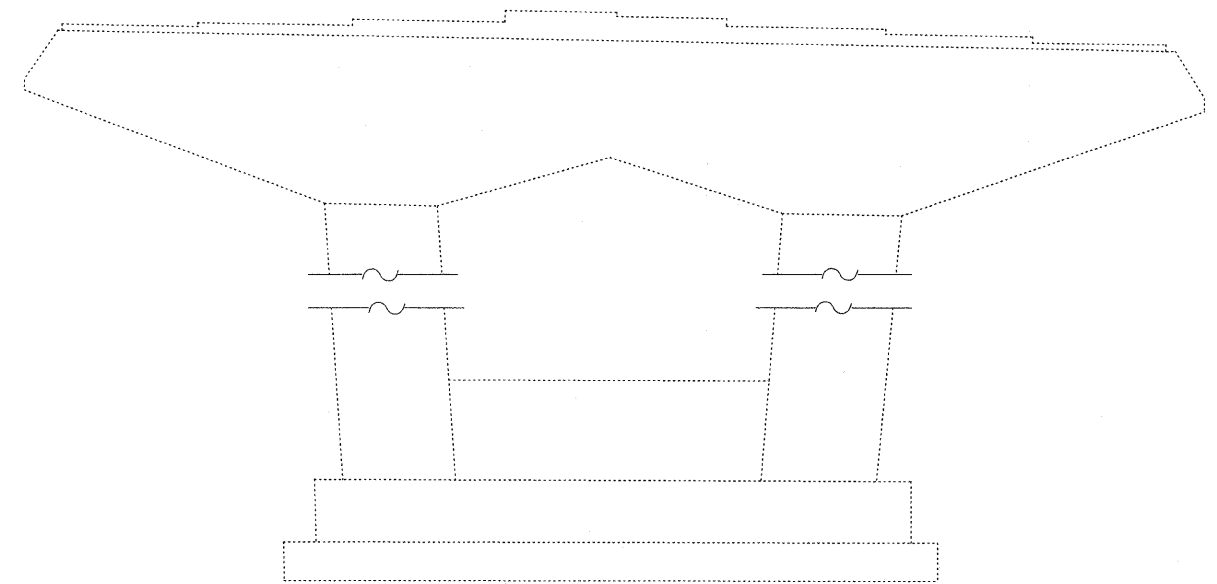

**SOUTH FACE**  
(Looking North)

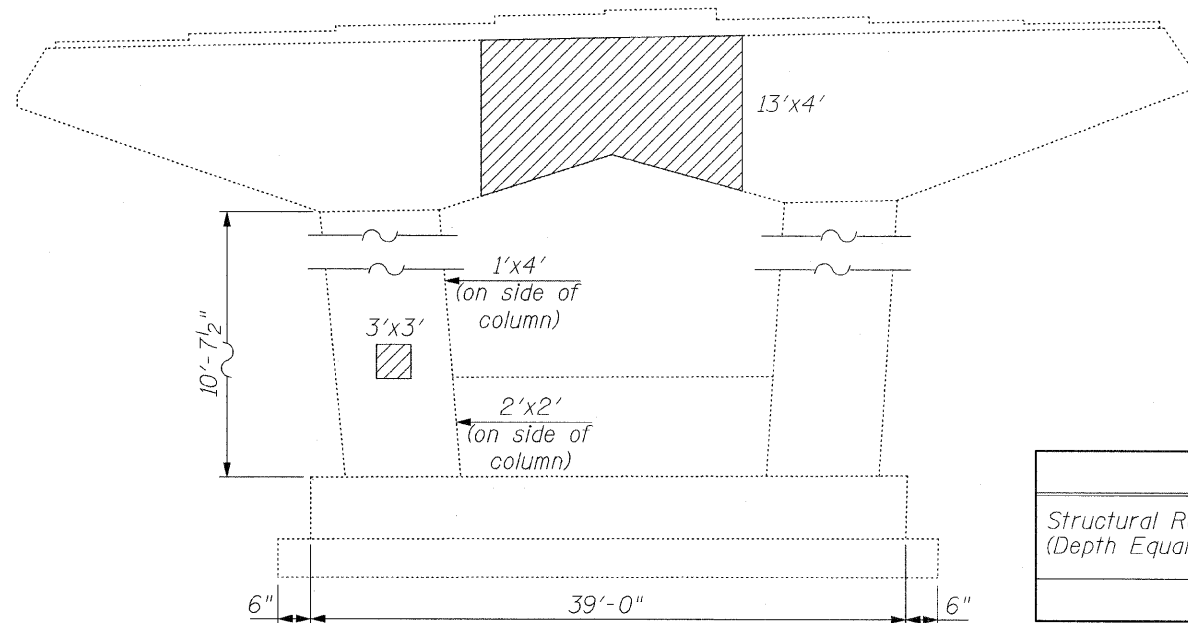

**NORTH FACE**  
(Looking South)

**PIER NO. 15**

**BILL OF MATERIAL**

Item	Unit	Total
Structural Repair of Concrete (Depth Equal to or Less Than 5 In.)	Sq. Ft.	135

**LEGEND:**

Structural Repair of Concrete  
(Depth Equal to or Less Than 5 In.)

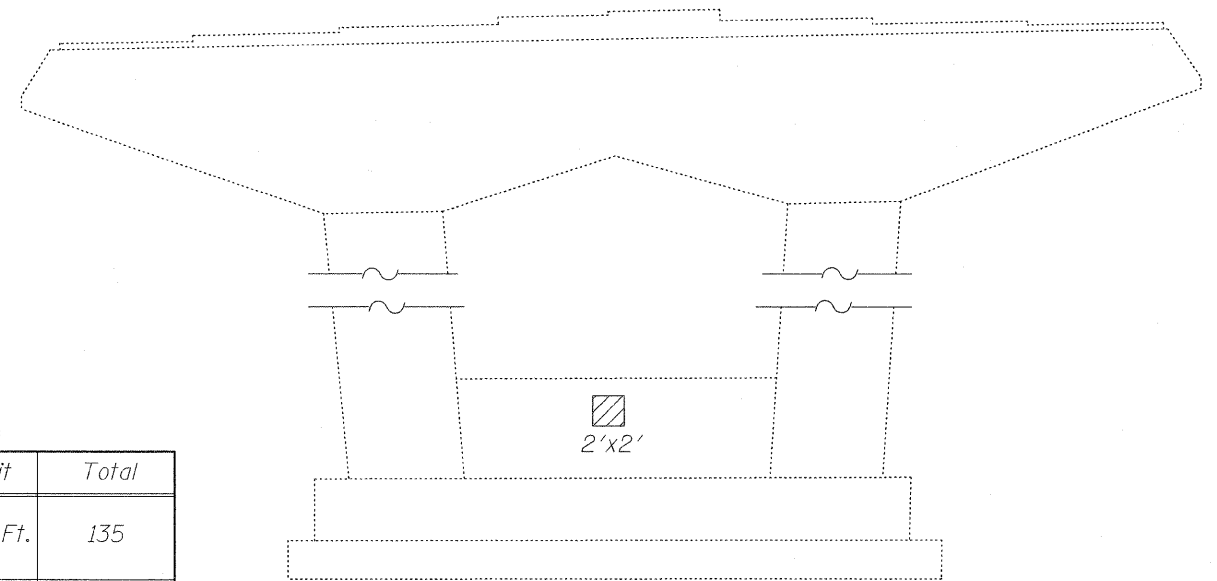

**NORTH FACE**  
(Looking South)

**PIER NO. 16**

**CR & A**  
CHRISTIAN-ROGE & ASSOCIATES, INC.  
ENGINEERS / PLANNERS / SURVEYORS  
211 W. WACKER DRIVE CHICAGO, IL. 60606  
PHONE: (312)372-2023 FAX: (312)372-5274

FILE NAME = pier_15-16-elev.dgn	USER NAME = IDOT	DESIGNED - B.N.S.	REVISED -
		DRAWN - R.E.S./D.L./F.M.	REVISED -
		CHECKED - B.N.S./J.C.N.	REVISED -
		DATE - JANUARY, 2009	REVISED -

**STATE OF ILLINOIS**  
**DEPARTMENT OF TRANSPORTATION**

**PIER NO. 15 & PIER NO. 16 REPAIRS**  
**LEMONT ROAD OVER DES PLAINES RIVER**  
S.N. 016-2504

F.A.U. RTE. 2612	SECTION 3104 B-1-I-2	COUNTY COOK	TOTAL SHEETS 80	SHEET NO. 74
SCALE: SHEET NO. S38 OF S41 SHEETS		STA.	TO STA.	FED. ROAD DIST. NO. ILLINOIS FED. AID PROJECT
CONTRACT NO. 60D76				