

**SYMBOLS**

- Work area
- Sign
- Type III barricade
- Traffic signal
- Detector loops
- Impact attenuator
- Non-directional flashing beacon
- Drum with steady burning light 25' cts.
- Temporary concrete barrier
- Temporary rumble strip (when specified)
- Double vertical panel (see detail)
- Crystal, bidirectional barrier wall/guardrail marker
- Temporary Pavement:  
Hot-mix asphalt surface course, mix "C", N50 1 1/2"  
Hot-mix asphalt binder course, IL-19.0, N50 8 1/2" (In 4 Lifts)

- ① Type III barricade to be placed when no work is being performed.
- ② Barrier wall/guardrail markers at 7.6 m (25') cts. See Standards 704001 & 635011.

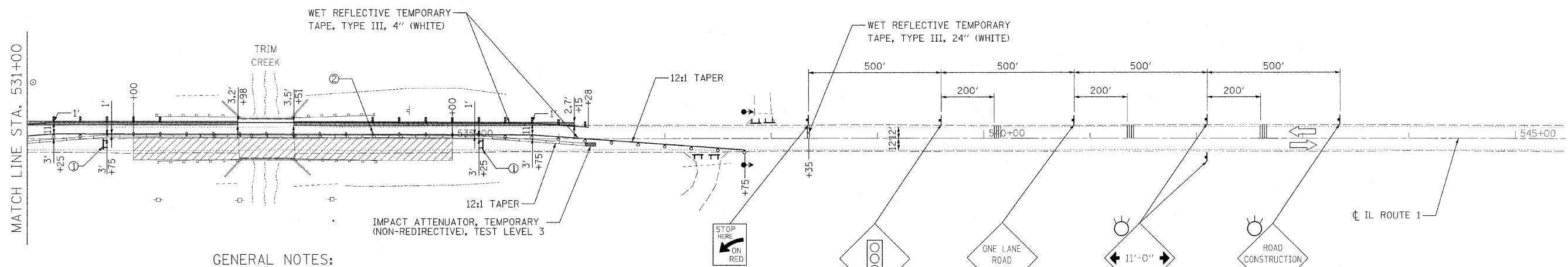

**GENERAL NOTES:**

TRAFFIC SIGNALS SHALL BE OPERATIONAL ONLY WHEN ALL TRAFFIC CONTROLS ARE IN PLACE. WHEN TRAFFIC SIGNALS ARE NOT IN OPERATION, FLAGGERS SHALL BE USED AND TRAFFIC CONTROL SHALL BE STANDARD 701201.

TEMPORARY CONCRETE BARRIER SHALL BE ACCORDING TO STANDARD 704001

WHEN EXISTING PAVEMENT MARKINGS AND RAISED PAVEMENT MARKERS ARE IN CONFLICT WITH THE TRAFFIC CONTROL AND PROTECTION PLAN, EXISTING PAVEMENT MARKINGS AND RAISED PAVEMENT MARKERS SHALL BE REMOVED AND PAID FOR AS PAVEMENT MARKING REMOVAL OR AS RAISED REFLECTIVE PAVEMENT MARKING REMOVAL.

**Ciorba Group, Inc.**  
CONSULTING ENGINEERS  
5507 North Cumberland Avenue, Suite 402  
Chicago, Illinois 60656  
Tel. 773.775.4009 Fax 773.775.4014

USER NAME = mbalog	DESIGNED - JCC	REVISED -
PLLOT SCALE = 50.0000 1/ IN.	DRAWN - JCC	REVISED -
PLLOT DATE = 1/13/2009	CHECKED - MJL	REVISED -
	DATE - 05/15/2008	REVISED -

**STATE OF ILLINOIS  
DEPARTMENT OF TRANSPORTATION**

**FAP 332 / ILLINOIS ROUTE 1  
OVER TRIM CREEK  
TRAFFIC CONTROL AND PROTECTION - STAGE 2**

SCALE: 1"=50'  
SHEET NO. OF SHEETS STA. TO STA.

F.A.P. RTE. 332	SECTION 8 R-B-1-2	COUNTY WILL	TOTAL SHEETS 28	SHEET NO. 8
CONTRACT NO. 60DB1				
FED. ROAD DIST. NO. ILLINOIS FED. AID PROJECT				

FILE NAME = N:\PROJ\332\332\_26\Design\Proposed\Plan\332\_26-09-mo1.dgn