

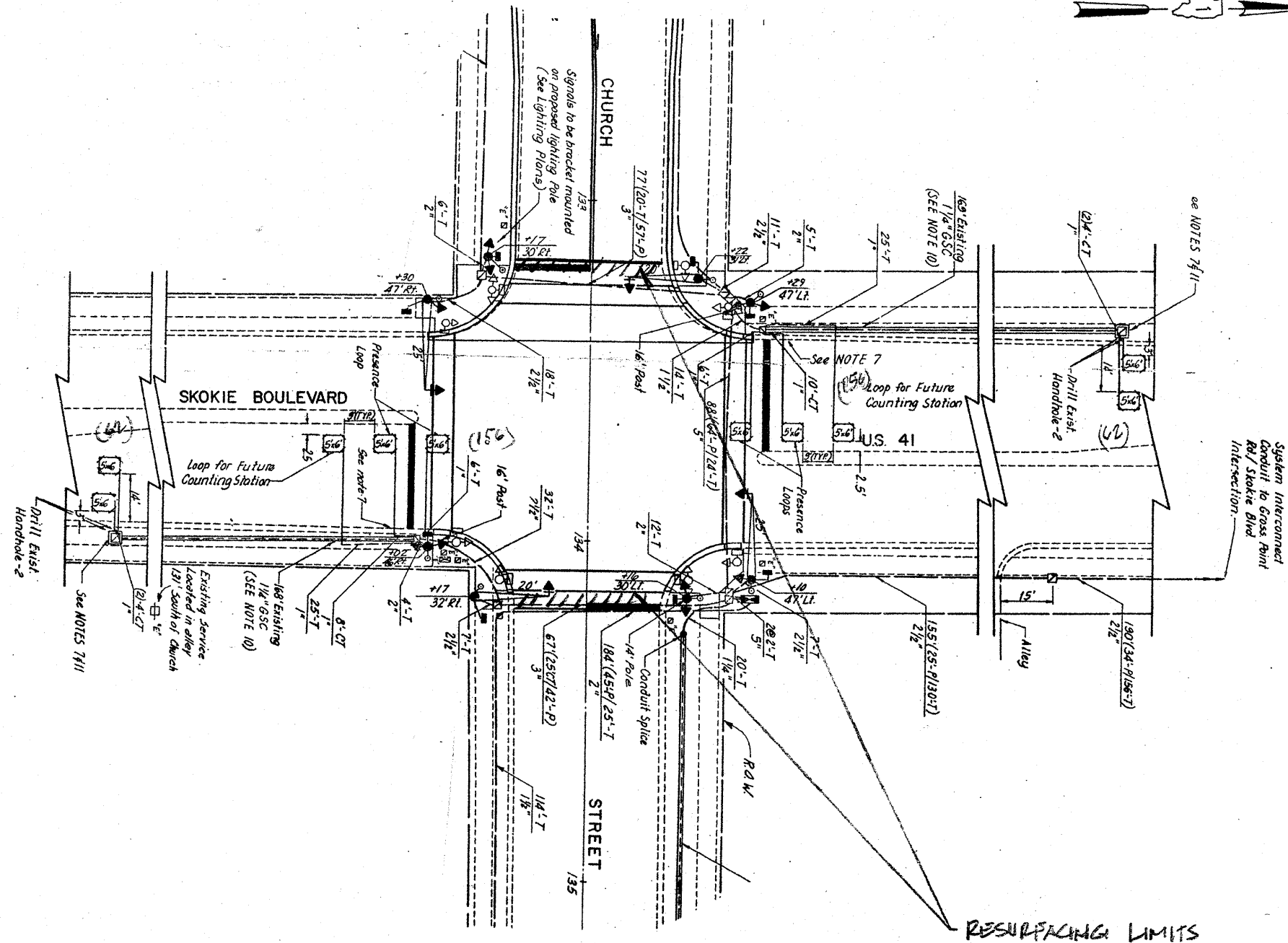

**TRAFFIC SIGNAL LEGEND**

- |  |  |
|--|--|
| <b>PROPOSED</b>                                      | <b>EXISTING</b>                                  |
| CONTROLLER   | RAILROAD CONTROL CABINET                         |
| SERVICE INSTALLATION, (P) POLE OR (G) GROUND MOUNTED | SIGNAL HEAD                                      |
| SIGNAL HEAD WITH BACKPLATE                           | SIGNAL HEAD, PEDESTRIAN                          |
| SIGNAL HEAD, PEDESTRIAN                              | SIGNAL POST                                      |
| SIGNAL POST  | MAST ARM ASSEMBLY AND POLE, STEEL                |
| MAST ARM ASSEMBLY AND POLE, STEEL                    | MAST ARM ASSEMBLY AND POLE, ALUMINIUM            |
| MAST ARM ASSEMBLY AND POLE, ALUMINIUM                | COMMON TRENCH                                    |
| COMMON TRENCH  | UNIT DUCT  |
| UNIT DUCT  | HANDHOLE   |
| HANDHOLE   | HEAVY DUTY HANDHOLE                              |
| HEAVY DUTY HANDHOLE                                  | DOUBLE HANDHOLE                                  |
| DOUBLE HANDHOLE                                      | G.S.CONDUIT IN TRENCH OR PUSHED                  |
| G.S.CONDUIT IN TRENCH OR PUSHED                      | CAST IRON JUNCTION BOX                           |
| CAST IRON JUNCTION BOX                               | SIGNAL HEAD OPTICALLY PROGRAMMED                 |
| SIGNAL HEAD OPTICALLY PROGRAMMED                     | CONDUIT SPLICE                                   |
| CONDUIT SPLICE                                       | WOOD POLE  |
| WOOD POLE  | RACEWAY FOR MAGNETIC DETECTOR, TYPE I OR TYPE II |
| RACEWAY FOR MAGNETIC DETECTOR, TYPE I OR TYPE II     | VEHICLE DETECTOR, NON COMPENSATED MAGNETIC TYPE  |
| VEHICLE DETECTOR, NON COMPENSATED MAGNETIC TYPE      | ILLUMINATED SIGN, FIBER OPTIC "NO LEFT TURN"     |
| ILLUMINATED SIGN, FIBER OPTIC "NO LEFT TURN"         | ILLUMINATED SIGN, FIBER OPTIC "NO RIGHT TURN"    |
| ILLUMINATED SIGN, FIBER OPTIC "NO RIGHT TURN"        | TELEPHONE CONNECTION                             |
| TELEPHONE CONNECTION                                 | PEDESTRIAN PUSHBUTTON DETECTOR                   |
| PEDESTRIAN PUSHBUTTON DETECTOR                       | DETECTOR LOOP, TYPE I                            |



**REPLACE ALL DETECTOR LOOPS AS SHOWN**  
(WITHIN THE RESURFACING LIMITS)

CODE NO.	QUANTITY	UNIT	ITEM
86600600	444	Foot	Detector Loop Replacement

REVISIONS	
NAME	DATE

**NOTE:**  
THIS PLAN IS FOR THE PURPOSE OF REPLACING THE DETECTOR LOOPS ONLY. ALL OTHER INFORMATION SHOWN IS NOT RELATED AND WILL BE DISREGARDED.

ILLINOIS DEPARTMENT OF TRANSPORTATION  
**DETECTOR LOOP REPLACEMENT**  
U.S. ROUTE 41 @ CHURCH STREET

SCALE: NONE  
DATE: Nov. 2008

DRAWN BY: JHE  
DESIGNED BY: JHE  
CHECKED BY: DAB