

STATE OF ILLINOIS  
DEPARTMENT OF TRANSPORTATION  
DIVISION OF HIGHWAYS

PROPOSED  
HIGHWAY PLANS

FAP 303 (IL-173)  
U.S. 12 (MAIN ST.) TO LAKE CO. LINE  
SECTION: (132, 133 & 134) RS-6  
RESURFACING (MAINTENANCE)  
McHENRY COUNTY

C-91-253-02  
PROJECT: ESP-0303 (042)

F.A.P. RTE.	SECTION	COUNTY	TOTAL SHEETS	SHEET NO.
303	(132, 133 & 134) RS-6	McHENRY	26	1
FED. ROAD DIST. NO.	ILLINOIS	CONTRACT NO. 62495		

FOR INDEX OF SHEETS, SEE SHEET NO. 2

THE IMPROVEMENT IS LOCATED IN THE VILLAGE OF FOX LAKE & RICHMOND

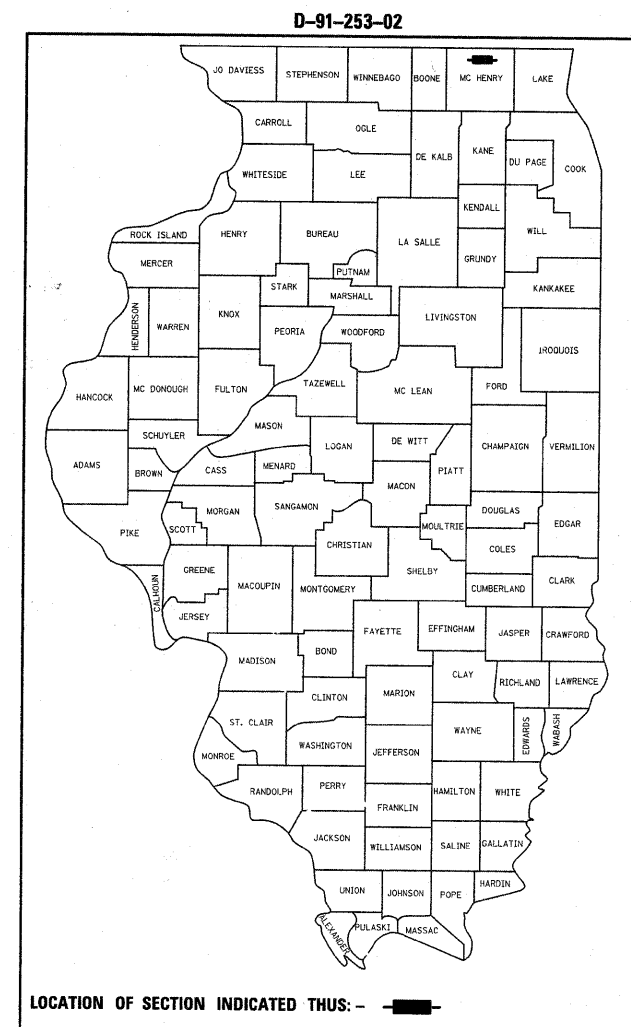

IMPROVEMENT BEGINS  
STATION 17+00

AVERAGE DAILY TRAFFIC  
IL-173, 2005 ADT=8,400

POSTED SPEED LIMIT  
45-55 MPH

IMPROVEMENT ENDS  
STA. 304+88

OMISSION  
STA. 35+70 TO STA. 48+50

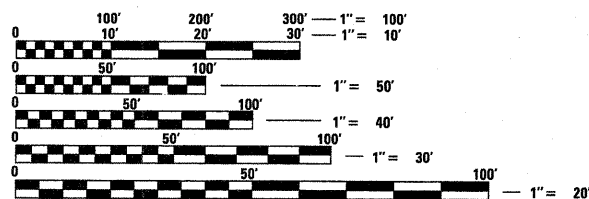
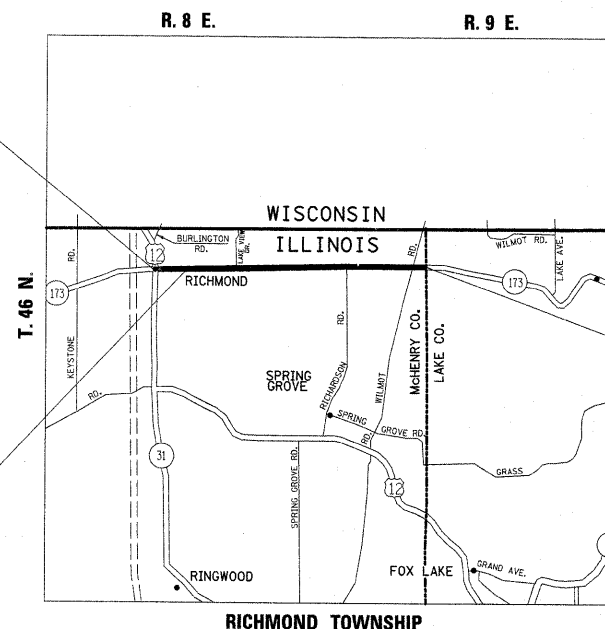

FULL SIZE PLANS HAVE BEEN PREPARED USING STANDARD ENGINEERING SCALES. REDUCED SIZED PLANS WILL NOT CONFORM TO STANDARD SCALES. IN MAKING MEASUREMENTS ON REDUCED PLANS, THE ABOVE SCALES MAY BE USED.

J.U.L.I.E.  
JOINT UTILITY LOCATION INFORMATION FOR EXCAVATION  
1-800-892-0123  
OR 811

PROJECT ENGINEER KEN ENG (847) 705-4247  
PROJECT MANAGER

GROSS LENGTH = 28,788 FEET (5.452 MILES)  
NET LENGTH = 27,508 FEET (5.210 MILES)

CONTRACT NO. 62495

STATE OF ILLINOIS  
DEPARTMENT OF TRANSPORTATION  
DIVISION OF HIGHWAYS

SUBMITTED JANUARY 6, 2009

Diana M. O'Keefe DEPUTY DIRECTOR OF HIGHWAYS, REGION ENGINEER  
March 13, 2009

Charles G. Ingersoll ENGINEER OF DESIGN AND ENVIRONMENT  
March 13, 2009

Christine M. Reed DIRECTOR OF HIGHWAYS, CHIEF ENGINEER

PRINTED BY THE AUTHORITY  
OF THE STATE OF ILLINOIS

DISTRICT 1 DESIGN PLAN PREPARATION ENGINEER: KEN ENG (847) 705-4247

**INDEX OF SHEETS**

SHEET NO.	DESCRIPTION
1	COVER SHEET
2	INDEX OF SHEETS, LIST OF STATE STANDARDS, AND PLAN NOTES
3	SUMMARY OF QUANTITIES
4	TYPICAL CROSS SECTIONS
5-14	EXISTING AND PROPOSED ROADWAY AND PAVEMENT MARKING PLANS
15	DETECTOR LOOP REPLACEMENT PLANS
16	DETAILS FOR FRAMES & LIDS ADJUSTMENT WITH MILLING
17	PAVEMENT PATCHING FOR HMA SURFACED PAVEMENT
18	CURB & GUTTER REMOVAL & REPLACEMENT
19	BUTT JOINT AND HMA TAPER DETAIL
20	TRAFFIC CONTROL AND PROTECTION FOR SIDE ROADS, INTERSECTIONS, AND DRIVEWAYS
21	TYPICAL APPLICATION RAISED REFLECTIVE PAVEMENT MARKERS (SNOW PLOW RESISTANT)
22	DISTRICT ONE TYPICAL PAVEMENT MARKINGS
23	TRAFFIC CONTROL AND PROTECTION AT TURN BAYS (TO REMAIN OPEN TO TRAFFIC)
24	PAVEMENT MARKING LETTERS AND SYMBOLS FOR TRAFFIC STAGING
25	ARTERIAL ROAD INFORMATION SIGN
26	DISTRICT ONE DETECTOR LOOP INSTALLATION DETAILS FOR ROADWAY RESURFACING

**STANDARDS**

STD. NO.	DESCRIPTION
000001-05	STANDARD SYMBOLS, ABBREVIATIONS AND PATTERNS
442201-03	CLASS C & D PATCHES
606001-04	CONCRETE CURB AND COMBINATION CONCRETE CURB AND GUTTER
701001-02	OFF ROAD OPERATIONS, 2L, 2W, MORE THEN 4.5m (15') AWAY
701011-02	OFF ROAD MOVING OPERATIONS, 2L, 2W, DAY ONLY
701206-02	LANE CLOSURE, 2L, 2W, NIGHT ONLY FOR SPEEDS $\geq$ 45 MPH
701306-02	LANE CLOSURE, 2L, 2W, SLOW MOVING, OPERATIONS DAYTIME ONLY FOR SPEED 45 MPH
701311-03	LANE CLOSURE, 2L, 2W, MOVING OPERATIONS, DAY ONLY
701336-05	LANE CLOSURE, 2L, 2W, WORK AREAS IN SERIES FOR SPEED $\geq$ 45 MPH
701201-03	LANE CLOSURE, 2L, 2W, DAY ONLY FOR SPEED 45 MPH
701901-01	TRAFFIC CONTROL DEVICES
886001-01	DETECTOR LOOP INSTALLATIONS

**PLAN NOTES**

BEFORE STARTING ANY EXCAVATION, THE CONTRACTOR SHALL CALL "JULIE" AT 1-800-892-0123 FOR FIELD LOCATIONS OF BURIED ELECTRIC, TELEPHONE, AND GAS FACILITIES. (48 HOUR NOTIFICATION IS REQUIRED)

THE CONTRACTOR SHALL COORDINATE CONSTRUCTION ACTIVITIES WITH UTILITY COMPANIES, THE VILLAGES OF FOX LAKE & RICHMOND.

THE CONTRACTOR WILL NOT BE ALLOWED TO SET UP A YARD OR FIELD OFFICE ON STATE PROPERTY WITHOUT WRITTEN PERMISSIONS FROM THE DEPARTMENT.

WHEN MILLED PAVEMENT IS OPEN TO TRAFFIC THE MAXIMUM GRADE DIFFERENTIAL BETWEEN PASSES OF THE MILLING MACHINE SHALL NOT EXCEED 1 1/2 INCHES WHERE THE SPEED LIMIT IS 45 MPH OR LESS AND 1 INCH WHERE THE SPEED LIMIT IS GREATER THAN 45 MPH. WITH WRITTEN APPROVAL FROM THE ENGINEER, A MAXIMUM GRADE DIFFERENTIAL OF 3 INCHES MAY BE ALLOWED IF THE EDGE OF THE MILLING SLOPED A MINIMUM 1:3 (V:H).

BUTT JOINTS WILL BE INSTALLED AT THE ENDS OF ALL RESURFACING (WHERE RESURFACING MEETS EXISTING PAVEMENT), IN ACCORDANCE WITH THE "BUTT JOINT AND HMA TAPER DETAILS," SHEET INCLUDED IN THE PLANS, UNLESS OTHERWISE SPECIFIED.

UNLESS OTHER CONDITIONS WARRANT EXTENDED LANE CLOSURE AS DETERMINED AND APPROVED IN WRITTING BY THE ENGINEER OR AS PROVIDED FOR IN THE CONTRACT SPECIFICATIONS, OVERNIGHT CLOSURES SHALL NOT BE ALLOWED FOR REHABILITATION PROJECTS INVOLVING DAYTIME MILLING AND RESURFACING OPERATIONS AND CLASS D PATCHING.

THE RESIDENT ENGINEER SHALL CONTACT MS. DEBBIE HANLON, AREA TRAFFIC FIELD ENGINEER AT (847) 438-2300 A MINIMUM OF TWO WEEKS PRIOR TO PLACEMENT OF PERMANENT PAVEMENT MARKINGS.

10 FEET TRANSITIONS SHALL BE USED TO MATCH PROPOSED CURB AND GUTTER AND MEDIAN ITEMS OF WORK TO EXISTING CURBS & GUTTER AND MEDIANS IN THE FIELD, UNLESS OTHERWISE SHOWN. THE TRANSITONS SHALL BE PAID FOR AT THE CONTRACT UNIT PRICE FOR THE PROPOSED ITEMS OF WORK SPECIFIED.

THE CONTRACTOR SHALL BE RESPONSIBLE FOR THE PROTECTION OF ALL OVERHEAD, SURFACE, AND UNDERGROUND UTILITIES WITHIN THE PROJECT LIMITS WHETHER OR NOT THE UTILITES ARE SHOWN ON THE PLANS. ANY UTILITY THAT IS DAMAGED DURING CONSTRUCTION SHALL BE REPAIRED OR REPLACED BY THE CONTRACTOR AT HIS OWN EXPENSE.

ALL PROPOSED DRIVEWAYS SHALL BE HOT-MIX ASPHALT UNLESS OTEHRWISE SPECIFIED AS PORTLAND CEMENT CONCRETE ON THE PLAN SHEETS.

THE RESIDENT ENGINEER SHALL CONTACT THE TRAFFIC CONTROL SUPERVISOR AT (847) 705-4470 A MINIMUM OF 72 HOURS PRIOR TO THE PLACEMENT OF ANY TRAFFIC CONTROL DEVICES.

FILE NAME =	USER NAME = lszekrf	DESIGNED -	REVISED -	<b>STATE OF ILLINOIS DEPARTMENT OF TRANSPORTATION</b>	<b>IL. RTE. 173 U.S. 12 (MAIN ST.) TO LAKE COUNTY LINE</b>	F.A.P. RTE.	SECTION	COUNTY	TOTAL SHEETS	SHEET NO.	
c:\Projects\dl25302\sh_rdw.dgn		DRAWN -	REVISED -			303	(132, 133 & 134)RS-6	McHENRY	26	2	
		CHECKED -	REVISED -			CONTRACT NO. 62495					
		DATE -	REVISED -			SCALE: 1"=50'	SHEET NO. OF SHEETS	STA. TO STA.	FED. ROAD DIST. NO.	ILLINOIS FED. AID PROJECT	

URBAN 100% FED

URBAN 100% FED

SUMMARY OF QUANTITIES			80% FEDERAL 20% STATE TOTAL QUANTITIES URBAN	CONSTRUCTION TYPE CODE					SUMMARY OF QUANTITIES			80% FEDERAL 20% STATE TOTAL QUANTITIES URBAN	CONSTRUCTION TYPE CODE					
CODE NO	ITEM	UNIT		I000						CODE NO	ITEM		UNIT	I000				
20201006	GRADING AND SHAPING SHOULDERS	UNIT	536	536														
40600200	BITUMINOUS MATERIALS (PRIME COAT)	TON	74	74														
40600300	AGGREGATE (PRIME COAT)	TON	367	367														
40600400	MIXTURE FOR CRACKS, JOINTS, AND FLANGEWAYS	TON	11	11														
40600895	CONSTRUCTING TEST STRIP	EACH	2	2														
40600982	HOT-MIX ASPHALT SURFACE REMOVAL - BUTT JOINT	SQ YD	153	153														
40601005	HOT-MIX ASPHALT REPLACEMENT OVER PATCHES	TON	1347	1347														
40603340	HOT-MIX ASPHALT SURFACE COURSE, MIX "D", N70	TON	8628	8628														
44000155	HOT-MIX ASPHALT SURFACE REMOVAL, 1 1/2"	SQ YD	22233	22233														
44000158	HOT-MIX ASPHALT SURFACE REMOVAL, 2 1/4"	SQ YD	80474	80474														
44001700	COMBINATION CONCRETE CURB AND GUTTER REMOVAL AND REPLACEMENT	FOOT	165	165														
44002232	HOT-MIX ASPHALT REMOVAL OVER PATCHES, 8"	SQ YD	8014	8014														
44201753	CLASS D PATCHES, TYPE II, 9 INCH	SQ YD	3435	3435														
44201757	CLASS D PATCHES, TYPE III, 9 INCH	SQ YD	2250	2250														
44201759	CLASS D PATCHES, TYPE IV, 9 INCH	SQ YD	1600	1600														
48102100	AGGREGATE WEDGE SHOULDER, TYPE B	TON	2459	2459														
60300310	FRAMES AND LIDS TO BE ADJUSTED (SPECIAL)	EACH	5	5														
67000400	ENGINEER'S FIELD OFFICE, TYPE A	CAL MO	6	6														
67100100	MOBILIZATION	L SUM	1	1														
70100450	TRAFFIC CONTROL AND PROTECTION, STANDARD 701201	L SUM	1	1														
70100455	TRAFFIC CONTROL AND PROTECTION, STANDARD 701206	L SUM	1	1														
70100460	TRAFFIC CONTROL AND PROTECTION, STANDARD 701306	L SUM	1	1														
70100600	TRAFFIC CONTROL AND PROTECTION, STANDARD 701336	L SUM	1	1														
70300100	SHORT-TERM PAVEMENT MARKING	FOOT	7059	7059														
70300210	TEMPORARY PAVEMENT MARKING - LETTERS AND SYMBOLS	SQ FT	218	218														
70300220	TEMPORARY PAVEMENT MARKING - LINE 4"	FOOT	91972	91972														
70300240	TEMPORARY PAVEMENT MARKING - LINE 6"	FOOT	700	700														
70300260	TEMPORARY PAVEMENT MARKING - LINE 12"	FOOT	557	557														
70300280	TEMPORARY PAVEMENT MARKING - LINE 24"	FOOT	41	41														
* 78000100	THERMOPLASTIC PAVEMENT MARKING - LETTERS AND SYMBOLS	SQ FT	218	218														
* 78000200	THERMOPLASTIC PAVEMENT MARKING - LINE 4"	FOOT	91972	91972														
* 78000400	THERMOPLASTIC PAVEMENT MARKING - LINE 6"	FOOT	700	700														
* 78000600	THERMOPLASTIC PAVEMENT MARKING - LINE 12"	FOOT	557	557														
* 78000650	THERMOPLASTIC PAVEMENT MARKING - LINE 24"	FOOT	41	41														
* 78100100	RAISED REFLECTIVE PAVEMENT MARKER	EACH	500	500														
78300200	RAISED REFLECTIVE PAVEMENT MARKER REMOVAL	EACH	500	500														
88600600	DETECTOR LOOP REPLACEMENT	FOOT	165	165														
X0322256	TEMPORARY INFORMATION SIGNING	SQ FT	52	52														
X4067107	POLYMERIZED LEVELING BINDER (MACHINE METHOD), IL-4.75, N50	TON	3380	3380														
© 20076600	TRAINEES	HOUR	1000	1000														

© Y080  
\* SPECIALTY ITEM

FILE NAME =	USER NAME = ulrlorkd	DESIGNED -	REVISED -	<b>STATE OF ILLINOIS DEPARTMENT OF TRANSPORTATION</b>				<b>SUMMARY OF QUANTITIES</b>				F.A.P RTE.	SECTION	COUNTY	TOTAL SHEETS	SHEET NO.
g:\pw_work\PI\DOT\ULRICH\D\dms90758\sh_rdw\y.dgn		DRAWN -	REVISED -									303	(132, 133 & 134)RS-6	McHENRY	26	3
		CHECKED -	REVISED -									FED. ROAD DIST. NO. 1 ILLINOIS FED. AID PROJECT				
		DATE -	REVISED -									SCALE:	SHEET NO. OF SHEETS	STA.	TO STA.	CONTRACT NO. 62495

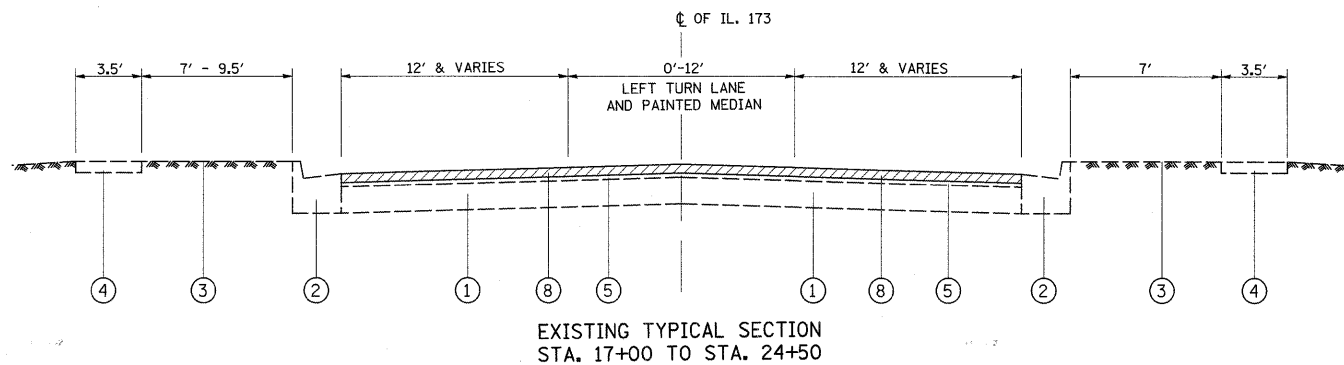

EXISTING TYPICAL SECTION  
STA. 17+00 TO STA. 24+50

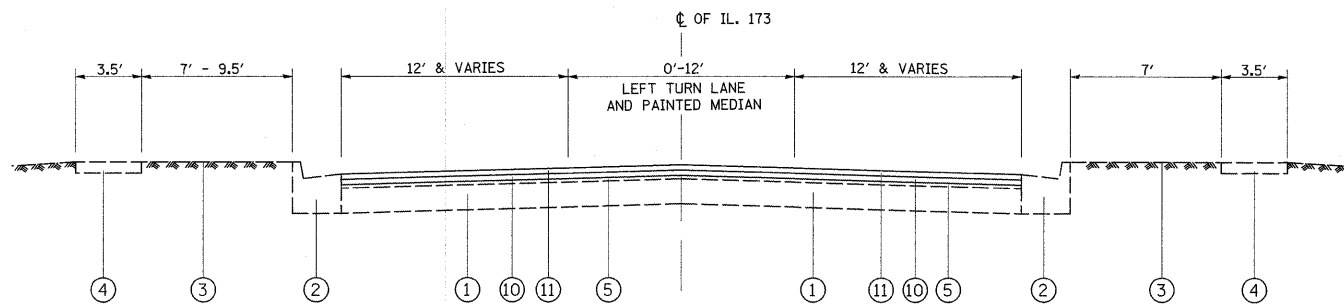

PROPOSED TYPICAL SECTION  
STA. 17+00 TO STA. 24+50

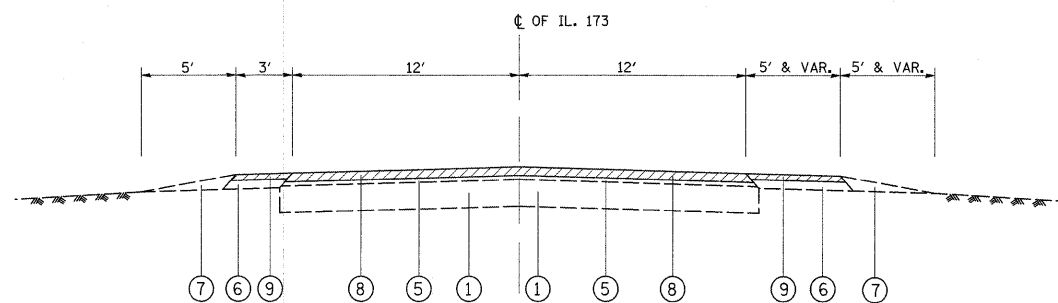

EXISTING TYPICAL SECTION  
STA. 24+50 TO STA. 123+50  
STA. 141+00 TO STA. 219+50  
STA. 232+00 TO STA. 304+88

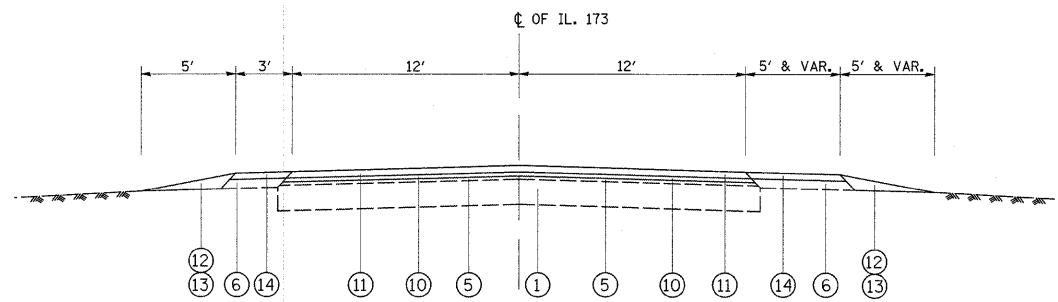

PROPOSED TYPICAL SECTION  
STA. 24+50 TO STA. 123+50  
STA. 141+00 TO STA. 219+50  
STA. 232+00 TO STA. 304+88

MIXTURE USE	AC/PG	DESIGN AIR VOIDS	REMARKS
HOT-MIX ASPHALT SURFACE COURSE, SUPERPAVE MIX "D", N70, 1 1/2"	PG 64-22	4% @ 70 GYR.	IL-9.5 MM
POLYMERIZED LEVELING BINDER (MACHINE METHOD), IL-4.75, N50, 3/4"	SBS/SBR PG 76-28/-22	4% @ 50 GYR.	
HMA REPLACEMENT OVER PATCHES, 7.5"	PG 64-22*	4% @ 70' GYR.	BINDER HMA IL-19 MM
HMA SHOULDER, 1 1/2" (MIX SAME AS SURFACE COURSE)	PG 64-22	4% @ 70 GYR.	IL-9.5 MM
CLASS "D" PATCHES, 8"	PG 64-22*	4% @ 70 GYR.	BINDER HMA IL-19 MM

NOTE: "THE UNIT WEIGHT USED TO CALCULATE ALL HMA SURFACE MIXTURE QUANTITIES IS 112 LBS./SQ.YD./IN"  
"WHEN RAP EXCEEDS 20%, THEN NEW ASPHALT BINDER IN THE MIX SHALL BE PG58-22"

- ① EXISTING P.C.C. PAVEMENT
- ② EXISTING COMBINATION CONCRETE CURB & GUTTER, TYPE B-6.24
- ③ EXISTING PARKWAY
- ④ EXISTING P.C.C. SIDEWALK
- ⑤ EXISTING HMA SURFACE REMAINING AFTER SURFACE REMOVAL, 5 3/4"
- ⑥ EXISTING HMA SHOULDER, 8"
- ⑦ EXISTING AGGREGATE SHOULDER
- ⑧ PROPOSED HMA SURFACE REMOVAL, 2 1/4"
- ⑨ PROPOSED HMA SURFACE REMOVAL, 1 1/2"
- ⑩ PROPOSED POLYMERIZED LEVELING BINDER (MM), IL-4.75, N50, 3/4"
- ⑪ PROPOSED HMA SURFACE COURSE, MIX D, N70, 1 1/2"
- ⑫ PROPOSED GRADING AND SHAPING
- ⑬ PROPOSED AGGREGATE SHOULDER, TYPE B, 380 UNITS
- ⑭ PROPOSED HMA SHOULDER, 1 1/2"

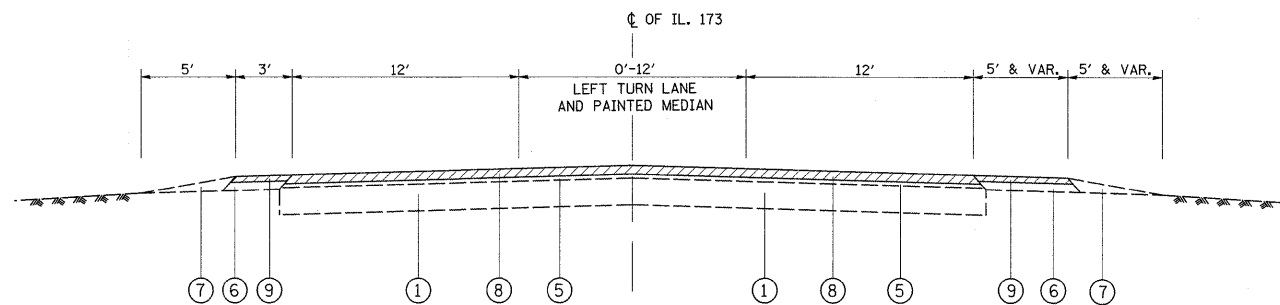

EXISTING TYPICAL SECTION  
STA. 123+50 TO STA. 141+00  
STA. 219+50 TO STA. 232+00

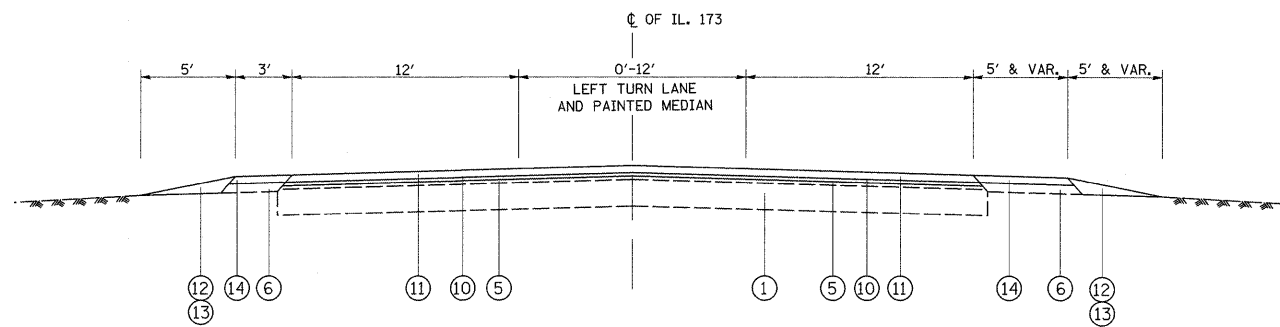

PROPOSED TYPICAL SECTION  
STA. 123+50 TO STA. 141+00  
STA. 219+50 TO STA. 232+00

FILE NAME =  
c:\Projects\dl25302\sh\_rdw.dgn

USER NAME = lsszkrf  
PLOT SCALE = 50.0000' / IN.  
PLOT DATE = 10/17/2008

DESIGNED -  
DRAWN -  
CHECKED -  
DATE -

REVISED -  
REVISED -  
REVISED -  
REVISED -

STATE OF ILLINOIS  
DEPARTMENT OF TRANSPORTATION

IL. ROUTE 173 (U.S. 12 TO COUNTY LINE)  
TYPICAL SECTIONS

SCALE: 1"=50' SHEET NO. 1 OF 10 SHEETS STA. 17+00 TO STA. 304+88

F.A.P. RTE. 303	SECTION (132, 133 & 134)RS-6	COUNTY McHENRY	TOTAL SHEETS 26	SHEET NO. 4
CONTRACT NO. 62495				
FED. ROAD DIST. NO. [ILLINOIS] FED. AID PROJECT				



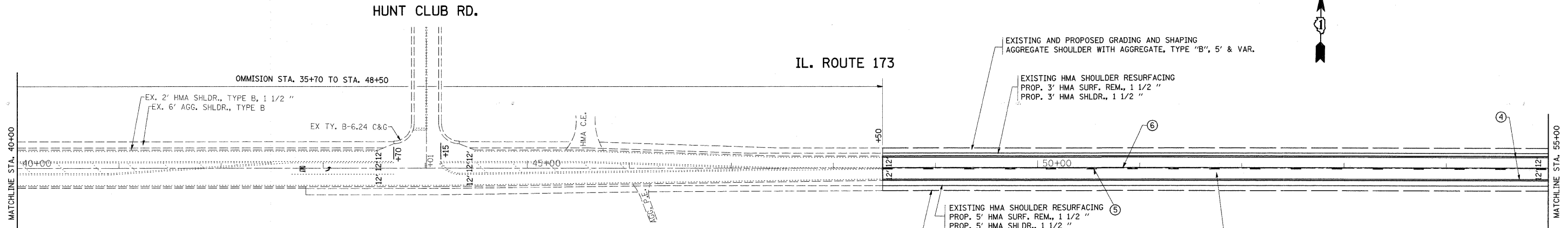

**LEGEND**

- ① THERMOPLASTIC PAVEMENT MARKING CENTERLINE, 4" SOLID YELLOW (DOUBLE), 11" C-C
- ② THERMOPLASTIC PAVEMENT MARKING 12" SOLID YELLOW (RT. 45° DIAGONALS @ 20' C-C)
- ③ THERMOPLASTIC PAVEMENT MARKING LANE LINE, 6" WHITE
- ④ THERMOPLASTIC PAVEMENT MARKING EDGE LINE, 4" SOLID WHITE
- ⑤ THERMOPLASTIC PAVEMENT MARKING SKIP DASH LINE, 4" YELLOW, 10'-30'
- ⑥ THERMOPLASTIC PAVEMENT MARKING CENTERLINE (NO PASS ZONE), 4" SOLID YELLOW
- ⑦ THERMOPLASTIC PAVEMENT MARKING STOP BAR, 24" SOLID WHITE
- ⑧ THERMOPLASTIC PAVEMENT MARKING LEFT TURN ONLY LETTERS AND SYMBOLS, 8" WHITE

FILE NAME = c:\p\projects\d125302\sh_rdwj.dgn	USER NAME = lszekrf	DESIGNED -	REVISED -	<b>STATE OF ILLINOIS DEPARTMENT OF TRANSPORTATION</b>	<b>IL. ROUTE 173 (U.S. 12 TO COUNTY LINE) ROADWAY AND PAVEMENT MARKING PLAN</b>	F.A.P. RTE. 303	SECTION (132, 133 & 134)RS-6	COUNTY McHENRY	TOTAL SHEETS 26	SHEET NO. 6		
	PLOT SCALE = 50.0000' / IN.	CHECKED -	REVISED -			CONTRACT NO. 62495						
	PLOT DATE = 10/17/2008	DATE -	REVISED -			SCALE: 1"=50'	SHEET NO. 2 OF 10 SHEETS	STA. 40+00 TO STA. 70+00	FED. ROAD DIST. NO. [ILLINOIS] FED. AID PROJECT			

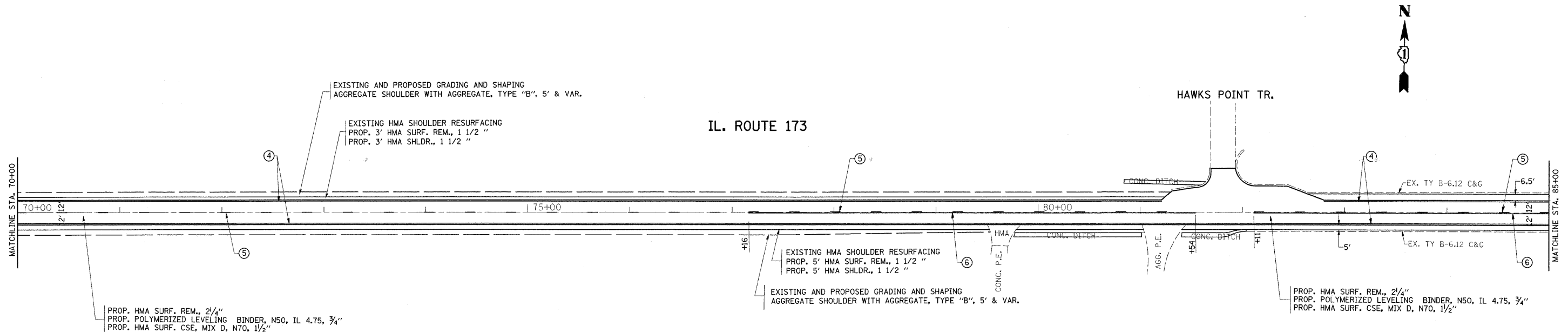

**LEGEND**

- ① THERMOPLASTIC PAVEMENT MARKING CENTERLINE, 4" SOLID YELLOW (DOUBLE), 11" C-C
- ② THERMOPLASTIC PAVEMENT MARKING 12" SOLID YELLOW (RT. 45° DIAGONALS @ 20' C-C)
- ③ THERMOPLASTIC PAVEMENT MARKING LANE LINE, 6" WHITE
- ④ THERMOPLASTIC PAVEMENT MARKING EDGE LINE, 4" SOLID WHITE
- ⑤ THERMOPLASTIC PAVEMENT MARKING SKIP DASH LINE, 4" YELLOW, 10'-30'
- ⑥ THERMOPLASTIC PAVEMENT MARKING CENTERLINE (NO PASS ZONE), 4" SOLID YELLOW
- ⑦ THERMOPLASTIC PAVEMENT MARKING STOP BAR, 24" SOLID WHITE
- ⑧ THERMOPLASTIC PAVEMENT MARKING LEFT TURN ONLY LETTERS AND SYMBOLS, 8" WHITE

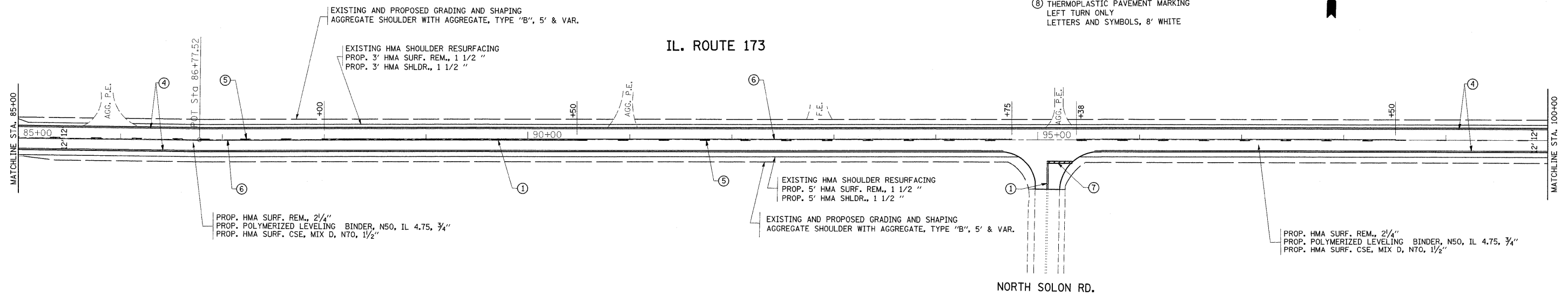

FILE NAME =  
c:\Projects\1125302\sh\_rdw.dgn

USER NAME = lizekrf  
PLOT SCALE = 50.0000' / IN.  
PLOT DATE = 10/17/2008

DESIGNED -  
DRAWN -  
CHECKED -  
DATE -

REVISED -  
REVISED -  
REVISED -  
REVISED -

**STATE OF ILLINOIS  
DEPARTMENT OF TRANSPORTATION**

**IL. ROUTE 173 (U.S. 12 TO COUNTY LINE)  
ROADWAY AND PAVEMENT MARKING PLAN**

SCALE: 1"=50'    SHEET NO. 3 OF 10 SHEETS    STA. 70+00 TO STA. 100+00

F.A.P. RTE.	SECTION	COUNTY	TOTAL SHEETS	SHEET NO.
303	(132, 133 & 134)RS-6	McHENRY	26	7
CONTRACT NO. 62495				
FED. ROAD DIST. NO. ILLINOIS FED. AID PROJECT				

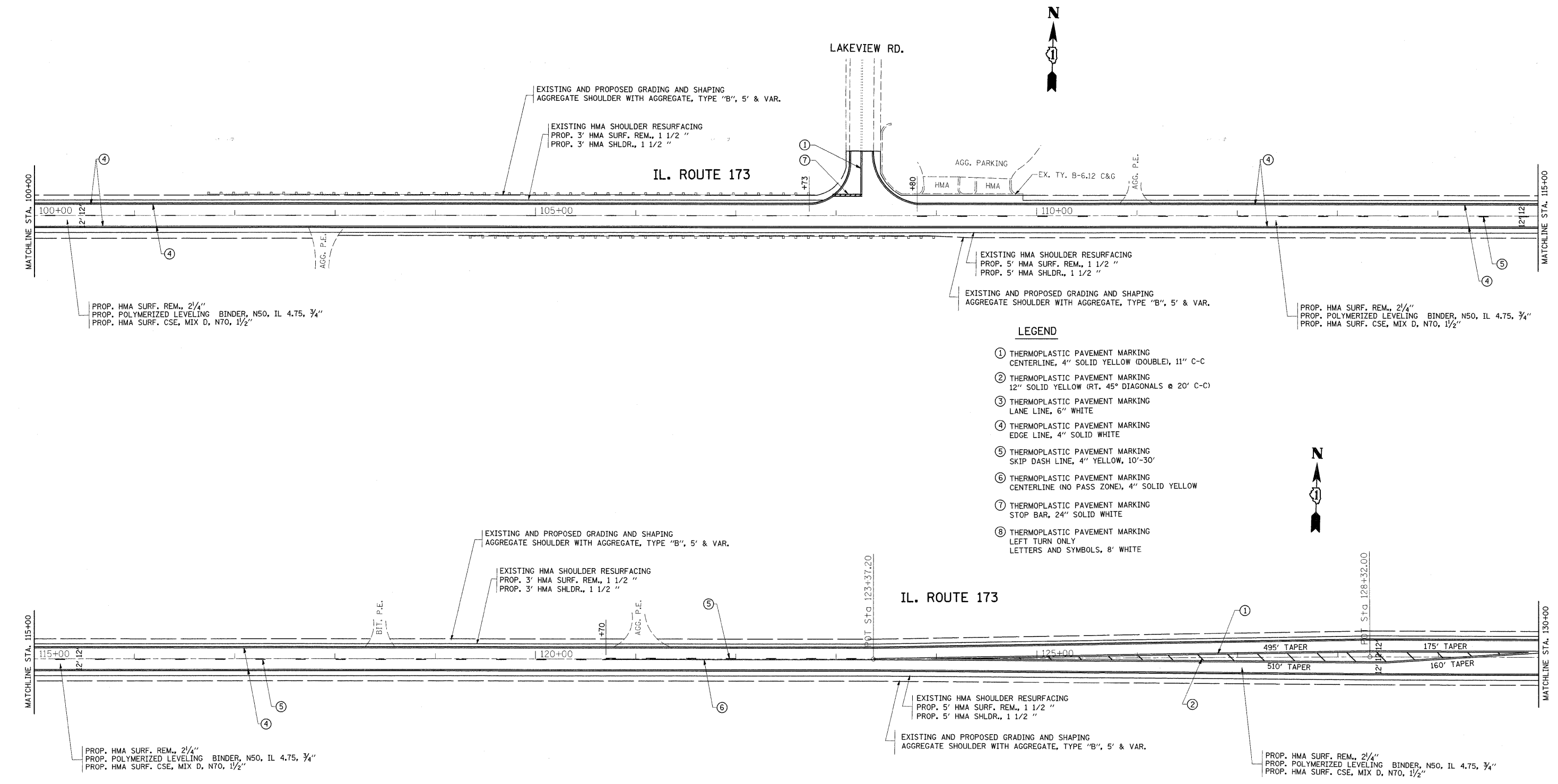

**LEGEND**

- ① THERMOPLASTIC PAVEMENT MARKING  
CENTERLINE, 4" SOLID YELLOW (DOUBLE), 11" C-C
- ② THERMOPLASTIC PAVEMENT MARKING  
12" SOLID YELLOW (RT. 45° DIAGONALS @ 20' C-C)
- ③ THERMOPLASTIC PAVEMENT MARKING  
LANE LINE, 6" WHITE
- ④ THERMOPLASTIC PAVEMENT MARKING  
EDGE LINE, 4" SOLID WHITE
- ⑤ THERMOPLASTIC PAVEMENT MARKING  
SKIP DASH LINE, 4" YELLOW, 10'-30'
- ⑥ THERMOPLASTIC PAVEMENT MARKING  
CENTERLINE (NO PASS ZONE), 4" SOLID YELLOW
- ⑦ THERMOPLASTIC PAVEMENT MARKING  
STOP BAR, 24" SOLID WHITE
- ⑧ THERMOPLASTIC PAVEMENT MARKING  
LEFT TURN ONLY  
LETTERS AND SYMBOLS, 8" WHITE

FILE NAME = c:\Projects\dl25302\sh_rdy.dgn	USER NAME = lszkrf	DESIGNED -	REVISED -	<b>STATE OF ILLINOIS DEPARTMENT OF TRANSPORTATION</b>	<b>IL. ROUTE 173 (U.S. 12 TO COUNTY LINE) ROADWAY AND PAVEMENT MARKING PLAN</b>			F.A.P. RTE.	SECTION	COUNTY	TOTAL SHEETS	SHEET NO.
	PLOT SCALE = 50,0000' / IN.	CHECKED -	REVISED -					303	(132, 133 & 134)RS-6	McHENRY	26	8
PLOT DATE = 10/17/2008	DATE -	REVISED -	REVISED -		SCALE: 1"=50'	SHEET NO. 4 OF 10 SHEETS	STA. 100+00 TO STA. 130+00	FED. ROAD DIST. NO. ILLINOIS FED. AID PROJECT				
							CONTRACT NO. 62495					



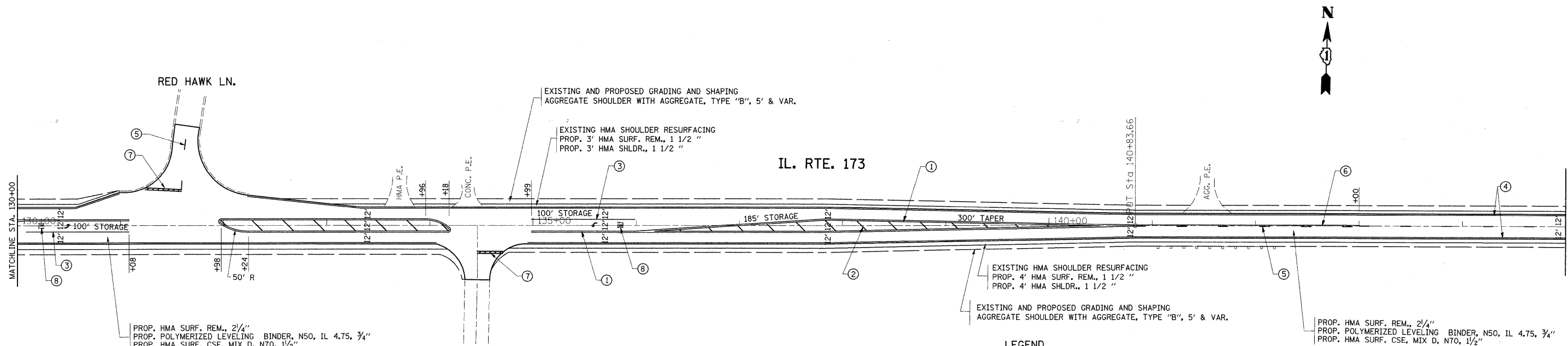

N. CLARK RD.

IL. RTE. 173

PROP. HMA SURF. REM., 2/4"  
 PROP. POLYMERIZED LEVELING BINDER, N50, IL 4.75, 3/4"  
 PROP. HMA SURF. CSE, MIX D, N70, 1/2"

EXISTING HMA SHOULDER RESURFACING  
 PROP. 4' HMA SURF. REM., 1 1/2 "  
 PROP. 4' HMA SHLDR., 1 1/2 "

EXISTING AND PROPOSED GRADING AND SHAPING  
 AGGREGATE SHOULDER WITH AGGREGATE, TYPE "B", 5' & VAR.

PROP. HMA SURF. REM., 2/4"  
 PROP. POLYMERIZED LEVELING BINDER, N50, IL 4.75, 3/4"  
 PROP. HMA SURF. CSE, MIX D, N70, 1/2"

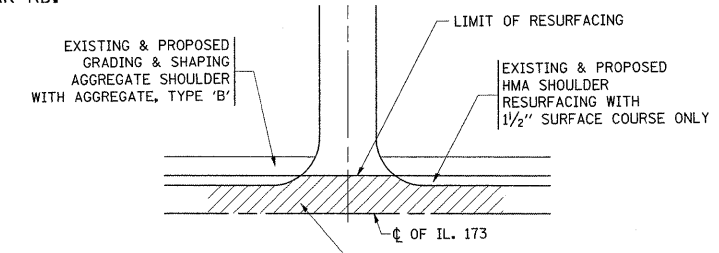

- RESURFACING OF MAIN LINE
- ① HMA SURFACE REMOVAL, 2/4"
  - ② POLYMERIZED LEVELING BINDER (MM) WITH IL-4.75 MM MIX, 3/4"
  - ③ HMA SURFACE COURSE, MIX D, 1/2"

**LEGEND**

- ① THERMOPLASTIC PAVEMENT MARKING CENTERLINE, 4" SOLID YELLOW (DOUBLE), 11" C-C
- ② THERMOPLASTIC PAVEMENT MARKING 12" SOLID YELLOW (RT. 45° DIAGONALS @ 20' C-C)
- ③ THERMOPLASTIC PAVEMENT MARKING LANE LINE, 6" WHITE
- ④ THERMOPLASTIC PAVEMENT MARKING EDGE LINE, 4" SOLID WHITE
- ⑤ THERMOPLASTIC PAVEMENT MARKING SKIP DASH LINE, 4" YELLOW, 10'-30'
- ⑥ THERMOPLASTIC PAVEMENT MARKING CENTERLINE (NO PASS ZONE), 4" SOLID YELLOW
- ⑦ THERMOPLASTIC PAVEMENT MARKING STOP BAR, 24" SOLID WHITE
- ⑧ THERMOPLASTIC PAVEMENT MARKING LEFT TURN ONLY LETTERS AND SYMBOLS, 8" WHITE

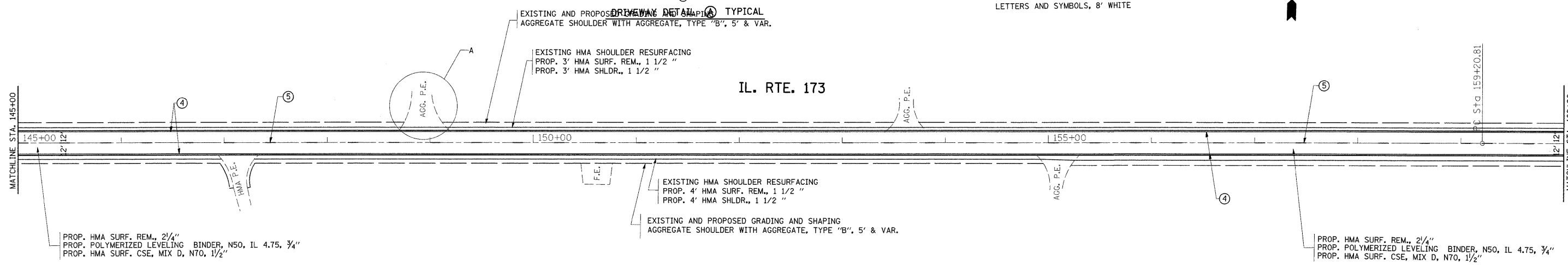

IL. RTE. 173

PROP. HMA SURF. REM., 2/4"  
 PROP. POLYMERIZED LEVELING BINDER, N50, IL 4.75, 3/4"  
 PROP. HMA SURF. CSE, MIX D, N70, 1/2"

EXISTING HMA SHOULDER RESURFACING  
 PROP. 4' HMA SURF. REM., 1 1/2 "  
 PROP. 4' HMA SHLDR., 1 1/2 "

EXISTING AND PROPOSED GRADING AND SHAPING  
 AGGREGATE SHOULDER WITH AGGREGATE, TYPE "B", 5' & VAR.

PROP. HMA SURF. REM., 2/4"  
 PROP. POLYMERIZED LEVELING BINDER, N50, IL 4.75, 3/4"  
 PROP. HMA SURF. CSE, MIX D, N70, 1/2"

FILE NAME = c:\Projects\125302\sh_rdw.dgn	USER NAME = lszekrf	DESIGNED -	REVISED -	<b>STATE OF ILLINOIS DEPARTMENT OF TRANSPORTATION</b>	<b>IL. ROUTE 173 (U.S. 12 TO COUNTY LINE) ROADWAY AND PAVEMENT MARKING PLAN</b>		F.A.P. RTE. 303	SECTION (132, 133 & 134)RS-6	COUNTY McHENRY	TOTAL SHEETS 26	SHEET NO. 9			
	PLOT SCALE = 50.0000' / IN.	CHECKED -	REVISED -				SCALE: 1"=50'		SHEET NO. 5 OF 10 SHEETS		STA. 130+00 TO STA. 160+00		CONTRACT NO. 62495	
	PLOT DATE = 10/17/2008	DATE -	REVISED -				FED. ROAD DIST. NO.		ILLINOIS FED. AID PROJECT					

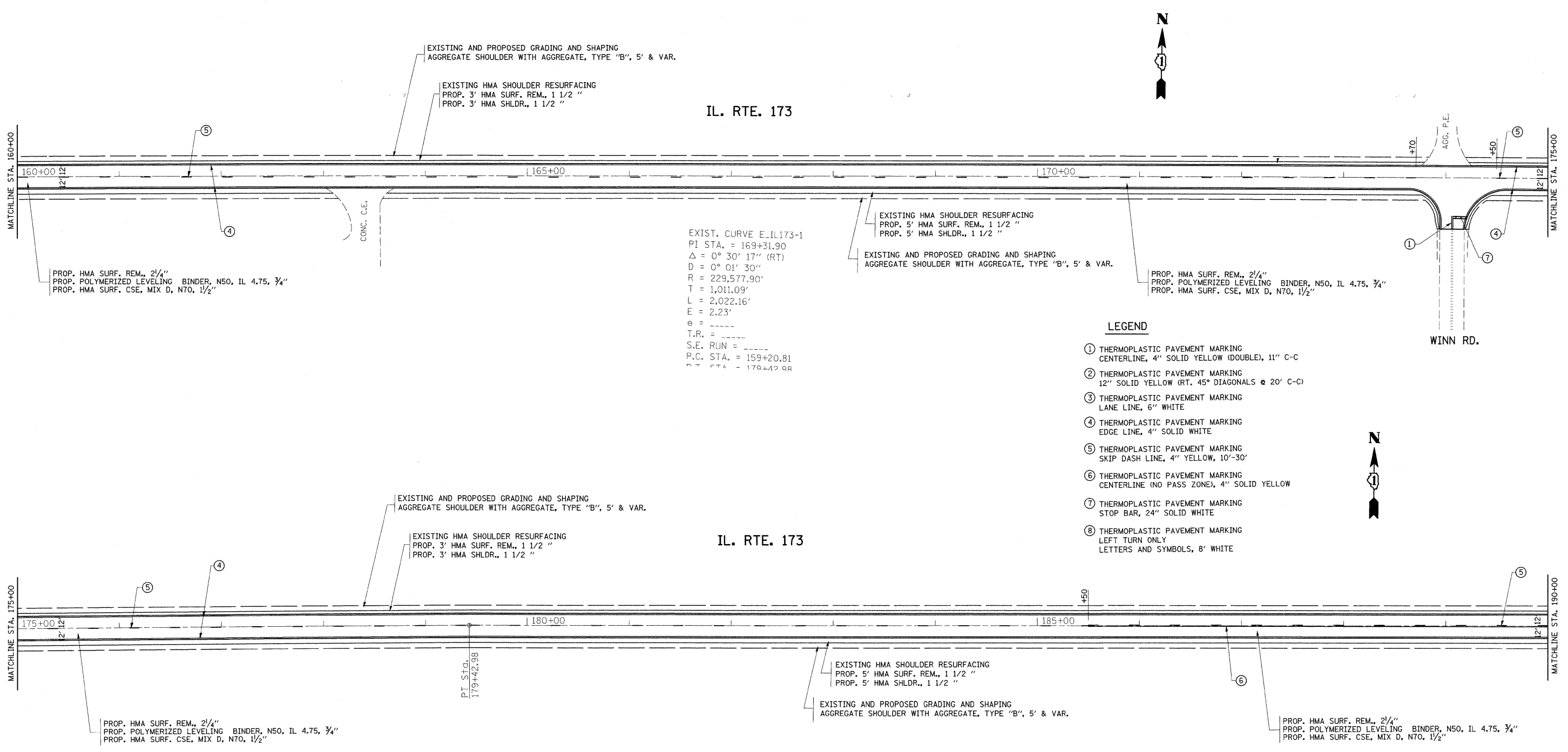

FILE NAME = c:\Projects\dl25302\sh_rdwg.dgn	USER NAME = lszekrf	DESIGNED -	REVISED -	<b>STATE OF ILLINOIS DEPARTMENT OF TRANSPORTATION</b>	<b>IL. ROUTE 173 (U.S. 12 TO COUNTY LINE) ROADWAY AND PAVEMENT MARKING PLAN</b>			F.A.P. RTE. 303	SECTION 132, 133 & 134/RS-6	COUNTY McHENRY	TOTAL SHEETS 26	SHEET NO. 10
PLOT SCALE = 50.0000' / IN.	CHECKED -	REVISED -	REVISED -		SCALE: 1"=50'	SHEET NO. 6 OF 10 SHEETS	STA. 160+00 TO STA. 190+00	CONTRACT NO. 62495				
PLOT DATE = 10/17/2008	DATE -	REVISED -	REVISED -		FED. ROAD DIST. NO. ILLINOIS FED. AID PROJECT							

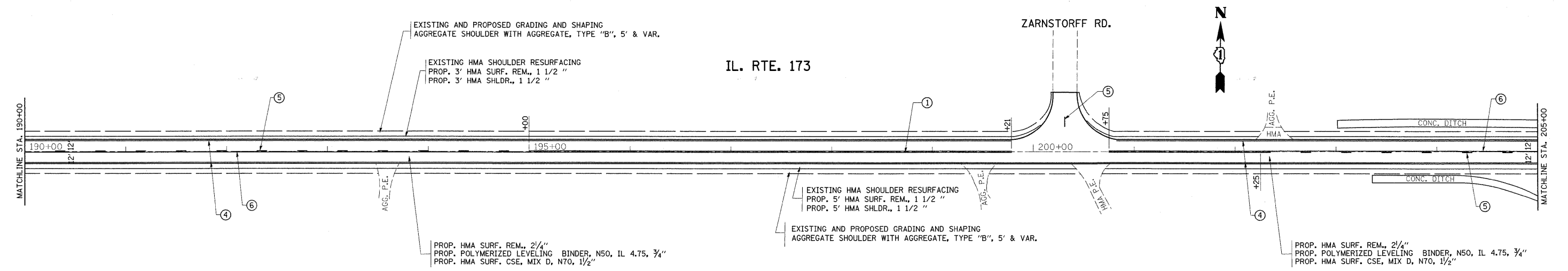

**LEGEND**

- ① THERMOPLASTIC PAVEMENT MARKING  
CENTERLINE, 4" SOLID YELLOW (DOUBLE), 11" C-C
- ② THERMOPLASTIC PAVEMENT MARKING  
12" SOLID YELLOW (RT. 45° DIAGONALS @ 20' C-C)
- ③ THERMOPLASTIC PAVEMENT MARKING  
LANE LINE, 6" WHITE
- ④ THERMOPLASTIC PAVEMENT MARKING  
EDGE LINE, 4" SOLID WHITE
- ⑤ THERMOPLASTIC PAVEMENT MARKING  
SKIP DASH LINE, 4" YELLOW, 10'-30'
- ⑥ THERMOPLASTIC PAVEMENT MARKING  
CENTERLINE (NO PASS ZONE), 4" SOLID YELLOW
- ⑦ THERMOPLASTIC PAVEMENT MARKING  
STOP BAR, 24" SOLID WHITE
- ⑧ THERMOPLASTIC PAVEMENT MARKING  
LEFT TURN ONLY  
LETTERS AND SYMBOLS, 8" WHITE

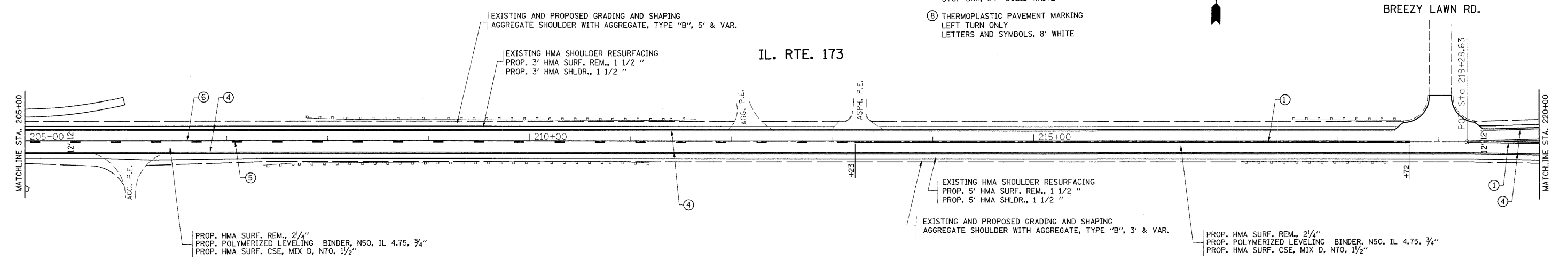

FILE NAME = c:\Projects\125302\sh_rdw.dgn	USER NAME = lszekrf	DESIGNED -	REVISED -	<b>STATE OF ILLINOIS DEPARTMENT OF TRANSPORTATION</b>	<b>IL. ROUTE 173 (U.S. 12 TO COUNTY LINE) ROADWAY AND PAVEMENT MARKING PLAN</b>	F.A.P. RTE. 303	SECTION (132, 133 & 134)RS-6	COUNTY McHENRY	TOTAL SHEETS 26	SHEET NO. 11		
	PLOT SCALE = 50,0000' / IN.	CHECKED -	REVISED -			SCALE: 1"=50'		SHEET NO. 7 OF 10 SHEETS		STA. 190+00 TO STA. 220+00		CONTRACT NO. 62495
	PLOT DATE = 10/17/2008	DATE -	REVISED -			FED. ROAD DIST. NO.		ILLINOIS		FED. AID PROJECT		

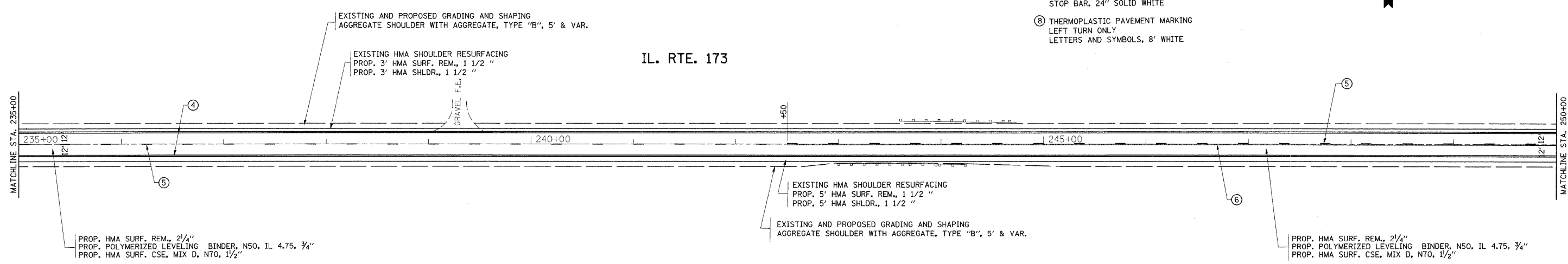
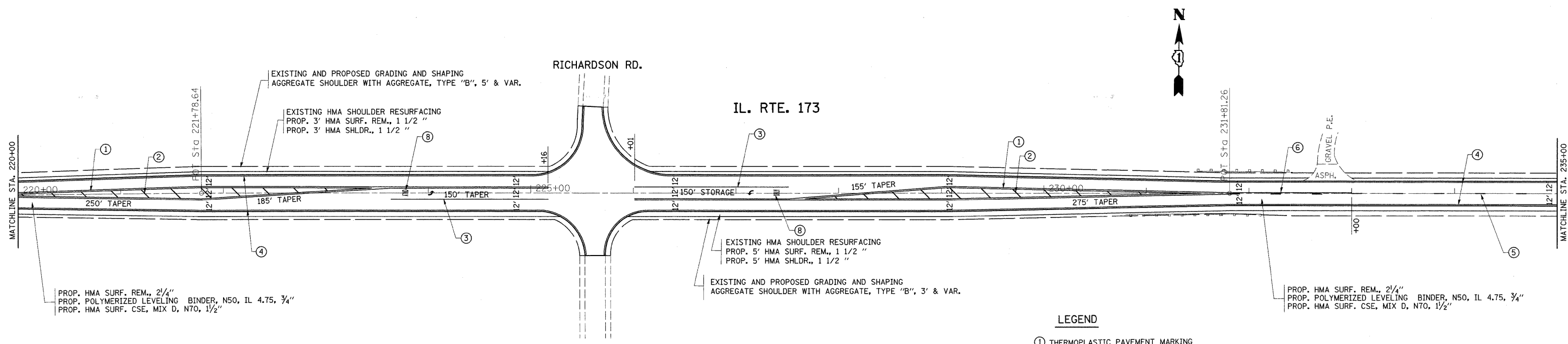

**LEGEND**

- ① THERMOPLASTIC PAVEMENT MARKING  
CENTERLINE, 4" SOLID YELLOW (DOUBLE), 11" C-C
- ② THERMOPLASTIC PAVEMENT MARKING  
12" SOLID YELLOW (RT. 45° DIAGONALS @ 20' C-C)
- ③ THERMOPLASTIC PAVEMENT MARKING  
LANE LINE, 6" WHITE
- ④ THERMOPLASTIC PAVEMENT MARKING  
EDGE LINE, 4" SOLID WHITE
- ⑤ THERMOPLASTIC PAVEMENT MARKING  
SKIP DASH LINE, 4" YELLOW, 10'-30'
- ⑥ THERMOPLASTIC PAVEMENT MARKING  
CENTERLINE (NO PASS ZONE), 4" SOLID YELLOW
- ⑦ THERMOPLASTIC PAVEMENT MARKING  
STOP BAR, 24" SOLID WHITE
- ⑧ THERMOPLASTIC PAVEMENT MARKING  
LEFT TURN ONLY  
LETTERS AND SYMBOLS, 8" WHITE

FILE NAME =  
c:\Projects\dl25302\sh\_rdw.dgn

USER NAME = lszekrf  
PLOT SCALE = 50.0000' / IN.  
PLOT DATE = 10/17/2008

DESIGNED -	REVISED -
DRAWN -	REVISED -
CHECKED -	REVISED -
DATE -	REVISED -

**STATE OF ILLINOIS  
DEPARTMENT OF TRANSPORTATION**

**IL. ROUTE 173 (U.S. 12 TO COUNTY LINE)  
ROADWAY AND PAVEMENT MARKING PLAN**

SCALE: 1"=50'    SHEET NO. 8 OF 10 SHEETS    STA. 220+00 TO STA. 250+00

F.A.P. RTE. 303	SECTION (132, 133 & 134)RS-6	COUNTY McHENRY	TOTAL SHEETS 26	SHEET NO. 12
CONTRACT NO. 62495				
FED. ROAD DIST. NO.    ILLINOIS FED. AID PROJECT				

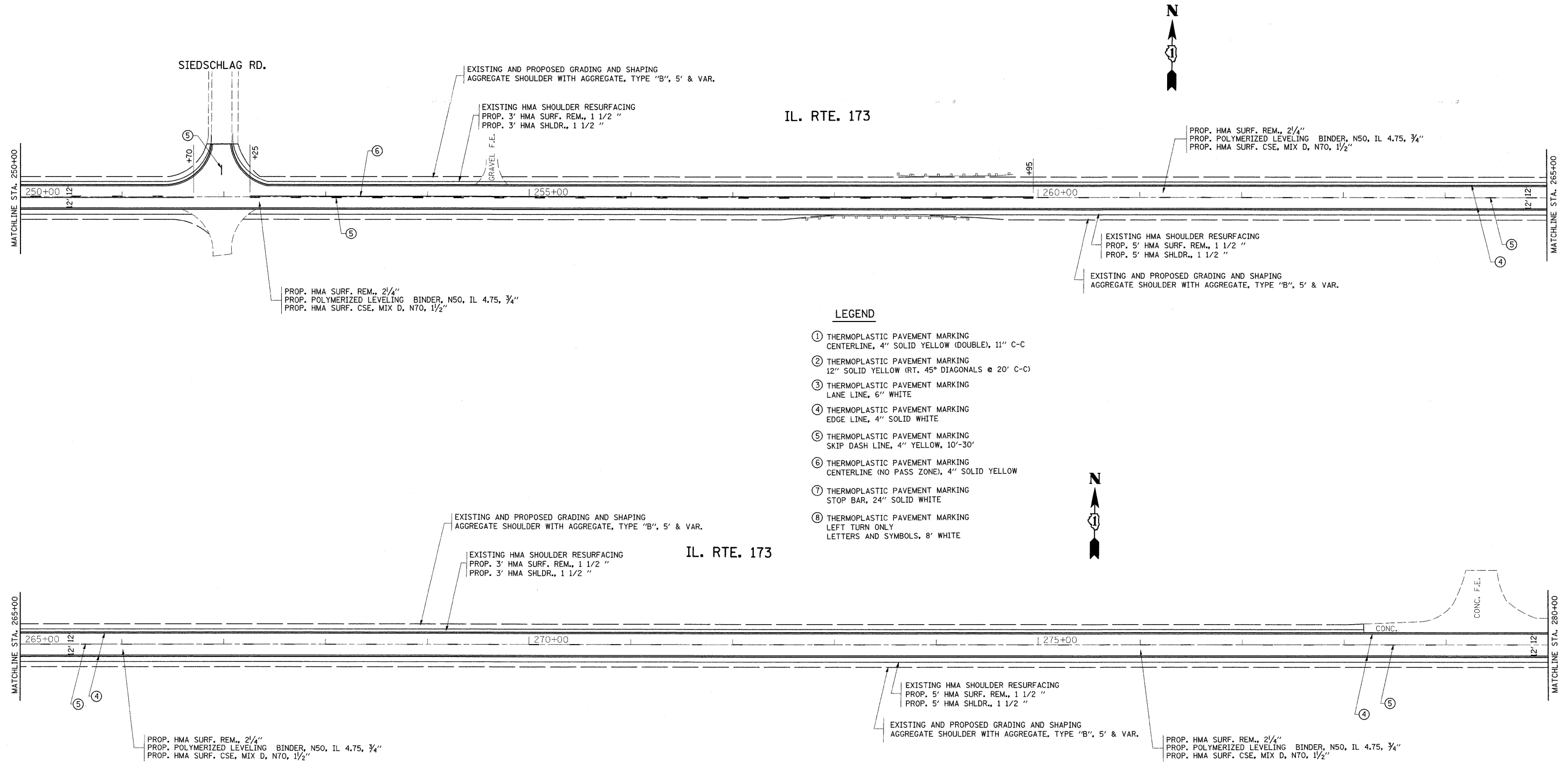

- LEGEND**
- ① THERMOPLASTIC PAVEMENT MARKING  
CENTERLINE, 4" SOLID YELLOW (DOUBLE), 11" C-C
  - ② THERMOPLASTIC PAVEMENT MARKING  
12" SOLID YELLOW (RT. 45° DIAGONALS @ 20' C-C)
  - ③ THERMOPLASTIC PAVEMENT MARKING  
LANE LINE, 6" WHITE
  - ④ THERMOPLASTIC PAVEMENT MARKING  
EDGE LINE, 4" SOLID WHITE
  - ⑤ THERMOPLASTIC PAVEMENT MARKING  
SKIP DASH LINE, 4" YELLOW, 10'-30'
  - ⑥ THERMOPLASTIC PAVEMENT MARKING  
CENTERLINE (NO PASS ZONE), 4" SOLID YELLOW
  - ⑦ THERMOPLASTIC PAVEMENT MARKING  
STOP BAR, 24" SOLID WHITE
  - ⑧ THERMOPLASTIC PAVEMENT MARKING  
LEFT TURN ONLY  
LETTERS AND SYMBOLS, 8" WHITE

FILE NAME =  
e:\Projects\dl25302\sh\_rdw.dgn

USER NAME = lszekrf  
PLOT SCALE = 50.0000' / IN.  
PLOT DATE = 10/17/2008

DESIGNED -	REVISED -
DRAWN -	REVISED -
CHECKED -	REVISED -
DATE -	REVISED -

**STATE OF ILLINOIS  
DEPARTMENT OF TRANSPORTATION**

**IL. ROUTE 173 (U.S. 12 TO COUNTY LINE)  
ROADWAY AND PAVEMENT MARKING PLAN**

SCALE: 1"=50'    SHEET NO. 9 OF 10 SHEETS    STA. 250+00 TO STA. 280+00

F.A.P. RTE.	SECTION	COUNTY	TOTAL SHEETS	SHEET NO.
303	(132, 133 & 134)RS-6	McHENRY	26	13
CONTRACT NO. 62495				
FED. ROAD DIST. NO. [ILLINOIS] FED. AID PROJECT				

**LEGEND**

- ① THERMOPLASTIC PAVEMENT MARKING CENTERLINE, 4" SOLID YELLOW (DOUBLE), 11" C-C
- ② THERMOPLASTIC PAVEMENT MARKING 12" SOLID YELLOW (RT. 45° DIAGONALS @ 20' C-C)
- ③ THERMOPLASTIC PAVEMENT MARKING LANE LINE, 6" WHITE
- ④ THERMOPLASTIC PAVEMENT MARKING EDGE LINE, 4" SOLID WHITE
- ⑤ THERMOPLASTIC PAVEMENT MARKING SKIP DASH LINE, 4" YELLOW, 10'-30'
- ⑥ THERMOPLASTIC PAVEMENT MARKING CENTERLINE (NO PASS ZONE), 4" SOLID YELLOW
- ⑦ THERMOPLASTIC PAVEMENT MARKING STOP BAR, 24" SOLID WHITE
- ⑧ THERMOPLASTIC PAVEMENT MARKING LEFT TURN ONLY LETTERS AND SYMBOLS, 8' WHITE

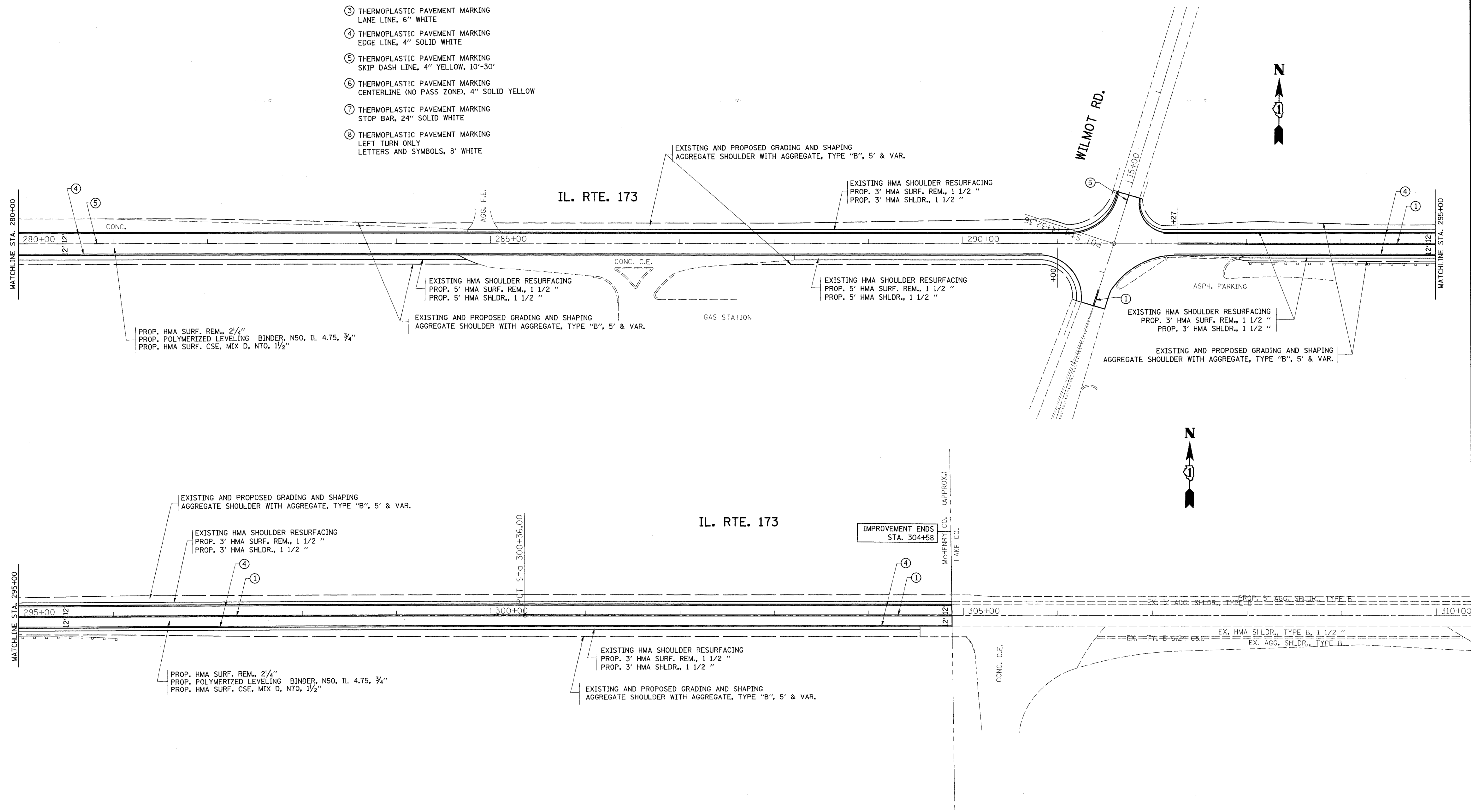

FILE NAME = c:\Projects\125382\sh_rdw.dgn	USER NAME = llszkrf	DESIGNED -	REVISED -	<b>STATE OF ILLINOIS DEPARTMENT OF TRANSPORTATION</b>	<b>IL. ROUTE 173 (U.S. 12 TO COUNTY LINE) ROADWAY AND PAVEMENT MARKING PLAN</b>	F.A.P. RTE. 303	SECTION (132, 133 & 134)RS-6	COUNTY McHENRY	TOTAL SHEETS 26	SHEET NO. 14		
	PLOT SCALE = 50.0000' / IN.	CHECKED -	REVISED -			SCALE: 1"=50'	SHEET NO. 10 OF 10 SHEETS	STA. 280+00	TO STA. 304+88	FED. ROAD DIST. NO.	ILLINOIS FED. AID PROJECT	
	PLOT DATE = 10/17/2008	DATE -	REVISED -			CONTRACT NO. 62495						

**NOTE:**  
 THIS PLAN IS FOR THE PURPOSE OF  
 REPLACING THE DETECTOR LOOPS ONLY.  
 ALL OTHER INFORMATION SHOWN IS NOT  
 RELATED AND WILL BE DISREGARDED.

**NOTE:** "THE ENVIRONMENTAL FIRM IS REQUIRED TO CONTINUOUSLY MONITOR FOR WORKER PROTECTION AND SOIL CONTAMINATION AT SEVERAL AREAS. SEE SPECIAL PROVISION AND SUPPLEMENTAL SPECIFICATIONS FOR DETAILS."

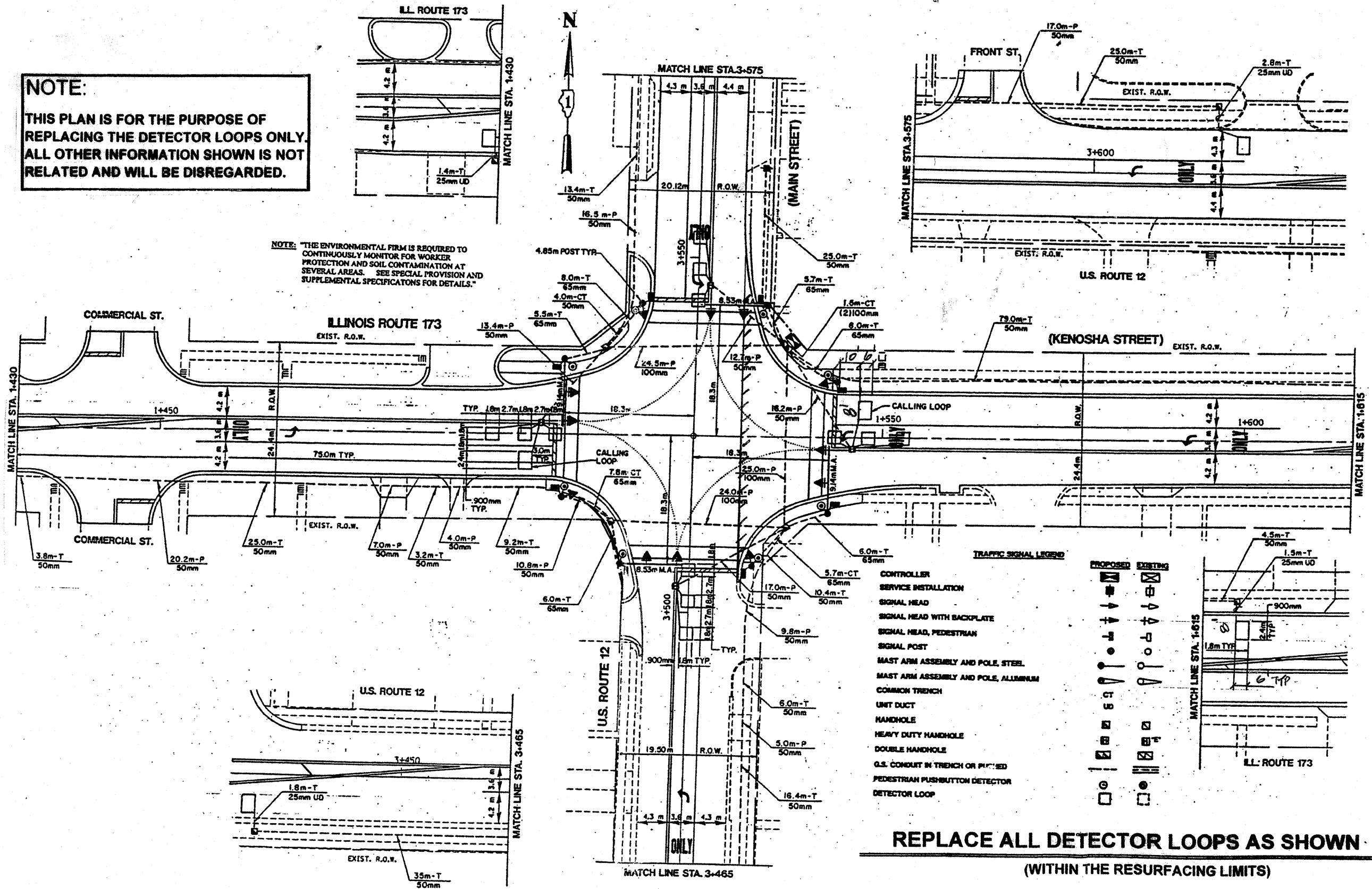

**TRAFFIC SIGNAL LEGEND**

- |                                      |          |          |
|--------------------------------------|----------|----------|
| CONTROLLER                           | PROPOSED | EXISTING |
| SERVICE INSTALLATION                 | [Symbol] | [Symbol] |
| SIGNAL HEAD                          | [Symbol] | [Symbol] |
| SIGNAL HEAD WITH BACKPLATE           | [Symbol] | [Symbol] |
| SIGNAL HEAD, PEDESTRIAN              | [Symbol] | [Symbol] |
| SIGNAL POST                          | [Symbol] | [Symbol] |
| MAST ARM ASSEMBLY AND POLE, STEEL    | [Symbol] | [Symbol] |
| MAST ARM ASSEMBLY AND POLE, ALUMINUM | [Symbol] | [Symbol] |
| COMMON TRENCH                        | [Symbol] | [Symbol] |
| UNIT DUCT                            | [Symbol] | [Symbol] |
| HANDHOLE                             | [Symbol] | [Symbol] |
| HEAVY DUTY HANDHOLE                  | [Symbol] | [Symbol] |
| DOUBLE HANDHOLE                      | [Symbol] | [Symbol] |
| G.S. CONDUIT IN TRENCH OR PIPED      | [Symbol] | [Symbol] |
| PEDESTRIAN PUSHBUTTON DETECTOR       | [Symbol] | [Symbol] |
| DETECTOR LOOP                        | [Symbol] | [Symbol] |

**REPLACE ALL DETECTOR LOOPS AS SHOWN**  
 (WITHIN THE RESURFACING LIMITS)

CODE NO.	QUANTITY	UNIT	ITEM
86600600	165	Foot	Detector Loop Replacement

FILE NAME =	USER NAME = kanthapixoybc	DESIGNED -	REVISED -
c:\projects\traffic\1070022\1168e\forestby.dgn		DRAWN -	REVISED -
		CHECKED -	REVISED -

STATE OF ILLINOIS  
 DEPARTMENT OF TRANSPORTATION

ILL. RTE. 173 @ U.S. RTE. 12 / ILL. RTE. 31

F.A.P. / R.T.E.	SECTION	COUNTY	TOTAL SHEETS	SHEET NO.
303	(132, 133, 134) RS-6	McHENRY	26	15

CONTRACT # 62-495

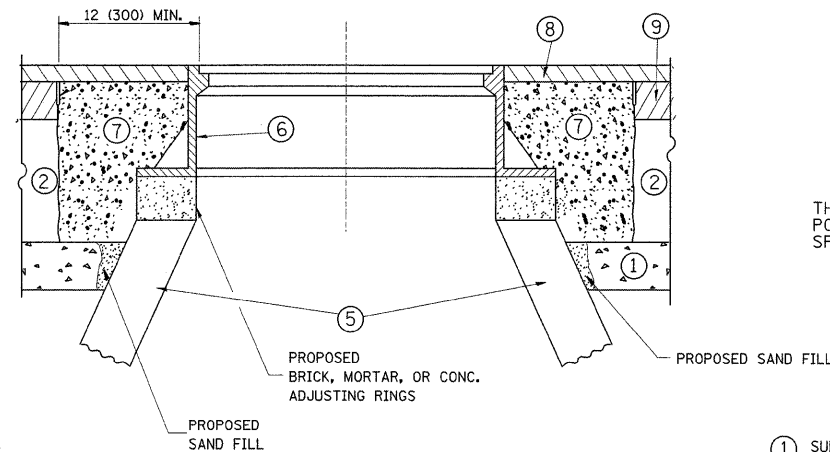
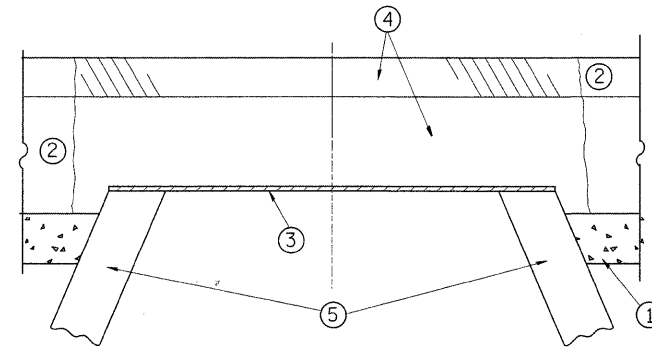

**CONSTRUCTION PROCEDURES**

**STAGE 1 (BEFORE PAVEMENT MILLING)**

- A) REMOVE A MINIMUM OF 12 (300) OF THE PAVEMENT FROM AROUND THE STRUCTURE.
- B) REMOVE THE EXISTING FRAME AND LID FROM THE STRUCTURE.
- C) COVER THE STRUCTURE OPENING WITH A 36 (900) DIAMETER METAL PLATE.
- D) BACKFILL WITH CRUSHED STONE AND A MINIMUM 1/2 (40) THICK HMA SURFACE MIX APPROVED BY THE ENGINEER.

**STAGE 2 (AFTER PAVEMENT MILLING)**

- A) REMOVE THE HMA SURFACE MIX AND CRUSHED STONE.
- B) INSTALL THE FRAME AND LID; ADJUST THE FRAME TO ITS FINAL SURFACE ELEVATION.
- C) THE SURROUNDING SPACE SHALL BE FILLED WITH CLASS SI CONCRETE, OR HMA SURFACE COURSE OR HMA BINDER COURSE TO THE ELEVATION OF THE SURFACE OF THE EXISTING BASE COURSE OR THE BINDER COURSE.

THE PROCEDURE EXPLAINED ABOVE SHALL CONFORM TO THE APPLICABLE PORTIONS OF SECTIONS 353, 406, 602, AND 603 OF THE STANDARD SPECIFICATIONS.

**LEGEND**

- ① SUB-BASE GRANULAR MATERIAL
- ② EXISTING PAVEMENT
- ③ 36 (900) DIAMETER METAL PLATE
- ④ PROPOSED CRUSHED STONE AND HMA SURFACE MIX
- ⑤ EXISTING STRUCTURE
- ⑥ FRAME AND LID (SEE NOTES)
- ⑦ CLASS SI CONCRETE, HMA SURFACE COURSE OR HMA BINDER COURSE
- ⑧ PROPOSED HMA SURFACE COURSE
- ⑨ PROPOSED HMA BINDER COURSE

**NOTES:**

EXISTING BROKEN FRAMES AND LIDS SHALL BE REMOVED AND DISPOSED OF BY THE CONTRACTOR AND SHALL BE REPLACED AS DIRECTED BY THE ENGINEER. REPLACEMENT FRAMES AND LIDS WILL BE PAID FOR IN ACCORDANCE WITH ARTICLE 109.04 OF THE STANDARD SPECIFICATIONS UNLESS A SEPARATE PAY ITEM HAS BEEN PROVIDED.

IF THE EXISTING LIDS ARE OPEN, THE FRAME WILL BE ADJUSTED TO THE ELEVATION OF THE MILLED PAVEMENT SURFACE PRIOR TO THE MILLING OPERATION. THE FRAME WILL NOT BE REMOVED AND COVERED BY THE METAL PLATE.

CITY OF CHICAGO CASTINGS ARE THE PROPERTY OF THE CITY AND THE CONTRACTOR SHALL NOTIFY THE CITY FOR REMOVAL AND DISPOSITION OF THE CASTINGS.

THE METAL PLATE USED TO COVER THE STRUCTURE SHALL REMAIN THE PROPERTY OF THE CONTRACTOR.

WHEN STRUCTURES ARE TO BE ADJUSTED OR RECONSTRUCTED, THE LOWERING AND RAISING OF THE FRAMES AND LIDS WILL NOT BE PAID FOR SEPARATELY BUT WILL BE INCLUDED IN THE COST OF THE CORRESPONDING PAY ITEM.

**LOCATION OF STRUCTURES:**

THE CONTRACTOR WILL BE REQUIRED TO KEEP A RECORD OF THE LOCATIONS OF THE BURIED STRUCTURES ACCORDING TO THE STATION AND DISTANCE LEFT OR RIGHT OF THE CENTERLINE OF PAVEMENT. UPON COMPLETION OF THE WORK, THE CONTRACTOR WILL DELIVER THE RECORD TO THE ENGINEER.

**BASIS OF PAYMENT:** THIS WORK WILL BE PAID FOR AT THE CONTRACT UNIT PRICE PER EACH FOR "FRAMES AND LIDS TO BE ADJUSTED, SPECIAL"

NEW FRAMES AND LIDS, WHEN SPECIFIED, WILL BE PAID FOR SEPARATELY.

**DETAILS FOR FRAMES AND LIDS ADJUSTMENT WITH MILLING**

ALL DIMENSIONS ARE IN INCHES (MILLIMETERS) UNLESS OTHERWISE SHOWN

FILE NAME = c:\Projects\dl25302\sh.rdw.dgn	USER NAME = lszekrf	DESIGNED - R. SHAH	REVISED - R. SHAH 03-10-95	<b>STATE OF ILLINOIS DEPARTMENT OF TRANSPORTATION</b>	<b>DETAILS FOR FRAMES AND LIDS ADJUSTMENT WITH MILLING</b>			F.A.P. RTE. 303	SECTION (132, 133 & 134) RS-6	COUNTY McHENRY	TOTAL SHEETS 26	SHEET NO. 16
	PLOT SCALE = 50.0000' / IN.	DRAWN -	REVISED - A. ABBAS 03-21-97		SCALE: NONE SHEET NO. 1 OF 1 SHEETS STA. TO STA.			<b>BD600-03 (BD-8)</b>		CONTRACT NO. 62495		
	PLOT DATE = 10/17/2008	CHECKED -	REVISED - R. WIEDEMAN 05-14-04									
		DATE - 10-25-94	REVISED - R. BORO 01-01-07									





VARIABLE - TO MEET EXISTING DIMENSIONS AND FIELD CONDITIONS (SEE NOTE ②)

PROP. CONC. CURB OR CURB AND GUTTER REPLACEMENT IN ACCORDANCE WITH STATE STANDARD 606001. (SEE NOTE ②)

SAW CUT FULL DEPTH - INCLUDED IN THE COST OF SIDEWALK, DRIVEWAY OR MEDIAN SURFACE REMOVAL PAY ITEM.

SEE STATE STANDARD 606001

EXISTING OR PROPOSED HMA SURFACE (IF APPLICABLE)

1/4" (5) \*\*

18" (450) MAX.

EXISTING SIDEWALK, DRIVEWAY, MEDIAN SURFACE OR GROUND.

PROPOSED SIDEWALK, DRIVEWAY PAVEMENT, MEDIAN SURFACE OR SALT TOLERANT SOD AND TOP SOIL, 4" (100) SOD RESTORATION (SEE NOTE ①).

EXISTING CONCRETE PAVEMENT, CONCRETE BASE COURSE OR FLEXIBLE PAVEMENT

3" (75) MIN.

SUITABLE BACKFILL MATERIAL (INCLUDED IN THE COST OF CURB OR CURB AND GUTTER REMOVAL AND REPLACEMENT)

PROPOSED 3/4" (20) PREFORMED EXPANSION JOINT AT CONCRETE SIDEWALKS, DRIVEWAYS, AND MEDIANS. (INCLUDED IN THE COST OF CURB OR CURB AND GUTTER REMOVAL AND REPLACEMENT.)

\* 3" (75) MINIMUM FROM TOP AND BOTTOM OF THE CONCRETE PAVEMENT OR BASE COURSE.

\*\* IF THE FINAL SURFACE OF THE PAVEMENT IS CONCRETE, THE GUTTER IS TO BE FLUSH WITH THE PAVEMENT.

NOTE: ① SIDEWALK, DRIVEWAY PAVEMENT OR MEDIAN SURFACE SHALL BE SIMILAR TO THE MATERIAL BEING REMOVED AND WILL BE PAID FOR SEPARATELY.

SALT TOLERANT SOD AND TOP SOIL, 4" (100) RESTORATION WILL NOT BE PAID FOR SEPARATELY, BUT SHALL BE INCLUDED IN THE COST OF CURB OR CURB AND GUTTER REMOVAL AND REPLACEMENT.

② CURB OR CURB AND GUTTER REPLACEMENT SHALL MATCH THE SHAPE OF THE EXISTING CURB OR CURB AND GUTTER UNLESS OTHERWISE SPECIFIED.

③ FOR CURB OR CURB AND GUTTER REMOVAL AND REPLACEMENT ADJACENT TO FLEXIBLE PAVEMENT DELETE EPOXY COATED TIE BARS.

④ LONGITUDINAL BARS, IF ENCOUNTERED IN THE EXISTING CURB OR CURB AND GUTTER, ARE NOT TO BE REPLACED. CUTTING AND REMOVING LONGITUDINAL BARS SHALL BE INCLUDED IN THE COST OF CURB OR CURB AND GUTTER REMOVAL AND REPLACEMENT.

⑤ THE COST OF HMA SURFACE REMOVAL IN THE EXISTING GUTTER FLAG SHALL BE INCLUDED IN THE COST OF THE CURB AND GUTTER REMOVAL AND REPLACEMENT.

⑥ THE REMOVAL AND REPLACEMENT OF THE EXISTING CURB OR CURB AND GUTTER SHALL BE DONE IN ACCORDANCE WITH THE APPLICABLE PORTIONS OF SECTION 440 AND 606 OF THE STANDARD SPECIFICATIONS.

⑦ THE LOCATIONS OF REMOVAL AND REPLACEMENT OF EXISTING CURB OR CURB AND GUTTER SHALL BE DETERMINED BY THE RESIDENT ENGINEER AT THE TIME OF CONSTRUCTION.

UNSUITABLE SUB-BASE MATERIAL TO BE REMOVED, IF DIRECTED BY THE ENGINEER, SHALL BE REPLACED WITH EITHER SUB-BASE GRANULAR MATERIAL, TYPE B OR ADDITIONAL THICKNESS OF CONCRETE.

REMOVAL AND REPLACEMENT 4" (100) OR LESS IS INCLUDED IN THE COST OF CURB OR CURB AND GUTTER REMOVAL AND REPLACEMENT.

REMOVAL AND REPLACEMENT IN EXCESS OF 4" (100) WILL BE PAID FOR IN ACCORDANCE WITH ARTICLE 109.04 OF THE STANDARD SPECIFICATIONS.

PROPOSED #6 (20) EPOXY COATED TIE BARS 24" (600) LONG AT 24" (600) CENTERS WILL NOT BE PAID FOR SEPARATELY. DELETE EPOXY COATED TIE BARS IF EXISTING TIE BARS ARE USUABLE AS DETERMINED BY THE ENGINEER. (SEE NOTE ③).

**BASIS OF PAYMENT:**

THIS WORK WILL BE PAID FOR AT THE CONTRACT UNIT PRICE PER FOOT (METER) FOR "CURB REMOVAL AND REPLACEMENT" OR "COMBINATION CONCRETE CURB AND GUTTER REMOVAL AND REPLACEMENT".

# CURB OR CURB AND GUTTER REMOVAL AND REPLACEMENT

ALL DIMENSIONS ARE IN INCHES (MILLIMETERS) UNLESS OTHERWISE SHOWN.

FILE NAME = c:\Projects\dl25302\sh_rdy.dgn	USER NAME = lszekrf	DESIGNED - A. HOUSEH	REVISED - R. SHAH 10-03-96	<b>STATE OF ILLINOIS DEPARTMENT OF TRANSPORTATION</b>	<b>CURB OR CURB AND GUTTER REMOVAL AND REPLACEMENT</b>	F.A.P. RTE. 303	SECTION (132, 133 & 134) RS-6	COUNTY McHENRY	TOTAL SHEETS 26	SHEET NO. 18	
PLOT SCALE = 50.0000' / IN.	CHECKED -	REVISED - M. GOMEZ 01-22-01	REVISED - A. ABBAS 03-21-97			SCALE: NONE SHEET NO. 1 OF 1 SHEETS STA. TO STA.		BD600-06 (BD-24)		CONTRACT NO. 62495	
PLOT DATE = 10/17/2008	DATE - 03-11-94	REVISED - R. BORO 01-01-07				FED. ROAD DIST. NO. 1 ILLINOIS FED. AID PROJECT					

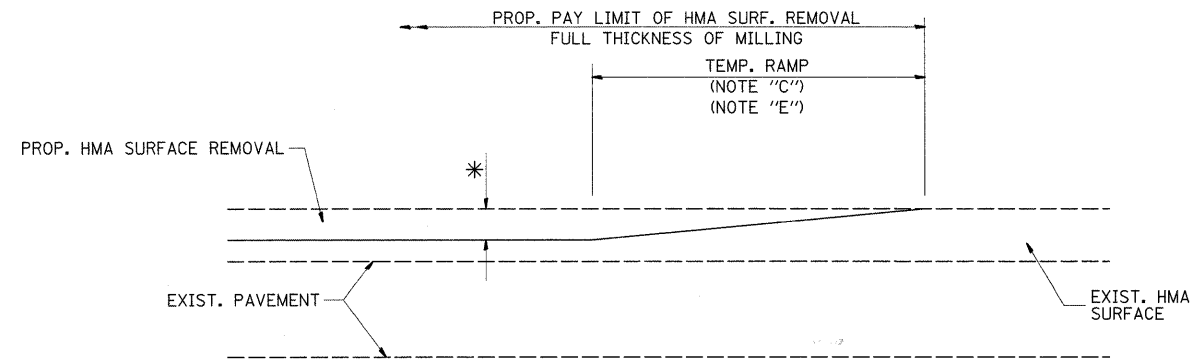

MILLED TEMPORARY RAMP  
(FOR BUTT JOINT AND HMA TAPER SEE DETAIL BELOW)

**OPTION 1**

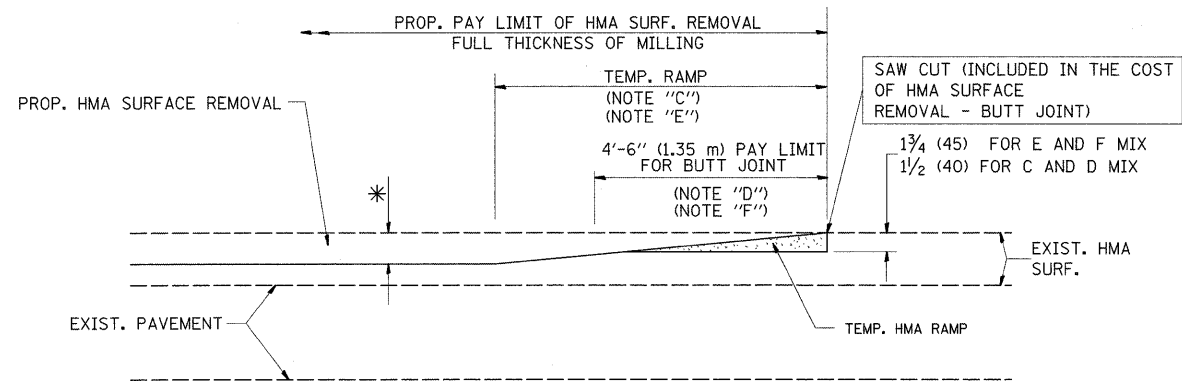

HMA CONSTRUCTED TEMPORARY RAMP  
(FOR BUTT JOINT AND HMA TAPER SEE DETAIL BELOW)

**OPTION 2**

**TYPICAL TEMPORARY RAMP**

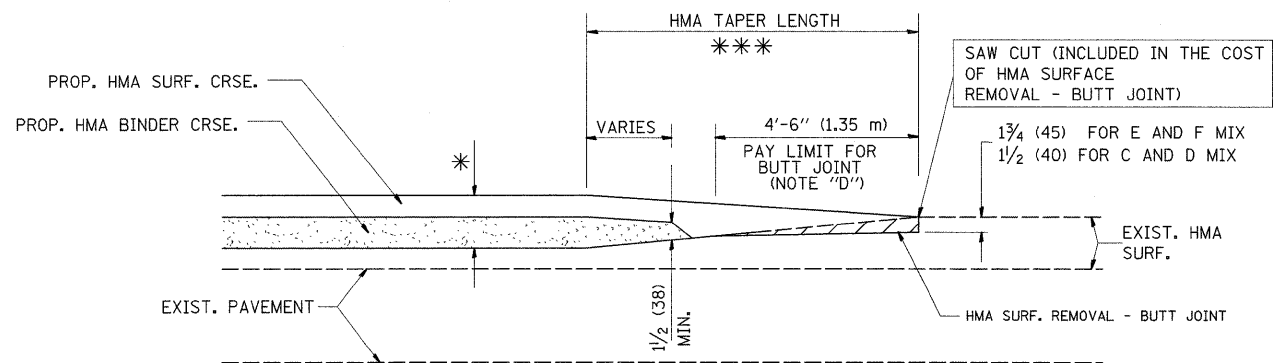

BUTT JOINT AND  
HMA TAPER

**TYPICAL BUTT JOINT AND HMA TAPER  
FOR MILLING AND RESURFACING**

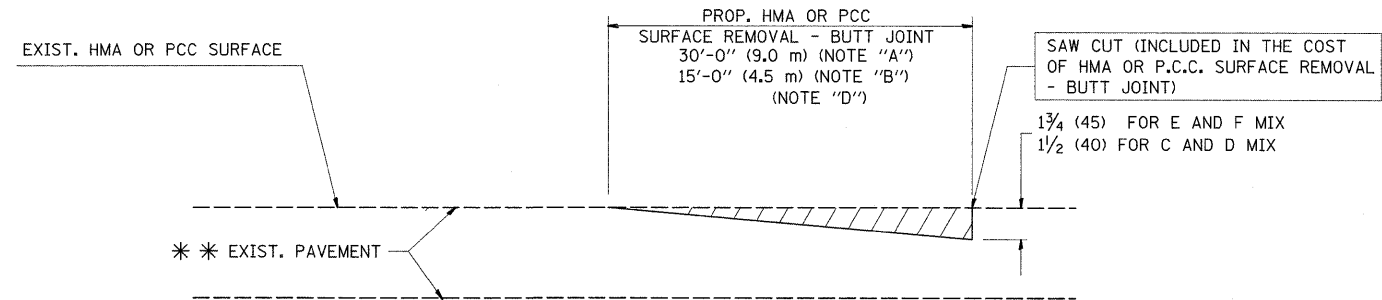

BUTT JOINT DETAIL

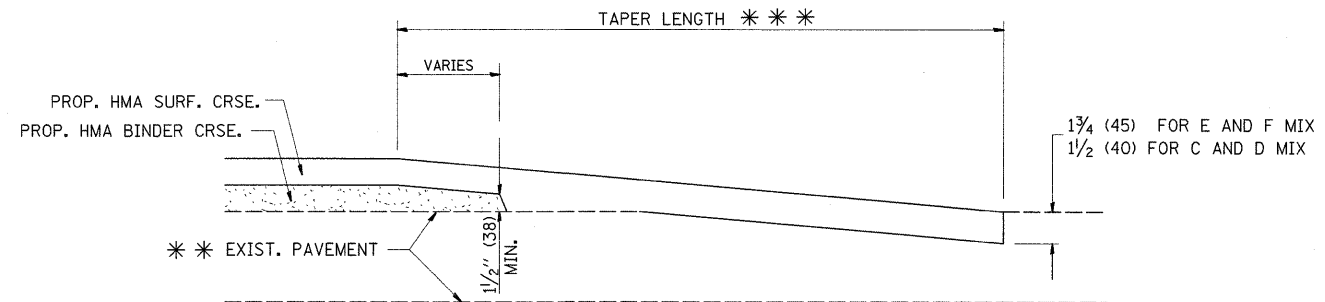

HMA TAPER DETAIL

**TYPICAL BUTT JOINT AND HMA TAPER  
FOR RESURFACING ONLY**

\*\*\* PC CONCRETE, HMA OR HMA RESURFACED PAVEMENT.

**NOTES**

- A: MAINLINE ROADWAYS AND MAJOR SIDE ROADS.
- B: MINOR SIDE ROADS.
- C: THE TEMP. RAMP SHALL BE CONSTRUCTED IMMEDIATELY UPON REMOVAL OF THE EXISTING HMA SURFACE.
- D: THE BUTT JOINT SHALL BE CONSTRUCTED IMMEDIATELY PRIOR TO PLACING THE PROPOSED HMA COURSES.
- E: TAPER THE TEMP. RAMP AT A RATE OF 3'-0" (900 mm) PER 1 INCH (25 mm) OF MILLING THICKNESS.
- F: INSTALLATION AND REMOVAL OF THE 4'-6" (1.35 m) TEMP. RAMP IS INCLUDED IN COST OF HMA SURFACE REMOVAL - BUTT JOINT
- G: SEE ARTICLE 406.08 AND 406.14 OF THE STANDARD SPECIFICATIONS FOR "HMA AND/OR PCC SURFACE REMOVAL, BUTT JOINT".

\* SEE TYPICAL SECTIONS FOR MILLING THICKNESS.

\*\*\* 20'-0" (6.1 m) PER 1 (25) RESURFACING (NOTE "A")  
10'-0" (3.0 m) PER 1 (25) RESURFACING (NOTE "B")

**BASIS OF PAYMENT:**

THE BUTT JOINT WILL BE PAID FOR AT THE CONTRACT UNIT PRICE PER SQUARE YARD (SQUARE METER) FOR "HOT-MIX ASPHALT SURFACE REMOVAL - BUTT JOINT" OR FOR "PORTLAND CEMENT CONCRETE SURFACE REMOVAL - BUTT JOINT".

ALL DIMENSIONS ARE IN INCHES (MILLIMETERS) UNLESS OTHERWISE SHOWN.

FILE NAME =	USER NAME = lszekrf
DESIGNED - M. DE YONG	REVISOR - R. SHAH 10-25-94
DRAWN -	REVISOR - A. ABBAS 03-21-97
FLAT SCALE = 50.0000' / IN.	REVISOR - M. GOMEZ 04-06-01
PLOT DATE = 10/17/2008	REVISOR - R. BORO 01-01-07

DESIGNED - M. DE YONG	REVISOR - R. SHAH 10-25-94
DRAWN -	REVISOR - A. ABBAS 03-21-97
CHECKED -	REVISOR - M. GOMEZ 04-06-01
DATE - 06-13-90	REVISOR - R. BORO 01-01-07

**STATE OF ILLINOIS  
DEPARTMENT OF TRANSPORTATION**

**BUTT JOINT AND  
HMA TAPER DETAILS**

SCALE: NONE SHEET NO. 1 OF 1 SHEETS STA. TO STA.

F.A.P. RTE.	SECTION	COUNTY	TOTAL SHEETS	SHEET NO.
303	(132, 133 & 134) RS-6	McHENRY	26	19
BD400-05 BD32			CONTRACT NO. 62495	
FED. ROAD DIST. NO. 1 ILLINOIS FED. AID PROJECT				

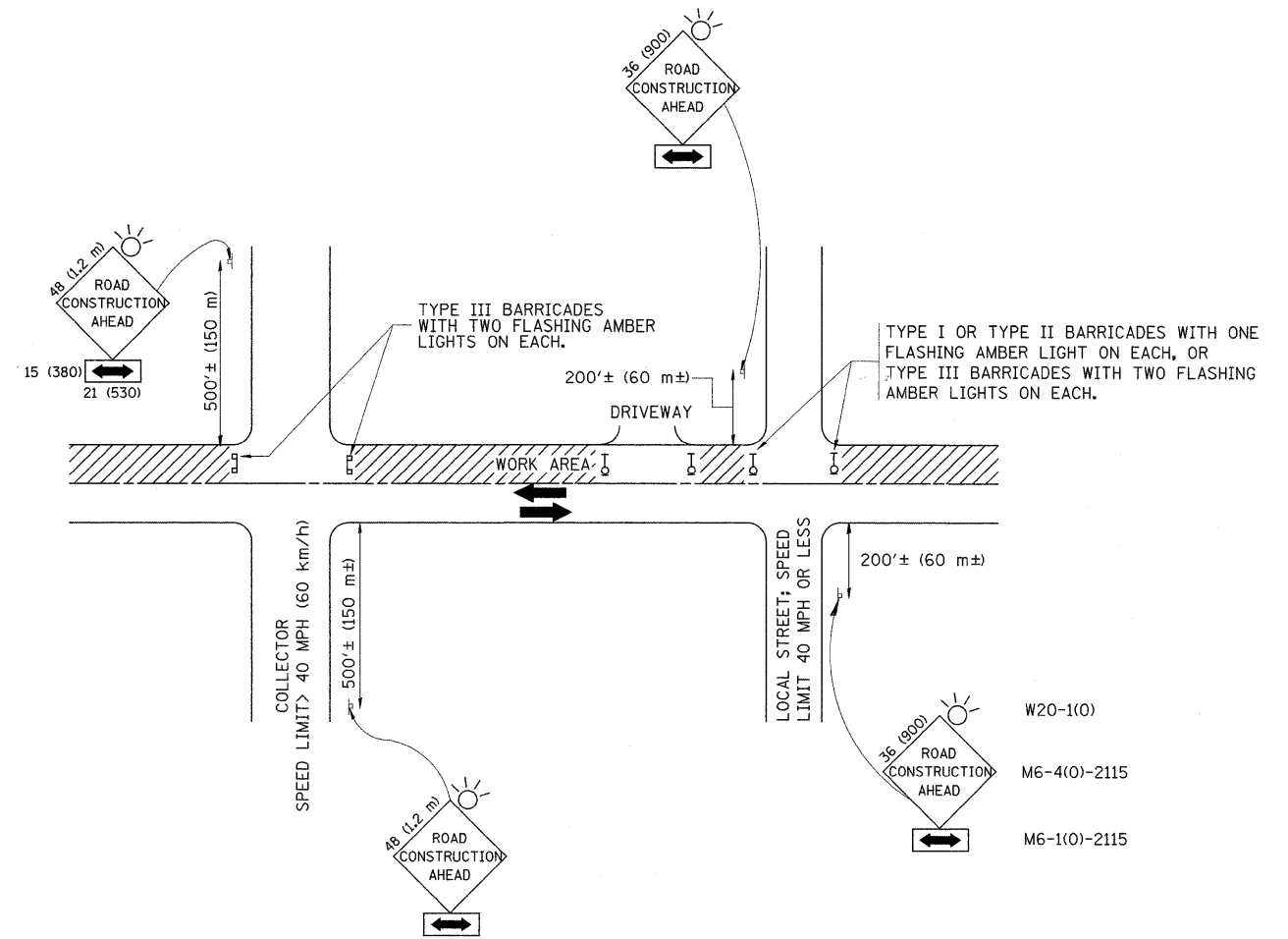

**TRAFFIC CONTROL AND PROTECTION FOR SIDE ROADS, INTERSECTIONS, AND DRIVEWAYS**

**NOTES:**

**A. FOR NO LANE RESTRICTION ON THE SIDE ROAD OR DRIVEWAYS**

1. SIDE ROAD WITH A SPEED LIMIT OF 40 MPH (60 km/h) OR LESS AS SHOWN ON THE DRAWING AND AS DIRECTED BY THE ENGINEER:
  - a) ONE **ROAD CONSTRUCTION AHEAD** SIGN 36 x 36 (900x900) WITH A FLASHER AND FLAG MOUNTED ON IT APPROXIMATELY 200' (60 m) IN ADVANCE OF THE MAIN ROUTE.
  - b) THE CLOSED PORTION OF THE MAIN ROUTE SHALL BE PROTECTED BY BLOCKING WITH TYPE I, TYPE II OR TYPE III BARRICADES, 1/3 OF THE CROSS SECTION OF THE CLOSED PORTION.
2. SIDE ROAD WITH A SPEED LIMIT GREATER THAN 40 MPH (60 km/h) AS SHOWN ON THE DRAWING AND AS DIRECTED BY THE ENGINEER:
  - a) ONE **ROAD CONSTRUCTION AHEAD** SIGN 48 x 48 (1.2 m x 1.2 m) WITH A FLASHER MOUNTED ON IT APPROXIMATELY 500' (150 m) IN ADVANCE OF THE MAIN ROUTE.
  - b) THE CLOSED PORTION OF THE MAIN ROUTE SHALL BE PROTECTED BY BLOCKING WITH TYPE III BARRICADES, 1/2 OF THE CROSS SECTION OF THE CLOSED PORTION.
3. WHEN THE SIDE ROAD LIES BETWEEN THE BEGINNING OF THE MAINLINE SIGNING AND THE WORK ZONE, A SINGLE HEADED ARROW (M6-1) SHALL BE USED IN LIEU OF THE DOUBLE HEADED ARROW (M6-4).

**B. FOR A LANE CLOSURE ON A SIDE ROAD OR DRIVEWAY:**

USE APPLICABLE PORTIONS OF THE TYPICAL APPLICATION OF TRAFFIC CONTROL DEVICES (STD. 701501, STD. 701606 OR THE APPROPRIATE STANDARD). THE SPACING OF SIGNS AND BARRICADES SHALL BE ADJUSTED FOR FIELD CONDITIONS AS DIRECTED BY THE ENGINEER. THE DIRECTIONAL ARROW SHALL BE COVERED OR REMOVED WHEN NO LONGER CONSISTENT WITH THE SIDE ROAD LANE CLOSURE.

**C. ADVANCE WARNING SIGNS ARE TO BE OMITTED ON DRIVEWAY UNLESS OTHERWISE NOTED.**

**D. THE TRAFFIC CONTROL AND PROTECTION FOR SIDE ROADS, INTERSECTIONS, AND DRIVEWAYS SHALL BE INCIDENTAL TO THE COST OF SPECIFIED TRAFFIC CONTROL STANDARDS OR ITEMS.**

All dimensions are in millimeters (Inches) unless otherwise shown.

FILE NAME =	USER NAME = llszekrf	DESIGNED - LHA	REVISED - J. OBERLE 10-18-95
ca\Projects\125302\sh_rndes.dgn		DRAWN -	REVISED - A. HOUSEH 03-06-96
		CHECKED -	REVISED - A. HOUSEH 10-15-96
		DATE - 06-89	REVISED - T. RAMMACHER 01-06-00

**STATE OF ILLINOIS  
DEPARTMENT OF TRANSPORTATION**

**TRAFFIC CONTROL AND PROTECTION FOR  
SIDE ROADS, INTERSECTIONS, AND DRIVEWAYS**

F.A.P. RTE.	SECTION	COUNTY	TOTAL SHEETS	SHEET NO.
303	(132, 133 & 134) RS-6	McHENRY	26	20
TC-10			CONTRACT NO. 62495	
FED. ROAD DIST. NO. 1 (ILLINOIS) FED. AID PROJECT				

SCALE: NONE SHEET NO. 1 OF 1 SHEETS STA. TO STA.

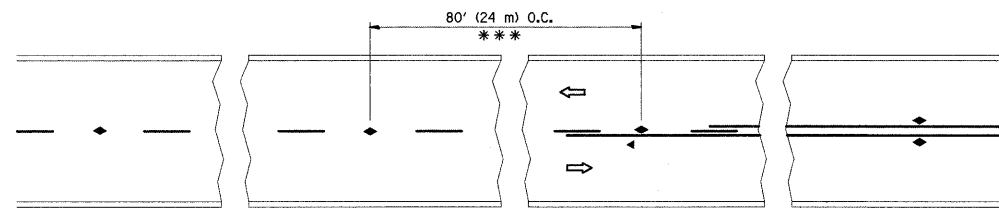

\*\*\* REDUCE TO 40' (12 m) O.C. ON CURVES WITH POSTED OR ADVISORY SPEED 45 M.P.H. (70 km/h) OR LESS.

TWO-LANE/TWO-WAY

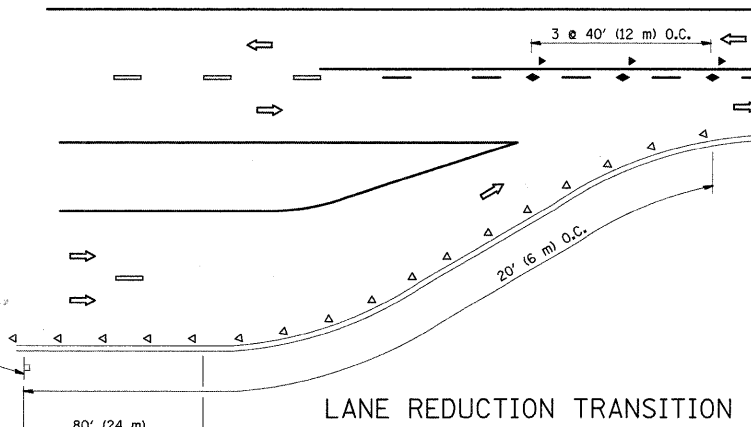

LANE REDUCTION TRANSITION

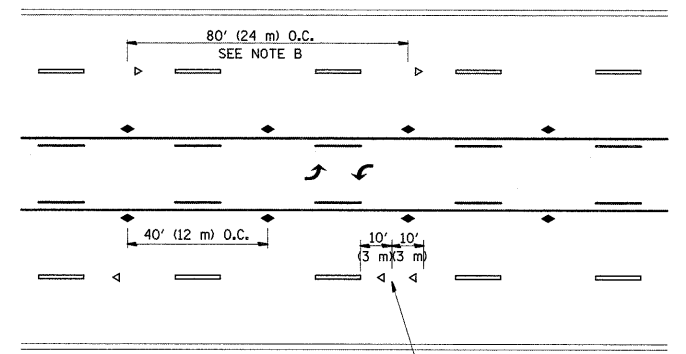

TWO-WAY LEFT TURN

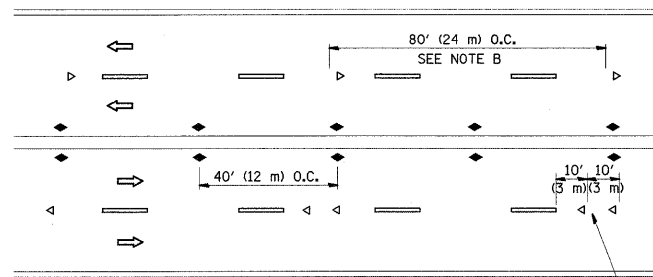

MULTI-LANE/UNDIVIDED

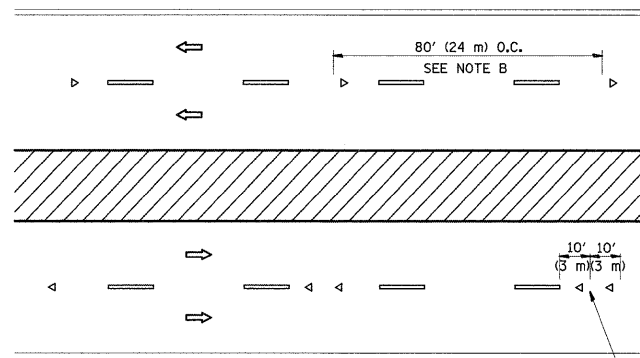

MULTI-LANE/DIVIDED

GENERAL NOTES

1. MARKERS USED WITH DASHED LINES SHALL BE CENTERED IN THE GAP BETWEEN SEGMENTS.
2. MARKERS USED ADJACENT TO SOLID LINES SHALL BE OFFSET 2 TO 3 (50 TO 75) TOWARD TRAFFIC AS SHOWN.
3. MARKERS THROUGH TANGENTS LESS THAN 500' (150 m) IN LENGTH BETWEEN CURVES SHALL BE INSTALLED AT THE LESSER OF THE TWO CURVE SPACINGS.

SYMBOLS

- YELLOW STRIPE
- WHITE STRIPE
- ◀ ONE-WAY AMBER MARKER
- ◁ ONE-WAY CRYSTAL MARKER (W/O)
- ◆ TWO-WAY AMBER MARKER

LANE MARKER NOTES

- B. REDUCE TO 40' (12 m) O.C. ON CURVES WHERE ADVISORY SPEEDS ARE 10 M.P.H. (20 km/h) LOWER THAN POSTED SPEEDS.
- A. USE DOUBLE LANE LINE MARKERS SPACED AS SHOWN.

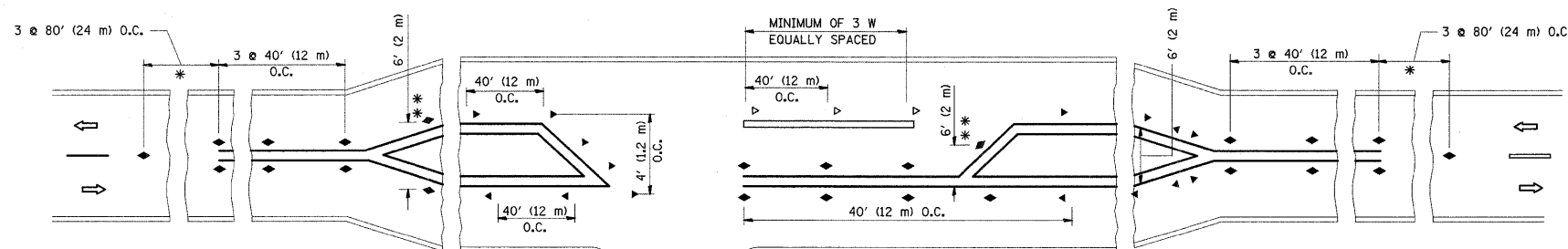

LEFT TURN

\* SEE TWO-LANE/TWO-WAY WHERE MARKERS CONTINUE  
 \*\* WHERE THE MEDIAN WIDTH IS 6' (2 m) OR LESS USE TWO-WAY MARKERS.

All dimensions are in inches (millimeters) unless otherwise shown.

FILE NAME = c:\Projects\125302\sh_rdw.dgn	USER NAME = jlszekrf	DESIGNED -	REVISED - T. RAMMACHER 09-19-94	<b>STATE OF ILLINOIS DEPARTMENT OF TRANSPORTATION</b>	<b>TYPICAL APPLICATIONS RAISED REFLECTIVE PAVEMENT MARKERS (SNOW-PLOW RESISTANT)</b>		F.A.P. RTE.	SECTION	COUNTY	TOTAL SHEETS	SHEET NO.
	PLOT SCALE = 50,000' / IN.	DRAWN -	REVISED - T. RAMMACHER 03-12-99				303	(132, 133 & 134) RS-6	McHENRY	26	2/
PLOT DATE = 10/17/2008	CHECKED -	REVISED - T. RAMMACHER 01-06-00	REVISED -	SCALE: NONE	SHEET NO. 1 OF 1 SHEETS	STA. TO STA.	<b>TC-11</b>		CONTRACT NO. 62495		
	DATE -						FED. ROAD DIST. NO. 1 ILLINOIS FED. AID PROJECT				



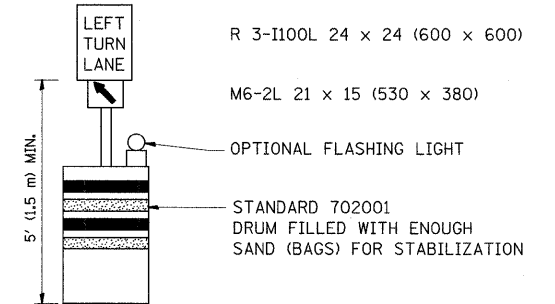
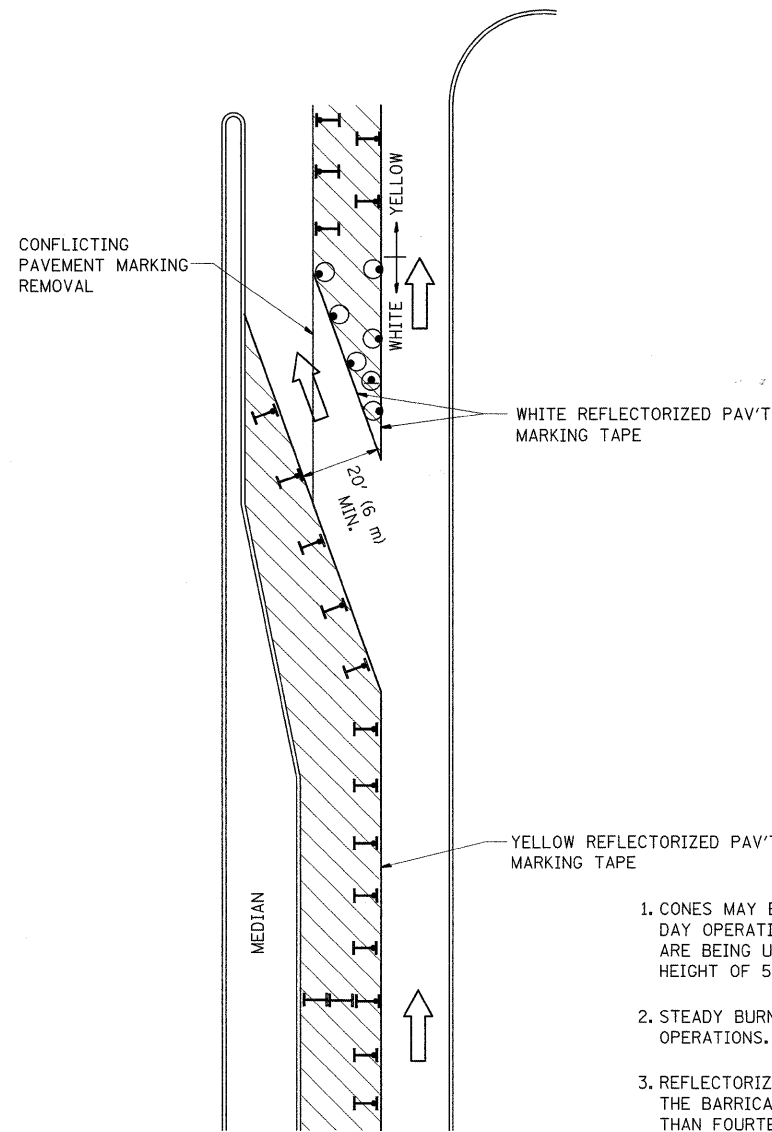



**GENERAL NOTES**

1. CONES MAY BE SUBSTITUTED FOR BARRICADES OR DRUMS AT HALF THE SPACING DURING DAY OPERATIONS. CONES SHALL BE A MINIMUM OF 28 (710) IN HEIGHT. WHEN CONES ARE BEING USED, THE "LEFT TURN LANE" SIGN MAY BE SKID MOUNTED AT A MINIMUM HEIGHT OF 5' (1.5 m).
2. STEADY BURNING LIGHTS WILL NOT BE REQUIRED ON BARRICADES OR DRUMS FOR DAY OPERATIONS. ALL LIGHTS SHALL BE MONODIRECTIONAL.
3. REFLECTORIZED TEMPORARY PAVEMENT MARKING TAPE SHALL BE PLACED THROUGHOUT THE BARRICADED AREA OF EACH TURN BAY WHERE THE CLOSURE TIME IS GREATER THAN FOURTEEN DAYS.
4. THIS APPLICATION ALSO APPLIES WHEN WORK IS BEING PERFORMED IN THE RIGHT LANE(S) AND THE RIGHT TURN BAY IS TO REMAIN OPEN. UNDER THIS CONDITION, "RIGHT TURN LANE" R3-100 24 x 24 (600 x 600) AND M6-2R 21 x 15 (530 x 380) SHALL BE USED.
5. THESE CONTROLS SHALL SUPPLEMENT MAINLINE TRAFFIC CONTROL FOR LANE CLOSURES.
6. LONGITUDINAL DIMENSIONS MAY BE ADJUSTED TO FIT FIELD CONDITIONS.
7. FORM BT 725 IS REQUIRED.
8. TRAFFIC CONTROL AND PROTECTION AT TURN BAYS (TO REMAIN OPEN TO TRAFFIC) SHALL BE INCLUDED IN THE COST SPECIFIED TRAFFIC CONTROL STANDARDS OR ITEMS.

All dimensions are in inches (millimeters) unless otherwise shown.

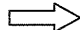
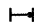
**LEGEND**

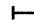
-  WORK AREA
-  LANE OPEN TO TRAFFIC
-  TYPE I OR II BARRICADE WITH STEADY BURN LIGHT
-  DRUM WITH STEADY BURN LIGHT
-  DRUM WITH SIGN (WITH OPTIONAL FLASHING LIGHT) SEE DETAIL
-  TYPE I OR II CHECK BARRICADE WITH FLASHING LIGHT

FILE NAME =	USER NAME = lszekrf	DESIGNED -	REVISED -T. RAMMACHER 09-08-94
ct\Projects\dl25302\sh_rdey.dgn		DRAWN -	REVISED - A. HOUSEH 11-07-95
		CHECKED -	REVISED - A. HOUSEH 10-12-96
		DATE -	REVISED -T. RAMMACHER 01-06-00

**STATE OF ILLINOIS  
DEPARTMENT OF TRANSPORTATION**

**TRAFFIC CONTROL AND PROTECTION AT TURN BAYS  
(TO REMAIN OPEN TO TRAFFIC)**

F.A.P. RTE.	SECTION	COUNTY	TOTAL SHEETS	SHEET NO.
303	(132, 133 & 134) RS-6	McHENRY	26	23
TC-14			CONTRACT NO. 62495	
FED. ROAD DIST. NO. 1 (ILLINOIS) FED. AID PROJECT				

SCALE: NONE SHEET NO. 1 OF 1 SHEETS STA. TO STA.

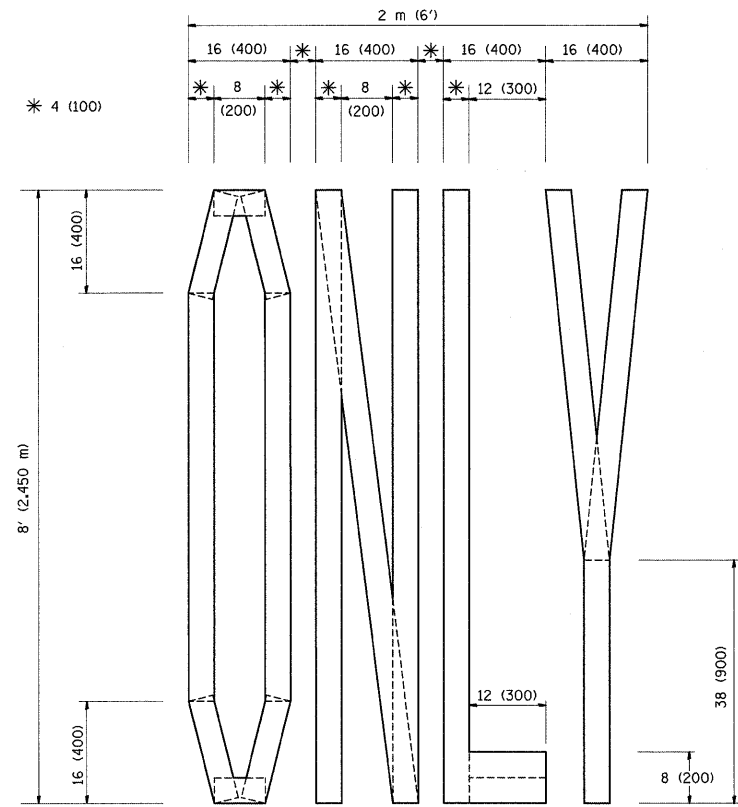

QUANTITY  
 4 (100) LINE = 64.1 ft. (19.7 m)  
 21.1 sq. ft. (1.97 sq. m)

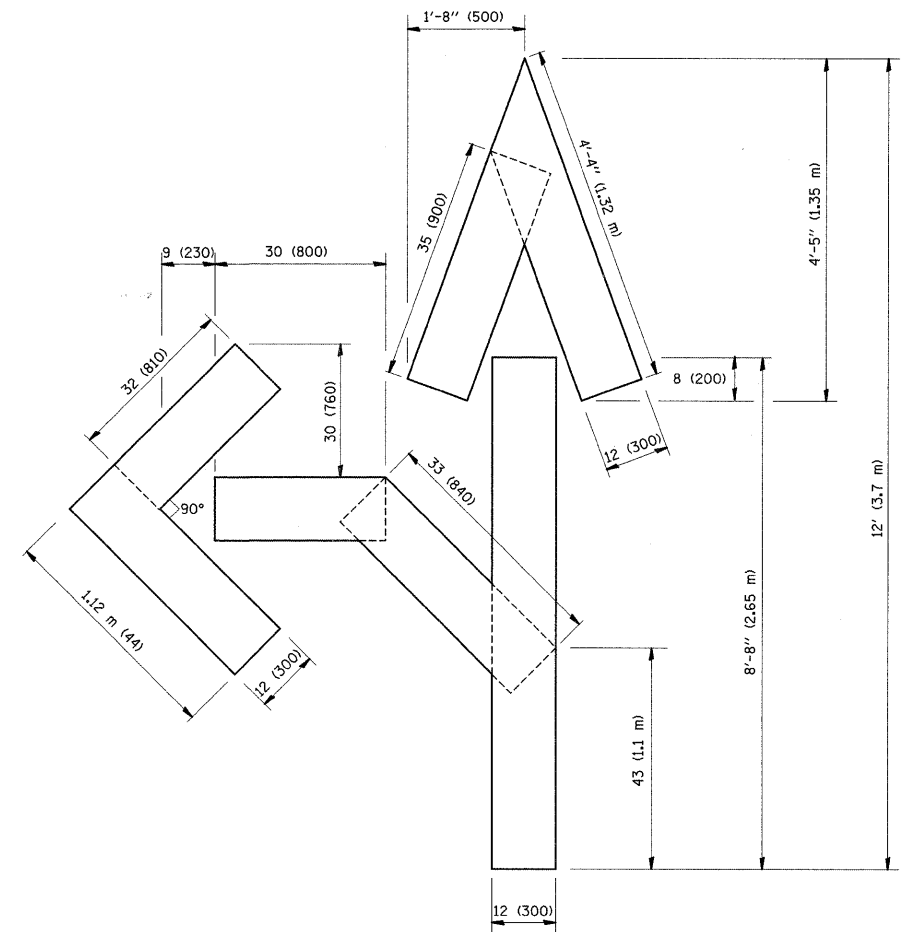

QUANTITY  
 4 (100) LINE = 82.5 ft. (25.3 m)  
 27.5 sq. ft. (2.53 sq. m)

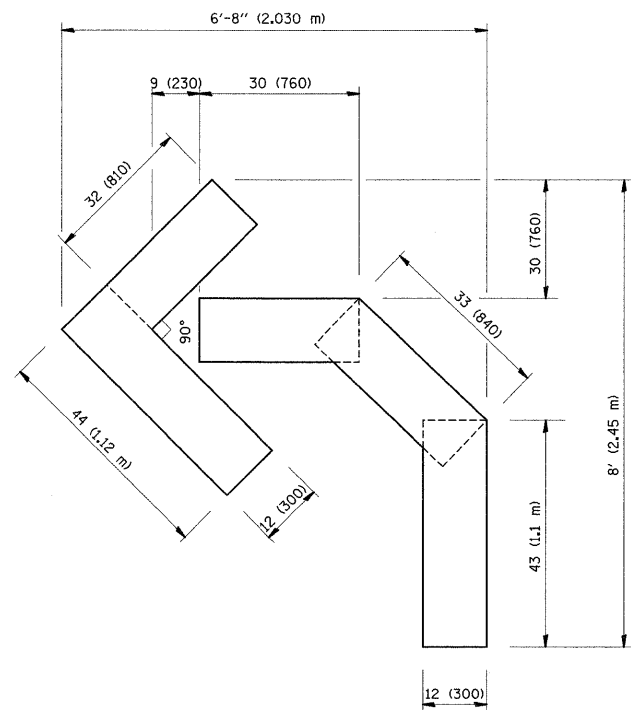

QUANTITY  
 4 (100) LINE = 45.5 ft. (13.9 m)  
 15.2 sq. ft. (1.39 sq. m)

All dimensions are in inches (millimeters) unless otherwise shown.

FILE NAME = c:\Projects\125302\sh_rdw.dgn	USER NAME = lisekrf	DESIGNED -	REVISED -T. RAMMACHER 06-05-96
		DRAWN -	REVISED -T. RAMMACHER 11-04-97
	PLOT SCALE = 50.0000' / IN.	CHECKED -	REVISED -T. RAMMACHER 03-02-98
	PLOT DATE = 10/17/2008	DATE - 09-18-94	REVISED -E. GOMEZ 08-28-00

**STATE OF ILLINOIS  
 DEPARTMENT OF TRANSPORTATION**

**PAVEMENT MARKING LETTERS AND SYMBOLS  
 FOR TRAFFIC STAGING**

SCALE: NONE SHEET NO. 1 OF 1 SHEETS STA. TO STA.

F.A.P. RTE. 303	SECTION (132, 133 & 134) RS-6	COUNTY McHENRY	TOTAL SHEETS 26	SHEET NO. 24
TC-16			CONTRACT NO. 62495	
FED. ROAD DIST. NO. 1 ILLINOIS FED. AID PROJECT				



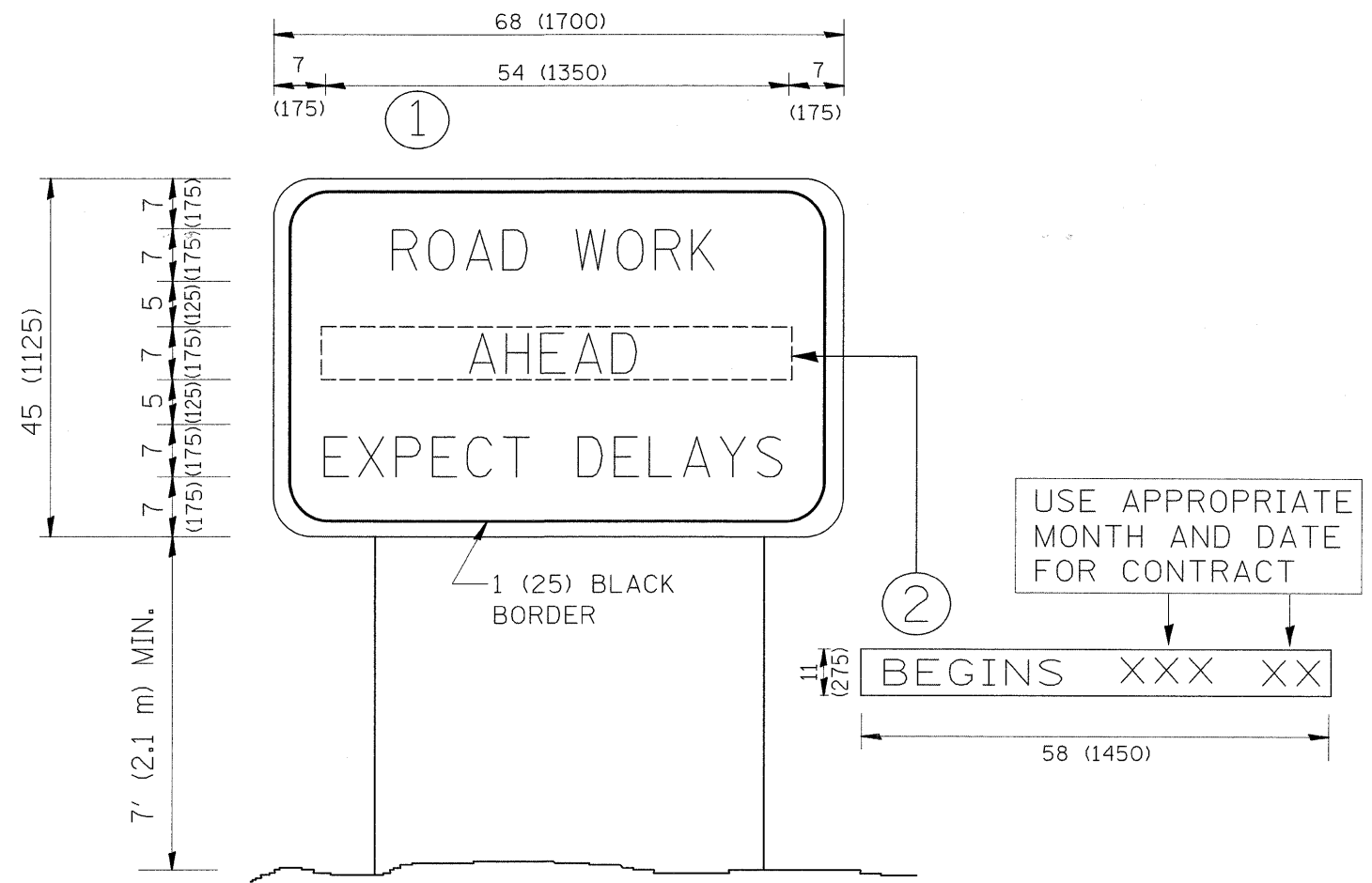

**NOTES:**

1. USE BLACK LETTERING ON ORANGE BACKGROUND.
2. ERECT SIGNS IN ADVANCE OF THE LOCATION FOR THE "ROAD CONSTRUCTION AHEAD" SIGN AT LOCATIONS AS DIRECTED BY THE ENGINEER.
3. ERECT SIGN ① WITH INSTALLED PANEL ② ONE WEEK PRIOR TO THE START OF CONSTRUCTION.
4. REMOVE PANEL ② SOON AFTER THE START OF CONSTRUCTION.
5. SEE SPECIAL PROVISION FOR "TEMPORARY INFORMATION SIGNING" FOR ADDITIONAL INFORMATION.
6. ONE SIGN ASSEMBLY EQUALS 25.70 SQ. FT. (2.3 SQ. M.)
7. SHALL BE PAID FOR AS TEMPORARY INFORMATION SIGNING.

ALL DIMENSIONS ARE IN INCHES (MILLIMETERS) UNLESS OTHERWISE SHOWN.

FILE NAME = e:\Projects\125302\ah_rdw.dgn	USER NAME = lszokrf	DESIGNED -	REVISED - R. MIRS 09-15-97
		DRAWN -	REVISED - R. MIRS 12-11-97
	PLOT SCALE = 50.0000' / IN.	CHECKED -	REVISED - T. RAMMACHER 02-02-99
	PLOT DATE = 10/17/2008	DATE -	REVISED - C. JUCIUS 01-31-07

**STATE OF ILLINOIS  
DEPARTMENT OF TRANSPORTATION**

**ARTERIAL ROAD  
INFORMATION SIGN**

SCALE: NONE SHEET NO. 1 OF 1 SHEETS STA. TO STA.

F.A.P. RTE. 303	SECTION (132, 133 & 134) RS-6	COUNTY McHENRY	TOTAL SHEETS 26	SHEET NO. 25
TC-22			CONTRACT NO. 62495	
FED. ROAD DIST. NO. 1 ILLINOIS FED. AID PROJECT				

**LOOPS NEXT TO SHOULDERS**

PROVIDE A PAVEMENT REPLACEMENT NOTE WHICH SHOULD EQUAL 3' (900 mm) X WIDTH OF PAVED SHOULDER.

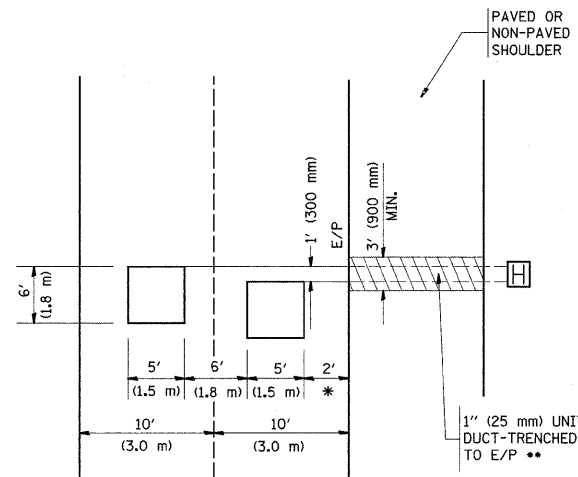

\* = (600 mm)

\*\* UNIT DUCT IS TO BE SHOWN ON PLAN SHEETS BUT SHALL NOT BE INCLUDED IN THE PAY ITEMS.

**LEFT TURN LANES WITH MEDIANS  
VOLUME DENSITY ("FAR OUT" DETECTION)  
ON SAME APPROACH  
(PROTECTED / PERMITTED LEFT TURN PHASING)**

HANDHOLE LOCATION MAY VARY DEPENDING ON GEOMETRICS AND DESIGN OF TRAFFIC SIGNALS. HEAVY-DUTY HANDHOLES TO BE USED WHEN THE MEDIAN IS MOUNTABLE. REFER TO STANDARD B14001 TO ENSURE THAT HANDHOLE FITS IN MEDIAN.

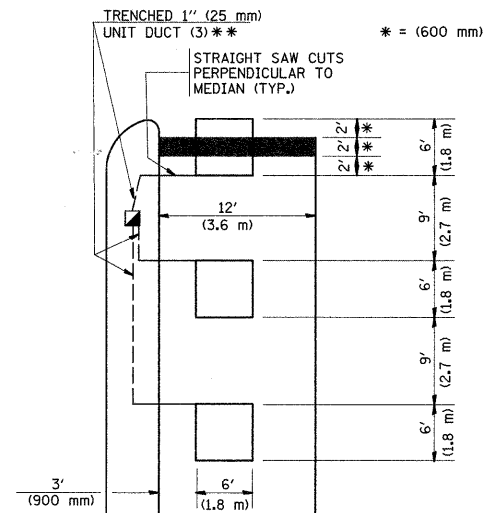

\*\* UNIT DUCT IS TO BE SHOWN ON PLAN SHEETS BUT SHALL NOT BE INCLUDED IN THE PAY ITEMS.

NOTE: DUAL LEFT TURNS NOT SHOWN REFER TO PLAN SHEET FOR DETECTOR LOOP REPLACEMENT

**LEFT TURN LANES WITHOUT MEDIANS  
VOLUME DENSITY ("FAR OUT" DETECTION)  
ON SAME APPROACH  
(PROTECTED / PERMITTED LEFT TURN PHASING)**

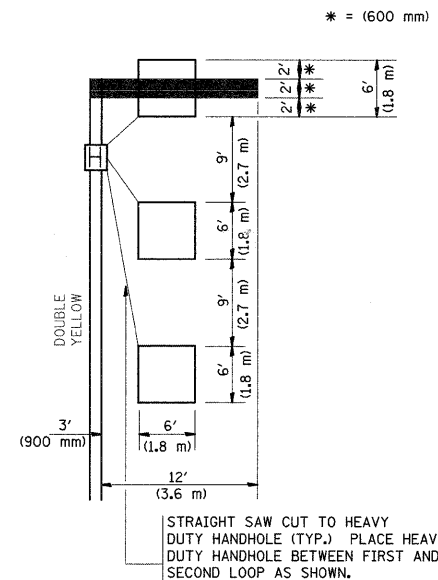

NOTE: DUAL LEFT TURNS NOT SHOWN REFER TO PLAN SHEET FOR DETECTOR LOOP REPLACEMENT

**ARTERIAL-VOLUME DENSITY ("FAR OUT" DETECTION)  
CROSS STREET-VOLUME DENSITY ("FAR OUT" DETECTION)**

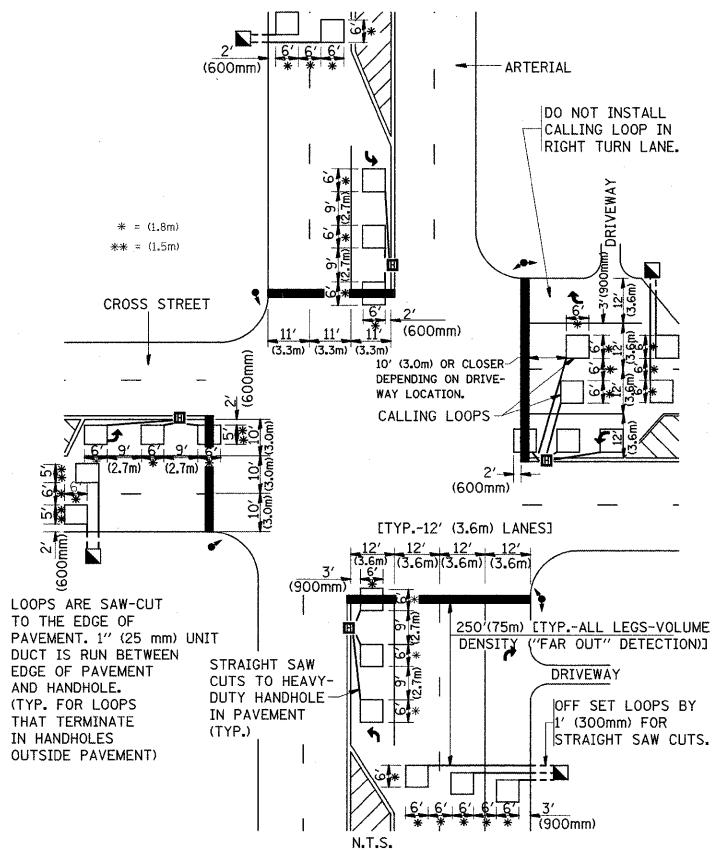

**DETAIL 1  
N.T.S.**

**ARTERIAL-VOLUME DENSITY ("FAR OUT" DETECTION)  
CROSS STREET-NON VOLUME DENSITY ("UPTIGHT" PRESENCE DETECTION)**

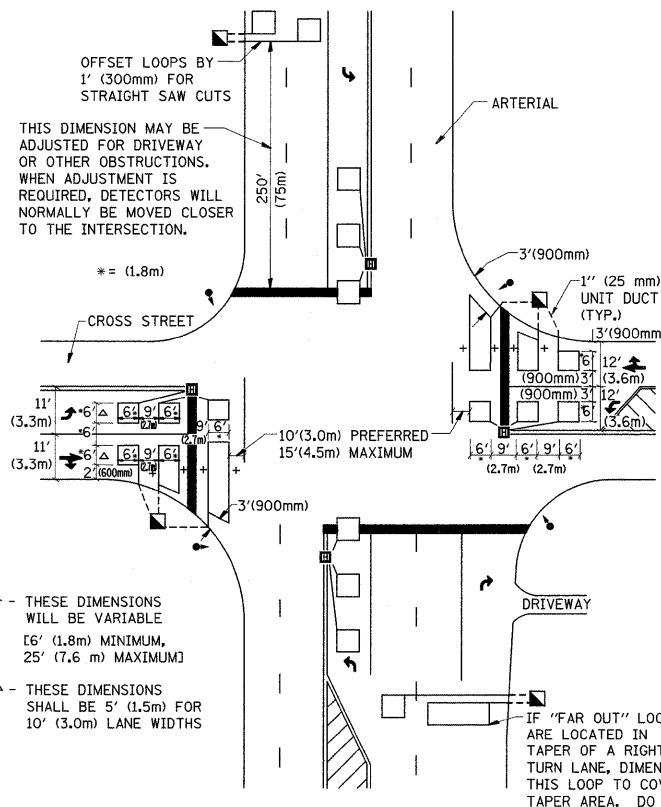

**DETAIL 2  
N.T.S.**

**NOTES:**

**VEHICLES LOOP DETECTORS**

- \* ALL LEAD IN CABLE SHALL BE TWO CONDUCTOR NO. 14 TWISTED, SHIELDED.
- \* EACH DETECTOR LOOP SHALL HAVE ITS OWN SAW CUT FROM THE LOOP TO THE EDGE OF PAVEMENT OR TO A HANDHOLE IN THE PAVEMENT.
- \* EACH DETECTOR LOOP SHALL HAVE ITS OWN ONE INCH (25 mm) UNIT DUCT BETWEEN THE EDGE OF PAVEMENT AND THE FIRST HANDHOLE OR JUNCTION BOX. EACH UNIT DUCT RUN SHALL BE SHOWN ON THE PLANS BY THE DESIGNER, BUT SHALL NOT BE PAID FOR SEPARATELY. THIS ITEM IS INCIDENTAL TO THE PAY ITEM FOR DETECTOR LOOPS.
- \* ONE DIMENSION OF ALL DETECTOR LOOPS SHALL BE SIX FEET (1.8 m)
- \* EACH LANE OF NON-LOCKING, PRESENCE DETECTION AND EACH LANE OF A DOUBLE LEFT TURN LANE REQUIRES A SEPARATE INDUCTIVE LOOP DETECTOR AND LEAD IN CABLE.
- \* WHEN NON-LOCKING, PRESENCE DETECTION IS USED, MORE THAN ONE LOOP PER LANE IS REQUIRED BEHIND THE STOP BAR (i.e. 1-1/2, 1-3/4, 2).
- \* WHEN SYSTEM LOOPS ARE REQUIRED ON AN APPROACH OF AN INTERSECTION, THE LOOPS USED FOR VOLUME DENSITY AND INTERSECTION TIMING SHALL ALSO BE USED AS SYSTEM DETECTORS. EACH ONE OF THESE TYPE OF LOOPS REQUIRES A SEPARATE TWO CONDUCTOR NO. 14 TWISTED SHIELDED CABLE AND A SEPARATE INDUCTIVE LOOP DETECTOR WHEN NEW CONTROLLERS ARE UTILIZED. THE DESIGNER SHALL LABEL THESE TYPES OF LOOPS AS "INTERSECTION AND SAMPLING (SYSTEM) DETECTORS" ON THE SIGNAL LAYOUT, THE INTERCONNECT PLAN AND THE SYSTEM CABLE PLAN. WHEN AN EXISTING CONTROLLER IS UTILIZED FOR THIS TYPE OF DETECTION, THE PAY ITEM "INDUCTIVE LOOP DETECTOR WITH SYSTEM OUTPUT" SHOULD BE USED.

**PLACEMENT OF DETECTORS**

THE FOLLOWING FIGURES REPRESENT THE MOST COMMON DETECTOR LOOP LOCATIONS AND SIZES. ADJUSTMENTS WILL BE NECESSARY FOR SPECIFIC GEOMETRIC CONSIDERATIONS.

LOCATIONS AND DEMENSIONS OF DETECTOR LOOPS ARE REQUIRED ON ALL SIGNAL LAYOUT PLAN SHEETS.

"FAR OUT" DETECTION REFERS TO LOCKING, PRESENCE TYPE DETECTION LOCATED IN THRU LANES, RIGHT TURN LANES, AND RIGHT TURN LANE TAPER AREAS (IF APPLICABLE), USUALLY 250' (75 m) IN ADVANCE OF STOP BARS. "UPTIGHT" DETECTION REFERS TO NON-LOCKING PRESENCE TYPE DETECTION LOCATED IN ALL LANES AND 10'-15' (3.0 m-4.5 m) BEHIND THE CROSSING STREET'S EDGE OF PAVEMENT EXTENDED.

**NOTE:**

ALL DETAILS AND NOTES SHOWN ARE FROM THE I.D.O.T. DISTRICT 1 TRAFFIC SIGNAL DESIGN GUIDELINES DATED JANUARY 1995

THIS DRAWING HAS BEEN PREPARED TO ASSIST THE RESIDENT ENGINEER FOR ALL ROADWAY RESURFACING OR S.M.A.R.T. PROJECTS WHERE THE DIMENSIONS ARE NOT SHOWN ON THE PLANS AND THE FINAL LOCATIONS FOR CROSSWALKS OR STOP BARS ARE NOT DETERMINED.

FILE NAME = c:\Projects\125302\sh_rdw.dgn	USER NAME = lszekrf	DESIGNED -	REVISED -	<b>STATE OF ILLINOIS DEPARTMENT OF TRANSPORTATION</b>	<b>DISTRICT 1 - DETECTOR LOOP INSTALLATION DETAILS FOR ROADWAY RESURFACING</b>			F.A.P. RTE. 303	SECTION (132, 133 & 134) RS-6	COUNTY McHENRY	TOTAL SHEETS 26	SHEET NO. 26
PLOT SCALE = 50.0000' / IN.	CHECKED - R.K.F.	DATE -	REVISED -		SCALE: NONE	SHEET NO. 1 OF 1 SHEETS	STA.	TO STA.	<b>TS-07</b>		CONTRACT NO. 62495	
PLOT DATE = 10/17/2008	DATE -	REVISED -	REVISED -		FED. ROAD DIST. NO. 1 [ILLINOIS] FED. AID PROJECT							