

STAGE 5

STA. 118+00 TO 124+00

EXIST. CURVE A0311590
 PI STA. =66+18.91
 $\Delta = 9^\circ 19' 43''$ (LT)
 $D = 1^\circ 00' 00''$
 $R = 5,729.53'$
 $T = 467.46'$
 $L = 932.85'$
 $E = 19.04'$
 $e = \text{-----}$
 $T.R. = \text{-----}$
 $S.E. \text{ RUN} = \text{-----}$
 $P.C. \text{ STA.} = 61+51.45$
 $P.T. \text{ STA.} = 70+84.30$

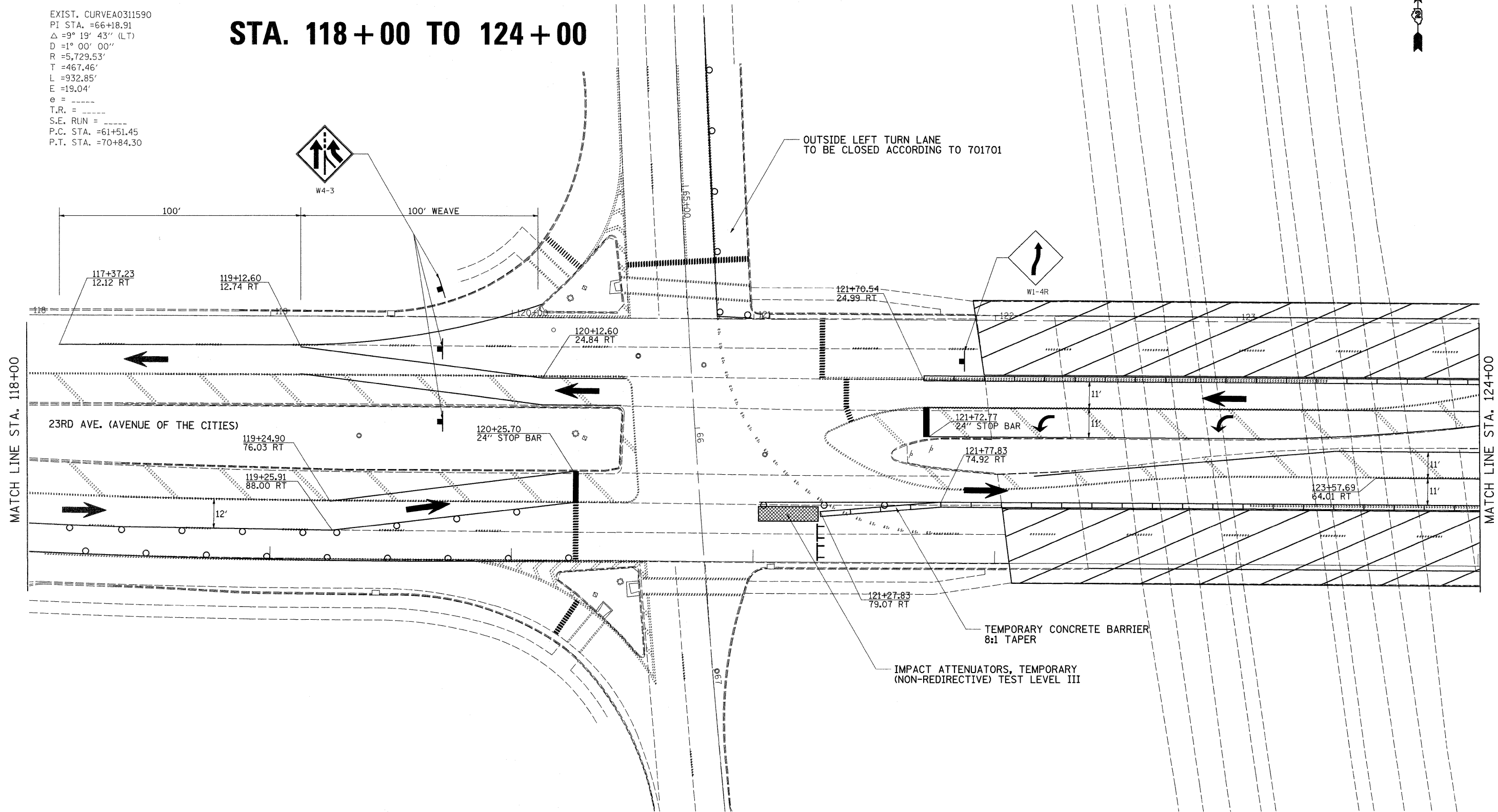

FILE NAME =	USER NAME = hensonke	DESIGNED -	REVISED -	STATE OF ILLINOIS DEPARTMENT OF TRANSPORTATION	STAGE 5 - STAGING PLANS				F.A.I. RTE.	SECTION	COUNTY	TOTAL SHEETS	SHEET NO.
C:\pw_work\PWIDOT\HENSONKE\dms33952\dms33952-shd-staging.dgn		DRAWN -	REVISED -		74	*	ROCK ISLAND	246	83				
PLOT SCALE = 28.0000' / IN.		CHECKED -	REVISED -		CONTRACT NO. 64A97								
PLOT DATE = Fri Feb 06 10:38:43 2009		DATE -	REVISED -		ILLINOIS FED. AID PROJECT								
					SCALE:	SHEET NO.	OF	SHEETS	STA.	TO	STA.	81-(1-2,1,2-2)RS-1&M	