

DETOUR FOR IL 5 EB TO I-74 EB (RAMP F)

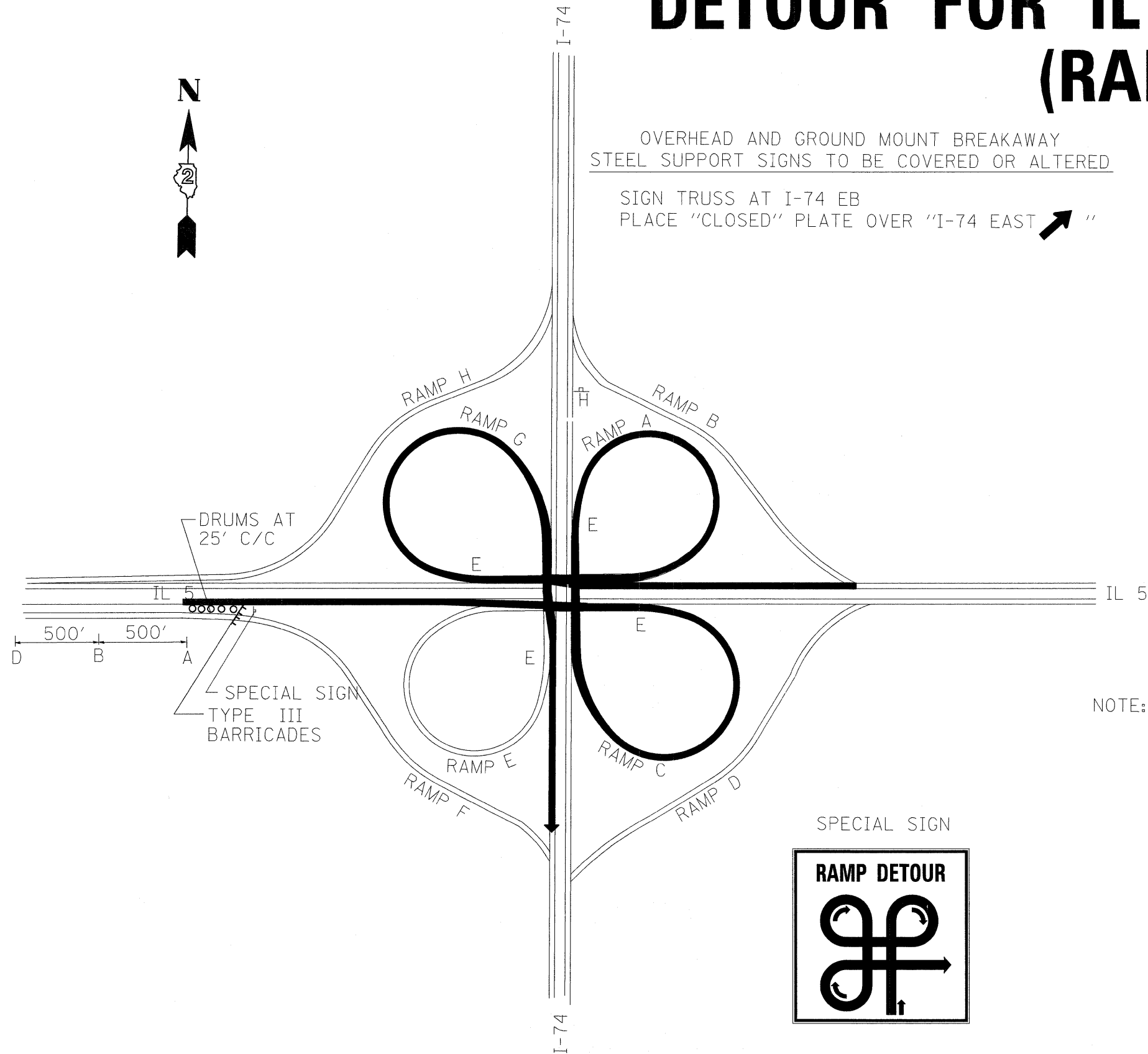

OVERHEAD AND GROUND MOUNT BREAKAWAY
STEEL SUPPORT SIGNS TO BE COVERED OR ALTERED

SIGN TRUSS AT I-74 EB
PLACE "CLOSED" PLATE OVER "I-74 EAST" →



- A. **DETOUR** M4-8(0)(30x15)
- WEST** M3-4 30X15 BLUE
- 74** M1-1 36 RED, WHITE, BLUE
- ↑** M6-3 30X18 ORANGE
- B. **RAMP DETOUR AHEAD** 48"
- D. **RAMP CLOSED AHEAD** 48"
- H. **END DETOUR** M4-8A 24X18
- E. **DETOUR** M4-8(0)(30x15)
- WEST** M3-4 30X15 BLUE
- 74** M1-1 36 RED, WHITE, BLUE
- ↗** M6-2R 30X18 ORANGE

NOTE: THE TYPE III BARRICADE SHALL HAVE A RAMP CLOSED SIGN. REVISE SIGN R11-2 (Road Closed) to "RAMP CLOSED"

RAMP CLOSED 48X30 BLACK ON WHITE

THE CONTRACTOR SHALL BE RESPONSIBLE FOR PROVIDING ALL SIGNS REQUIRED FOR THE RAMP CLOSURES AND DETOURS.

SEE SPECIAL SIGN DETAILS SHEET
THE RAMPS SHALL NOT BE CLOSED AT THE SAME TIME.

Powerdraft: special signs I74&IL5

FILE NAME =	USER NAME = duncanfa	DESIGNED -	REVISED -	STATE OF ILLINOIS DEPARTMENT OF TRANSPORTATION	DETOUR FOR IL 5 EB TO I-74 EB				F.A.I. RTE.	SECTION	COUNTY	TOTAL SHEETS	SHEET NO.
ct:\pw_work\PWIDOT\DUNCANFA\dms33952\d08005-shi-ta.dgn		DRAWN -	REVISED -		505	*	ROCK ISLAND	246	104				
PLOT SCALE = 50.0000' / IN.		CHECKED -	REVISED -		CONTRACT NO. 64A97								
PLOT DATE = Fri Feb 06 10:54:45 2009		DATE -	REVISED -		ILLINOIS FED. AID PROJECT								
					SCALE:	SHEET NO.	OF	SHEETS	STA.	TO STA.	81-(1-2,1,2-2)RS-1&M		