

NOTES:
 ALL DIMENSIONS SHOWN ARE BETWEEN POINTS ON A HORIZONTAL PLANE AT A TEMPERATURE OF 50°F.
 □ INDICATES FLOOR DRAIN.
 ○ INDICATES LIGHT STANDARD (BY OTHERS)

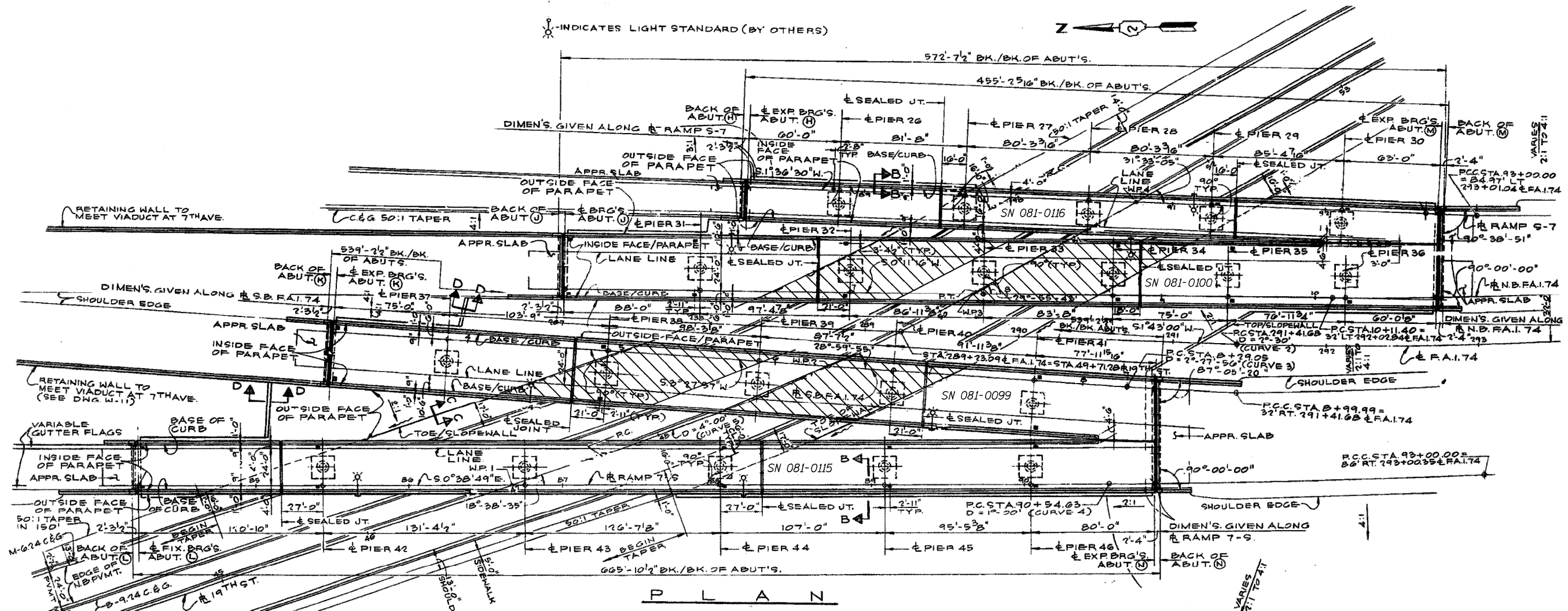

P L A N

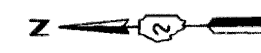
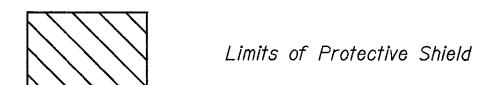
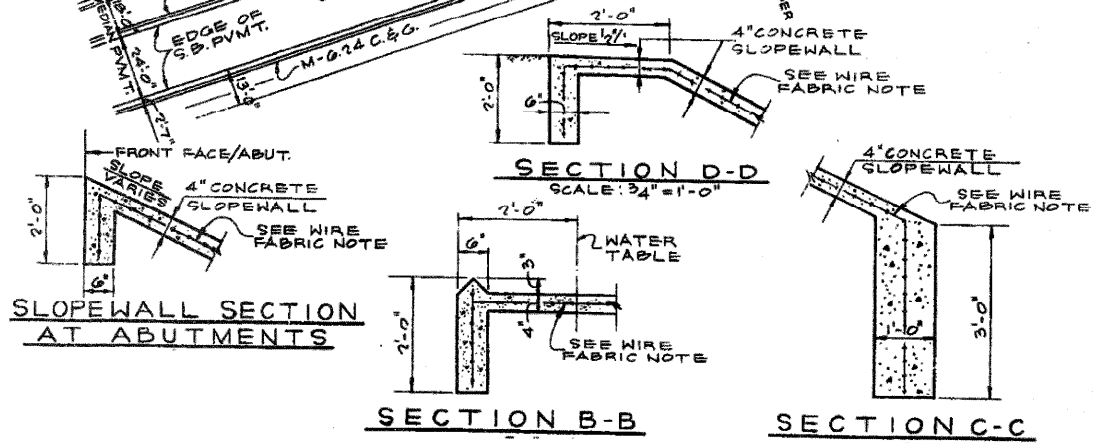

GENERAL PLAN & ELEVATION
I-74 OVER 19th STREET
FAI 74 (I-74)
SECTION 81-(1-2,1,2-2)RS-1 & M
ROCK ISLAND COUNTY
STRUCTURE NUMBER 081-0099 (SB) &
081-0100 (NB)



Expires 11/30/2009

Sheet 1 of 18

FILE NAME =	USER NAME = cushmanbw	DESIGNED -	REVISED -	STATE OF ILLINOIS DEPARTMENT OF TRANSPORTATION	General Plan & Elevation			F.A.I. RTE.	SECTION	COUNTY	TOTAL SHEETS	SHEET NO.
0:\Projects\Rock_Island\64497_IL 74 - resurfacing in MoLine\Phase I\CAD\Final Bridge	DRAWN 081-0099 & 081-0100.dgn	CHECKED -	REVISED -					74	81-(1-2,1,2-2)RS-1 & M	Rock Island	246	130
PLOT SCALE = 50.0000' / IN.	DATE -	REVISED -	REVISED -					CONTRACT NO. 64A97				
PLOT DATE = Fri Feb 06 13:16:25 2009	DATE -	REVISED -	REVISED -					ILLINOIS FED. AID PROJECT				