

F.A.P. RTE.	SECTION	COUNTY	TOTAL SHEETS	SHEET NO.
741	•	PIATT	48	1

• 8RS-4&(9,10)RS-3

STATE OF ILLINOIS
DEPARTMENT OF TRANSPORTATION

DIVISION OF HIGHWAYS

**PROPOSED
HIGHWAY PLANS**

FAP ROUTE 741 (IL 105)
SECTION 8RS-4&(9,10)RS-3
PROJECT ESP-0741(098)
PIATT COUNTY

C-95-121-00

RESURFACING (3P) FROM IL 32 (2 MILES SOUTH OF CERRO GORDO) TO SCL OF BEMENT

D-95-059-00



LOCATION OF SECTION INDICATED THUS: - [rectangle] -

(217)465-4181

PROJECT ENGINEER: KEVIN TRAPP

SQUAD LEADER: MICHAEL LEROY

DESIGNER: DANA HENNESS

FOR INDEX OF SHEETS, SEE SHEET NO. 2
FOR SUMMARY OF QUANTITIES, SEE SHEET NO. 4-5

CURRENT ADT			
IL 105 (S)	1,800	2007	
IL 105 (E)	900	2007	
IL 105 (N)	1,550	2007	

DESIGN DESIGNATION	
N/A	

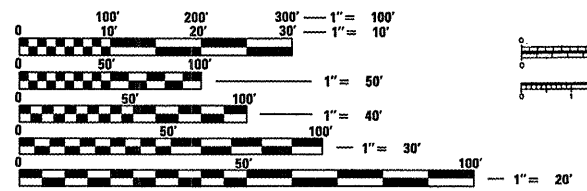

FULL SIZE PLANS HAVE BEEN PREPARED USING STANDARD ENGINEERING SCALES. REDUCED SIZED PLANS WILL NOT CONFORM TO STANDARD SCALES. IN MAKING MEASUREMENTS ON REDUCED PLANS, THE ABOVE SCALES MAY BE USED.

J.U.L.I.E.
JOINT UTILITY LOCATION INFORMATION FOR EXCAVATION
1-800-892-0123

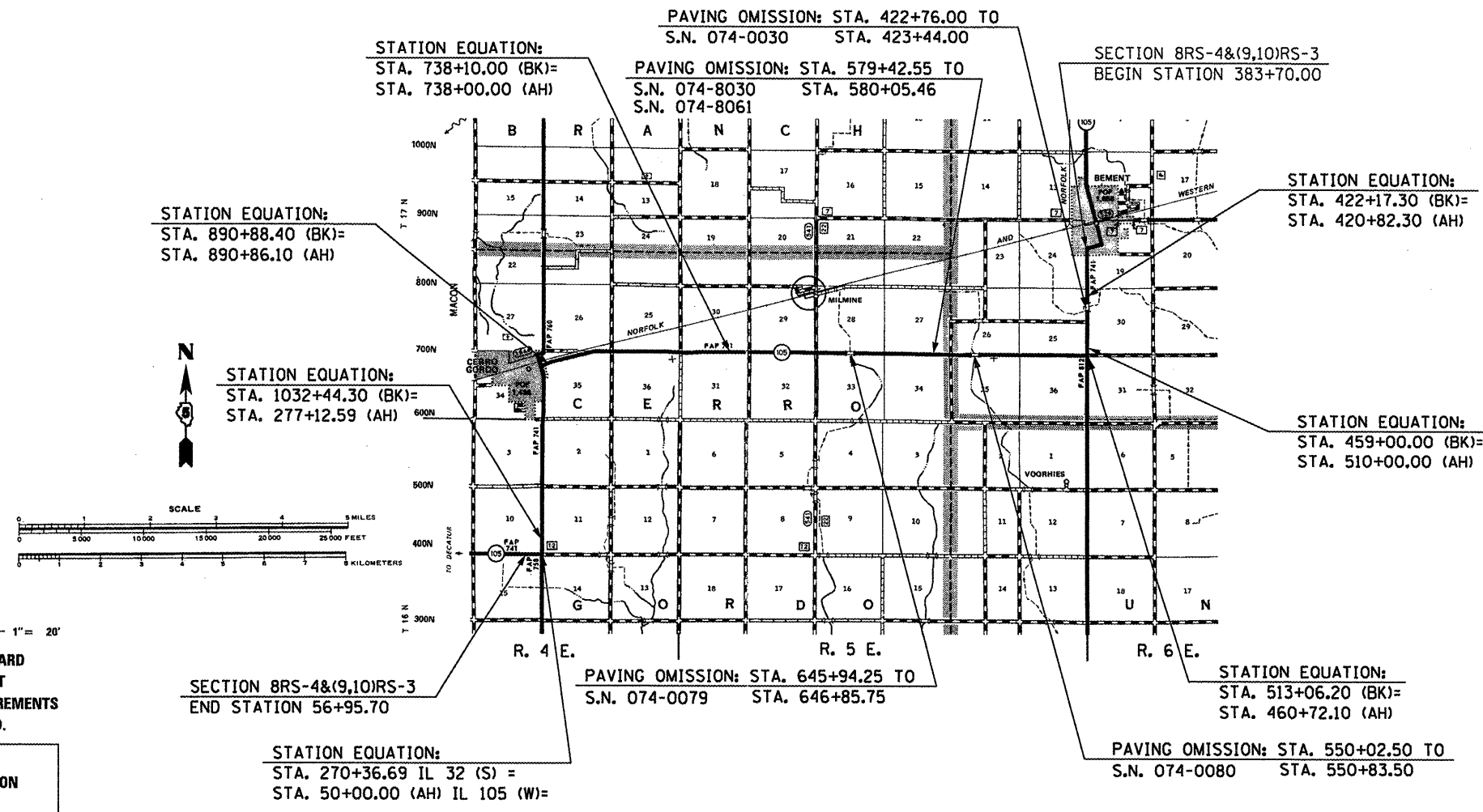

TOTAL LENGTH OF SECTION & PROJECT = 66,527.30 FEET = 12.600 MILES
NET LENGTH OF SECTION & PROJECT = 66,223.89 FEET = 12.542 MILES

STATE OF ILLINOIS
DEPARTMENT OF TRANSPORTATION
DIVISION OF HIGHWAYS

SUBMITTED 1/22 20 09
Joseph E. Cooney
DEPUTY DIRECTOR OF HIGHWAYS, REGION ENGINEER

March 13, 20 09
Charles G. Lovell
ENGINEER OF DESIGN AND ENVIRONMENT

March 13, 20 09
Christine M. Reed
DIRECTOR OF HIGHWAYS, CHIEF ENGINEER

**PRINTED BY THE AUTHORITY
OF THE STATE OF ILLINOIS**

CONTRACT NO. 70129

PLOT DATE = 1/28/2009
FILE NAME = c:\pwork\70129\DOT\CEARL\001\DWG\04137\B12cover.dgn
USER NAME = dhenness