

F.A. RTE.	SECTION	COUNTY	TOTAL SHEETS	SHEET NO.
172	*	ADAMS	108	42

STA. 94+92.26 TO STA. 110+35.67
 FED. ROAD DIST. NO. 6 ILLINOIS FED. AID PROJECT

*** (1-5)RS-1; (1-6)RS**
CONTRACT NO. 72694



CURVE
 P.I. STA= 90+24.84
 $\Delta = 61^{\circ}39'37''$ (LT)
 D= 1 $^{\circ}59'48''$
 R= 2,869.79'
 T= 1,712.78'
 L= 3,088.24'
 E= 472.26'
 EX & PR SE= 6.00% (70 MPH DESIGN)
 T.R.= 38.30'
 S.E. RUN= 270.00'
 P.C. STA= 73+12.06
 P.T. STA= 104+00.30
 SE TRANS.:
 STA 70+93.76 TO STA 74+02.06
 STA 103+10.45 TO STA 106+18.75

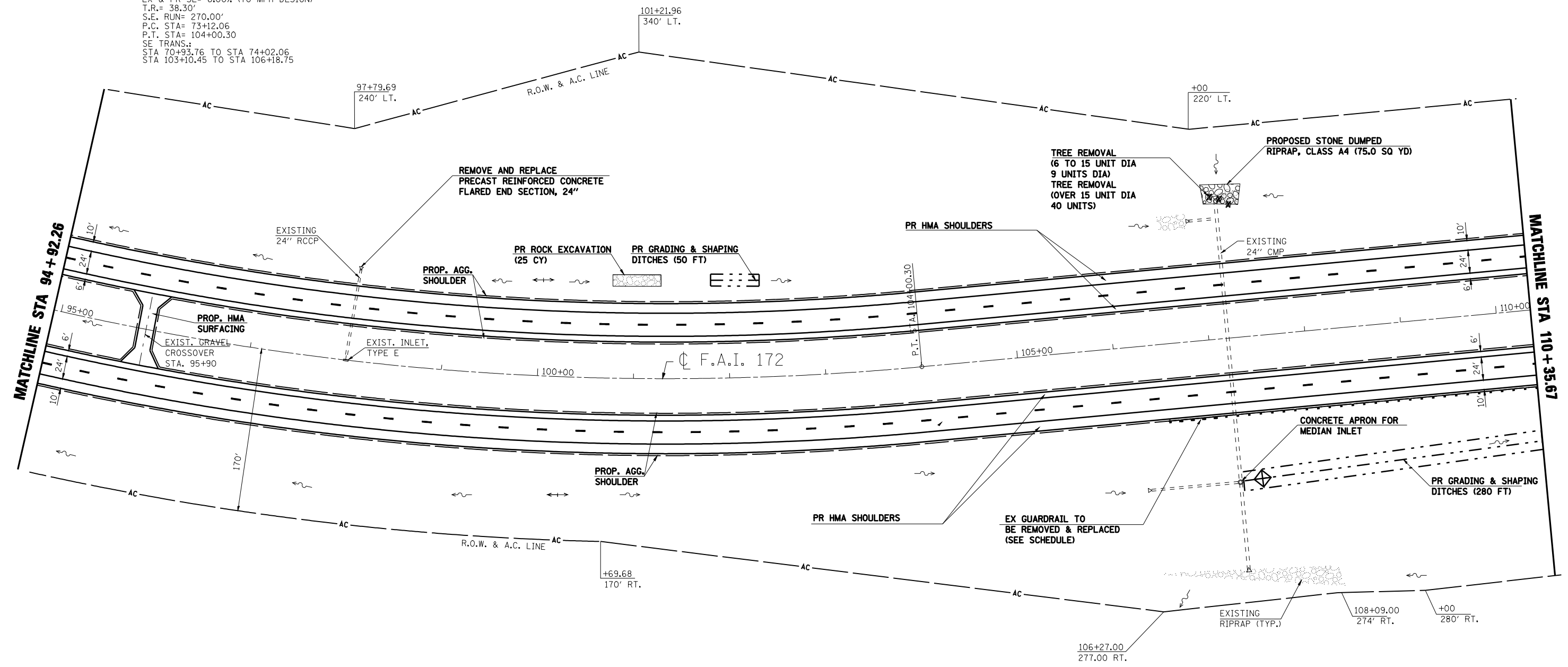

MATCHLINE STA 94+92.26

MATCHLINE STA 110+35.67

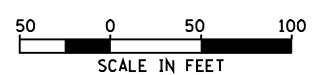

- INLET & PIPE PROTECTION
- HMA SURFACE REMOVAL - BUTT JOINT
- PCC SURFACE REMOVAL - BUTT JOINT
- HEAVY DUTY EXCELSIOR BLANKET
- TEMPORARY DITCH CHECK (AGG. EROS. CONTROL)
- DITCH FLOW LINE

REVISIONS	
NAME	DATE

ILLINOIS DEPARTMENT OF TRANSPORTATION
PLAN SHEET
STA. 94+92.26 TO STA. 110+35.67
 F.A.I. 172
 ADAMS COUNTY

SCALE: VERT. _____
 HORIZ. _____
 DATE: 08/09/04

DRAWN BY: JJS
 CHECKED BY: LLQ