

F.A.I. RTE.	SECTION	COUNTY	TOTAL SHEETS	SHEET NO.
172	*	ADAMS	108	43

STA. 110+35.67 TO STA.125+73.04
 FED. ROAD DIST. NO. 6 ILLINOIS FED. AID PROJECT

* (1-5)RS-1; (1-6)RS
 CONTRACT NO. 72694

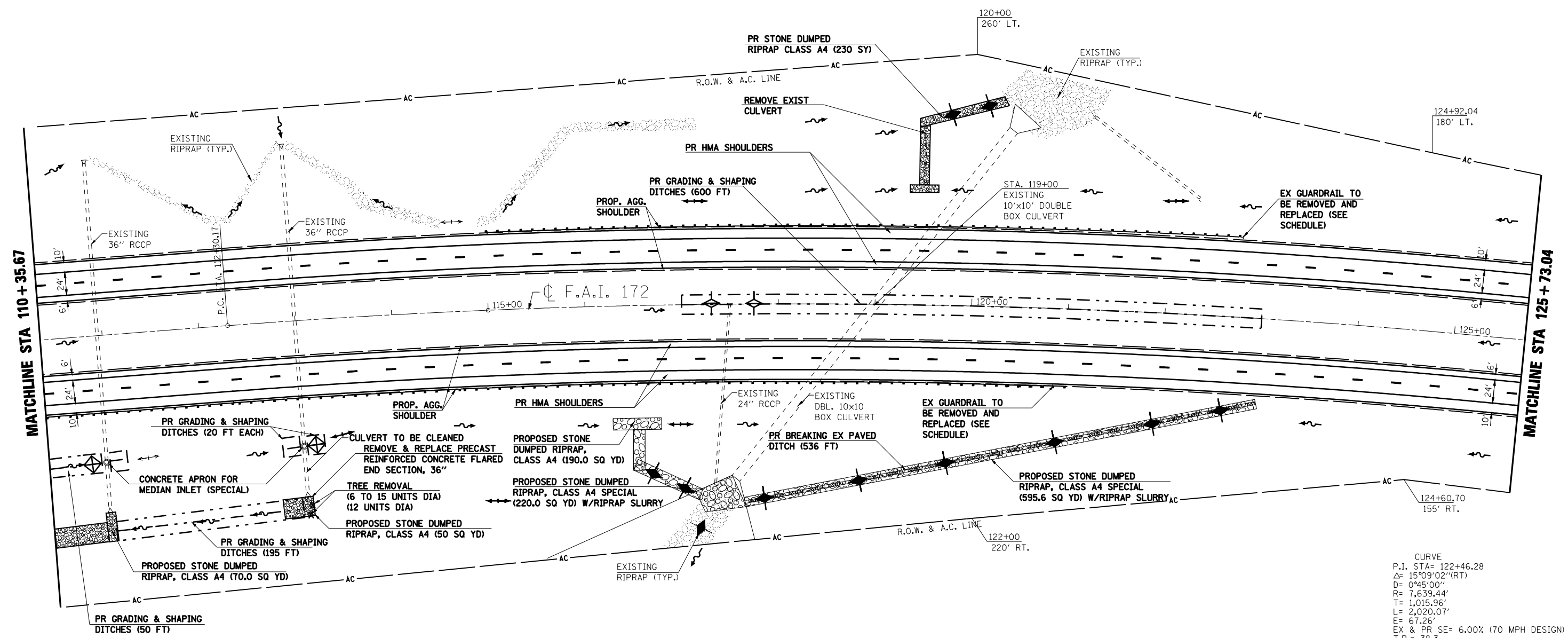

CURVE
 P.I. STA= 122+46.28
 Δ = 15°09'02\"/>

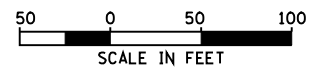

- INLET & PIPE PROTECTION
- HMA SURFACE REMOVAL - BUTT JOINT
- PCC SURFACE REMOVAL - BUTT JOINT
- HEAVY DUTY EXCELSIOR BLANKET
- TEMPORARY DITCH CHECK (AGG. EROS. CONTROL)
- DITCH FLOW LINE

REVISIONS	
NAME	DATE

ILLINOIS DEPARTMENT OF TRANSPORTATION
PLAN SHEET
STA. 110 + 35.67 TO STA. 125 + 73.04
 F.A.I. 172
 ADAMS COUNTY

SCALE: VERT. _____
 HORIZ. _____
 DATE: 08/09/04

DRAWN BY: JJS
 CHECKED BY: LLO