

| F.A.I. RTE.                                     | SECTION | COUNTY           | TOTAL SHEETS | SHEET NO. |
|---|---------|------------------|--------------|-----------|
| 172   | *       | ADAMS            | 108          | 45        |
| STA. 141+08.63                                  |         | TO STA.156+43.63 |              |           |
| FED. ROAD DIST. NO. 6 ILLINOIS FED. AID PROJECT |         |                  |              |           |

\* (1-5)RS-1; (1-6)RS  
CONTRACT NO. 72694

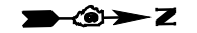

| S.N. 001-0045 | SB    |       |       | NB    |       |       |
|---------------|-------|-------|-------|-------|-------|-------|
|               | EOP   | CL    | EOP   | EOP   | CL    | EOP   |
| NORTH BEAM    | 16.25 | 16.10 | 16.39 | 16.89 | 16.80 | 17.04 |
| SOUTH BEAM    | 16.48 | 16.40 | 16.75 | 17.28 | 17.21 | 17.52 |

NOTE: 16.0' MIN. CLEARANCE MUST BE MAINTAINED AFTER RESURFACING (SEE RAMP DETAILS).

CURVE  
P.I. STA= 45+62.23  
Δ= 9°38'33"LT  
D= 1°54'35"  
R= 3000.35'  
T= 253.07'  
L= 504.94'  
E= 10.65'  
e= 2.50%  
T.R.=  
S.E. RUN=  
P.C. STA=  
P.T. STA=  
EX SE TRANS.:  
STA 47+46.00 TO STA 48+71.00

MATCHLINE STA 141 + 08.63

MATCHLINE STA 156 + 43.63

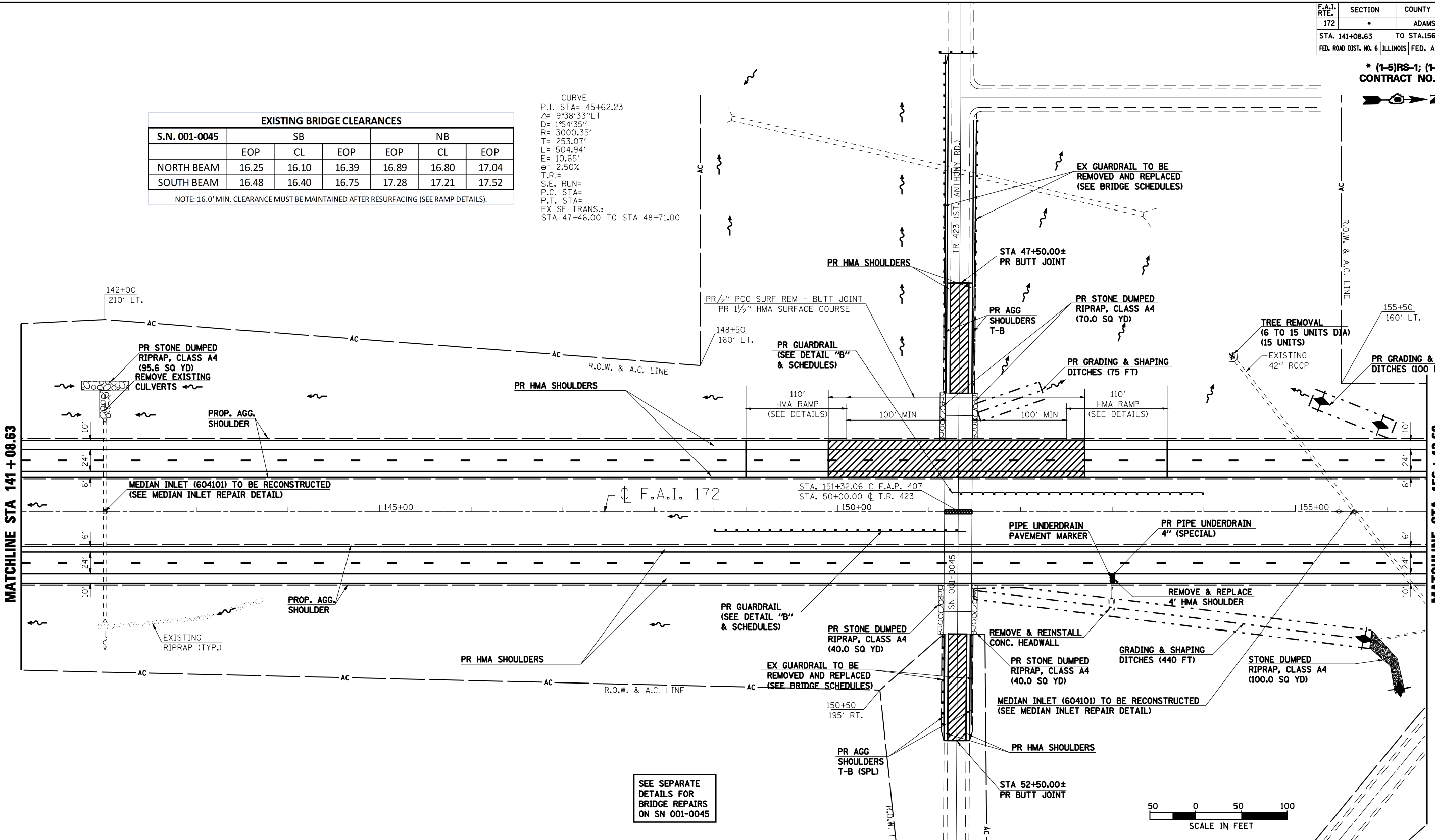

SEE SEPARATE  
DETAILS FOR  
BRIDGE REPAIRS  
ON SN 001-0045

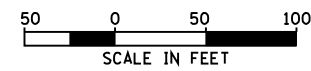

- ◆ INLET & PIPE PROTECTION
- ▨ HMA SURFACE REMOVAL - BUTT JOINT
- ▩ PCC SURFACE REMOVAL - BUTT JOINT
- ▧ HEAVY DUTY EXCELISIOR BLANKET
- ✦ TEMPORARY DITCH CHECK (AGG. EROS. CONTROL)
- ~ DITCH FLOW LINE

| REVISIONS |      |
|-----------|------|
| NAME      | DATE |
|           |      |
|           |      |
|           |      |
|           |      |
|           |      |
|           |      |
|           |      |
|           |      |
|           |      |
|           |      |

ILLINOIS DEPARTMENT OF TRANSPORTATION  
**PLAN SHEET**  
**STA. 141+08.63 TO STA. 156+43.63**  
F.A.I. 172  
ADAMS COUNTY

SCALE: VERT. \_\_\_\_\_  
HORIZ. \_\_\_\_\_  
DATE: 08/09/04

DRAWN BY: JJS  
CHECKED BY: LLQ