

| F.A.I. RTE. | SECTION | COUNTY | TOTAL SHEETS | SHEET NO. |
|---|---------|-------------------|--------------|-----------|
| 172 | * | ADAMS | 108 | 50 |
| STA. 217+84.42 | | TO STA. 233+23.31 | | |
| FED. ROAD DIST. NO. 6 ILLINOIS FED. AID PROJECT | | | | |

* (1-5)RS-1; (1-8)RS
CONTRACT NO. 72894

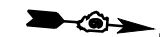

| EXISTING BRIDGE CLEARANCES | | | | | | |
|----------------------------|-------|-------|-------|-------|-------|-------|
| S.N. 001-0046 | SB | | | NB | | |
| | EOP | CL | EOP | EOP | CL | EOP |
| NORTH BEAM | 21.99 | 21.34 | 20.68 | 18.53 | 17.75 | 17.00 |
| SOUTH BEAM | 22.02 | 21.34 | 20.70 | 18.60 | 17.80 | 16.97 |

NOTE: 16.0' MIN. CLEARANCE MUST BE MAINTAINED AFTER RESURFACING (SEE RAMP DETAILS).

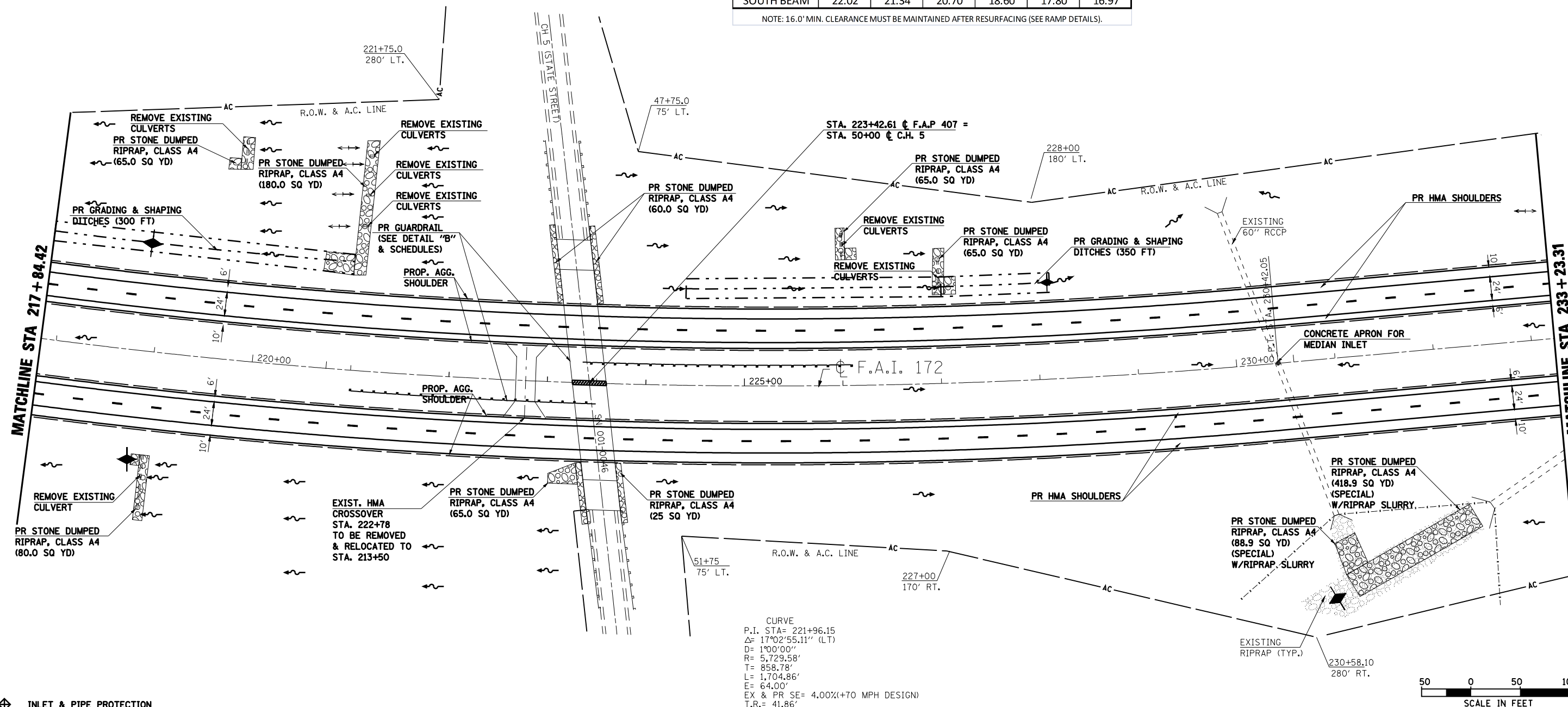

- INLET & PIPE PROTECTION
- HMA SURFACE REMOVAL - BUTT JOINT
- PCC SURFACE REMOVAL - BUTT JOINT
- HEAVY DUTY EXCELSIOR BLANKET
- TEMPORARY DITCH CHECK (AGG. EROS. CONTROL)
- DITCH FLOW LINE

| REVISIONS | |
|-----------|------|
| NAME | DATE |
| | |
| | |
| | |
| | |
| | |
| | |
| | |
| | |
| | |
| | |

ILLINOIS DEPARTMENT OF TRANSPORTATION
PLAN SHEET
STA. 217 + 84.42 TO STA. 233 + 23.31
F.A.I. 172
ADAMS COUNTY
SCALE: VERT. _____
HORIZ. _____
DATE 08/09/04
DRAWN BY JJS
CHECKED BY LLQ

