

F.A.I. RTE.	SECTION	COUNTY	TOTAL SHEETS	SHEET NO.
172	*	ADAMS	108	56

STA. 21+26.90 TO STA. 36+62.41  
 FED. ROAD DIST. NO. 6 ILLINOIS FED. AID PROJECT

\* (1-5)RS-1; (1-6)RS  
 CONTRACT NO. 72694

CURVE RAMP C  
 P.I. STA= 19+24.40  
 $\Delta$ = 5°52'58" (LT)  
 D= 1°33'02"  
 R= 3695.13'  
 T= 189.86'  
 L= 379.39'  
 E= 41.37'  
 EX & PR SE= 5.44%  
 T.R.= 60.0'  
 S.E. RUN= 217.60'  
 P.C. STA= 17+34.54  
 P.T. STA= 21+23.63  
 SE TRANS.:  
 STA 15+32.47 TO STA 18+10.07

CURVE RAMP D  
 P.I. STA= 7+67.72  
 $\Delta$ = 30°20'18" (RT)  
 D= 5°00'00"  
 R= 1145.92'  
 T= 310.68'  
 L= 606.77'  
 E= 41.37'  
 EX & PR SE= 8.00%  
 T.R.= 51.12'  
 S.E. RUN= 272.64'  
 P.C. STA= 4+57.04  
 P.T. STA= 10+63.81  
 SE TRANS.:  
 STA 3+03.52 TO STA 5+47.92  
 STA 9+72.93 TO STA 12+17.33



MATCHLINE STA 21+26.90

MATCHLINE STA 36+62.41

MATCHLINE STA 8+00.00  
 SEE SHEET 67

MATCHLINE STA 5+00.00  
 SEE SHEET 66

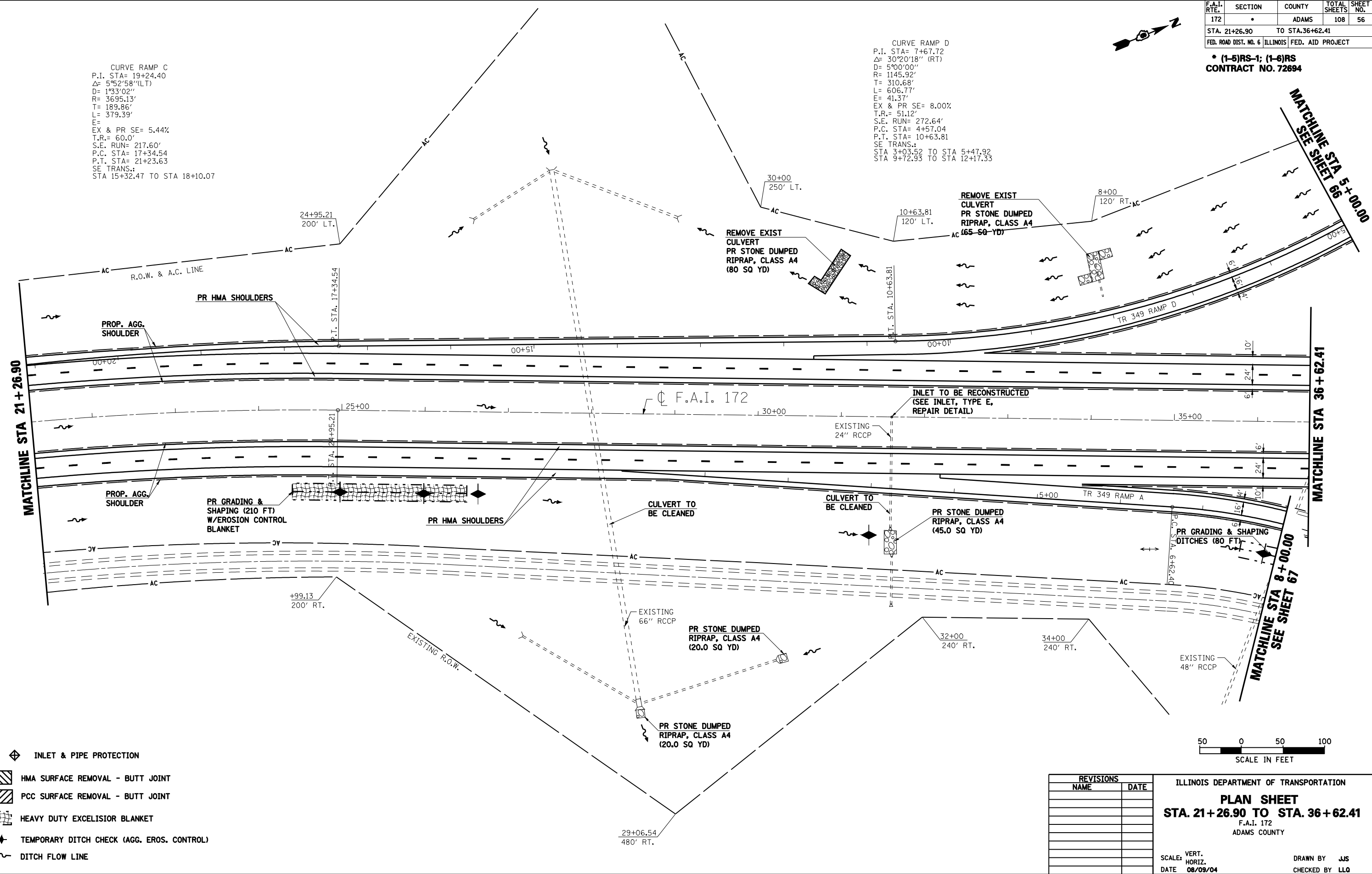

- ◆ INLET & PIPE PROTECTION
- ▨ HMA SURFACE REMOVAL - BUTT JOINT
- ▩ PCC SURFACE REMOVAL - BUTT JOINT
- ▧ HEAVY DUTY EXCELISIOR BLANKET
- ◆ TEMPORARY DITCH CHECK (AGG. EROS. CONTROL)
- ~ DITCH FLOW LINE

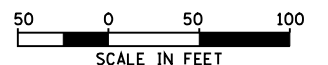

REVISIONS	
NAME	DATE

ILLINOIS DEPARTMENT OF TRANSPORTATION  
**PLAN SHEET**  
**STA. 21+26.90 TO STA. 36+62.41**  
 F.A.I. 172  
 ADAMS COUNTY

SCALE: VERT. \_\_\_\_\_  
 HORIZ. \_\_\_\_\_  
 DATE: 08/09/04  
 DRAWN BY: JJS  
 CHECKED BY: LLQ