

F.A.I. RTE.	SECTION	COUNTY	TOTAL SHEETS	SHEET NO.
172	*	ADAMS	108	63
STA. 128+73.56		TO STA. 144+08.56		
FED. ROAD DIST. NO. 6 ILLINOIS FED. AID PROJECT				

**\* (1-5)RS-1; (1-6)RS  
CONTRACT NO. 72694**



S.N. 001-0049	SB			NB		
	EOP	CL	EOP	EOP	CL	EOP
NORTH BEAM	17.38	17.17	17.30	16.75	16.38	16.38
SOUTH BEAM	17.77	17.60	17.75	17.05	16.80	16.85

NOTE: 16.0' MIN. CLEARANCE MUST BE MAINTAINED AFTER RESURFACING (SEE RAMP DETAILS).

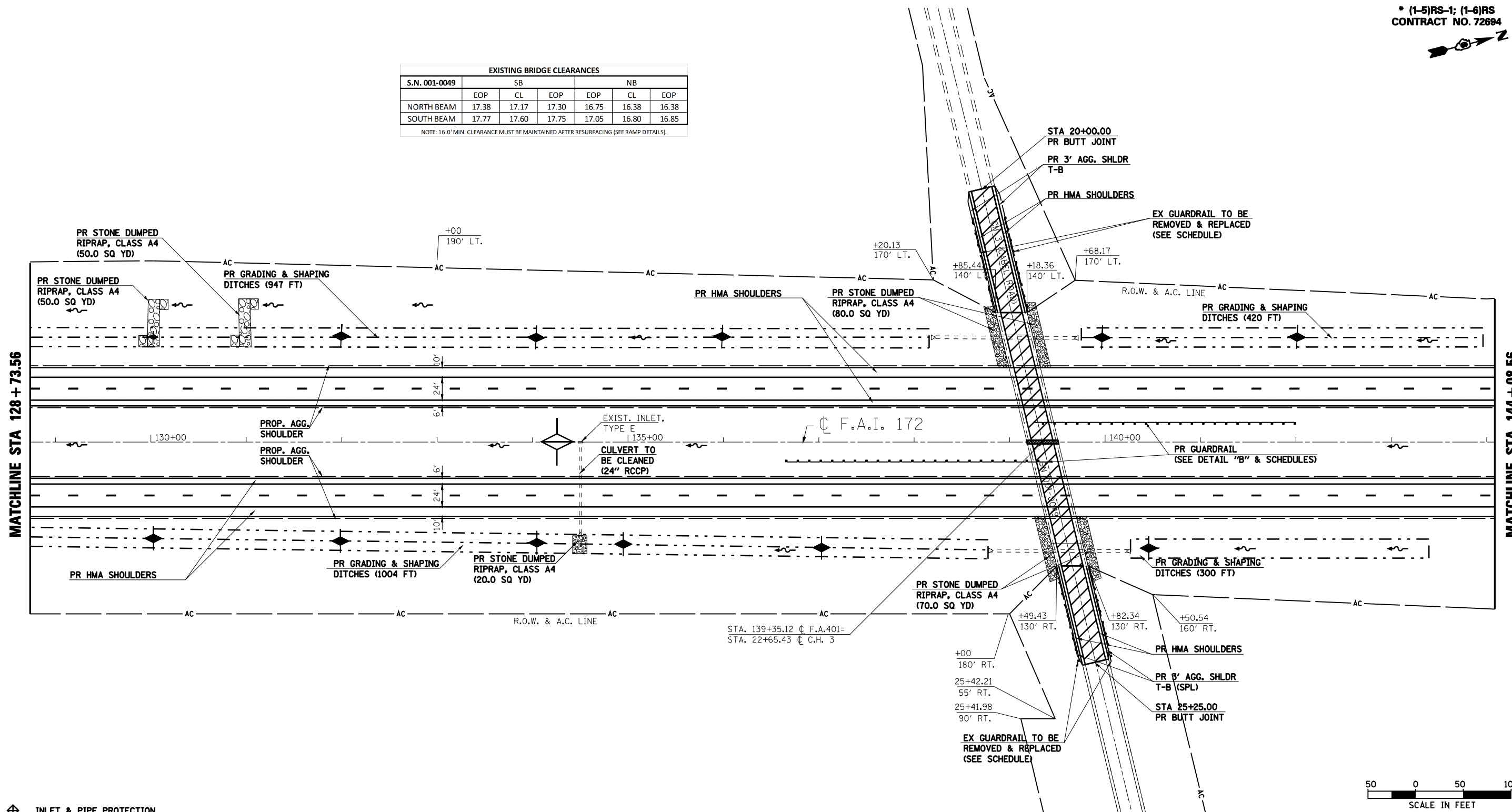

- INLET & PIPE PROTECTION
- HMA SURFACE REMOVAL - BUTT JOINT
- PCC SURFACE REMOVAL - BUTT JOINT
- HEAVY DUTY EXCELSIOR BLANKET
- TEMPORARY DITCH CHECK (AGG. EROS. CONTROL)
- DITCH FLOW LINE

SEE SEPARATE  
DETAILS FOR  
BRIDGE REPAIRS  
SN 001-0049

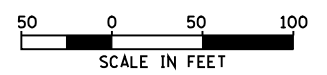

REVISIONS	
NAME	DATE

ILLINOIS DEPARTMENT OF TRANSPORTATION  
**PLAN SHEET**  
**STA. 128+73.56 TO STA. 144+08.56**  
F.A.I. 172  
ADAMS COUNTY

SCALE: VERT.    DRAWN BY JJS  
          HORIZ.    CHECKED BY LLQ  
DATE 08/09/04