

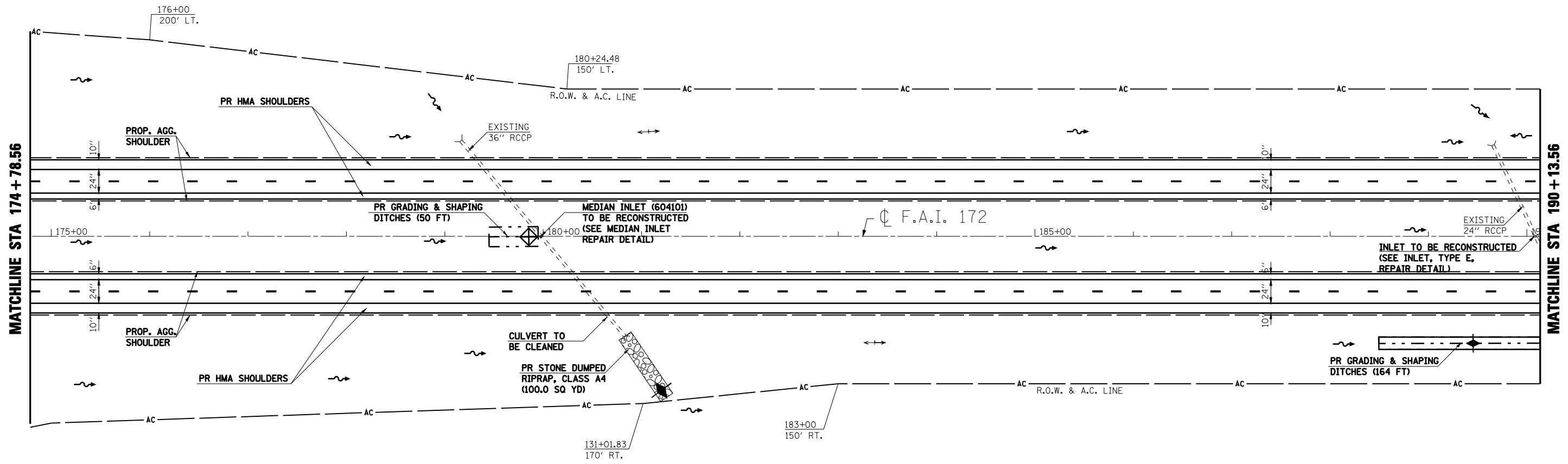





F.A.I. RTE.	SECTION	COUNTY	TOTAL SHEETS	SHEET NO.
172	*	ADAMS	108	66

STA. 174+78.56 TO STA.190+13.56
FED. ROAD DIST. NO. 6 ILLINOIS FED. AID PROJECT

* (1-5)RS-1; (1-6)RS
CONTRACT NO. 72694

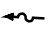

-  INLET & PIPE PROTECTION
-  HMA SURFACE REMOVAL - BUTT JOINT
-  PCC SURFACE REMOVAL - BUTT JOINT
-  HEAVY DUTY EXCELSIOR BLANKET
-  TEMPORARY DITCH CHECK (AGG. EROS. CONTROL)
-  DITCH FLOW LINE

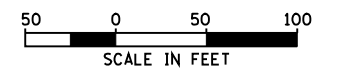

REVISIONS	
NAME	DATE

ILLINOIS DEPARTMENT OF TRANSPORTATION
PLAN SHEET
STA. 174+78.56 TO STA. 190+13.56
F.A.I. 172
ADAMS COUNTY

SCALE: VERT. _____
HORIZ. _____
DATE: 08/09/04

DRAWN BY: JJS
CHECKED BY: LLQ