

F.A.I. RTE.	SECTION	COUNTY	TOTAL SHEETS	SHEET NO.
172	*	ADAMS	108	75

STA. 349 RAMP C TO STA. 349 RAMP D
 FED. ROAD DIST. NO. 6 ILLINOIS FED. AID PROJECT
 • (1-5)RS-1; (1-6)RS
CONTRACT NO. 72694



CURVE RAMP C
 P.I. STA= 18+54.86
 Δ = 73°58'23" (LT)
 D= 12°00'00"
 R= 477.46'
 T= 359.62'
 L= 616.44'
 E= 120.28'
 EX & PR SE= 8.00%
 T.R.= 21.24'
 S.E. RUN= 38.64'
 P.C. STA= 14+95.24
 P.T. STA= 21+11.68
 SE TRANS.:
 STA 13+75.24 TO STA 15+81.32
 STA 20+42.99 TO STA 22+27.83

CURVE RAMP D
 P.I. STA= 9+74.65
 Δ = 44°27'46" (RT)
 D= 7°30'00"
 R= 763.94'
 T= 312.25'
 L= 592.84'
 E= 61.35'
 EX & PR SE= 8.00%
 T.R.= 44.4'
 S.E. RUN= 236.80'
 P.C. STA= 6+62.40
 P.T. STA= 12+55.24
 SE TRANS.:
 STA 5+29.02 TO STA 7+41.33
 STA 11+38.44 TO STA 13+75.24

SEE SEPERATE PLAN SHEETS FOR COLUMBUS ROAD AND INTERSECTION IMPROVEMENTS

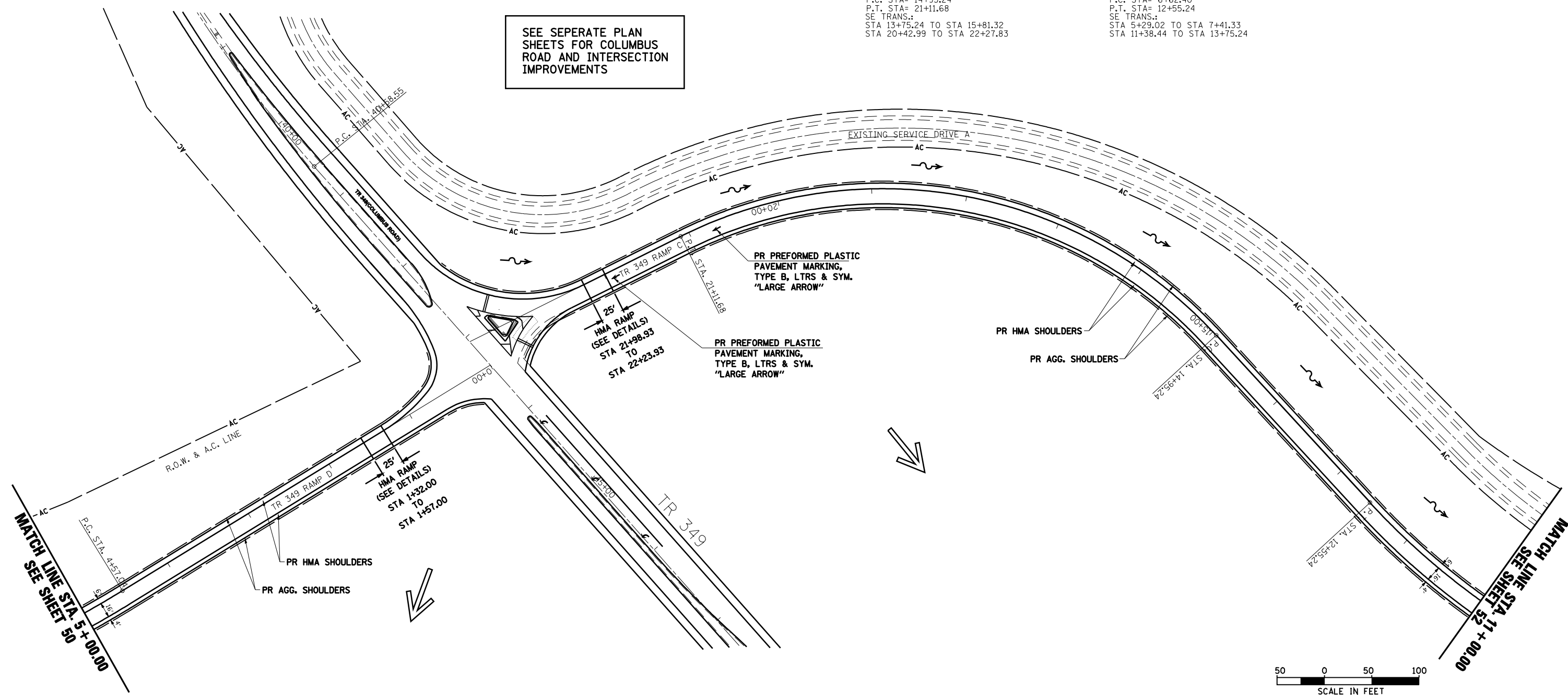

REVISIONS	
NAME	DATE

ILLINOIS DEPARTMENT OF TRANSPORTATION
PLAN SHEET
TR 349 (COLUMBUS ROAD)
RAMP C & D
 SCALE: VERT. _____
 HORIZ. _____
 DATE 06/09/2004
 DRAWN BY JJS
 CHECKED BY LLO