

F.A.I. RTE.	SECTION	COUNTY	TOTAL SHEETS	SHEET NO.
172	*	ADAMS	108	77
STA. 24/RAMP D		TO STA.24/RAMP D		
FED. ROAD DIST. NO. 6 ILLINOIS FED. AID PROJECT				
• (1-5)RS-1; (1-6)RS				
<b>CONTRACT NO. 72694</b>				

CURVE RAMP D  
P.I. STA= 4+70.55  
Δ= 46°28'44" (LT)  
D= 9°32'58"  
R= 600.00'  
T= 257.65'  
L= 486.73'  
E= 52.98'  
EX & PR SE= 8.00%  
T.R.= 44.4'  
S.E. RUN= 236.80'  
P.C. STA= 2+12.90  
P.T. STA= 6+99.62  
SE TRANS.:  
STA 0+79.52 TO STA 2+91.83  
STA 5+82.82 TO STA 8+19.62

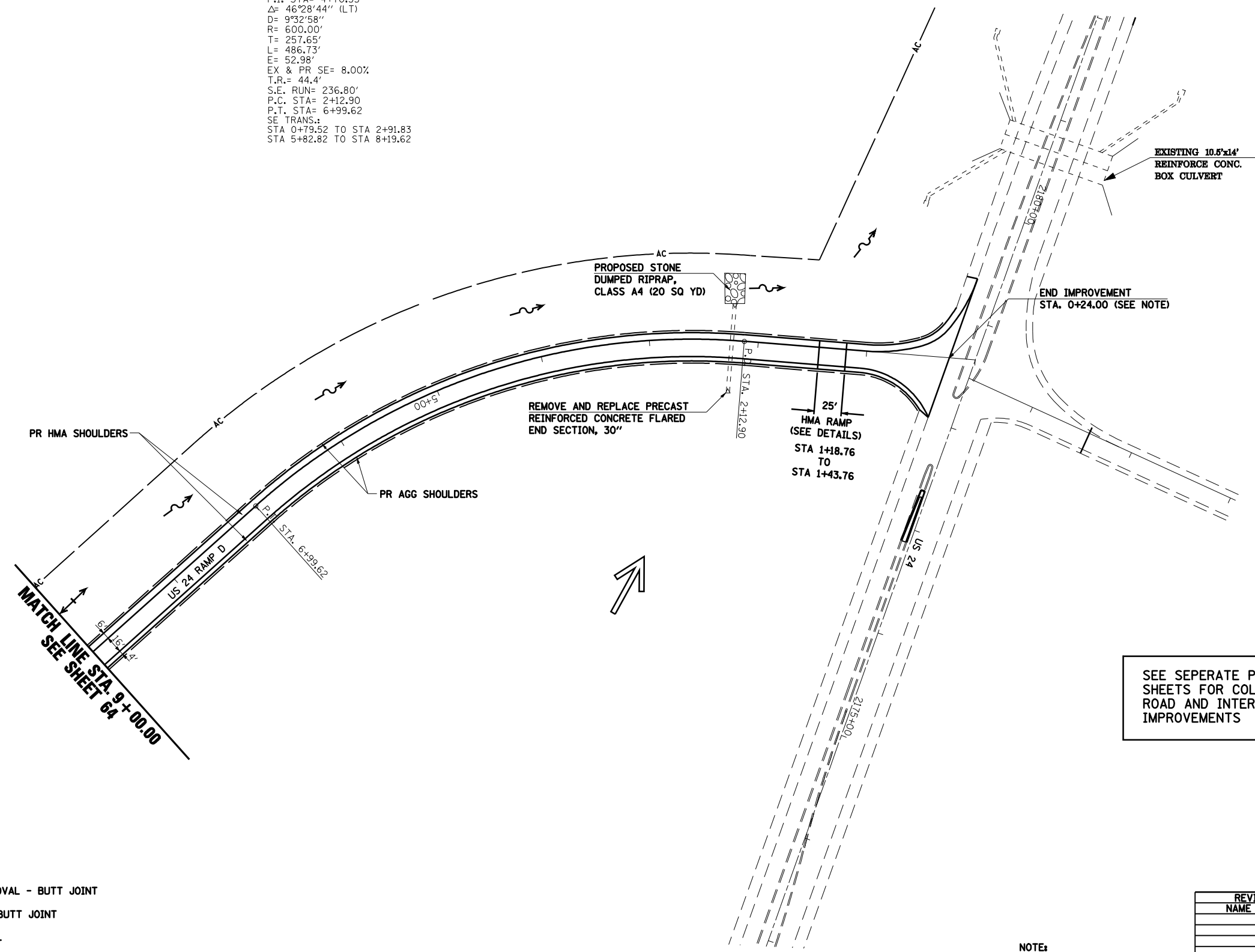

SEE SEPERATE PLAN SHEETS FOR COLUMBUS ROAD AND INTERSECTION IMPROVEMENTS

- TEMPORARY EASEMENT
- BOLLARD
- ▨ BITUMINOUS SURFACE REMOVAL - BUTT JOINT
- ▩ PCC SURFACE REMOVAL - BUTT JOINT
- ▧ EROSION CONTROL BLANKET
- ⚡ TEMPORARY DITCH CHECK (AGG. EROS. CONTROL)
- ~ DITCH FLOW LINE

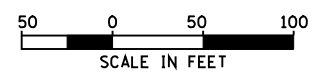

REVISIONS	
NAME	DATE

NOTE:  
SEE INTERCHANGE DETAILS (I-172 & U.S. 24 RAMP D) FOR WIDENING AND HMA BUTT JOINT REMOVAL AT INTERSECTION

ILLINOIS DEPARTMENT OF TRANSPORTATION

**PLAN SHEET  
US 24 RAMP D**

SCALE: VERT. \_\_\_\_\_  
HORIZ. \_\_\_\_\_  
DATE 06/11/2004

DRAWN BY JJS  
CHECKED BY LLQ