

F.A.I. RTE.	SECTION	COUNTY	TOTAL SHEETS	SHEET NO.
172	•	ADAMS	108	83
STA.		TO STA.		
FED. ROAD DIST. NO. 6 ILLINOIS		FED. AID PROJECT		
• (1-5)RS-1; (1-6)RS				
CONTRACT NO. 72694				

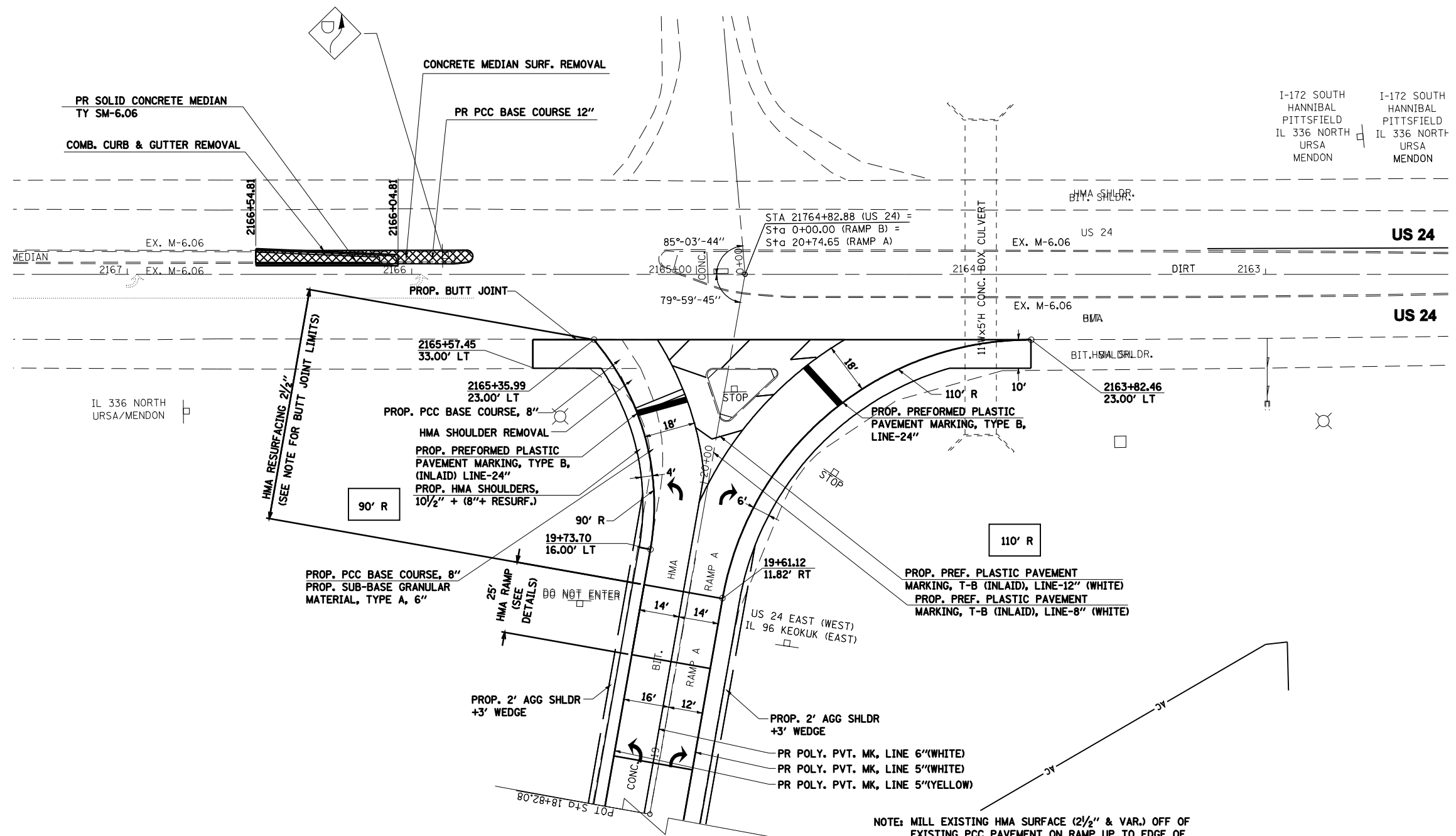

I-172 SOUTH HANNIBAL PITTSFIELD IL 336 NORTH URSA MENDON
 I-172 SOUTH HANNIBAL PITTSFIELD IL 336 NORTH URSA MENDON

IL 336 NORTH URSA/MENDON

NOTE: MILL EXISTING HMA SURFACE (2 1/2" & VAR.) OFF OF EXISTING PCC PAVEMENT ON RAMP UP TO EDGE OF PAVEMENT ON US 24.

RESURFACE (1" LEVEL BINDER & 1 1/2" SURFACE) FROM EDGE OF PAVEMENT ON US 24 TO START OF HMA RAMP. ESTIMATED QUANTITY FOR HMA BUTT JOINT = 785 SQ YD

SUB-BASE GRANULAR MATERIAL, TYPE A, 6", SHALL BE PLACED UNDER PROP. PCC BASE COURSE, 8", AND UNDER PROP. BITUMINOUS SHOULDERS, SUPERPAVE, 10 1/2"

ELEVATIONS ALONG THE RADII WHERE THE RAMP ARE TO BE WIDENED SHALL BE DETERMINED IN THE FIELD BY THE ENGINEER

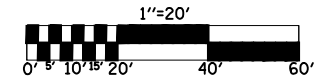

REVISIONS	
NAME	DATE

ILLINOIS DEPARTMENT OF TRANSPORTATION
INTERCHANGE DETAILS
I-172 & US 24 RAMP A
 SCALE: VERT. HORIZ. DATE 08/03/2004
 DRAWN BY LLO
 CHECKED BY LEL

ct:\p\work\PI\DOT\LAUGH\INRL\dms26563\083-084 PROPOSED_US24 Interchange Plans_IDOT_REV.dgn
 Feb-11-2009 12:48:55PM
 *REF01