

F.A.I. RTE.	SECTION	COUNTY	TOTAL SHEETS	SHEET NO.
172	**	ADAMS	108	89

STA. TO STA.
 FED. ROAD DIST. NO. ILLINOIS FED. AID PROJECT

** (1-5)RS-1; (1-6)RS
 CONTRACT NO. 72694

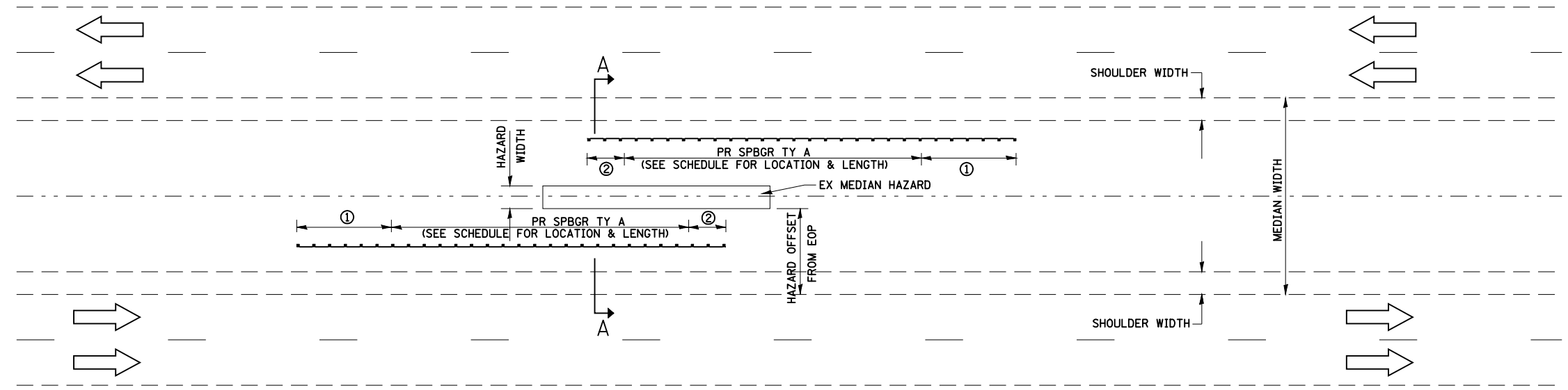

DETAIL "B"

(PROPOSED PROTECTION OF MEDIAN HAZARD WITH PROPOSED GUARDRAIL)

- ① PR TRAFFIC BARRIER TERMINAL, TYPE 1, SPECIAL (TANGENT)
- ② PR TRAFFIC BARRIER TERMINAL, TYPE 2

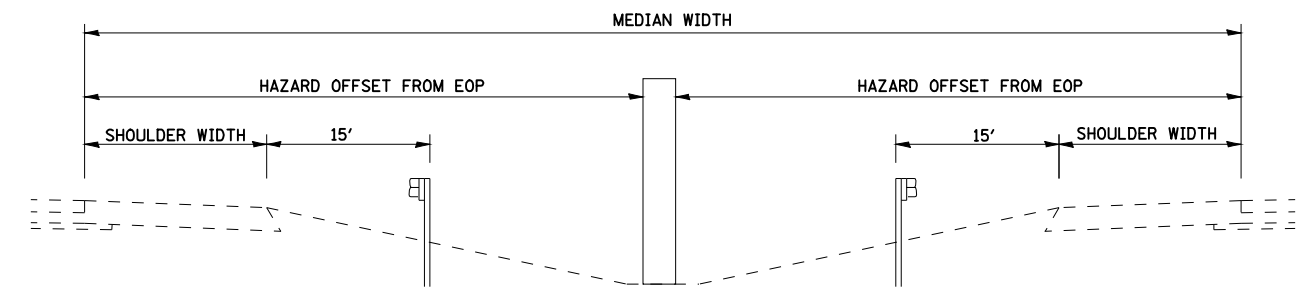

SECTION A-A
 (TYPICAL CROSS SECTION)

REVISIONS	
NAME	DATE

ILLINOIS DEPARTMENT OF TRANSPORTATION
 GUARDRAIL LAYOUT FOR
 MEDIAN PIERS
 DETAIL "B"