

STAGE I

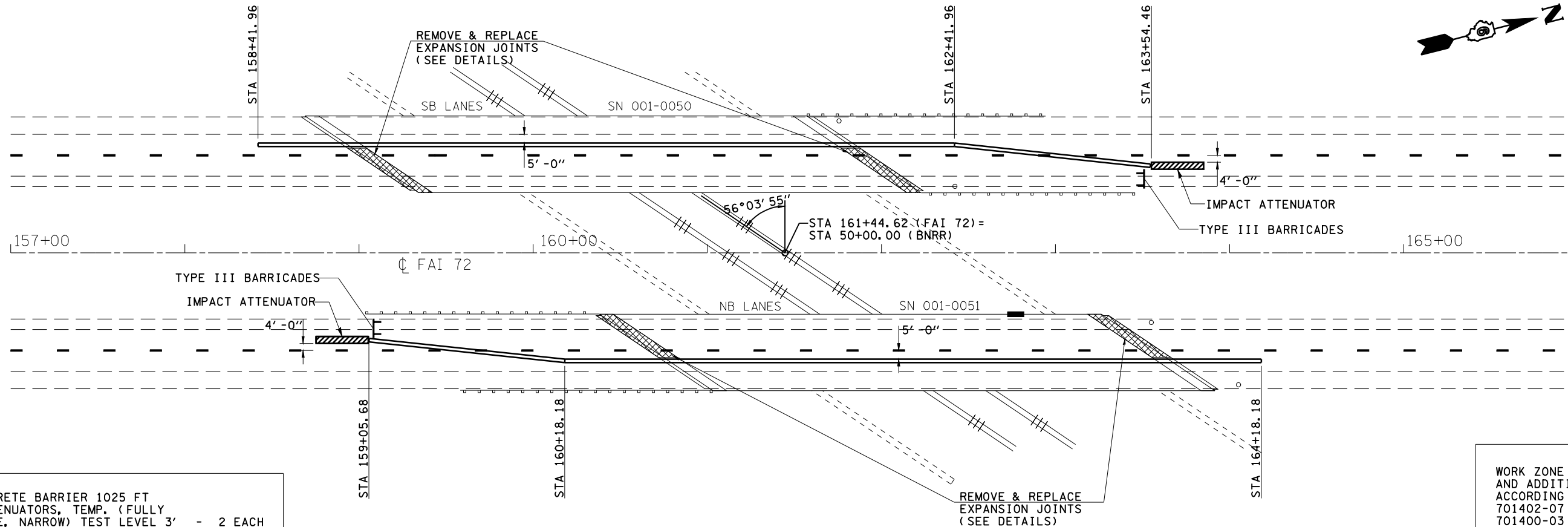

TEMP. CONCRETE BARRIER 1025 FT
IMPACT ATTENUATORS, TEMP. (FULLY
REDIRECTIVE, NARROW) TEST LEVEL 3' - 2 EACH

WORK ZONE PAVEMENT MARKING
AND ADDITIONAL TRAFFIC CONTROL
ACCORDING TO STANDARD
701402-07
701400-03

STAGE II

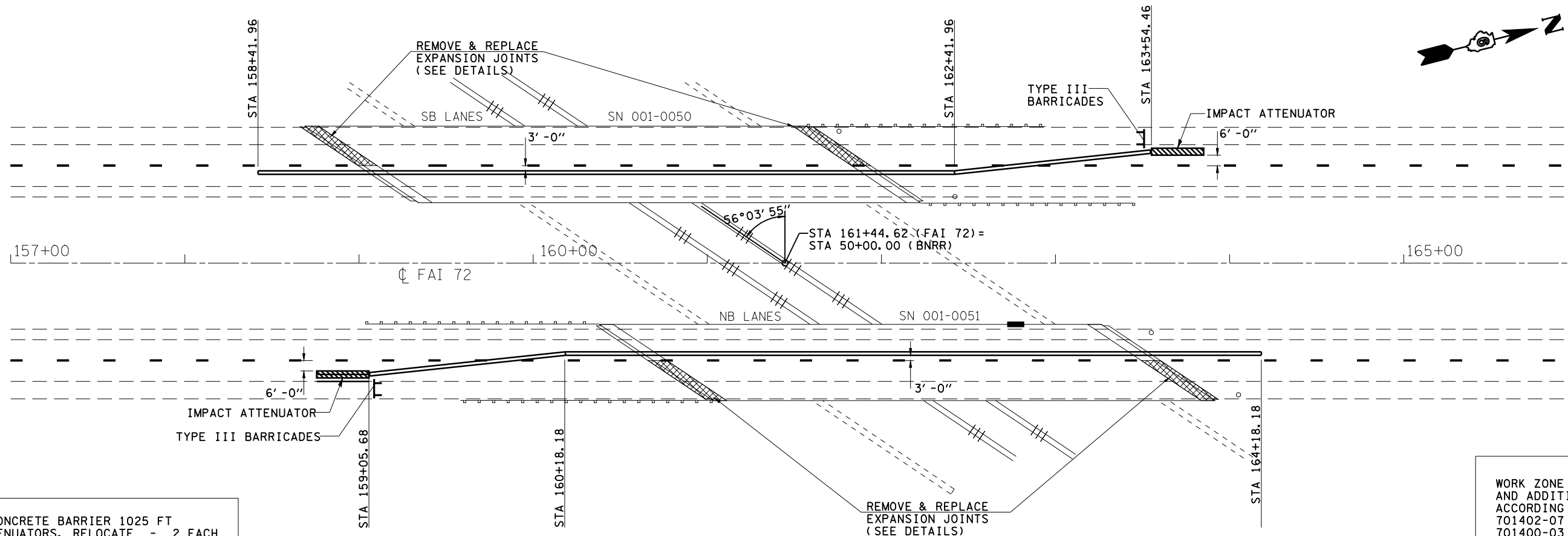

RELOCATE CONCRETE BARRIER 1025 FT
IMPACT ATTENUATORS, RELOCATE - 2 EACH

WORK ZONE PAVEMENT MARKING
AND ADDITIONAL TRAFFIC CONTROL
ACCORDING TO STANDARD
701402-07
701400-03

FILE NAME =	USER NAME = laughlinr1	DESIGNED -	REVISED -
et:\pwork\PWIDOT\LAUGHLINRL\dms26563\108A Temp Barrier Wall Detail SN001-0050-SN001-0051-DRAWN.DGN		DRAWN -	REVISED -
PLOT SCALE = 100.0000' / IN.		CHECKED -	REVISED -
PLOT DATE = Feb-11-2009 12:50:05PM		DATE -	REVISED -

STATE OF ILLINOIS
DEPARTMENT OF TRANSPORTATION

TEMPORARY BARRIER WALL DETAIL
STA 161 + 44.62(FAI 72), STA 50 + 00.00(BNRR)
SN001-0050(SB), SN001-0051(NB)

SCALE: SHEET NO. OF SHEETS STA. TO STA.

F.A.I. RTE.	SECTION	COUNTY	TOTAL SHEETS	SHEET NO.
172	(1-5)RS-1; (1-6)RS	ADAMS	108	108A
CONTRACT NO. 72694				
ILLINOIS FED. AID PROJECT				