

F.A.P. RTE.	SECTION	COUNTY	TOTAL SHEETS	SHEET NO.
310	•	CASS	33	11
STA. 55+00		TO STA. 84+00		
FED. ROAD DIST. NO.		ILLINOIS	FED. AID PROJECT	
• 114(RS-3); 115(RS-3)				72830

EXIST. CURVE CUR1
 PI STA. = 66+41.30
 $\Delta = 22^\circ 51' 47''$ (RT)
 D = 3° 59' 57"
 R = 1,432.70'
 T = 289.70'
 L = 571.70'
 E = 29.00'
 $e = 6.0\%$
 T.R. = 39.80'
 S.E. RUN = 159.00'
 P.C. STA. = 63+51.60
 P.T. STA. = 69+23.30

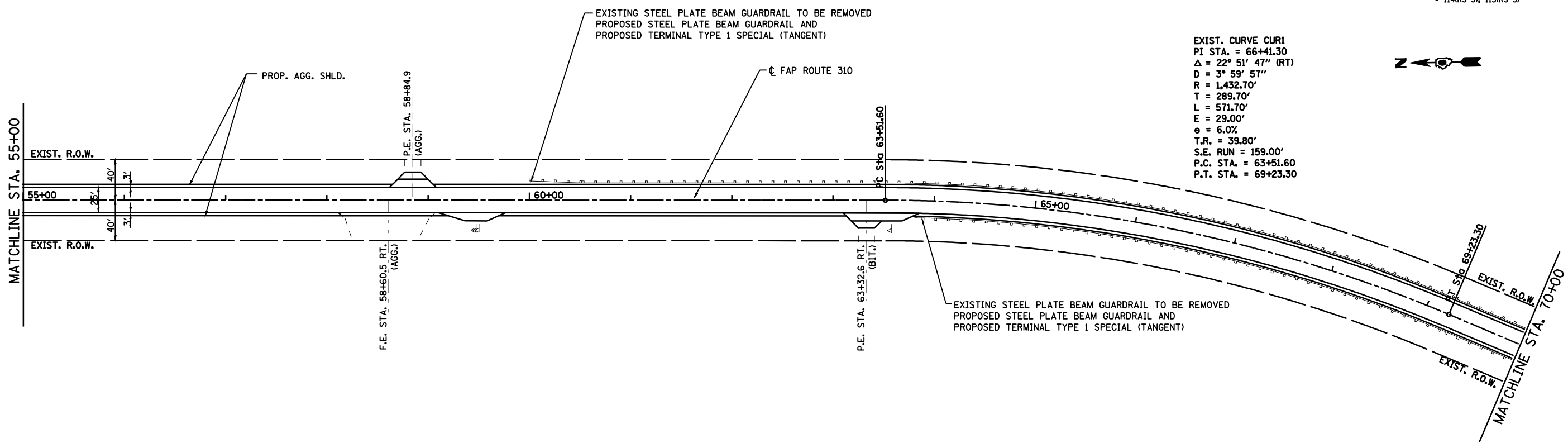

EXIST. CURVE CUR2
 PI STA. = 77+41.70
 $\Delta = 24^\circ 22' 56''$ (RT)
 D = 2° 59' 59"
 R = 1,910.00'
 T = 412.65'
 L = 812.80'
 E = 44.07'
 $e = 5.5\%$
 T.R. = 39.90'
 S.E. RUN = 146.30'
 P.C. STA. = 73+29.05
 P.T. STA. = 81+41.85

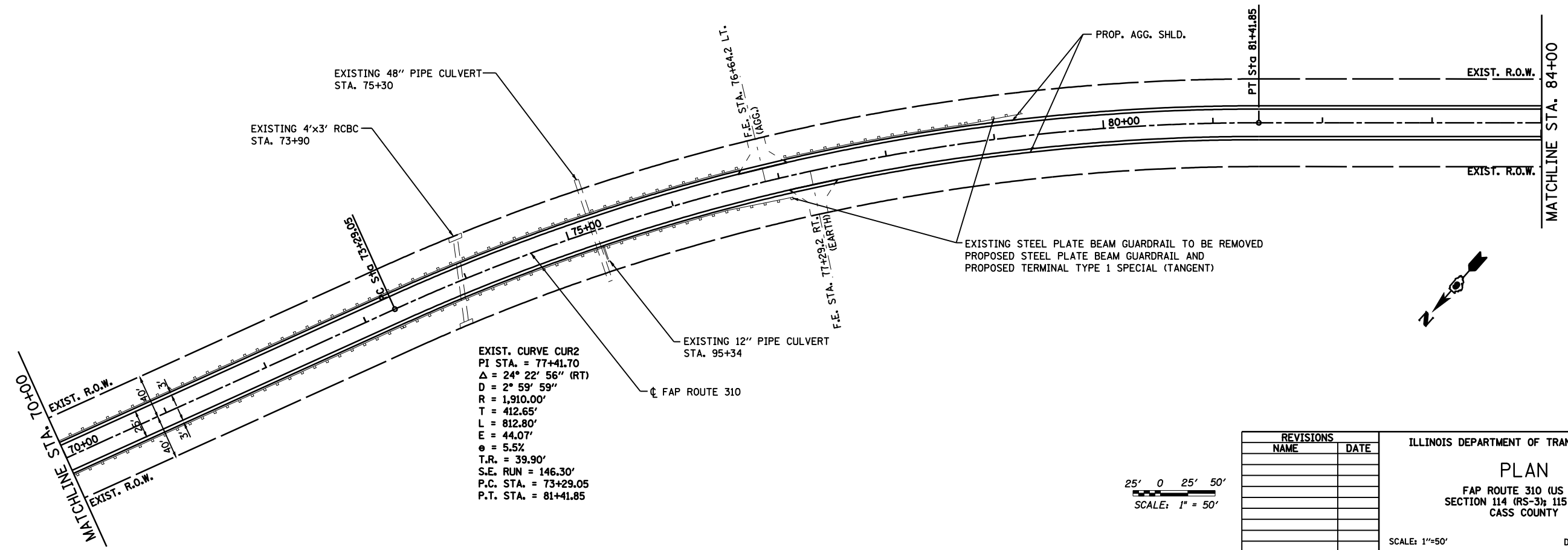

25' 0 25' 50'
 SCALE: 1" = 50'

REVISIONS	
NAME	DATE

ILLINOIS DEPARTMENT OF TRANSPORTATION
PLAN
 FAP ROUTE 310 (US 67)
 SECTION 114 (RS-3); 115 (RS-3)
 CASS COUNTY
 SCALE: 1"=50'
 DATE: 11/2003
 DRAWN BY: FCX
 CHECKED BY: FML