

F.A.P. RTE.	SECTION	COUNTY	TOTAL SHEETS	SHEET NO.
310	•	CASS	33	13
STA. 113+00	TO STA. 141+00			
FED. ROAD DIST. NO.	ILLINOIS	FED. AID PROJECT		
• 114(RS-3); 115(RS-3)			72830	

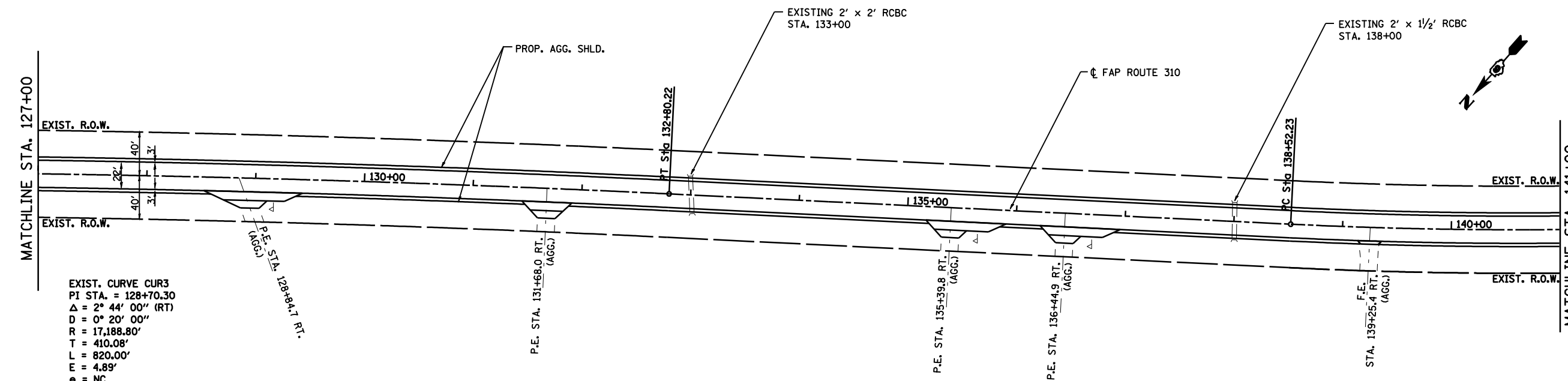
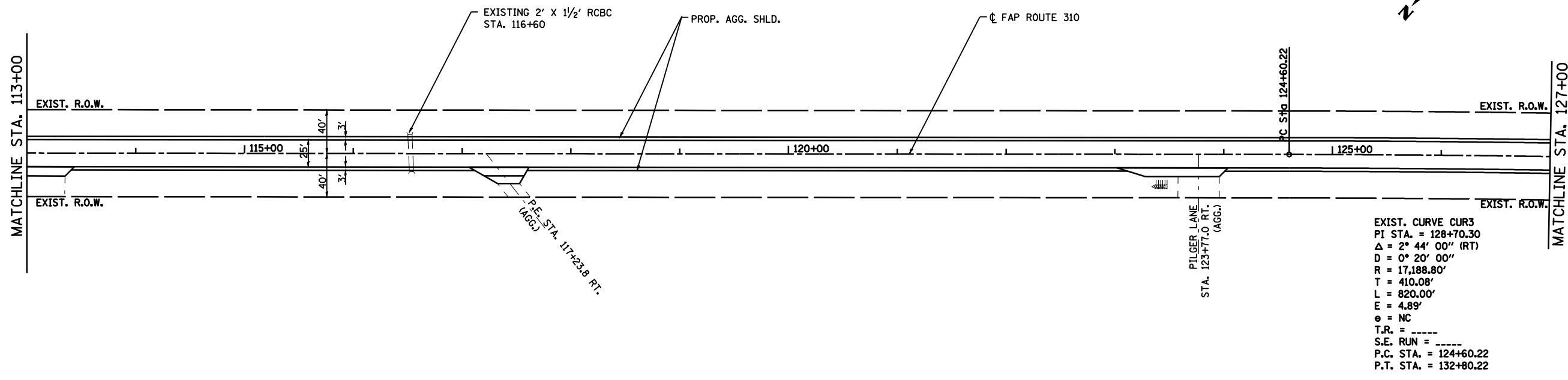

EXIST. CURVE CUR3
 PI STA. = 128+70.30
 Δ = 2° 44' 00'' (RT)
 D = 0° 20' 00''
 R = 17,188.80'
 T = 410.08'
 L = 820.00'
 E = 4.89'
 e = NC
 T.R. = ----
 S.E. RUN = ----
 P.C. STA. = 124+60.22
 P.T. STA. = 132+80.22

EXIST. CURVE CUR4
 PI STA. = 143+31.20
 Δ = 12° 43' 11'' (LT)
 D = 1° 20' 00''
 R = 4,297.30'
 T = 478.97'
 L = 954.00'
 E = 26.61'
 e = 3.4%
 T.R. = 40.30'
 S.E. RUN = 91.20'
 P.C. STA. = 138+52.23
 P.T. STA. = 148+06.23

25' 0 25' 50'
 SCALE: 1" = 50'

REVISIONS	
NAME	DATE

ILLINOIS DEPARTMENT OF TRANSPORTATION
PLAN
 FAP ROUTE 310 (US 67)
 SECTION 114 (RS-3); 115 (RS-3)
 CASS COUNTY
 SCALE: 1"=50'
 DATE: 11/2003
 DRAWN BY: FCX
 CHECKED BY: FML