

F.A.P. RTE.	SECTION	COUNTY	TOTAL SHEETS	SHEET NO.
310	•	CASS	33	14
STA. 141+00		TO STA. 170+00		
FED. ROAD DIST. NO. 114(RS-3)		ILLINOIS FED. AID PROJECT		
• 114(RS-3); 115(RS-3)				72830

EXIST. CURVE CUR4
 PI STA. = 143+31.20
 $\Delta = 12^\circ 43' 11''$ (LT)
 $D = 1^\circ 20' 00''$
 $R = 4,297.30'$
 $T = 478.97'$
 $L = 954.00'$
 $E = 26.61'$
 $e = 3.4\%$
 $T.R. = 40.30'$
 $S.E. RUN = 91.20'$
 $P.C. STA. = 138+52.23$
 $P.T. STA. = 148+06.23$

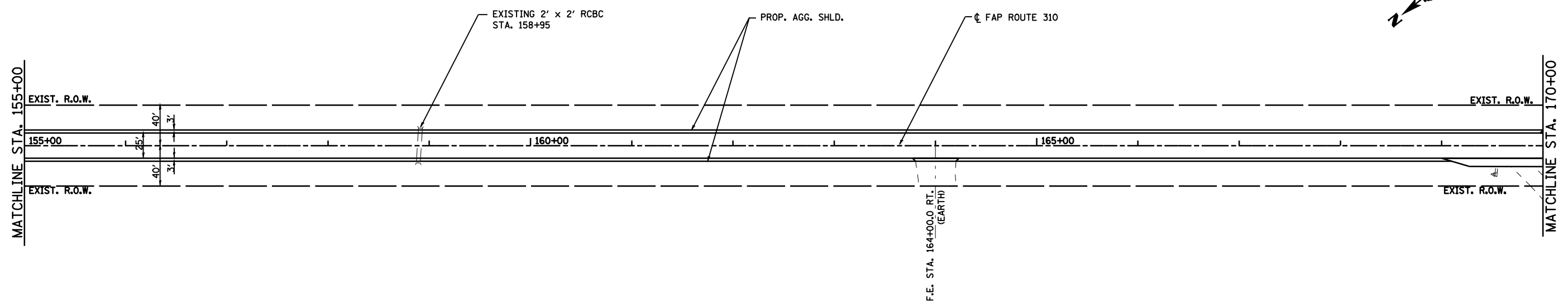
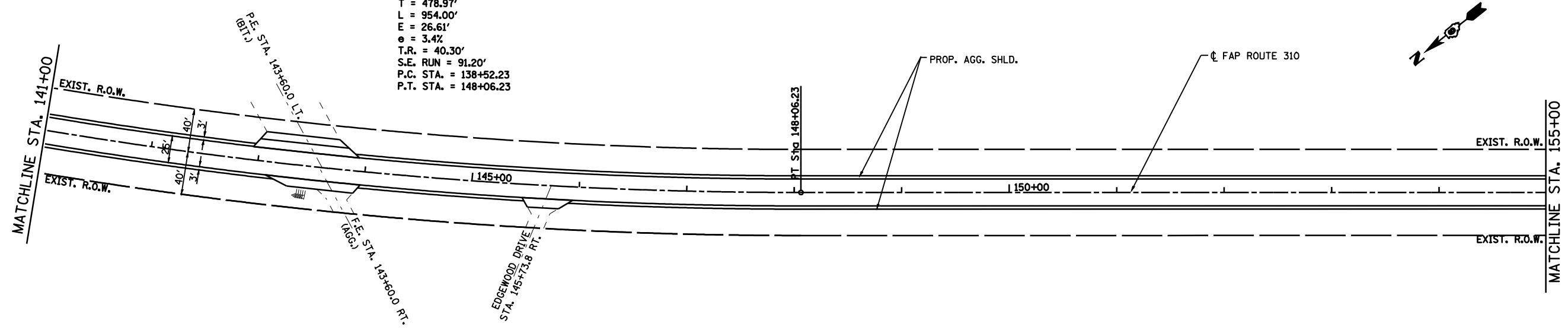

25' 0 25' 50'
 SCALE: 1" = 50'

REVISIONS	
NAME	DATE

ILLINOIS DEPARTMENT OF TRANSPORTATION
PLAN
 FAP ROUTE 310 (US 67)
 SECTION 114 (RS-3); 115 (RS-3)
 CASS COUNTY
 SCALE: 1"=50'
 DATE: 11/2003
 DRAWN BY: FCX
 CHECKED BY: FML