

F.A.P. RTE.	SECTION	COUNTY	TOTAL SHEETS	SHEET NO.
310	•	CASS	33	16
STA. 198+00		TO STA. 226+00		
FED. ROAD DIST. NO. ILLINOIS FED. AID PROJECT				
• 114(RS-3); 115(RS-3)				72830

EXIST. CURVE CUR5
 PI STA. = 202+02.20
 $\Delta = 5^{\circ} 15' 00''$ (RT)
 $D = 0^{\circ} 30' 00''$
 $R = 11,459.20'$
 $T = 525.37'$
 $L = 1,050.00'$
 $E = 12.04'$
 $e = NC$
 $T.R. = \text{-----}$
 $S.E. RUN = \text{-----}$
 $P.C. STA. = 196+76.84$
 $P.T. STA. = 207+26.84$

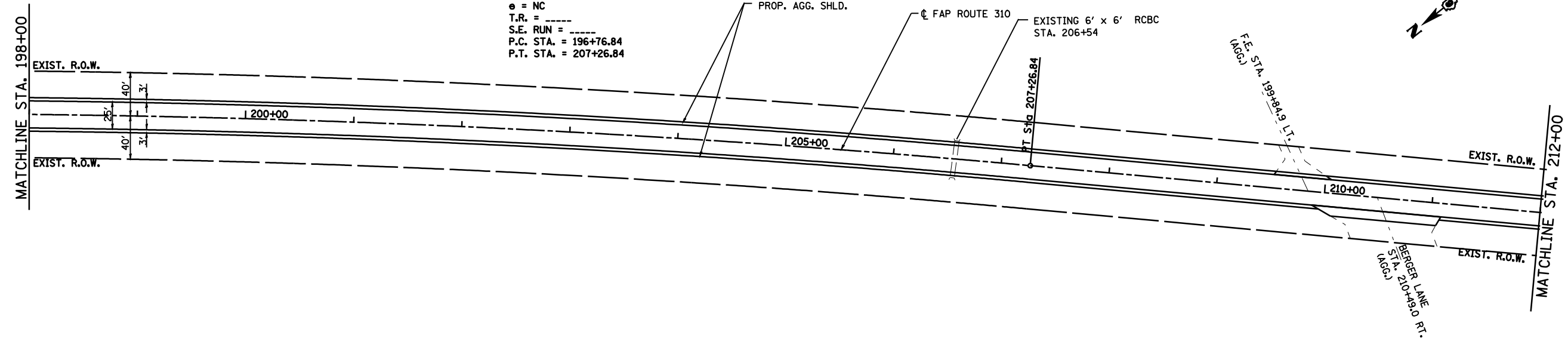

EXIST. CURVE CUR6
 PI STA. = 230+19.01
 $\Delta = 7^{\circ} 42' 58''$ (RT)
 $D = 0^{\circ} 45' 00''$
 $R = 7,639.50'$
 $T = 515.20'$ $L = 1,028.84'$
 $E = 17.35'$
 $e = 1.7\%$
 $T.R. = 39.90'$
 $S.E. RUN = 45.20'$
 $P.C. STA. = 225+03.81$
 $P.T. STA. = 235+32.65$

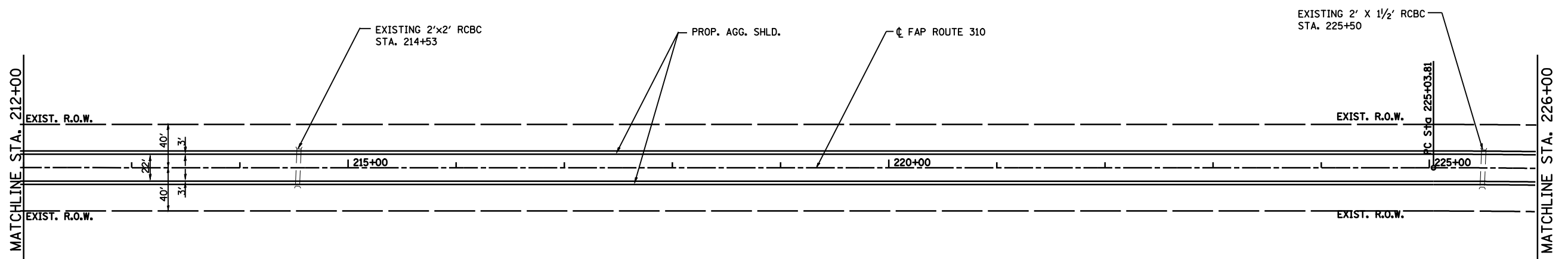

25' 0 25' 50'
 SCALE: 1" = 50'

REVISIONS	
NAME	DATE

ILLINOIS DEPARTMENT OF TRANSPORTATION
PLAN
 FAP ROUTE 310 (US 67)
 SECTION 114 (RS-3); 115 (RS-3)
 CASS COUNTY
 SCALE: 1"=50'
 DATE: 11/2003
 DRAWN BY: FCX
 CHECKED BY: FML