

F.A.P. RTE.	SECTION	COUNTY	TOTAL SHEETS	SHEET NO.
310	•	CASS	33	18
STA. 254+00	TO STA. 283+00			
FED. ROAD DIST. NO.	ILLINOIS	FED. AID PROJECT		
• 114(RS-3); 115(RS-3)			72830	

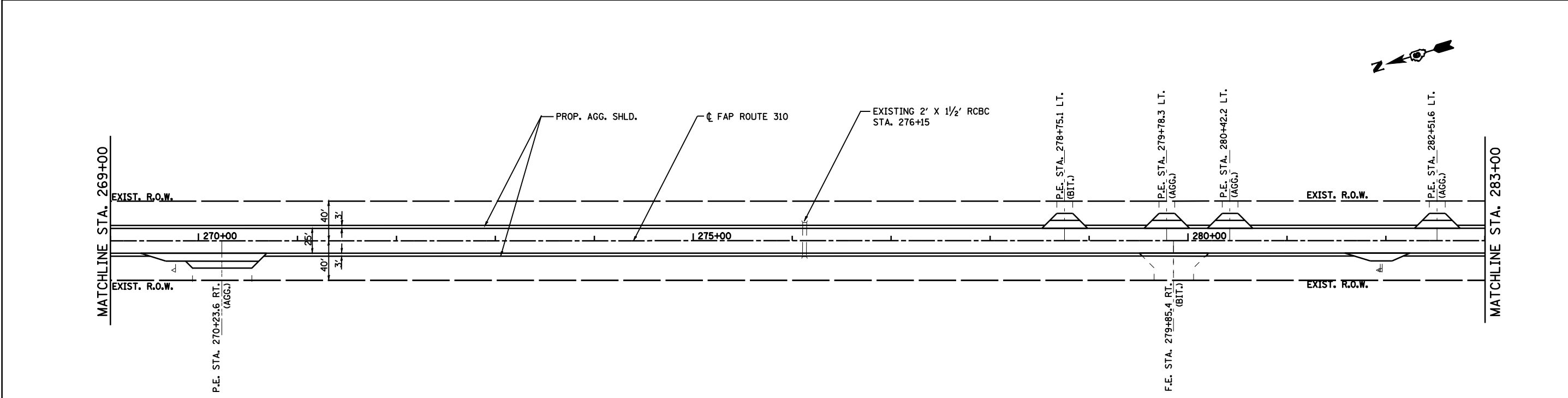
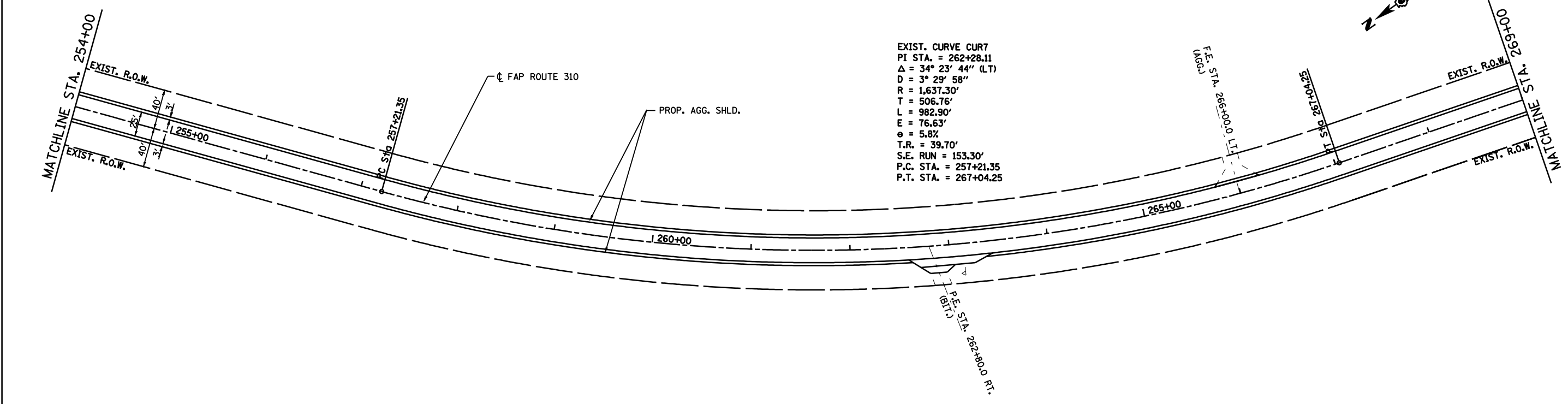

25' 0 25' 50'
SCALE: 1" = 50'

REVISIONS	
NAME	DATE

ILLINOIS DEPARTMENT OF TRANSPORTATION
PLAN
 FAP ROUTE 310 (US 67)
 SECTION 114 (RS-3); 115 (RS-3)
 CASS COUNTY
 SCALE: 1"=50'
 DATE: 11/2003
 DRAWN BY: FCX
 CHECKED BY: FML