

F.A.P. RTE.	SECTION	COUNTY	TOTAL SHEETS	SHEET NO.
781	2ZRS-1	CRAWFORD	191	55
STA. 1+225		TO STA. 1+575		
FED. ROAD DIST. NO.		ILLINOIS	FED. AID PROJECT	

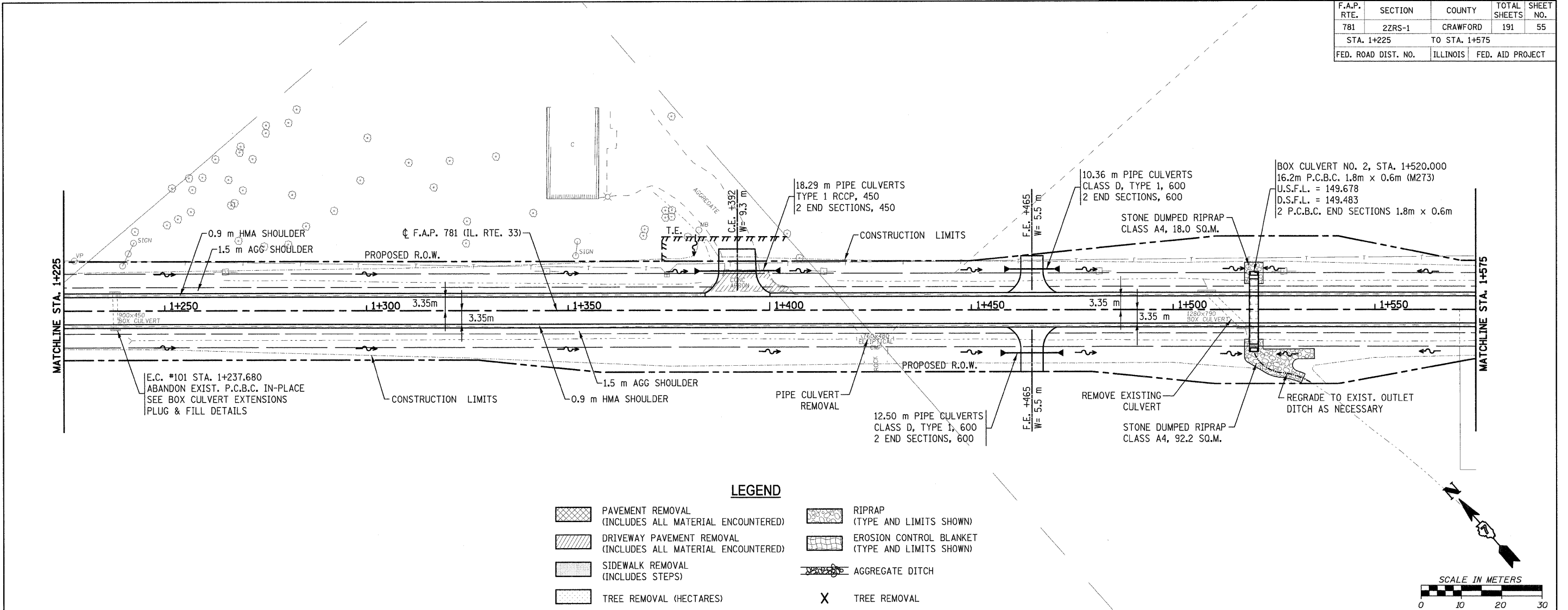

**LEGEND**

- PAVEMENT REMOVAL (INCLUDES ALL MATERIAL ENCOUNTERED)
- DRIVEWAY PAVEMENT REMOVAL (INCLUDES ALL MATERIAL ENCOUNTERED)
- SIDEWALK REMOVAL (INCLUDES STEPS)
- TREE REMOVAL (HECTARES)
- RIPRAP (TYPE AND LIMITS SHOWN)
- EROSION CONTROL BLANKET (TYPE AND LIMITS SHOWN)
- AGGREGATE DITCH
- TREE REMOVAL

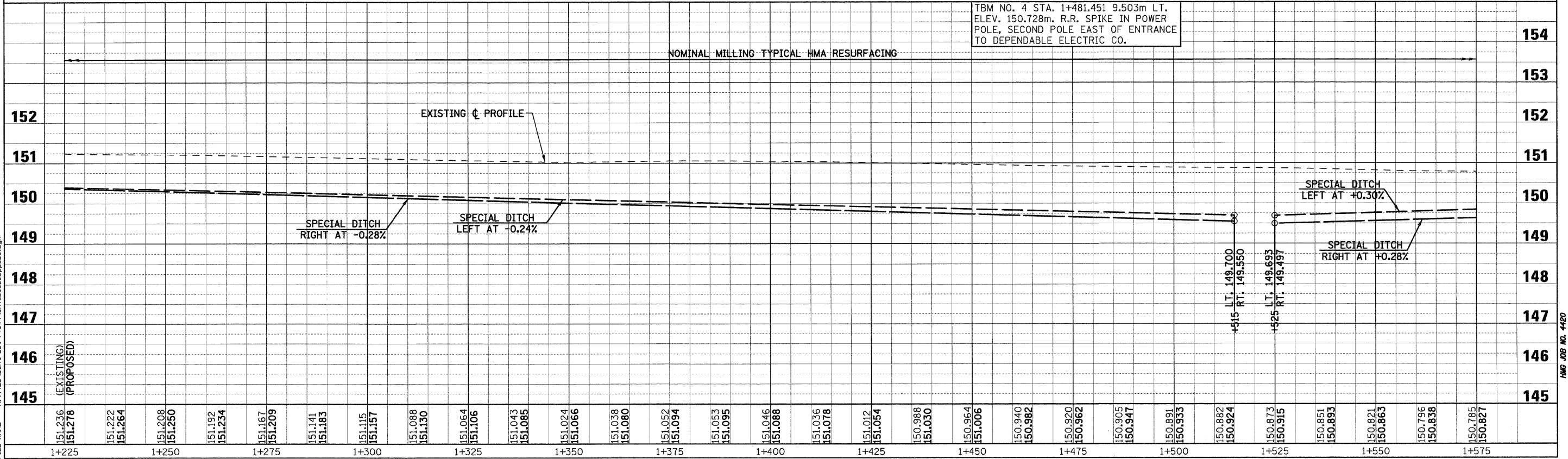

PLOT DATE = 2/5/2009  
 FILE NAME = H:\4428\Contract 74349\SH1\_095\_50ppa\_05.dgn