

| F.A.P. RTE. | SECTION | COUNTY | TOTAL SHEETS | SHEET NO. |
|---------------------|----------|------------------|--------------|-----------|
| 781 | 2ZRS-1 | CRAWFORD | 191 | 83 |
| STA. 4+025 | | TO STA. 4+200 | | |
| FED. ROAD DIST. NO. | ILLINOIS | FED. AID PROJECT | | |

- | | | | |
|--|---|---|---|
| P500 STORM SEWER, CL.A, TY.1, 300 8.496m @ 0.50% | P505 STORM SEWER, CL.A, TY.1, 300 8.496m @ 0.50% | P510 STORM SEWER, CL.A, TY.1, 300 6.981m @ 0.50% | T50 REINFORCED CONC. PIPE TEE 450 PIPE WITH 300 RISER |
| P501 STORM SEWER, CL.A, TY.1, 300 0.923m @ 0.50% | P506 STORM SEWER, CL.A, TY.1, 300 1.498m @ 2.00% | P511 STORM SEWER, CL.A, TY.1, 300 8.806m @ 0.50% | T51 REINFORCED CONC. PIPE TEE 450 PIPE WITH 300 RISER |
| P502 STORM SEWER, CL.A, TY.1, 450 108.763m @ 0.40% | P507 STORM SEWER, CL.A, TY.1, 300 1.065m @ 1.00% | P512 STORM SEWER, CL.A, TY.1, 600 60.815m @ 1.00% | T52 REINFORCED CONC. PIPE TEE 600 PIPE WITH 300 RISER |
| P503 STORM SEWER, CL.A, TY.1, 300 8.496m @ 0.50% | P508 STORM SEWER, CL.A, TY.1, 450 16.466m @ 0.40% | P513 STORM SEWER, CL.A, TY.1, 300 8.496m @ 0.50% | |
| P504 STORM SEWER, CL.A, TY.1, 300 1.498m @ 2.00% | P509 STORM SEWER, CL.A, TY.1, 300 9.610m @ 0.50% | P514 STORM SEWER, CL.A, TY.1, 300 1.498m @ 2.00% | |

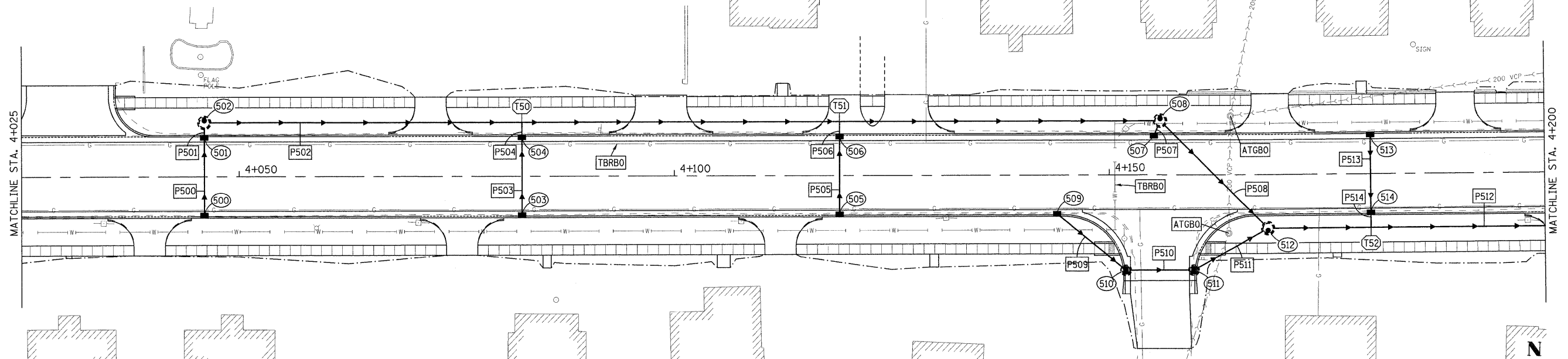

- | | | | | |
|---|--|---|--|--|
| 500 INLET TY.A, TY.3 F&G STA. 4+046.000, 4.475m RT. GRATE 153.386 INV. 152.400 | 503 INLET TY.A, TY.3 F&G STA. 4+082.500, 4.475m RT. GRATE 153.284 INV. 152.206 | 506 INLET TY.A, TY.3 F&G STA. 4+119.000, 4.475m LT. GRATE 153.182 INV. 152.017 | 509 INLET TY.A, TY.3 F&G STA. 4+144.000, 4.475m RT. GRATE 153.094 INV. 151.979 | 512 MH. TY.A, RESTRICTED DEPTH 1.2m DIA., TY.1 FRAME, CL. LID STA. 4+168.233, 6.200m RT. SEE DETAIL FOR FRAME OFFSET TOP 153.096 INV.(NW) 151.700 INV.(E) 151.547 INV.(SW) 151.852 |
| 501 INLET TY.A, TY.3 F&G STA. 4+046.000, 4.475m LT. GRATE 153.386 INV. 152.358 | 504 INLET TY.A, TY.3 F&G STA. 4+082.500, 4.475m LT. GRATE 153.284 INV. 152.163 | 507 INLET TY.A, TY.3 F&G STA. 4+155.118, 4.475m LT. GRATE 153.024 INV. 151.928 | 510 INLET TY.B, RESTRICTED DEPTH 0.9m DIA., TY.3 F&G STA. 4+151.900, 11.000m RT. GRATE 152.887 INV.(NW,E) 151.931 | 513 INLET TY.A, TY.3 F&G STA. 4+180.000, 4.475m LT. GRATE 152.795 INV. 151.658 |
| 502 MH. TY.A, RESTRICTED DEPTH 1.2m DIA., TY.1 FRAME, CL. LID STA. 4+046.000, 6.200m LT. SEE DETAIL FOR FRAME OFFSET TOP 153.570 INV.(E) 152.201 INV.(S) 152.353 | 505 INLET TY.A, TY.3 F&G STA. 4+119.000, 4.475m RT. GRATE 153.182 INV. 152.060 | 508 MH. TY.A, RESTRICTED DEPTH 1.2m DIA., TY.1 FRAME, CL. LID STA. 4+155.833, 6.200m LT. SEE DETAIL FOR FRAME OFFSET TOP 153.235 INV.(W,SE) 151.765 INV.(SW) 151.917 | 511 INLET TY.B, RESTRICTED DEPTH 0.9m DIA., TY.3 F&G STA. 4+159.700, 11.000m RT. GRATE 152.885 INV.(W,NE) 151.896 | 514 INLET TY.A, TY.3 F&G STA. 4+180.000, 4.475m RT. GRATE 152.795 INV. 151.616 |

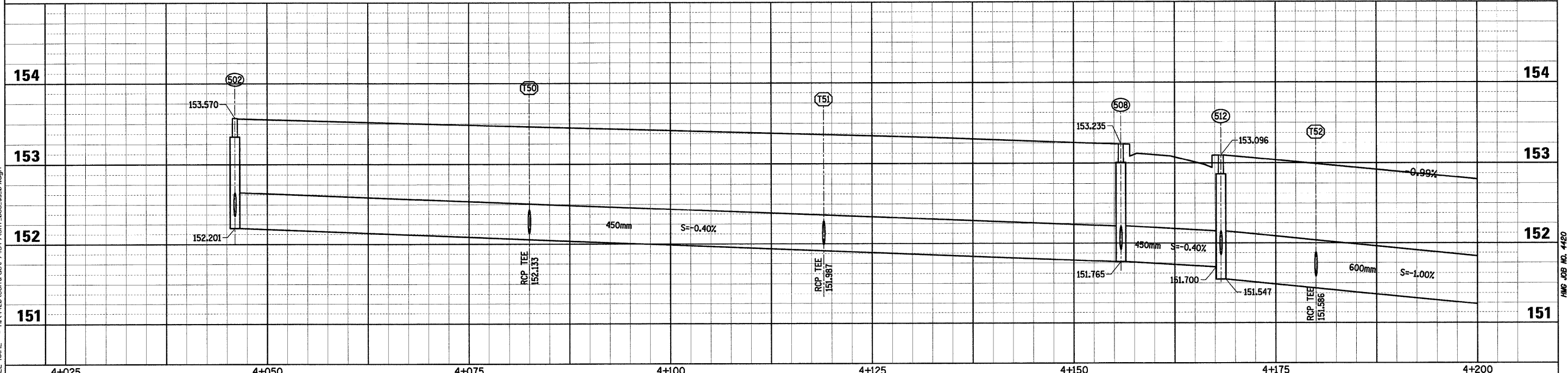
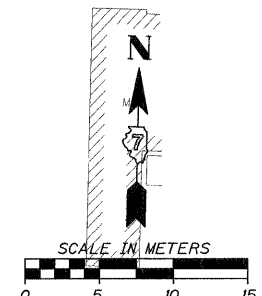

PLOT DATE = 2/5/2009
FILE NAME = H:\V4420\Contract 74349\SH1_083.as.dwg

Sheet: 9
Angle: 1.3348
Chain: P_IL33

HMG JOB NO. 4420