

EXIST. CURVE CURV32
 PI STA. = 41+95.85
 $\Delta = 90^\circ 34' 51''$ (RT)
 D = 5° 42' 01"
 R = 1,005.13'
 T = 1,015.38'
 L = 1,589.05'
 E = 423.60'
 e = -----
 T.R. = -----
 S.E. RUN = -----
 P.C. STA. = 31+80.47
 P.T. STA. = 47+69.52

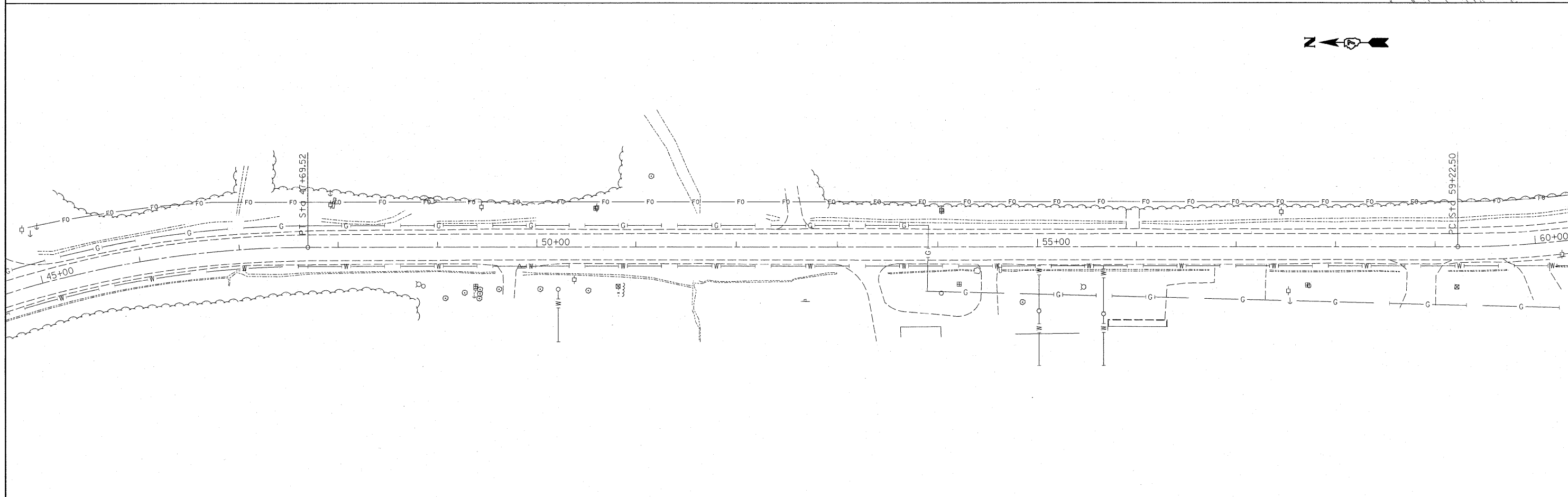

FILE NAME =	USER NAME = steffenmk	DESIGNED -	REVISED -	STATE OF ILLINOIS DEPARTMENT OF TRANSPORTATION	PLAN SHEETS			F.A.P. RTE. 773	SECTION .	COUNTY Cumberland	TOTAL SHEETS 26	SHEET NO. 19
er:\pw_work\PWIDOT\STEFFEN\MK\d0123229\074379-sh-t-plan.dgn		DRAWN -	REVISED -		SCALE: 1"=50'	SHEET NO. 2 OF 9 SHEETS	STA. 30+00	TO STA. 60+00	CONTRACT NO. 74379			
PLOT SCALE = 50.0000' / IN.		CHECKED -	REVISED -		ILLINOIS FED. AID PROJECT							
PLOT DATE = 2/6/2009		DATE -	REVISED -		#110RS-1,(111,111)RS-2,F-ZRS-1							