

F.A.P. RTE.	SECTION	COUNTY	TOTAL SHEETS	SHEET NO.
711	116RS-3	VERMILION	51	1
FED. ROAD DIST. NO.		ILLINOIS	CONTRACT NO. 90914	

STATE OF ILLINOIS
DEPARTMENT OF TRANSPORTATION
DIVISION OF HIGHWAYS

PROPOSED HIGHWAY PLANS

F.A.P. ROUTE 711 (ILL 119)
SECTION 116RS-3
VERMILION COUNTY
RESURFACING (3P)
ILL I TO INDIANA STATE LINE

C-95-005-98

PROJECT ESP-0711(010)

FOR INDEX OF SHEETS, SEE SHEET NO. 2
FOR SUMMARY OF QUANTITIES, SHEE SHEET NO. 4

HMA RESURFACING (2.25'')
ON STRUCTURES

- S. N. 092-8034
- S. N. 092-8309
- S. N. 092-8310
- S. N. 092-8311
- S. N. 092-8330

D-95-005-98

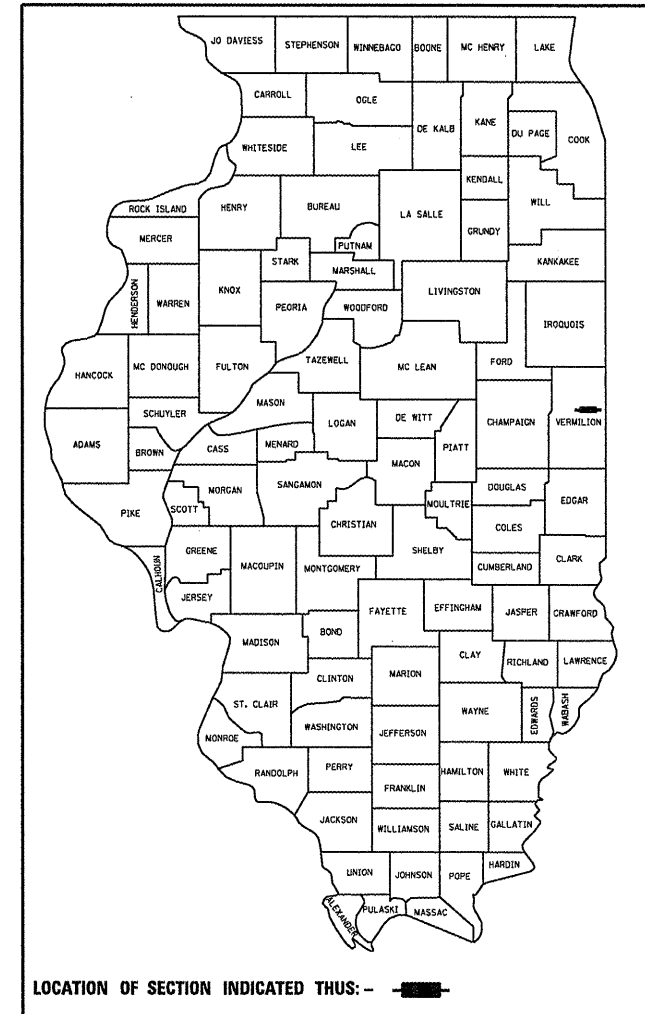

LOCATION OF SECTION INDICATED THUS: - [shaded box] -

CURRENT ADT

ILLINOIS 1 TO ALVIN	1,700	(2007)
ALVIN TO BOWMAN AVE.	2,300	(2007)
BOWMAN AVE. TO INDIANA LINE	1,000	(2007)

DESIGN DESIGNATION

MINOR ARTERIAL

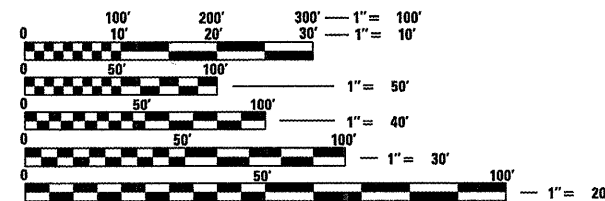

FULL SIZE PLANS HAVE BEEN PREPARED USING STANDARD ENGINEERING SCALES. REDUCED SIZED PLANS WILL NOT CONFORM TO STANDARD SCALES. IN MAKING MEASUREMENTS ON REDUCED PLANS, THE ABOVE SCALES MAY BE USED.

J.U.L.I.E.
JOINT UTILITY LOCATION INFORMATION FOR EXCAVATION
1-800-892-0123
OR 811 SOUTH ROSS TOWNSHIP

PROJECT ENGINEER: KEVIN TRAPP
SQUAD LEADER: CHRIS GREESON
DESIGNER: BILL MURPHY
(217)465-4181
CONTRACT NO. 90914

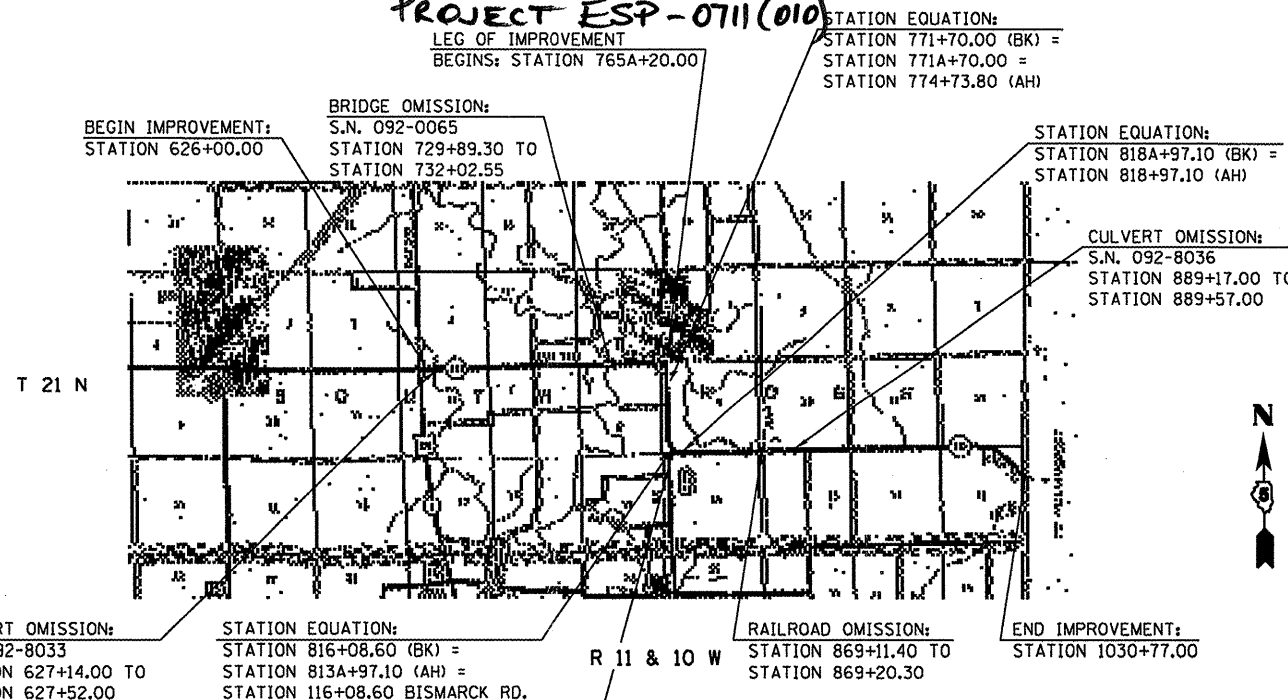

LEG OF IMPROVEMENT
BEGINS: STATION 121+64.00
BISMARCK RD.

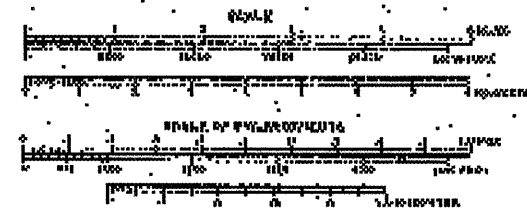

TOTAL LENGTH OF SECTION & PROJECT = 40,384.7 FEET = 7.649 MILES
NET LENGTH OF SECTION & PROJECT = 40,084.55 FEET = 7.592 MILES

STATE OF ILLINOIS
DEPARTMENT OF TRANSPORTATION
DIVISION OF HIGHWAYS

SUBMITTED 1/19 20 09
Joseph K. Gougeon
DEPUTY DIRECTOR OF HIGHWAYS, REGION ENGINEER

March 13, 2009
Charles J. Ingersoll
ENGINEER OF DESIGN AND ENVIRONMENT

March 13, 2009
Christine M. Reed
DIRECTOR OF HIGHWAYS, CHIEF ENGINEER

PRINTED BY THE AUTHORITY
OF THE STATE OF ILLINOIS