

F.A.S. RTE.	SECTION	COUNTY	TOTAL SHEETS	SHEET NO.
119T	105-T	WHITESIDE	59	12
STA. 425+38	TO STA. 429+00			
FED. ROAD DIST. NO.	ILLINOIS	FED. AID PROJECT		
CONTRACT 64421				

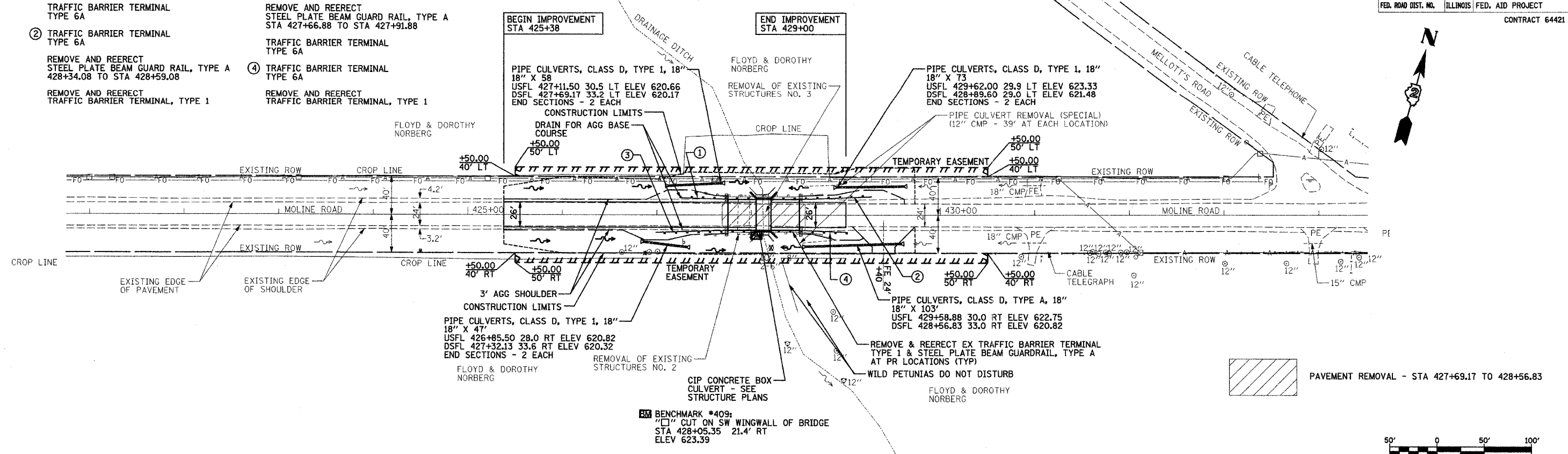

- ① REMOVE AND REERECT TRAFFIC BARRIER TERMINAL, TYPE 1  
TRAFFIC BARRIER TERMINAL TYPE 6A
- ② TRAFFIC BARRIER TERMINAL TYPE 6A  
REMOVE AND REERECT STEEL PLATE BEAM GUARD RAIL, TYPE A 428+34.08 TO STA 428+59.08  
REMOVE AND REERECT TRAFFIC BARRIER TERMINAL, TYPE 1
- ③ REMOVE AND REERECT TRAFFIC BARRIER TERMINAL, TYPE 1  
REMOVE AND REERECT STEEL PLATE BEAM GUARD RAIL, TYPE A STA 427+66.88 TO STA 427+91.88  
TRAFFIC BARRIER TERMINAL TYPE 6A
- ④ TRAFFIC BARRIER TERMINAL TYPE 6A  
REMOVE AND REERECT TRAFFIC BARRIER TERMINAL, TYPE 1



BENCHMARK \*409:  
" CUT ON SW WINGWALL OF BRIDGE  
STA 428+05.35 21.4' RT  
ELEV 623.39

PAVEMENT REMOVAL - STA 427+69.17 TO 428+56.83

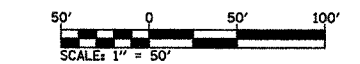

DATE	
BY	
DESIGNED	
PLOTTED	
CHECKED	
DATE	
NO.	

DATE	
BY	
DESIGNED	
PLOTTED	
CHECKED	
DATE	
NO.	

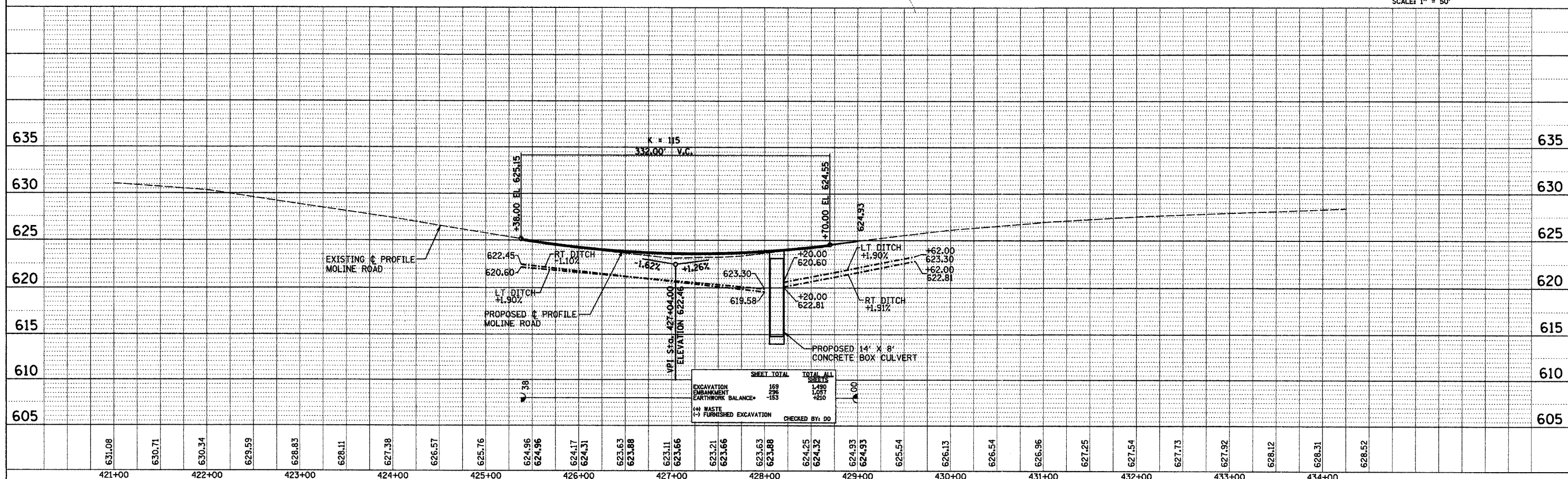

PLOT DATE: 11/8/2004 10:14:02 AM D05499PLN1b.dgn

MOLINE ROAD (0.5 mi SW of I-88)