

STATE OF ILLINOIS  
DEPARTMENT OF TRANSPORTATION

Sheet No. 4  
of 11 Sheets

ROUTE NO.	SECTION	COUNTY	TOTAL SHEETS	SHEET NO.
FAS 1197	105BR-2	WHITESIDE	59	19
FED. ROAD DIST. NO.	ILLINOIS	PROJECT	CONTRACT 64421	

\*Order a(E) bars full length  
Cut to fit skew and use  
remainder in opposite end  
(See Bar Cutting Diagram)

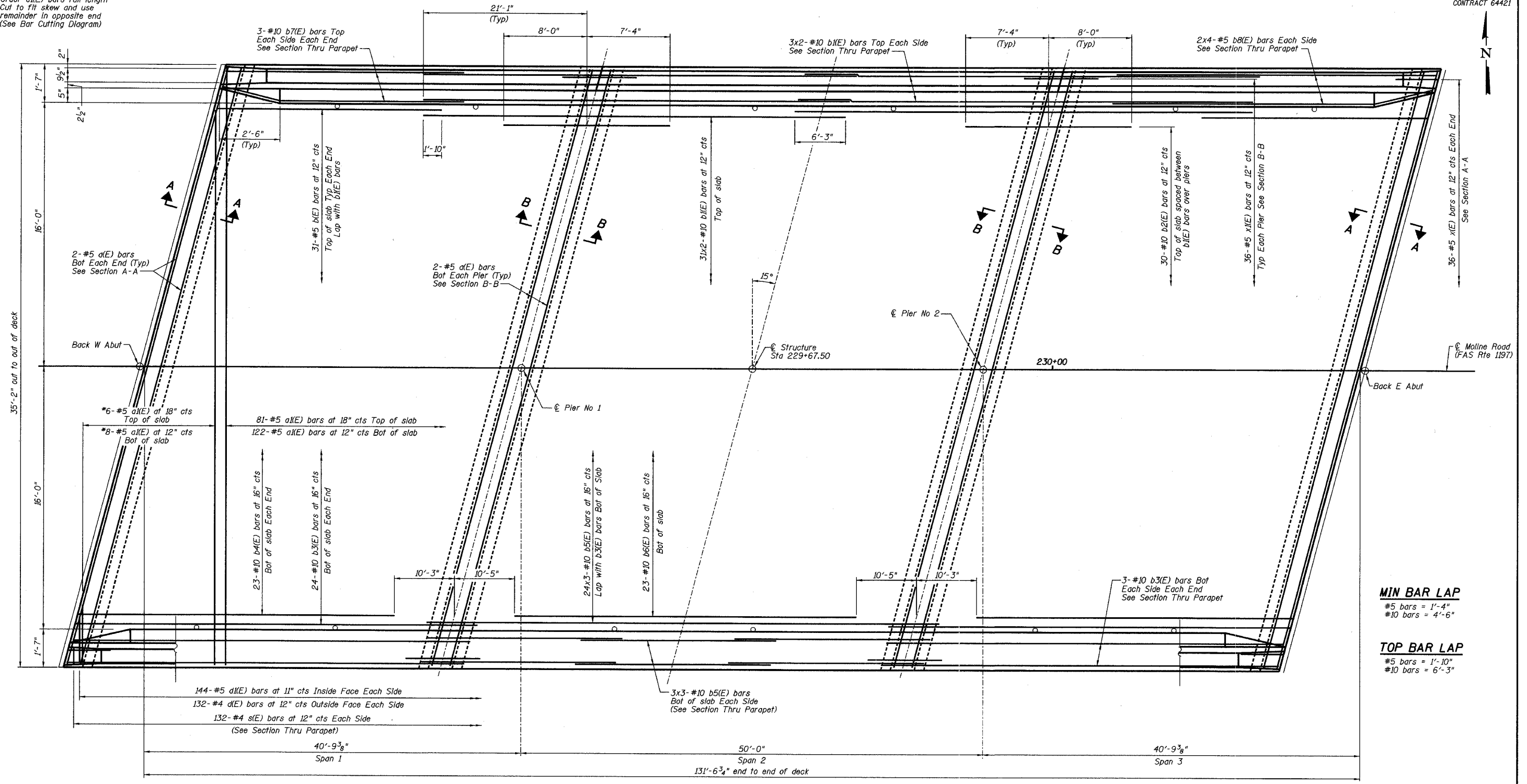

**MIN BAR LAP**  
#5 bars = 1'-4"  
#10 bars = 4'-6"

**TOP BAR LAP**  
#5 bars = 1'-10"  
#10 bars = 6'-3"

**PLAN**

**NOTES:**

- See Sheet No. 6 of 11 for Superstructure Details, parapet reinforcing and Bill of Material.
- Reinforcement bars designated (E) shall be epoxy coated.
- Bars indicated thus 6x3-#5 etc indicates 6 lines of bars with 3 lengths per line.
- See Sheet No. 1 of 11 for floor drain spacing.
- Space reinforcement bars to clear floor drains.

REVISIONS			SUPERSTRUCTURE PLAN	
No.	DATE	INITIALS	MOLINE ROAD OVER UNNAMED TRIBUTARY TO ROCK RIVER	
1			DRAWN BY DATE: R King 8/04	
2			CHECKED BY DATE: CMV 8/04	
3			DATE: 8/04	
4			PROJECT NO. 4858-3	
5			SHEET NO.	
6			PROJECT NO. 4858-3	
7			PROJECT NO. 4858-3	
8			PROJECT NO. 4858-3	
9			PROJECT NO. 4858-3	
10			PROJECT NO. 4858-3	
11			PROJECT NO. 4858-3	
12			PROJECT NO. 4858-3	