

STATE OF ILLINOIS  
DEPARTMENT OF TRANSPORTATION  
DIVISION OF HIGHWAYS

**PROPOSED  
CONTRACT MAINTENANCE**

FAU ROUTE 7998 (E. LAKE SHORE DR.)  
SECTION (110) BDR

BRIDGE DECK PATCHING  
SANGAMON COUNTY

C-96-035-16

FOR INDEX OF SHEETS, SEE SHEET NO. 2

F.A.U. RTE.	SECTION	COUNTY	TOTAL SHEETS	SHEET NO.
7998	(110) BDR	SANGAMON	6	1
		ILLINOIS	CONTRACT NO. 72122	

D-96-035-16

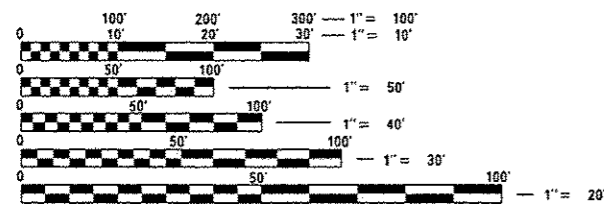
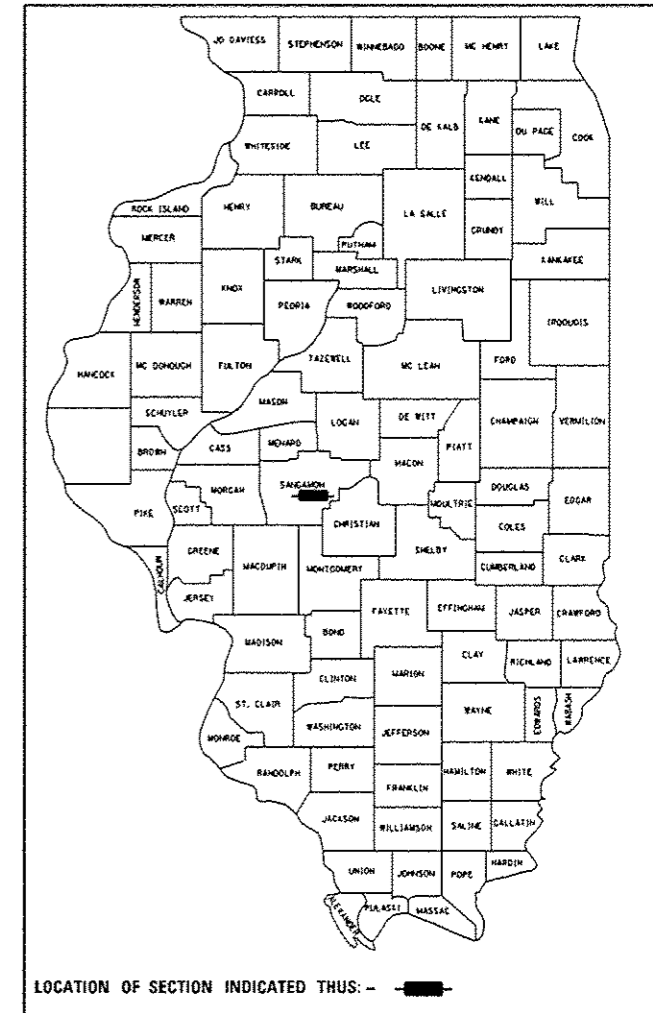

FULL SIZE PLANS HAVE BEEN PREPARED USING STANDARD ENGINEERING SCALES. REDUCED SIZED PLANS WILL NOT CONFORM TO STANDARD SCALES. IN MAKING MEASUREMENTS ON REDUCED PLANS, THE ABOVE SCALES MAY BE USED.

J.U.L.I.E.  
JOINT UTILITY LOCATION INFORMATION FOR EXCAVATION  
1-800-892-0123  
OR 811

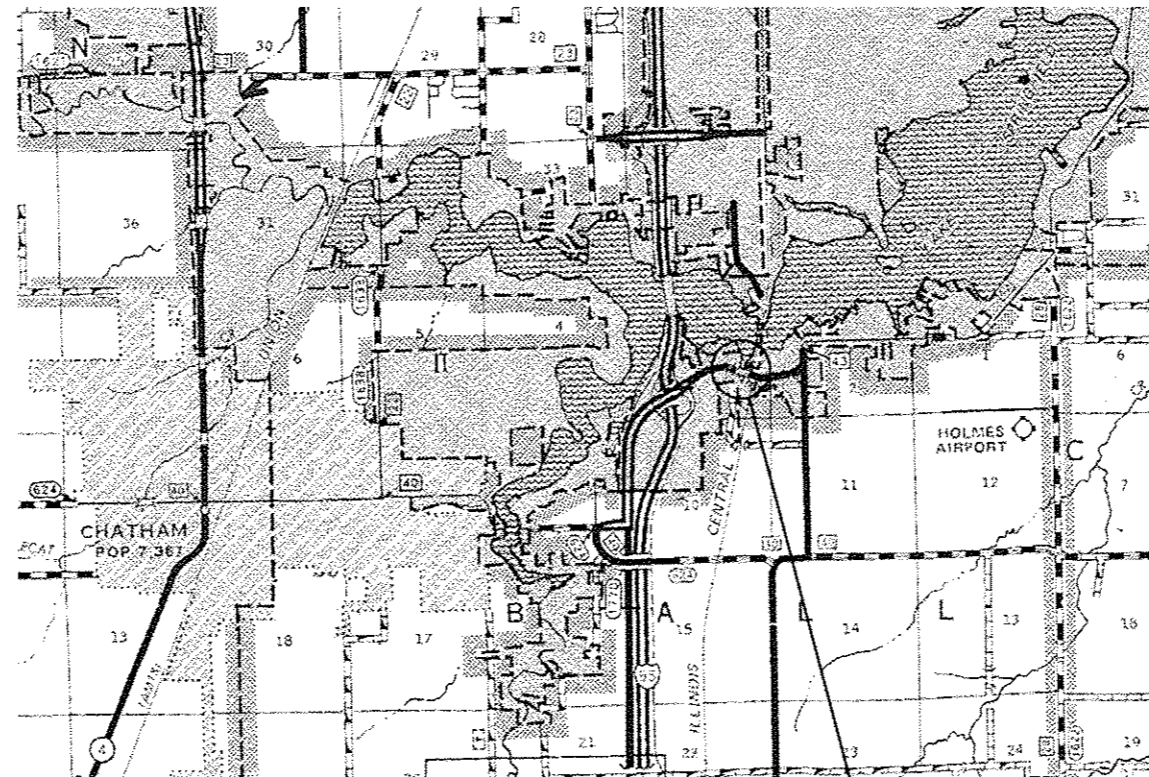

PROJECT LOCATION:  
SN 084-0209  
E. LAKE SHORE DRIVE OVER  
LAKE SPRINGFIELD SLOUGH  
0.5 MI EAST OF I-55  
N39.689285° W89.632954°

NET LENGTH = 280 FT = 0.053 MILE

BRIDGE MAINTENANCE ENGINEER: BRANDON DUDLEY (217) 785-9290  
BRIDGE INSPECTION ENGINEER: DAVE COPENBARGER (217) 785-5306

CONTRACT NO. 72122

STATE OF ILLINOIS  
DEPARTMENT OF TRANSPORTATION  
DIVISION OF HIGHWAYS

SUBMITTED *January 29 2016*  
*2016*  
DEPUTY DIRECTOR OF HIGHWAYS, REGION ENGINEER

*March 13 2016*  
Maurice M. Addis PE  
ENGINEER OF DESIGN AND ENVIRONMENT

*March 13 2016*  
Omer Osman PE  
DIRECTOR OF HIGHWAYS/CHIEF ENGINEER



**PRINTED BY THE AUTHORITY  
OF THE STATE OF ILLINOIS**

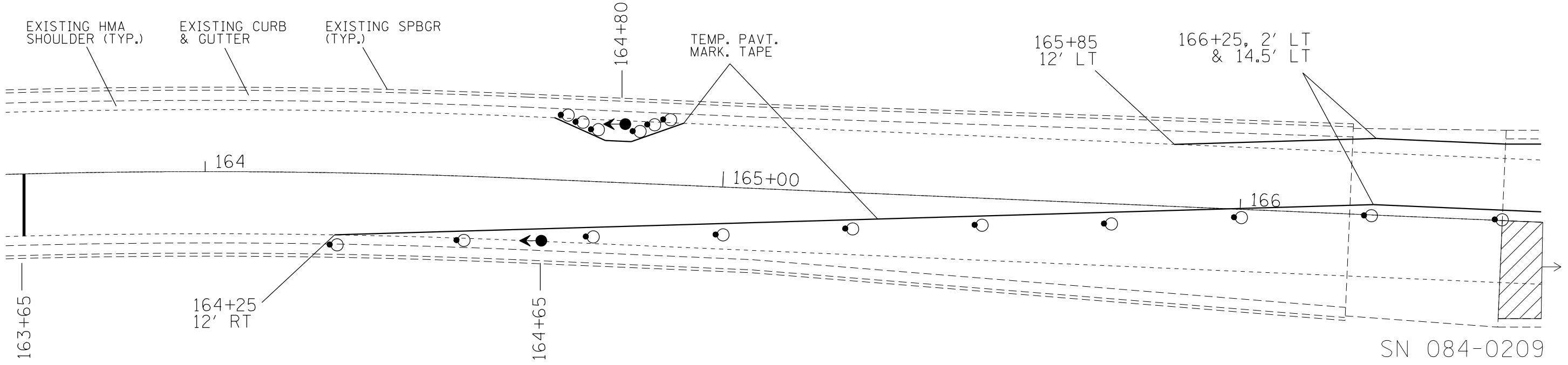

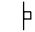

SN 084-0209

**SYMBOLS**

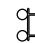
-  WORK AREA
-  SIGN
-  TRAFFIC SIGNAL
-  DRUM WITH STEADY BURNING LIGHT
-  TYPE III BARRICADE WITH FLASHING LIGHTS

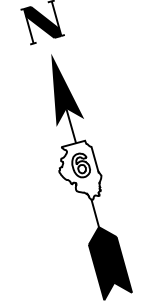

**NOTES:**

1. TRAFFIC CONTROL SHALL CONFORM TO STANDARD 701316 AND AS SHOWN ON THIS SHEET.
2. ALL TRAFFIC CONTROL DEVICES NOT SHOWN ON THIS DETAIL SHALL BE PLACED PER STANDARD 701316.
3. REMOVAL OF EXISTING PAVEMENT MARKINGS WILL NOT BE REQUIRED.

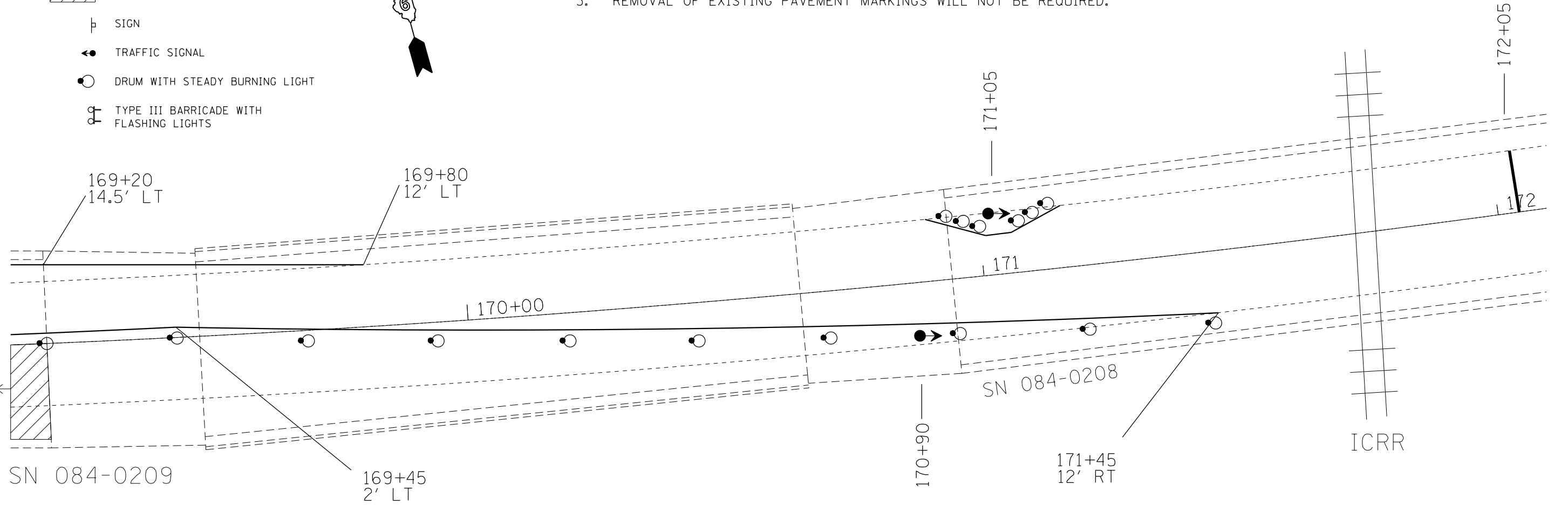

SN 084-0209



SN 084-0208

ICRR

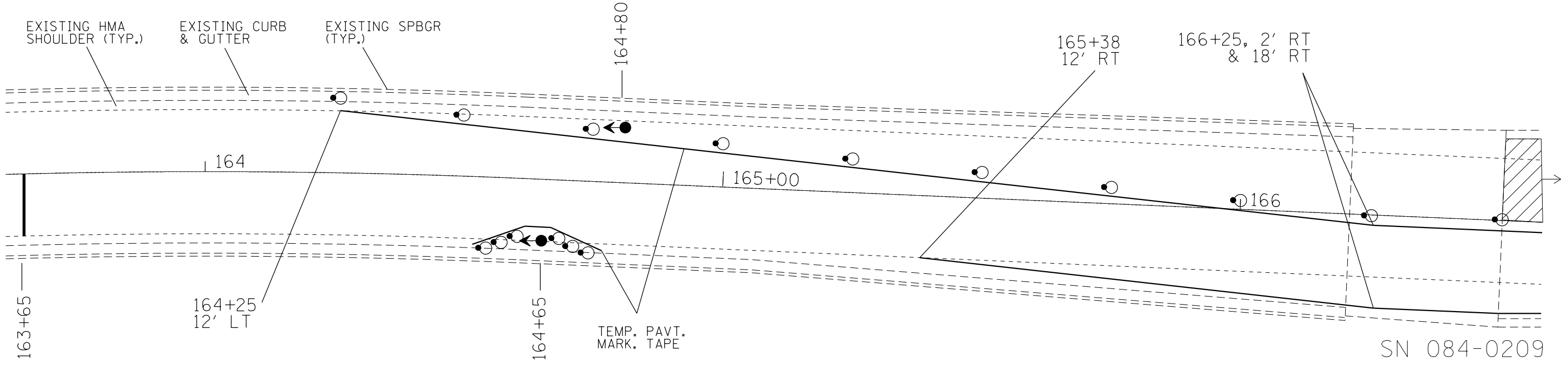
FILE NAME = G:\OPERATIONS\Bridges\Bridgplans\CAD\72122 - 0840209 deck patching\plansheet.dgn	USER NAME = dudleybm	DESIGNED -	REVISED -	<b>STATE OF ILLINOIS DEPARTMENT OF TRANSPORTATION</b>	<b>TRAFFIC CONTROL PLAN STAGE I</b>				F.A.U. RTE. = 7998	SECTION = (110) BDR	COUNTY = SANGAMON	TOTAL SHEETS = 6	SHEET NO. = 3
	Default	PLOT SCALE = 40.0000' / in.	CHECKED -		REVISED -	SCALE:	SHEET	OF	SHEETS	STA.	TO	STA.	ILLINOIS FED. AID PROJECT
	PLOT DATE = 1/29/2016	DATE -	REVISED -		CONTRACT NO. 72122								

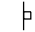

**SYMBOLS**

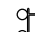
-  WORK AREA
-  SIGN
-  TRAFFIC SIGNAL
-  DRUM WITH STEADY BURNING LIGHT
-  TYPE III BARRICADE WITH FLASHING LIGHTS

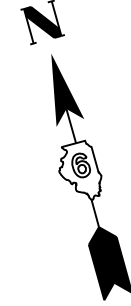

- NOTES:
1. TRAFFIC CONTROL SHALL CONFORM TO STANDARD 701316 AND AS SHOWN ON THIS SHEET.
  2. ALL TRAFFIC CONTROL DEVICES NOT SHOWN ON THIS DETAIL SHALL BE PLACED PER STANDARD 701316.
  3. REMOVAL OF EXISTING PAVEMENT MARKINGS WILL NOT BE REQUIRED.

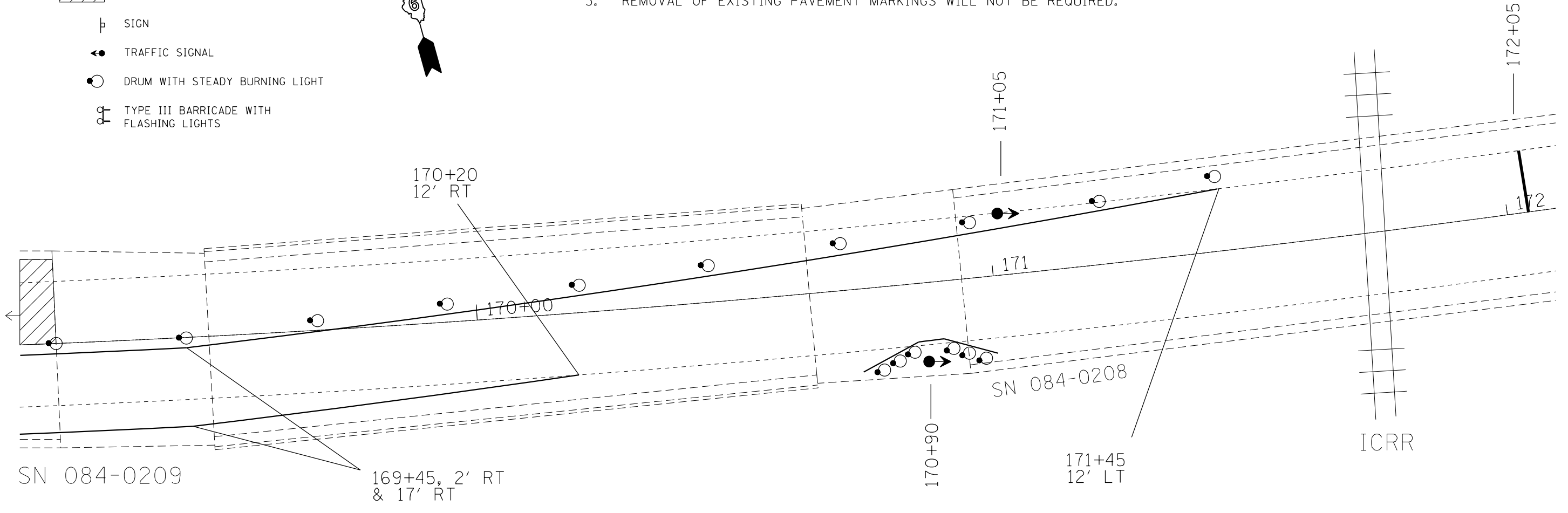

FILE NAME = D:\OPERATIONS\Bridges\Bridgplans\CAD\72122 - 0840209 deck patching\plansheet.dgn	USER NAME = dudleybm	DESIGNED -	REVISED -	<b>STATE OF ILLINOIS DEPARTMENT OF TRANSPORTATION</b>	<b>TRAFFIC CONTROL PLAN STAGE II</b>				F.A.U. RTE. = 7998	SECTION = (110) BDR	COUNTY = SANGAMON	TOTAL SHEETS = 6	SHEET NO. = 4
	Default	PLOT SCALE = 40.0000' / in.	CHECKED -		REVISED -	SCALE:	SHEET	OF	SHEETS	STA.	TO	STA.	CONTRACT NO. 72122
	PLOT DATE = 1/29/2016	DATE -	REVISED -		ILLINOIS FED. AID PROJECT								



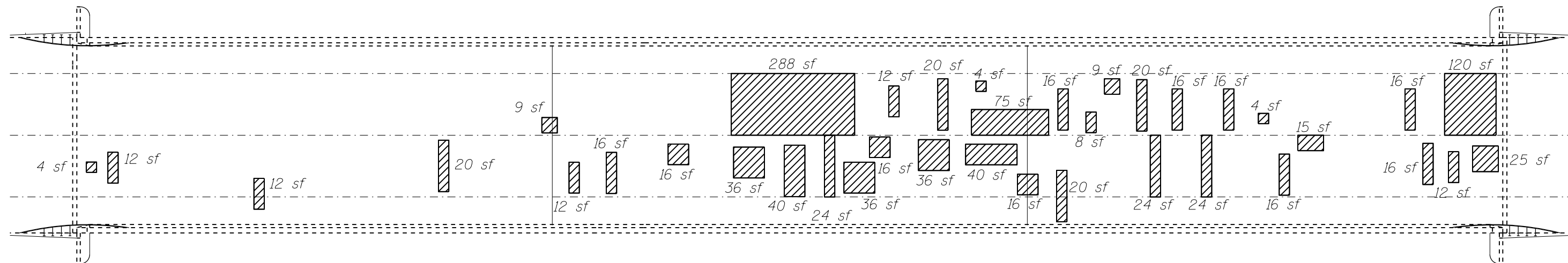

 PARTIAL DEPTH PATCHING AREAS

PATCHING SURVEY: 12-2015

BILL OF MATERIAL		
ITEM	UNIT	QUANTITY
DECK SLAB REPAIR (PARTIAL)	SQ. YD.	124

GENERAL NOTES:

1. THE PATCH SIZES AND LOCATIONS SHOWN ON THE PLAN SHEETS ARE ESTIMATED. THE FINAL PATCH LOCATIONS SHALL BE DETERMINED BY THE ENGINEER IN THE FIELD.

FILE NAME =	USER NAME = dudleybm	DESIGNED -	REVISED -	<b>STATE OF ILLINOIS DEPARTMENT OF TRANSPORTATION</b>	<b>PATCHING PLAN SN 084-0209</b>			F.A.U. RTE.	SECTION	COUNTY	TOTAL SHEETS	SHEET NO.
Q:\OPERATIONS\Bridges\Bridgplans\CAD\72122 - 0840209 deck patching\plansheet.dgn	PLOT SCALE = 40.0000' / in.	DRAWN -	REVISED -					7998	(110) BDR	SANGAMON	6	6
Default	PLOT DATE = 1/29/2016	CHECKED -	REVISED -		CONTRACT NO. 72122			ILLINOIS FED. AID PROJECT				
		DATE -	REVISED -		SCALE:	SHEET	OF	SHEETS	STA.	TO	STA.	