



Copyright Hanson Professional Services Inc. 2016

COMMITMENTS

THE CITY OF SPRINGFIELD HAS ENTERED INTO COMMITMENTS WITH SEVERAL PROPERTY OWNERS. THESE COMMITMENTS ARE AS FOLLOWS:

BROOKVIEW PROPERTIES, LLC:

1. THE CITY'S CONTRACTOR WILL CONSTRUCT A 30 FEET WIDE COMMERCIAL ENTRANCE TO THE PROPOSED RIGHT OF WAY LINE AT STA 228+60 LT. IT WILL BE THE PROPERTY OWNER'S RESPONSIBILITY TO CONNECT ANY INTERNAL VEHICULAR LANES TO SAID COMMERCIAL ENTRANCE AT ITS OWN EXPENSE. NEITHER THE CITY NOR ITS CONTRACTOR WILL BE RESPONSIBLE FOR COSTS INCURRED BY THE PROPERTY OWNER IN CONNECTING THE INTERNAL VEHICULAR LANES TO SAID COMMERCIAL ENTRANCE.

MERRILL'S CONTRACTORS INC:

1. THE CITY'S CONTRACTOR WILL CONSTRUCT A 30 FEET WIDE COMMERCIAL ENTRANCE FROM THE PROPOSED STANFORD AVENUE TO THE PROPERTY OWNERS WESTERLY REMAINDER AT STA 218+70 LT.
2. THE CITY'S CONTRACTOR WILL CONSTRUCT A 30 FEET WIDE COMMERCIAL ENTRANCE FROM THE PROPOSED STANFORD AVENUE TO THE PROPERTY OWNER'S EASTERLY REMAINDER AT STA 229+54 LT.

JOSEPH NIELSEN OF NIELSEN'S BILLIARDS:

1. ACCESS WILL BE MAINTAINED THROUGHOUT CONSTRUCTION. THE PROPOSED ENTRANCE WILL BE CONSTRUCTED PRIOR TO THE REMOVAL OF THE EXISTING ENTRANCE. THE CITY'S CONTRACTOR WILL COORDINATE WITH THE PROPERTY OWNER DURING CONSTRUCTION OF THE PARKING LOT WIDENING TO ATTEMPT TO MINIMIZE ANY INCONVENIENCE.
2. THE CITY'S CONTRACTOR WILL IMMEDIATELY NOTIFY THE PROPERTY OWNER SHOULD ANY UTILITY SERVICE BE AFFECTED BY CONSTRUCTION ACTIVITIES. THE CITY'S CONTRACTOR WILL WORK WITH THE PROPERTY OWNER AND THE UTILITY COMPANIES TO RESTORE ANY SERVICE DISRUPTION CAUSED BY THE CONSTRUCTION OF THE PROJECT AS SOON AS POSSIBLE.
3. THE CITY'S CONTRACTOR WILL CONSTRUCT THE ENTRANCE AND THE PARKING LOT AND WILL RECONSTRUCT THE EXISTING DRIVE AND GRAVEL AREAS AS SHOWN ON THE PLANS.
4. THE CITY'S CONTRACTOR WILL GRADE THE BACK SLOPE AT AN 8:1 SLOPE FROM THE SOUTH FACE OF THE BUILDING AND A 4:1 SLOPE FROM 1' OFF THE BACK OF SIDEWALK. DETAILS AND LOCATIONS FOR THIS GRADING SHALL BE AS SHOWN IN THE GRADING PLAN AND CROSS SECTIONS.
5. THE CITY'S CONTRACTOR WILL INSTALL SEVEN 6" BOLLARDS WITH THE FACE OF THE BOLLARDS 4.5 FEET BEHIND THE PROPOSED SIDEWALK AT 18 FOOT INTERVALS BEGINNING AT STA 244+46 LT TO STA 245+54 LT AS SHOWN ON THE PLANS.
6. THE CITY'S CONTRACTOR WILL PROVIDE A DEPRESSED CURB FOR A FUTURE 24' WIDE DRIVEWAY. THE CENTER OF THIS DEPRESSED CURB WILL BE AT STA 240+00 LT.

HOT-MIX ASPHALT PAVING DETAILS

CRITERIA	FULL-DEPTH MIXTURE REQUIREMENTS				
	MIX 1	MIX 2	MIX 3	TAYLOR (SURFACE)	BIKE PATH/HMA SHOULDER
PG	SBS PG 64-28	SBS PG 64-28	PG 64-22	SBS PG 64-28	PG 58-28
VOIDS	4% @ N50	4% @ N50	4% @ N50	4% @ N50	4% @ N50
MIX COMPOSITION	IL 9.5	IL 19.0	IL 19.0	IL 9.5	IL 19.0
FRICTION AGG	MIX "D"	NA	NA	MIX "D"	NA
QUALITY MANAGEMENT	OC/OA	OC/OA	OC/OA	OC/OA	OC/OA

LIFT DIAGRAM

MIX 1	2" SURFACE
MIX 2	2 1/4" TOP LIFT BINDER
MIX 3	LOWER LIFTS BINDER

HMA THICKNESS (INCHES)		
ROADWAY	MIX 1	MIX 2/3
STANFORD	2.0	10.0
TRUMAN	2.0	5.0
LIFT THICKNESS		
TAYLOR	1.5	
BIKEPATH	3	

UTILITY NOTES

1. THE CONTRACTOR SHALL BE RESPONSIBLE FOR PROTECTING UTILITY PROPERTY FROM CONSTRUCTION OPERATIONS AS OUTLINED IN ARTICLE 107.31 OF THE STANDARD SPECIFICATIONS. THE CONTRACTOR SHALL CONTACT JULIE AT LEAST 48 HOURS PRIOR TO EXCAVATION TO DETERMINE WHICH UTILITIES ARE WITHIN THE AREA. MEMBERS OF JULIE AND NON JULIE MEMBERS KNOWN TO BE WITHIN THE LIMITS OF THE IMPROVEMENT ARE:

MEMBERS OF JULIE UTILITY CONTACT INFORMATION			NON JULIE UTILITY CONTACT INFORMATION
<p>CWLP (WATER) MICHAEL T. JOHNSON (217) 789-2323 x1617 401 NORTH 11TH STREET SPRINGFIELD, IL 62702</p> <p>CWLP (ELECTRIC) CHRIS HARNEY (217) 757-8520 X 2153 1008 EAST MILLER STREET SPRINGFIELD, IL 62702</p> <p>AMEREN CILCO NORTH (ELECTRIC) GEREALD HUTCHINSON (217) 753-5173 825 NORTH MACARTHUR SPRINGFIELD, IL 62702</p>	<p>COMCAST DAVID BLY (224) 229-3204 (W) (217) 306-3759 (M) 711 SOUTH DIRKSEN PARKWAY SPRINGFIELD, IL 62703</p> <p>ZAYO GROUP (FIBER) TIM PLANK (618) 971-0586 810 JORIE BLVD STE 110 OAKBROOK, IL 60523</p> <p>AMEREN CILCO NORTH (GAS) RICK COMBS (217) 753-5187 (W) (217) 971-0517 (M) 825 NORTH MACARTHUR SPRINGFIELD, IL 62702</p>	<p>WINSTREAM KOL, INC. DAVID FERREIRA (309) 282-3110 (W) (309) 253-0930 (M) 211-B SW ADAMS STREET PEORIA, IL 61602</p> <p>CITY OF SPRINGFIELD (SEWER DEPARTMENT) JOHN HIGGINBOTHAM (217) 789-2260 300 SOUTH SEVENTH STREET SPRINGFIELD, IL 62701</p> <p>AT&T MIDWEST MICHAEL OSMOND (217) 789-5644 1640 HAZEL DELL ROAD SPRINGFIELD, IL 62703</p>	<p>ILLINOIS CENTRAL RAILROAD COMPANY PAUL CHOJENSKI (708) 332-3805 17641 SOUTH ASHLAND AVENUE HOMEWOOD, IL 60430</p>

FINAL
 DESIGNED: JDS 5/22/2015
 DRAWN: JDS 5/22/2015
 REVIEWED: JWM 5/28/2015

FILE NAME = C:\COMMITMENTS.dgn	USER NAME = shipp01354	DESIGNED - JDS	REVISED - 4/6/2016	STATE OF ILLINOIS DEPARTMENT OF TRANSPORTATION	STANFORD AVE EXTENSION FOX BRIDGE TO TAYLOR AVE SPRINGFIELD, SANGAMON COUNTY, ILLINOIS COMMITMENTS, UTILITIES, AND PAVEMENT DETAILS	F.A.U. RTE. 1297	SECTION 12-00467-01-PV	COUNTY SANGAMON	TOTAL SHEETS 79	SHEET NO. 3	
Default	PLOT SCALE = 2.0000' / 1"	CHECKED - JWM	REVISED -			SCALE: NA	SHEET 1 OF 1 SHEETS	STA. TO STA.	CONTRACT NO. 07S2010A		93658
	PLOT DATE = 4/6/2016	DATE -	REVISED -			ILLINOIS FED. AID PROJECT					



© Hanson Professional Services, Inc. 2015

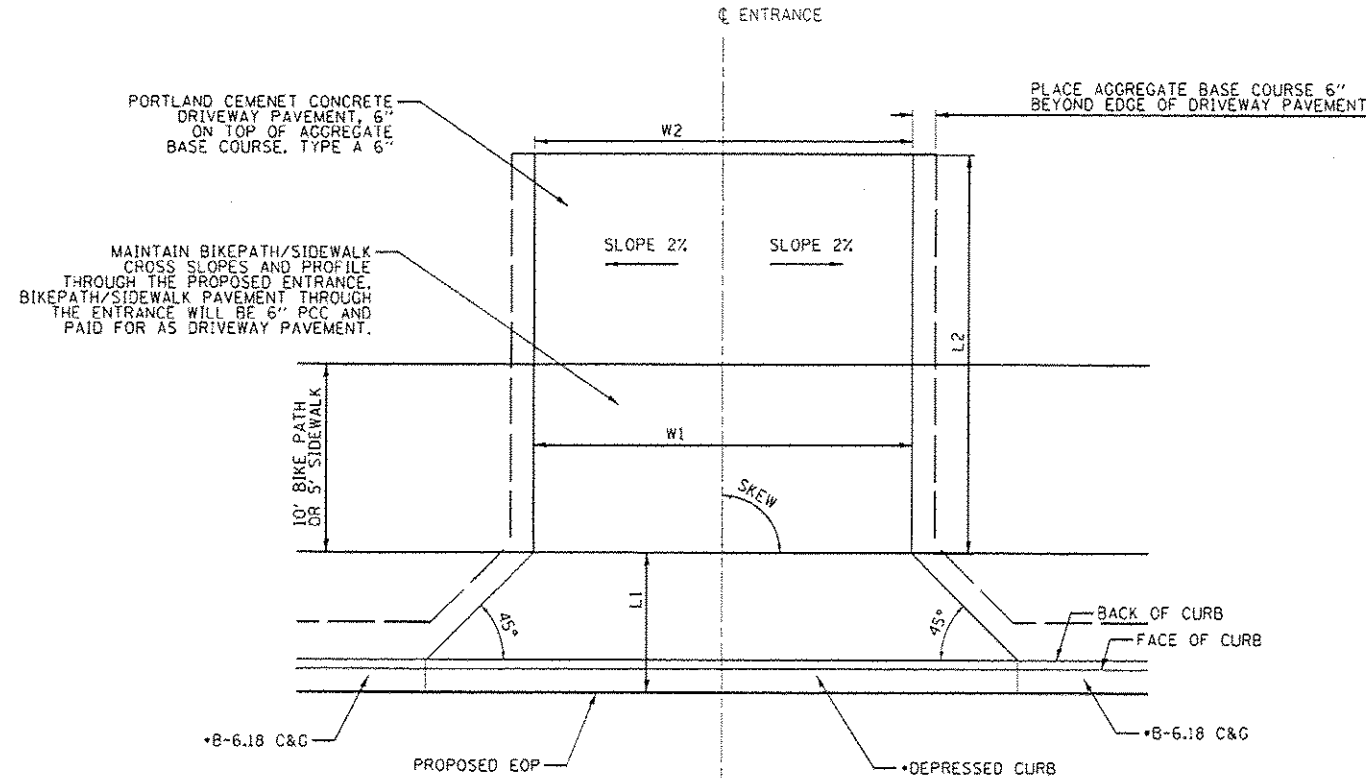

ENTRANCE LOCATIONS AND DETAILS								
ALIGNMENT	± STATION	LT/RT	SKEW	W1	W2	L1	L2	CONCRETE
STANFORD	215+08.00	LT	79°58'	24.0'	19.0'	8.5'	38.3'	6"
STANFORD	215+08.00	RT	90°	24.0'	24.0'	6.5'	24.3'	6"
STANFORD	218+70.00	LT	90°	30.0'	30.0'	8.5'	37.7'	6"
STANFORD	228+60.00	LT	90°	30.0'	30.0'	8.5'	35.0'	6"
STANFORD	229+54.00	LT	90°	30.0'	18.6'	8.5'	SEE DETAIL	6"
STANFORD	232+79.00	LT	90°	12.0'	12.0'	6.5'	10.0'	6"
TAYLOR	15+07.66	LT	78°29'	35.0'	20.0'	7.0'	SEE DETAIL	6"

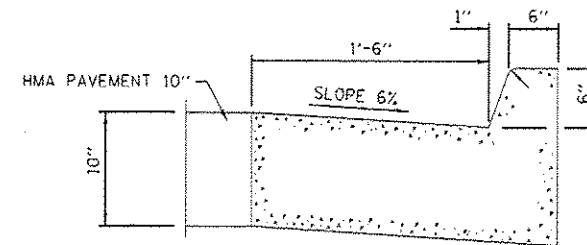

B-6.18 C&G

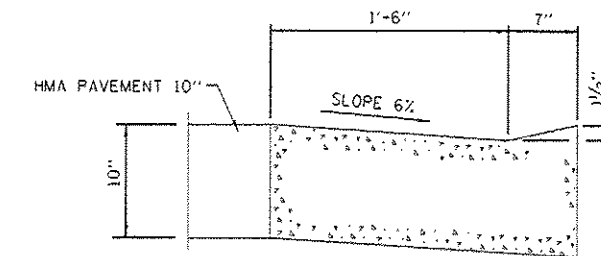

DEPRESSED CURB

• NOTE: CURB AND CUTTER IS NOT USED ON TRUMAN ROAD. FULL-DEPTH PAVEMENT WILL BE PLACED ADJACENT TO THE ENTRANCE PAVEMENT. ENTRANCE PAVEMENT WILL BE PAID FOR OUT TO THE PROPOSED EOP.

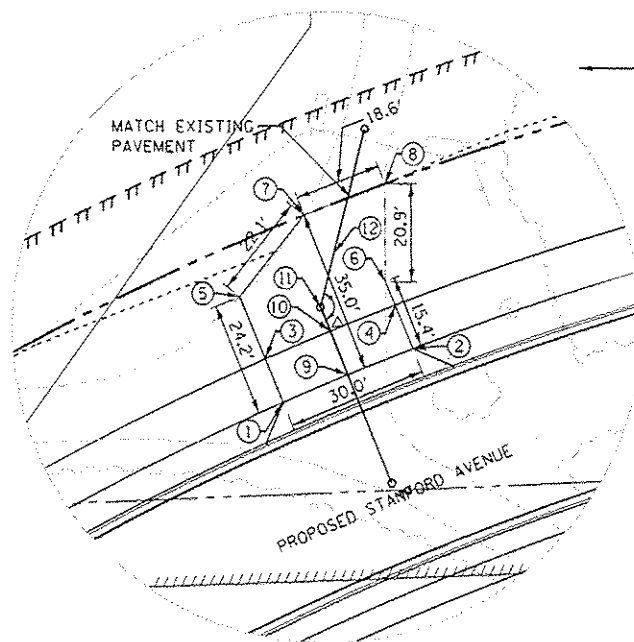

**ENTRANCE DETAIL
STANFORD STA 229 + 54.00**

STANFORD STATION 229+54.00			
PNT	STATION	OFFSET	ELEV
1	229+39.60	25.00 LT	595.41
2	229+68.40	25.00 LT	595.26
3	229+39.83	35.00 LT	595.41
4	229+68.17	35.00 LT	595.26
5	229+40.14	49.22 LT	594.55
6	229+68.05	40.42 LT	594.90
7	229+57.82	60.00 LT	592.91
8	229+74.76	60.00 LT	592.81
9	229+54.02	25.00 LT	595.33
10	229+54.02	35.00 LT	595.33
11	229+54.02	40.51 LT	595.11
12	229+60.52	50.13 LT	594.01
Δ	143°42'25.01"		

TAYLOR STATION 15+07.66			
PNT	STATION	OFFSET	ELEV
1	1+38.19	17.29 RT	573.86
2	1+35.26	17.17 LT	574.93
3	1+63.61	14.95 RT	575.80
4	1+71.72	16.00 LT	576.29
5	1+77.26	14.00 RT	576.76
6	2+08.20	32.63 RT	580.43
7	2+16.48	54.16 RT	581.19
8	2+29.15	46.52 RT	581.76
9	2+15.00	16.00 RT	578.17
10	2+34.37	22.00 RT	579.61
11	2+44.82	14.00 RT	579.40
12	2+39.90	16.00 LT	578.77
13	2+49.45	28.94 LT	579.82
14	2+46.83	37.48 LT	580.00
15			
16			

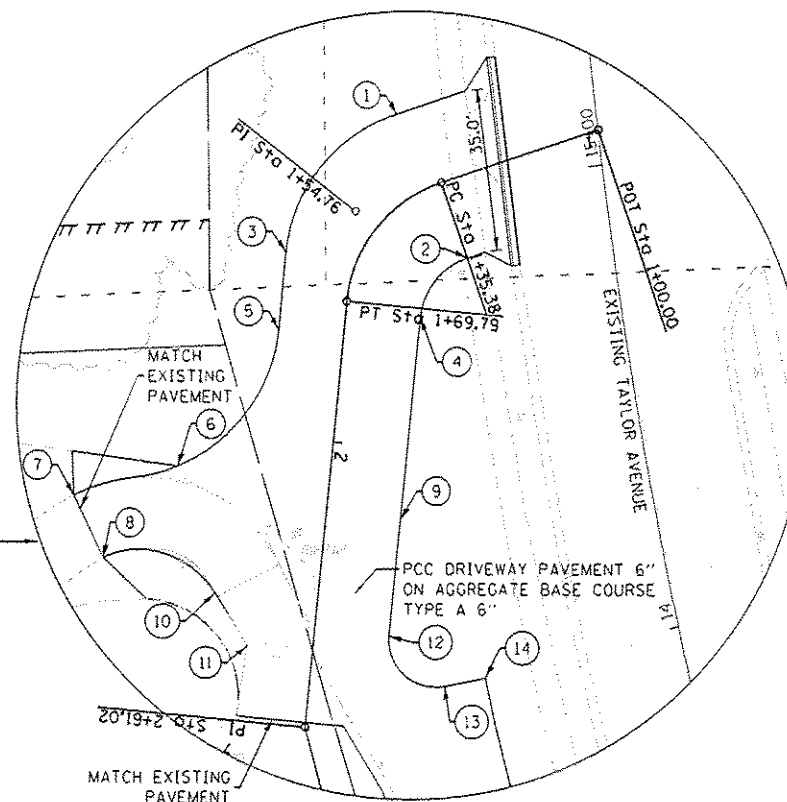

**ENTRANCE DETAIL
TAYLOR STA 15 + 07.66**

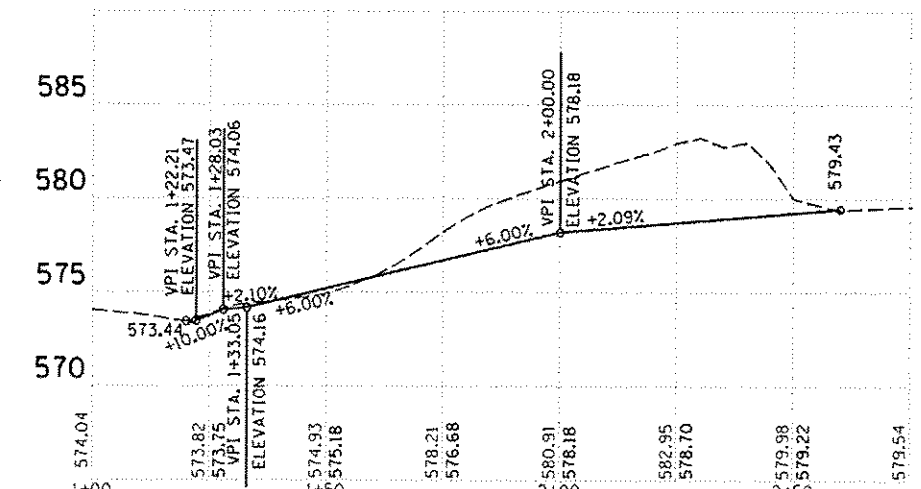

DESIGNED: JDS 5/22/2015
DRAWN: JDS 5/22/2015
REVIEWED: JWM 5/28/2015

FILE NAME: C:\PLAN_ENT_DETAIL.dgn	USER NAME: jdspp21264	DESIGNED: JDS	REVISED: 4/6/2016
		DRAWN: JDS	REVISED: -
		CHECKED: JWM	REVISED: -
		DATE: -	REVISED: -

STATE OF ILLINOIS
DEPARTMENT OF TRANSPORTATION

STANFORD AVE EXTENSION FOX BRIDGE TO TAYLOR AVE
SPRINGFIELD, SANGAMON COUNTY, ILLINOIS
ENTRANCE DETAILS

P.A.U. RTE. 7997	SECTION 12-00467-01-PV	COUNTY SANGAMON	TOTAL SHEETS 79	SHEET NO. 51
0752010A		CONTRACT NO. 93658		ILLINOIS FED. AID PROJECT

SCALE: NA SHEET 1 OF 1 SHEETS STA. TO STA.