

F.A.U. RTE.	SECTION	COUNTY	TOTAL SHEETS	SHEET NO.
530	15-00011-00-RS	DuPAGE	15	1
FED. ROAD DIST. NO.	ILLINOIS	CONTRACT NO.	61C57	

FOR INDEX OF SHEETS, SEE SHEET NO. 2

STATE OF ILLINOIS  
DEPARTMENT OF TRANSPORTATION  
DIVISION OF HIGHWAYS

PLANS FOR PROPOSED  
FEDERAL AID HIGHWAY

FAU 1368 (ARMY TRAIL ROAD)  
CN RAILROAD TO UP RAILROAD  
RESURFACING  
SECTION NO. 15-00011-00-RS  
PROJECT NO. M-4003(609)  
VILLAGE OF WAYNE  
DuPAGE COUNTY  
JOB NO. C-91-106-16



LOCATION OF SECTION INDICATED THIS: - [black rectangle] -

TRAFFIC DATA

ARMY TRAIL ROAD  
ADT (YEAR) = 5,500 (2008)  
POSTED SPEED LIMIT = 25 MPH

DESIGN DESIGNATION: MINOR ARTERIAL

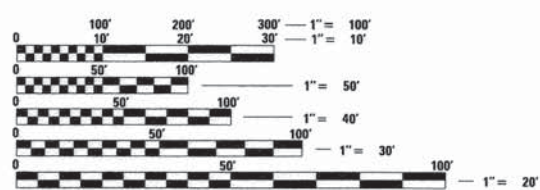

FULL SIZE PLANS HAVE BEEN PREPARED USING STANDARD ENGINEERING SCALES. REDUCED SIZED PLANS WILL NOT CONFORM TO STANDARD SCALES. IN MAKING MEASUREMENTS ON REDUCED PLANS, THE ABOVE SCALES MAY BE USED.

J.U.L.I.E.  
JOINT UTILITY LOCATION INFORMATION FOR EXCAVATION  
8-1-1 OR 1-800-892-0123

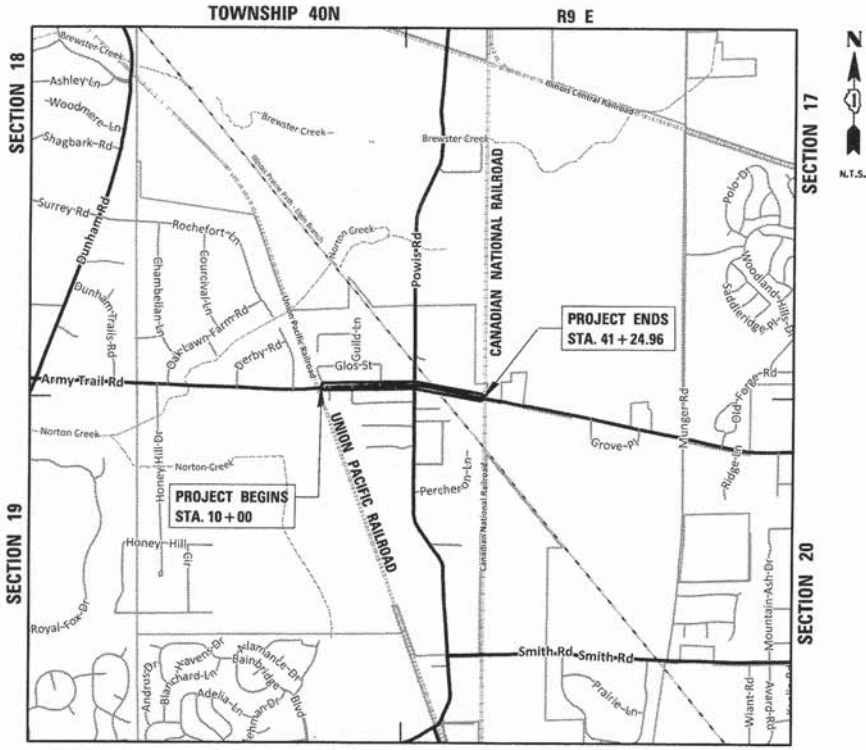

LOCATION MAP

ARMY TRAIL ROAD  
GROSS LENGTH OF PROJECT = 3,400 LINEAL FEET (0.64 MILES)  
NET LENGTH OF PROJECT = 3,400 LINEAL FEET (0.64 MILES)

**CB** CHRISTOPHER B. BURKE ENGINEERING LTD.  
9575 West Higgins Road, Suite 600  
Rosemont, Illinois 60018 (847) 823-0500

PROFESSIONAL DESIGN FIRM NO. 184-001175  
EXPIRATION DATE: 04/30/17

CONTRACT NO. 61C57

STATE OF ILLINOIS  
DEPARTMENT OF TRANSPORTATION  
DIVISION OF HIGHWAYS

APPROVED 1/22/2016  
*Colleen Purpitt*  
VILLAGE PRESIDENT, VILLAGE OF WAYNE

PASSED FEBRUARY 9 2016  
*Chad Christopher Hill*  
DISTRICT 1 ENGINEER OF LOCAL ROADS AND STREETS

RELEASING FOR  
BID BASED ON  
LIMITED REVIEW February 11 2016  
*John Fortman*  
DEPUTY DIRECTOR OF HIGHWAYS, REGION ONE ENGINEER

**LEE M. FELL**  
062-053708  
REGISTERED  
PROFESSIONAL  
ENGINEER  
OF  
ILLINOIS

*Lee M. Fell*  
ENGINEER

1/22/16  
DATE

LEE M. FELL  
ILLINOIS REGISTRATION No. 062-053708  
EXPIRATION DATE: 11/30/2017

PRINTED BY THE AUTHORITY OF THE STATE OF ILLINOIS

FEDERAL AID PROGRAM ENGINEER: FAWAD AQUEEL, P.E. (847) 705-4021  
SCHAUMBURG, ILLINOIS

**GENERAL NOTES**

SPECIFICATIONS, STANDARDS AND SPECIAL PROVISIONS

ALL CONSTRUCTION SHALL BE DONE IN ACCORDANCE WITH THE "STANDARD SPECIFICATIONS FOR ROAD AND BRIDGE CONSTRUCTION", ADOPTED APRIL 1, 2016; THE "SUPPLEMENTAL SPECIFICATIONS AND RECURRING SPECIAL PROVISIONS", THE LATEST REVISION; THE LATEST EDITION OF THE "ILLINOIS MANUAL ON UNIFORM TRAFFIC CONTROL DEVICES FOR STREETS AND HIGHWAYS", (IMUTCD) "THE STANDARD SPECIFICATIONS FOR WATER AND SEWER MAIN CONSTRUCTION IN ILLINOIS" JUNE 2014 SEVENTH EDITION, THE "DETAILS" IN THE PLANS AND THE "SPECIAL PROVISIONS" INCLUDED IN THE CONTRACT DOCUMENTS.

ANY REFERENCE TO STANDARDS THROUGHOUT THE PLANS OR SPECIAL PROVISIONS SHALL BE INTERPRETED AS THE LATEST IDOT HIGHWAY STANDARD.

CODES OF THE IEPA TITLE 35, AND O.S.H.A. SHALL BE ADHERED TO FOR THE CONSTRUCTION OF THIS PROJECT.

ALL TRAFFIC CONTROL AND OTHER ADVISORY SIGNS NEEDED FOR CONSTRUCTION ARE TO BE FURNISHED BY THE CONTRACTOR IN ACCORDANCE WITH SECTION 700 OF THE STANDARD SPECIFICATIONS.

ALL REQUIRED PERMITS FROM THE PROPER GOVERNING AGENCY SHALL BE OBTAINED FOR CONSTRUCTION ALONG OR ACROSS EXISTING STREETS OR HIGHWAYS. THE CONTRACTOR SHALL MAKE ARRANGEMENTS FOR THE PROPER BRACING, SHEETING, SHORING AND OTHER REQUIRED PROTECTION OF ALL ROADWAYS BEFORE CONSTRUCTION BEGINS. THE CONTRACTOR SHALL BE RESPONSIBLE FOR ANY DAMAGE TO THE STREETS OR ROADWAYS AND ASSOCIATED STRUCTURES AND SHALL MAKE REPAIRS AS NECESSARY TO THE SATISFACTION OF THE ENGINEER. AT THE CONTRACTOR'S OWN EXPENSE, THE CONTRACTOR SHALL BE RESPONSIBLE FOR THE INSTALLATION AND MAINTENANCE OF ADEQUATE SIGNS AND WARNING DEVICES TO INFORM AND PROTECT THE PUBLIC.

UTILITIES

THE CONTRACTOR SHALL BE RESPONSIBLE FOR CONTACTING THE OWNERS OF ALL EXISTING UTILITY FACILITIES SO THAT THE UTILITIES AND THEIR APPURTENANCES MAY BE LOCATED AND ADJUSTED OR MOVED, IF NECESSARY, PRIOR TO THE START OF CONSTRUCTION OPERATIONS. THE CONTRACTOR SHALL COOPERATE WITH ALL UTILITY OWNERS AS PROVIDED FOR IN THE STANDARD SPECIFICATIONS.

THE LOCATIONS OF EXISTING DRAINAGE STRUCTURES, STORM AND SANITARY SEWERS, WATER SERVICE LINES AND OTHER UTILITY LINES ARE APPROXIMATE, AND THE DEPARTMENT AND VILLAGE DO NOT GUARANTEE THEIR ACCURACY. THEIR EXACT HORIZONTAL AND VERTICAL LOCATIONS ARE TO BE DETERMINED IN THE FIELD BY THE CONTRACTOR AT HIS OWN EXPENSE.

THE CONTRACTOR SHALL BE RESPONSIBLE FOR THE PROTECTION OF ALL UNDERGROUND OR SURFACE UTILITIES EVEN THOUGH THEY MAY NOT BE SHOWN ON THE PLANS. ANY UTILITY THAT IS DAMAGED DURING CONSTRUCTION SHALL BE REPAIRED OR REPLACED TO THE SATISFACTION OF THE ENGINEER OR THE VILLAGE. THIS WORK SHALL BE AT THE CONTRACTOR'S EXPENSE.

BEFORE STARTING ANY EXCAVATION, THE CONTRACTOR SHALL CALL "JULIE" AT 8-1-1 FOR FIELD LOCATIONS OF BURIED ELECTRIC, TELEPHONE, GAS AND CABLE.

WATER, STORM SEWER AND SANITARY SEWER

WHENEVER DURING CONSTRUCTION OPERATIONS ANY LOOSE MATERIAL IS DEPOSITED IN THE FLOW LINE OF DRAINAGE STRUCTURES SUCH THAT THE NATURAL FLOW OF WATER IS OBSTRUCTED, IT SHALL BE REMOVED AT THE CLOSE OF EACH WORKING DAY. AT THE CONCLUSION OF CONSTRUCTION OPERATIONS, ALL UTILITY STRUCTURES SHALL BE FREE FROM DIRT AND DEBRIS. THE WORK SPECIFIED ABOVE WILL NOT BE PAID FOR SEPARATELY BUT SHALL BE INCLUDED IN THE COST OF INLET FILTERS.

ALL EXISTING OR PROPOSED STORM SEWER DAMAGED BY THE CONTRACTOR DURING CONSTRUCTION SHALL BE REPLACED BY THE CONTRACTOR AND INCLUDED IN THE COST OF HOT-MIX ASPHALT SURFACE REMOVAL, 2 3/4".

MISCELLANEOUS

ACCESS: THE CONTRACTOR SHALL PROVIDE ACCESS TO ABUTTING PROPERTY AT ALL TIMES DURING THE CONSTRUCTION OF THIS PROJECT, EXCEPT FOR PERIODS OF SHORT DURATION. THE COST TO PROVIDE ACCESS SHALL BE PAID FOR AND INCLUDED IN THE ITEM TEMPORARY ACCESS (ROAD) OR TEMPORARY ACCESS (PRIVATE ENTRANCE).

DIMENSIONS: IT SHALL BE THE CONTRACTOR'S RESPONSIBILITY TO VERIFY ALL DIMENSIONS AND CONDITIONS EXISTING IN THE FIELD PRIOR TO ORDERING MATERIALS AND BEGINNING CONSTRUCTION.

ALL SAWCUTTING SHALL BE INCLUDED IN THE COST OF THE REMOVAL ITEMS AND SHALL BE PERFORMED PRIOR TO BEGINNING REMOVAL. ANY ITEMS OF WORK REMOVED PRIOR TO SAWCUTTING WILL NOT BE MEASURED FOR PAYMENT.

CLASS D PATCHES, 6" WILL BE DETERMINED BY THE ENGINEER IN THE FIELD AND WILL NOT EXCEED THE PLANNED QUANTITY.

THE THICKNESSES OF HOT-MIX ASPHALT MIXTURES SHOWN IN THE PLANS ARE NOMINAL. DEVIATIONS MAY OCCUR DUE TO IRREGULARITIES IN THE SURFACES OR BASIS ON WHICH THEY ARE TO BE PLACED. PLAN THICKNESSES SHOULD BE CONSIDERED THE MINIMUM THICKNESS PERMITTED.

FRESH OIL SIGNS SHALL BE POSTED AT BOTH ENDS OF THE ROADWAY AND ALL SIDE STREETS AS DIRECTED BY THE ENGINEER. CONSTRUCTION AHEAD SIGNS SHALL BE PLACED AT ALL SIDE STREETS AND BOTH ENDS OF THE ROADWAY WHILE CONSTRUCTION IS IN PROGRESS. THIS WILL NOT BE PAID FOR SEPARATELY BUT SHALL BE INCLUDED IN THE COST OF TRAFFIC CONTROL STANDARD 701501.

CONTRACTOR SHALL NOT PLACE SOD UNTIL THE TEMPERATURE IS 80 OR LESS AND THE FORECAST FOR THE NEXT 7 DAYS SHOWS TEMPERATURES OF 80 OR LESS. IF ALL OTHER PAY ITEMS ARE COMPLETED, THE CONTRACTOR WILL NOT BE CHARGED WORKING DAYS FOR DELAYS IN PARKWAY RESTORATION DUE TO TEMPERATURE.

NO CONSTRUCTION SHALL BEGIN UNTIL ALL PROPER TEMPORARY SIGNS AND BARRICADES HAVE BEEN INSTALLED.

AT NO TIME SHALL LESS THAN HALF OF THE STREET BE AVAILABLE FOR PARKING.

ALL ROADS MUST HAVE ONLY ONE LONGITUDINAL JOINT WHILE PAVING.

VANDALISM - SPECIAL ATTENTION IS CALLED TO THE SPECIAL PROVISION FOR "INSPECTION" AS WELL AS ARTICLE 107.30 OF THE "STANDARD SPECIFICATIONS." ANY DEFACED WORK AS DETERMINED AND DIRECTED BY THE VILLAGE SHALL BE CORRECTED OR REPLACED TO THE SATISFACTION OF THE ENGINEER BY THE CONTRACTOR AT HIS SOLE EXPENSE PRIOR TO FINAL PAYMENT. THE VILLAGE OF WAYNE WILL COOPERATE WITH THE CONTRACTOR TO MINIMIZE VANDALISM, BUT THE CONTRACTOR SHALL BE ULTIMATELY RESPONSIBLE TO CORRECT ANY DAMAGE. THE VILLAGE WILL NOT BE RESPONSIBLE FOR THE SECURITY OF THE WORK SITE IN THIS REGARD, OTHER THAN NORMAL PATROLLING AND RESPONSE TO EMERGENCIES. THE COST OF ADDITIONAL SECURITY REQUIRED TO MEET THIS SPECIAL PROVISION SHALL BE SOLELY THE CONTRACTOR'S RESPONSIBILITY.

DESCRIPTION	SHEET NO.
COVER SHEET	1
GENERAL NOTES AND HIGHWAY STANDARDS	2
SUMMARY OF QUANTITIES	3
TYPICAL SECTIONS	4
EXISTING CONDITIONS AND REMOVAL PLAN	5-7
PROPOSED PLAN	8-10
PAVEMENT PATCHING FOR HMA SURFACED PAVEMENT (BD 22)	11
BUTT JOINT AND HMA TAPER DETAILS (BD-32)	12
TRAFFIC CONTROL AND PROTECTION FOR SIDE ROADS, INTERSECTIONS, AND DRIVEWAYS (TC-10)	13
DISTRICT ONE TYPICAL PAVEMENT MARKINGS (TC-13)	14
ARTERIAL ROAD INFORMATION SIGN (TC-22)	15

**HIGHWAY STANDARDS**

000001-06	STANDARD SYMBOLS, ABBREVIATIONS, AND PATTERNS
424001-08	PERPENDICULAR CURB RAMPS FOR SIDEWALKS
442201-03	CLASS C AND D PATCHES
701006-05	OFF ROAD OPERATIONS, 2L, 2W, 15' TO 24" FROM PAVEMENT EDGE
701301-04	LANE CLOSURE, 2L, 2W, SHORT TIME OPERATIONS
701311-03	LANE CLOSURE, 2L, 2W, MOVING OPERATIONS - DAY ONLY
701501-06	URBAN LANE CLOSURE, 2L, 2W, UNDIVIDED
701801-06	SIDEWALK, CORNER OR CROSSWALK CLOSURE
701901-05	TRAFFIC CONTROL DEVICES

## SUMMARY OF QUANTITIES

			CONSTRUCTION CODE 0005
ITEM NO.	ITEM	UNIT	Quantity
~	28000510 INLET FILTERS	EACH	5
~	40600290 BITUMINOUS MATERIALS (TACK COAT)	POUND	6,850
	40600400 MIXTURE FOR CRACKS, JOINTS, AND FLANGEWAYS	TON	15
	40600625 LEVELING BINDER (MACHINE METHOD), N50	TON	500
	40600982 HOT-MIX ASPHALT SURFACE REMOVAL - BUTT JOINT	SQ YD	500
	40603335 HOT-MIX ASPHALT SURFACE COURSE, MIX "D", N50	TON	1,000
	42400200 PORTLAND CEMENT CONCRETE SIDEWALK 5 INCH	SQ FT	120
	42400800 DETECTABLE WARNINGS	SQ FT	40
	44000160 HOT-MIX ASPHALT SURFACE REMOVAL, 2 3/4"	SQ YD	8,600
	44000600 SIDEWALK REMOVAL	SQ FT	120
	44201713 CLASS D PATCHES, TYPE I, 6 INCH	SQ YD	215
	44201717 CLASS D PATCHES, TYPE II, 6 INCH	SQ YD	215
	44201721 CLASS D PATCHES, TYPE III, 6 INCH	SQ YD	215
	44201723 CLASS D PATCHES, TYPE IV, 6 INCH	SQ YD	215
	44300200 STRIP REFLECTIVE CRACK CONTROL TREATMENT	FOOT	3,400
	48101498 AGGREGATE SHOULDERS, TYPE B 4"	SQ YD	600
	67100100 MOBILIZATION	L SUM	1
	70102620 TRAFFIC CONTROL AND PROTECTION, STANDARD 701501	L SUM	1
	70102640 TRAFFIC CONTROL AND PROTECTION, STANDARD 701801	L SUM	1
	70106800 CHANGEABLE MESSAGE SIGN	CAL MO	1
	70300100 SHORT TERM PAVEMENT MARKING	FOOT	500
	70300150 SHORT TERM PAVEMENT MARKING REMOVAL	SQ FT	150
	72000100 SIGN PANEL - TYPE 1	SQ FT	40
	72900100 METAL POST - TYPE A	FOOT	30
*	78000100 THERMOPLASTIC PAVEMENT MARKING - LETTERS AND SYMBOLS	SQ FT	265
*	78000200 THERMOPLASTIC PAVEMENT MARKING - LINE 4"	FOOT	12,000
*	78000400 THERMOPLASTIC PAVEMENT MARKING - LINE 6"	FOOT	108
*	78000600 THERMOPLASTIC PAVEMENT MARKING - LINE 12"	FOOT	114
~	X4021000 TEMPORARY ACCESS (PRIVATE ENTRANCE)	EACH	33
~	X4023000 TEMPORARY ACCESS (ROAD)	EACH	9
~	Z0013798 CONSTRUCTION LAYOUT	L SUM	1
~	Z0030850 TEMPORARY INFORMATION SIGNING	SQ FT	50
	*INDICATES SPECIALTY ITEM		
	~INDICATES SPECIAL PROVISION		

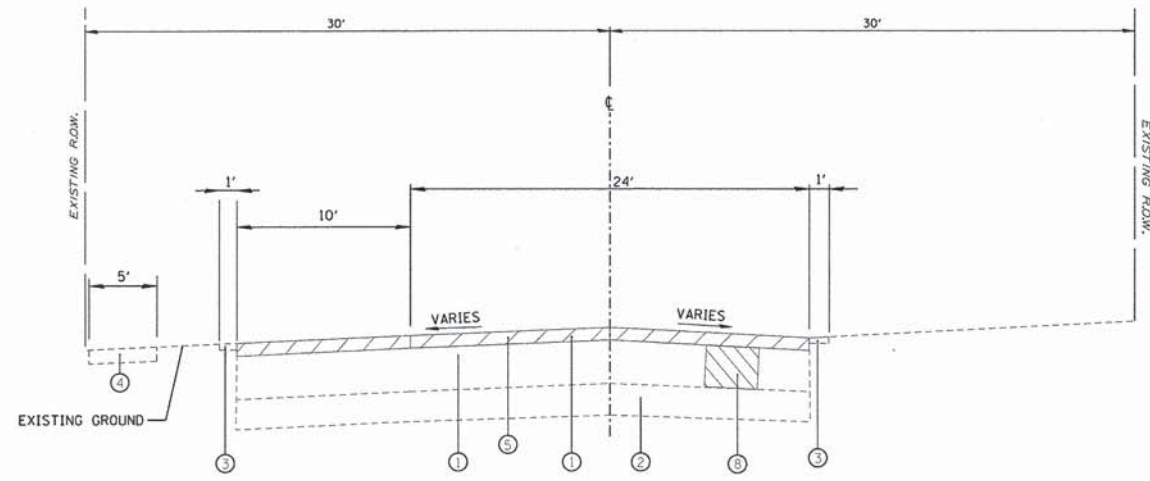

**EXISTING TYPICAL SECTION**  
STA. 10+00 TO STA 16+55, ARMY TRAIL ROAD

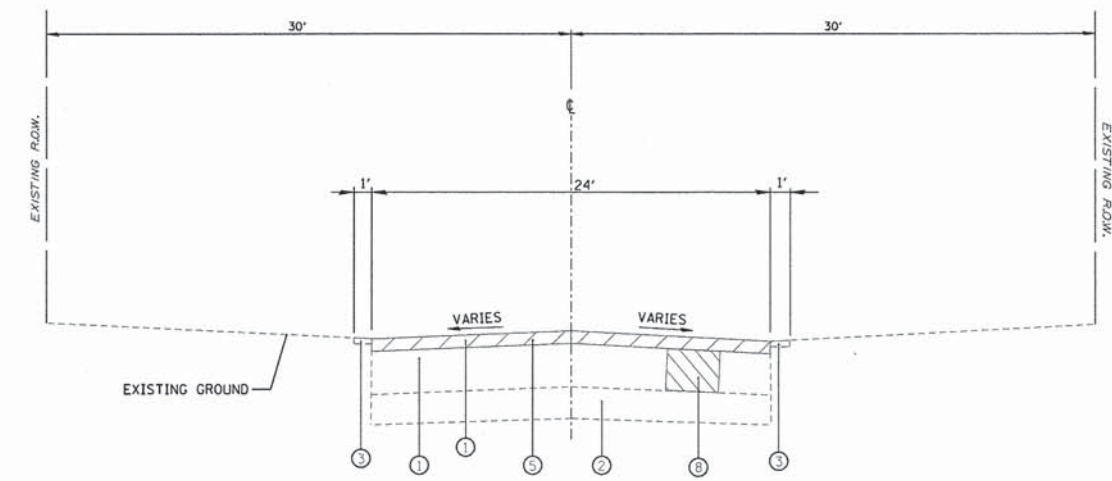

**EXISTING TYPICAL SECTION**  
STA. 16+55 TO STA 41+24.96, ARMY TRAIL ROAD

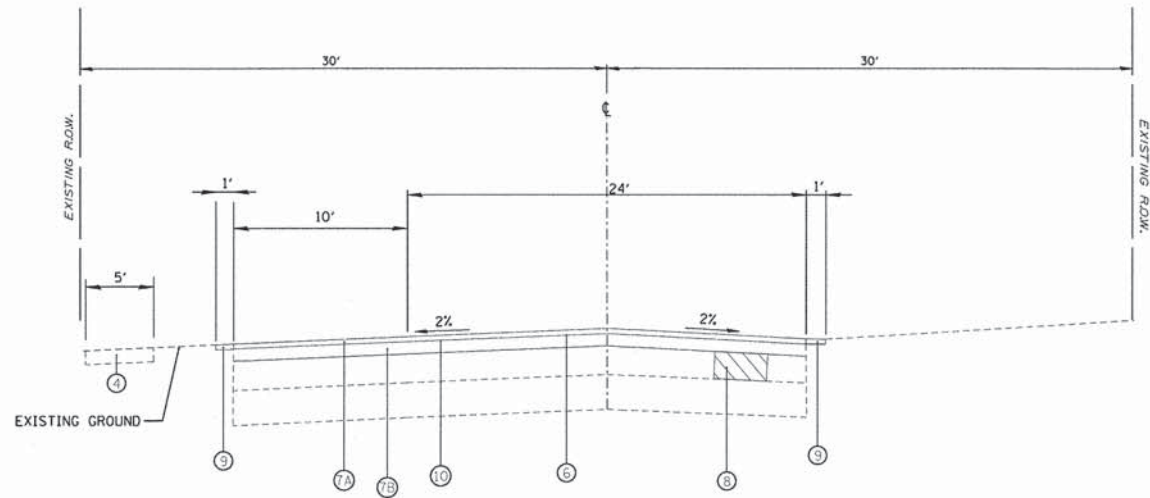

**PROPOSED TYPICAL SECTION**  
STA. 10+00 TO STA 16+55, ARMY TRAIL ROAD

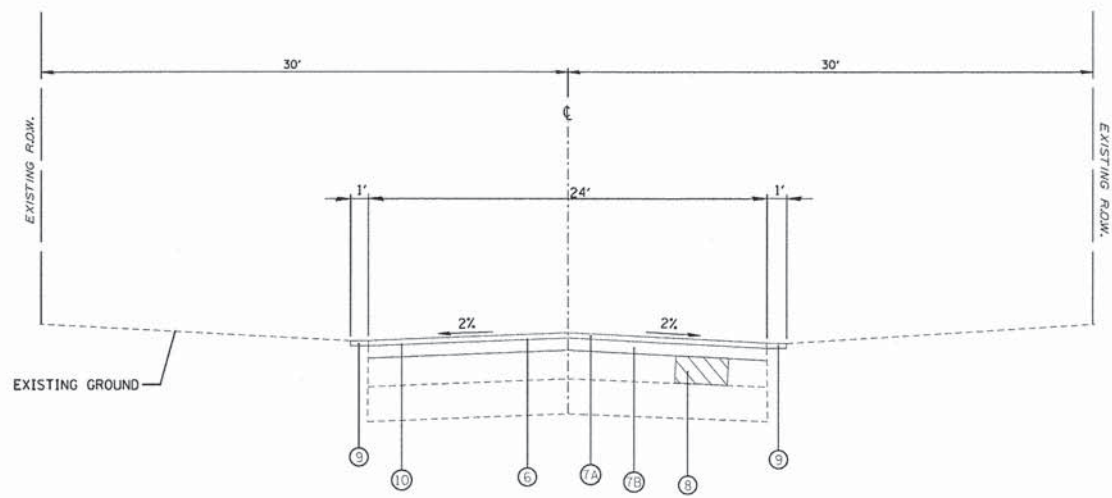

**PROPOSED TYPICAL SECTION**  
STA. 16+55 TO STA 41+24.96, ARMY TRAIL ROAD

**LEGEND**

**EXISTING**

- ① EXISTING HOT-MIX ASPHALT PAVEMENT
- ② EXISTING AGGREGATE BASE
- ③ EXISTING GRAVEL SHOULDER
- ④ EXISTING SIDEWALK



**PROPOSED**

- ⑤ HOT-MIX ASPHALT SURFACE REMOVAL, 2 3/4"
- ⑥ PROPOSED BITUMINOUS MATERIAL (TACK COAT)
- ⑦ HOT-MIX ASPHALT PAVEMENT (FULL DEPTH) - 3"
- ⑦A \*HOT-MIX ASPHALT SURFACE COURSE, MIX "D" N50 - 2"
- ⑦B \*LEVELING BINDER COURSE, (MACHINE METHOD), N50 - 1"
- ⑧ CLASS D PATCHES, 6" (AS DIRECTED BY THE ENGINEER)
- ⑨ AGGREGATE SHOULDERS, TYPE B 4"
- ⑩ STRIP REFLECTIVE CRACK CONTROL

**NOTE:**

PAVING OF THE FULL ROADWAY WIDTH SHALL BE COMPLETED AT THE END OF EACH DAY OF PAVING TO PREVENT A LONGITUDINAL COLD JOINT FROM APPEARING WHEN OPPOSITE SIDES OF THE ROAD ARE PAVED ON DIFFERENT DAYS. THE CONTRACTOR SHALL ALSO ENSURE THAT AT THE END OF EACH DAY EACH PASS ENDS AT APPROXIMATELY THE SAME STATION TO PREVENT A COLD JOINT.

**NOTES:**

- 1. THE HIGH SIDE OF THE ROADWAY SHALL BE PAVED FIRST.

HOT-MIX ASPHALT MIXTURE REQUIREMENTS ITEM	VOIDS
HOT-MIX ASPHALT SURFACE COURSE, MIX "D", N50 (IL 9.5 mm), 2"	4% @ 50 GYR.
LEVELING BINDER (MACHINE METHOD), IL 9.5 mm, N50, 1" (SHALL BE PLACED IN 1 LIFT) (WITH STRIP REFLECTIVE CRACK CONTROL)	4% @ 50 GYR.
CLASS D PATCHES, 6" (HMA BINDER IL-19 mm)	4% @ 70 GYR.

**MIXTURE REQUIREMENT NOTES:**

- 1. THE UNIT WEIGHT USED TO CALCULATE ALL HOT-MIX ASPHALT SURFACE MIXTURE IS 112 LBS/SY/IN. THE "AC TYPE" FOR POLYMERIZED HMA MIXES SHALL BE "SBS/SBR PG 76-22" AND FOR NON-POLYMERIZED HMA THE "AC TYPE" SHALL BE "PG 64-22" UNLESS MODIFIED BY DISTRICT ONE SPECIAL PROVISIONS.
- 2. FOR "PERCENT OF RAP AND RAS" SEE DISTRICT ONE SPECIAL PROVISIONS.

FILE NAME *	USER NAME = jlapaglia	DESIGNED - LMF	REVISED -
N:\WAYNE\9143H\H200-H299\9143H207\Civil\typr_910043H207-01.dwg		DRAWN - EDT	REVISED -
	PLOT SCALE = NOT TO SCALE	CHECKED - JGS	REVISED -
	PLOT DATE = 2/8/2016	DATE - #DATE#	REVISED -



**STATE OF ILLINOIS  
DEPARTMENT OF TRANSPORTATION**

**ARMY TRAIL ROAD  
TYPICAL SECTIONS**

SCALE: 5/8" SHEET NO. 4 OF 15 SHEETS STA. TO STA.

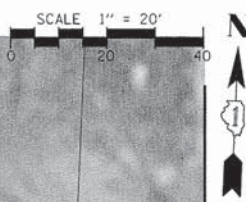
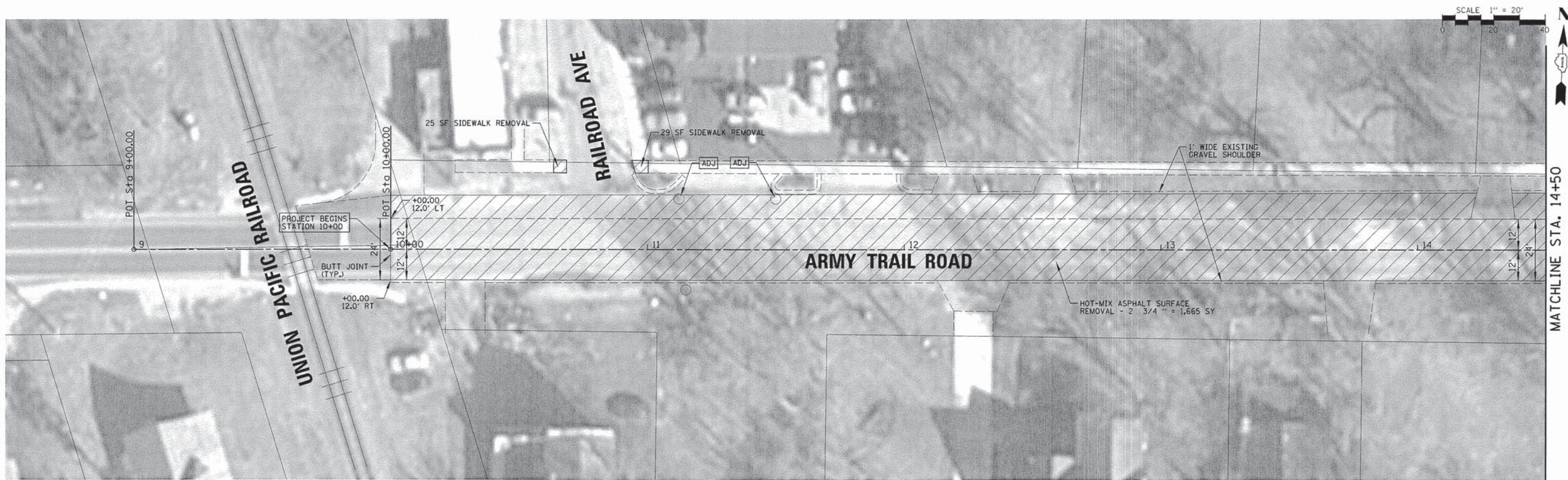
F.A.U. RTE.	SECTION	COUNTY	TOTAL SHEETS	SHEET NO.
1368	15-00011-00-RS	DUPAGE	15	4
ILLINOIS FED. AID PROJECT			CONTRACT NO. 61C57	



**LEGEND:**  
 HOT-MIX ASPHALT SURFACE REMOVAL - 2 3/4"  
 1' WIDE EXISTING GRAVEL SHOULDER

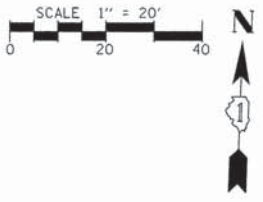

FILE NAME =	USER NAME = jlapaglia	DESIGNED - LMF	REVISED -	<b>STATE OF ILLINOIS DEPARTMENT OF TRANSPORTATION</b>	<b>ARMY TRAIL ROAD EXISTING CONDITIONS AND REMOVAL PLAN</b>		F.A.U. RTE. 1368	SECTION 15-00011-00-RS	COUNTY LAKE	TOTAL SHEETS 15	SHEET NO. 5
N:\WAYNE\9143H\H200\H299\9143H207\Civ	\rem_910043H207-01.sht	DRAWN - FCP	REVISED -		SCALE: 20'	SHEET NO. 5 OF 15 SHEETS	STA.	TO STA.	CONTRACT NO. 61C57		ILLINOIS FED. AID PROJECT
	PLOT SCALE = 20'	CHECKED - JGS	REVISED -								
	PLOT DATE = 2/8/2016	DATE - \$DATE\$	REVISED -								

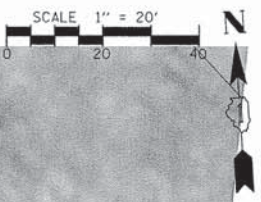
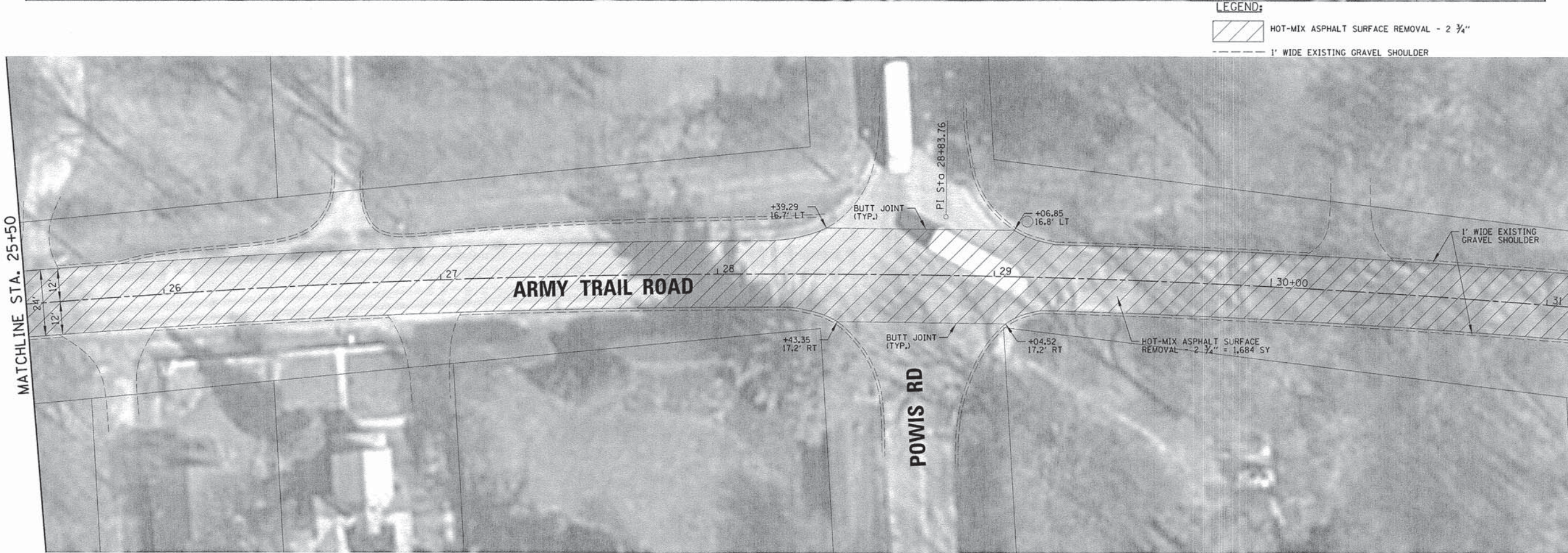
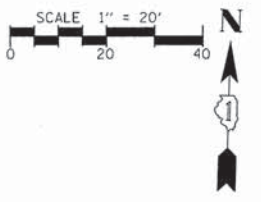
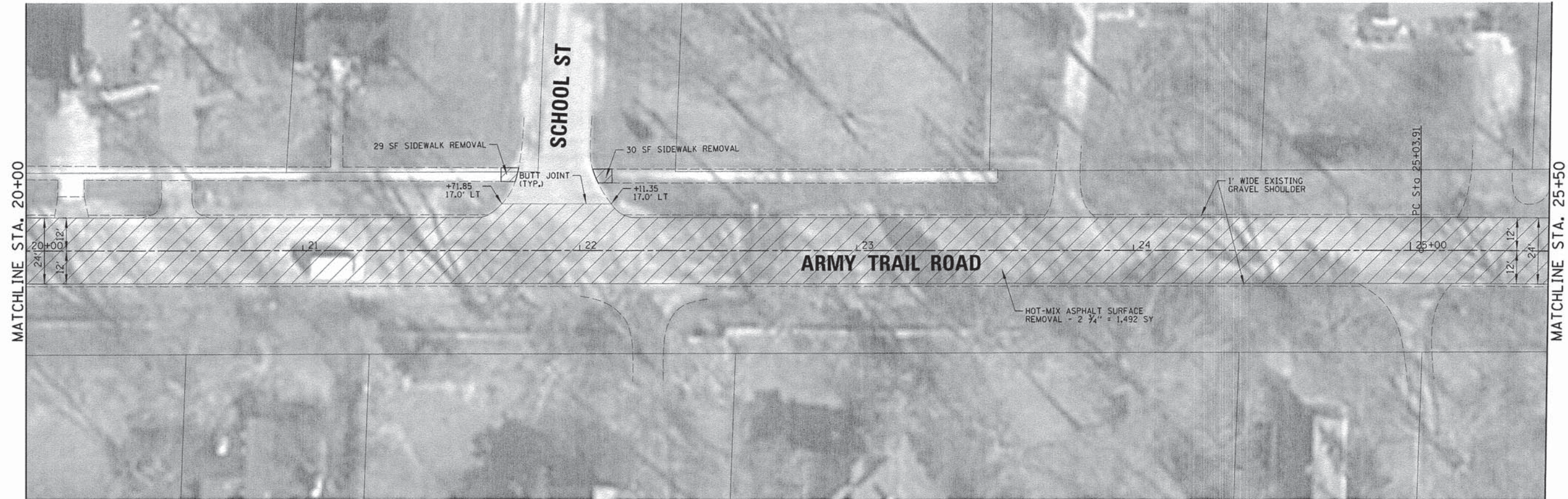

**LEGEND:**  
 HOT-MIX ASPHALT SURFACE REMOVAL - 2 3/4"  
 1' WIDE EXISTING GRAVEL SHOULDER

FILE NAME *	USER NAME = jlepegio	DESIGNED - LMF	REVISED -
N:\WAYNE\9143H\H200-H299\9143H207\Civil\rem_910043.H207-02.sht		DRAWN - FCP	REVISED -
PLOT SCALE = 20'		CHECKED - JGS	REVISED -
PLOT DATE = 2/8/2016		DATE - *DATE*	REVISED -



**STATE OF ILLINOIS  
DEPARTMENT OF TRANSPORTATION**

**ARMY TRAIL ROAD  
EXISTING CONDITIONS AND REMOVAL PLAN**

SCALE: 20' SHEET NO. 6 OF 15 SHEETS STA. TO STA.

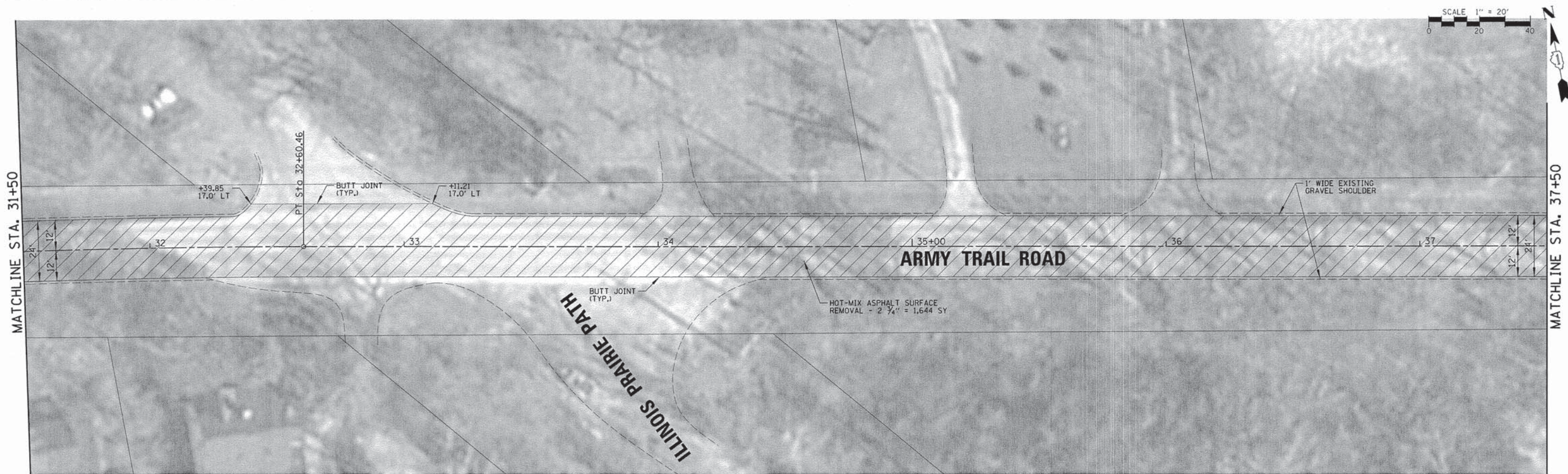
F.A.U. RTE.	SECTION	COUNTY	TOTAL SHEETS	SHEET NO.
1368	15-00011-00-RS	LAKE	15	6
CONTRACT NO. 61C57				
ILLINOIS FED. AID PROJECT				



**LEGEND:**  
 HOT-MIX ASPHALT SURFACE REMOVAL - 2 3/4"  
 1' WIDE EXISTING GRAVEL SHOULDER

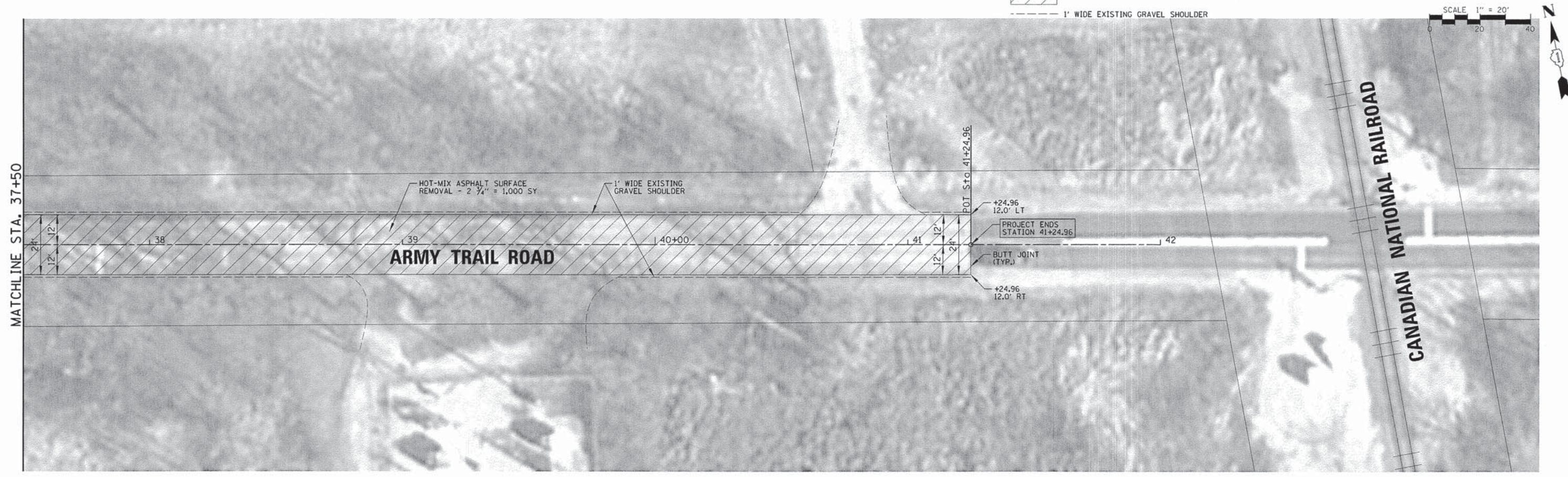

FILE NAME *	USER NAME = jlopaglia	DESIGNED - LMF	REVISED -	<b>STATE OF ILLINOIS DEPARTMENT OF TRANSPORTATION</b>	<b>ARMY TRAIL ROAD EXISTING CONDITIONS AND REMOVAL PLAN</b>			F.A.U. RTE.	SECTION	COUNTY	TOTAL SHEETS	SHEET NO.
N:\WAYNE\9143H\H200-H299\9143H207\Civild\rem_910043.H207-03.sht		DRAWN - FCP	REVISED -		1368	15-00011-00-RS	LAKE	15	7			
PLOT SCALE = 20'		CHECKED - JGS	REVISED -		CONTRACT NO. 61C57							
PLOT DATE = 2/8/2016		DATE - @DATE*	REVISED -		ILLINOIS FED. AID PROJECT							

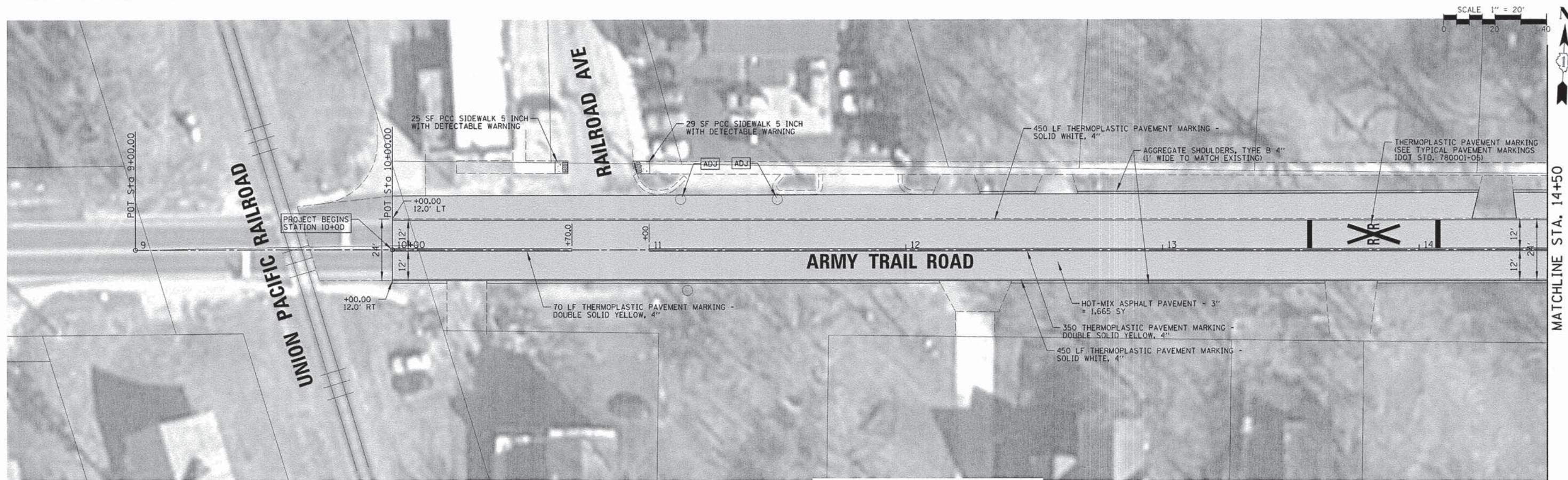

**LEGEND:**

	HOT-MIX ASPHALT SURFACE COURSE, MIX "D", N50, 2"
	LEVELING BINDER (MACHINE METHOD), IL 9.5 mm N50, 1" (WITH STRIP REFLECTIVE CRACK CONTROL)
	AGGREGATE SHOULDER, TYPE B-4"

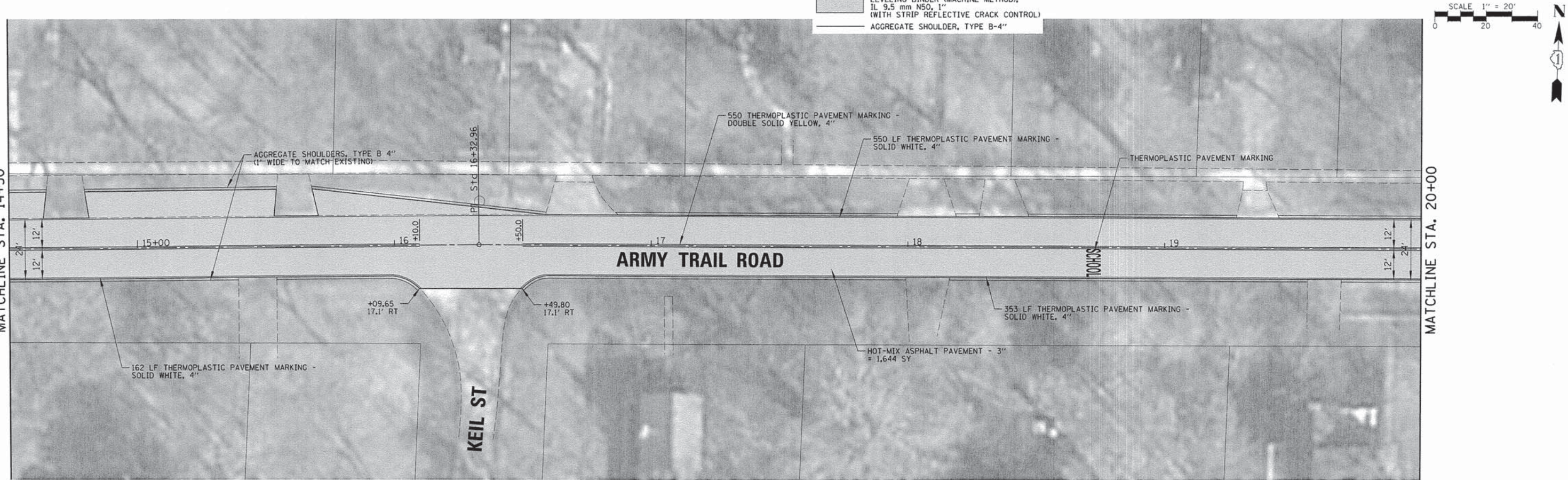

FILE NAME =	USER NAME = jlopaglio	DESIGNED - LMF	REVISED -	<b>STATE OF ILLINOIS DEPARTMENT OF TRANSPORTATION</b>	<b>ARMY TRAIL ROAD PROPOSED ROADWAY IMPROVEMENTS PLAN</b>		F.A.U. RTE.	SECTION	COUNTY	TOTAL SHEETS	SHEET NO.
N:\WAYNE\9143H\H200-H299\9143H207\Civil\pro_910043.H207-01.sht		DRAWN - FCP	REVISED -				1368	15-00011-00-RS	LAKE	15	8
PLOT SCALE = 20'		CHECKED - JGS	REVISED -				CONTRACT NO. 61C57				
PLOT DATE = 2/8/2016		DATE - *DATE*	REVISED -				ILLINOIS FED. AID PROJECT				
				SCALE: 20'	SHEET NO. 8 OF 15 SHEETS	STA. TO STA.					



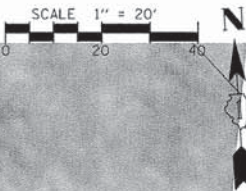
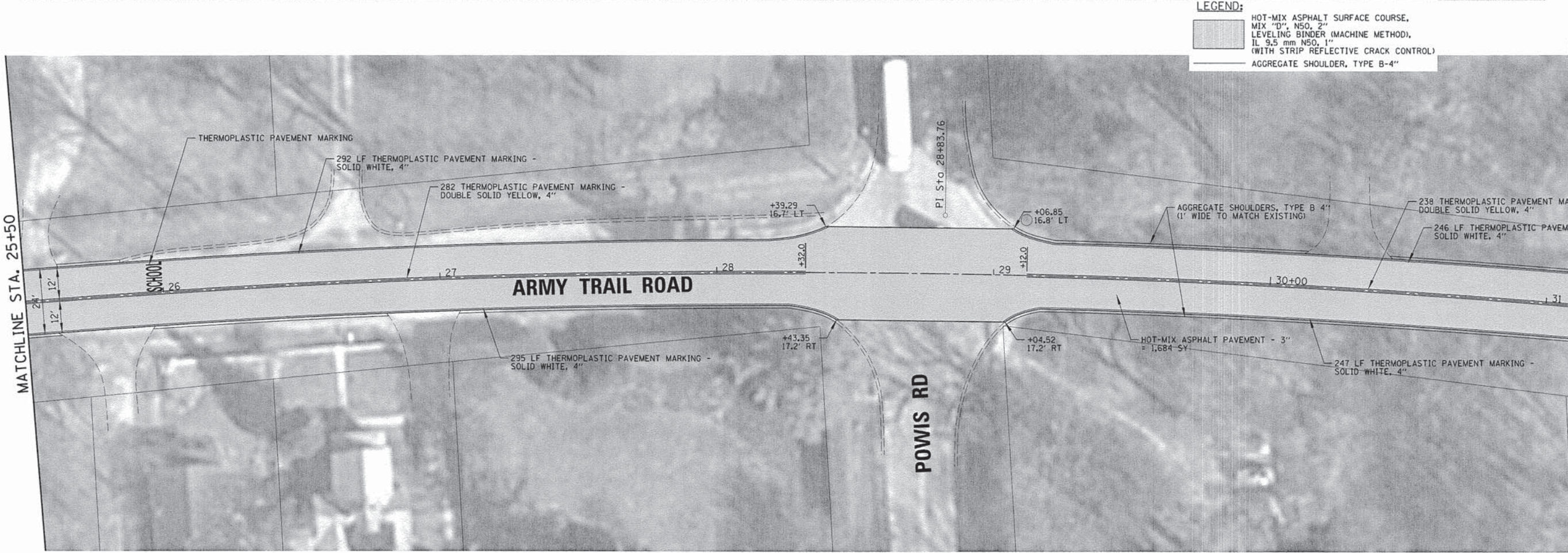
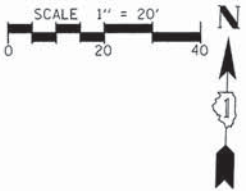
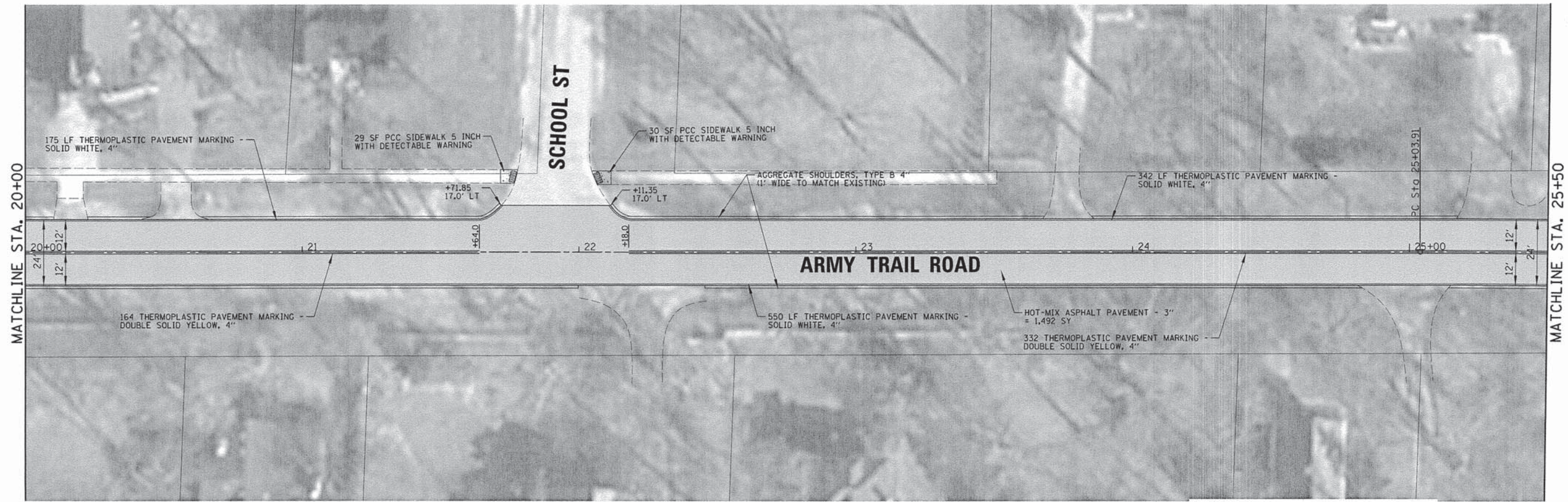

**LEGEND:**

- HOT-MIX ASPHALT SURFACE COURSE, MIX "D", N50, 2" LEVELING BINDER (MACHINE METHOD), IL 9.5 mm N50, 1" (WITH STRIP REFLECTIVE CRACK CONTROL)
- AGGREGATE SHOULDER, TYPE B-4"

FILE NAME =	USER NAME = jlapaglia	DESIGNED - LMF	REVISED -
\\NWAYNE\9143H\200-H299\9143H207\Civil\proj\910043\H207-02.sht		DRAWN - FCP	REVISED -
	PLOT SCALE = 20'	CHECKED - JGS	REVISED -
	PLOT DATE = 2/8/2016	DATE - #DATE#	REVISED -

**STATE OF ILLINOIS  
DEPARTMENT OF TRANSPORTATION**

<b>ARMY TRAIL ROAD PROPOSED ROADWAY IMPROVEMENTS PLAN</b>			
SCALE: 20'	SHEET NO. 9 OF 15 SHEETS	STA. _____	TO STA. _____

F.A.U. RTE. 1368	SECTION 15-00011-00-RS	COUNTY LAKE	TOTAL SHEETS 15	SHEET NO. 9
CONTRACT NO. 61C57				
ILLINOIS FED. AID PROJECT				

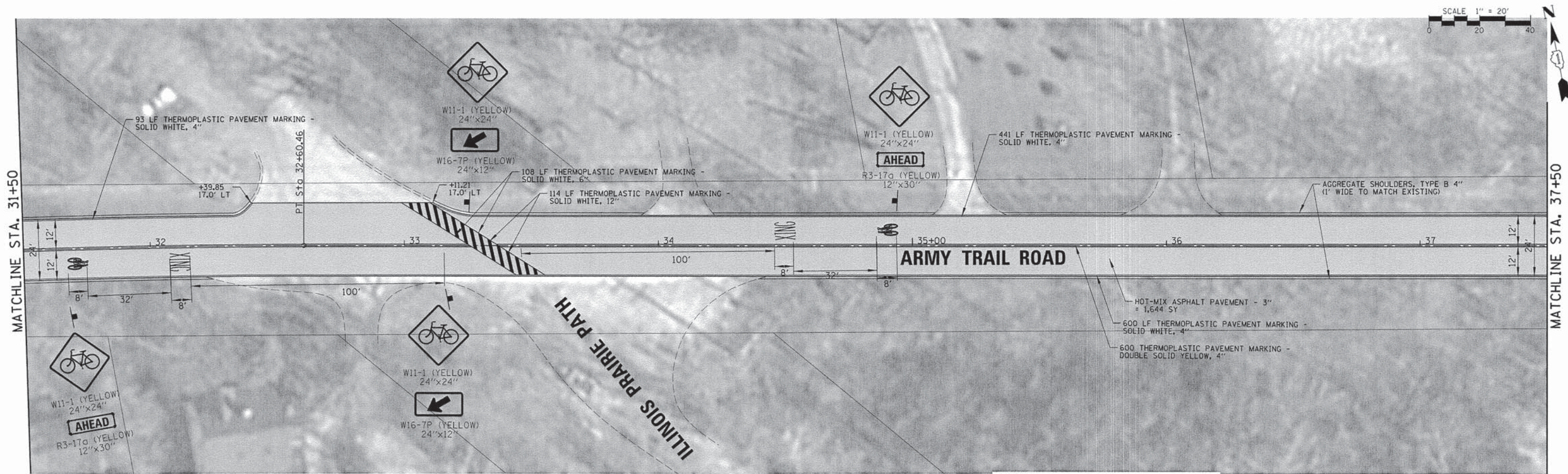

**LEGEND:**

- HOT-MIX ASPHALT SURFACE COURSE, MIX "D", NSO, 2"
- LEVELING BINDER (MACHINE METHOD), IL 9.5 mm NSO, 1" (WITH STRIP REFLECTIVE CRACK CONTROL)
- AGGREGATE SHOULDER, TYPE B-4"

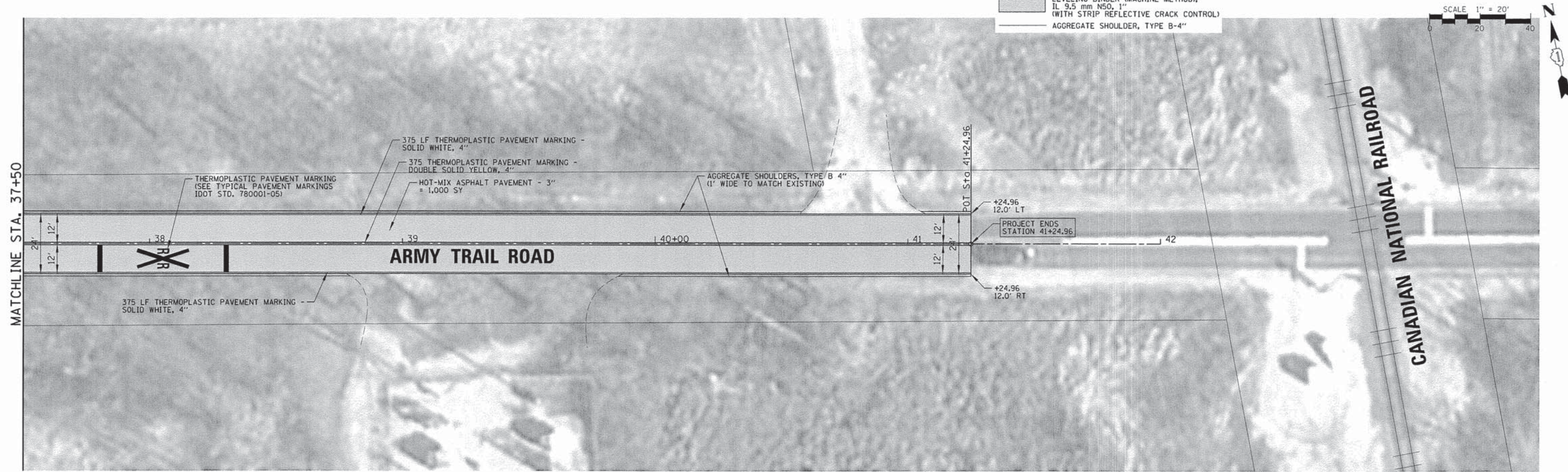

FILE NAME =	USER NAME = jlopaglia	DESIGNED - LMF	REVISED -	<b>STATE OF ILLINOIS DEPARTMENT OF TRANSPORTATION</b>	<b>ARMY TRAIL ROAD PROPOSED ROADWAY IMPROVEMENTS PLAN</b>	F.A.U. RTE. 1368	SECTION 15-00011-00-RS	COUNTY LAKE	TOTAL SHEETS 15	SHEET NO. 10		
	PLOT SCALE = 20'	DRAWN - FCP	REVISED -			SCALE: 20'	SHEET NO. 10 OF 15 SHEETS	STA.	TO STA.	CONTRACT NO. 61C57		
	PLOT DATE = 2/8/2016	CHECKED - JGS	REVISED -			ILLINOIS FED. AID PROJECT						
		DATE - *DATE*	REVISED -									



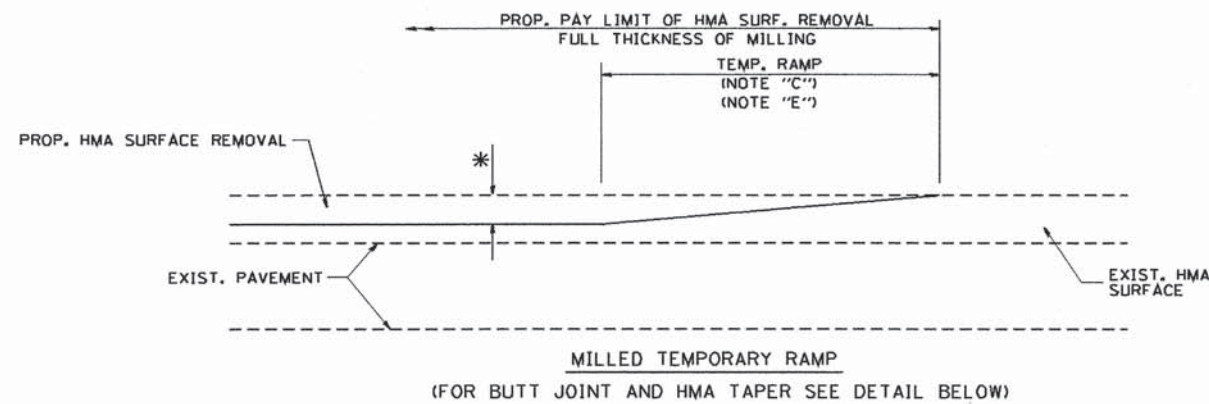

OPTION 1

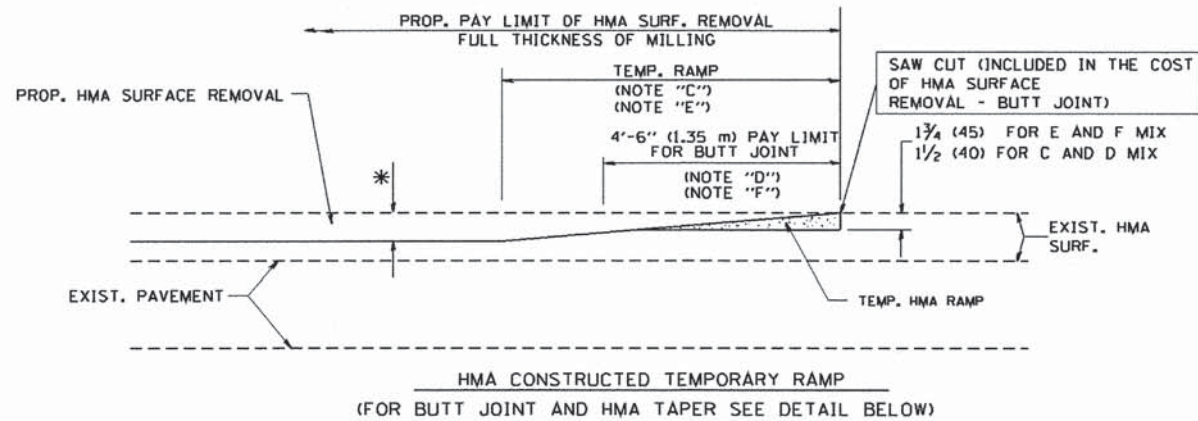

OPTION 2  
TYPICAL TEMPORARY RAMP

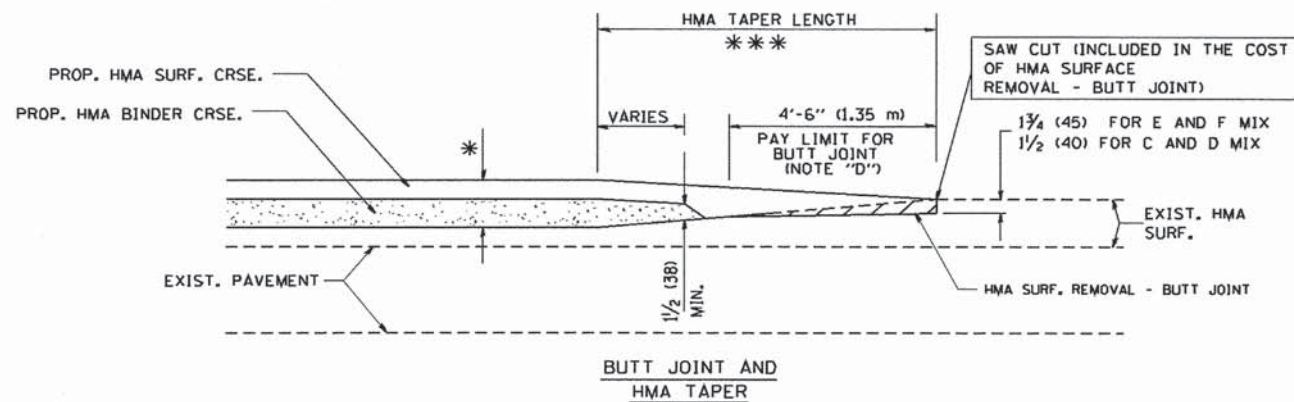

TYPICAL BUTT JOINT AND HMA TAPER  
FOR MILLING AND RESURFACING

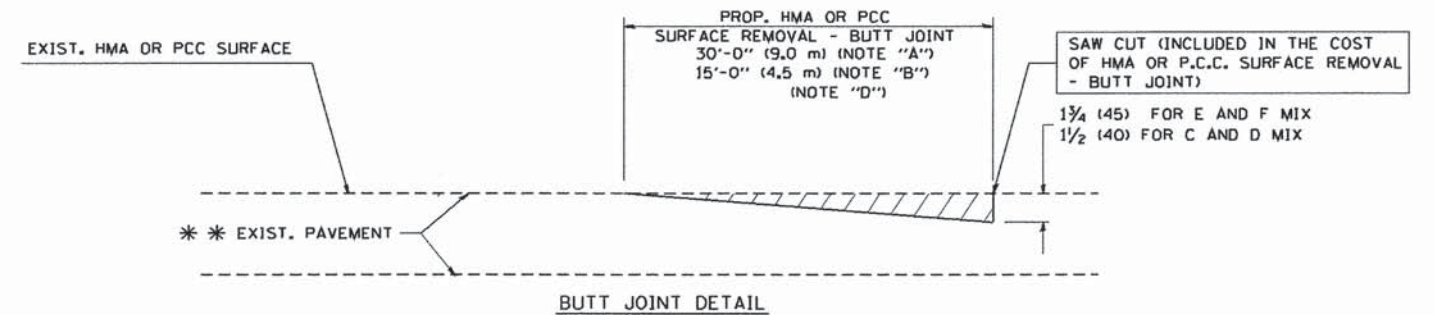

BUTT JOINT DETAIL

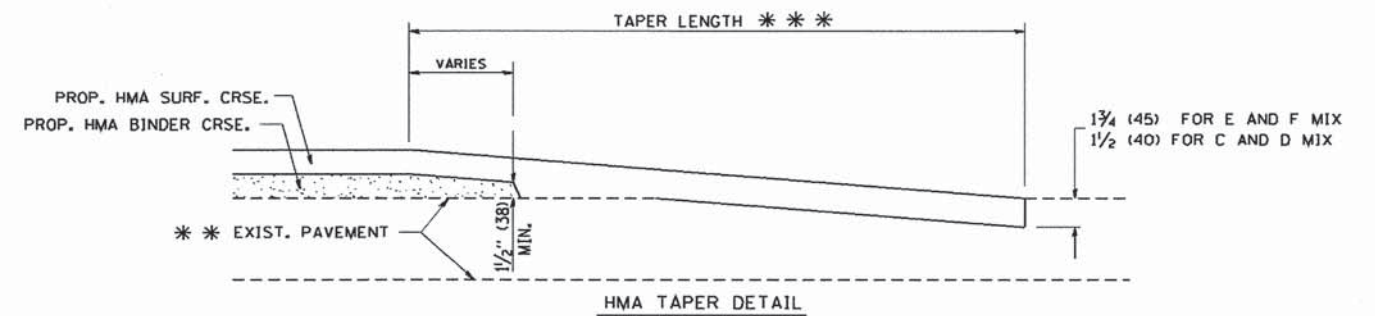

HMA TAPER DETAIL

TYPICAL BUTT JOINT AND HMA TAPER  
FOR RESURFACING ONLY

\*\*\* PC CONCRETE, HMA OR HMA RESURFACED PAVEMENT.

NOTES

- A: MAINLINE ROADWAYS AND MAJOR SIDE ROADS.
  - B: MINOR SIDE ROADS.
  - C: THE TEMP. RAMP SHALL BE CONSTRUCTED IMMEDIATELY UPON REMOVAL OF THE EXISTING HMA SURFACE.
  - D: THE BUTT JOINT SHALL BE CONSTRUCTED IMMEDIATELY PRIOR TO PLACING THE PROPOSED HMA COURSES.
  - E: TAPER THE TEMP. RAMP AT A RATE OF 3'-0" (900 mm) PER 1 INCH (25 mm) OF MILLING THICKNESS.
  - F: INSTALLATION AND REMOVAL OF THE 4'-6" (1.35 m) TEMP. RAMP IS INCLUDED IN COST OF HMA SURFACE REMOVAL - BUTT JOINT
  - G: SEE ARTICLE 406.08 AND 406.14 OF THE STANDARD SPECIFICATIONS FOR "HMA AND/OR PCC SURFACE REMOVAL, BUTT JOINT".
- \* SEE TYPICAL SECTIONS FOR MILLING THICKNESS.
- \*\*\* 20'-0" (6.1 m) PER 1 (25) RESURFACING (NOTE "A")  
10'-0" (3.0 m) PER 1 (25) RESURFACING (NOTE "B")

BASIS OF PAYMENT:

ALL BUTT JOINTS ARE INCIDENTAL TO THE SURFACE COURSE.

ALL DIMENSIONS ARE IN INCHES (MILLIMETERS) UNLESS OTHERWISE SHOWN.

FILE NAME = W:\diststd\22x34\bd32.dgn

USER NAME = geg11enabt  
PLOT SCALE = 50.0000' / IN.  
PLOT DATE = 1/4/2008

DESIGNED - M. DE YONG  
DRAWN -  
CHECKED -  
DATE - 06-13-90

REVISED - R. SHAH 10-25-94  
REVISED - A. ABBAS 03-21-97  
REVISED - M. GOMEZ 04-06-01  
REVISED - R. BORO 01-01-07

STATE OF ILLINOIS  
DEPARTMENT OF TRANSPORTATION

BUTT JOINT AND  
HMA TAPER DETAILS

SCALE: NONE SHEET NO. 1 OF 1 SHEETS STA. TO STA.

F.A. RTE. 1368	SECTION 15-00011-00-RS	COUNTY DuPAGE	TOTAL SHEETS 15	SHEET NO. 12
BD400-05 BD32			CONTRACT NO. 61C57	
FED. ROAD DIST. NO. 1 ILLINOIS FED. AID PROJECT				

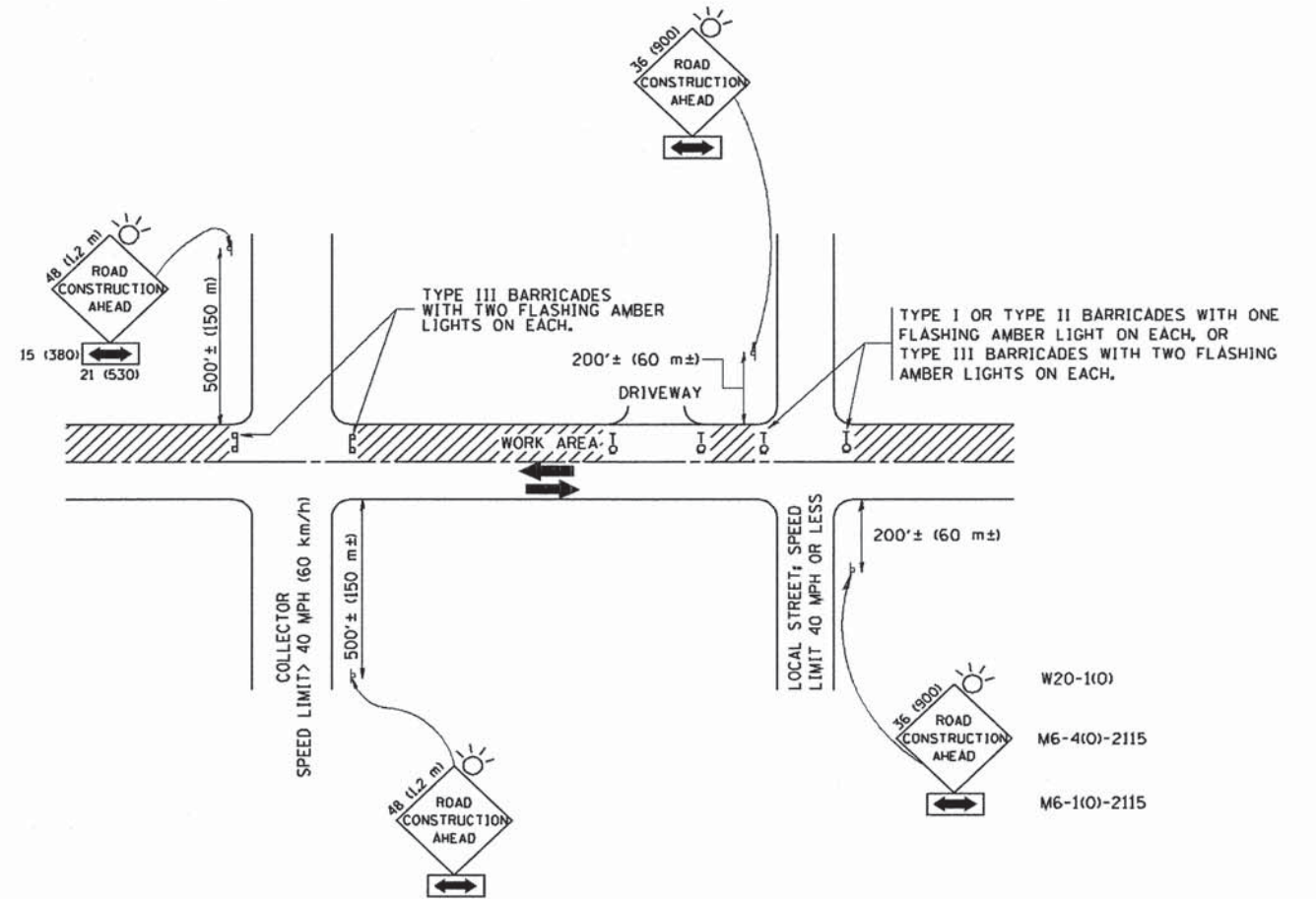

TRAFFIC CONTROL AND PROTECTION FOR SIDE ROADS, INTERSECTIONS, AND DRIVEWAYS

NOTES:

- A. FOR NO LANE RESTRICTION ON THE SIDE ROAD OR DRIVEWAYS
  1. SIDE ROAD WITH A SPEED LIMIT OF 40 MPH (60 km/h) OR LESS AS SHOWN ON THE DRAWING AND AS DIRECTED BY THE ENGINEER:
    - a) ONE ROAD CONSTRUCTION AHEAD SIGN 36 x 36 (900x900) WITH A FLASHER AND FLAG MOUNTED ON IT APPROXIMATELY 200' (60 m) IN ADVANCE OF THE MAIN ROUTE.
    - b) THE CLOSED PORTION OF THE MAIN ROUTE SHALL BE PROTECTED BY BLOCKING WITH TYPE I, TYPE II OR TYPE III BARRICADES, 1/3 OF THE CROSS SECTION OF THE CLOSED PORTION.
  2. SIDE ROAD WITH A SPEED LIMIT GREATER THAN 40 MPH (60 km/h) AS SHOWN ON THE DRAWING AND AS DIRECTED BY THE ENGINEER:
    - a) ONE ROAD CONSTRUCTION AHEAD SIGN 48 x 48 (1.2 m x 1.2 m) WITH A FLASHER MOUNTED ON IT APPROXIMATELY 500' (150 m) IN ADVANCE OF THE MAIN ROUTE.
    - b) THE CLOSED PORTION OF THE MAIN ROUTE SHALL BE PROTECTED BY BLOCKING WITH TYPE III BARRICADES, 1/2 OF THE CROSS SECTION OF THE CLOSED PORTION.
- 3. WHEN THE SIDE ROAD LIES BETWEEN THE BEGINNING OF THE MAINLINE SIGNING AND THE WORK ZONE, A SINGLE HEADED ARROW (M6-1) SHALL BE USED IN LIEU OF THE DOUBLE HEADED ARROW (M6-4).
- B. FOR A LANE CLOSURE ON A SIDE ROAD OR DRIVEWAY:
 

USE APPLICABLE PORTIONS OF THE TYPICAL APPLICATION OF TRAFFIC CONTROL DEVICES (STD. 701501, STD. 701606 OR THE APPROPRIATE STANDARD). THE SPACING OF SIGNS AND BARRICADES SHALL BE ADJUSTED FOR FIELD CONDITIONS AS DIRECTED BY THE ENGINEER. THE DIRECTIONAL ARROW SHALL BE COVERED OR REMOVED WHEN NO LONGER CONSISTENT WITH THE SIDE ROAD LANE CLOSURE.
- C. ADVANCE WARNING SIGNS ARE TO BE OMITTED ON DRIVEWAY UNLESS OTHERWISE NOTED.
- D. THE TRAFFIC CONTROL AND PROTECTION FOR SIDE ROADS, INTERSECTIONS, AND DRIVEWAYS SHALL BE INCIDENTAL TO THE COST OF SPECIFIED TRAFFIC CONTROL STANDARDS OR ITEMS.

All dimensions are in millimeters (inches) unless otherwise shown.

FILE NAME =	USER NAME = goglienobt	DESIGNED - LHA	REVISED - J. OBERLE 10-18-95
W:\distatd\22x34\tcl8.dgn		DRAWN -	REVISED - A. HOUSEH 03-06-96
		CHECKED -	REVISED - A. HOUSEH 10-15-96
		DATE - 06-89	REVISED - T. RAMMACHER 01-06-00

STATE OF ILLINOIS  
DEPARTMENT OF TRANSPORTATION

TRAFFIC CONTROL AND PROTECTION FOR  
SIDE ROADS, INTERSECTIONS, AND DRIVEWAYS

SCALE: NONE SHEET NO. #SHDF 15 SHEETS STA. TO STA.

F.A. RTE.	SECTION	COUNTY	TOTAL SHEETS	SHEET NO.
1368	15-00011-00-RS	DuPAGE	15	13
TC-10			CONTRACT NO. 61C57	
FED. ROAD DIST. NO. 1 ILLINOIS FED. AID PROJECT				

D(FT)	SPEED LIMIT
345	30
425	35
500	40
580	45
665	50
750	55

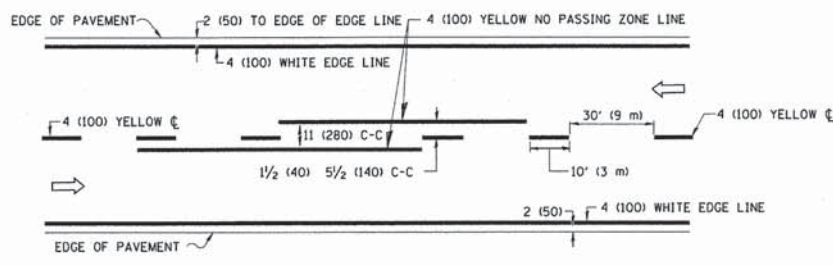

**2-LANE ROADWAY**

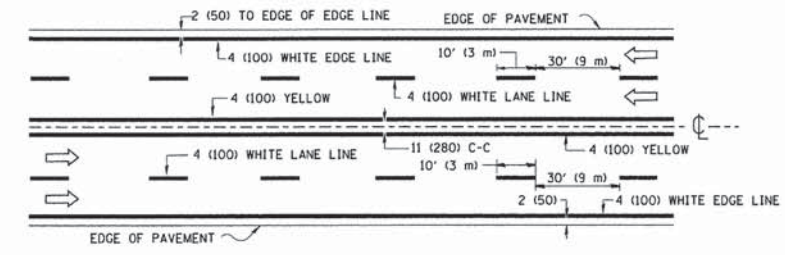

**MULTI-LANE UNDIVIDED**

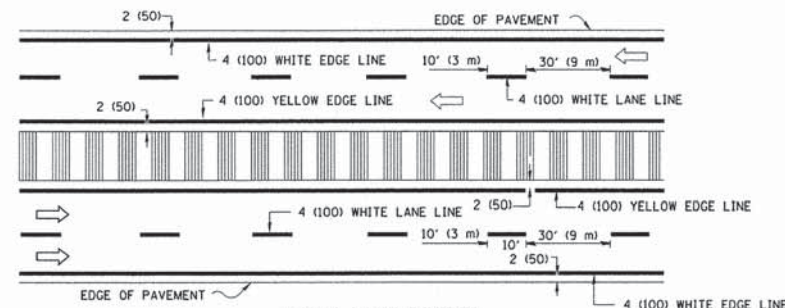

**MULTI-LANE DIVIDED WITH MEDIAN**

**TYPICAL LANE AND EDGE LINE MARKING**

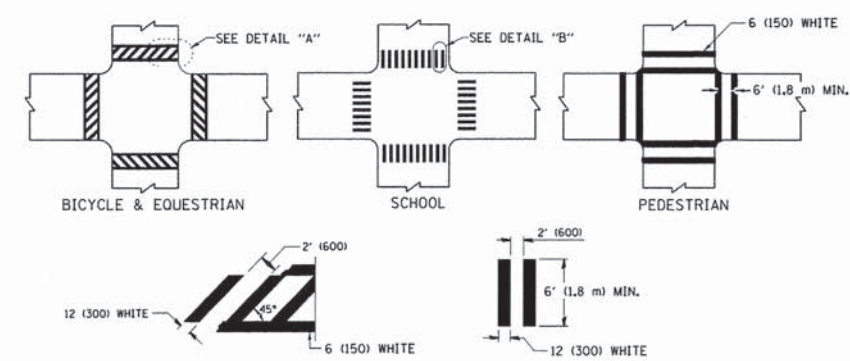

**DETAIL "A"**

**DETAIL "B"**

**TYPICAL CROSSWALK MARKING**

\* MARKINGS SHALL BE INSTALLED PARALLEL TO THE CENTERLINE OF THE ROAD WHICH IT CROSSES

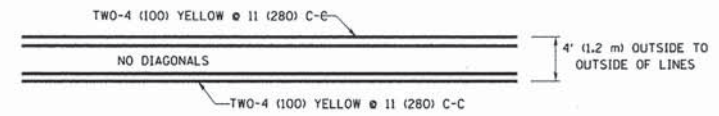

**4' (1.2 m) WIDE MEDIANS ONLY**

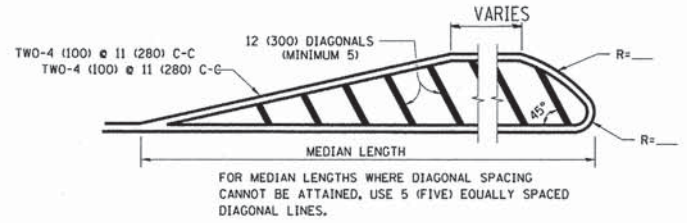

**MEDIANS OVER 4' (1.2 m) WIDE**

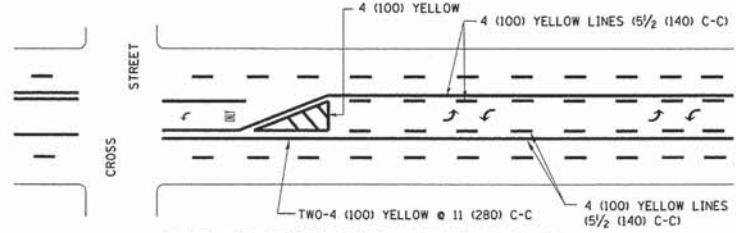

**MEDIAN WITH TWO-WAY LEFT TURN LANE**

**TYPICAL PAINTED MEDIAN MARKING**

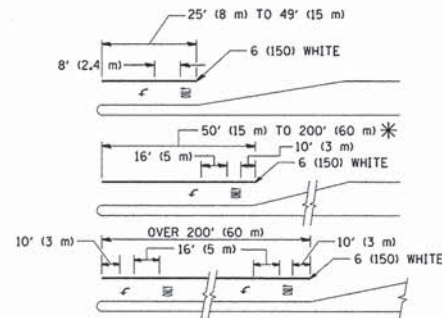

**TYPICAL LEFT (OR RIGHT) TURN LANE**

**TYPICAL TURN LANE MARKING**

FULL SIZE LETTERS 8' (2.4 m) AND ARROWS SHALL BE USED.  
 AREA = 15.6 SQ. FT. (1.5 m<sup>2</sup>) ONLY AREA = 20.8 SQ. FT. (1.9 m<sup>2</sup>)  
 \* TURN LANES IN EXCESS OF 400' (120 m) IN LENGTH MAY HAVE AN ADDITIONAL SET OF ARROW - "ONLY" INSTALLED MIDWAY BETWEEN THE OTHER TWO SETS OF ARROW - "ONLY".

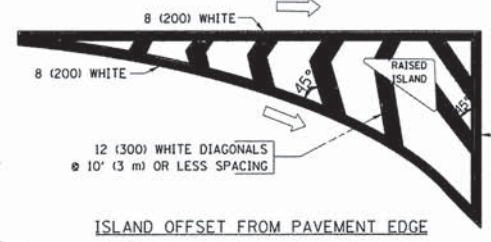

**ISLAND OFFSET FROM PAVEMENT EDGE**

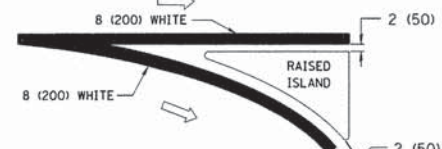

**ISLAND AT PAVEMENT EDGE**

**TYPICAL ISLAND MARKING**

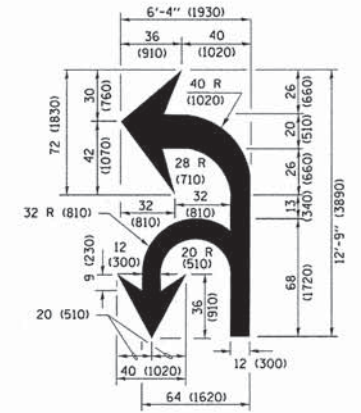

**COMBINATION LEFT AND U-TURN**

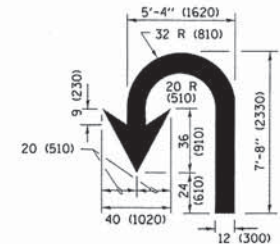

**U-TURN**

**LANE REDUCTION TRANSITION**  
 \* LANE REDUCTION ARROWS REQUIRED AT SPEEDS OF 45 MPH OR GREATER OR WHEN SPECIFIED IN PLANS.

TYPE OF MARKING	WIDTH OF LINE	PATTERN	COLOR	SPACING /REMARKS
CENTERLINE ON 2 LANE PAVEMENT	4 (100)	SKIP-DASH	YELLOW	10' (3 m) LINE WITH 30' (9 m) SPACE
CENTERLINE ON MULTI-LANE UNDIVIDED PAVEMENT	2 @ 4 (100)	SOLID	YELLOW	11 (280) C-C
NO PASSING ZONE LINES FOR ONE DIRECTION FOR BOTH DIRECTIONS	4 (100) 2 @ 4 (100)	SOLID SOLID	YELLOW YELLOW	5 1/2 (140) C-C FROM SKIP-DASH CENTERLINE 11 (280) C-C OMIT SKIP-DASH CENTERLINE BETWEEN
LANE LINES	4 (100) 5 (125) ON FREEWAYS	SKIP-DASH SKIP-DASH	WHITE WHITE	10' (3 m) LINE WITH 30' (9 m) SPACE
DOTTED LINES (EXTENSIONS OF CENTER, LANE OR TURN LANE MARKINGS)	SAME AS LINE BEING EXTENDED	SKIP-DASH	SAME AS LINE BEING EXTENDED	2' (600) LINE WITH 6' (1.8 m) SPACE
EDGE LINES	4 (100)	SOLID	YELLOW-LEFT WHITE-RIGHT	OUTLINE MEDIANS IN YELLOW
TURN LANE MARKINGS	6 (150) LINE; FULL SIZE LETTERS & SYMBOLS (8' (2.4m))	SOLID	WHITE	SEE TYPICAL TURN LANE MARKING DETAIL
TWO WAY LEFT TURN MARKING	2 @ 4 (100) EACH DIRECTION 8' (2.4m) LEFT ARROW	SKIP-DASH AND SOLID IN PAIRS	YELLOW WHITE	10' (3 m) LINE WITH 30' (9 m) SPACE FOR SKIP-DASH; 5 1/2 (140) C-C BETWEEN SOLID LINE AND SKIP-DASH LINE SEE TYPICAL TWO-WAY LEFT TURN MARKING DETAIL
CROSSWALK LINES (PEDESTRIAN) A. DIAGONALS (BIKE & EQUESTRIAN) B. LONGITUDINAL BARS (SCHOOL)	2 @ 6 (150) 12 (300) @ 45° 12 (300) @ 90°	SOLID SOLID SOLID	WHITE WHITE WHITE	NOT LESS THAN 6' (1.8 m) APART 2' (600) APART SEE TYPICAL CROSSWALK MARKING DETAILS.
STOP LINES	24 (600)	SOLID	WHITE	PLACE 4' (1.2 m) IN ADVANCE OF AND PARALLEL TO CROSSWALK, IF PRESENT. OTHERWISE, PLACE AT DESIRED STOPPING POINT, PARALLEL TO CROSSROAD CENTERLINE, WHERE POSSIBLE.
PAINTED MEDIANS	2 @ 4 (100) WITH 12 (300) DIAGONALS @ 45° NO DIAGONALS USED FOR 4' (1.2 m) WIDE MEDIANS	SOLID	YELLOW; TWO WAY TRAFFIC WHITE; ONE WAY TRAFFIC	11 (280) C-C FOR THE DOUBLE LINE SEE TYPICAL PAINTED MEDIAN MARKING.
GORE MARKING AND CHANNELIZING LINES	8 (200) WITH 12 (300) DIAGONALS @ 45°	SOLID	WHITE	DIAGONALS: 15' (4.5 m) C-C (LESS THAN 30MPH (50 km/h)) 20' (6 m) C-C (30MPH (50 km/h) TO 45MPH (70 km/h)) 30' (9 m) C-C (OVER 45MPH (70 km/h))
RAILROAD CROSSING	24 (600) TRANSVERSE LINES; "RR" 15 6' (1.8 m) LETTERS; 16 (400) LINE FOR "X"	SOLID	WHITE	SEE STATE STANDARD 780001 AREA OF: "R"=3.6 SQ. FT. (0.33 m <sup>2</sup> ) EACH "X"=54.0 SQ. FT. (5.0 m <sup>2</sup> )
SHOULDER DIAGONALS (REQUIRED FOR SHOULDERS ≥ 8')	12 (300) @ 45°	SOLID	WHITE - RIGHT YELLOW - LEFT	50' (15 m) C-C (LESS THAN 30MPH (50 km/h)) 75' (25 m) C-C (30 MPH (50 km/h) TO 45MPH (70 km/h)) 150' (45 m) C-C (OVER 45MPH (70 km/h))
U TURN ARROW	SEE DETAIL	SOLID	WHITE	16.3 SF
2 ARROW COMBINATION LEFT AND U TURN	SEE DETAIL	SOLID	WHITE	30.4 SF

FOR FURTHER DETAILS ON PAVEMENT MARKING REFER TO STANDARD SPECIFICATIONS FOR ROAD AND BRIDGE CONSTRUCTION AND STATE STANDARD 780001.

All dimensions are in inches (millimeters) unless otherwise shown.

FILE NAME =	USER NAME = lizakrf	DESIGNED - EVERS	REVISED - T. RAMMACHER 10-27-94
g:\IL\84E\BID\INTEG\Illinois.gov\PWIDOT\Documents\IDOT Offices\District 1\Projects\Dist1\DRM\CADData\CADsheets\tel3.dgn		CHECKED -	REVISED - C. JUCIUS 09-09-09
Default	PLOT SCALE = 50.000' / in.	DATE - 03-19-90	REVISED - C. JUCIUS 07-01-13
	PLOT DATE = 12/21/2015		REVISED - C. JUCIUS 12-21-15

**STATE OF ILLINOIS  
DEPARTMENT OF TRANSPORTATION**

**DISTRICT ONE  
TYPICAL PAVEMENT MARKINGS**

SCALE: NONE SHEET 1 OF 1 SHEETS STA. TO STA.

F.A. RTE.	SECTION	COUNTY	TOTAL SHEETS	SHEET NO.
1368	15-00011-00-RS	DuPAGE	15	14
TC-13			CONTRACT NO. 61C57	
ILLINOIS FED. AID PROJECT				

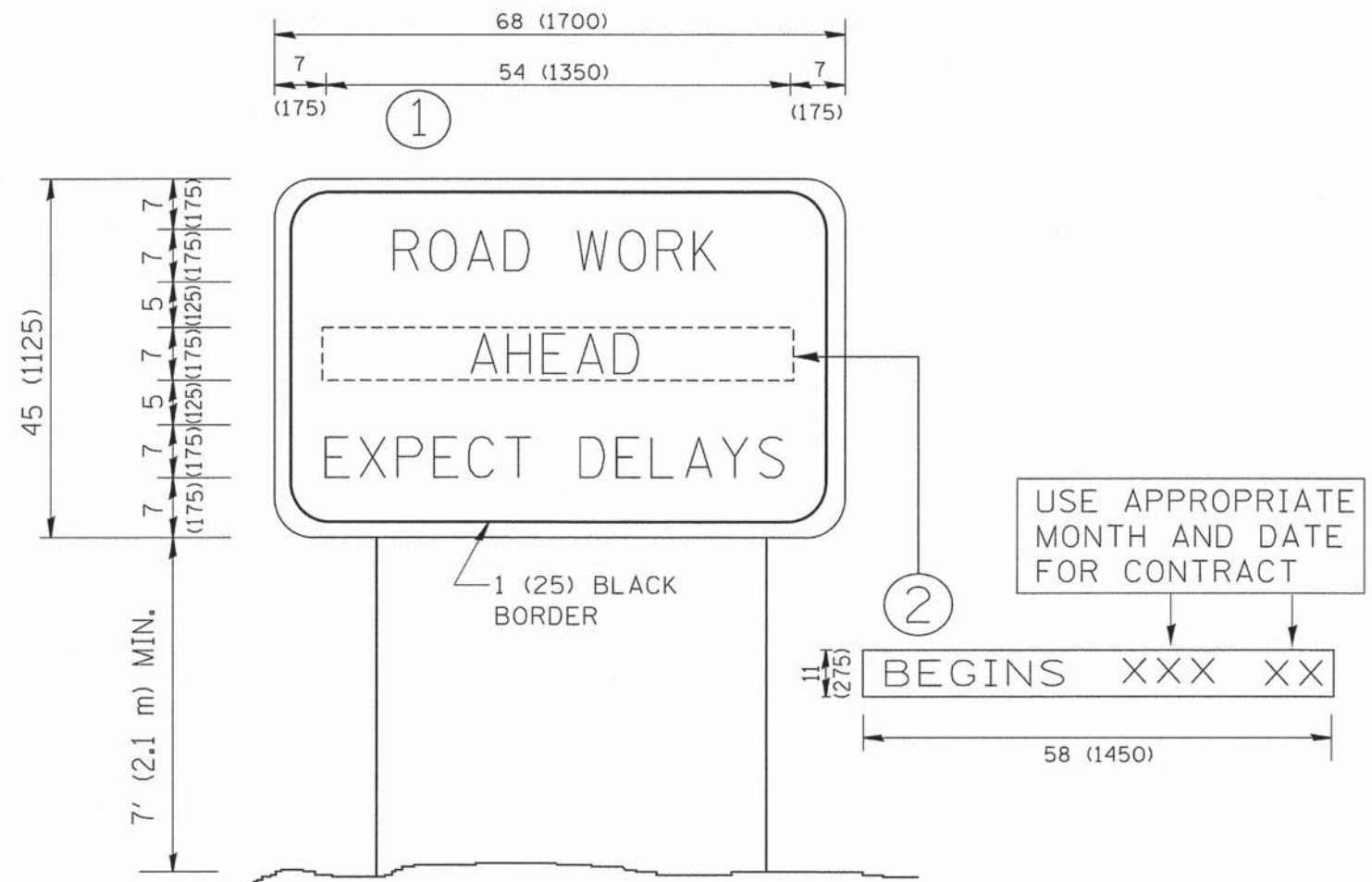

**NOTES:**

1. USE BLACK LETTERING ON ORANGE BACKGROUND.
2. ERECT SIGNS IN ADVANCE OF THE LOCATION FOR THE "ROAD CONSTRUCTION AHEAD" SIGN AT LOCATIONS AS DIRECTED BY THE ENGINEER.
3. ERECT SIGN ① WITH INSTALLED PANEL ② ONE WEEK PRIOR TO THE START OF CONSTRUCTION.
4. REMOVE PANEL ② SOON AFTER THE START OF CONSTRUCTION.
5. SEE SPECIAL PROVISION FOR "TEMPORARY INFORMATION SIGNING" FOR ADDITIONAL INFORMATION.
6. ONE SIGN ASSEMBLY EQUALS 25.70 SQ. FT. (2.3 SQ. M.)
7. SHALL BE PAID FOR AS TEMPORARY INFORMATION SIGNING.

ALL DIMENSIONS ARE IN INCHES (MILLIMETERS) UNLESS OTHERWISE SHOWN.

FILE NAME = W:\dststd\22x34\tc22.dgn	USER NAME = gegl1anobt	DESIGNED -	REVISED - R. MIRS 09-15-97
		DRAWN -	REVISED - R. MIRS 12-11-97
	PLOT SCALE = 50.000 ' / IN.	CHECKED -	REVISED - T. RAMMACHER 02-02-99
	PLOT DATE = 1/4/2008	DATE -	REVISED - C. JUCIUS 01-31-07

**STATE OF ILLINOIS  
DEPARTMENT OF TRANSPORTATION**

**ARTERIAL ROAD  
INFORMATION SIGN**

SCALE: NONE SHEET NO. 1 OF 1 SHEETS STA. TO STA.

F.A. RTE. 1368	SECTION 15-00011-00-RS	COUNTY LAKE	TOTAL SHEETS 15	SHEET NO. 15
TC-22			CONTRACT NO. 61C57	
FED. ROAD DIST. NO. 1 ILLINOIS FED. AID PROJECT				