

STATE OF ILLINOIS
 DEPARTMENT OF TRANSPORTATION
 DIVISION OF HIGHWAYS

PLANS FOR PROPOSED
 SAFE ROUTES TO SCHOOL
 NORTH SCHOOL & 6th / MULBERRY STREET

PROJECT NO.: SRTS-4009 (077)
 JOB NO.: C-40-090-09
 SECTION: 10-00052-00-SP
 CITY OF MARSHALL
 CLARK COUNTY, ILLINOIS
 SRTS FUNDS

INDEX OF SHEETS

- 1 COVER SHEET
- 2 GENERAL NOTES & SUMMARY OF QUANTITIES
- 3-6 PLAN SHEET
- 7-8 MISCELLANEOUS DETAILS SHEET

ILLINOIS HIGHWAY STANDARDS

000001-06	STANDARD SYMBOLS, ABBREVIATIONS AND PATTERNS
280001-07	TEMPORARY EROSION CONTROL SYSTEMS
424001-08	PERPENDICULAR CURB RAMPS FOR SIDEWALKS
424011-02	CORNER PARALLEL CURB RAMPS FOR SIDEWALKS
424016-02	MID-BLOCK CURB RAMPS FOR SIDEWALKS
424021-03	DEPRESSED CORNER FOR SIDEWALKS
424026-01	ENTRANCE / ALLEY PEDESTRIAN CROSSINGS
542306-03	PRECAST REINFORCED CONCRETE ELLIPTICAL FLARED END SECTION
602301-04	INLET - TYPE A
604001-04	FRAME AND LIDS TYPE 1
604036-03	GRATE TYPE 8
606001-06	CONCRETE CURB TYPE B AND COMBINATION CURB AND GUTTER
701501-06	URBAN LANE CLOSURE, 2L, 2W, UNDIVIDED
701801-06	SIDEWALK, CORNER OR CROSSWALK CLOSURE
701901-05	TRAFFIC CONTROL DEVICES
720001-01	SIGN PANEL MOUNTING DETAILS
720006-04	SIGN PANEL ERECTION DETAILS
728001-01	TELESCOPING STEEL SIGN SUPPORT
BLR10-6	PCC PAVEMENT SPECIAL (NONREINFORCED)

(copies included in bid booklet / specs)

FUNCTIONAL CLASSIFICATION - 6th STREET - MAJOR COLLECTOR

TRAFFIC COUNT - 6th STREET - 1400

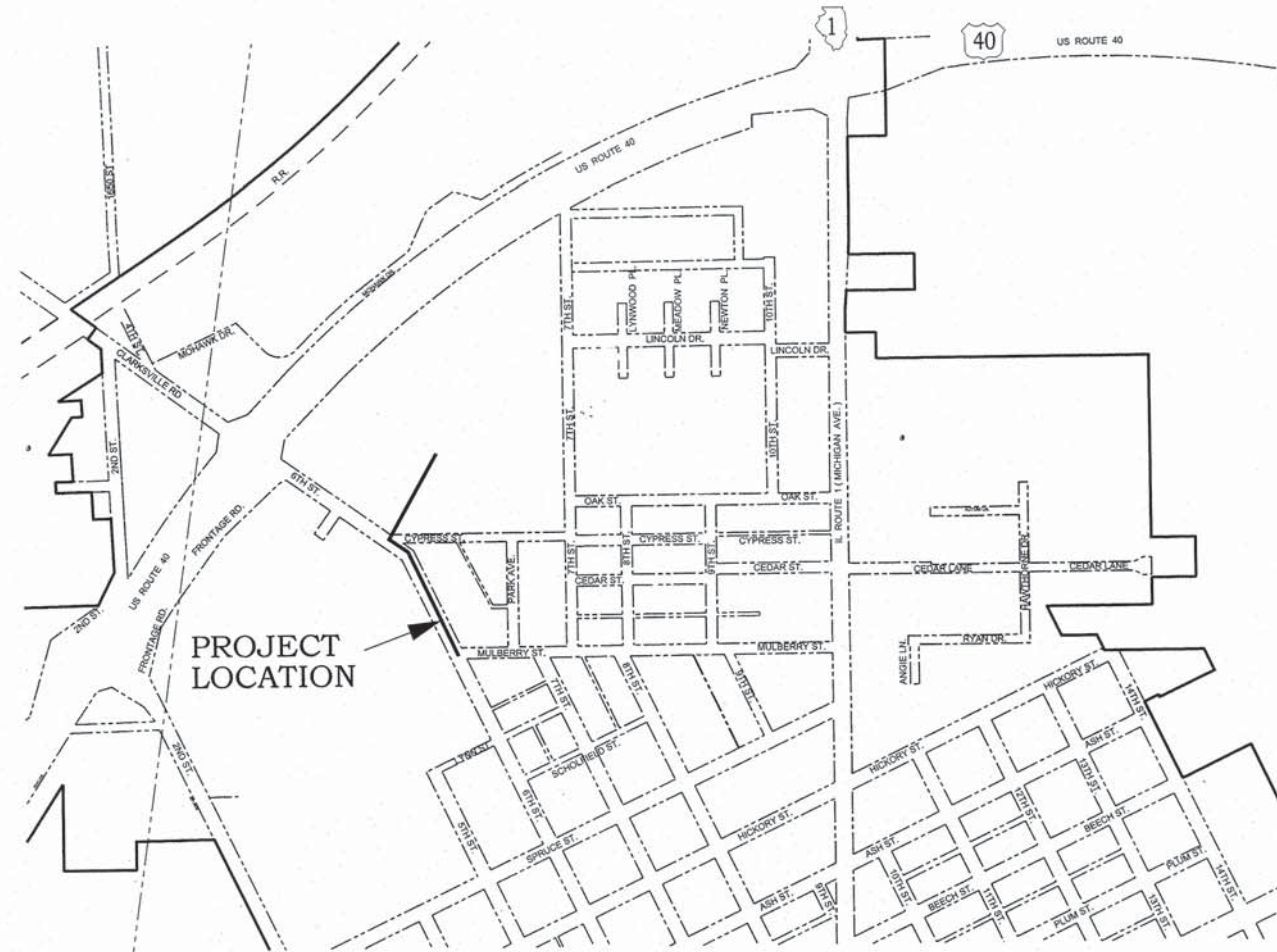

CITY OF MARSHALL
 (NOT TO SCALE)
 LOCATION MAP

TOTAL LENGTH = 1,235 LIN. FT. = 0.23 MILES
 NET LENGTH OF PROJECT = 1,235 LIN. FT. = 0.23 MILES

ILLINOIS DEPARTMENT OF TRANSPORTATION	
APPROVED:	2/23/16 <i>Camie Sanders</i> CITY OF MARSHALL - MAYOR
PASSED:	2/26/16 <i>Maureen Elwell</i> DISTRICT 7 ENGINEER OF LOCAL ROADS & STREETS
RELEASING FOR BID BASED ON LIMITED REVIEW:	2/26/16 <i>Jeffrey M. Southard</i> REGION 4 ENGINEER



CONTACT JULIE AT 811 OR 800-892-0123
 With the following:
 County CLARK COUNTY
 City/Township CITY OF MARSHALL
 Sec & 1/4 Sec No. NE 1/4 SEC. 13-T11N-R12W
 48 HOURS (2 working days) BEFORE YOU DIG

PREPARED BY,
FRANCIS ASSOCIATES
 CONSULTING ENGINEERS
 LAND SURVEYORS
 330 NORTH CENTRAL AVENUE
 PARIS, ILLINOIS 61944
 217-465-5306



PROFESSIONAL DESIGN FIRM #184-001406

CONTRACT NO. 95785

Duncan T. MacGibbon 02-23-2016
 DUNCAN T. MacGIBBON DATE
 ILLINOIS PROFESSIONAL ENGINEER NO. 062-043706
 EXP. 11/30/17



DESIGN INFORMATION

1) SEEDING

APPLICATION RATES:
 90 LBS. / ACRE NITROGEN FERTILIZER NUTRIENT
 90 LBS. / ACRE PHOSPHORUS FERTILIZER NUTRIENT
 90 LBS. / ACRE POTASSIUM FERTILIZER NUTRIENT
 2 TON / ACRE MULCH (METHOD 2)

SUMMARY OF SEEDING:
 SEEDING, CLASS 1 (SPECIAL) = 0.2 ACRES
 NITROGEN FERTILIZER NUTRIENT = 18 LBS.
 PHOSPHORUS FERTILIZER NUTRIENT = 18 LBS.
 POTASSIUM FERTILIZER NUTRIENT = 18 LBS.
 MULCH (METHOD 1) = 0.4 TONS

GENERAL NOTES

- 1) THIS SECTION SHALL BE CONSTRUCTED IN ACCORDANCE WITH THE "STANDARD SPECIFICATIONS FOR ROAD & BRIDGE CONSTRUCTION" ADOPTED APRIL 1, 2016.
- 2) ANY REFERENCE TO STANDARDS THROUGHOUT THE PLANS SHALL BE INTERPRETED TO BE THE LATEST STANDARDS OF THE DEPARTMENT.
- 3) PLAN ELEVATIONS ARE BASED ON ASSUMED ELEVATIONS.

SUMMARY OF QUANTITIES

CODE NUMBER	ITEM	UNIT	QUANTITY
20200100	EARTH EXCAVATION	CU YD	47
20800150	TRENCH BACKFILL	CU YD	5
20900110	POROUS GRANULAR BACKFILL	CU YD	66.7
21101625	TOPSOIL FURNISH AND PLACE, 6"	SQ YD	14
21400100	GRADING AND SHAPING DITCHES	FOOT	52
35101400	AGGREGATE BASE COURSE, TYPE B	TON	51.2
40200800	AGGREGATE SURFACE COURSE, TYPE B	TON	15
42300200	PORTLAND CEMENT CONCRETE DRIVEWAY PAVEMENT, 6 INCH	SQ YD	5.9
42400100	PORTLAND CEMENT CONCRETE SIDEWALK 4 INCH	SQ FT	8,610.4
42400300	PORTLAND CEMENT CONCRETE SIDEWALK 6 INCH	SQ FT	354.7
42400800	DETECTABLE WARNINGS	SQ FT	112.7
44000100	PAVEMENT REMOVAL	SQ YD	128
44000200	DRIVEWAY PAVEMENT REMOVAL	SQ YD	32.1
44000500	COMBINATION CURB AND GUTTER REMOVAL	FOOT	147
44000600	SIDEWALK REMOVAL	SQ FT	5,859.1
50105220	PIPE CULVERT REMOVAL	FOOT	17
542A5479	PIPE CULVERTS, CLASS A, TYPE 1 EQUIVALENT ROUND SIZE 24"	FOOT	16
54214719	PRECAST REINFORCED CONCRETE FLARED END SECTIONS - ELLIPTICAL, EQUIVALENT ROUND - SIZE 24"	EACH	2
60100915	PIPE DRAINS 6"	FOOT	12
60100925	PIPE DRAINS 8"	FOOT	18
60234200	INLETS, TYPE A, TYPE 1 FRAME, OPEN LID	EACH	1
60235300	INLETS, TYPE A, TYPE 1 FRAME, CLOSED LID	EACH	1
60236200	INLETS, TYPE A, TYPE 8 GRATE	EACH	1
60500060	REMOVING INLETS	EACH	2
60600605	CONCRETE CURB, TYPE B	FOOT	141
60604400	COMBINATION CONCRETE CURB AND GUTTER, TYPE B-6.18	FOOT	148
67100100	MOBILIZATION	L SUM	1
70102620	TRAFFIC CONTROL AND PROTECTION, STANDARD 701501	L SUM	1
72000100	SIGN PANEL - TYPE 1	SQ FT	30.6
72800100	TELESCOPING STEEL SIGN SUPPORT	FOOT	46
△ 78001100	PAINT PAVEMENT MARKING - LETTERS AND SYMBOLS	SQ FT	162.4
△ 78001130	PAINT PAVEMENT MARKING - LINE 6"	FOOT	494
△ 78001150	PAINT PAVEMENT MARKING - LINE 12"	FOOT	65
78300100	PAVEMENT MARKING REMOVAL	SQ FT	125
LR420029	PORTLAND CEMENT CONCRETE PAVEMENT 8" (SPECIAL)	SQ YD	128
X2500900	SEEDING, CLASS 1 (SPECIAL)	ACRE	0.2
X4240420	PORTLAND CEMENT CONCRETE SIDEWALK 4 INCH, SPECIAL	SQ FT	122
Z0004002	BOLLARDS	EACH	2
△ Z0033058	POST MOUNTED FLASHING BEACON INSTALLATION (SPECIAL)	EACH	2

△ SPECIALTY ITEMS

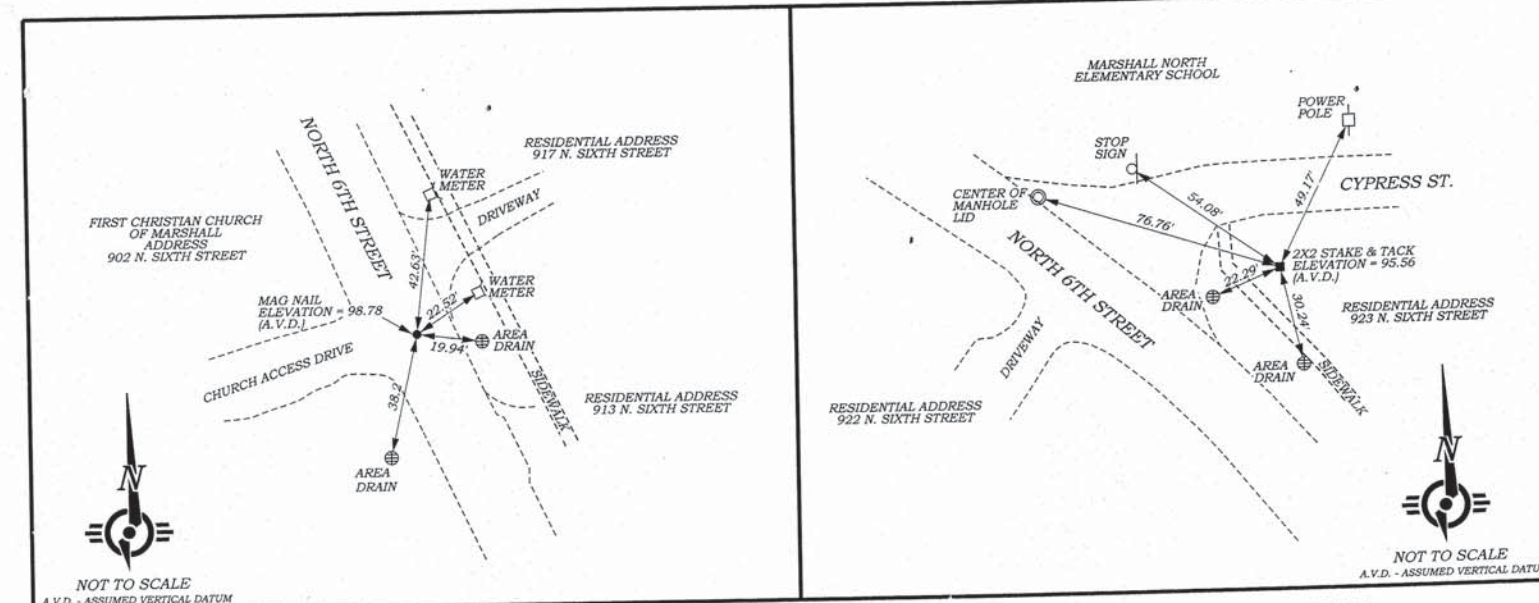

LOCAL TIE SKETCHES SHOWING PROJECT HORIZONTAL & VERTICAL CONTROL POINTS

GENERAL NOTES & SUMMARY OF QUANTITIES
 SAFE ROUTES TO SCHOOL
 CITY OF MARSHALL, ILLINOIS, CLARK COUNTY

SHEET NO.
2
 OF 8 SHEETS

FRANCIS ASSOCIATES
 CONSULTING ENGINEERS
 LAND SURVEYORS
 330 NORTH CENTRAL AVENUE
 PARIS, ILLINOIS 61944
 PH. (217) 465-5306
 PROFESSIONAL DESIGN FIRM #184-001406

SCALES	
PLAN : N-T-S	
REVISED DATE	DATE
REVISED DATE	DATE

FRANCIS ASSOC. FILE NO.
M-125-3

DRAWN DATE	12/30/15
CHECKED DATE	
APPROVED DATE	
REVISED DATE	1/12/16
REVISED DATE	2/18/16

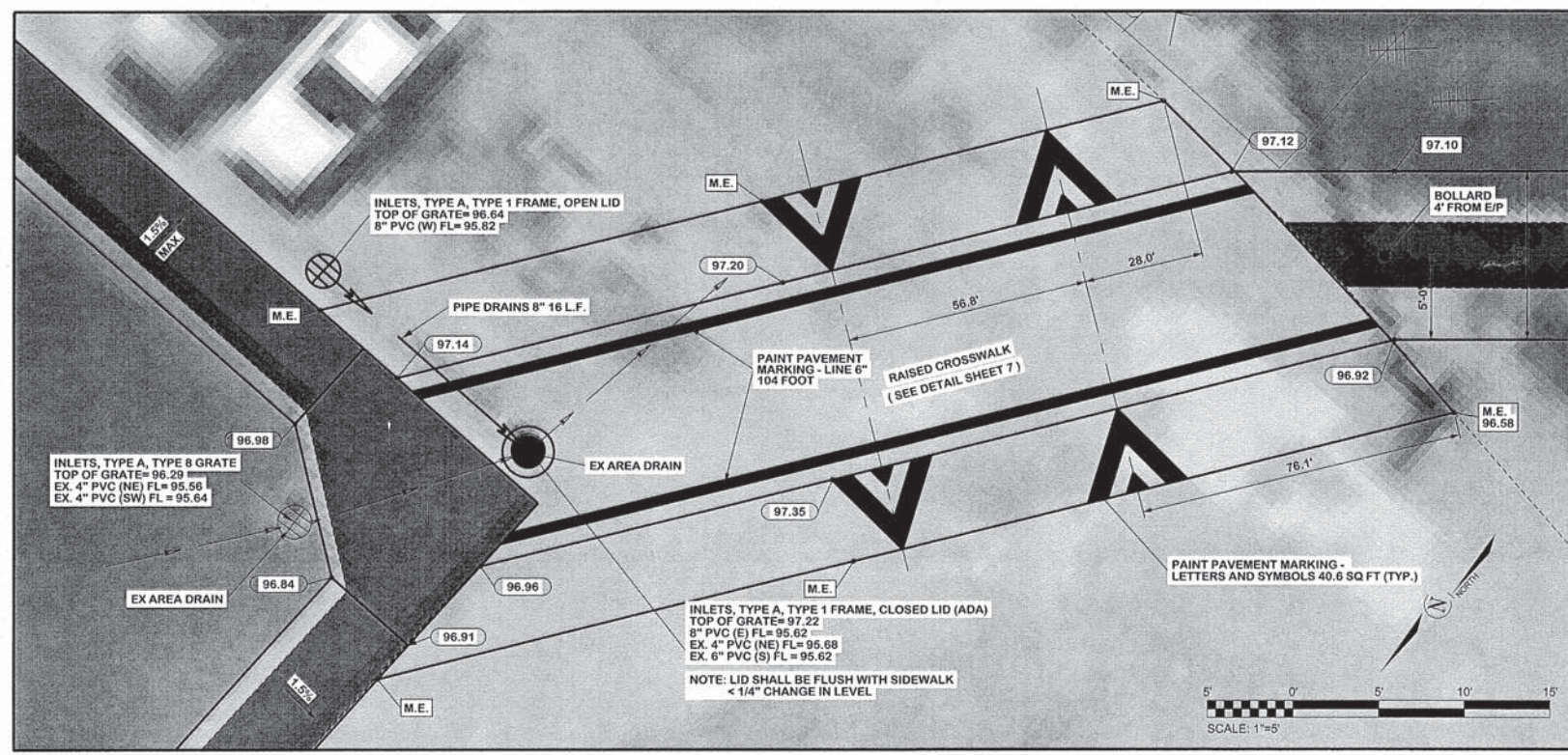

RAISED CROSSWALK DETAIL
 SCALE: 1"=5'

PAINT PAVEMENT MARKING - LINE 6"	
RAISED CROSS WALK 104 FOOT	
DETAIL TOTAL=	104 FOOT
PAINT PAVEMENT MARKING - LETTERS AND SYMBOLS	
DETAIL TOTAL=	162.4 SQ FT
INLETS, TYPE A, TYPE 1 FRAME, OPEN LID	
DETAIL TOTAL=	1 EACH
INLETS, TYPE A, TYPE 1 FRAME, CLOSED LID	
DETAIL TOTAL=	1 EACH
INLETS, TYPE A, TYPE 8 GRATE	
DETAIL TOTAL=	1 EACH
REMOVING INLETS	
DETAIL TOTAL=	2 EACH
PIPE DRAINS 8"	
DETAIL & SHEET TOTAL=	18 FOOT
AGGREGATE BASE COURSE, TYPE B	
DETAIL TOTAL=	40.9 TON
PAVEMENT REMOVAL	
DETAIL TOTAL=	128 SQ YD
PORTLAND CEMENT CONCRETE PAVEMENT 8" (SPECIAL)	
DETAIL TOTAL=	128 SQ YD

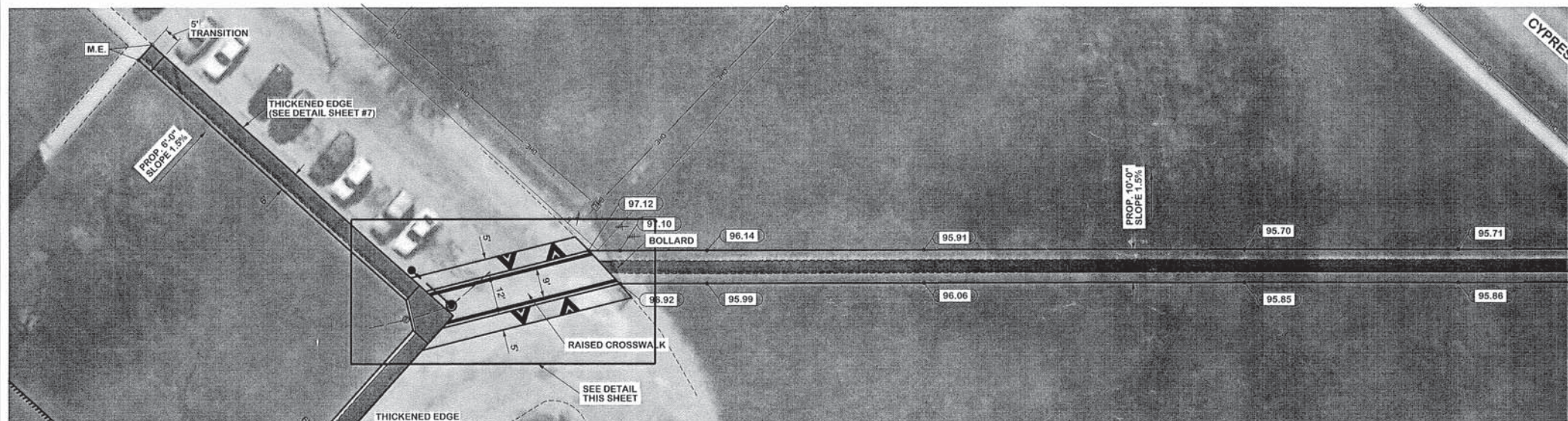
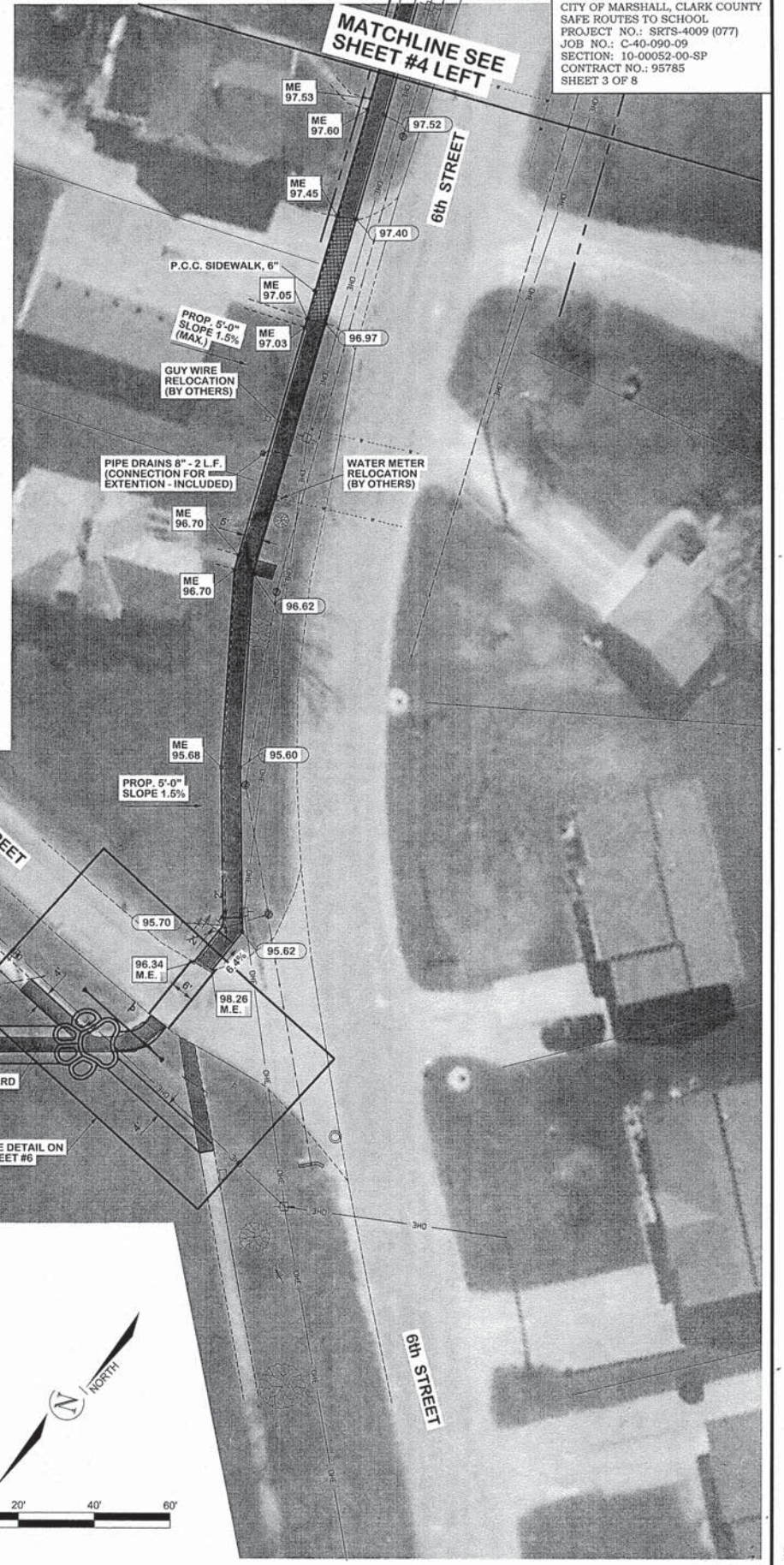

DETECTABLE WARNINGS		POROUS GRANULAR BACKFILL		TELESCOPING STEEL SIGN SUPPORT	
SHEET TOTAL = 30 SQ. FT.		SHEET TOTAL = 55.5 CU. YD.		W17-1, W13-1P 14 FOOT	
PORTLAND CEMENT CONCRETE SIDEWALK 4 INCH		BOLLARD		S1-1, W16-7P 16 FOOT	
SHEET TOTAL = 5,980.0 SQ. FT.		SHEET TOTAL = 2 EACH		S1-1, W16-7P 16 FOOT	
SIDEWALK REMOVAL		EARTH EXCAVATION		SHEET TOTAL = 46 FOOT	
SHEET TOTAL = 3,765.6 SQ. FT.		SHEET TOTAL = 40 CU. YD.		SIGN PANEL - TYPE 1	
PORTLAND CEMENT CONCRETE SIDEWALK 6 INCH				W17-1 6.3 SQ FT	
SHEET TOTAL = 144.3 SQ. FT.				W13-1P 2.3 SQ FT	
				S1-1 9.0 SQ FT	
				W16-7P 2.0 SQ FT	
				S1-1 9.0 SQ FT	
				W16-7P 2.0 SQ FT	
				SHEET TOTAL = 30.6 SQ FT	

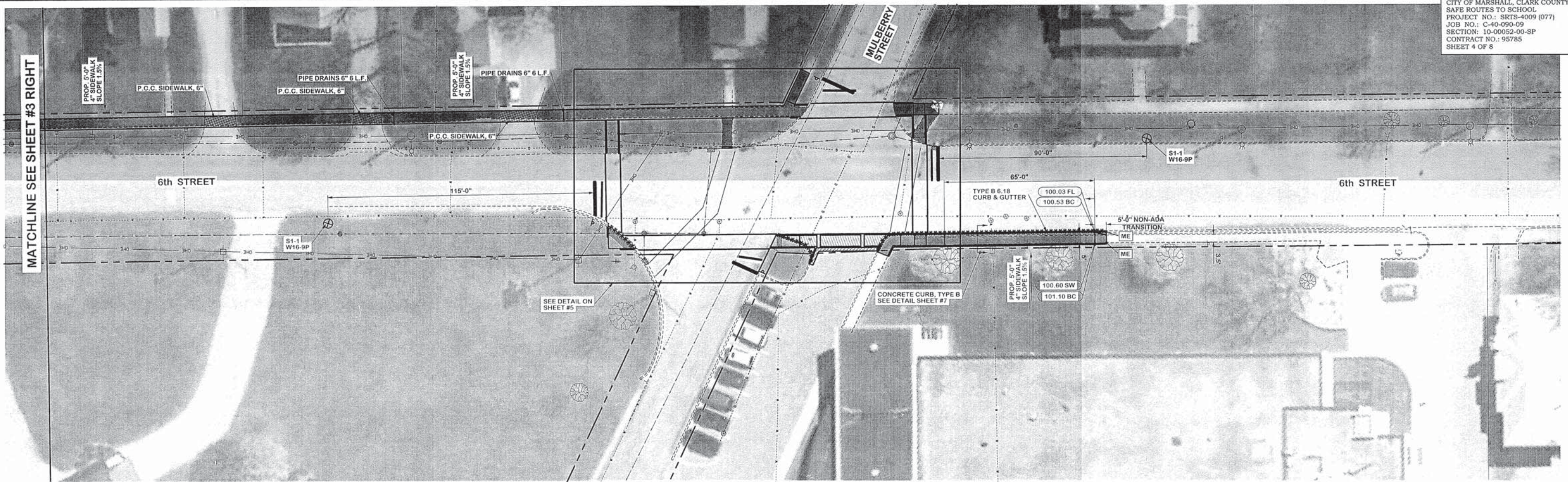

	DRIVEWAY PAVEMENT REMOVAL SHEET TOTAL = 32.1 SQ. YD.
	PORTLAND CEMENT CONCRETE DRIVEWAY PAVEMENT, 6 INCH SHEET TOTAL = 5.9 SQ. YD.
	DETECTABLE WARNINGS SHEET TOTAL = 82.7 SQ. FT.
	SIDEWALK REMOVAL SHEET TOTAL = 2,093.5 SQ. FT.
	PORTLAND CEMENT CONCRETE SIDEWALK 6 INCH SHEET TOTAL = 210.4 SQ. FT.

	PORTLAND CEMENT CONCRETE SIDEWALK 4 INCH SHEET TOTAL = 2,522.4 SQ. FT.
	POROUS GRANULAR BACKFILL SHEET TOTAL = 11.2 CU. YD.
	COMBINATION CONCRETE CURB AND GUTTER, TYPE B-6.18 SHEET TOTAL = 148.0 FOOT
	CONCRETE CURB, TYPE B SHEET TOTAL = 141 FOOT
	COMBINATION CURB AND GUTTER REMOVAL ***** SHEET TOTAL = 147 FOOT

	AGGREGATE BASE COURSE, TYPE B SHEET TOTAL = 10.3 TON
	EARTH EXCAVATION SHEET TOTAL = 7.0 CU. YD.
	TOPSOIL FURNISH AND PLACE, 6" SHEET TOTAL = 7.0 SQ. YD.
	PIPE DRAINS 6" DETAIL & SHEET TOTAL = 12 FOOT
	POST MOUNTED FLASHING BEACON INSTALLATION (SPECIAL) ⊗ SHEET TOTAL = 2 EACH

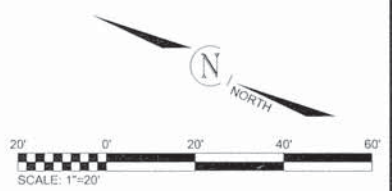
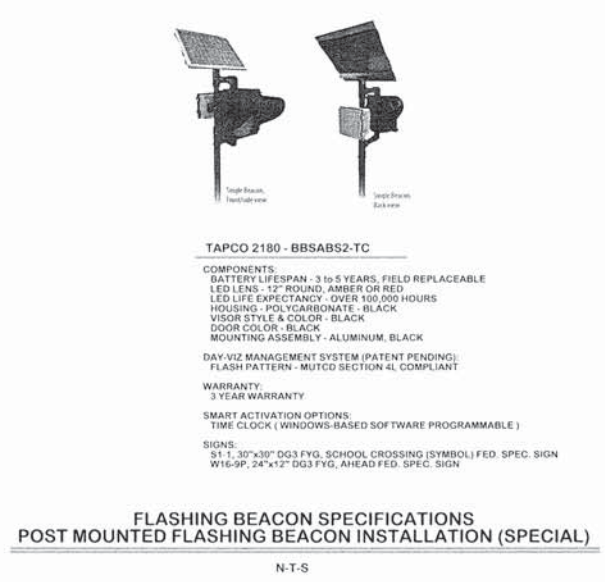
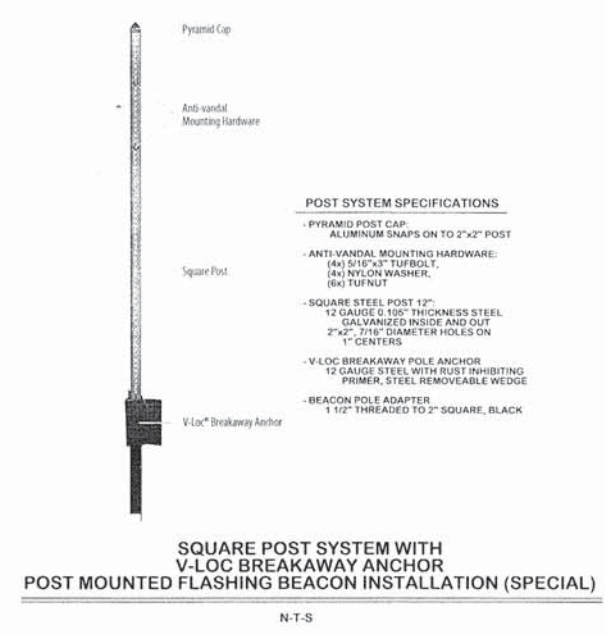

PAINT PAVEMENT MARKING - LINE 12"

E. MULBERRY - STOP BAR	15 FOOT
N. 6TH ST. - STOP BAR	14 FOOT
W. MULBERRY - STOP BAR	12 FOOT
S. 6TH ST. - STOP BAR	14 FOOT
SHEET TOTAL=	55 FOOT

PAINT PAVEMENT MARKING - LINE 6"

E. MULBERRY - CROSS WALK	80.0 FOOT
N. 6TH ST. - CROSS WALK	65.0 FOOT
W. MULBERRY - CROSS WALK	121.5 FOOT
S. 6TH ST. - CROSS WALK	80.5 FOOT
SHEET TOTAL=	347.0 FOOT

PAVEMENT MARKING REMOVAL

E. MULBERRY - STOP BAR	15 SQ FT
N. 6TH ST. - CROSS WALK & STOP BAR	59 SQ FT
W. MULBERRY - STOP BAR	11 SQ FT
S. 6TH ST. - CROSS WALK & STOP BAR	40 SQ FT
SHEET TOTAL=	125 SQ FT

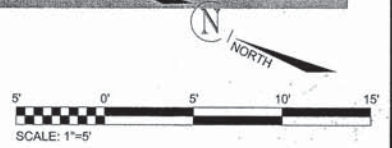
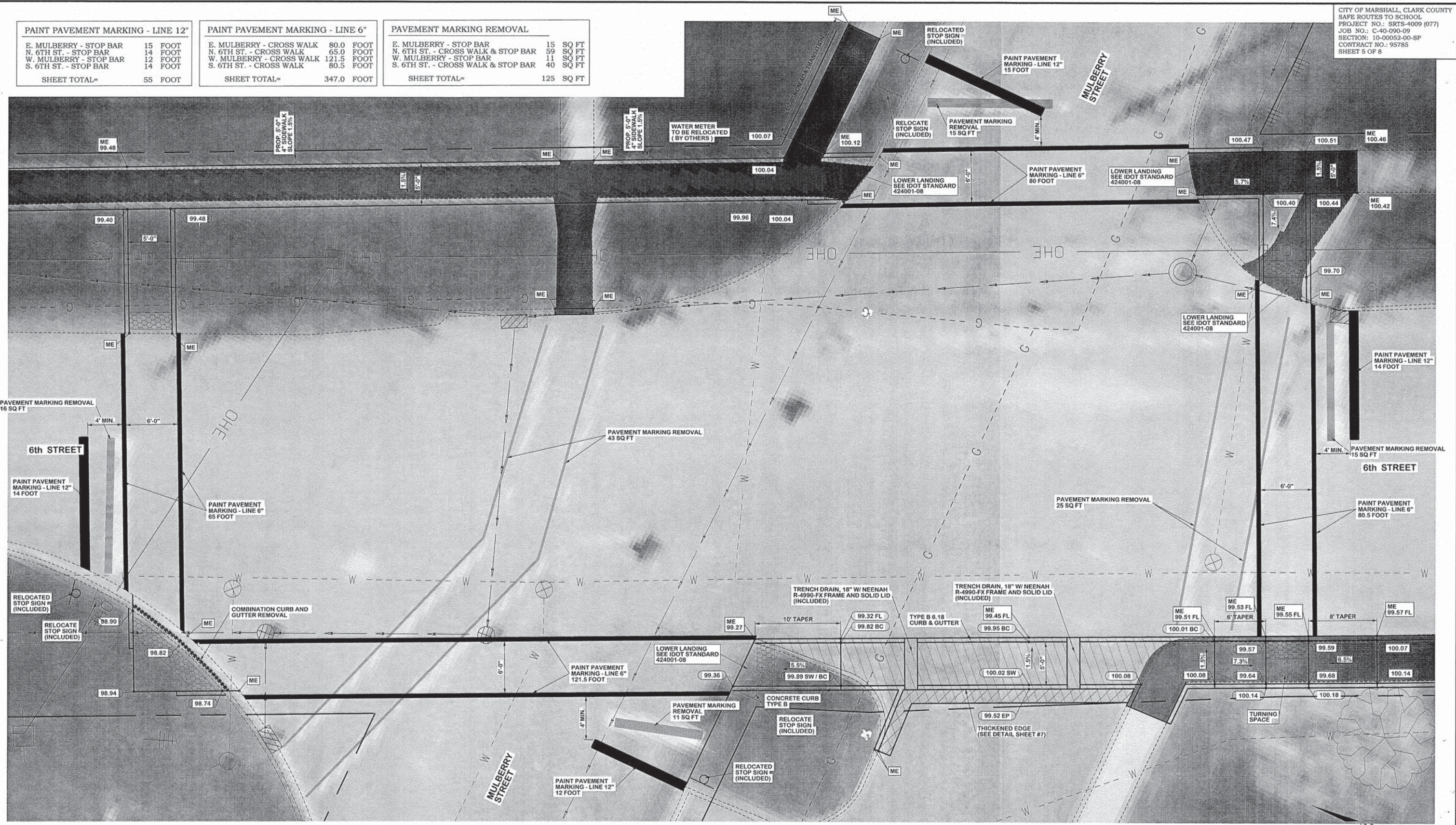

FRANCIS ASSOCIATES
 CONSULTING ENGINEERS
 LAND SURVEYORS
 330 NORTH CENTRAL AVENUE
 PARIS, ILLINOIS 61944
 PH. (217) 465-5306
 PROFESSIONAL DESIGN FIRM #184-001406



SCALES	
PLAN :	1"=5'
REVISED	IRG
DATE	2/3/16
REVISED	TLT
DATE	2/18/16

DRAWN	
DATE	12/30/15
CHECKED	DATE
APPROVED	DATE
REVISED	DATE

FRANCIS ASSOC. FILE NO. **M-125-1**

PLAN SHEET

CITY OF MARSHALL, ILLINOIS

SHEET NO. **5**
 OF 8 SHEETS

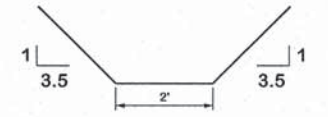
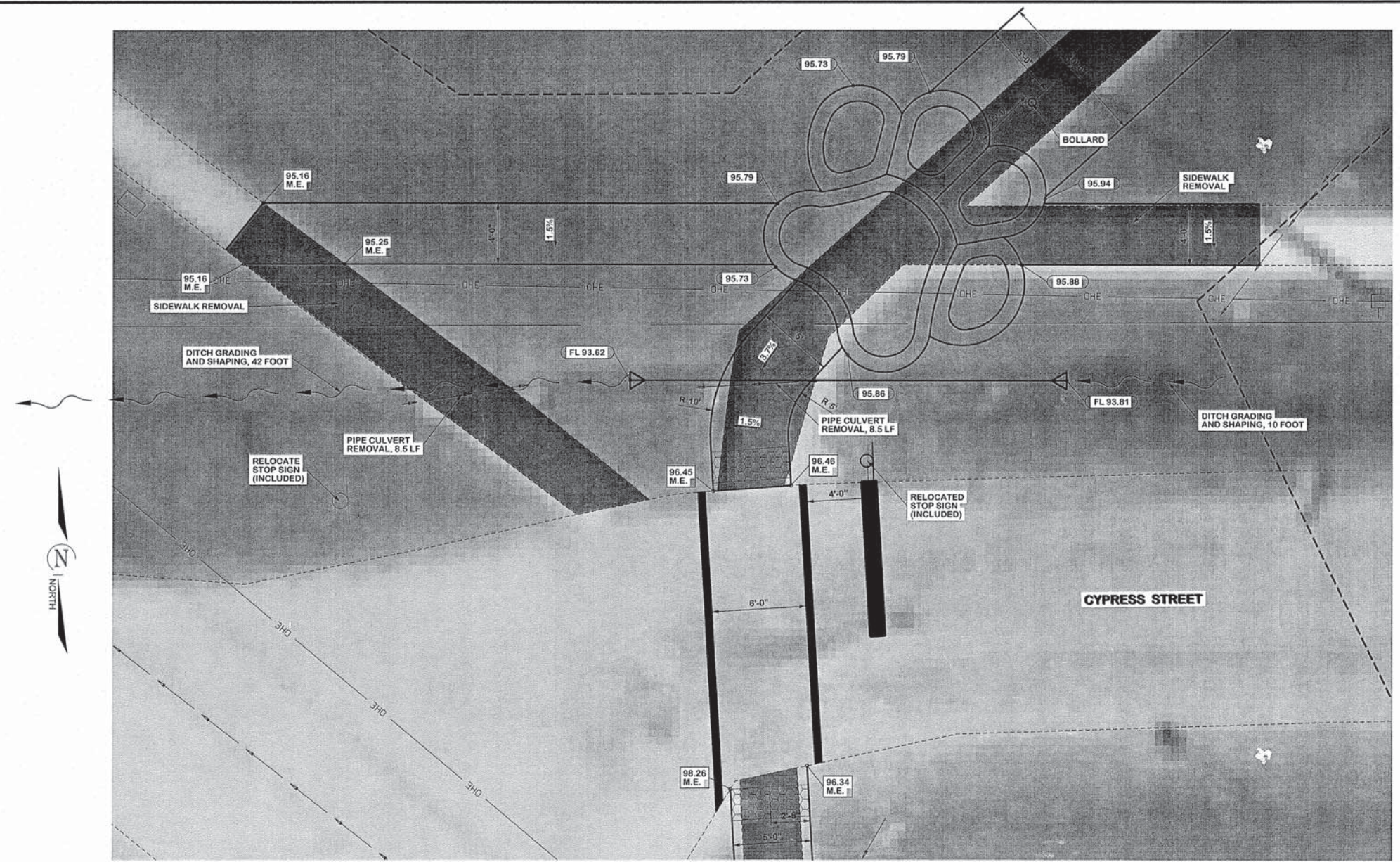

GRADING AND SHAPING DITCHES
 TYPICAL SECTION
 N.T.S.

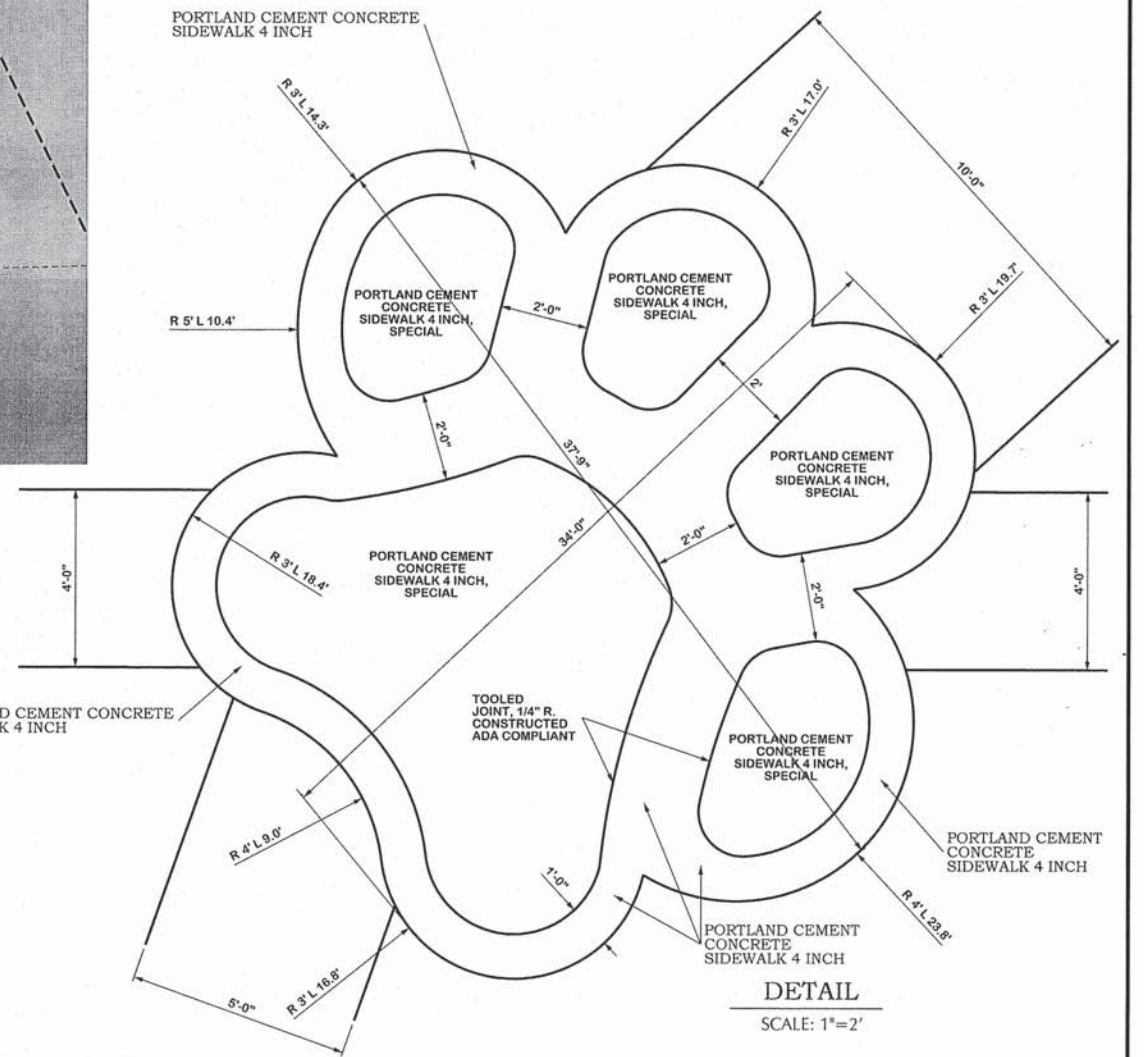

PRECAST REINFORCED CONCRETE FLARED END SECTIONS - ELLIPTICAL, EQUIVALENT ROUND - SIZE 24"
 SHEET TOTAL = 2 EACH

TOPSOIL FURNISH AND PLACE, 6"
 SHEET TOTAL = 7.0 SQ. YD.

GRADING AND SHAPING DITCHES
 SHEET TOTAL = 52 FOOT

PIPE CULVERTS, CLASS A, TYPE 1 EQUIVALENT ROUND-SIZE 24"
 SHEET TOTAL = 16 FOOT

PAINT PAVEMENT MARKING - LINE 6"
 SHEET TOTAL = 43 FOOT

PIPE CULVERT REMOVAL
 SHEET TOTAL = 17 FOOT

PORTLAND CEMENT CONCRETE SIDEWALK 4 INCH, SPECIAL
 PAW SHAPE TOTAL = 121.7 SQ FT

PAINT PAVEMENT MARKING - LINE 12"
 SHEET TOTAL = 10 FOOT

PORTLAND CEMENT CONCRETE SIDEWALK 4 INCH
 PAW SHAPE TOTAL = 108 SQ. FT.

FRANCIS ASSOCIATES
 CONSULTING ENGINEERS
 LAND SURVEYORS
 330 NORTH CENTRAL AVENUE
 PARIS, ILLINOIS 61944
 PH. (217) 465-5306
 PROFESSIONAL DESIGN FIRM #184-001406

SCALES	DRAWN TLT
PLAN: 1"=5'	DATE 12/30/15
REVISIONS	CHECKED
DATE 2/2/16	DATE
REVISIONS	APPROVED
DATE 2/18/16	DATE

FRANCIS ASSOC. FILE NO.
M-125-3

PLAN SHEET

SAFE ROUTES TO SCHOOL
 CITY OF MARSHALL, ILLINOIS, CLARK COUNTY

- NOTES:
 1. SEALANT BETWEEN SIDEWALK AND CONCRETE PAVEMENT SHALL MEET STANDARD B.L.R. 10-6
 2. SEE IDOT STANDARD B.L.R. 10-6 LONGITUDINAL AND TRANSVERSE JOINT DETAILS.
 3. SIGNAGE AND PAVEMENT MARKINGS SHALL BE IN ACCORDANCE WITH THE MUTCD.

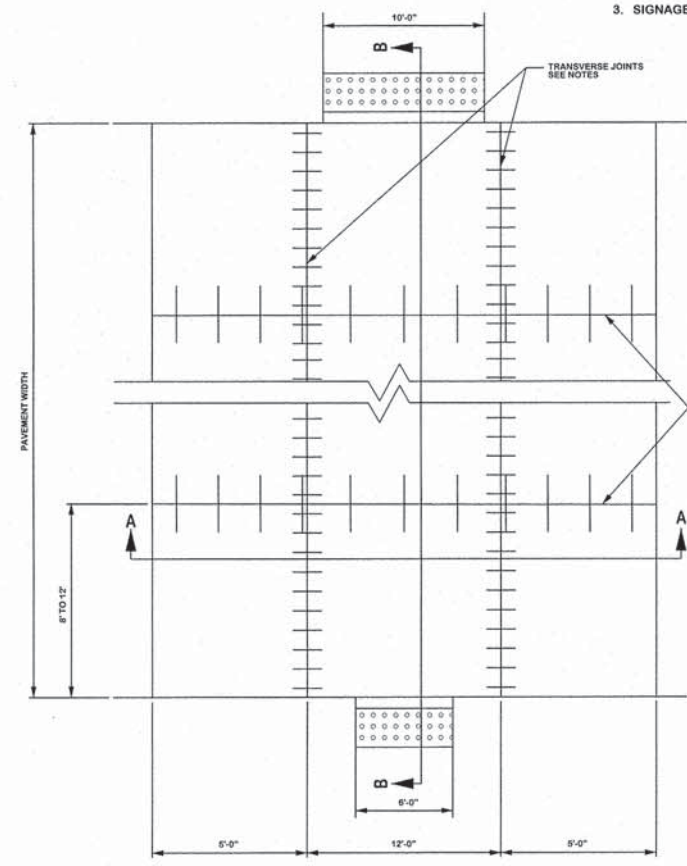

PLAN VIEW

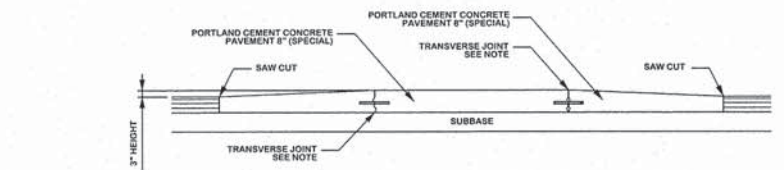

SECTION A-A
PROFILE

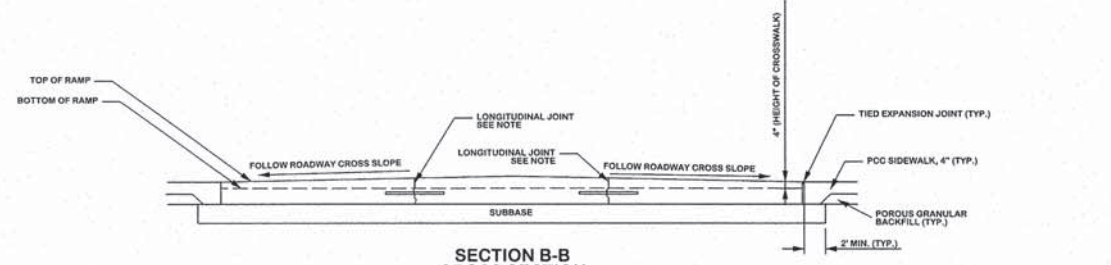

SECTION B-B
CROSS SECTION

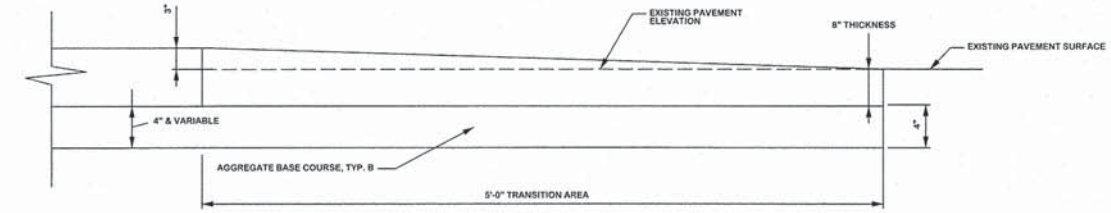

TRANSITION AREA - FULL DEPTH

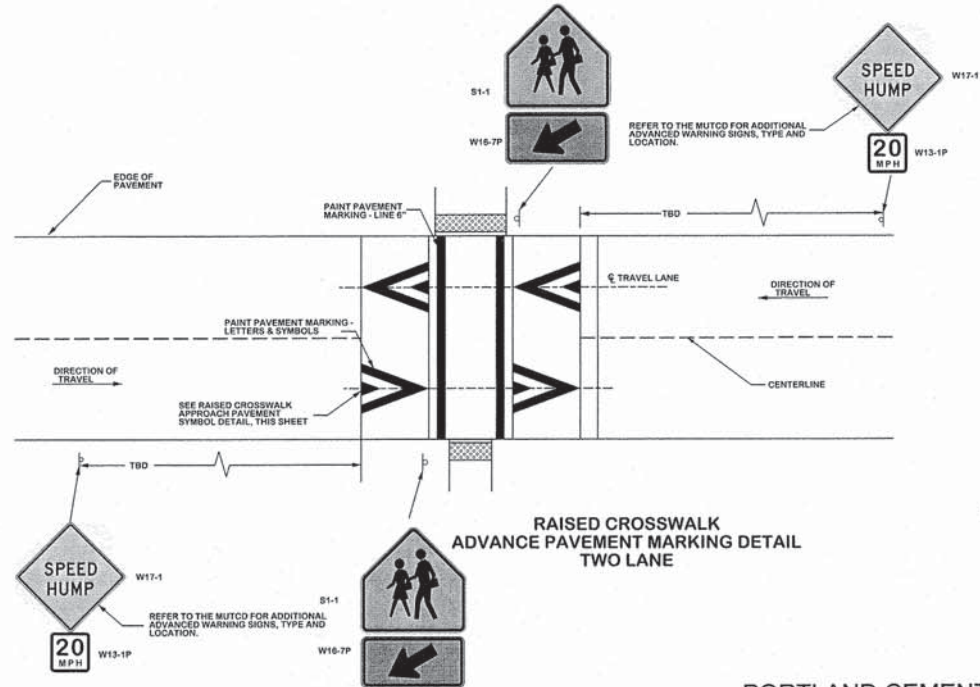

RAISED CROSSWALK
ADVANCE PAVEMENT MARKING DETAIL
TWO LANE

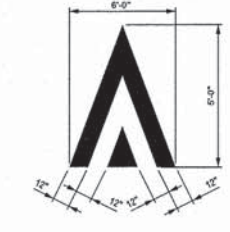

RAISED CROSSWALK APPROACH
PAVEMENT SYMBOL DETAIL

PORTLAND CEMENT CONCRETE PAVEMENT 8" (SPECIAL)
RAISED CROSSWALK DETAIL

N.T.S.

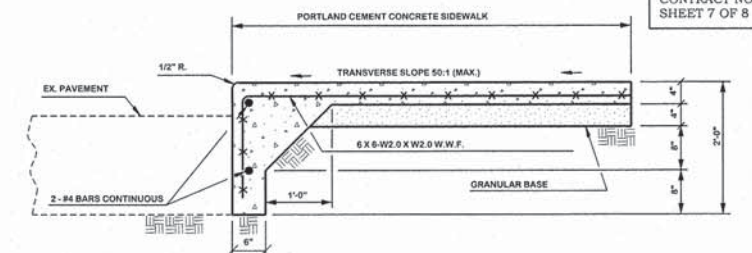

PORTLAND CEMENT CONCRETE
SIDEWALK, 4 INCH
THICKENED EDGE DETAIL

N.T.S.
HIGH SCHOOL / NORTH SCHOOL PARKING LOT

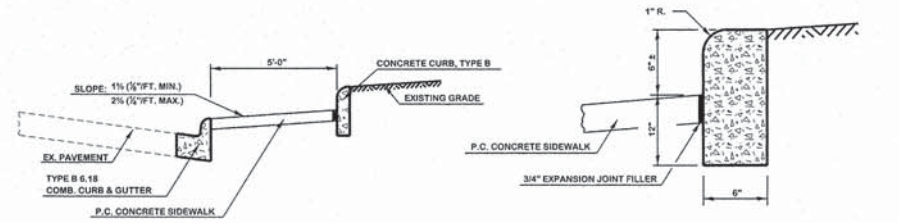

TYPICAL SECTION

SECTION THROUGH CONCRETE CURB, TYPE B

CONCRETE CURB, TYPE B

N.T.S.

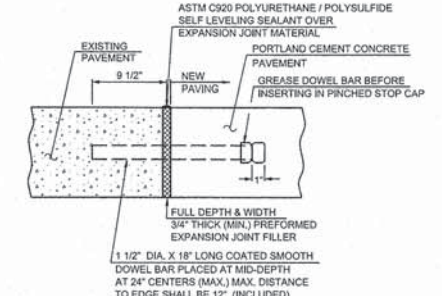

PAVEMENT EXPANSION
JOINT SECTION

N.T.S.

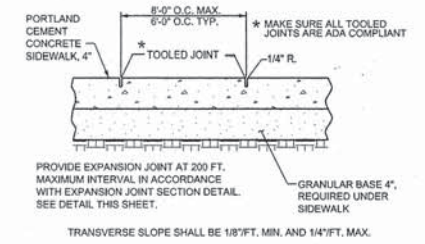

PORTLAND CEMENT
CONCRETE SIDEWALK

N.T.S.

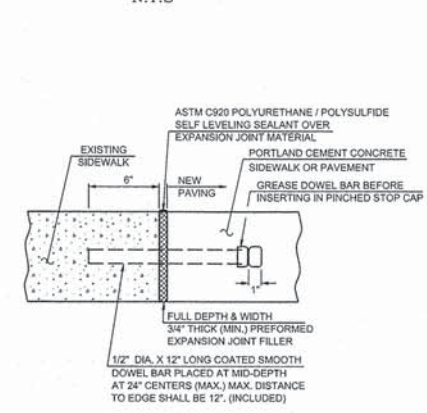

SIDEWALK EXPANSION
JOINT SECTION

N.T.S.

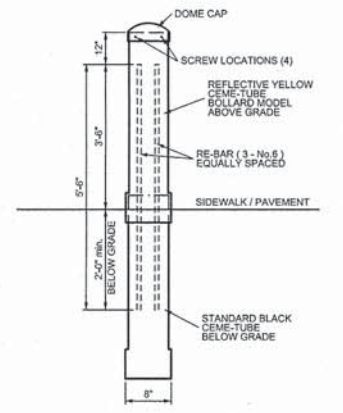

BOLLARD ASSEMBLY DETAIL

N.T.S.

SCALES	DRAWN	TLT
PLAN : N-T-S	DATE	12/30/15
REVISION	CHECKED	
DATE	DATE	
REVISION	APPROVED	
DATE	DATE	
REVISION	REVISION	
DATE	DATE	

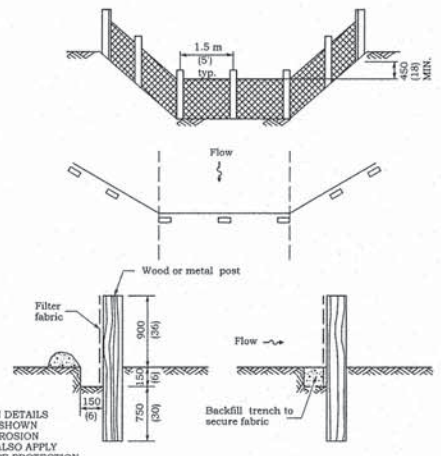

SILT FILTER FENCE AS A PERIMETER EROSION BARRIER

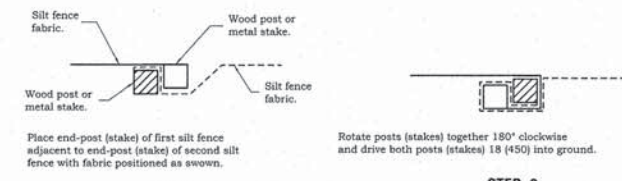

STEP 1
STEP 2
ATTACHING TWO SILT FILTER FENCES
 (Not applicable for J-hooks)

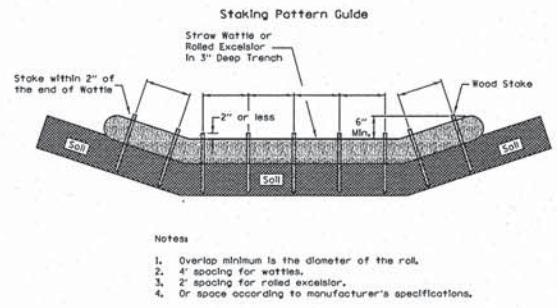

- Notes
1. Overlap minimum is the diameter of the roll.
 2. 4' spacing for wattles.
 3. 2' spacing for rolled excelsior.
 4. Or space according to manufacturer's specifications.

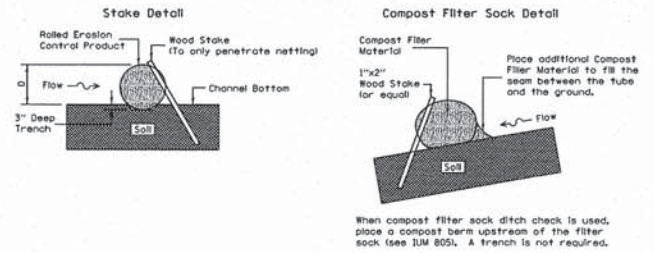

- Notes
1. Drawings are not to scale.
 2. Ends of wattles or rolled excelsior shall be turned at least 6\"/>
 - 3. Recommended stakes are 1 1/8\"/>
 - 4. Stakes shall not extend above the straw wattle more than 2\"/>
 - 5. Spacing: The top of the upstream ditch check shall create a horizontal line with the top of the downstream ditch check.
 - 6. When compost filter sock ditch check is used, place a compost berm upstream of the filter sock (see IJM 805). A trench is not required.

ROLLED EXCELSIOR FOR DITCH CHECK

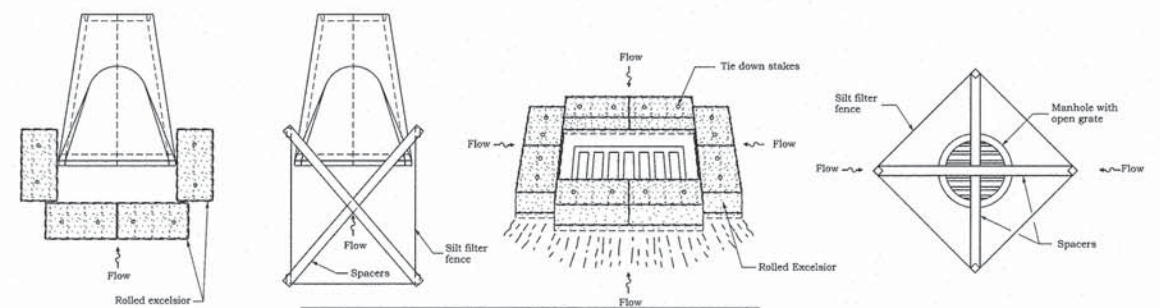

INLET AND PIPE PROTECTION

SCALES	DRAWN: TLT DATE: 12/30/15
PLAN: N-T-S	CHECKED: _____ DATE: _____
REVISED: TLT DATE: 2/18/16	APPROVED: _____ DATE: _____
REVISED: _____ DATE: _____	REVISED: _____ DATE: _____