

F.A.P. RTE.	SECTION	COUNTY	TOTAL SHEETS	SHEET NO.
778	(2-B)-1	SALINE	74	7
FED. ROAD DIST. NO. 9 ILLINOIS FED. AID PROJECT				

See Sheet 9 for Stage Construction Details not shown

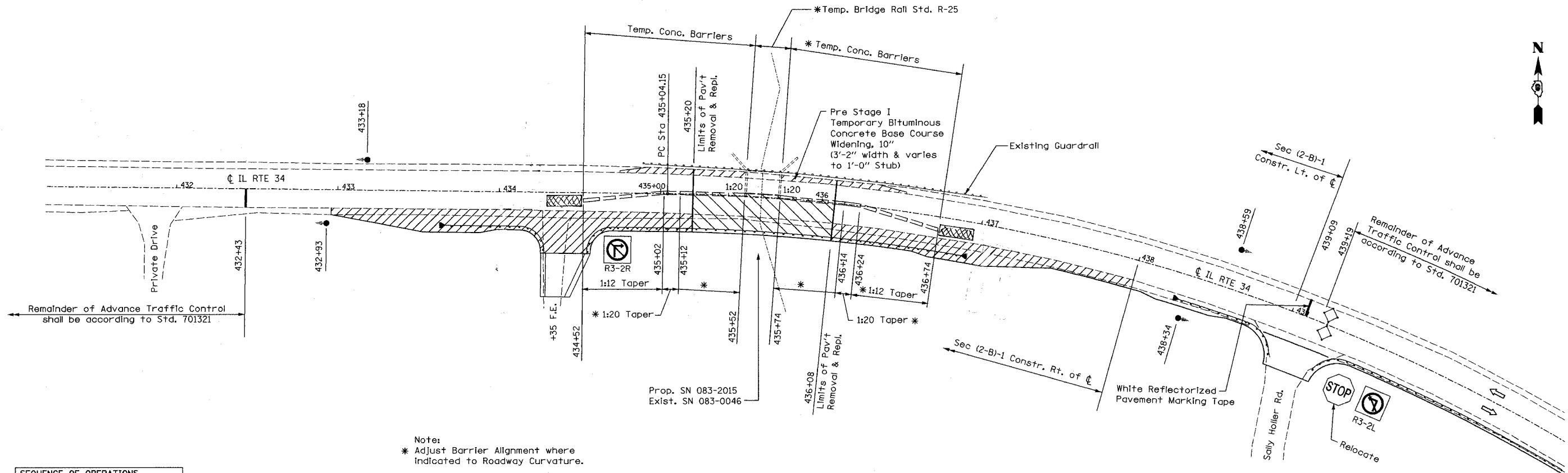

Note:  
\* Adjust Barrier Alignment where Indicated to Roadway Curvature.

PHASE	A			B		
INTERVAL	1	2	3	4	5	6
EASTBOUND	G	Y	R	R	R	R
WESTBOUND	R	R	R	G	Y	R

**GENERAL NOTES**

1. WORK, REQUIRING TRAFFIC CONTROL PER STD. 701321, ON STRUCTURE 083-2015 SHALL NOT BE PERFORMED SIMULTANEOUSLY WITH WORK, REQUIRING TRAFFIC CONTROL PER STD. 701321, ON STRUCTURE 083-2016
2. THIS WORK SHALL SUPPLEMENT AND BE IN ACCORDANCE WITH TRAFFIC CONTROL AND PROTECTION STANDARD 701321, AND 701326.
3. THE COST OF ALL ITEMS REQUIRED PER STANDARDS 701321 & 701326 BUT NOT SPECIFICALLY LISTED AS A PAY ITEM OR SHOWN HEREIN SHALL BE INCLUDED IN THE COST FOR TRAFFIC CONTROL AND PROTECTION STANDARD 701321 AND TRAFFIC CONTROL AND PROTECTION STANDARD 701326.
4. AT CONTRACTOR'S OPTION, BITUMINOUS CONCRETE SURFACE COURSE MAY BE PLACED POST STAGE II UTILIZING STD. 701306. NO ADDITIONAL COMPENSATION WILL BE ALLOWED.

**STAGE 1**

1. TRAFFIC USES EXISTING PAVEMENT AND THE NORTH HALF OF THE EXISTING BRIDGE, AS SHOWN IN STAGE CONSTRUCTION DRAWINGS.
2. ALL WORK IS DONE UNDER TRAFFIC CONTROL AND PROTECTION STD. 701321, UNLESS NOTED OTHERWISE.
3. THE SOUTH PORTION OF THE EXISTING BRIDGE IS TO BE REMOVED AND THE SOUTH HALF OF THE PROPOSED BOX CULVERT TO BE CONSTRUCTED AS SHOWN IN STAGE CONSTRUCTION DRAWINGS.
4. BITUMINOUS SHOULDER WIDENING AND GUARDRAIL TO BE CONSTRUCTED UTILIZING STD. 701326 OUTSIDE THE WORK ZONE COVERED BY STD. 701321. PORTIONS OF THIS WORK SHALL BE CONSTRUCTED PRE-STAGE 1 USING STANDARD 701326.
5. RELOCATE TRAFFIC CONTROL DRUMS, TEMPORARY CONCRETE BARRIERS, AND IMPACT ATTENUATORS FOR STAGE 2.

ITEM	UNITS	QTY
TRAFFIC CONTROL & PROTECTION STD. 701321 (SPECIAL)	EACH	1
TRAFFIC CONTROL & PROTECTION STD. 701326	L SUM	1
TEMPORARY BRIDGE RAIL STD. R-25	LF	22
TEMPORARY PAINT PAVEMENT MARKING LINE, 4"	LF	171
TEMPORARY PAINT PAVEMENT MARKING LINE, 24"	LF	24
WORK ZONE PAVEMENT MARKING REMOVAL	SQ FT	24
IMPACT ATTENUATORS (NON REDIRECTIVE, TEMPORARY)	EACH	2
TEMPORARY BRIDGE TRAFFIC SIGNALS	EACH	1
TEMPORARY CONCRETE BARRIER	LF	180
TEMPORARY TRAFFIC BARRIER TERMINAL TY 11	EACH	2
BITUMINOUS CONCRETE BASE COURSE WIDENING, 10"	SQ YD	44
TEMPORARY RUMBLE STRIPS	EACH	6

**LEGEND**

	Work Zone Utilizing Std. 701321
	Bituminous Shoulder Widening Utilizing Std. 701326
	Traffic Signal
	Temporary Bridge Rail Std. R-25
	Impact Attenuator (Non Redirective, Temporary)
	Induction Loop Detector
	Temporary Concrete Barrier

NAME	DATE

ILLINOIS DEPARTMENT OF TRANSPORTATION  
**FAP ROUTE 778 (IL 34)**  
**SEC. (2-B)-1, SALINE COUNTY**  
**TRAFFIC CONTROL PLAN**  
**STAGE I SN-083-2015**  
 SCALE: VERT. \_\_\_\_\_ DRAWN BY \_\_\_\_\_  
 HORIZ. \_\_\_\_\_ DATE \_\_\_\_\_ CHECKED BY \_\_\_\_\_

C:\ROADWAY\PROJECTS\TRAFFIC\11-17-2008\REF 11-25-08