

F.A.P. RTE.	SECTION	COUNTY	TOTAL SHEETS	SHEET NO.
778	(2-B)-1	SALINE	74	8
FED. ROAD DIST. NO. 9 ILLINOIS FED. AID PROJECT				

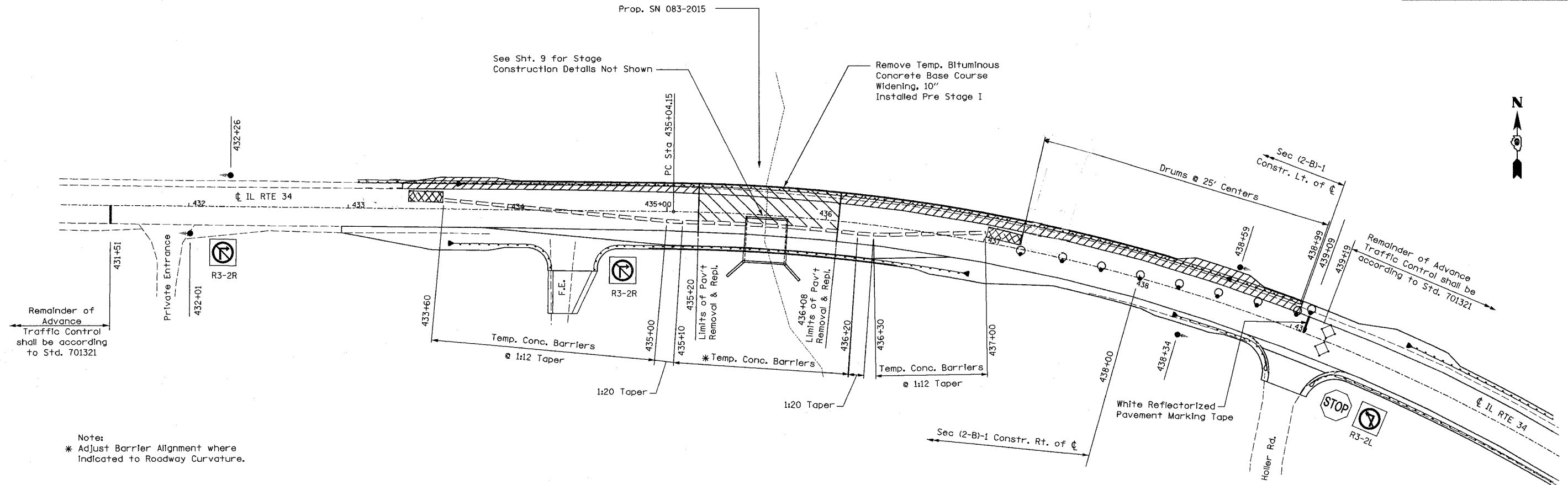

Note:  
\* Adjust Barrier Alignment where Indicated to Roadway Curvature.

PHASE	A	B
INTERVAL	1 2 3 4 5 6	
EASTBOUND	G Y R R R R	
WESTBOUND	R R R G Y R	

- LEGEND**
- Work Zone Utilizing Std. 701321
  - Bituminous Shoulder Widening Utilizing Std. 701326
  - Drum with Steady Burning Light
  - Traffic Signal
  - Temporary Concrete Barrier
  - Impact Attenuator (Non Redirective, Temporary)
  - Induction Loop Detector

**GENERAL NOTES**

1. WORK, REQUIRING TRAFFIC CONTROL PER STD. 701321, ON STRUCTURE 083-2015 SHALL NOT BE PERFORMED SIMULTANEOUSLY WITH WORK, REQUIRING TRAFFIC CONTROL PER STD. 701321, ON STRUCTURE 083-2016
2. THIS WORK SHALL SUPPLEMENT AND BE IN ACCORDANCE WITH TRAFFIC CONTROL AND PROTECTION STANDARD 701321, AND 701326.
3. THE COST OF ALL ITEMS REQUIRED PER STANDARD 701321 & 701326 BUT NOT SPECIFICALLY LISTED AS A PAY ITEM OR SHOWN HEREIN SHALL BE INCLUDED IN THE COST FOR TRAFFIC CONTROL AND PROTECTION STANDARD 701321 AND TRAFFIC CONTROL AND PROTECTION STANDARD 701326.
4. AT CONTRACTOR'S OPTION, BITUMINOUS CONCRETE SURFACE COURSE MAY BE PLACED POST STAGE II UTILIZING STD. 701306. NO ADDITIONAL COMPENSATION WILL BE ALLOWED.

**STAGE 2**

1. TRAFFIC USES NEW PAVEMENT AND THE SOUTH HALF OF THE PROPOSED BRIDGE, AS SHOWN IN STAGE CONSTRUCTION DRAWINGS.
2. ALL WORK IS DONE UNDER TRAFFIC CONTROL AND PROTECTION STD. 701321, EXCEPT AS NOTED HEREIN.
3. THE NORTH PORTION OF THE EXISTING BRIDGE IS TO BE REMOVED AND THE NORTH HALF OF THE PROPOSED BOX CULVERT TO BE CONSTRUCTED AS SHOWN IN STAGE CONSTRUCTION DRAWINGS.
4. BITUMINOUS SHOULDER WIDENING AND GUARDRAIL ON THE WESTBOUND LANE TO BE CONSTRUCTED UTILIZING STD. 701326 OUTSIDE THE WORKZONE COVERED BY STD. 701321. AT CONTRACTOR'S OPTION, PORTIONS OF THIS WORK MAY BE CONSTRUCTED PRE-STAGE I OR POST STAGE II UTILIZING STD. 701326.

ITEM	UNITS	QTY
TEMPORARY CONCRETE BARRIER	LF	160
RELOCATE TEMPORARY CONC. BARRIER	LF	180
IMPACT ATTENUATORS (NON REDIRECTIVE, RELOCATE)	EACH	2
PAVEMENT REMOVAL	SQ YD	44
TEMPORARY PAINT PAVEMENT MARKING LINE, 4"	LF	298
TEMPORARY PAINT PAVEMENT MARKING LINE, 24"	LF	12
WORK ZONE PAVEMENT MARKING REMOVAL	SQ FT	147
TEMPORARY RUMBLE STRIPS	EACH	6

NAME	DATE

ILLINOIS DEPARTMENT OF TRANSPORTATION  
**FAP ROUTE 778 (IL 34)**  
**SEC. (2-B)-1, SALINE COUNTY**  
**TRAFFIC CONTROL PLAN**  
**STAGE II SN-083-2015**

SCALE: VERT. \_\_\_\_\_  
 HORIZ. \_\_\_\_\_

DATE \_\_\_\_\_ DRAWN BY \_\_\_\_\_  
 CHECKED BY \_\_\_\_\_