

F.A.P. RTE.	SECTION	COUNTY	TOTAL SHEETS	SHEET NO.
778	Q2-B1-1	SALINE	74	28

FED. ROAD DIST. NO. 9 ILLINOIS FED. AID PROJECT 95

ORIGINAL SURVEY	DATE
SURVEYED	
PLOTTED	
TEMPLATE	
NOTE BOOK	
AREAS CHECKED	

FINAL SURVEY	DATE
SURVEYED	
PLOTTED	
TEMPLATE	
NOTE BOOK	
AREAS CHECKED	

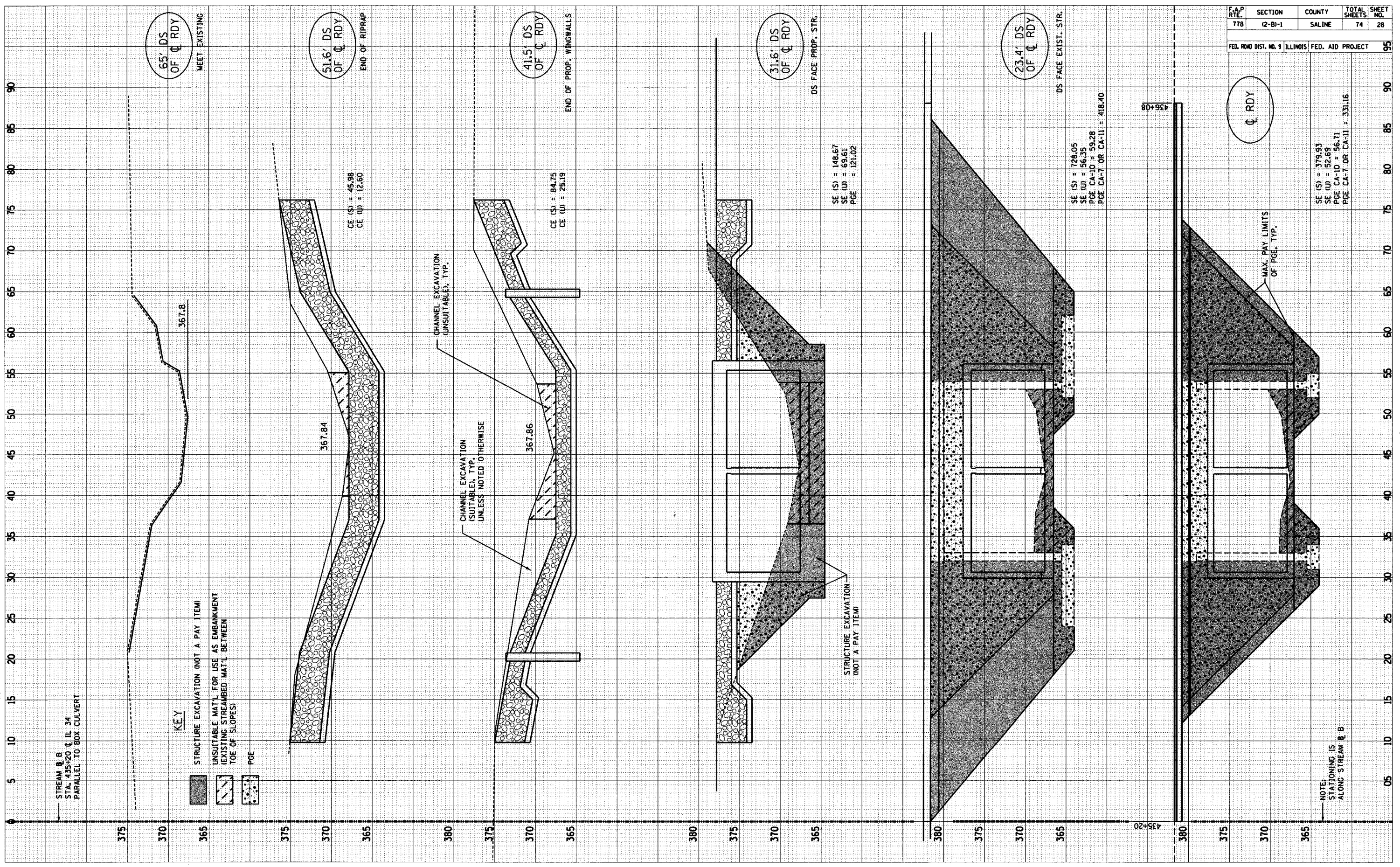

65' DS OF CL RDY MEET EXISTING

51.6' DS OF CL RDY END OF RIPRAP

41.5' DS OF CL RDY END OF PROP. WINGWALLS

31.6' DS OF CL RDY DS FACE PROP. STR.

23.4' DS OF CL RDY DS FACE EXIST. STR.

CL RDY

STREAM B STA. 435+20 CL IL 34 PARALLEL TO BOX CULVERT

KEY

- STRUCTURE EXCAVATION (NOT A PAY ITEM)
- UNSUITABLE MAT'L FOR USE AS EMBANKMENT EXISTING STREAMBED MAT'L BETWEEN TOE OF SLOPES
- PGE

SE (S) = 148.67
SE (U) = 69.61
PGE = 121.02

SE (S) = 178.05
SE (U) = 56.35
PGE CA-10 = 59.28
PGE CA-7 OR CA-11 = 418.40

SE (S) = 379.93
SE (U) = 56.69
PGE CA-10 = 56.71
PGE CA-7 OR CA-11 = 331.16

MAX. PAY LIMITS OF PGE, TYP.

NOTE: STATIONING IS ALONG STREAM B B