

F.A.P. RTE.	SECTION	COUNTY	TOTAL SHEETS	SHEET NO.
331	5-(2,3) I-1, TS-2	JACKSON	94	27
STA.		TO STA.		
FED. ROAD DIST. NO.	ILLINOIS	FED. AID PROJECT		

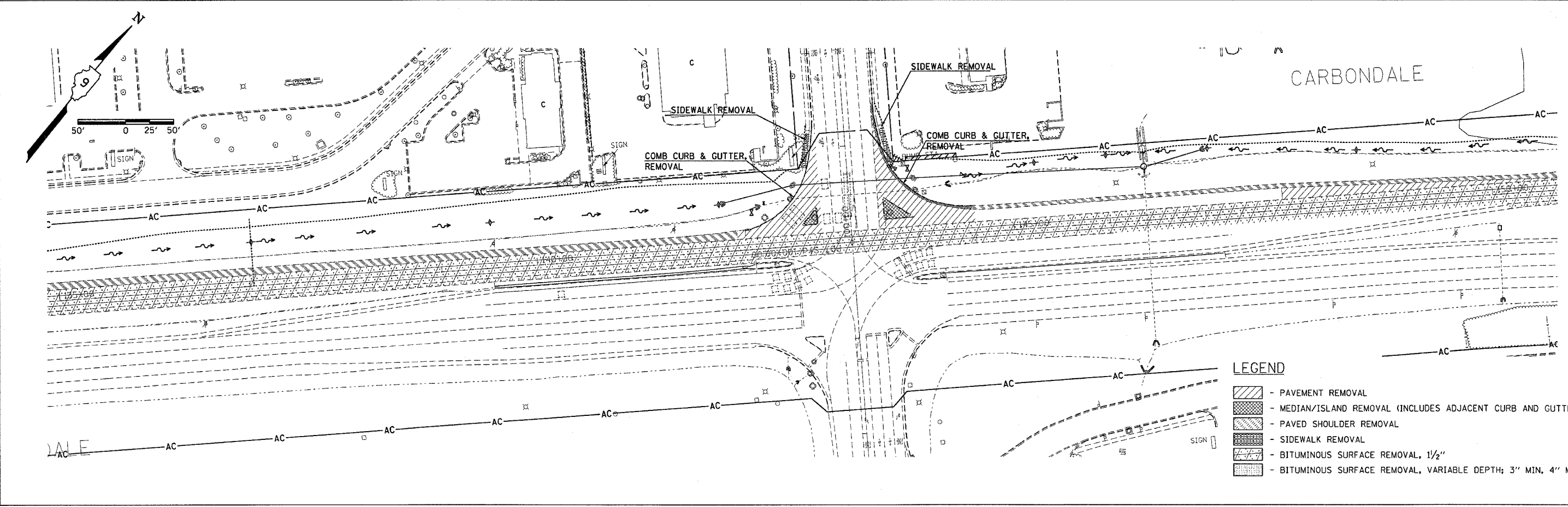
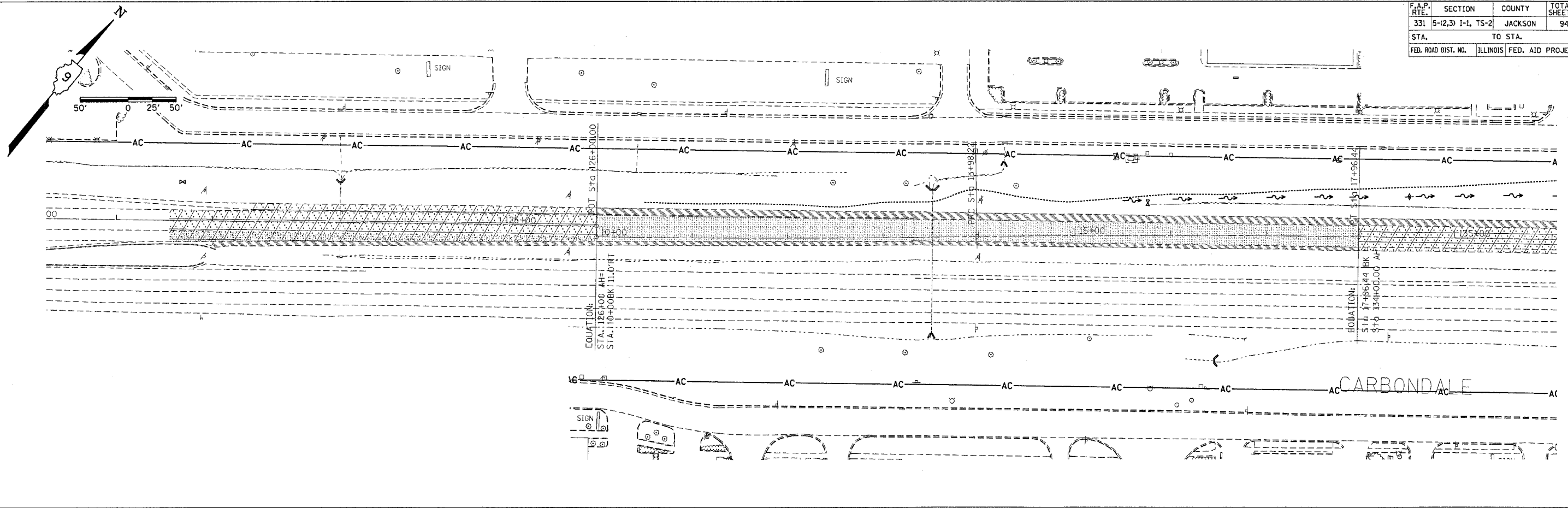

- LEGEND**
- PAVEMENT REMOVAL
 - MEDIAN/ISLAND REMOVAL (INCLUDES ADJACENT CURB AND GUTTER)
 - PAVED SHOULDER REMOVAL
 - SIDEWALK REMOVAL
 - BITUMINOUS SURFACE REMOVAL, 1/2"
 - BITUMINOUS SURFACE REMOVAL, VARIABLE DEPTH; 3" MIN, 4" MAX

REMOVAL

THIS MAY BE... 0906200 0004
 c:\projects\d90490\d90490.mxd LV2-55,57-63
 DWS: D:\projects\d90490\d90490.mxd, LV2-4-14, 15, 19-21, 23, 25, 28, 30, 32, 35, 37, 39, 41, 44, 48-52, 54, 55
 DWS: D:\projects\d90490\d90490.mxd, LV2-4-14, 15, 19-21, 23, 25, 28, 30, 32, 35, 37, 39, 41, 44, 48-52, 54, 55