

F.A.P. RTE.	SECTION	COUNTY	TOTAL SHEETS	SHEET NO.
331	5-(2,3)I-1,TS-2	JACKSON	94	75
STA. 142+70		TO STA.142+80		
FED. ROAD DIST. NO.		ILLINOIS FED. AID PROJECT		

DATE: _____
 BY: _____
 SURVEYED _____
 PLOTTED _____
 TEMPLATE _____
 NOTE BOOK _____
 AREAS CHECKED _____

DATE: _____
 BY: _____
 SURVEYED _____
 PLOTTED _____
 TEMPLATE _____
 NOTE BOOK _____
 AREAS CHECKED _____

Thu Mar 18 09:03:31 2004
 c:\p\project\61904503\user\118r1b.dgn Lvl=35,37,63

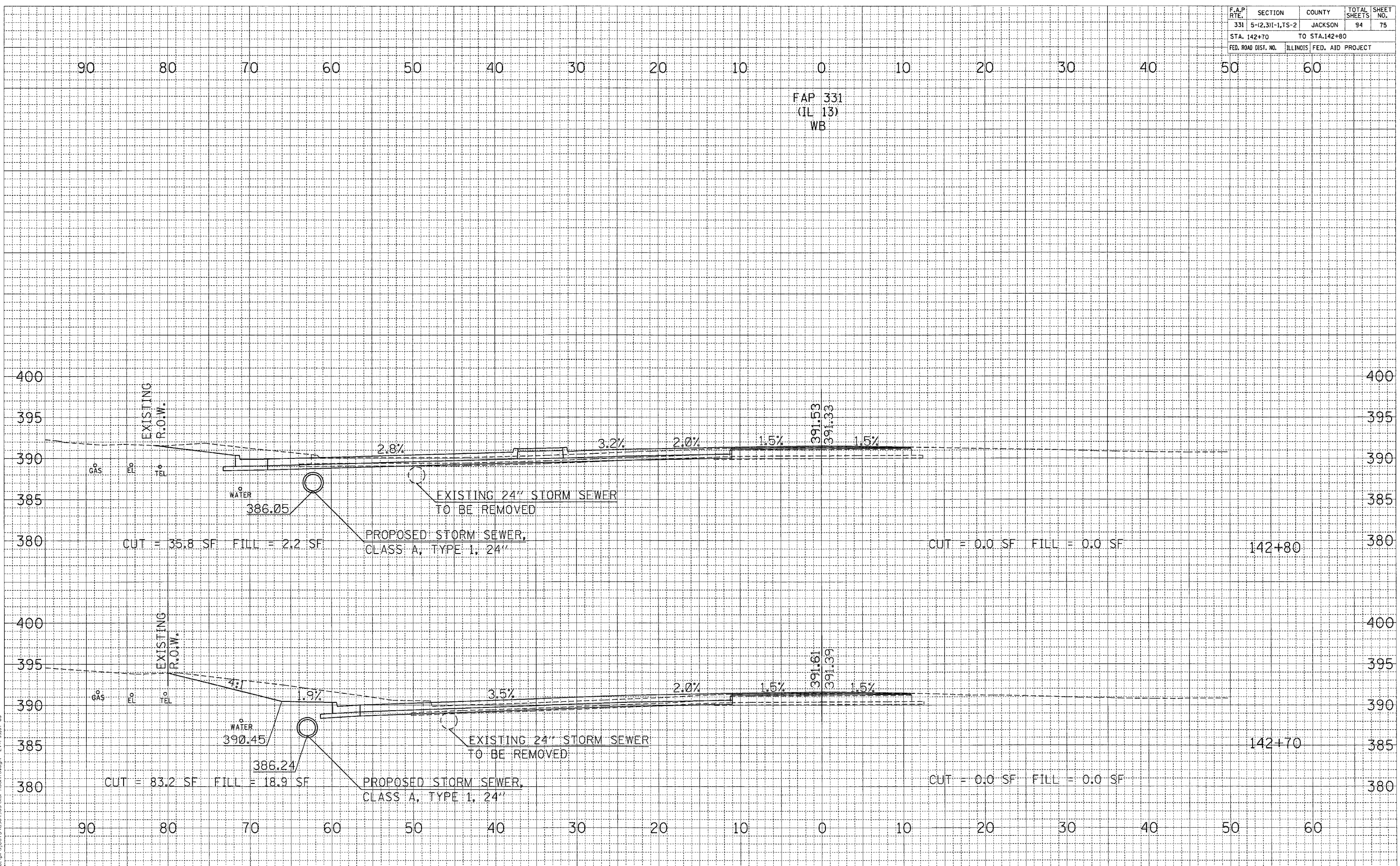

CROSS SECTIONS STA 142+70 TO STA 142+80