

F.A.P. RTE.	SECTION	COUNTY	TOTAL SHEETS	SHEET NO.
331	5-(2,311-1,TS-2	JACKSON	94	77
STA. 143+10		TO STA.143+20		
FED. ROAD DIST. NO.		ILLINOIS FED. AID PROJECT		

DATE	BY

DATE	BY

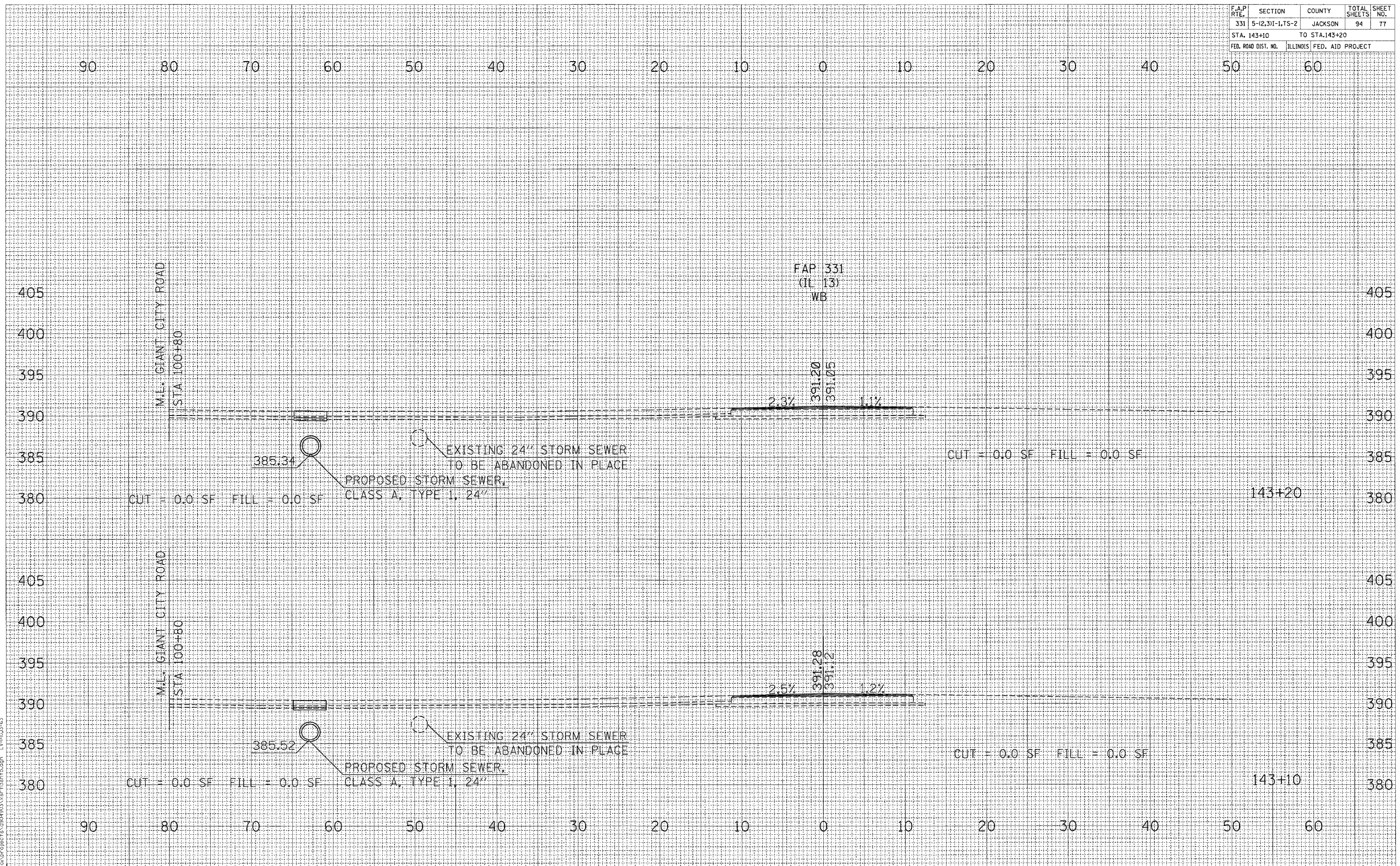

The: Feb 18 M6536 2004
 d:\projecta\380493\380493.dgn L:\m\j\143

CROSS SECTIONS STA 143+10 TO STA 143+20