

F.A.P. RTE.	SECTION	COUNTY	TOTAL SHEETS	SHEET NO.
331	5-(2,3)-1,TS-2	JACKSON	94	79
STA. 143+50		TO STA. 143+60		
FED. ROAD DIST. NO.		ILLINOIS FED. AID PROJECT		

DATE	
BY	
DESIGNED	
PLOTTED	
TEMPLATE	
AREAS CHECKED	
NO.	
FINAL SURVEY	
NOTE BOOK	

DATE	
BY	
DESIGNED	
PLOTTED	
TEMPLATE	
AREAS CHECKED	
NO.	
ORIGINAL SURVEY	
NOT FOR	

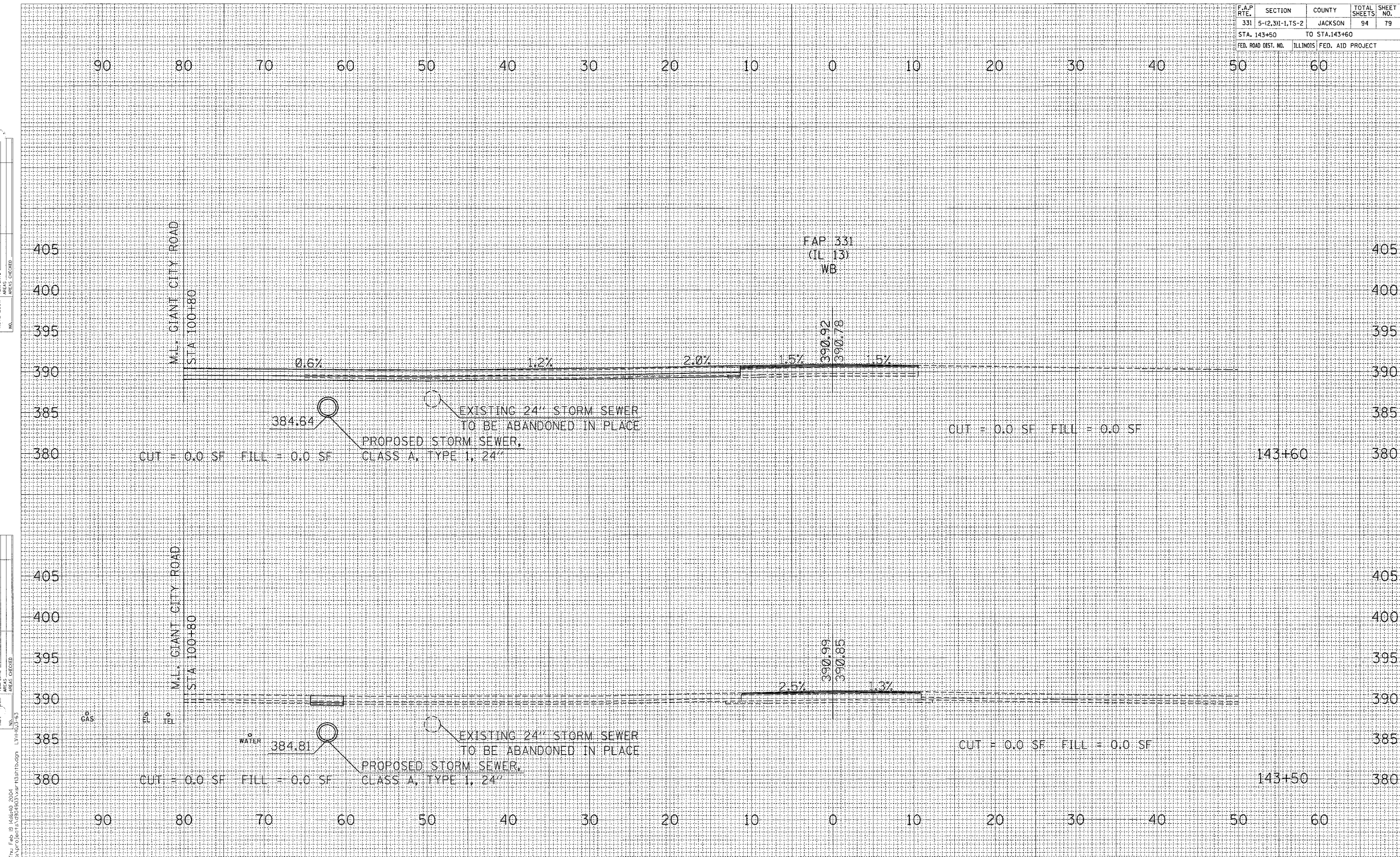

Top File is 143+50.dwg
 on 10/24/2004 10:00:00 AM
 by 10/24/2004 10:00:00 AM
 L:\H\1011\1011.dwg

CROSS SECTIONS STA 143+50 TO STA 143+60