

F.A.P. RTE.	SECTION	COUNTY	TOTAL SHEETS	SHEET NO.
331	5-(2,311-1,TS-2	JACKSON	94	84
STA. 146+39.83		TO STA. 147+00		
FED. ROAD DIST. NO.		ILLINOIS FED. AID PROJECT		

DATE	BY
ORIGINAL SURVEY	REVISIONS
NOTE BOOK	PLOTTED
NO.	TEMPLATE
	AREAS
	CHECKED

DATE	BY
ORIGINAL SURVEY	REVISIONS
NOTE BOOK	PLOTTED
NO.	TEMPLATE
	AREAS
	CHECKED

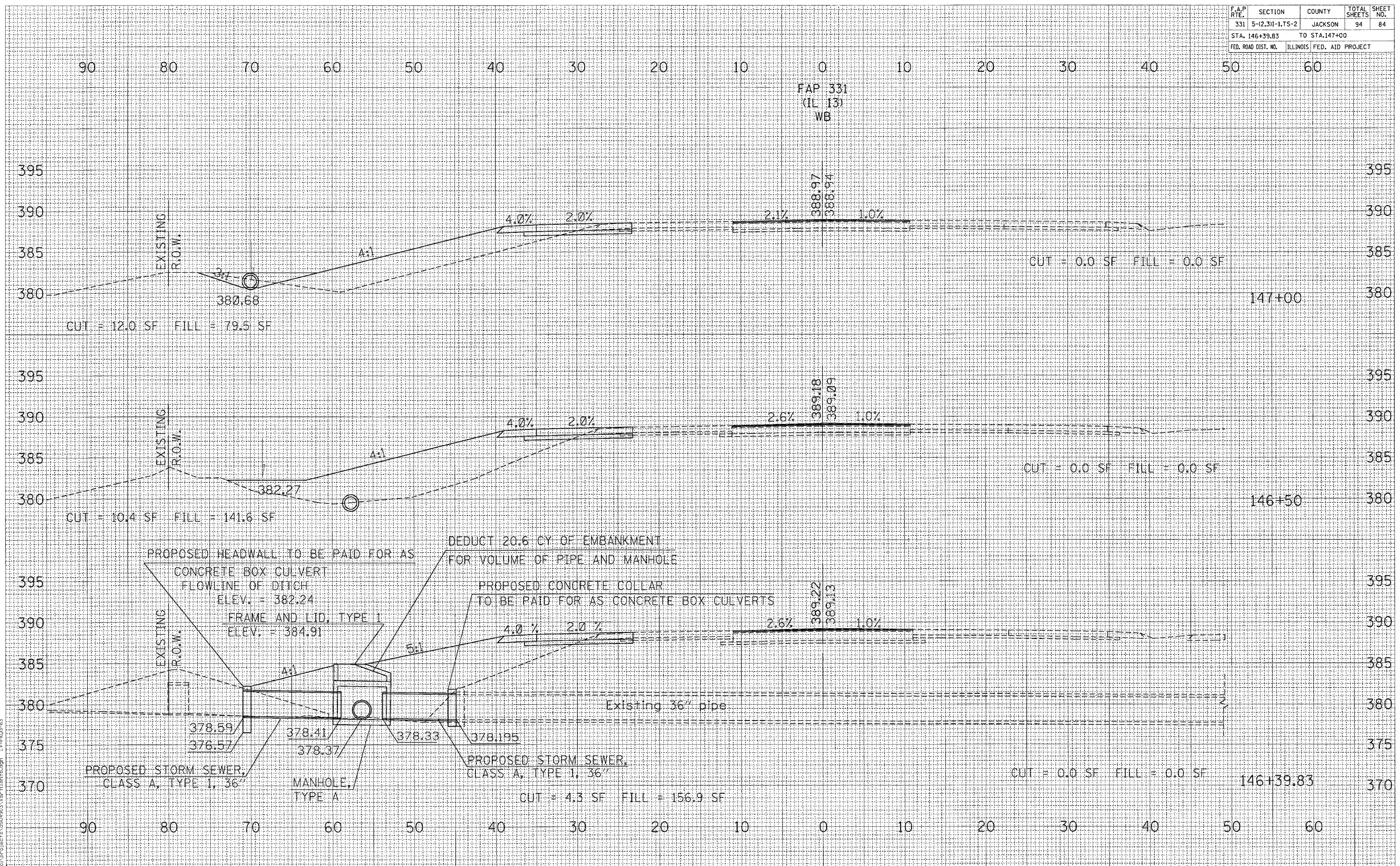

This file is for use only by the user who created it. It is not to be distributed or used for any other purpose.

**CROSS SECTIONS STA 146+39.83 TO STA 147+00**