

STATE OF ILLINOIS
DEPARTMENT OF TRANSPORTATION

F.A.I. RTE.	SECTION	COUNTY	TOTAL SHEETS	SHEET NO.
94	2020-259-BR	COOK	31	J
		ILLINOIS	CONTRACT NO. 62N30	

D-91-072-21

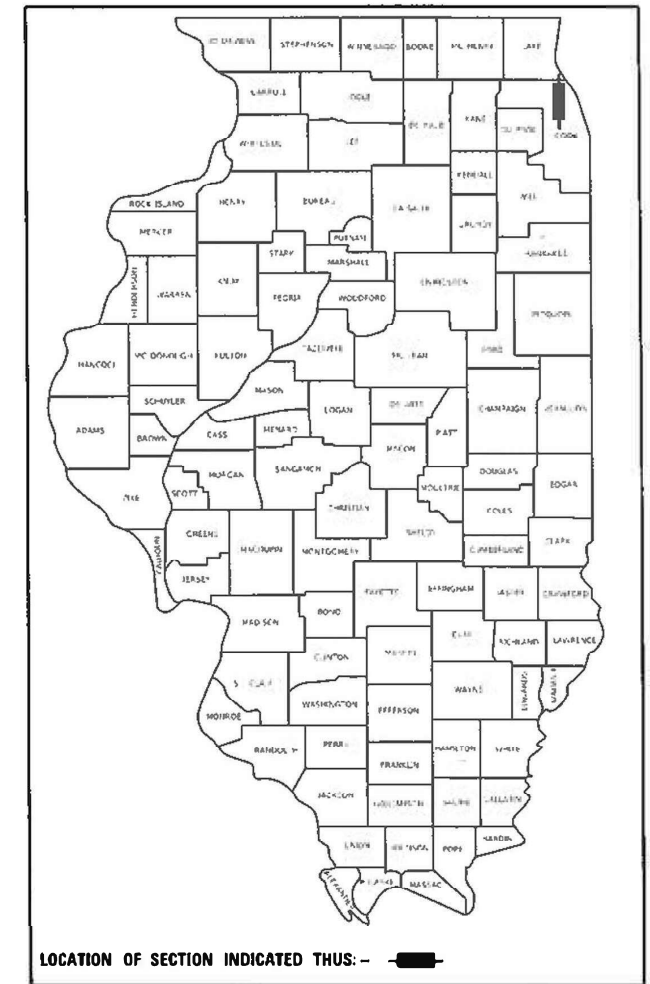

PROPOSED HIGHWAY PLANS

F.A.I. ROUTE 94: I-94
AT VARIOUS LOCATIONS
SECTION 2020-259-BR
SUBSTRUCTURE REPAIRS
COOK COUNTY

C-91-088-21

FOR INDEX OF SHEETS, SEE SHEET NO. 2

TRAFFIC DATA

IL RTE 50:

EXISTING ADT = 26600 (2018)

POSTED SPEED LIMIT = 30 MPH

I-94

EXISTING ADT = 128800 (2018)

POSTED SPEED LIMIT = 55 MPH

THE IMPROVEMENT IS LOCATED IN
THE VILLAGES OF SKOKIE AND WILMETTE,
AND THE CITY OF CHICAGO

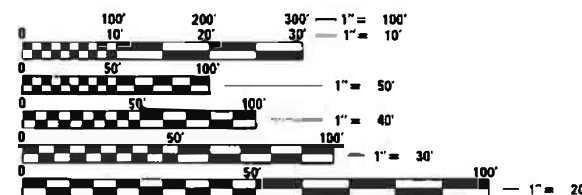

FULL SIZE PLANS HAVE BEEN PREPARED USING STANDARD
ENGINEERING SCALES. REDUCED SIZED PLANS WILL NOT
CONFORM TO STANDARD SCALES. IN MAKING MEASUREMENTS
ON REDUCED PLANS, THE ABOVE SCALES MAY BE USED.

J.U.L.I.E.
JOINT UTILITY LOCATION INFORMATION FOR EXCAVATORS
1-800-892-0123
OR 811

LOCATION OF IMPROVEMENT:
VILLAGE OF WILMETTE
I-94 AT LAKE AVE
SN 016-0943

LOCATION OF IMPROVEMENT:
VILLAGE OF SKOKIE
I-94 AT IL 58 (DEMPSTER AVE)
SN 016-0545

LOCATION OF IMPROVEMENT:
CITY OF CHICAGO
I-94 AT IL 50 (CICERO AVE)
SN 016-0108

C.U.A.N.
CHICAGO UTILITY ALERT NETWORK
1-312-744-7000

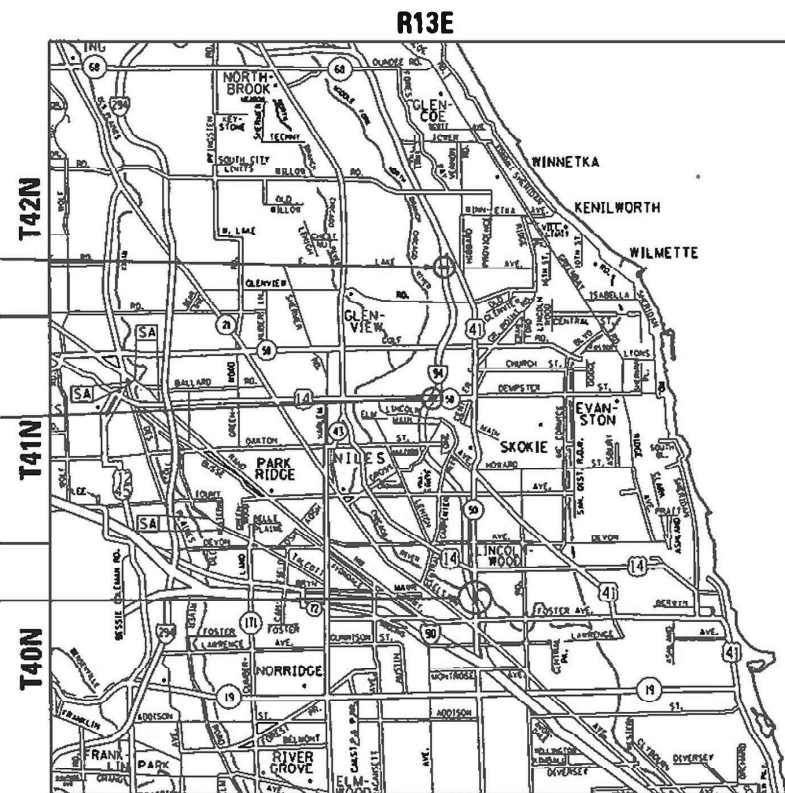

NEW TRIER, JEFFERSON, AND NILES TOWNSHIPS

GROSS LENGTH = 537.43 FT. = 0.102 MILE
NET LENGTH = 537.43 FT. = 0.102 MILE

PROJECT MANAGER: J. ALAIN MIDY 847-221-3056

CONTRACT NO. 62N30

STATE OF ILLINOIS
DEPARTMENT OF TRANSPORTATION

SUBMITTED February 2, 2021

Jose Bros / CB
REGIONAL ENGINEER

March 19, 2021
Scott A. Elk
ENGINEER OF DESIGN AND ENVIRONMENT

March 19, 2021
James J. Gu
DIRECTOR OF HIGHWAYS PROJECT IMPLEMENTATION

PRINTED BY THE AUTHORITY
OF THE STATE OF ILLINOIS

INDEX OF SHEETS

1	COVER SHEET
2	INDEX OF SHEETS, STATE STANDARDS AND GENERAL NOTES
3	SUMMARY OF QUANTITIES
4	TRAFFIC CONTROL TYPICAL SECTION (SN 016-0108)
5	TRAFFIC CONTROL STAGING (SN 016-0108)
6-10	PROPOSED SUBSTRUCTURE REPAIR PLANS (SN 016-0108)
11	TRAFFIC CONTROL TYPICAL SECTION (SN 016-0545)
12	TRAFFIC CONTROL STAGING (SN 016-0545)
13-17	PROPOSED SUBSTRUCTURE REPAIR PLANS (SN 016-0545)
18	TRAFFIC CONTROL TYPICAL SECTION (SN 016-0943)
19	TRAFFIC CONTROL STAGING (SN 016-0943)
20-24	PROPOSED SUBSTRUCTURE REPAIR PLANS (SN 016-0943)
25	ENTRANCE AND EXIT RAMP CLOSURE DETAILS (TC-08)
26	TRAFFIC CONTROL AND PROTECTION FOR FREEWAY SINGLE & MULTI-LANE WEAVE (TC-09)
27	TRAFFIC CONTROL AND PROTECTION FOR SIDEROADS, INTERSECTIONS AND DRIVEWAYS (TC-10)
28	TRAFFIC CONTROL AND PROTECTION AT TURNBAYS (TC-14)
29	SHORT TERM PAVEMENT MARKING LETTERS AND SYMBOLS (TC-16)
30	TRAFFIC CONTROL DETAILS FOR FREEWAY SHOULDER CLOSURES AND PARTIAL RAMP CLOSURES (TC-17)
31	ARTERIAL ROAD INFORMATION SIGN (TC-22)

STATE STANDARDS

701101-05	OFF-RD OPERATIONS, MULTILANE, 15' (4.5 m) TO 24" (600 mm) FROM PAVEMENT EDGE
701106-02	OFF-RD OPERATIONS, MULTILANE, MORE THAN 15' (4.5 m) AWAY
701400-10	APPROACH TO LANE CLOSURE, FREEWAY/EXPRESSWAY
701401-12	LANE CLOSURE, FREEWAY/EXPRESSWAY
701411-09	LANE CLOSURE, MULTILANE, AT ENTRANCE OR EXIT RAMP, FOR SPEEDS > 45 MPH
701427-05	LANE CLOSURE, MULTILANE, INTERMITTENT OR MOVING OPER., FOR SPEEDS < 40 MPH
701428-01	TRAFFIC CONTROL SETUP AND REMOVAL FREEWAY/EXPRESSWAY
701446-11	TWO LANE CLOSURE, FREEWAY/EXPRESSWAY
701601-09	URBAN LANE CLOSURE, MULTILANE, 1W OR 2W WITH NONTRAVERSABLE MEDIAN
701701-10	URBAN LANE CLOSURE, MULTILANE INTERSECTION
701801-06	SIDEWALK, CORNER OR CROSSWALK CLOSURE
701901-08	TRAFFIC CONTROL DEVICES
704001-08	TEMPORARY CONCRETE BARRIER
782006-01	GUARDRAIL AND BARRIER WALL REFLECTOR MOUNTING DETAILS

GENERAL NOTES

1. BEFORE STARTING ANY EXCAVATION, THE CONTRACTOR SHALL CALL C.U.A.N. AT (312) 744-7000 FOR FIELD LOCATIONS OF BURIED ELECTRIC, TELEPHONE AND GAS UTILITIES. (48 HOUR NOTIFICATION IS REQUIRED).
2. BEFORE STARTING ANY EXCAVATION, THE CONTRACTOR SHALL CALL "J.U.L.I.E." AT (800) 892-0123 OR 811 FOR FIELD LOCATIONS OF BURIED ELECTRIC, TELEPHONE AND GAS UTILITIES. 48 HOUR NOTIFICATION IS REQUIRED.
3. THE CONTRACTOR SHALL COORDINATE CONSTRUCTION ACTIVITIES WITH UTILITY COMPANIES, THE CITY OF CHICAGO, AND THE VILLAGES OF WILMETTE AND SKOKIE.
4. THE CONTRACTOR WILL NOT BE ALLOWED TO SET UP A YARD OR FIELD OFFICE ON STATE PROPERTY WITHOUT WRITTEN PERMISSION FROM THE DEPARTMENT.
5. IT SHALL BE THE CONTRACTORS RESPONSIBILITY TO VERIFY ALL DIMENSIONS AND CONDITIONS EXISTING IN THE FIELD PRIOR TO CONSTRUCTION AND ORDERING OF MATERIALS.
6. THE CONTRACTOR SHALL CONTACT THE DISTRICT ONE TRAFFIC CONTROL SUPERVISOR AT KALPANA.KANNAN-HOSADURGA@ILLINOIS.GOV FOR ARTERIALS AND (847) 705-4151 FOR EXPRESSWAYS A MINIMUM OF 72 HOURS IN ADVANCE OF BEGINNING WORK.
7. THE CONTRACTOR SHALL REQUEST AND GAIN APPROVAL FROM THE ILLINOIS DEPARTMENT OF TRANSPORTATION'S EXPRESSWAY TRAFFIC OPERATIONS ENGINEER AT WWW.IDOTLCS.COM AT LEAST 24 HOURS IN ADVANCE OF ALL DAILY LANE, RAMP, AND SHOULDER CLOSURES AND 7 DAYS IN ADVANCE OF ALL PERMANENT AND WEEKEND CLOSURES ON ALL FREEWAYS AND/OR EXPRESSWAYS. THIS ADVANCE NOTIFICATION IS CALCULATED BASED ON WORKWEEK OF MONDAY THROUGH FRIDAY AND SHALL NOT INCLUDE WEEKENDS AND HOLIDAYS.
8. THESE PLANS HAVE BEEN PREPARED FROM NOTES RECEIVED FROM THE BUREAU OF MAINTENANCE.
9. DO NOT SCALE PLANS FOR CONSTRUCTION DIMENSIONS.
10. THE "ARTERIAL ROAD INFORMATION SIGN (TC-22)" IS APPLICABLE ONLY TO ARTERIAL ROADS AND SHALL NOT BE APPLIED TO EXPRESSWAYS/TOLLWAYS.

MODEL: Default
 FILE NAME: \\paulamr0001.dca.illinois.gov\PIWDOT\Documents\DOT_Offices\District 1\Projects\I-94 Bridge Repair\CADD\Bids\Design\1\1xxxxx-shr-generals.dgn

	USER NAME = rothjp PLOT SCALE = 100,0000' / in. PLOT DATE = 2/5/2021	DESIGNED - DRAWN - CHECKED - DATE -	REVISED - REVISED - REVISED - REVISED -	STATE OF ILLINOIS DEPARTMENT OF TRANSPORTATION	I-94 AT IL 50, LAKE AVE, AND IL 58 (DEMPSTER AVE) INDEX OF SHEETS, STATE STANDARDS AND GENERAL NOTES	F.A.I. RTE. 94	SECTION 2020-259-BR	COUNTY COOK	TOTAL SHEETS 31	SHEET NO. 2
SCALE: SHEET 1 OF 1 SHEETS STA. TO STA.						ILLINOIS FED. AID PROJECT CONTRACT NO. 62N30				

SUMMARY OF QUANTITIES			URBAN TOTAL QUANTITIES 100% STATE	CONSTRUCTION TYPE CODE			
CODE NO	ITEM	UNIT		016-0108 LOC #1 0013	016-0545 LOC #2 0013	016-0943 LOC #3 0013	
67000400	ENGINEER'S FIELD OFFICE, TYPE A	CAL MO	6	2	2	2	
70107005	PAVEMENT MARKING BLACKOUT TAPE, 5"	FOOT	453	453			
67100100	MOBILIZATION	L SUM	1	0.33	0.33	0.34	
70107025	CHANGEABLE MESSAGE SIGN	CAL DA	20	20			
70200100	NIGHTTIME WORK ZONE LIGHTING	L SUM	1		0.5	0.5	
70300520	PAVEMENT MARKING TAPE, TYPE III 4"	FOOT	453	453			
70400100	TEMPORARY CONCRETE BARRIER	FOOT	587.5	237.5	162.5	187.5	
70600250	IMPACT ATTENUATORS, TEMPORARY (NON- REDIRECTIVE), TEST LEVEL 3	EACH	2		1	1	
78200011	BARRIER WALL REFLECTORS, TYPE C	EACH	94	38	26	30	
X7010216	TRAFFIC CONTROL AND PROTECTION, (SPECIAL)	L SUM	1	0.33	0.33	0.34	
X7011015	TRAFFIC CONTROL AND PROTECTION (EXPRESSWAYS)	L SUM	1		0.5	0.5	
X7030005	TEMPORARY PAVEMENT MARKING REMOVAL	SO. FT.	151	151			
X7040125	PINNING TEMPORARY CONCRETE BARRIER	EACH	159	63	45	51	
Z0012754	STRUCTURAL REPAIR OF CONCRETE (DEPTH EQUAL TO OR LESS THAN 5 INCHES)	SO FT	974	513	225	236	
Z0012755	STRUCTURAL REPAIR OF CONCRETE (DEPTH GREATER THAN 5 INCHES)	SO FT	1179	526	348	305	
Z0030850	TEMPORARY INFORMATION SIGNING	SO FT	51.4	51.4			

SUMMARY OF QUANTITIES			URBAN TOTAL QUANTITIES 100% STATE	CONSTRUCTION TYPE CODE			
CODE NO	ITEM	UNIT		016-0108 LOC #1 0013	016-0545 LOC #2 0013	016-0943 LOC #3 0013	
Z0073200	TEMPORARY SHORING AND CRIBBING	EACH	58	17	27	14	
70600240	IMPACT ATTENUATORS, TEMPORARY (NON- REDIRECTIVE), TEST LEVEL 2	EACH	1	1			
Z0076604	TRAINEES - TRAINING GRADUATE PROGRAM	HOURS	500	500			

FILE NAME =	USER NAME = rthjp	DESIGNED -	REVISED -
pw:\planroom\dtd\illinois\gov\FWIDOT\Documents\DOT Offices\District\Projects\I-94 Bridge Repair\CADData\Design\DRAWNS\00.dgn		CHECKED -	REVISED -
		DATE -	REVISED -

**STATE OF ILLINOIS
DEPARTMENT OF TRANSPORTATION**

**I-94 AT IL 50, LAKE AVE, AND IL 58 (DEMPSTER AVE)
SUMMARY OF QUANTITIES**

SCALE: SHEET NO. 1 OF 1 SHEETS STA. TO STA.

F.A.I. RTÉ.	SECTION	COUNTY	TOTAL SHEETS	SHEET NO.
94	2020-259-BR	COOK	31	3
CONTRACT NO. 62N30				

0042
REV-SEP

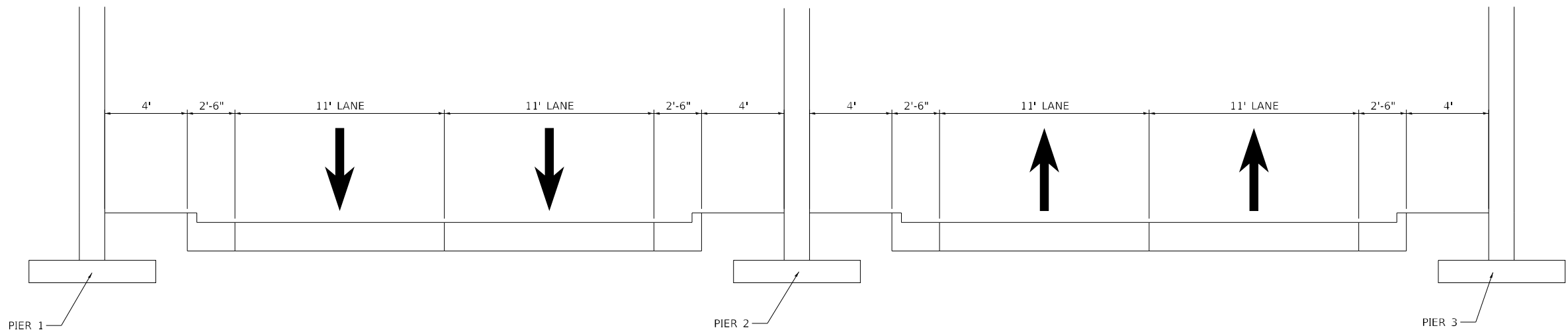

EXISTING TRAFFIC CONTROL SECTION

I-94 AT IL 50 (CICERO AVE.)
(LOOKING NORTH)

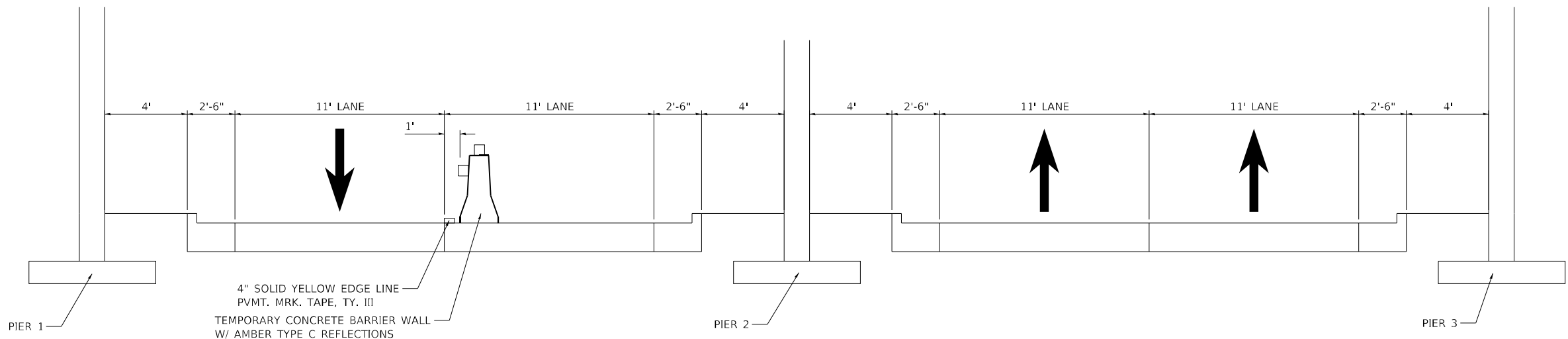

STAGED TRAFFIC CONTROL SECTION

I-94 AT IL 50 (CICERO AVE.)
(LOOKING NORTH)

MODEL: Default
FILE NAME: sht_ttypical.dgn
WORKSPACE: sht_ttypical.dgn

USER NAME = rothjp	DESIGNED -	REVISED -
	DRAWN -	REVISED -
PLOT SCALE = 100,0000' / in.	CHECKED -	REVISED -
PLOT DATE = 3/8/2021	DATE -	REVISED -

**STATE OF ILLINOIS
DEPARTMENT OF TRANSPORTATION**

**I-94 AT IL 50 (CICERO AVE.)
TRAFFIC CONTROL TYPICAL SECTIONS**

SCALE: SHEET 1 OF 3 SHEETS STA. TO STA.

F.A.I. RTE.	SECTION	COUNTY	TOTAL SHEETS	SHEET NO.
94	2020-259-BR	COOK	31	4
CONTRACT NO. 62N30				
ILLINOIS FED. AID PROJECT				

DETAIL A:

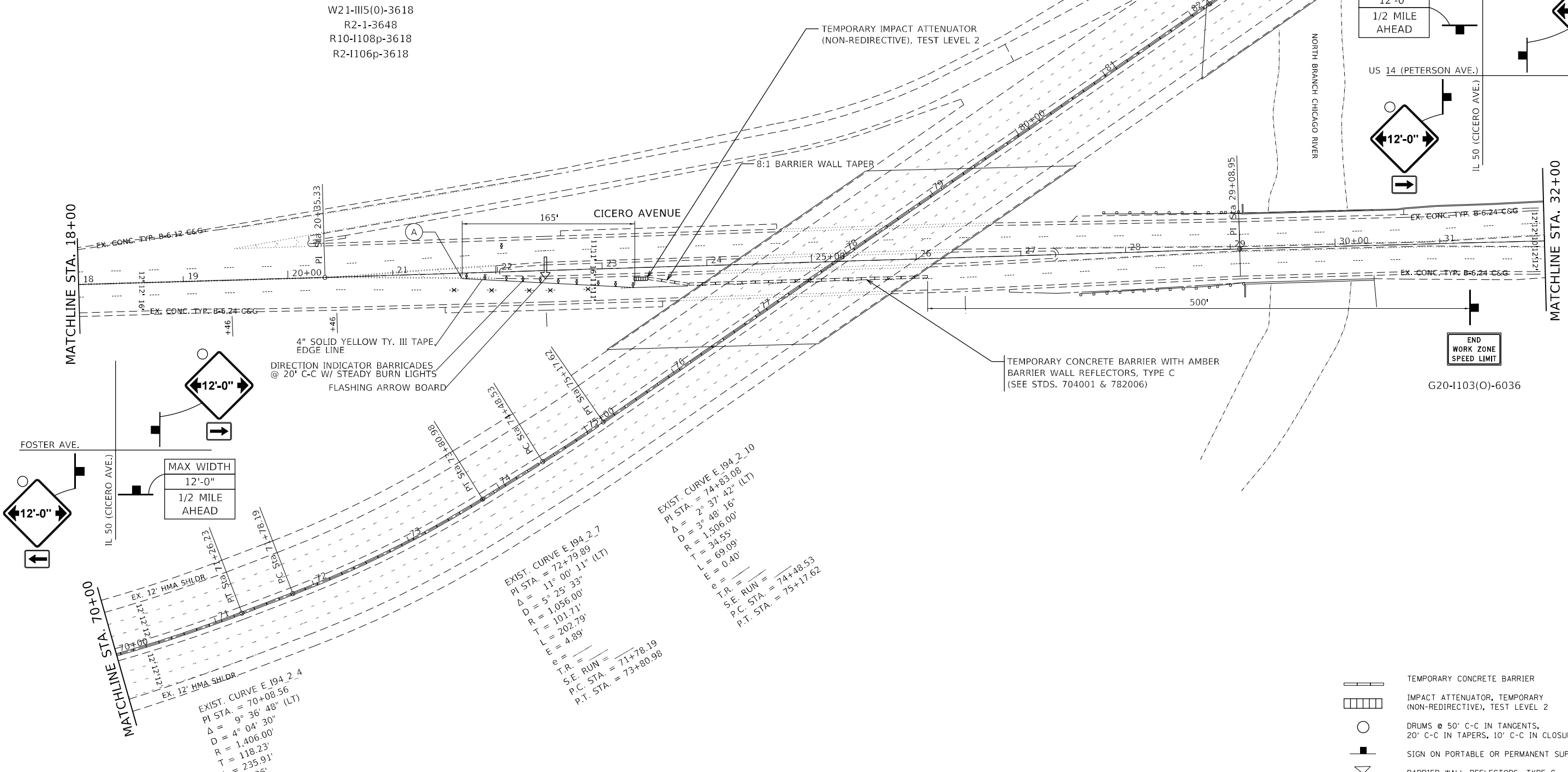
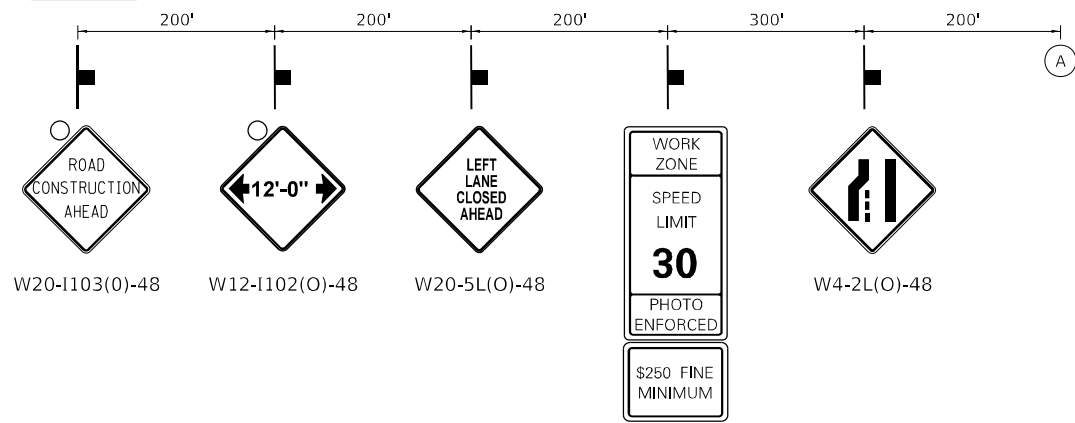

- TEMPORARY CONCRETE BARRIER
- IMPACT ATTENUATOR, TEMPORARY (NON-REDIRECTIVE), TEST LEVEL 2
- DRUMS @ 50' C-C IN TANGENTS, 20' C-C IN TAPERS, 10' C-C IN CLOSURES
- SIGN ON PORTABLE OR PERMANENT SUPPORT
- BARRIER WALL REFLECTORS, TYPE C

USER NAME = rothjp	DESIGNED -	REVISED -
PLOT SCALE = 100,0000' / in.	DRAWN -	REVISED -
PLOT DATE = 3/8/2021	CHECKED -	REVISED -
	DATE -	REVISED -

**STATE OF ILLINOIS
DEPARTMENT OF TRANSPORTATION**

**I-94 AT IL 50 (CICERO AVE.)
TRAFFIC CONTROL STAGING PLAN**

SCALE: 1"=50' SHEET OF SHEETS STA. 18+00 TO STA. 32+00

F.A.I. RTE.	SECTION	COUNTY	TOTAL SHEETS	SHEET NO.
94	2020-259-BR	COOK	31	5
			CONTRACT NO. 62N30	
ILLINOIS FED. AID PROJECT				

STATE OF ILLINOIS
DEPARTMENT OF TRANSPORTATION

DESIGN SPECIFICATIONS
2002 AASHTO

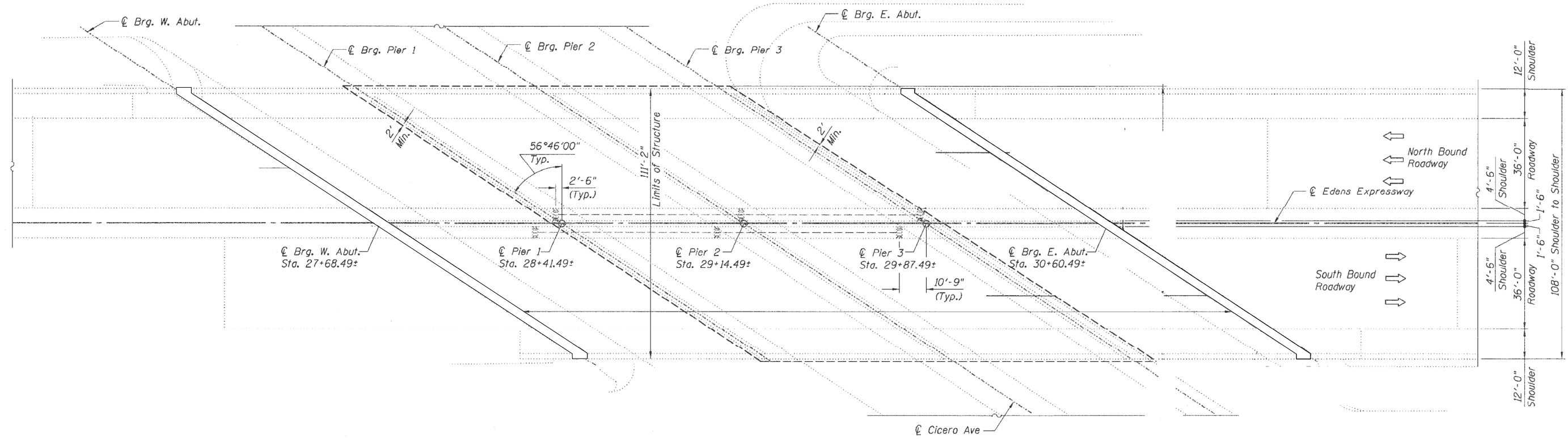

PLAN



Expires 11-30-2022
David Carl Puzey
03/11/2021

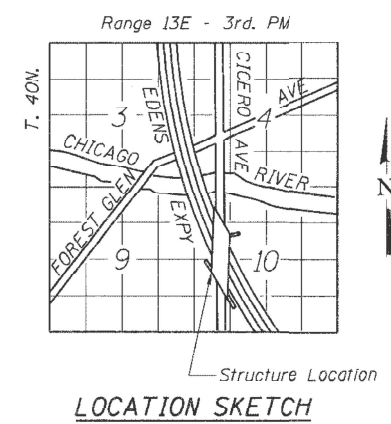

LOCATION SKETCH

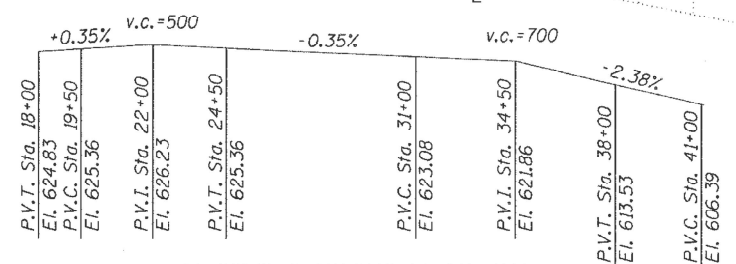

ELEVATION
(Looking East)

REACTION TABLE				
		CL E. & W. ABUTS.	CL PIER 1 CL PIER 3	CL PIER 2
R(DL)	K	30.8	88.7	69.6
R(LL)	K	40.4	52.1	50.8
R(IMP)	K	10.2	13.2	12.8
R(TOTAL)	K	81.4	154.0	133.2

TOTAL BILL OF MATERIAL (SN 016-0108)

ITEM	UNIT	QUANTITY
STRUCTURAL REPAIR OF CONCRETE LESS THAN OR EQUAL TO 5"	SQ. FT.	513
STRUCTURAL REPAIR OF CONCRETE GREATER THAN 5"	SQ. FT.	526
TEMPORARY SHORING AND CRIBBING	EACH	17

MODEL: Default
FILE NAME: C:\p1\work\p1\edens\repair.dgn

USER NAME = rothjp	DESIGNED -	REVISED -
PLOT SCALE = 100,0000' / in.	DRAWN -	REVISED -
PLOT DATE = 3/2/2021	CHECKED -	REVISED -
	DATE -	REVISED -

STATE OF ILLINOIS
DEPARTMENT OF TRANSPORTATION

SN 016-0108: I-94 OVER IL 50
SUBSTRUCTURE REPAIR PLANS

SCALE: SHEET 1 OF 5 SHEETS STA. TO STA.

F.A.I. RTE.	SECTION	COUNTY	TOTAL SHEETS	SHEET NO.
94	2020-259-BR	COOK	31	6
CONTRACT NO. 62N30				
ILLINOIS FED. AID PROJECT				

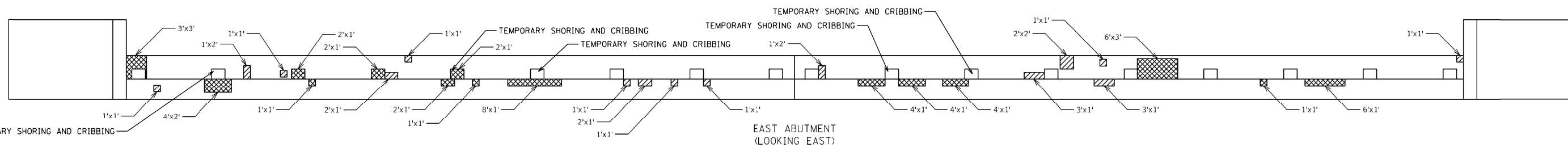
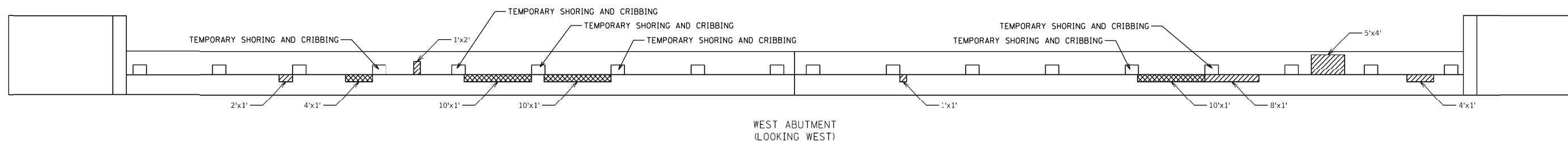

BILL OF MATERIAL

- STRUCTURAL REPAIR OF CONCRETE DEPTH LESS THAN OR EQUAL TO 5"
- STRUCTURAL REPAIR OF CONCRETE DEPTH GREATER THAN 5"

ITEM	UNIT	QUANTITY
STRUCTURAL REPAIR OF CONCRETE LESS THAN OR EQUAL TO 5"	SQ. FT.	67
STRUCTURAL REPAIR OF CONCRETE GREATER THAN 5"	SQ. FT.	106
TEMPORARY SHORING AND CRIBBING	EACH	11

MODEL: Default
 FILE NAME: \\pwwdot\documents\DOT_Offices\District_1\Projects\I-94_Edends_Repairs\CADD\Design\016-0108-0108-0108-0108.dwg

USER NAME = rothp	DESIGNED -	REVISED -
PLOT SCALE = 100,0000 ' / in.	DRAWN -	REVISED -
PLOT DATE = 2/5/2021	CHECKED -	REVISED -
	DATE -	REVISED -

**STATE OF ILLINOIS
 DEPARTMENT OF TRANSPORTATION**

**SN 016-0108: I-94 OVER IL 50
 SUBSTRUCTURE REPAIR PLANS**

SCALE: SHEET 2 OF 5 SHEETS STA. TO STA.

F.A.I. RTE. 94	SECTION 2020-259-BR	COUNTY COOK	TOTAL SHEETS 31	SHEET NO. 7
CONTRACT NO. 62N30				
ILLINOIS FED. AID PROJECT				

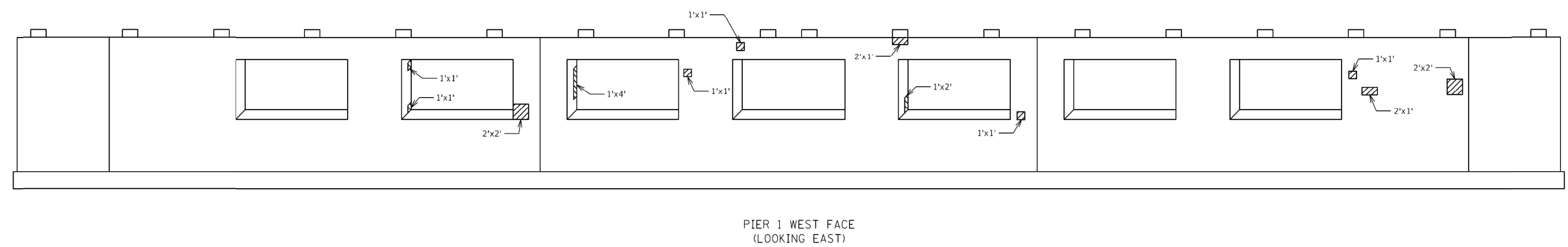
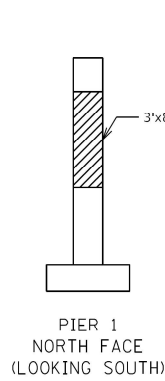
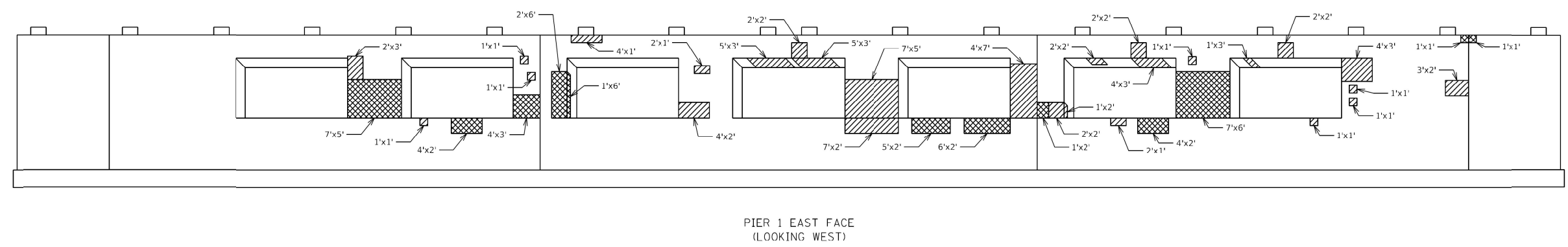
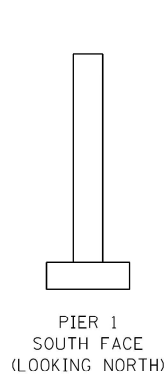

- STRUCTURAL REPAIR OF CONCRETE DEPTH LESS THAN OR EQUAL TO 5"
- STRUCTURAL REPAIR OF CONCRETE DEPTH GREATER THAN 5"

BILL OF MATERIAL

ITEM	UNIT	QUANTITY
STRUCTURAL REPAIR OF CONCRETE LESS THAN OR EQUAL TO 5"	SQ. FT.	235
STRUCTURAL REPAIR OF CONCRETE GREATER THAN 5"	SQ. FT.	149

NOTE:
 ALL REQUIRED SHORING TO BE PLACED ON WEST SIDE
 OF PIER NO MATTER THE SIDE OF WHERE TEMPORARY
 SHORING IS NEEDED.

MODEL: Default
 FILE NAME: p:\work\62n30\62n30.dwg
 PROJECT: I-94 Edens Over IL 50
 DATE: 2/5/2021

USER NAME = rothp	DESIGNED -	REVISED -
PLOT SCALE = 100,0000 ' / in.	DRAWN -	REVISED -
PLOT DATE = 2/5/2021	CHECKED -	REVISED -
	DATE -	REVISED -

**STATE OF ILLINOIS
 DEPARTMENT OF TRANSPORTATION**

**SN 016-0108: I-94 OVER IL 50
 SUBSTRUCTURE REPAIR PLANS**

SCALE: SHEET 3 OF 5 SHEETS STA. TO STA.

F.A.I. RTE.	SECTION	COUNTY	TOTAL SHEETS	SHEET NO.
94	2020-259-BR	COOK	31	8
ILLINOIS FED. AID PROJECT			CONTRACT NO. 62N30	

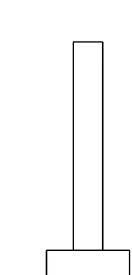

PIER 2
 SOUTH FACE
 (LOOKING NORTH)

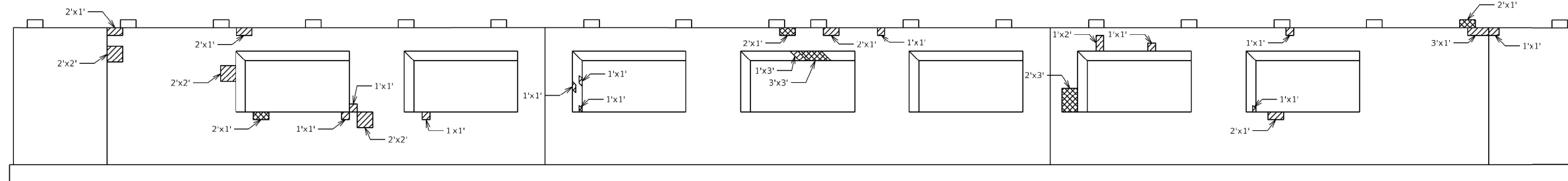

PIER 2 EAST FACE
 (LOOKING WEST)

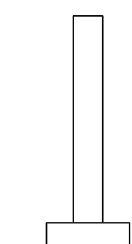

PIER 2
 NORTH FACE
 (LOOKING SOUTH)

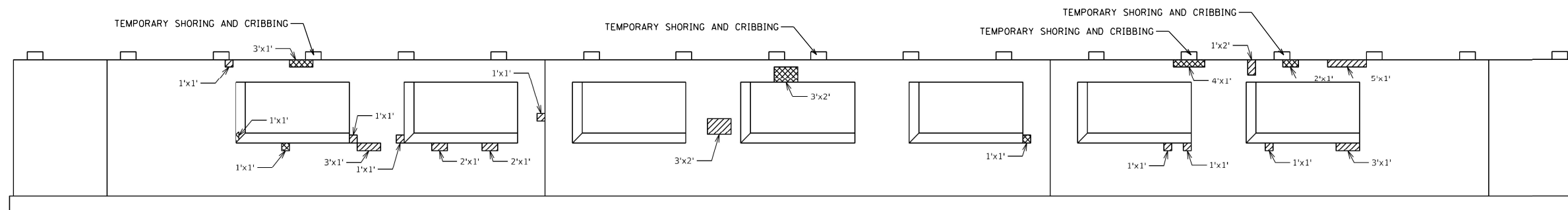

PIER 2 WEST FACE
 (LOOKING EAST)

- STRUCTURAL REPAIR OF CONCRETE DEPTH LESS THAN OR EQUAL TO 5"
- STRUCTURAL REPAIR OF CONCRETE DEPTH GREATER THAN 5"

BILL OF MATERIAL

ITEM	UNIT	QUANTITY
STRUCTURAL REPAIR OF CONCRETE LESS THAN OR EQUAL TO 5"	SQ. FT.	69
STRUCTURAL REPAIR OF CONCRETE GREATER THAN 5"	SQ. FT.	39
TEMPORARY SHORING AND CRIBBING	EACH	4

NOTE:
 ALL REQUIRED SHORING TO BE PLACED ON WEST SIDE
 OF PIER NO MATTER THE SIDE OF WHERE TEMPORARY
 SHORING IS NEEDED.

MODEL: Default
 FILE NAME: p:\pub\amr\sn016-0108\I-94 Edens Over IL 50\DOT Documents\DOT Office\Drawings\1\Project\104 Bridge Repair\CADD\Drawings\1\104-xx-xx-xx\3.dwg

USER NAME = rothjp	DESIGNED -	REVISED -
PLOT SCALE = 100,0000' / in.	DRAWN -	REVISED -
PLOT DATE = 2/5/2021	CHECKED -	REVISED -
	DATE -	REVISED -

**STATE OF ILLINOIS
 DEPARTMENT OF TRANSPORTATION**

**SN 016-0108: I-94 OVER IL 50
 SUBSTRUCTURE REPAIR PLANS**

SCALE: SHEET 4 OF 5 SHEETS STA. TO STA.

F.A.I. RTE.	SECTION	COUNTY	TOTAL SHEETS	SHEET NO.
94	2020-259-BR	COOK	31	9
ILLINOIS FED. AID PROJECT			CONTRACT NO. 62N30	

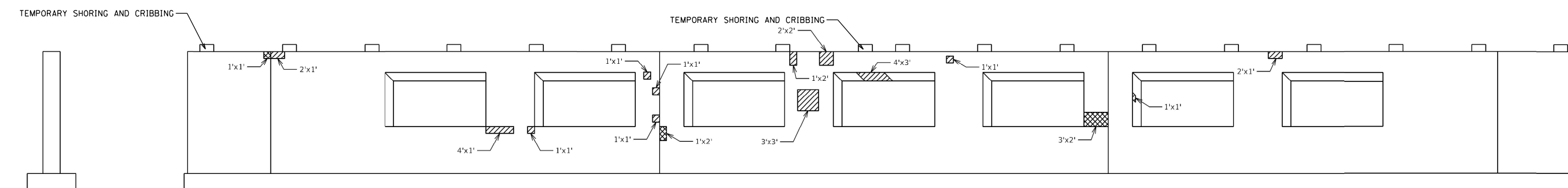

PIER 3
 SOUTH FACE
 (LOOKING NORTH)

PIER 3 EAST FACE
 (LOOKING WEST)

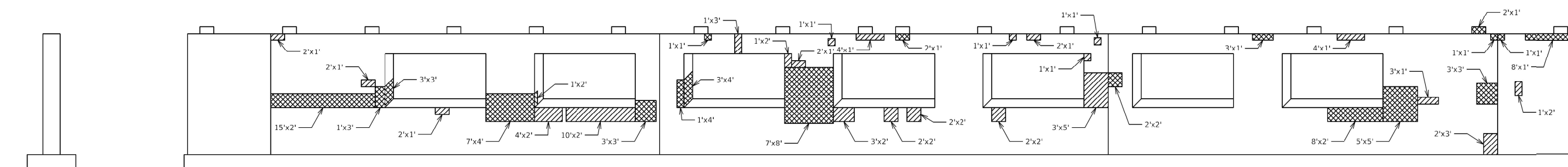

PIER 3
 NORTH FACE
 (LOOKING SOUTH)

PIER 3 WEST FACE
 (LOOKING EAST)

- STRUCTURAL REPAIR OF CONCRETE DEPTH LESS THAN OR EQUAL TO 5"
- STRUCTURAL REPAIR OF CONCRETE DEPTH GREATER THAN 5"

BILL OF MATERIAL

ITEM	UNIT	QUANTITY
STRUCTURAL REPAIR OF CONCRETE LESS THAN OR EQUAL TO 5"	SQ. FT.	142
STRUCTURAL REPAIR OF CONCRETE GREATER THAN 5"	SQ. FT.	232
TEMPORARY SHORING AND CRIBBING	EACH	2

NOTE:
 ALL REQUIRED SHORING TO BE PLACED ON EAST SIDE
 OF PIER NO MATTER THE SIDE OF WHERE TEMPORARY
 SHORING IS NEEDED.

MODEL: Default
 FILE NAME: p:\data\mroom.dwg
 PROJECT: I-94 Edens Over IL 50
 SHEET: 4 OF 4
 DATE: 2/5/2021
 USER: rothjp

USER NAME = rothjp	DESIGNED -	REVISED -
PLOT SCALE = 100,0000' / in.	DRAWN -	REVISED -
PLOT DATE = 2/5/2021	CHECKED -	REVISED -
	DATE -	REVISED -

**STATE OF ILLINOIS
 DEPARTMENT OF TRANSPORTATION**

**SN 016-0108: I-94 OVER IL 50
 SUBSTRUCTURE REPAIR PLANS**

SCALE: SHEET 5 OF 5 SHEETS STA. TO STA.

F.A.I. RTE.	SECTION	COUNTY	TOTAL SHEETS	SHEET NO.
94	2020-259-BR	COOK	31	10
CONTRACT NO. 62N30				
ILLINOIS FED. AID PROJECT				

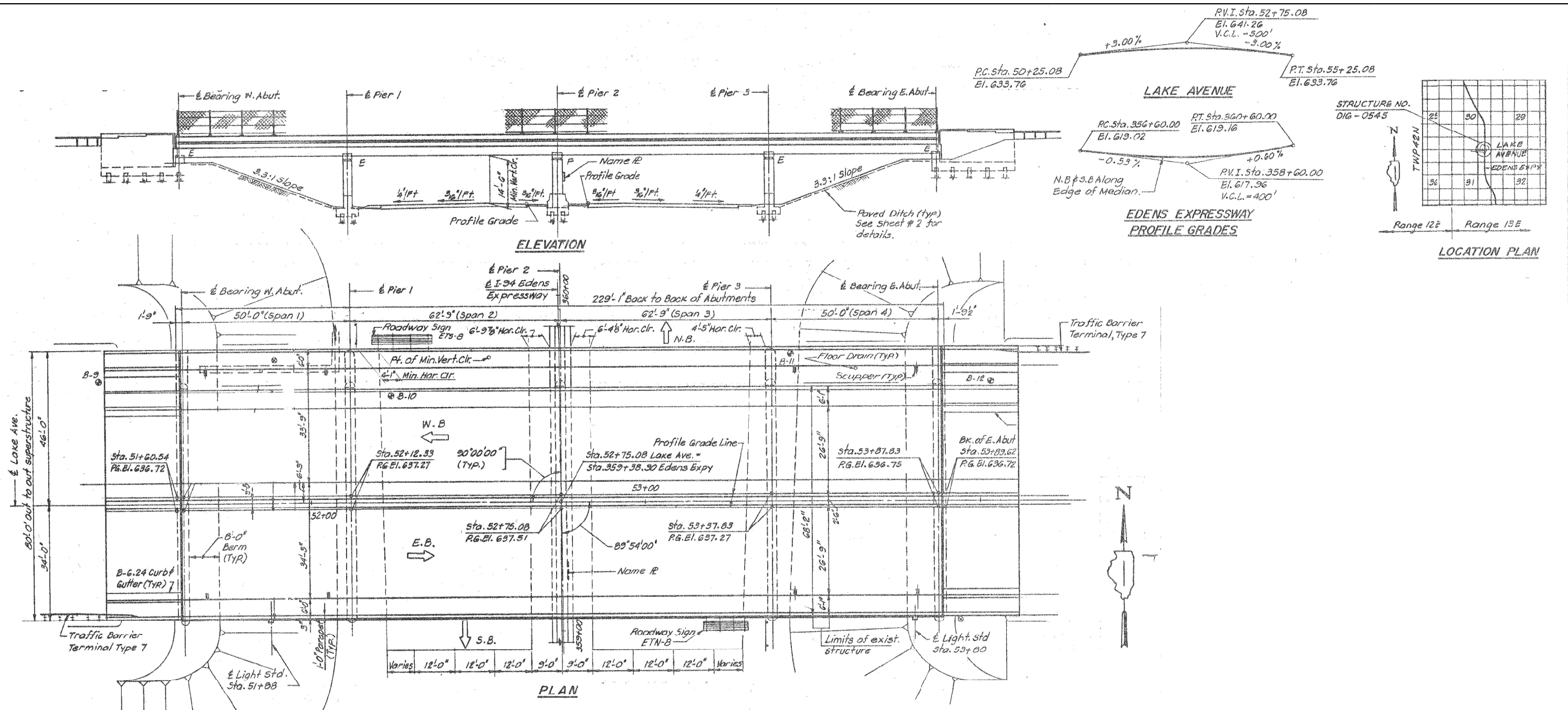

REACTION TABLE				
	CL E. & W. ABUTS.	CL PIER 1	CL PIER 3	CL PIER 2
R(DL)	K	17.0	59.4	59.2
R(LL)	K	32.9	42.0	43.2
R(IMP)	K	9.3	11.6	11.5
R(TOTAL)	K	59.2	113.0	113.9



Expires 11-30-2022
David Carl Puzey
 03/11/2021

TOTAL BILL OF MATERIAL (SN 016-0545)

ITEM	UNIT	QUANTITY
STRUCTURAL REPAIR OF CONCRETE LESS THAN OR EQUAL TO 5"	SQ. FT.	225
STRUCTURAL REPAIR OF CONCRETE GREATER THAN 5"	SQ. FT.	348
TEMPORARY SHORING AND CRIBBING	EACH	27

MODEL: Default FILE NAME: C:\pwworking\dstc\proj\00719099\016xxxx-crepair.dgn	USER NAME = rothjp	DESIGNED -	REVISED -	STATE OF ILLINOIS DEPARTMENT OF TRANSPORTATION	SN 016-0545: LAKE AVE OVER I-94 SUBSTRUCTURE REPAIRS PLANS	F.A.I. RTE.	SECTION	COUNTY	TOTAL SHEETS	SHEET NO.
PLOT SCALE = 100,0000' / in.	CHECKED -	REVISED -	94			2020-259-BR	COOK	31	13	
PLOT DATE = 3/2/2021	DATE -	REVISED -	CONTRACT NO. 62N30							
			ILLINOIS FED. AID PROJECT							

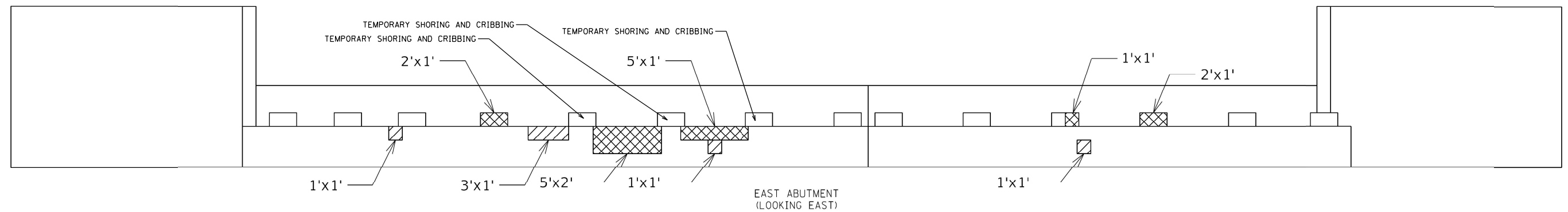
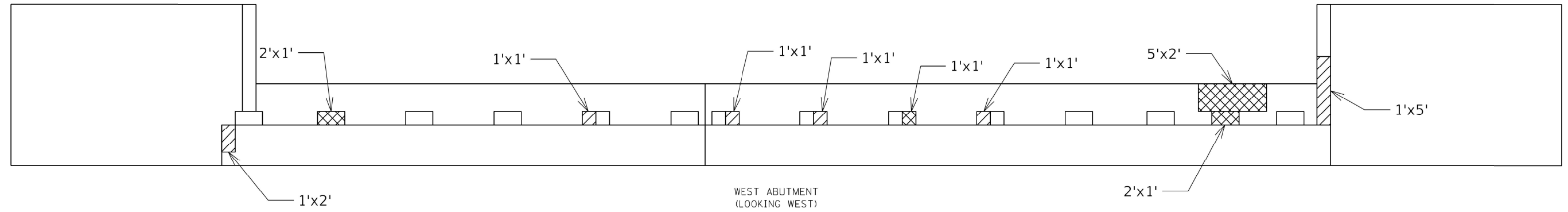

BILL OF MATERIAL

- STRUCTURAL REPAIR OF CONCRETE DEPTH LESS THAN OR EQUAL TO 5"
- STRUCTURAL REPAIR OF CONCRETE DEPTH GREATER THAN 5"

ITEM	UNIT	QUANTITY
STRUCTURAL REPAIR OF CONCRETE LESS THAN OR EQUAL TO 5"	SQ. FT.	34
STRUCTURAL REPAIR OF CONCRETE GREATER THAN 5"	SQ. FT.	35
TEMPORARY SHORING AND CRIBBING	EACH	3

MODEL: Default
 FILE NAME: p:\pub\amr\sn016-0545\p\DOT\Documents\DOT_Offices\District 1\Projects\104_Bridge_Repair\CADD\Drawings\104-xxxx-xxxx-01.dwg

USER NAME = rothjp	DESIGNED -	REVISED -
	DRAWN -	REVISED -
PLOT SCALE = 100,0000 ' / in.	CHECKED -	REVISED -
PLOT DATE = 2/5/2021	DATE -	REVISED -

**STATE OF ILLINOIS
DEPARTMENT OF TRANSPORTATION**

**SN 016-0545: LAKE AVE OVER I-94
SUBSTRUCTURE REPAIRS PLANS**

SCALE: SHEET 2 OF 5 SHEETS STA. TO STA.

F.A.I. RTE.	SECTION	COUNTY	TOTAL SHEETS	SHEET NO.
94	2020-259-BR	COOK	31	14
			CONTRACT NO. 62N30	
ILLINOIS FED. AID PROJECT				

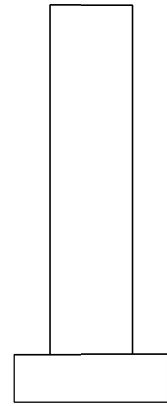

PIER 1 SOUTH FACE (LOOKING NORTH)

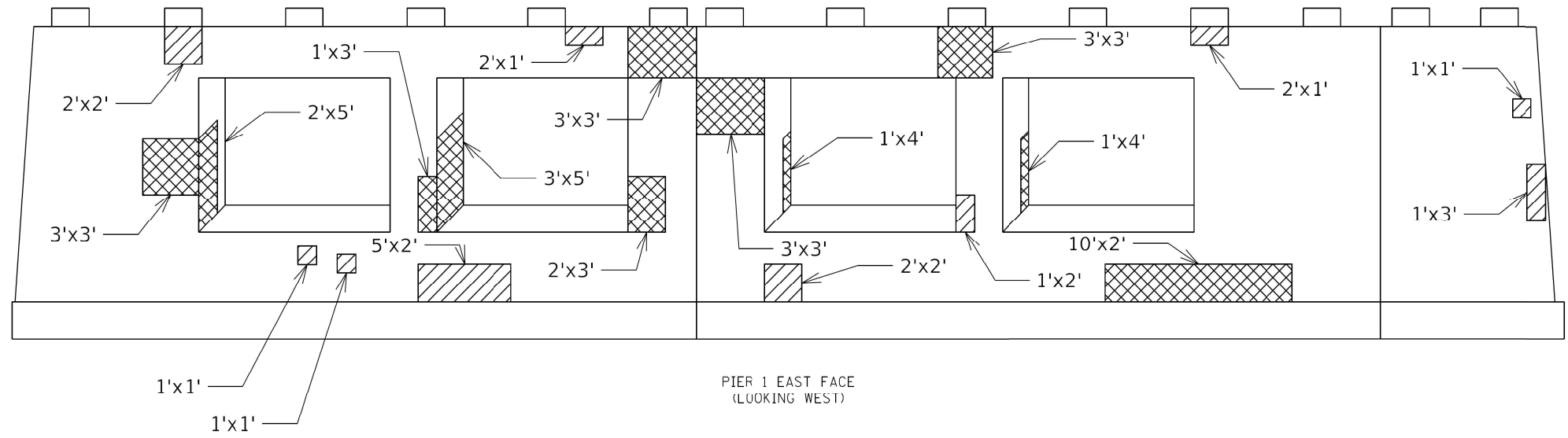

PIER 1 EAST FACE (LOOKING WEST)

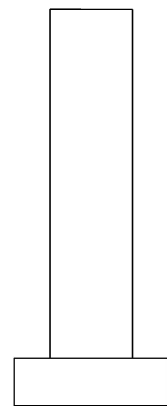

PIER 1 NORTH FACE (LOOKING SOUTH)

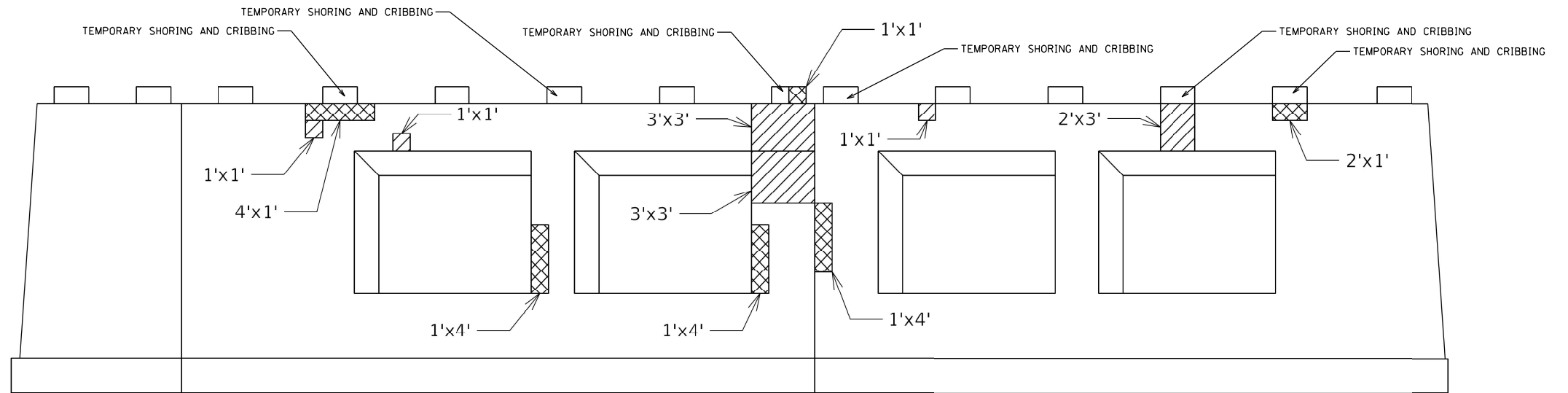

PIER 1 WEST FACE (LOOKING EAST)

- STRUCTURAL REPAIR OF CONCRETE DEPTH LESS THAN OR EQUAL TO 5"
- STRUCTURAL REPAIR OF CONCRETE DEPTH GREATER THAN 5"

BILL OF MATERIAL

ITEM	UNIT	QUANTITY
STRUCTURAL REPAIR OF CONCRETE LESS THAN OR EQUAL TO 5"	SQ. FT.	57
STRUCTURAL REPAIR OF CONCRETE GREATER THAN 5"	SQ. FT.	117
TEMPORARY SHORING AND CRIBBING	EACH	6

NOTE:
ALL REQUIRED SHORING TO BE PLACED ON WEST SIDE OF PIER NO MATTER THE SIDE OF WHERE TEMPORARY SHORING IS NEEDED.

MODEL: Default
FILE NAME: p:\pub\amromm.dwt\illinois\dot\pwwdot\Documents\DOT_Offices\District_1\Projects\I-94 Bridge_Repairs\CADD\Bids\Design\11222222-2021\I-94

USER NAME = rothjp	DESIGNED -	REVISED -
PLOT SCALE = 100,0000' / in.	DRAWN -	REVISED -
PLOT DATE = 2/5/2021	CHECKED -	REVISED -
	DATE -	REVISED -

**STATE OF ILLINOIS
DEPARTMENT OF TRANSPORTATION**

**SN 016-0545: LAKE AVE OVER I-94
SUBSTRUCTURE REPAIRS PLANS**

SCALE: SHEET 3 OF 5 SHEETS STA. TO STA.

F.A.I. RTE.	SECTION	COUNTY	TOTAL SHEETS	SHEET NO.
94	2020-259-BR	COOK	31	15
CONTRACT NO. 62N30			ILLINOIS FED. AID PROJECT	

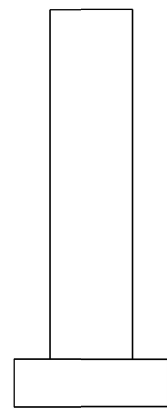

PIER 2
SOUTH FACE
(LOOKING NORTH)

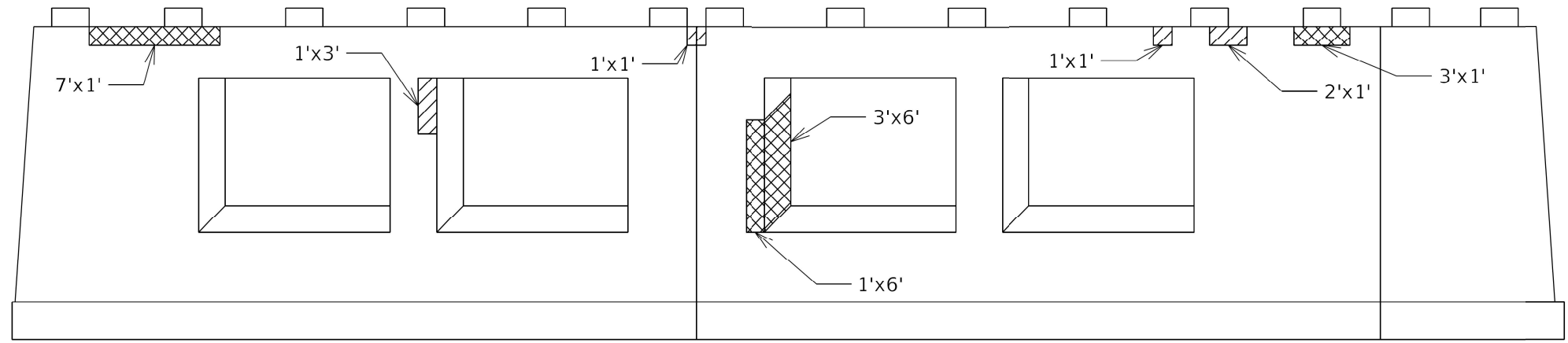

PIER 2 EAST FACE
(LOOKING WEST)

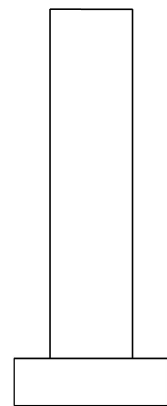

PIER 2
NORTH FACE
(LOOKING SOUTH)

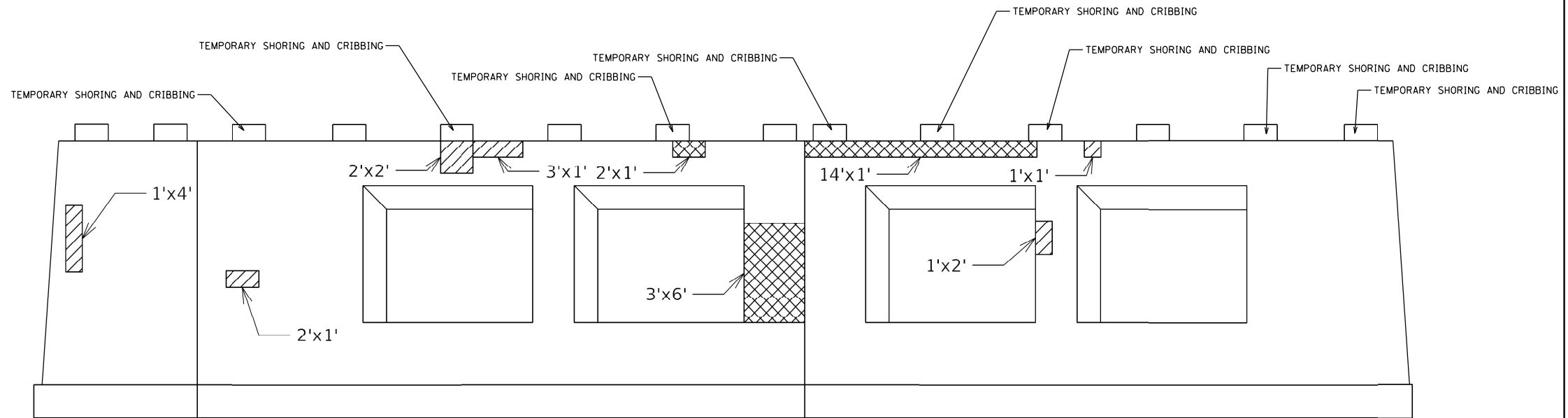

PIER 2 WEST FACE
(LOOKING EAST)

BILL OF MATERIAL

- STRUCTURAL REPAIR OF CONCRETE DEPTH LESS THAN OR EQUAL TO 5"
- STRUCTURAL REPAIR OF CONCRETE DEPTH GREATER THAN 5"

ITEM	UNIT	QUANTITY
STRUCTURAL REPAIR OF CONCRETE LESS THAN OR EQUAL TO 5"	SQ. FT.	23
STRUCTURAL REPAIR OF CONCRETE GREATER THAN 5"	SQ. FT.	68
TEMPORARY SHORING AND CRIBBING	EACH	8

NOTE:
ALL REQUIRED SHORING TO BE PLACED ON WEST SIDE
OF PIER NO MATTER THE SIDE OF WHERE TEMPORARY
SHORING IS NEEDED.

MODEL: Default
FILE NAME: p:\pub\amr\sn016-0545\p\DOT\Documents\DOT_Offices\Drawings\1\Project\104_Bridge_Repair\CADD\Drawings\104-xxxx-xxxx\3\3.dgn

USER NAME = rothp	DESIGNED -	REVISED -
PLOT SCALE = 100,0000' / in.	DRAWN -	REVISED -
PLOT DATE = 2/5/2021	CHECKED -	REVISED -
	DATE -	REVISED -

**STATE OF ILLINOIS
DEPARTMENT OF TRANSPORTATION**

**SN 016-0545: LAKE AVE OVER I-94
SUBSTRUCTURE REPAIRS PLANS**

SCALE: SHEET 4 OF 5 SHEETS STA. TO STA.

F.A.I. RTE.	SECTION	COUNTY	TOTAL SHEETS	SHEET NO.
94	2020-259-BR	COOK	31	16
CONTRACT NO. 62N30				
ILLINOIS FED. AID PROJECT				

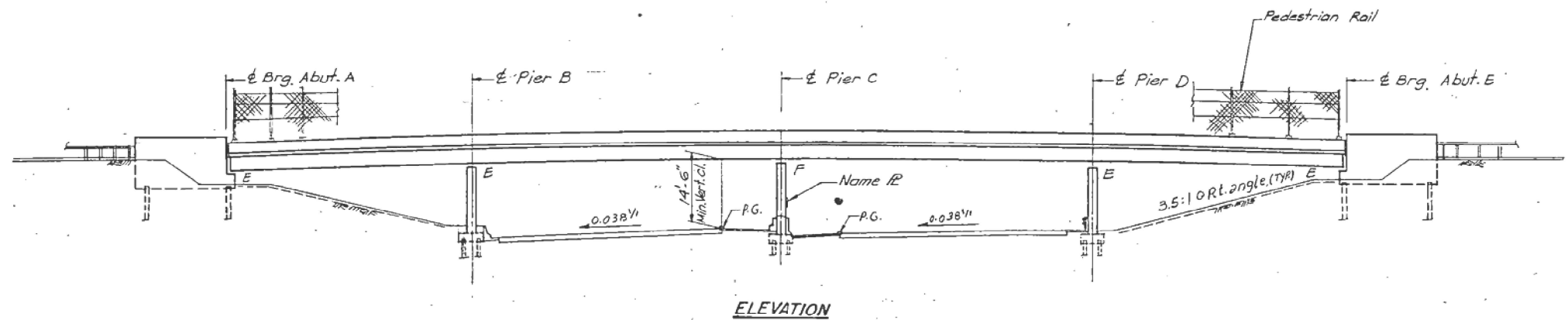

ELEVATION

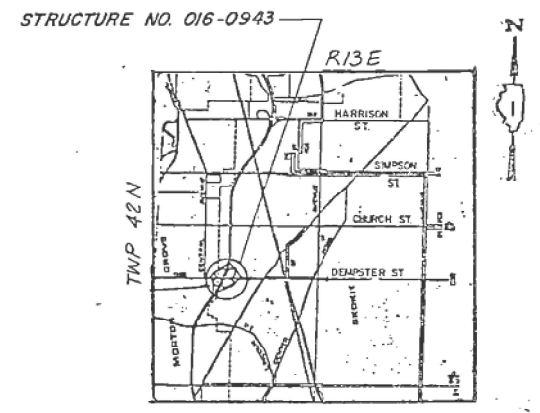

LOCATION PLAN

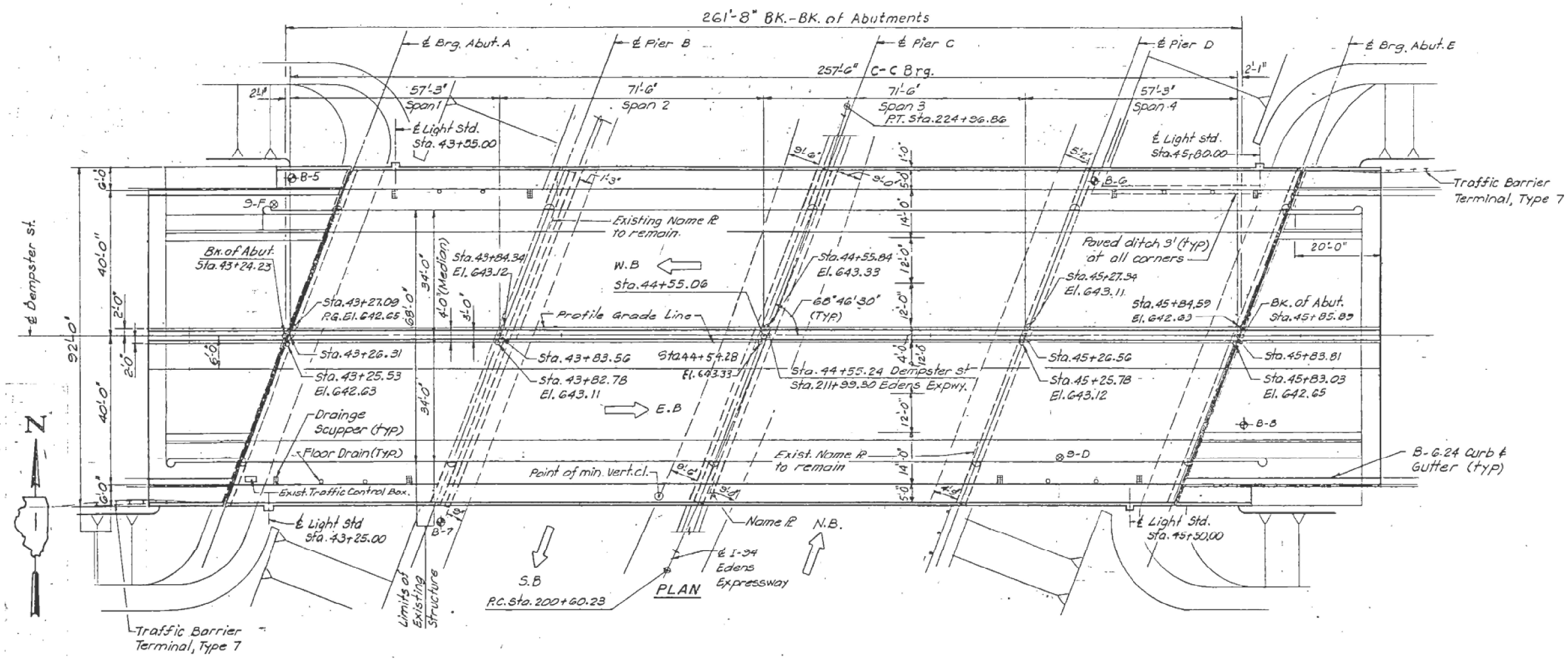

PLAN



Expires 11-30-2022

03/11/2021

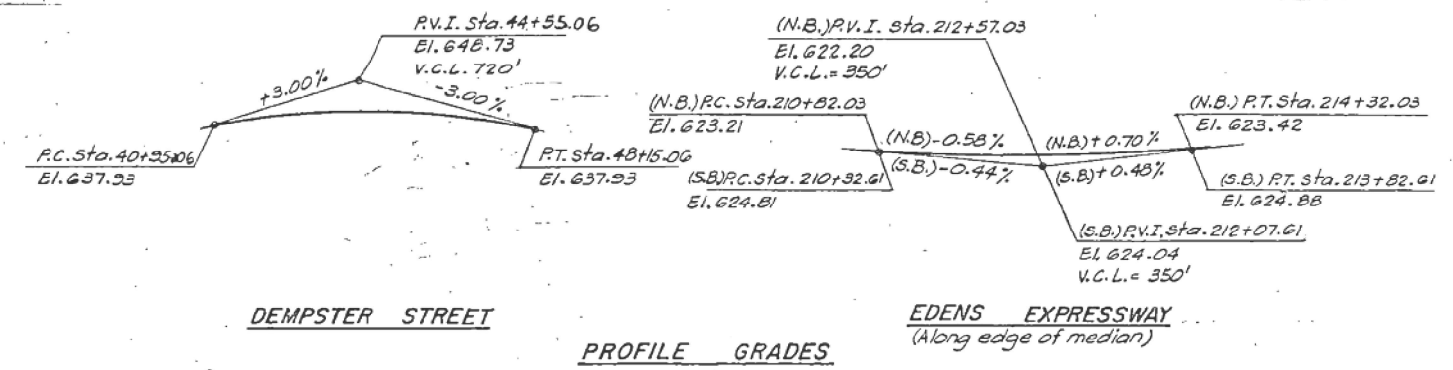

DEMPSTER STREET

PROFILE GRADES

EDENS EXPRESSWAY

(Along edge of median)

TOTAL BILL OF MATERIAL (SN 016-0943)

ITEM	UNIT	QUANTITY
STRUCTURAL REPAIR OF CONCRETE LESS THAN OR EQUAL TO 5"	SQ. FT.	236
STRUCTURAL REPAIR OF CONCRETE GREATER THAN 5"	SQ. FT.	305
TEMPORARY SHORING AND CRIBBING	EACH	14

REACTION TABLE				
		CL E. & W. ABUTS.	CL PIER 1 CL PIER 3	CL PIER 2
R(DL)	K	22.0	75.0	74.0
R(LL)	K	34.0	46.0	47.0
R(IMP)	K	9.0	12.0	12.0
R(TOTAL)	K	65.0	133.0	133.0

USER NAME = rothjp	DESIGNED -	REVISED -
	DRAWN -	REVISED -
PLOT SCALE = 100,000' / in.	CHECKED -	REVISED -
PLOT DATE = 3/2/2021	DATE -	REVISED -

STATE OF ILLINOIS
DEPARTMENT OF TRANSPORTATION

SN 016-0943: DEMPSTER AVE (IL 58) OVER I-94
SUBSTRUCTURE REPAIR PLANS

SCALE: SHEET 1 OF 5 SHEETS STA. TO STA.

F.A.I. RTE.	SECTION	COUNTY	TOTAL SHEETS	SHEET NO.
94	2020-259-BR	COOK	31	20
			CONTRACT NO. 62N30	
ILLINOIS FED. AID PROJECT				

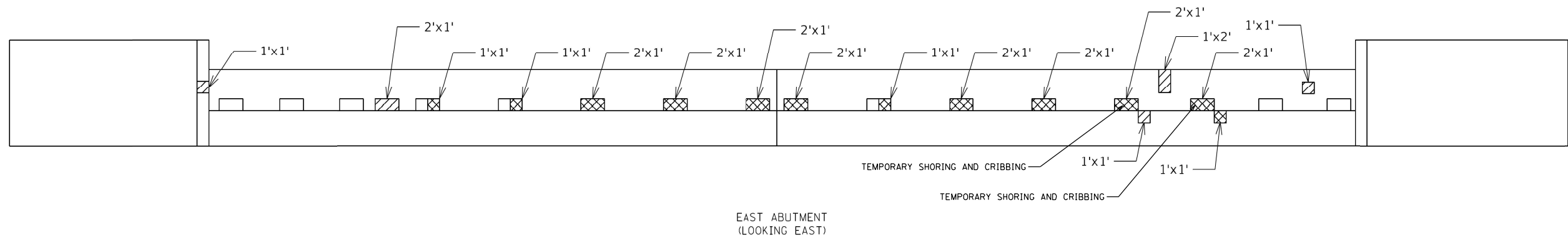
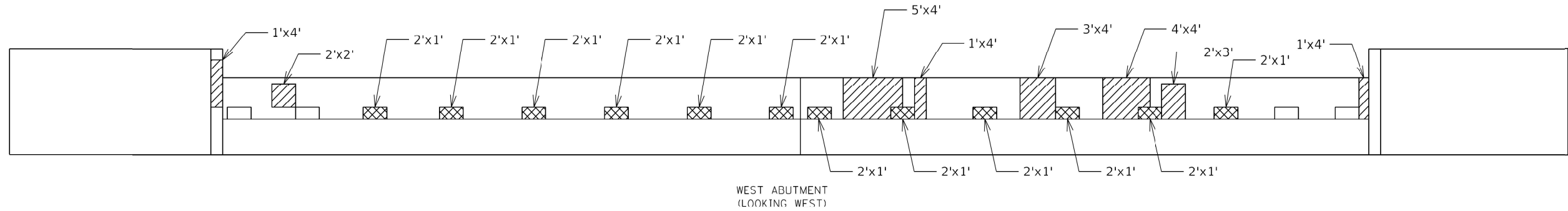

- STRUCTURAL REPAIR OF CONCRETE DEPTH LESS THAN OR EQUAL TO 5"
- STRUCTURAL REPAIR OF CONCRETE DEPTH GREATER THAN 5"

BILL OF MATERIAL

ITEM	UNIT	QUANTITY
STRUCTURAL REPAIR OF CONCRETE LESS THAN OR EQUAL TO 5"	SQ. FT.	79
STRUCTURAL REPAIR OF CONCRETE GREATER THAN 5"	SQ. FT.	44
TEMPORARY SHORING AND CRIBBING	EACH	2

MODEL: Default
 FILE NAME: p:\pub\amrom.dwg
 PLOT DATE: 2/5/2021
 PLOT SCALE: = 100,0000 ' / in.
 USER NAME = rothp
 DESIGNED -
 DRAWN -
 CHECKED -
 DATE -
 REVISED -
 REVISED -
 REVISED -
 REVISED -

**STATE OF ILLINOIS
 DEPARTMENT OF TRANSPORTATION**

**SN 016-0943: DEMPSTER AVE (IL 58) OVER I-94
 SUBSTRUCTURE REPAIR PLANS**

SCALE: SHEET 2 OF 5 SHEETS STA. TO STA.

F.A.I. RTE.	SECTION	COUNTY	TOTAL SHEETS	SHEET NO.
94	2020-259-BR	COOK	31	21
ILLINOIS FED. AID PROJECT			CONTRACT NO. 62N30	

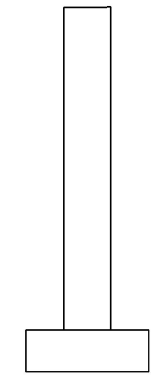

PIER 2
 SOUTH FACE
 (LOOKING NORTH)

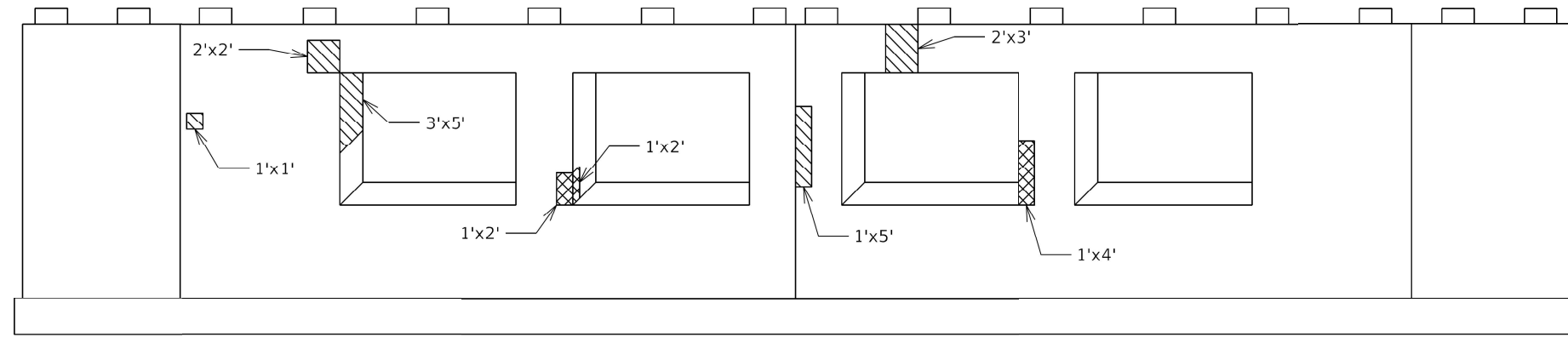

PIER 2 EAST FACE
 (LOOKING WEST)

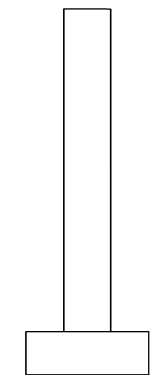

PIER 2
 NORTH FACE
 (LOOKING SOUTH)

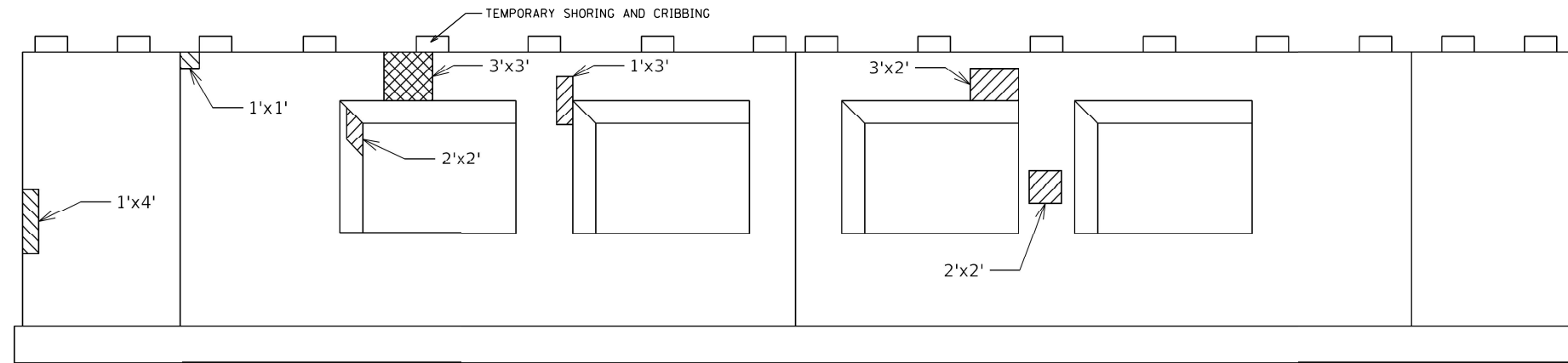

PIER 2 WEST FACE
 (LOOKING EAST)

- STRUCTURAL REPAIR OF CONCRETE DEPTH LESS THAN OR EQUAL TO 5"
- STRUCTURAL REPAIR OF CONCRETE DEPTH GREATER THAN 5"

BILL OF MATERIAL

ITEM	UNIT	QUANTITY
STRUCTURAL REPAIR OF CONCRETE LESS THAN OR EQUAL TO 5"	SQ. FT.	53
STRUCTURAL REPAIR OF CONCRETE GREATER THAN 5"	SQ. FT.	17
TEMPORARY SHORING AND CRIBBING	EACH	1

NOTE:
 ALL REQUIRED SHORING TO BE PLACED ON WEST SIDE
 OF PIER NO MATTER THE SIDE OF WHERE TEMPORARY
 SHORING IS NEEDED.

MODEL: Default
 FILE NAME: p:\pub\amr\room.dwg
 I:\projects\104 Bridge Repair\CADD\Design\104xxxx-rc\sub1r.dwg

USER NAME = rothp	DESIGNED -	REVISED -
PLOT SCALE = 100,0000' / in.	DRAWN -	REVISED -
PLOT DATE = 2/5/2021	CHECKED -	REVISED -
	DATE -	REVISED -

**STATE OF ILLINOIS
 DEPARTMENT OF TRANSPORTATION**

**SN 016-0943: DEMPSTER AVE (IL 58) OVER I-94
 SUBSTRUCTURE REPAIR PLANS**

SCALE: SHEET 4 OF 5 SHEETS STA. TO STA.

F.A.I. RTE.	SECTION	COUNTY	TOTAL SHEETS	SHEET NO.
94	2020-259-BR	COOK	31	23
			CONTRACT NO. 62N30	
		ILLINOIS FED. AID PROJECT		

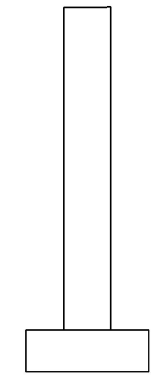

PIER 3
 SOUTH FACE
 (LOOKING NORTH)

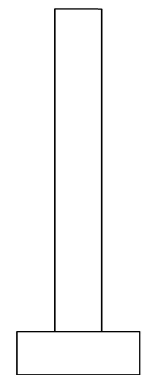

PIER 3
 NORTH FACE
 (LOOKING SOUTH)

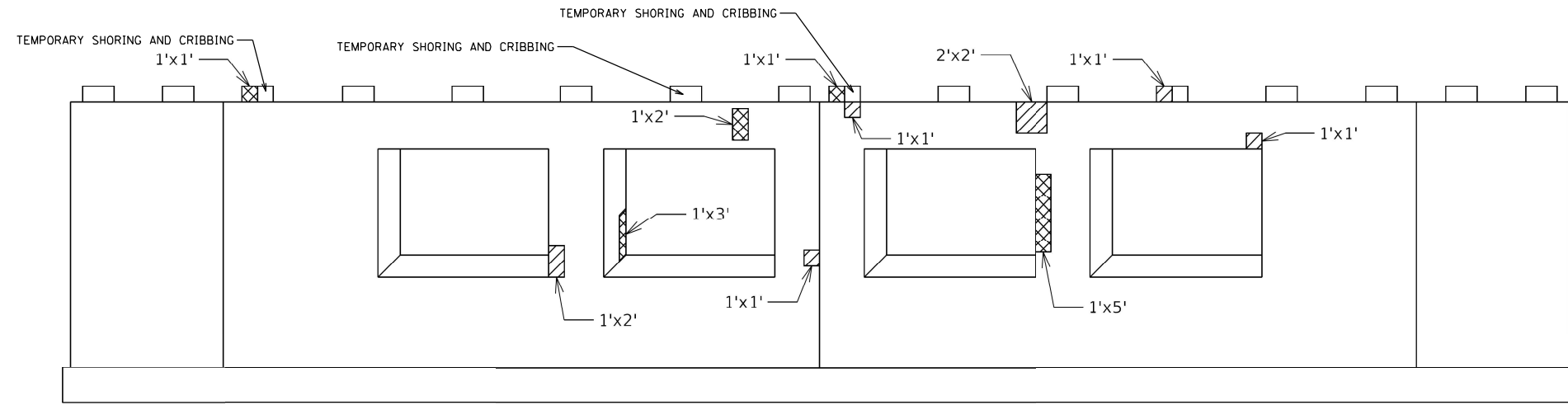

PIER 3 EAST FACE
 (LOOKING WEST)

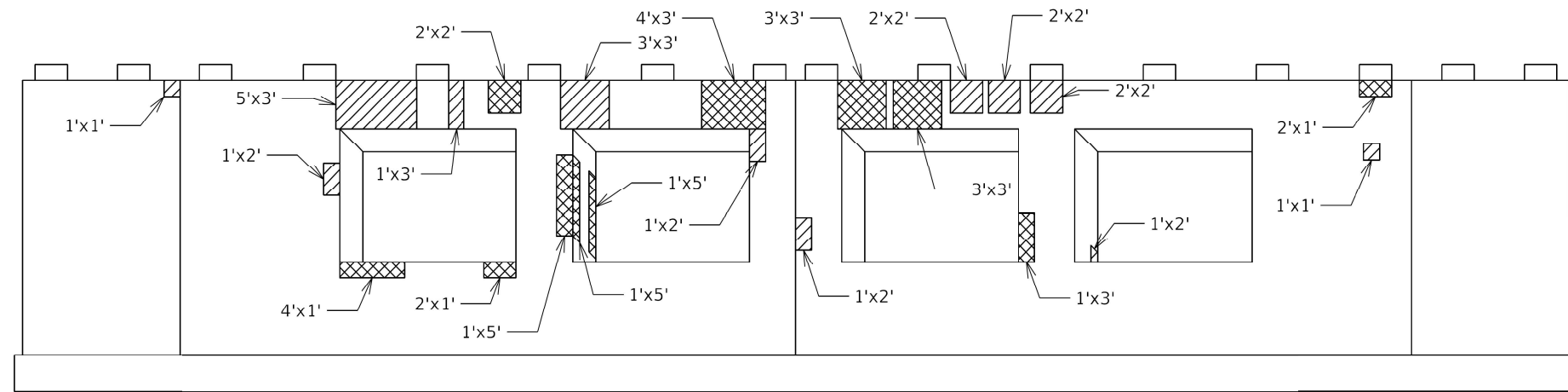

PIER 3 WEST FACE
 (LOOKING EAST)

- STRUCTURAL REPAIR OF CONCRETE DEPTH LESS THAN OR EQUAL TO 5"
- STRUCTURAL REPAIR OF CONCRETE DEPTH GREATER THAN 5"

BILL OF MATERIAL

ITEM	UNIT	QUANTITY
STRUCTURAL REPAIR OF CONCRETE LESS THAN OR EQUAL TO 5"	SQ. FT.	57
STRUCTURAL REPAIR OF CONCRETE GREATER THAN 5"	SQ. FT.	74
TEMPORARY SHORING AND CRIBBING	EACH	3

NOTE:
 ALL REQUIRED SHORING TO BE PLACED ON EAST SIDE
 OF PIER NO MATTER THE SIDE OF WHERE TEMPORARY
 SHORING IS NEEDED.

MODEL: Default
 FILE NAME: p:\pub\amr\room.dwg
 PROJECT: 016-0943-001-04 Bridge Repair\CADD\Drawings\1\Project\104 Bridge Repair\CADD\Drawings\1\104-001-04-01.dwg

USER NAME = rothp	DESIGNED -	REVISED -
PLOT SCALE = 100,0000' / in.	DRAWN -	REVISED -
PLOT DATE = 2/5/2021	CHECKED -	REVISED -
	DATE -	REVISED -

**STATE OF ILLINOIS
 DEPARTMENT OF TRANSPORTATION**

**SN 016-0943: DEMPSTER AVE (IL 58) OVER I-94
 SUBSTRUCTURE REPAIR PLANS**

SCALE: SHEET 5 OF 5 SHEETS STA. TO STA.

F.A.I. RTE.	SECTION	COUNTY	TOTAL SHEETS	SHEET NO.
94	2020-259-BR	COOK	31	24
ILLINOIS FED. AID PROJECT			CONTRACT NO. 62N30	

MODEL: Default
 FILE NAME: p:\work\m3000\dot\illinois\pwr\DOT\Documents\DOT_Offices\Distric 1\Projects\104 Bridge Repair\CADD\Drawings\Distric1.dgn

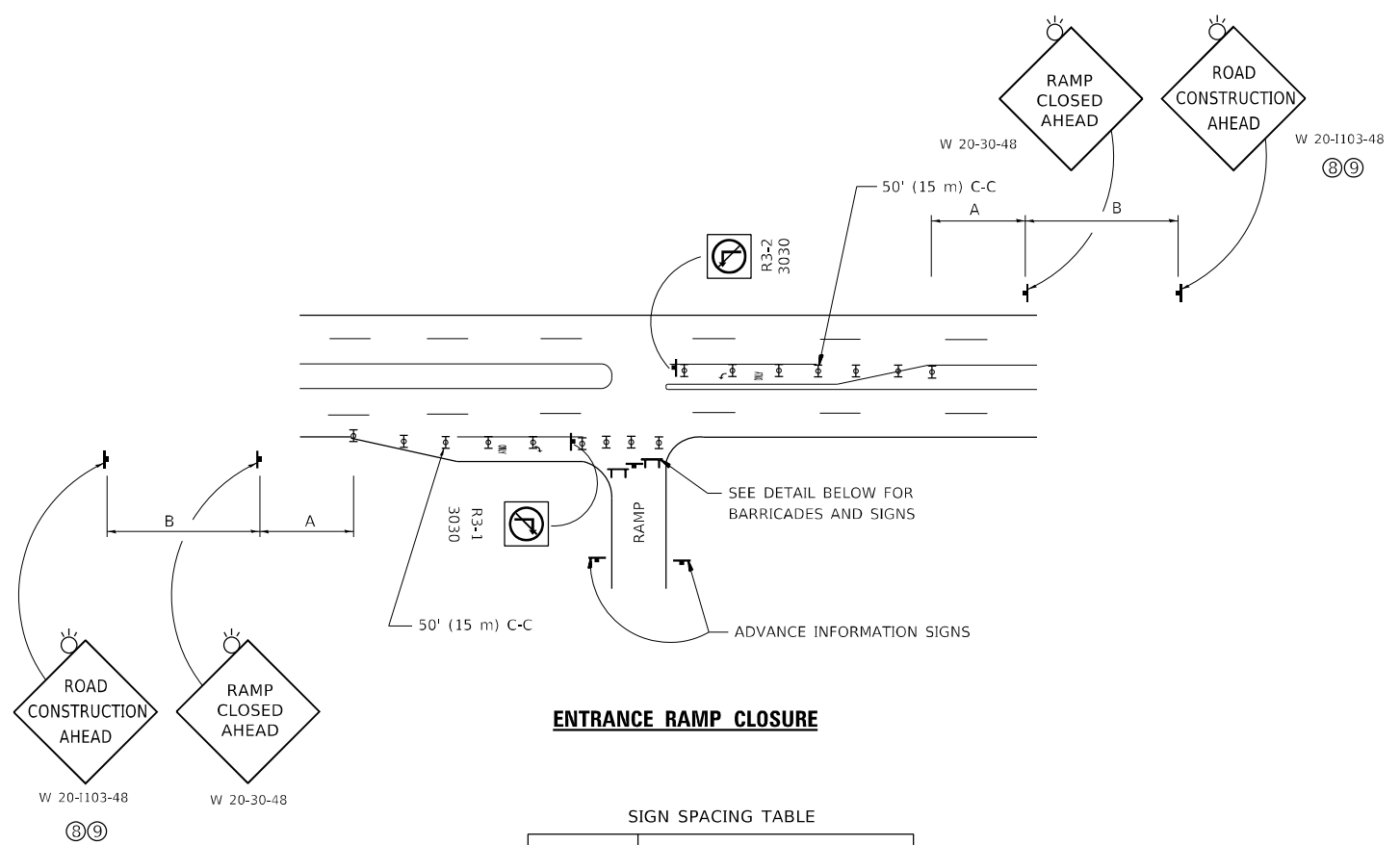

ENTRANCE RAMP CLOSURE

SIGN SPACING TABLE

FACILITY	DISTANCE BETWEEN SIGNS	
	A	B
EXPRESSWAY >24 HOURS	1000' (300 m)	1500' (450 m)
EXPRESSWAY ≤24 HOURS	500' (150 m)	500' (150 m)
ARTERIAL 55 MPH	500' (150 m)	500' (150 m)
ARTERIAL 50-45 MPH	350' (100 m)	350' (100 m)
ARTERIAL <45 MPH	200' (60 m)	200' (60 m)

DISTANCES MAY BE SHORTENED DEPENDING UPON THE PROXIMITY OF ADJACENT RAMPS OR INTERSECTIONS.

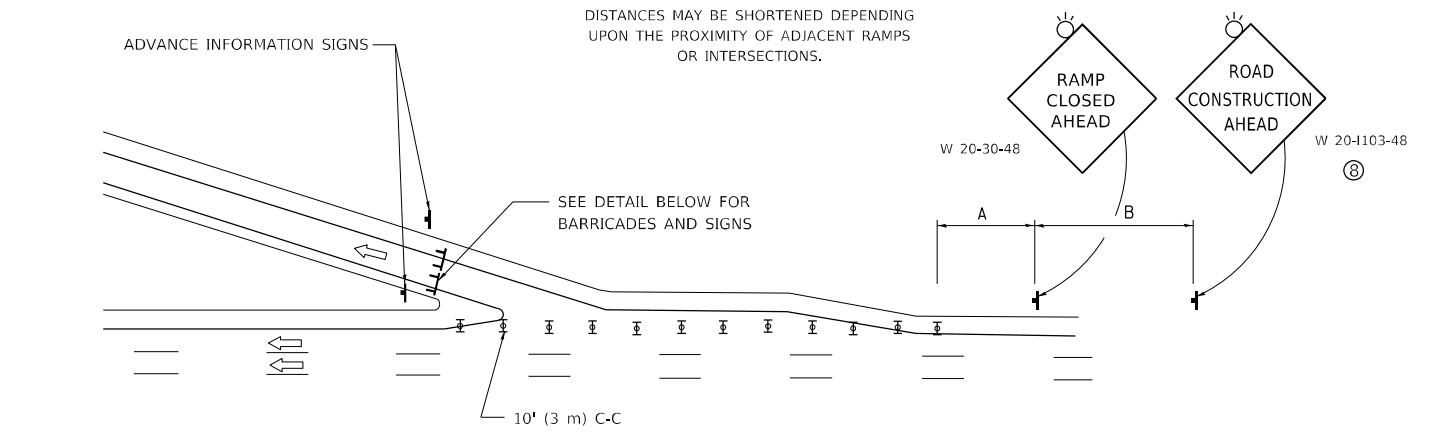

EXIT RAMP CLOSURE

SYMBOLS

- TYPE II BARRICADE OR DRUM
- TYPE III BARRICADE WITH 2 FLASHING LIGHTS

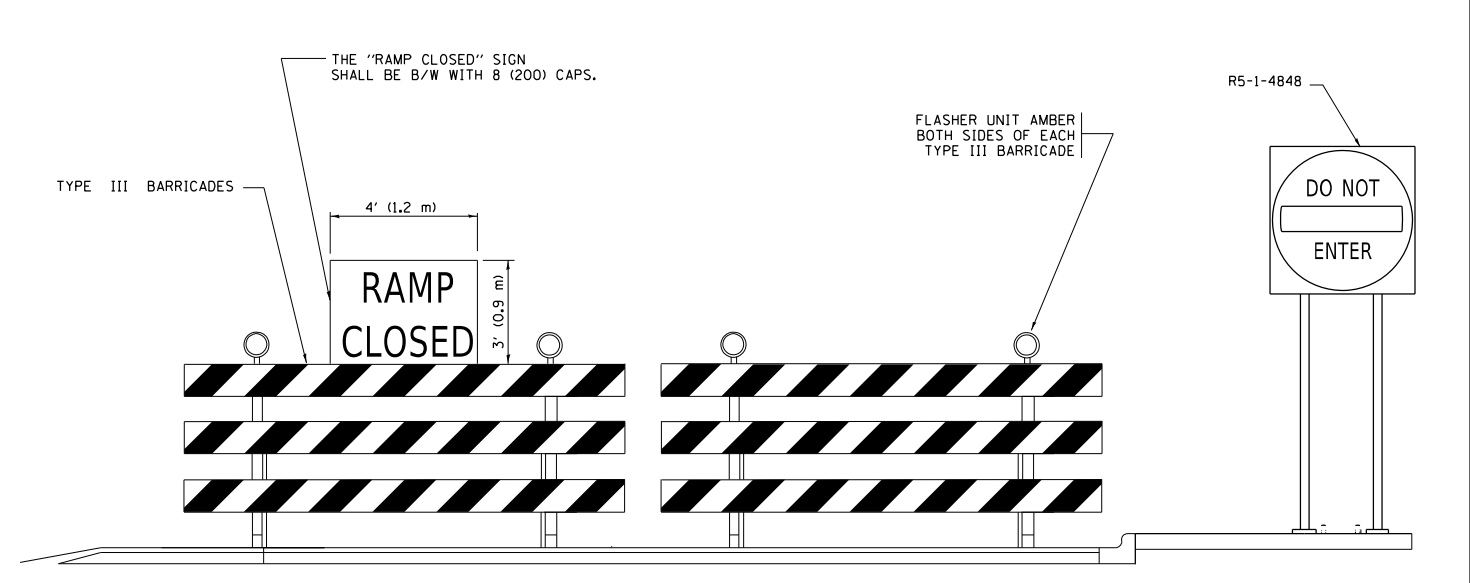

DETAIL FOR REQUIRED BARRICADES & SIGNS

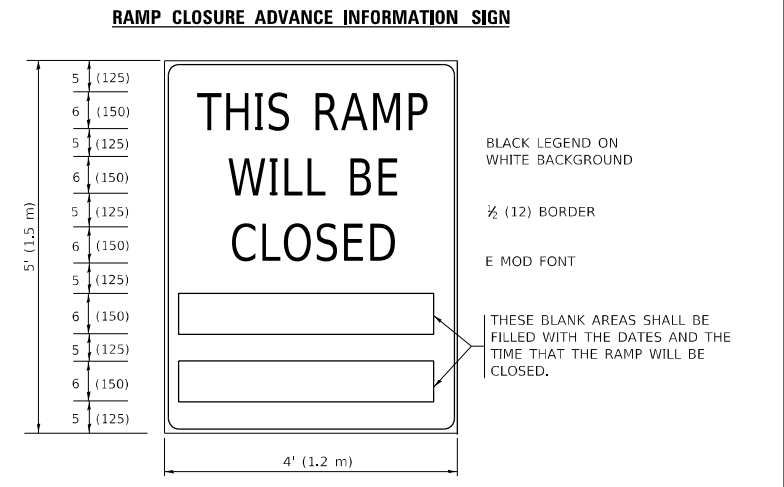
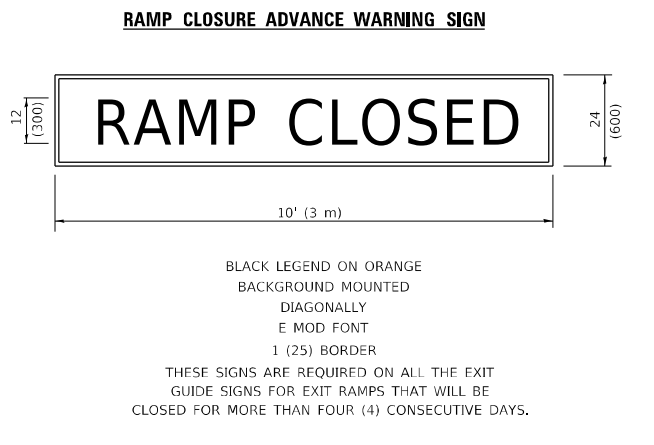

THESE SIGNS ARE REQUIRED ON BOTH SIDES OF THE RAMP, MINIMUM OF 1 WEEK IN ADVANCE OF THE CLOSURE.
 THESE SIGNS SHALL BE FABRICATED AND PAID FOR ACCORDING TO THE TEMPORARY INFORMATION SIGNING SPECIAL PROVISION

GENERAL NOTES:

- ① CONES MAY BE SUBSTITUTED FOR DRUMS OR TYPE II BARRICADES DURING DAY OPERATIONS. CONES SHALL BE A MINIMUM OF 28 (700) HIGH.
- ② VERTICAL BARRICADES SHALL NOT BE USED FOR RAMP CLOSURES.
- ③ A FLAGGER SHALL BE POSITIONED AT EACH CLOSED RAMP THAT IS OPEN TO CONSTRUCTION VEHICLES, PRECEDED BY A W20-7 FLAGGER WARNING SIGN.
- ④ ALL ROUTE MARKERS AND TRAILBLAZER ASSEMBLIES WHICH DIRECT MOTORISTS TO A CLOSED ENTRANCE RAMP SHALL BE COVERED WHEN THE RAMP IS CLOSED FOR MORE THAN FOUR (4) DAYS.
- ⑤ THE SIGNING AND BARRICADING WHICH IS REQUIRED BY THIS DETAIL SHALL BE INCLUDED IN THE COST OF TRAFFIC CONTROL AND PROTECTION (EXPRESSWAYS).
- ⑥ AUTHORIZATION FROM THE DISTRICT'S BUREAU OF TRAFFIC IS REQUIRED FOR ALL RAMP CLOSURES.
- ⑦ THE RAMP CLOSURE ADVANCE INFORMATION SIGNS SHALL BE ERECTED IF THE CLOSURE TIME EXCEEDS TWENTY-FOUR (24) HOURS. ADDITIONAL ADVANCE WARNING SIGNS ON EXIT GUIDE SIGNING WILL BE REQUIRED FOR EXIT RAMP CLOSURES THAT EXCEED FOUR (4) DAYS IN LENGTH.
- ⑧ ROAD CONSTRUCTION AHEAD SIGNS MAY BE OMITTED WHEN THIS DETAIL IS USED IN CONJUNCTION WITH OTHER TRAFFIC CONTROL THAT ALREADY INCLUDES A ROAD CONSTRUCTION AHEAD SIGN.
- ⑨ ARTERIAL ROAD CONSTRUCTION AHEAD SIGNS SHALL BE INSTALLED ON THE LEFT SIDE OF TRAFFIC IF THE MEDIAN IS MORE THAN 10 FT WIDE.

ALL DIMENSIONS ARE IN INCHES (MILLIMETERS) UNLESS OTHERWISE SHOWN.

USER NAME = rothjp	DESIGNED - D.W.S.	REVISED - S.P.B._01-07
PLOT SCALE = 100,0000' / in.	CHECKED -	REVISED - S.P.B._12-09
PLOT DATE = 2/5/2021	DATE - 02-83	REVISED - M.D._06-13
		REVISED - M.D._01-18

**STATE OF ILLINOIS
 DEPARTMENT OF TRANSPORTATION**

**ENTRANCE_AND_EXIT_RAMP
 CLOSURE_DETAILS**

SCALE: NONE SHEET 1 OF 1 SHEETS STA. TO STA.

F.A.I. RTE.	SECTION	COUNTY	TOTAL SHEETS	SHEET NO.
94	2020-259-BR	COOK	31	25
TC-08			CONTRACT NO. 62N30	
		ILLINOIS	FED. AID PROJECT	

SINGLE LANE WEAVE

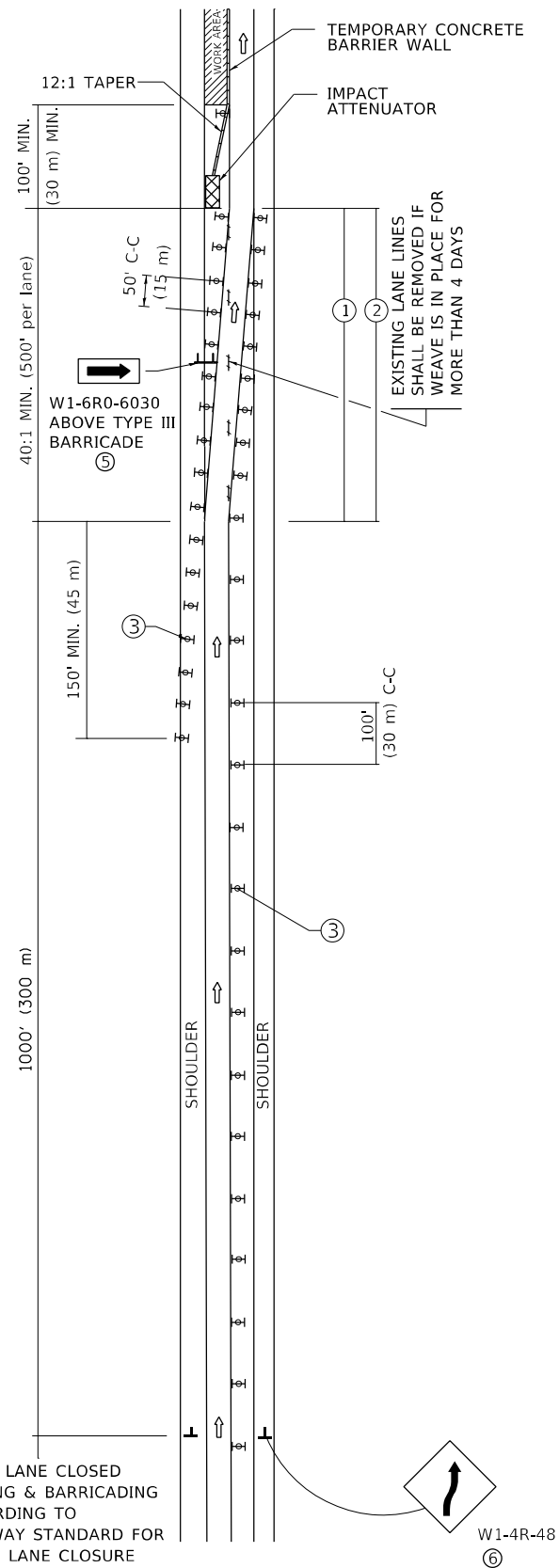

RIGHT LANE CLOSED SIGNING & BARRICADING ACCORDING TO FREEWAY STANDARD FOR A ONE LANE CLOSURE

MULTI-LANE WEAVE

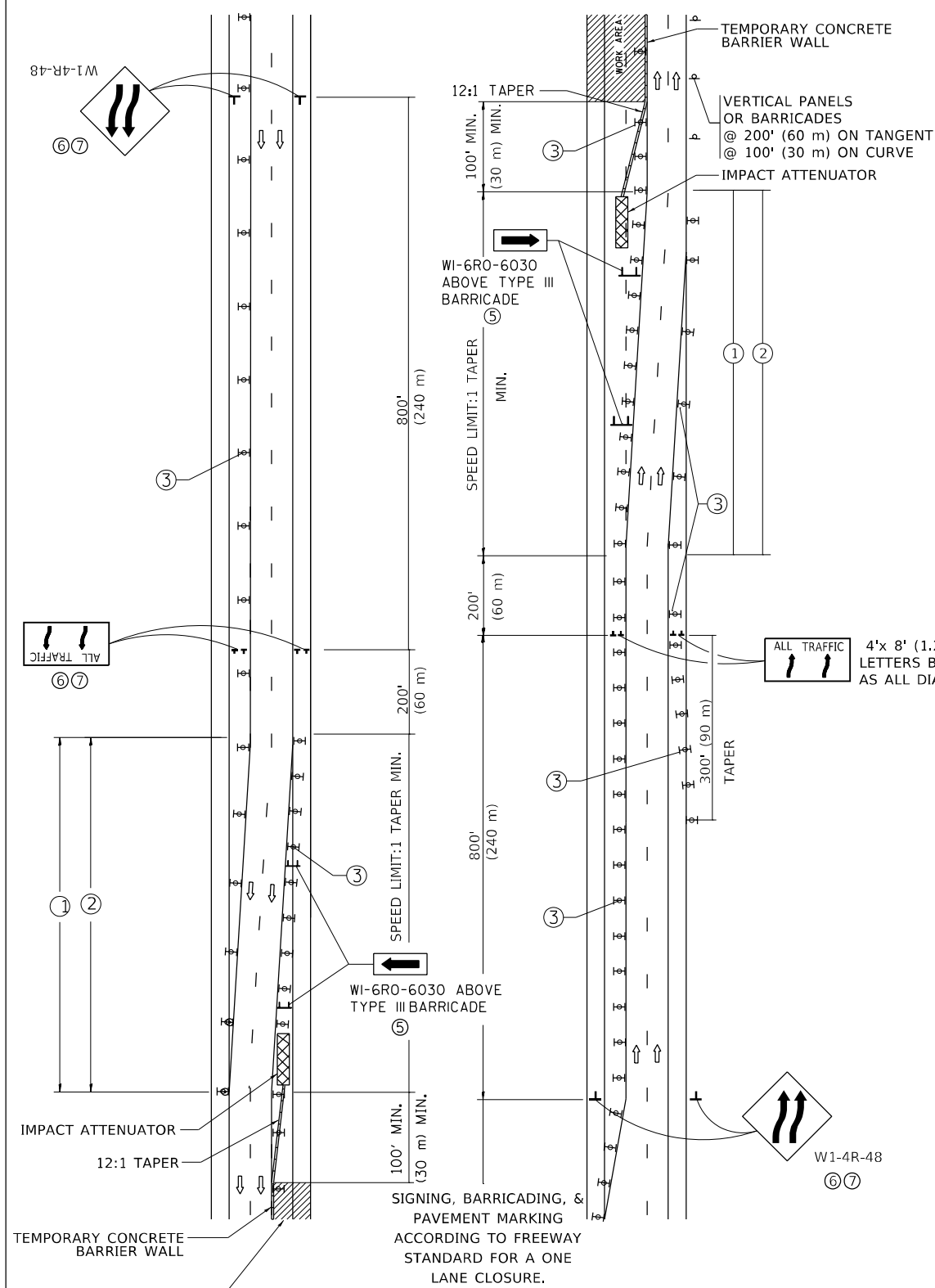

GENERAL NOTES:

- ① EXISTING CONFLICTING PAVEMENT MARKING LINES SHALL BE REMOVED. PAVEMENT MARKING REMOVAL SHALL NOT BE REQUIRED FOR SINGLE LANE WEAVES UNDER 4 DAYS IN DURATION.
- ② CONTINUOUS REFLECTIVE TEMPORARY PAVEMENT MARKING TAPE SHALL BE PLACED THROUGHOUT THE TAPER AND FOR 300' (90 m) ALONG SIDE THE WORK AREA WHERE THE CLOSURE TIME IS GREATER THAN FOURTEEN DAYS. THE LEFT EDGE LINE SHALL BE YELLOW AND THE RIGHT EDGE LINE SHALL BE WHITE. FOR MULTI-LANE WEAVES LANE LINES SHALL BE 5 INCH, 10'-30' (3 m-9 m) SKIP DASH, WHITE.
- ③ PLASTIC DRUMS WITH STEADY BURN LIGHTS AT 50' (15 m) C-C SPACING IN TAPERS AND 100' (30 m) C-C SPACING IN TANGENTS.
- ④ ALL SIGNS SHALL BE POST MOUNTED IF THE CLOSURE TIME EXCEEDS FOUR DAYS.
- ⑤ TYPE III BARRICADES MAY BE OMITTED FOR SINGLE-LANE WEAVES UNDER 24-HOURS IN DURATION. W1-6 SIGNS WILL STILL BE REQUIRED. IF THE WIDTH OF OFFSET IS LESS THAN 6' THEN THE TYPE III BARRICADE WITH ATTACHED ARROW SIGN PANEL CAN BE ELIMINATED IN THE TAPER AREAS.
- ⑥ WHEN THE LENGTH OF THE SHIFTED SEGMENT (DISTANCE BETWEEN WEAVE POINTS) IS LESS THAN 1500', DOUBLE REVERSE CURVE SIGNS (W24-1) SHOULD BE USED INSTEAD OF THE REVERSE CURVE (W1-4) SIGNS. ARROWS ON THE 4'X8' "ALL TRAFFIC" SIGNS SHALL BE THE SAME SHAPE.
- ⑦ THE NUMBER OF ARROWS ON THESE SIGNS SHALL MATCH THE NUMBER OF LANES OPEN TO TRAFFIC.

4'x 8' (1.2 m x 2.4 m); 1 (25) BORDER; 10 (250) CAPITAL LETTERS BACKGROUND SHEETING SHALL BE THE SAME AS ALL DIAMOND SHAPED CONSTRUCTION SIGNS.

SYMBOLS

- DIRECTION OF TRAFFIC
- WORK AREA
- SIGN ON PORTABLE OR PERMANENT SUPPORT
- TYPE II BARRICADE OR DRUM WITH MONO-DIRECTIONAL STEADY BURNING LIGHT
- TEMPORARY CONCRETE BARRIER WALL
- IMPACT ATTENUATOR
- W1-4R-48
- W24-1-48

ALL DIMENSIONS ARE IN INCHES (MILLIMETERS) UNLESS OTHERWISE SHOWN

MODEL: Default
FILE NAME: p:\pub\baronm.dwt\illinois.gov\PIWDOT\Documents\DOT_Offices\District 1\Projects\104 Bridge Repair\CADD\Drawings\Dist5\TC.dgn

USER NAME = rothp	DESIGNED - D.W.S.	REVISED - J.A.F. 02-06
	DRAWN -	REVISED - S.P.B. 01-07
PLOT SCALE = 100,000' / in.	CHECKED -	REVISED - S.P.B. 12-09
PLOT DATE = 2/5/2021	DATE - 02-87	REVISED - M.D. 06-13

**STATE OF ILLINOIS
DEPARTMENT OF TRANSPORTATION**

**TRAFFIC CONTROL DETAILS FOR
FREEWAY SINGLE & MULTI-LANE WEAVE**

SCALE: NONE SHEET 1 OF 1 SHEETS STA. TO STA.

F.A.I. RTE.	SECTION	COUNTY	TOTAL SHEETS	SHEET NO.
94	2020-259-BR	COOK	31	26
TC-09		CONTRACT NO. 62N30		
ILLINOIS FED. AID PROJECT				

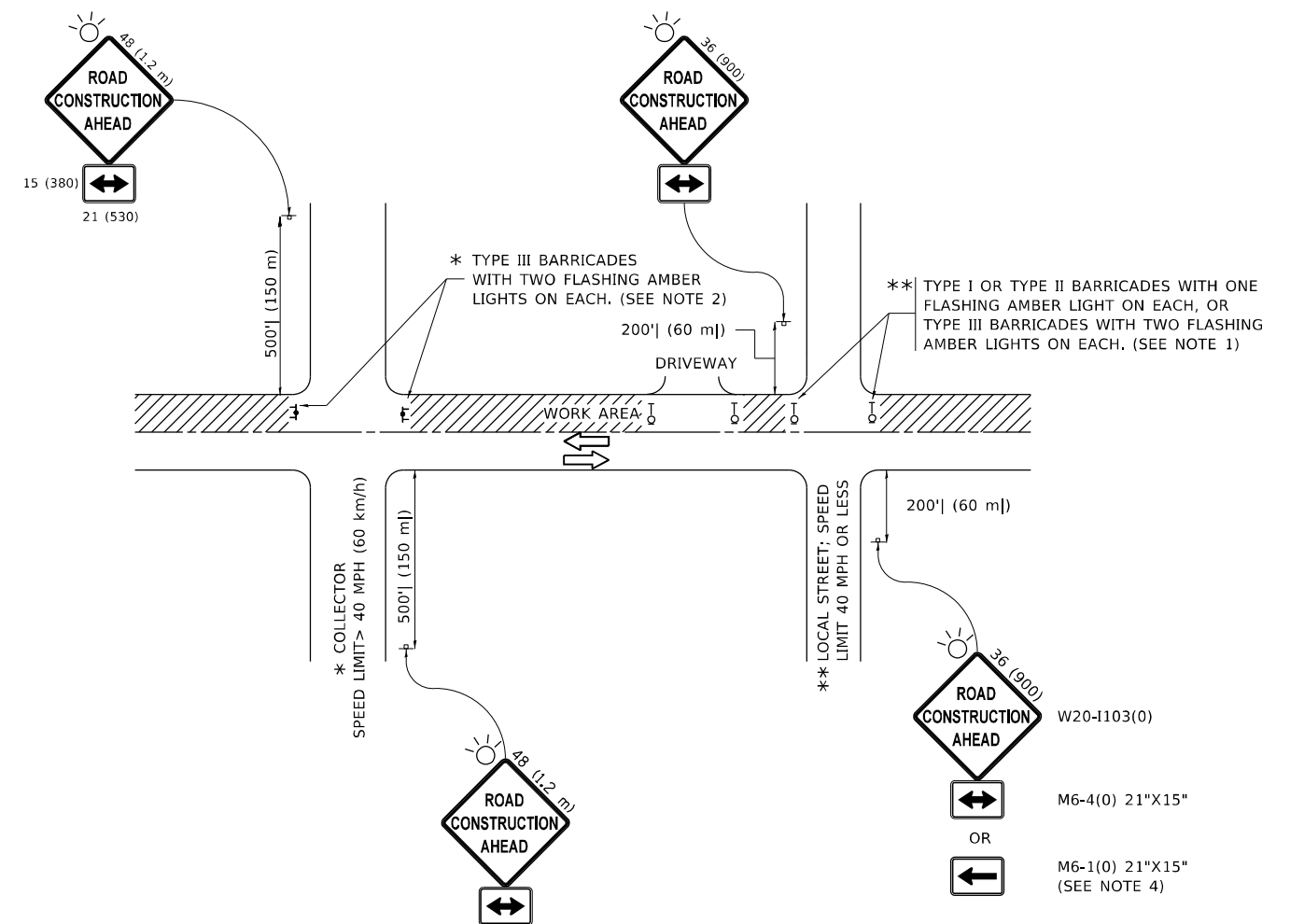

NOTES:

1. SIDE ROAD WITH A SPEED LIMIT OF 40 MPH (60 km/h) OR LESS AS SHOWN ON THE DRAWING AND AS DIRECTED BY THE ENGINEER:
 - a) ONE "ROAD CONSTRUCTION AHEAD" SIGN 36 x 36 (900x900) WITH A FLASHER MOUNTED ON IT APPROXIMATELY 200' (60 m) IN ADVANCE OF THE MAIN ROUTE.
 - b) THE CLOSED PORTION OF THE MAIN ROUTE SHALL BE PROTECTED BY BLOCKING WITH TYPE I, TYPE II OR TYPE III BARRICADES, 1/3 OF THE CROSS SECTION OF THE CLOSED PORTION.
2. SIDE ROAD WITH A SPEED LIMIT GREATER THAN 40 MPH (60 km/h) AS SHOWN ON THE DRAWING AND AS DIRECTED BY THE ENGINEER:
 - a) ONE "ROAD CONSTRUCTION AHEAD" SIGN 48 x 48 (1.2 m x 1.2 m) WITH A FLASHER MOUNTED ON IT APPROXIMATELY 500' (150 m) IN ADVANCE OF THE MAIN ROUTE.
 - b) BLOCKING WITH TYPE III BARRICADES, 1/2 OF THE CROSS SECTION OF THE CLOSED PORTION.
3. CONES MAY BE SUBSTITUTED FOR BARRICADES OR DRUMS AT HALF THE SPACING DURING DAY OPERATIONS. CONES SHALL BE A MINIMUM OF 28 (710) IN HEIGHT.
4. SIGNING AND THE WORK ZONE, A SINGLE HEADED ARROW (M6-1) SHALL BE USED IN LIEU OF THE DOUBLE HEADED ARROW (M6-4).
5. WHEN WORK IS BEING PERFORMED ON A SIDE ROAD OR DRIVEWAY, FOLLOW THE APPLICABLE STANDARD(S). THE DIRECTIONAL ARROW (M6-1 OR M6-4) SHALL BE COVERED OR REMOVED WHEN NO LONGER CONSISTENT WITH THE TRAFFIC CONTROL SET-UP.
6. ADVANCE WARNING SIGNS ARE TO BE OMITTED ON DRIVEWAYS UNLESS OTHERWISE SPECIFIED IN THE PLANS OR BY THE ENGINEER.
7. THE TRAFFIC CONTROL AND PROTECTION FOR SIDE ROADS, INTERSECTIONS, AND DRIVEWAYS SHALL BE INCLUDED IN THE COST OF SPECIFIED TRAFFIC CONTROL STANDARDS OR ITEMS.

All dimensions are in inches (millimeters) unless otherwise shown.

MODEL: Default
FILE NAME: p:\pub\barcom.ctd\Illinois\pwr\DOT\Document\DOT_Offices\District 1\Project\31-94_Bridge_Repair\CADD\Drawings\Design\Dist54.dwg

USER NAME = rothjp	DESIGNED - L.H.A.	REVISED - A. HOUSEH 10-15-96
	DRAWN -	REVISED - T. RAMMACHER 01-06-00
PLOT SCALE = 100,0010' / in.	CHECKED -	REVISED - A. SCHUETZE 07-01-13
PLOT DATE = 2/5/2021	DATE - 06-89	REVISED - A. SCHUETZE 09-15-16

**STATE OF ILLINOIS
DEPARTMENT OF TRANSPORTATION**

**TRAFFIC CONTROL AND PROTECTION FOR
SIDE ROADS, INTERSECTIONS, AND DRIVEWAYS**

SCALE: NONE SHEET 1 OF 1 SHEETS STA. TO STA.

F.A.I. RTE.	SECTION	COUNTY	TOTAL SHEETS	SHEET NO.
94	2020-259-BR	COOK	31	27
TC-10			CONTRACT NO. 62N30	
ILLINOIS FED. AID PROJECT				

TURN BAY ENTRANCE AT START OF LANE CLOSURE TAPER

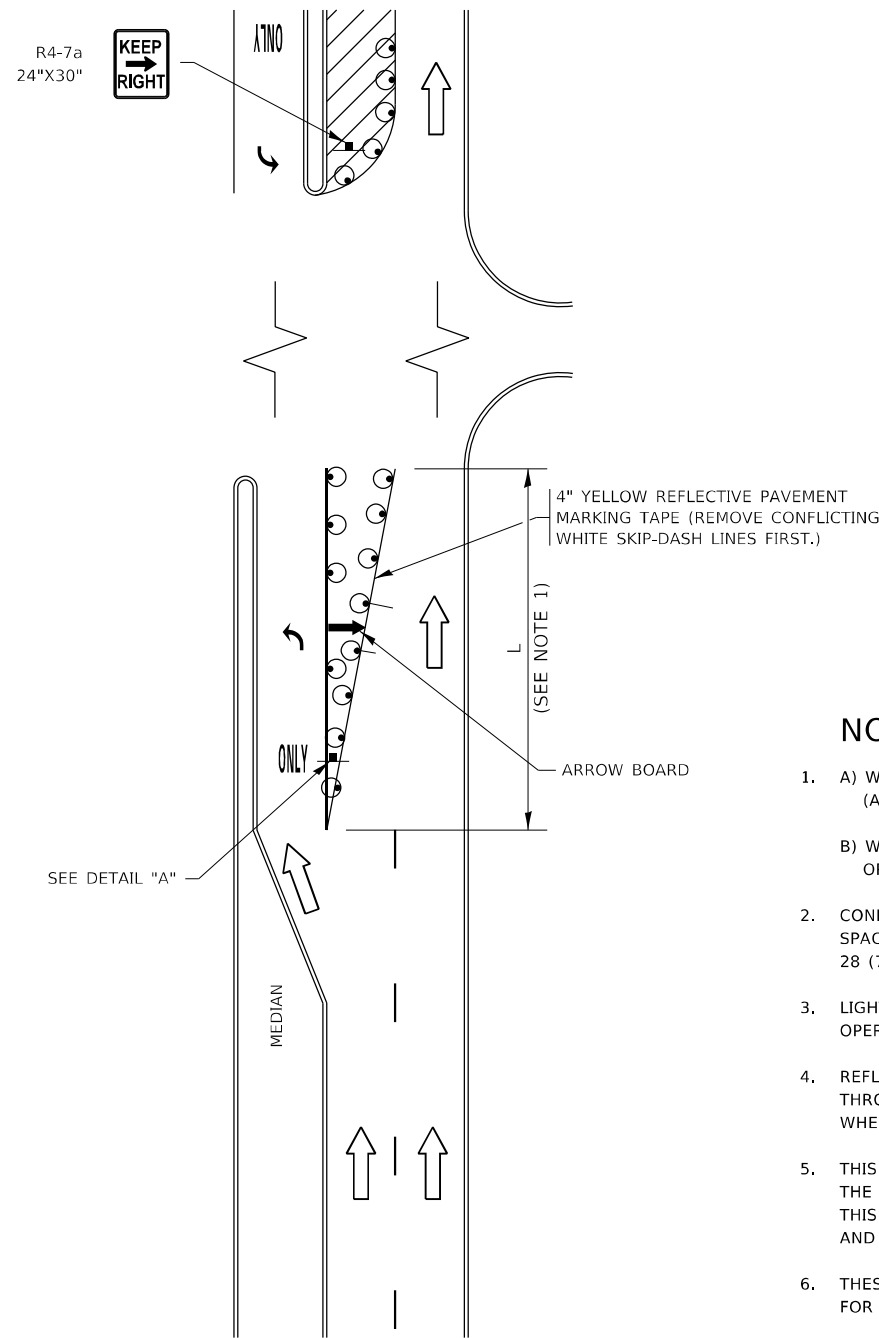

FIGURE 1

TURN BAY ENTRANCE WITHIN A LANE CLOSURE

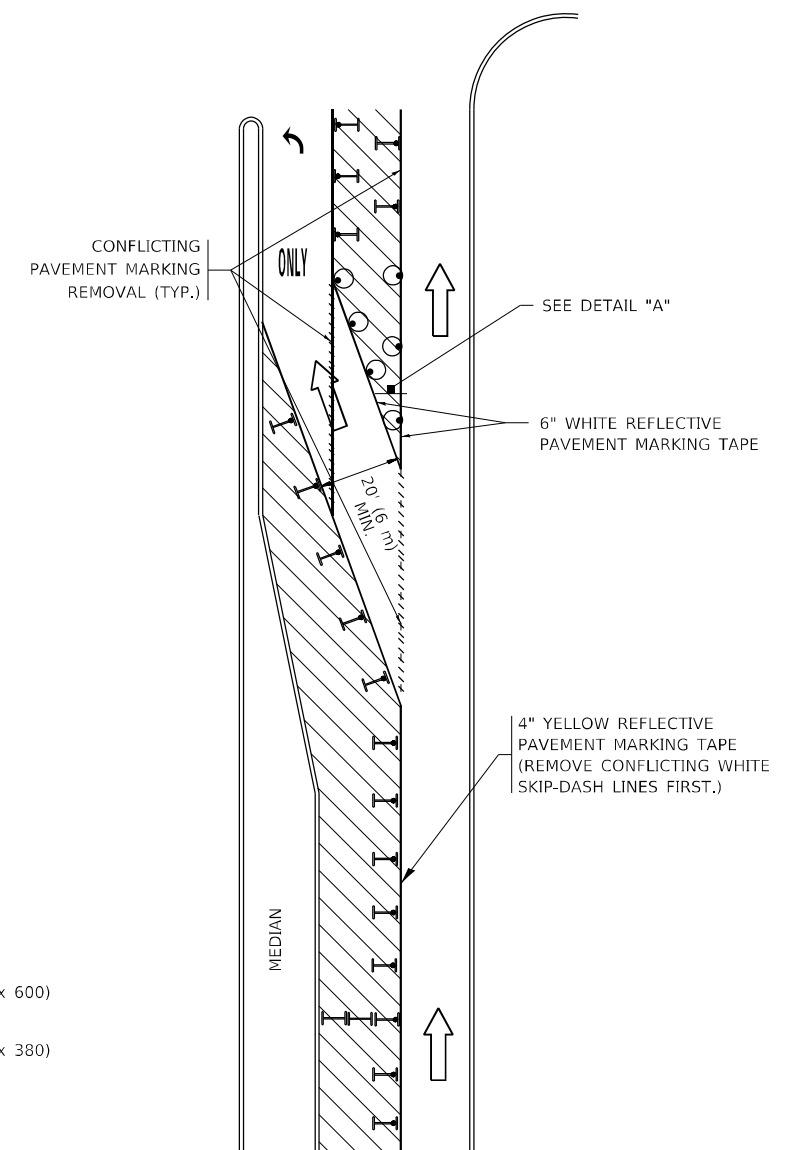
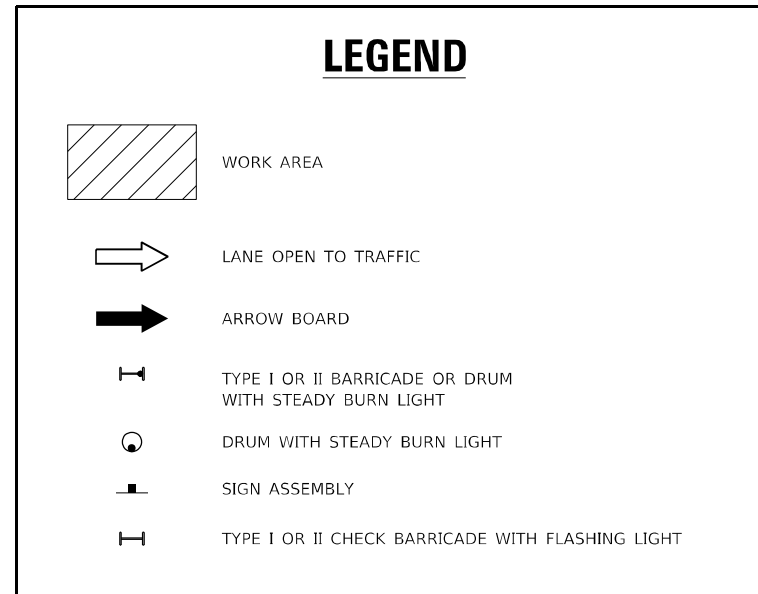
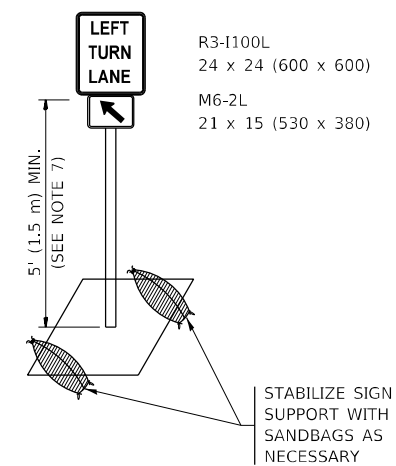

FIGURE 2



NOTES:

1. A) WHEN "L" IS \leq THE STORAGE LENGTH OF THE TURN LANE (AS SHOWN IN FIG. 1), USE FIGURE 1.
 B) WHEN "L" IS $>$ THE STORAGE LENGTH OF THE TURN LANE OR THE TURN LANE IS WITHIN THE LANE CLOSURE, USE FIGURE 2.
2. CONES MAY BE SUBSTITUTED FOR BARRICADES OR DRUMS AT HALF THE SPACING DURING DAY OPERATIONS. CONES SHALL BE A MINIMUM OF 28 (710) IN HEIGHT.
3. LIGHTS WILL NOT BE REQUIRED ON BARRICADES OR DRUMS FOR DAY OPERATIONS. ALL LIGHTS SHALL BE MONODIRECTIONAL.
4. REFLECTIVE TEMPORARY PAVEMENT MARKINGS SHALL BE PLACED THROUGHOUT THE BARRICADED AREAS OF EACH TURN BAY AS SHOWN WHERE THE CLOSURE TIME IS GREATER THAN FOURTEEN (14) DAYS.
5. THIS APPLICATION ALSO APPLIES WHEN WORK IS BEING PERFORMED IN THE RIGHT LANE(S) AND THE RIGHT TURN BAY IS TO REMAIN OPEN. UNDER THIS CONDITION, "RIGHT TURN LANE" R3-1100R 24 x 24 (600 x 600) AND M6-2R 21 x 15 (530 x 380) SHALL BE USED.
6. THESE CONTROLS SHALL SUPPLEMENT MAINLINE TRAFFIC CONTROL FOR LANE CLOSURES.
7. THE SIGNS SHALL BE MOUNTED ABOVE THE BARRICADES/DRUMS ON SEPARATE SIGN SUPPORTS THAT MEET NCHRP 350 OR MASH REQUIREMENTS.
8. TRAFFIC CONTROL AND PROTECTION AT TURN BAYS (TO REMAIN OPEN TO TRAFFIC) SHALL BE INCLUDED IN THE COST OF SPECIFIED TRAFFIC CONTROL STANDARDS OR ITEMS.



DETAIL A

All dimensions are in inches (millimeters) unless otherwise shown.

MODEL: Default
 FILE NAME: p:\pub\amr\room.dwg
 PROJECT: 104 Bridge Repair\CADD\Design\Design\DESIGN.dwg

USER NAME = rothjp	DESIGNED - T. RAMMACHER 09-08-94	REVISED - R. BORO 09-14-09
	DRAWN - A. HOUSEH 11-07-95	REVISED - A. SCHUETZE 07-01-13
PLOT SCALE = 100,0000' / in.	CHECKED - A. HOUSEH 10-12-96	REVISED - A. SCHUETZE 09-15-16
PLOT DATE = 2/5/2021	DATE - T. RAMMACHER 01-06-00	REVISED -

**STATE OF ILLINOIS
DEPARTMENT OF TRANSPORTATION**

**TRAFFIC CONTROL AND PROTECTION AT TURN BAYS
(TO REMAIN OPEN TO TRAFFIC)**

SCALE: NONE SHEET 1 OF 1 SHEETS STA. TO STA.

F.A.I. RTE.	SECTION	COUNTY	TOTAL SHEETS	SHEET NO.
94	2020-259-BR	COOK	31	28
TC-14		CONTRACT NO. 62N30		
ILLINOIS FED. AID PROJECT				

PARTIAL RAMP CLOSURE DETAILS

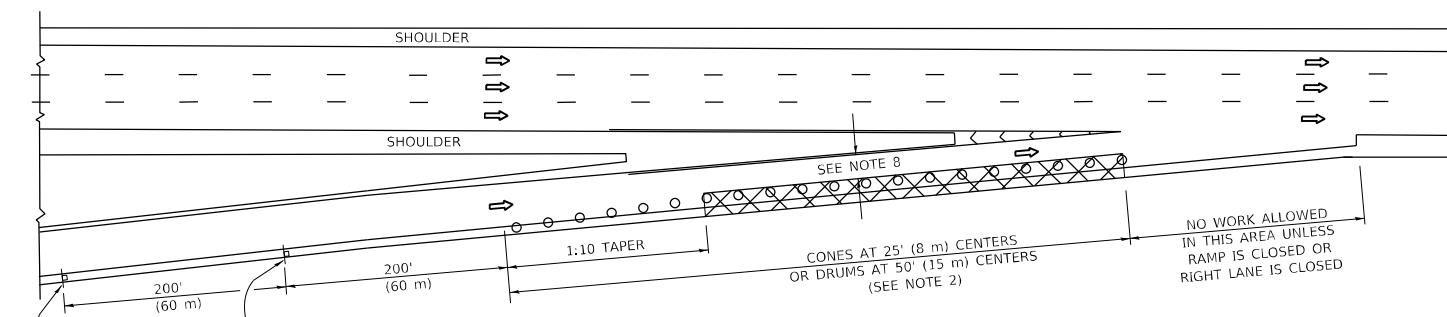

TYPICAL ENTRANCE RAMP

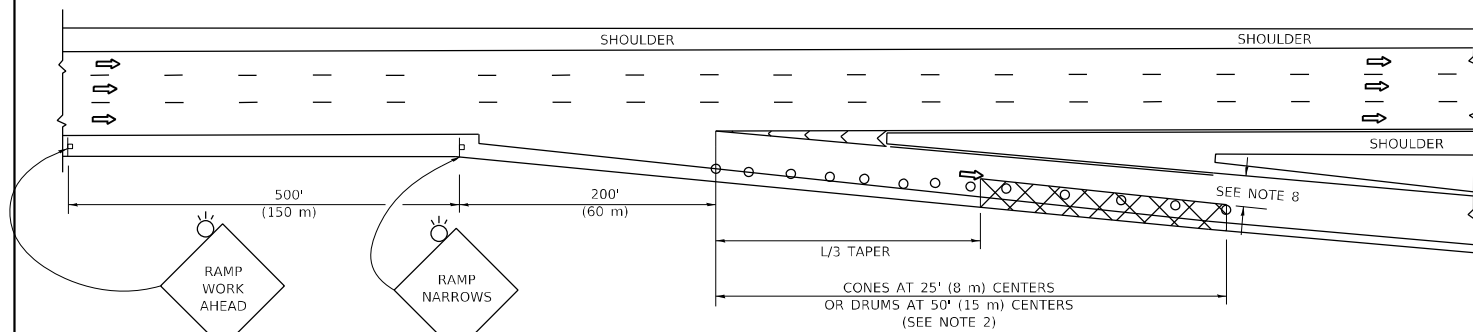

TYPICAL EXIT RAMP

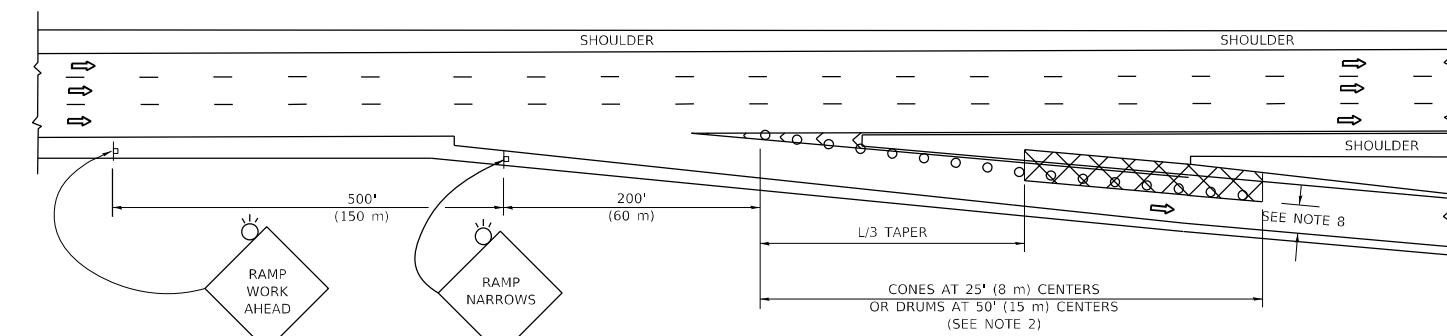

TYPICAL EXIT RAMP

SYMBOLS

- ACTIVE WORK AREA
- SIGN ON PORTABLE OR PERMANENT SUPPORT
- FLAGGER WITH CONTROL SIGN
- TYPE II BARRICADE OR DRUM
- CONE, DRUM OR BARRICADE
- IMPACT ATTENUATOR OF TYPE AND TEST LEVEL SPECIFIED

GENERAL NOTES:

- THE "L" DISTANCE EQUALS:

$L = \frac{W \cdot S}{S - V}$	FORMULAS
45 mph (80 km/h) OR GREATER:	METRIC ENGLISH
$L = 0.65(W/S)$	$L = (W/S)$
W = WIDTH OF OFFSET IN FEET (METERS)	
S = NORMAL POSTED SPEED MPH (KM/H)	
- TYPE II BARRICADES OR DRUMS ARE REQUIRED FOR ALL NIGHTTIME CLOSURES. TYPE II BARRICADES OR DRUMS WITH MONODIRECTIONAL STEADY BURN LIGHTS ARE REQUIRED FOR DELINEATING OBSTACLES, EXCAVATIONS, OR HAZARDS EXCEEDING 100 FT (30m) IN LENGTH AT NIGHT.
- ALL SIGNS SHALL BE POST MOUNTED IF THE CLOSURE TIME EXCEEDS FOUR DAYS.
- FLASHING LIGHTS SHALL BE USED DURING THE HOURS OF DARKNESS AND SHALL BE INSTALLED ABOVE THE FIRST TWO SETS OF SIGNS.

SHOULDER CLOSURE DETAILS

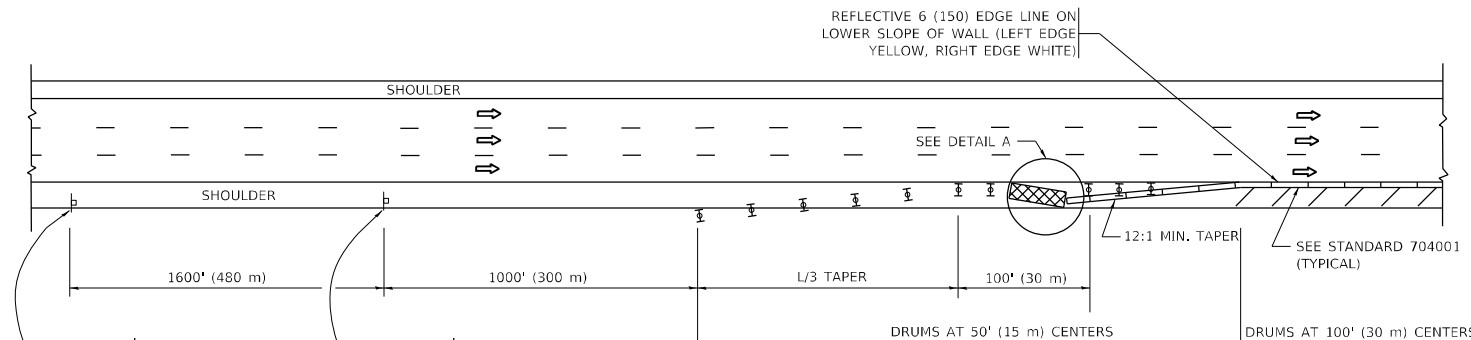

PERMANENT SHOULDER CLOSURE

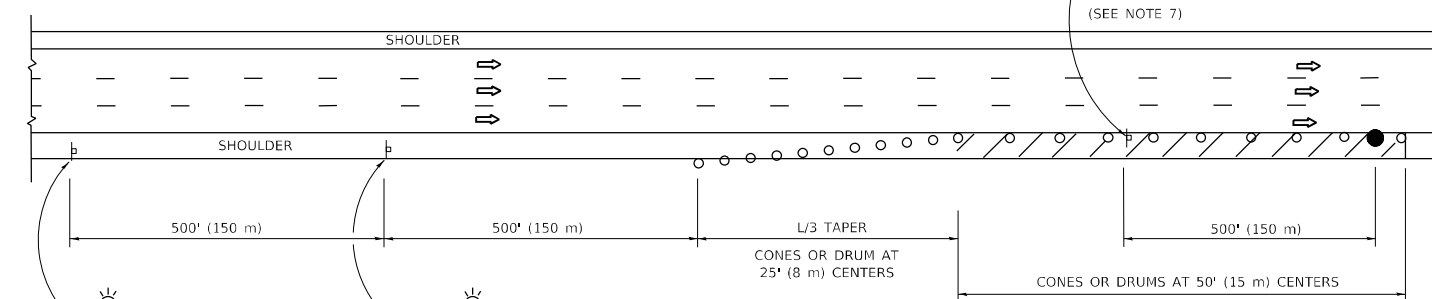

TEMPORARY SHOULDER CLOSURE

THIS DETAIL IS USED WHERE:
 1. VEHICLES, EQUIPMENT, WORKERS OR THEIR ACTIVITIES ENCR OACH IN AN AREA CLOSER THAN 15' (4.5 m) TO THE EDGE OF PAVEMENT FOR A PERIOD IN EXCESS OF 15 MINUTES.



ARRAY DESIGN PER MANUFACTURER TO BE NCHRP 350/MASH COMPLIANT.

**DETAIL "A"
IMPACT ATTENUATOR, TEMPORARY
(SEE NOTE 5)**

- THE IMPACT ATTENUATOR, TEMPORARY IS NOT REQUIRED WHEN THE TEMPORARY CONCRETE BARRIER WALL IS PROTECTED BY OR IS TIED INTO THE EXISTING GUARDRAIL. IF OFFSET IS LESS THAN 5 FEET USE NARROW USE TYPE DEVICE TO MEET NCHRP350/MASH.
- AUTHORIZATION FROM THE DISTRICT'S BUREAU OF TRAFFIC IS REQUIRED FOR ALL FREEWAY CLOSURES.
- THE FLAGGER AND FLAGGER SIGN ARE REQUIRED AT THE ABOVE WORK SITES WHEN:
 - FOUR OR MORE WORK VEHICLES ENTER THE TRAFFIC LANES IN A ONE HOUR PERIOD.
 - THE WORK AVTIVITY REQUIRES FREQUENT ENCR OACHMENT INTO THE LANE OPEN TO TRAFFIC.
 THE FLAGGER SHALL BE STATIONED APPROXIMATELY 100' (30 m) TO 200' (60 m) IN ADVANCE OF THE WORKERS.

- 12' MIN. WIDTH TANGENT SECTION
16' MIN. WIDTH CURVE SECTION.
- TEMPORARY SHOULDER AND NON-SYSTEM INTERCHANGE PARTIAL RAMP CLOSURES ARE ALLOWED WEEKDAYS BETWEEN 9:00 A.M. AND 3:00 P.M. AND BETWEEN 7:00 P.M. AND 5:00 A.M. OR AS APPROVED BY THE EXPRESSWAY TRAFFIC OPERATIONS ENGINEER. PERMANENT SHOULDER AND PARTIAL RAMP CLOSURES WILL ONLY BE PERMITTED IF CALLED FOR IN THE PLANS OR AS APPROVED BY THE EXPRESSWAY OPERATIONS ENGINEER.

ALL DIMENSIONS ARE IN INCHES (MILLIMETERS) UNLESS OTHERWISE SHOWN.

MODEL: Default
FILE NAME: p:\m\hammond.dwg
PROJECT: 104 Bridge Repair\CADD\Drawings\Design\DESIGN.dwg

USER NAME = rothp	DESIGNED -	REVISED - S.P.B. 12-09
	DRAWN - D.W.S.	REVISED - M.D. 06-13
PLOT SCALE = 100,0000' / in.	CHECKED -	REVISED - M.D. 01-18
PLOT DATE = 2/5/2021	DATE - 11-96	REVISED - M.D. 10-20

**STATE OF ILLINOIS
DEPARTMENT OF TRANSPORTATION**

**TRAFFIC CONTROL DETAILS FOR FREEWAY
SHOULDER CLOSURES AND PARTIAL RAMP CLOSURES**

SCALE: NONE SHEET 1 OF 1 SHEETS STA. TO STA.

F.A.I. RTE.	SECTION	COUNTY	TOTAL SHEETS	SHEET NO.
94	2020-259-BR	COOK	31	30
TC-17			CONTRACT NO. 62N30	
ILLINOIS FED. AID PROJECT				

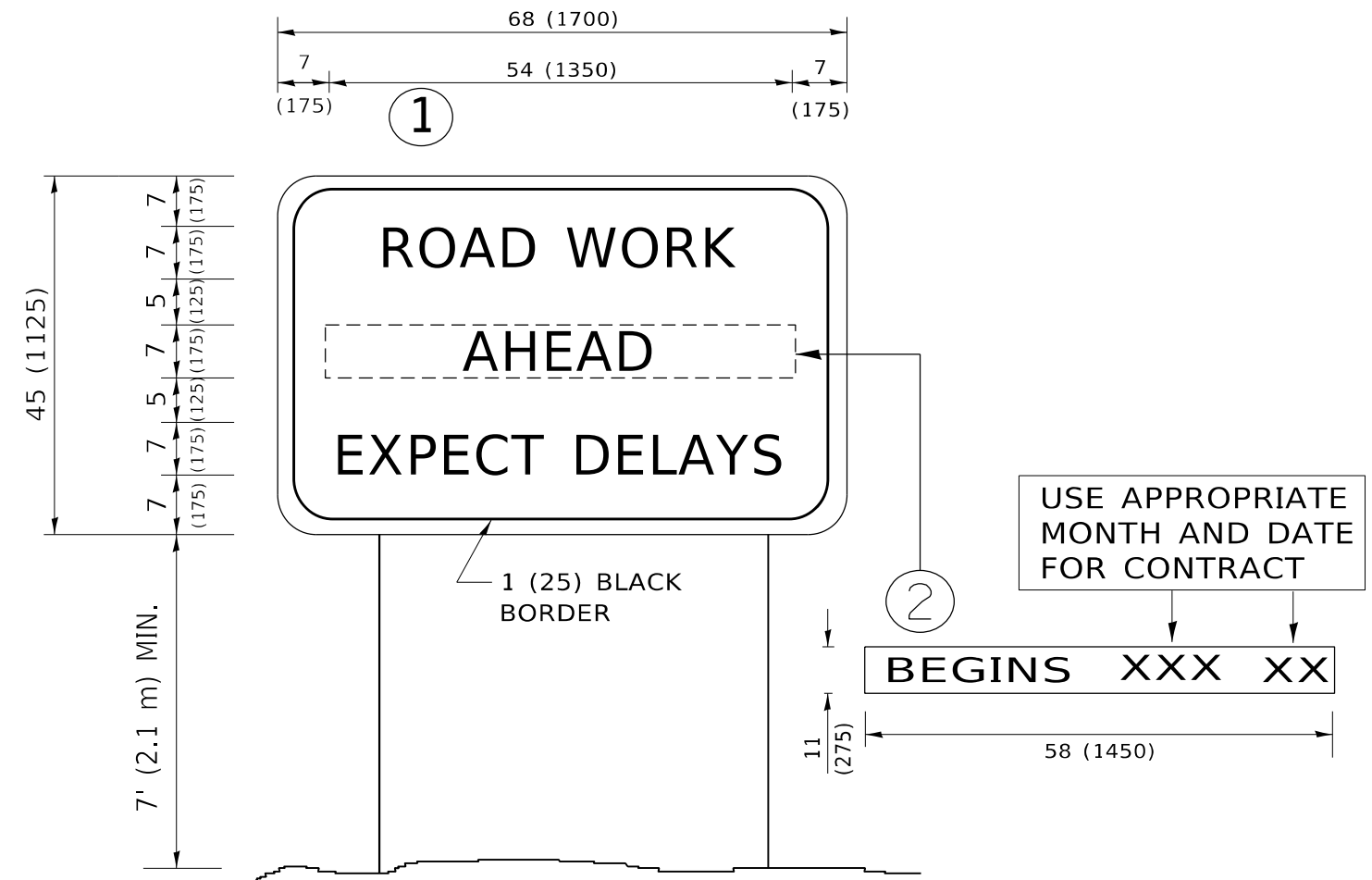

NOTES:

1. USE BLACK LETTERING ON ORANGE BACKGROUND.
2. ERECT SIGNS IN ADVANCE OF THE LOCATION FOR THE "ROAD CONSTRUCTION AHEAD" SIGN AT LOCATIONS AS DIRECTED BY THE ENGINEER.
3. ERECT SIGN ① WITH INSTALLED PANEL ② ONE WEEK PRIOR TO THE START OF CONSTRUCTION.
4. REMOVE PANEL ② SOON AFTER THE START OF CONSTRUCTION.
5. SEE SPECIAL PROVISION FOR "TEMPORARY INFORMATION SIGNING" FOR ADDITIONAL INFORMATION.
6. ONE SIGN ASSEMBLY EQUALS 25.70 SQ. FT. (2.3 SQ. M.)
7. SHALL BE PAID FOR AS TEMPORARY INFORMATION SIGNING.

ALL DIMENSIONS ARE IN INCHES (MILLIMETERS) UNLESS OTHERWISE SHOWN.

MODEL: Default
 FILE NAME: p:\pub\mroom.dwt\illinois.gov\PWIDOT\Documents\DOT_Offices\Distric. 1\Project\104 Bridge Repair\CADD\Bridges\Design\Dist5.dgn

USER NAME = rothjp	DESIGNED -	REVISED - R. MIRS 09-15-97
	DRAWN -	REVISED - R. MIRS 12-11-97
PLOT SCALE = 100,0000 ' / in.	CHECKED -	REVISED - T. RAMMACHER 02-02-99
PLOT DATE = 2/5/2021	DATE -	REVISED - C. JUCIUS 01-31-07

**STATE OF ILLINOIS
DEPARTMENT OF TRANSPORTATION**

**ARTERIAL ROAD
INFORMATION SIGN**

SCALE: NONE SHEET 1 OF 1 SHEETS STA. TO STA.

F.A.I. RTE.	SECTION	COUNTY	TOTAL SHEETS	SHEET NO.
94	2020-259-BR	COOK	31	31
TC-22		CONTRACT NO. 62N30		
ILLINOIS FED. AID PROJECT				