

04-23-2021 LETTING ITEM 093

STATE OF ILLINOIS
DEPARTMENT OF TRANSPORTATION

F.A.U. RTE.	SECTION	COUNTY	TOTAL SHEETS	SHEET NO.
6109	20-00083-00-RS	LASALLE	5	1
		ILLINOIS	CONTRACT NO. 87766	

INDEX OF SHEETS

1. COVER SHEET
2. GENERAL NOTES & SUMMARY OF QUANTITIES
3. TYPICAL SECTIONS
4. - 5. PLAN SHEETS

HIGHWAY STANDARDS

000001-08	STANDARD SYMBOLS, ABBREVIATIONS AND PATTERNS
280001-07	TEMPORARY EROSION CONTROL SYSTEMS
424001-11	PERPENDICULAR CURB RAMPS FOR SIDEWALKS
424006-05	DIAGONAL CURB RAMPS FOR SIDEWALKS
424011-04	CORNER PARALLEL CURB RAMPS FOR SIDEWALKS
424021-06	DEPRESSED CORNER FOR SIDEWALKS
424026-03	ENTRANCE/ALLEY PEDESTRIAN CROSSINGS
606001-07	CONCRETE CURB TYPE B AND COMBINATION CONCRETE CURB AND GUTTER
701001-02	OFF-ROAD OPERATIONS, 2L, 2W, MORE THAN 15' AWAY
701006-05	OFF-ROAD OPERATIONS, 2L, 2W, 15' TO 24" FROM PAVEMENT EDGE
701301-04	LANE CLOSURE, 2L, 2W, SHORT TIME OPERATIONS
701311-03	LANE CLOSURE 2L, 2W MOVING OPERATIONS - DAY ONLY
701501-06	URBAN LANE CLOSURE, 2L, 2W, UNDIVIDED
701801-06	SIDEWALK, CORNER OR CROSSWALK CLOSURE
701901-08	TRAFFIC CONTROL DEVICES
780001-05	TYPICAL PAVEMENT MARKINGS

PROPOSED FOR PROPOSED
FEDERAL AID HIGHWAY

CITY OF LA SALLE
FAU 6109 (CROSAT STREET)
SECTION 20-00083-00-RS
PROJECT 8AMN(810)
LASALLE COUNTY
C-93-001-22

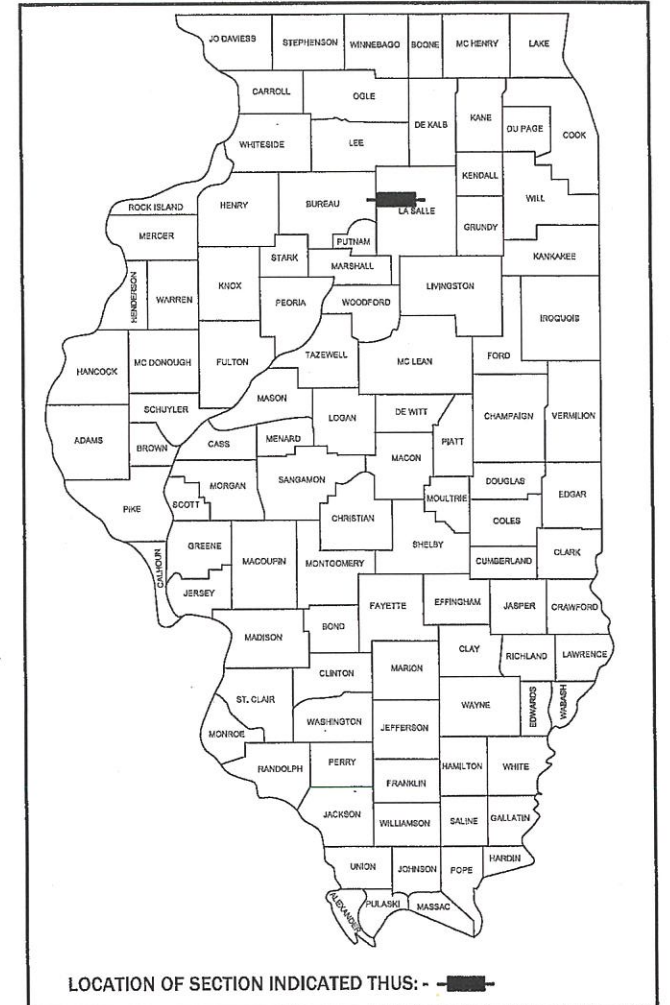

FAU 6109 (CROSAT STREET)
FUNCTIONAL CLASSIFICATION: MAJOR COLLECTOR
ADT = 1200 (2016)
POSTED SPEED = 30 MPH

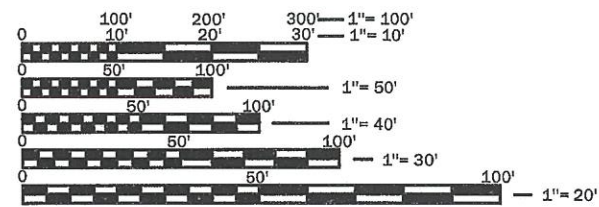

FULL SIZE PLANS HAVE BEEN PREPARED USING STANDARD ENGINEERING SCALES. REDUCED SIZED PLANS WILL NOT CONFORM TO STANDARD SCALES. IN MAKING MEASUREMENTS ON REDUCED PLANS, THE ABOVE SCALES MAY BE USED.

J.U.L.I.E.
JOINT UTILITY LOCATION INFORMATION FOR EXCAVATION
1-800-892-0123
OR 811

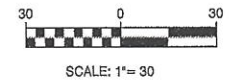

GROSS LENGTH = 2,210 FT. = 0.42 MILES
NET LENGTH = 2,210 FT. = 0.42 MILES

PREPARED BY OR UNDER THE DIRECT SUPERVISION OF:

[Signature]
DATED THIS 8TH DAY OF FEBRUARY, 2021



STATE OF ILLINOIS
DEPARTMENT OF TRANSPORTATION

SUBMITTED 2/8 2021
[Signature]
JEFF GROVE, MAYOR - CITY OF LA SALLE

PASSED FEBRUARY 18, 2021
[Signature]
DISTRICT 3, LOCAL ROADS AND STREET ENGINEER

RELEASED FOR FEBRUARY 18, 2021
[Signature]
LIMITED REVIEW REGION 2 ENGINEER

PRINTED BY THE AUTHORITY
OF THE STATE OF ILLINOIS

DISTRICT 3 NO. (815) 434-6131
CONTRACT NO. 87766

GENERAL NOTES

THE THICKNESS OF THE HOT-MIX ASPHALT SHOWN ON THE PLANS IS A NOMINAL THICKNESS. DEVIATIONS FROM NOMINAL THICKNESS WILL BE PERMITTED WHEN SUCH DEVIATIONS OCCUR DUE TO REGULARITIES IN THE EXISTING SURFACE OR BASE ON WHICH THE HOT-MIX ASPHALT IS PLACED.

THE ENGINEER WILL BE THE SOLE JUDGE CONCERNING CURING TIME FOR VARIOUS HOT-MIX ASPHALT LIFTS.

FOR STABILIZATION, ALL TYPE III BARRICADES WILL REQUIRE A MINIMUM OF FOUR (4) SAND BAGS PER BARRICADE.

CONTRACTOR SHALL NOTIFY J.U.L.I.E. AT LEAST 48 HOURS PRIOR TO EXCAVATION.

CONTRACTOR SHALL INSTALL "ROAD CONSTRUCTION AHEAD" SIGNS ON US ROUTE 6, PLACED EAST AND WEST OF CROSAT STREET. SIGNS TO BE 48" X 48" WITH A BLACK DIRECTIONAL ARROW ON FLUORESCENT ORANGE BACKGROUND.

THE FOLLOWING RATES OF APPLICATION HAVE BEEN USED IN CALCULATING PLAN QUANTITIES:

BITUMINOUS MATERIAL (PRIME COAT)

SURFACE TYPE	ESTIMATED TRUCK APPLICATION RATE	RESIDUAL RATE
AGGREGATE BASES	0.375 GAL/SQ YD	N/A
MILLED HMA OR PCC PAVEMENT	0.08 GAL/SQ YD	0.04 GAL/SQ YD
EXISTING PAVEMENT	0.05 GAL/SQ YD	0.025 GAL/SQ YD
FOG COAT (BETWEEN ADDITIONAL HMA LIFTS)	0.05 GAL/SQ YD	0.025 GAL/SQ YD

ESTIMATED TRUCK APPLICATION RATE USED FOR CALCULATING PLAN QUANTITIES

CONSTRUCTION TYPE CODE 005 SUMMARY OF QUANTITIES

ITEM CODE	ITEM DESCRIPTION	QUANTITY	UNIT
40600290	BITUMINOUS MATERIALS (TACK COAT)	5817	LBS
40602965	HOT-MIX ASPHALT BINDER COURSE, IL 9.5FG, N50	598	TON
40604000	HOT-MIX ASPHALT SURFACE COURSE, IL 9.5FG, MIX "C", N50	598	TON
Δ 42400200	PORTLAND CEMENT CONCRETE SIDEWALK, 5"	4610	SQ FT
Δ 42400800	DETECTABLE WARNINGS	342	SQ FT
44000158	HOT-MIX ASPHALT SURFACE REMOVAL, 2-1/4"	8543	SY
Δ 44000500	COMBINATION CURB AND GUTTER REMOVAL	892	FT
44000600	SIDEWALK REMOVAL	4610	SQ FT
Δ 60255500	MANHOLES TO BE ADJUSTED	6	EACH
Δ 60266600	VALVE BOXES TO BE ADJUSTED	4	EACH
60603800	COMBINATION CONCRETE CURB AND GUTTER, TY B-6.12	303	FT
60604400	COMBINATION CONCRETE CURB AND GUTTER, TY B-6.18	589	FT
67100100	MOBILIZATION	1	L.S.
70102620	TRAFFIC CONTROL AND PROTECTION 701501	1	L.S.
70102640	TRAFFIC CONTROL AND PROTECTION 701801	1	L.S.
* 78000200	THERMOPLASTIC PAVEMENT MARKING - LINE 4"	964	FT
* 78000400	THERMOPLASTIC PAVEMENT MARKING - LINE 6"	1828	FT
* 78000650	THERMOPLASTIC PAVEMENT MARKING - LINE 24"	245	FT

* SPECIALTY ITEM

Δ SPECIAL PROVISION

DRAWN BY: RYAN LANE

CAD:

REVISIONS

DATE BY



THE CITY OF
LaSalle
ILLINOIS

FAU 6109 (CROSAT STREET)
SECTION 20-00083-00-RS
CITY OF LA SALLE, LA SALLE COUNTY

GENERAL NOTES &
SUMMARY OF QUANTITIES

SCALE: N/A

SHEET 2

FILE NO.:

OF 5

CHECKED BY: BRIAN BROWN

DATE:

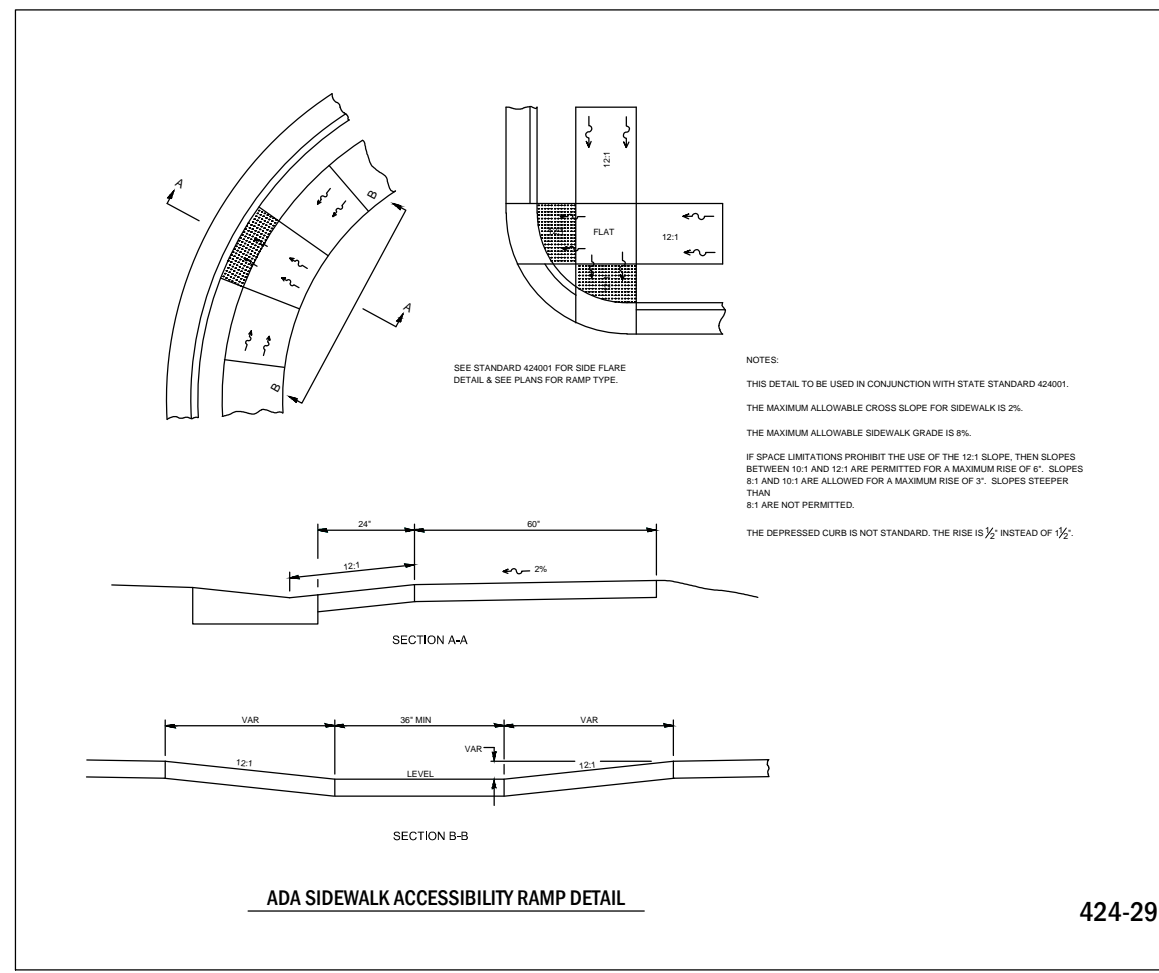

STANDARD ADA SIDEWALK RAMP DETAIL
CROSAT STREET
 N.T.S.

HOT-MIX ASPHALT REQUIREMENT TABLES		
LOCATION(S):	ENTIRE PROJECT	ENTIRE PROJECT
MIXTURE USE(S):	HMA BINDER	HMA SURFACE
BINDER GRADE (PG):	PG 64-22	PG 64-22
DESIGN AIR VOIDS:	4.0% @ N50	4.0% @ N50
MIXTURE COMPOSITION (MIXTURE GRADATION):	IL 9.5FG	IL 9.5FG
FRICTION AGGREGATE:		MIXTURE C
MIXTURE WEIGHT:	112.0 LB/IN/SY	112.0 LB/IN/SY
QUALITY MANAGEMENT PROGRAM:	QCQA	QCQA
SUBLOT SIZE:	N/A	N/A
DENSITY TESTING METHOD:	LR 1030	LR 1030

NOTE: IF ANTI-STRIPPING AGENT IS REQUIRED OR ADDED, THERE WILL BE NO ADDITIONAL COMPENSATION AND THE ANTI-STRIPPING AGENT SHALL BE CONSIDERED INCIDENTAL TO THE PRICE OF THE HOT-MIX ASPHALT

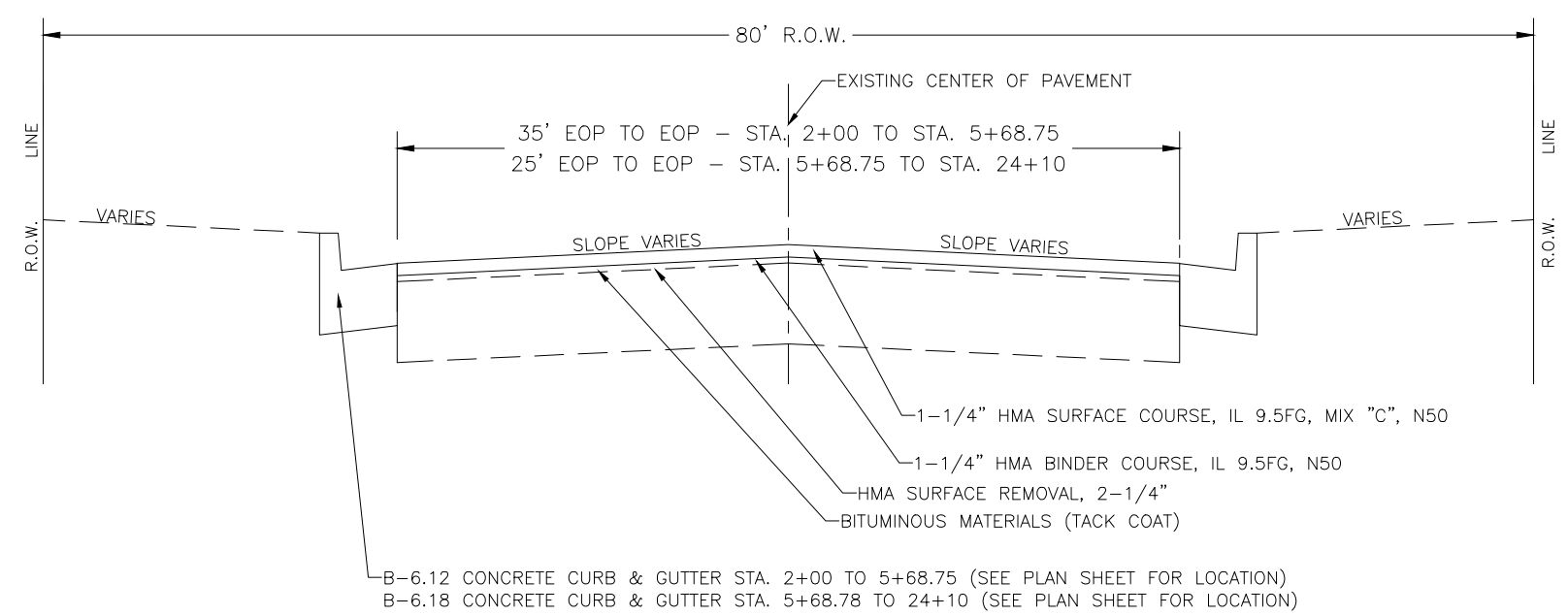
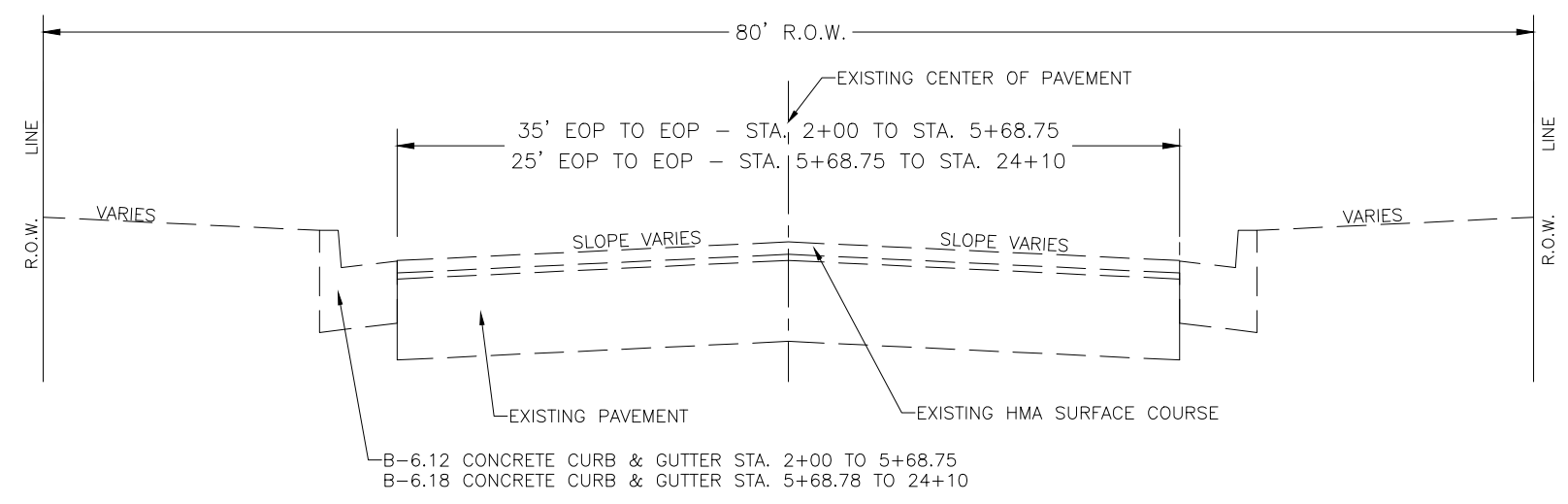

F.A.U. RTE.	SECTION	COUNTY	TOTAL SHEETS	SHEET NO.
6109	20-00083-00-RS	LASALLE	5	4
FED. ROAD DIST. NO.	ILLINOIS	CONTRACT NO. 87766		

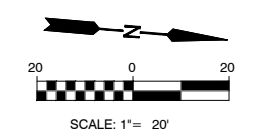
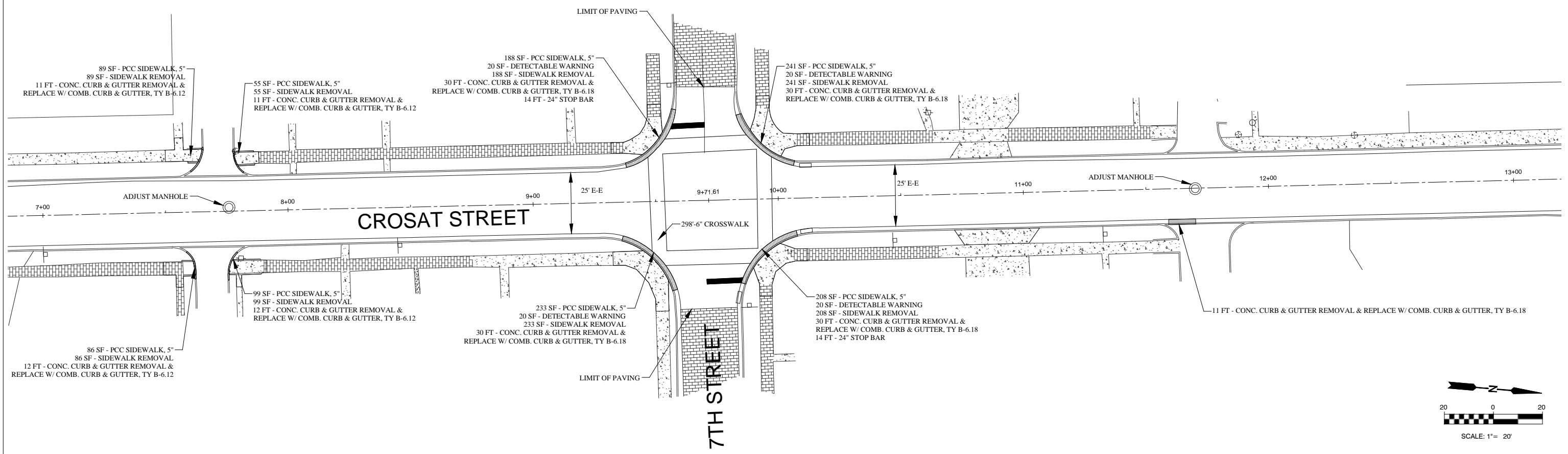
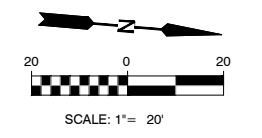
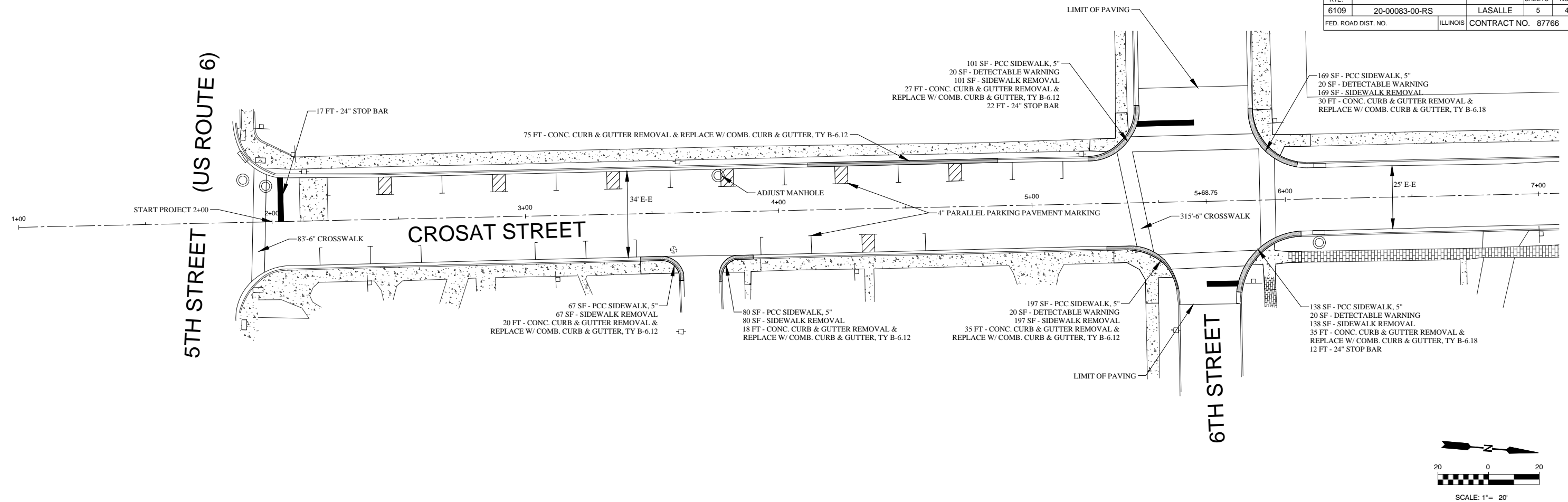

DRAWN BY: RYAN LANE	CAD:	REVISIONS	
CHECKED BY: BRIAN BROWN	DATE: 01-21	DATE	BY



FAU 6109 (CROSAT STREET)
SECTION 20-00083-00-RS
CITY OF LA SALLE, LA SALLE COUNTY

PLAN SHEET
STA. 1+00 TO STA. 13+00

SCALE: 1" = 20' (Horz.)	SHEET 4
1" = 2' (Vertical)	OF 5
FILE NO.:	

F.A.U. RTE.	SECTION	COUNTY	TOTAL SHEETS	SHEET NO.
6109	20-00083-00-RS	LASALLE	5	5
FED. ROAD DIST. NO.	ILLINOIS	CONTRACT NO. 87766		

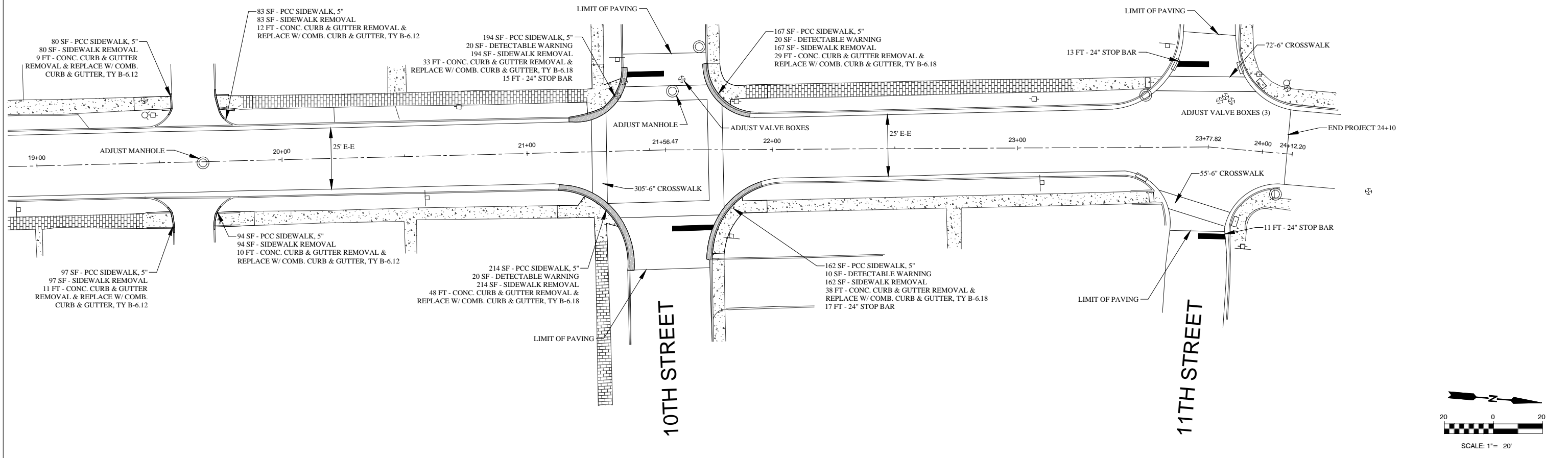
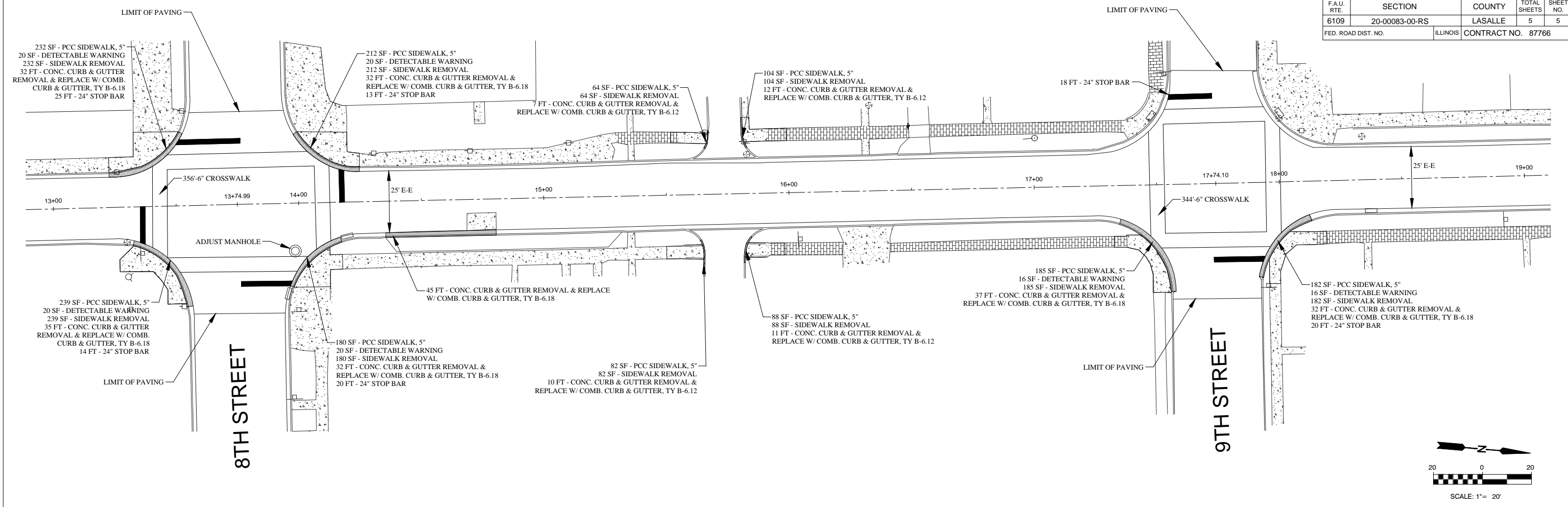

DRAWN BY: RYAN LANE	CAD:	REVISIONS
CHECKED BY: BRIAN BROWN	DATE: 01-21	DATE BY



FAU 6109 (CROSAT STREET)
SECTION 20-00083-00-RS
CITY OF LA SALLE, LA SALLE COUNTY

PLAN SHEET
STA. 13+00 TO STA. 24+12.20

SCALE: 1" = 20' (Horz.) 1" = 2' (Vertical)	SHEET 5
FILE NO.:	OF 5