

STATE OF ILLINOIS  
DEPARTMENT OF TRANSPORTATION

F.A.S. RTE.	SECTION	COUNTY	TOTAL SHEETS	SHEET NO.
334	(130-G-1)RS,MG	IROQUOIS	7	1
		ILLINOIS	CONTRACT NO. 66L41	

INDEX OF SHEETS

1. COVER SHEET
2. GENERAL NOTES
3. SUMMARY OF QUANTITIES
4. SITE PLAN - GENERAL
5. SITE PLAN - GRADING
6. SITE PLAN - REMOVAL
7. SITE PLAN - RESURFACING

STANDARDS

- |           |  |
|-----------|--|
| 000001-08 | STANDARD SYMBOLS, ABBREVIATIONS AND PATTERNS                               |
| 001006    | DECIMAL OF AN INCH AND OF A FOOT   |
| 701001-02 | OFF-ROAD OPERATIONS 2L, 2W, MORE THAN 15' (4.5 m) AWAY                     |
| 701006-05 | OFF-ROAD OPERATIONS 2L, 2W, 15' (4.5 m) TO 24" (600 mm) FROM PAVEMENT EDGE |
| 701201-05 | LANE CLOSURE, 2L, 2W, DAY ONLY, FOR SPEEDS ≥ 45 MPH                        |
| 701901-08 | TRAFFIC CONTROL DEVICES  |

# PROPOSED HIGHWAY PLANS

ROUTE F.A.S. 334 (800N RD.)  
SECTION (130-G-1)RS,MG  
CAPITOL DEVELOPEMENT BOARD  
MILLING AND RESURFACING  
IROQUOIS COUNTY

C-93-036-21

PROJECT LOCATION

ILLINOIS DEPARTMENT OF TRANSPORTATION  
DISTRICT 3 - BUCKLEY MAINTNANCE FACILITY  
435 E. 800N RD., BUCKLEY, 60918

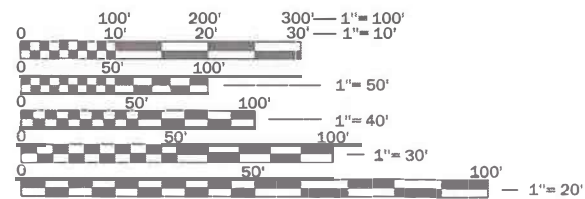
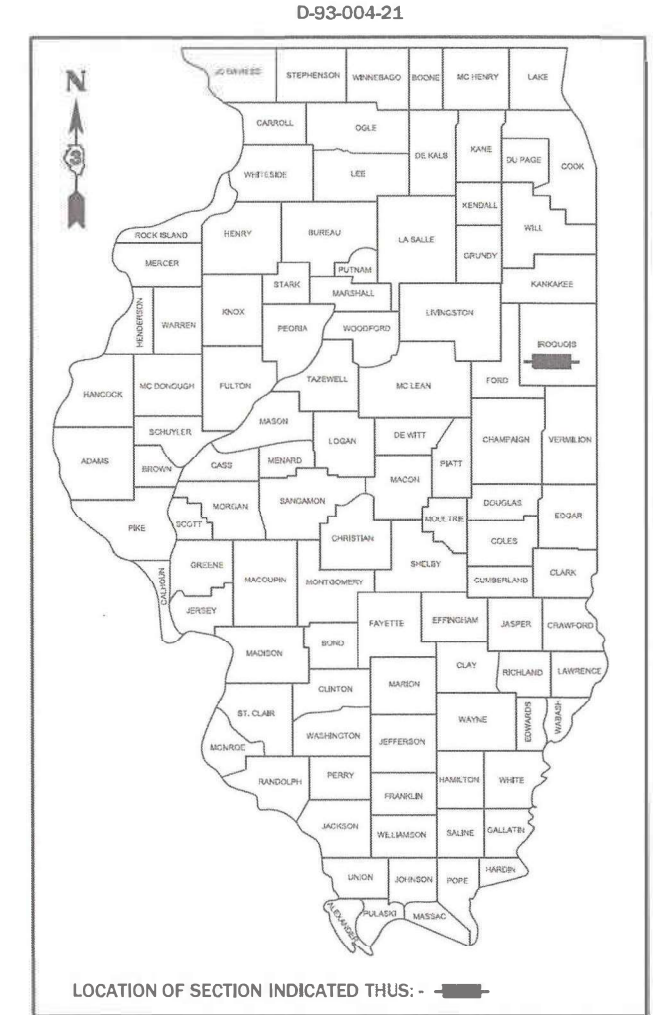

FULL SIZE PLANS HAVE BEEN PREPARED USING STANDARD ENGINEERING SCALES. REDUCED SIZED PLANS WILL NOT CONFORM TO STANDARD SCALES. IN MAKING MEASUREMENTS ON REDUCED PLANS, THE ABOVE SCALES MAY BE USED.

J.U.L.I.E.  
JOINT UTILITY LOCATION INFORMATION FOR EXCAVATION  
1-800-892-0123  
OR 811

PROJECT ENGINEER JOE KANNEL P.E.  
UNIT CHIEF RON WOODSHANK  
DISTRICT 3 NO. (815) 434-6131  
CONTRACT NO. 66L41

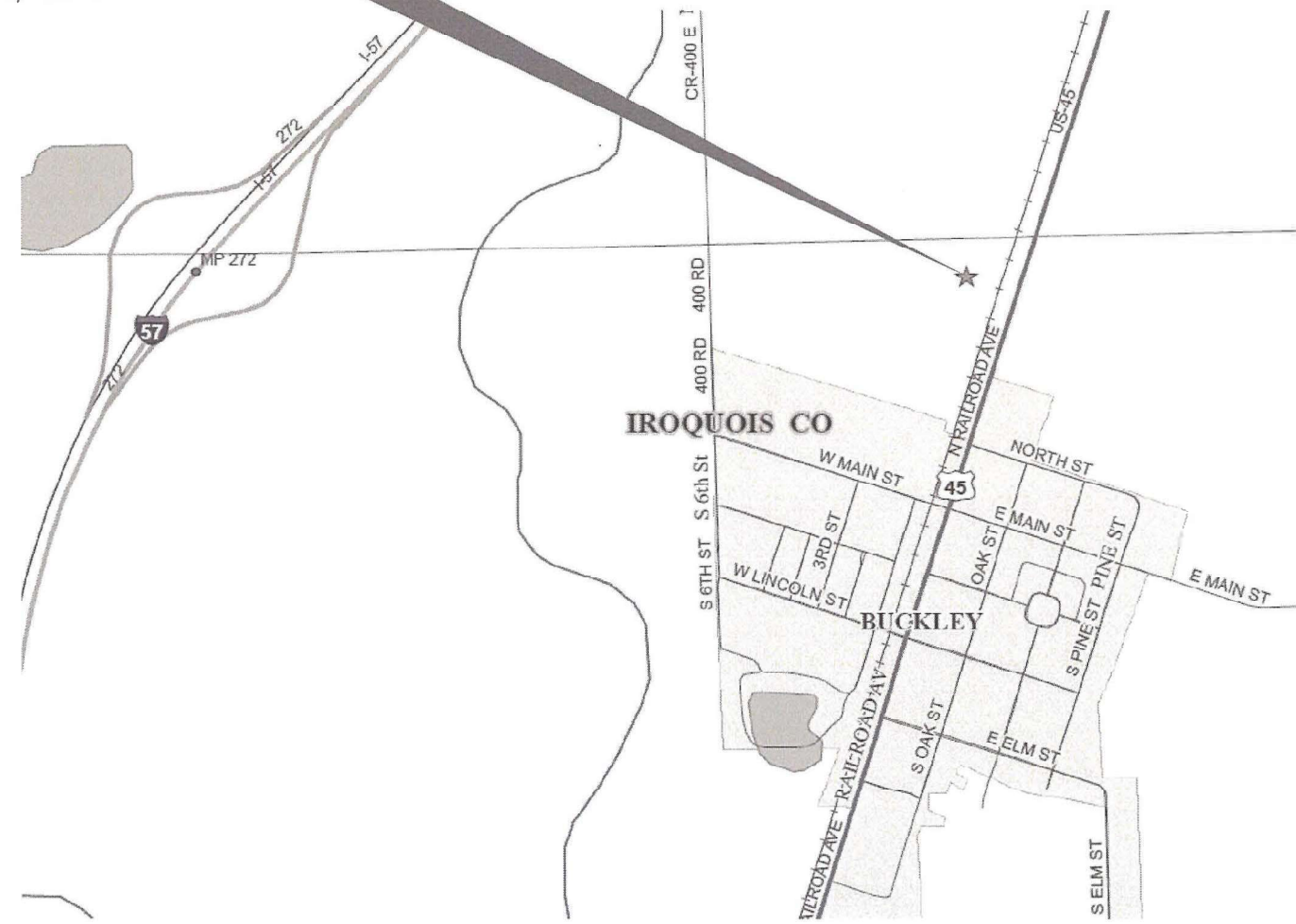

POINT LOCATION

STATE OF ILLINOIS  
DEPARTMENT OF TRANSPORTATION

SUBMITTED February 2, 2021  
[Signature] REGIONAL ENGINEER  
March 19, 2021  
[Signature] ENGINEER OF DESIGN AND ENVIRONMENT  
March 19, 2021  
[Signature] DIRECTOR OF HIGHWAYS PROJECT IMPLEMENTATION 13

PRINTED BY THE AUTHORITY OF THE STATE OF ILLINOIS

**GENERAL NOTES**

THE THICKNESS OF HMA SHOWN ON THE PLANS IS THE NOMINAL THICKNESS. DEVIATIONS FROM NOMINAL THICKNESS WILL BE PERMITTED WHEN SUCH DEVIATIONS OCCUR DUE TO IRREGULARITIES IN THE EXISTING SURFACE OR BASE ON WHICH THE HMA IS PLACED.

THE ENGINEER WILL BE THE SOLE JUDGE CONCERNING CURING TIME FOR THE VARIOUS HMA LIFTS.

ALL EXCAVATED MATERIALS, WHICH INCLUDE DIGGING OR GRADING OF ANY SOIL OR FILL MATERIAL, WITH EXCEPTION OF AGGREGATE FILLS, MUST BE INCORPORATED WITHIN THE IDOT RIGHT OF WAY DUE TO ENVIRONMENTAL DOCUMENTATION REQUIREMENTS.

ON EXISTING PAVEMENT WHICH MAY BE SUPERELEVATED, THE NEW HMA OVERLAY SHALL BE BUILT WITH THE SAME SUPERELEVATION UNLESS NEW SUPERELEVATION RATES ARE GIVEN ON THE PLANS.

ANY REFERENCE TO A STANDARD IN THESE PLANS SHALL BE INTERPRETED TO MEAN THE EDITION AS INDICATED BUY THE SUBNUMBER SHOWN IN THE LIST OF STANDARDS OR THE COPY INCLUDED IN THE PLANS.

THE FOLLOWING RATES OF APPLICATION HAVE BEEN USED IN CALCULATING PLAN QUANTITIES.

HMA RESURFACING 112 LBS / SQ YD / IN

ALL DAMAGE TO DEPARTMENT OWNED ABOVE/UNDERGROUND FACILITIES CAUSED BY THE CONTRACTOR SHALL BE REPAIRED OR REPLACED TO THE SATISFACTION OF THE ENGINEER AT THE CONTRACTOR'S EXPENSE. THIS SHALL INCLUDE ALL TEMPORARY REPAIRS REQUIRED TO KEEP THE FACILITY OPERATIONAL WHILE MATERIALS ARE BEING OBTAINED TO MAKE PERMANENT REPAIRS.

THE CONTRACTOR SHALL CONTACT "JULIE" AT LEAST 48 HOURS PRIOR TO ANY EXCAVATION TO DETERMINE WHICH UTILITIES ARE IN THE AREA.

**COMMITMENTS**

HMA MIXTURE REQUIREMENT TABLE		
LOCATION(S):	ENTIRE PROJECT	ENTIRE PROJECT
MIXTURE USE(S):	HMA BINDER	HMA SURFACE
BINDER GRADE (PG):	SBS PG70-28	SBS PG70-28
DESIGN AIR VOIDS:	4.0% @ N70	4.0% @ N70
MIXTURE COMPOSITION: (MIXTURE GRADATION)	IL 19.0	IL 9.5
FRICTION AGGREGATE:	N/A	MIXTURE C
MIXTURE WEIGHT:	112.0 LB/SY/IN	112.0 LB/SY/IN
QUALITY MANAGEMENT PROGRAM	QC/QA	QC/QA
SUBLOT SIZE:	N/A	N/A
DENSITY TEST METHOD:	GROWTH CURVE	GROWTH CURVE

STATE OF ILLINOIS  
DEPARTMENT OF TRANSPORTATION  
DISTRICT THREE  
AS BUILT INFORMATION

STATE OF ILLINOIS  
DEPARTMENT OF TRANSPORTATION  
DISTRICT THREE

\_\_\_\_\_  
SUPERVISING CONSTRUCTION FIELD ENGINEER

PREPARED BY: \_\_\_\_\_  
DISTRICT STUDIES & PLANS ENGINEER

\_\_\_\_\_  
RESIDENT ENGINEER / TECHNICIAN

DATE: \_\_\_\_\_

START & END DATES  
OF CONSTRUCTION:

\_\_\_\_\_

EXAMINED BY: \_\_\_\_\_  
DISTRICT CONSTRUCTION ENGINEER

INSPECTORS: \_\_\_\_\_

\_\_\_\_\_

\_\_\_\_\_  
DISTRICT MATERIALS ENGINEER

\_\_\_\_\_

\_\_\_\_\_  
DISTRICT OPERATIONS ENGINEER

MODEL: Default  
FILE NAME: \\paulhammon.dot.ilinois.gov\PIWDOT\Documents\DOT\_Offices\District 3\Projects\0366L41\CADD\0366L41-cover.dgn

USER NAME = WOODSHANKRL	DESIGNED - RW	REVISED -
	DRAWN - RW	REVISED -
PLOT SCALE = 100,0000' / in.	CHECKED - EM	REVISED -
PLOT DATE = 9/14/2020	DATE - 7/7/2020	REVISED -

**STATE OF ILLINOIS  
DEPARTMENT OF TRANSPORTATION**

**GENERAL NOTES**

SCALE: SHEET 1 OF 1 SHEETS STA. TO STA.

F.A.S RTE.	SECTION	COUNTY	TOTAL SHEETS	SHEET NO.
334	(130-G-1)RS, MG	IROUOIS	7	2
CONTRACT NO. 66L41				
ILLINOIS FED. AID PROJECT				

CONSTRUCTION CODE	
CAPITOL DEVELOPMENT BOARD	
100% STATE	
NONE	
0005	
RURAL	

CODE NO.	ITEM	UNIT	TOTAL QUANTITY	
35800100	PREPARATION OF BASE	SQ YD	818	818
40600290	BITUMINOUS MATERIALS (TACK COAT)	POUND	5022	5022
40600906	POLYMERIZED HOT-MIX ASPHALT BINDER COURSE (HAND METHOD), N70	TON	5	5
40600990	TEMPORARY RAMP	SQ YD	174	174
40603235	POLYMERIZED HOT-MIX ASPHALT BINDER COURSE, IL-19.0, N70	TON	1042	1042
40604152	POLYMERIZED HOT-MIX ASPHALT SURFACE COURSE, IL-9.5, MIX "C", N70	TON	625	625
67100100	MOBILIZATION	L SUM	1	1
70100450	TRAFFIC CONTROL AND PROTECTION, STANDARD 701201	L SUM	1	1
X0320050	CONSTRUCTION LAYOUT (SPECIAL)	L SUM	1	1
X4400196	HOT-MIX ASPHALT SURFACE REMOVAL, SPECIAL	SQ YD	7485	7485

MODEL: Default  
 FILE NAME: \\paulhammon.dot.ilinois.gov\PWDOT\Documents\DOT\_Offices\District 3\Projects\0366L41\CADD\0366L41-cover.dgn

USER NAME = WOODSHANKRL	DESIGNED - RW	REVISED -
	DRAWN - RW	REVISED -
PLOT SCALE = 100,0000' / in.	CHECKED - EM	REVISED -
PLOT DATE = 9/14/2020	DATE - 7/7/2020	REVISED -

**STATE OF ILLINOIS  
DEPARTMENT OF TRANSPORTATION**

**SUMMARY OF QUANTITIES**

SCALE: SHEET 1 OF 1 SHEETS STA. TO STA.

F.A.S RTE.	SECTION	COUNTY	TOTAL SHEETS	SHEET NO.
334	(130-G-1)RS, MG	IROUOIS	7	3
CONTRACT NO. 66L41				
ILLINOIS FED. AID PROJECT				

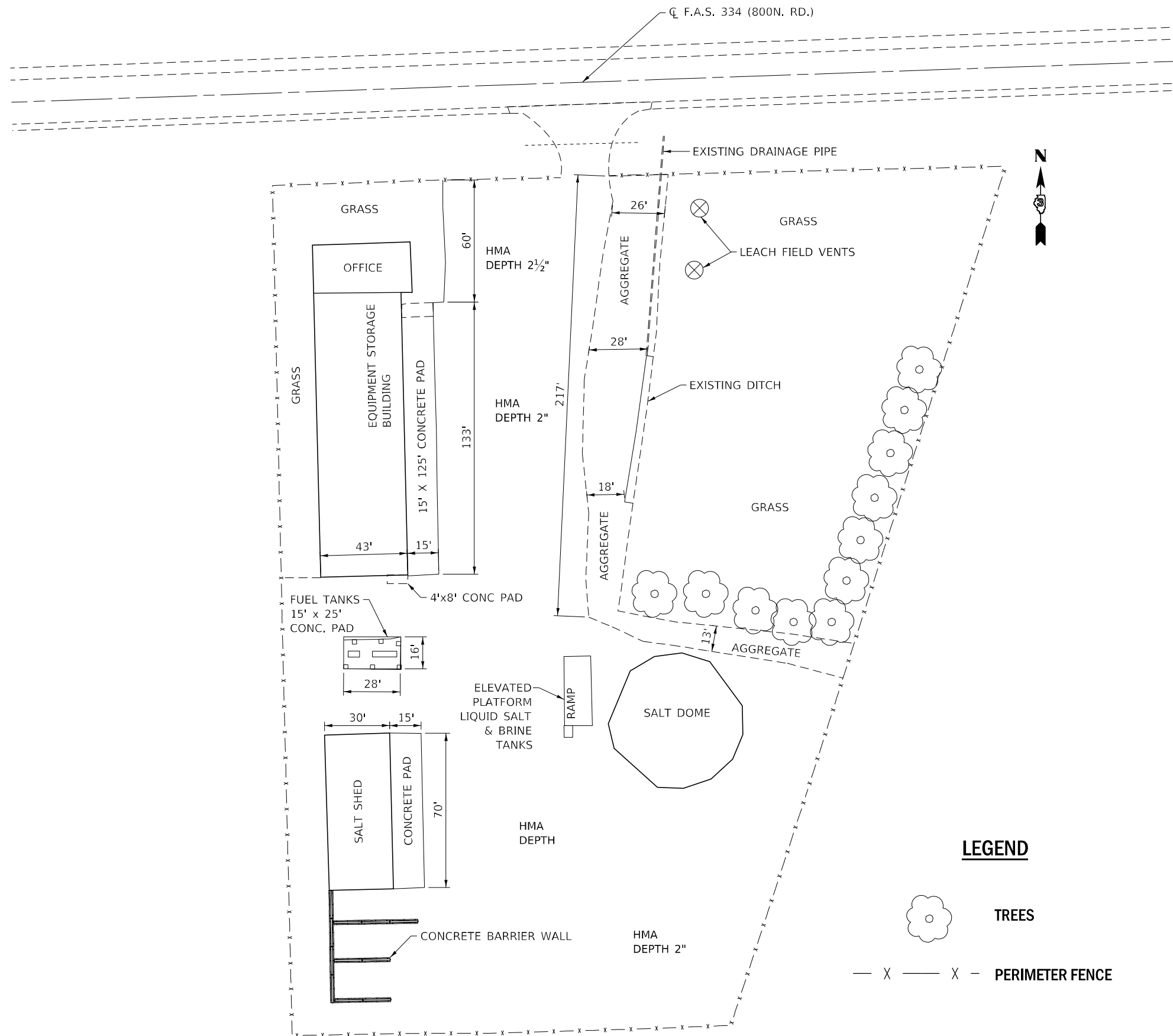

**LEGEND**



TREES

- X - PERIMETER FENCE

**SITE PLAN - GENERAL  
BUCKLEY MAINTENANCE FACILITY**

**STATE OF ILLINOIS  
DEPARTMENT OF TRANSPORTATION**

**SITE PLAN - GENERAL  
BUCKLEY MAINTENANCE FACILITY**

USER NAME = WOODSHANKRL	DESIGNED - RW	REVISED -
	DRAWN - RW	REVISED -
PLOT SCALE = 100,0000' / in.	CHECKED - EM	REVISED -
PLOT DATE = 9/14/2020	DATE - 7/7/2020	REVISED -

SCALE: SHEET 1 OF 1 SHEETS STA. TO STA.

F.A.S. RTE.	SECTION	COUNTY	TOTAL SHEETS	SHEET NO.
334	(130-G-1)RS,MG	IROQUOIS	7	4
CONTRACT NO. 66L41				
ILLINOIS FED. AID PROJECT				

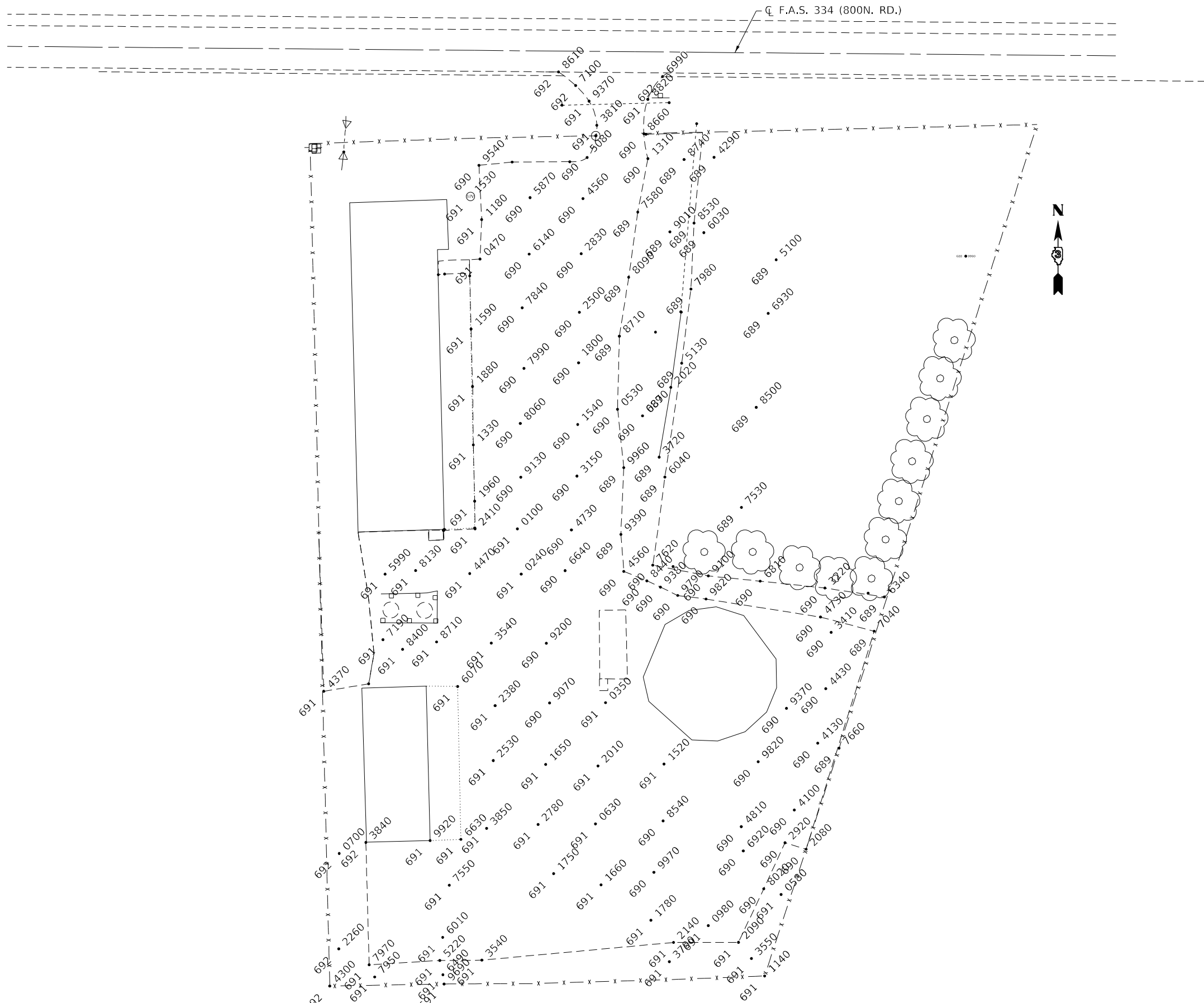

**SITE PLAN - GRADING**  
**BUCKLEY MAINTENANCE FACILITY**

MODEL: Default  
 FILE NAME: p:\pub\hankr\m\dot\Documents\DOT\_Offices\District 3\Projects\0366L41\CADD\0366L41-cover.dwg

USER NAME = WOODSHANKRL	DESIGNED - RW	REVISED -
	DRAWN - RW	REVISED -
PLOT SCALE = 100,0000' / in.	CHECKED - EM	REVISED -
PLOT DATE = 9/14/2020	DATE - 7/7/2020	REVISED -

**STATE OF ILLINOIS**  
**DEPARTMENT OF TRANSPORTATION**

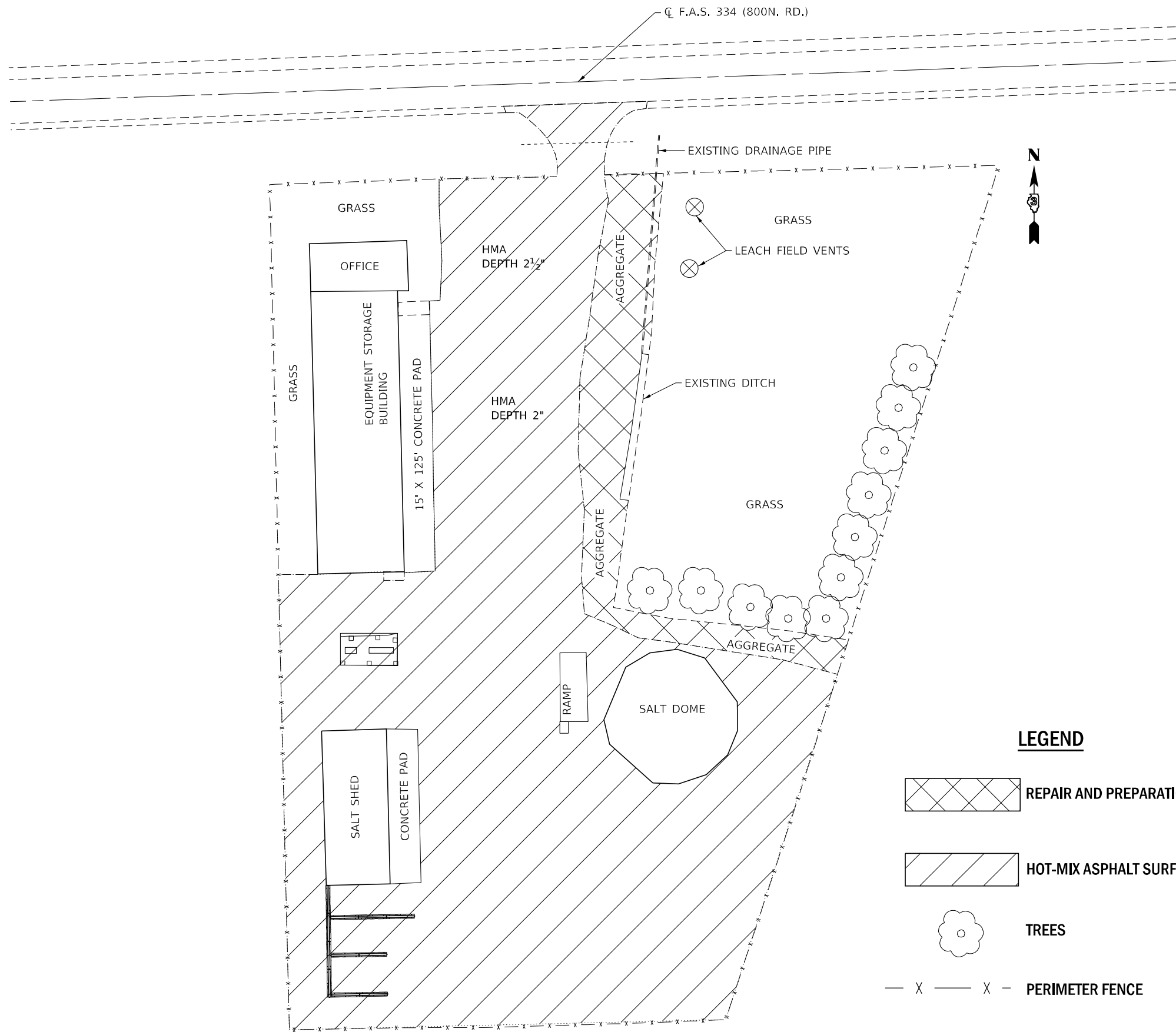

<b>SITE PLAN - GRADING</b>			
<b>BUCKLEY MAINTENANCE FACILITY</b>			
SCALE:	SHEET 1 OF 1 SHEETS	STA.	TO STA.

F.A.S. RTE.	SECTION	COUNTY	TOTAL SHEETS	SHEET NO.
334	(130-G-1)RS, MG	IROUOIS	7	5
CONTRACT NO. 66L41				
ILLINOIS FED. AID PROJECT				

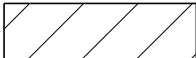

**SITE PLAN - REMOVAL  
BUCKLEY MAINTENANCE FACILITY**

**LEGEND**

-  REPAIR AND PREPARATION OF BASE
-  HOT-MIX ASPHALT SURFACE REMOVAL, SPECIAL
-  TREES
-  PERIMETER FENCE

MODEL: Default  
 FILE NAME: \\pwwd01\Documents\DOT - Office\District 3\Projects\0366L41\CADD\0366L41-Cover.dgn  
 PROJECT: 0366L41

USER NAME = WOODSHANKRL	DESIGNED - RW	REVISED -
	DRAWN - RW	REVISED -
PLOT SCALE = 100,0000' / in.	CHECKED - EM	REVISED -
PLOT DATE = 9/14/2020	DATE - 7/7/2020	REVISED -

**STATE OF ILLINOIS  
DEPARTMENT OF TRANSPORTATION**

**SITE PLAN - REMOVAL  
BUCKLEY MAINTENANCE FACILITY**

SCALE: SHEET 1 OF 1 SHEETS STA. TO STA.

F.A.S. RTE.	SECTION	COUNTY	TOTAL SHEETS	SHEET NO.
334	(130-G-1)RS, MG	IROQUOIS	7	6
CONTRACT NO. 66L41				
ILLINOIS FED. AID PROJECT				

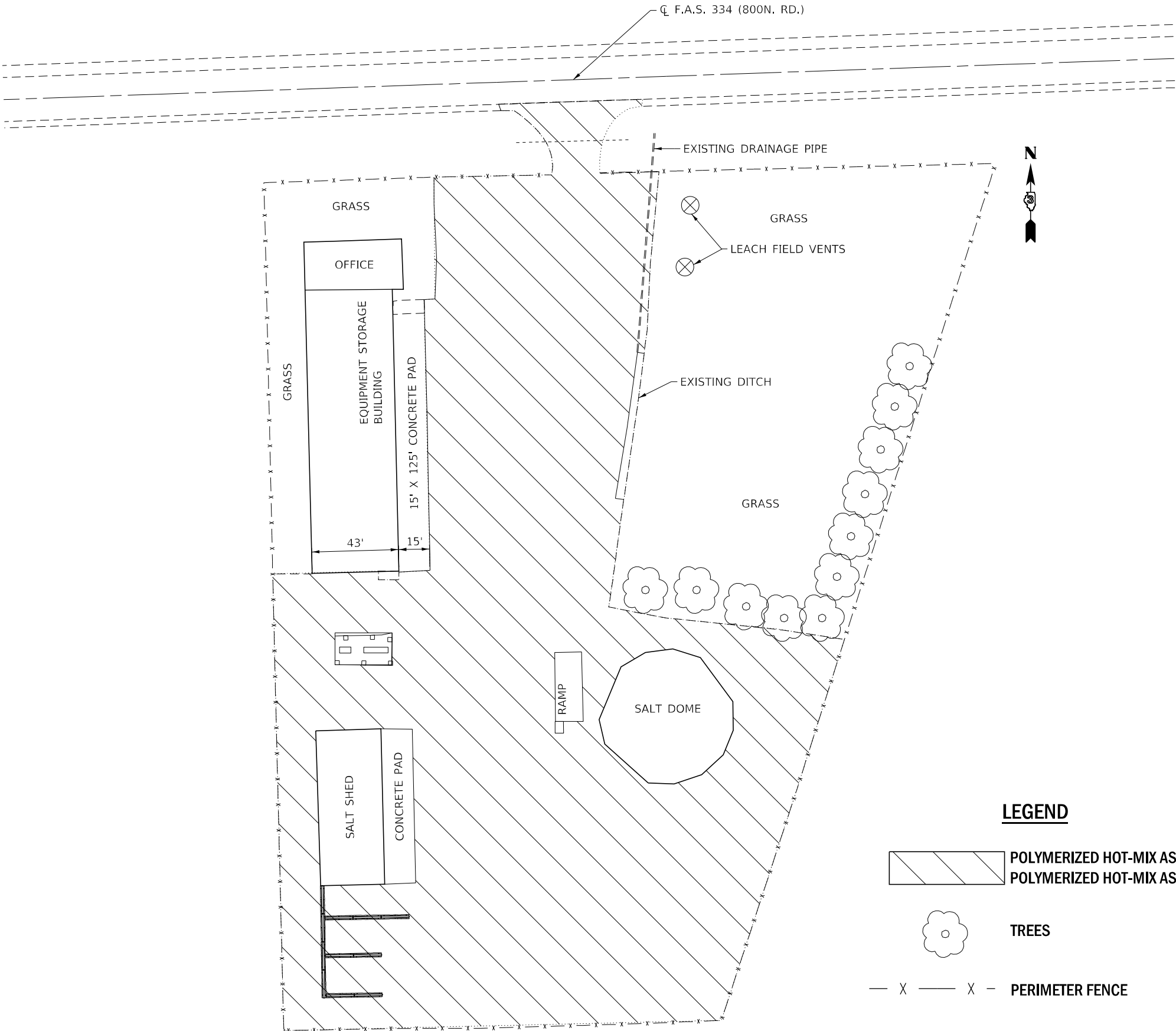

**SITE PLAN - RESURFACING  
BUCKLEY MAINTENANCE FACILITY**

**LEGEND**



**POLYMERIZED HOT-MIX ASPHALT SURFACE CSE. IL-9.5, MIX C, N70**  
**POLYMERIZED HOT-MIX ASPHALT BINDER CSE. IL-19.0, N70**



**TREES**

**— X — X — PERIMETER FENCE**

MODEL: Default  
 FILE NAME: s:\pub\amromm.dwg  
 PROJECT: P:\DOT\Documents\DOT - Office\District 3\Projects\0366L41\CADD\0366L41-Cover.dgn

USER NAME = WOODSHANKRL	DESIGNED - RW	REVISED -
	DRAWN - RW	REVISED -
PLOT SCALE = 100,0000' / in.	CHECKED - EM	REVISED -
PLOT DATE = 9/14/2020	DATE - 7/7/2020	REVISED -

**STATE OF ILLINOIS  
DEPARTMENT OF TRANSPORTATION**

**SITE PLAN - RESURFACING  
BUCKLEY MAINTENANCE FACILITY**

SCALE: SHEET 1 OF 1 SHEETS STA. TO STA.

F.A.S. RTE.	SECTION	COUNTY	TOTAL SHEETS	SHEET NO.
334	(130-G-1)RS,MG	IROQUOIS	7	7
CONTRACT NO. 66L41				
ILLINOIS FED. AID PROJECT				