

STATE OF ILLINOIS
DEPARTMENT OF TRANSPORTATION

F.A.I. RTE.	SECTION	COUNTY	TOTAL SHEETS	SHEET NO.
74	CM21-5007	DEWITT	10	1
		ILLINOIS	CONTRACT NO. 70F04	

FOR INDEX OF SHEETS, SEE SHEET NO. 2
FOR SUMMARY OF QUANTITIES, SEE SHEET NO. 3-4

PROPOSED HIGHWAY PLANS

F.A.I. ROUTE 74 (I-74)
SECTION CM21-5007
PROJECT
MICRO-SURFACING JOINT REPAIR
DEWITT COUNTY

C-95-027-21

CURRENT TRAFFIC DATA

MCLEAN CO. LINE TO PIATT CO. LINE
2020 ADT: 23,000
2030 ADT: 24,400
P.U. & P.C.%: 69.8
SU% = 3.7
MU% = 26.5

**DESIGN DESIGNATION
INTERSTATE**

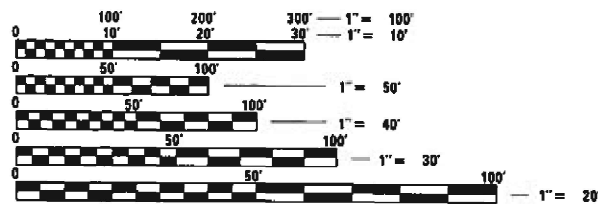

FULL SIZE PLANS HAVE BEEN PREPARED USING STANDARD ENGINEERING SCALES. REDUCED SIZED PLANS WILL NOT CONFORM TO STANDARD SCALES. IN MAKING MEASUREMENTS ON REDUCED PLANS, THE ABOVE SCALES MAY BE USED.

J.U.L.I.E.
JOINT UTILITY LOCATION INFORMATION FOR EXCAVATORS
1-800-892-0123
OR 811

TOWNSHIP: SANTA ANNA
PROJECT ENGINEER: JASON STULTS
SQUAD LEADER: CLARE DIETZ
PHONE NUMBER: (217)-465-4181
CONTRACT NO. 70F04

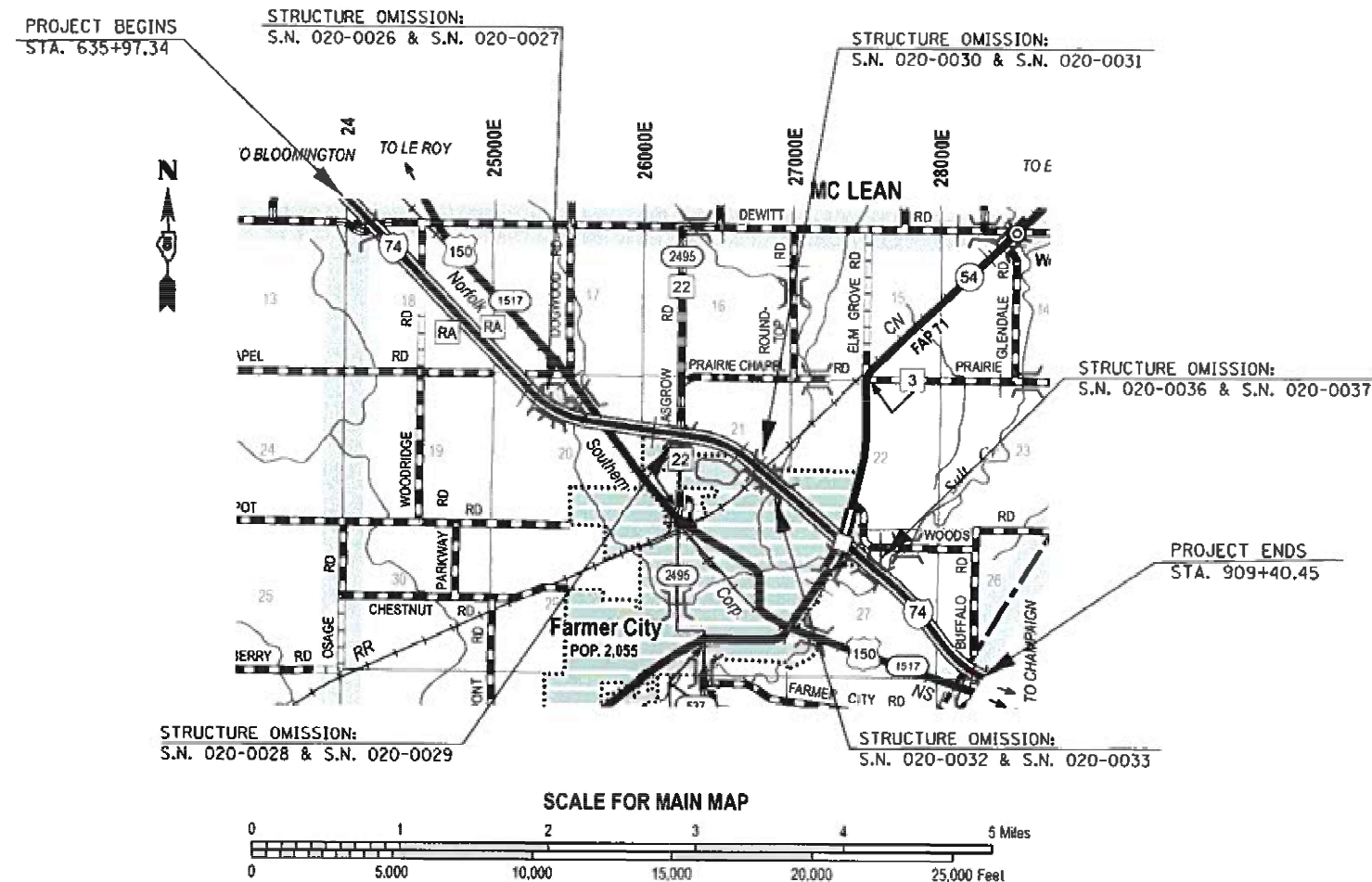

GROSS LENGTH = 27,343.11 FT. = 5.179 MILE
NET LENGTH = 24,583.63 FT. = 4.666 MILE

D-95-011-21

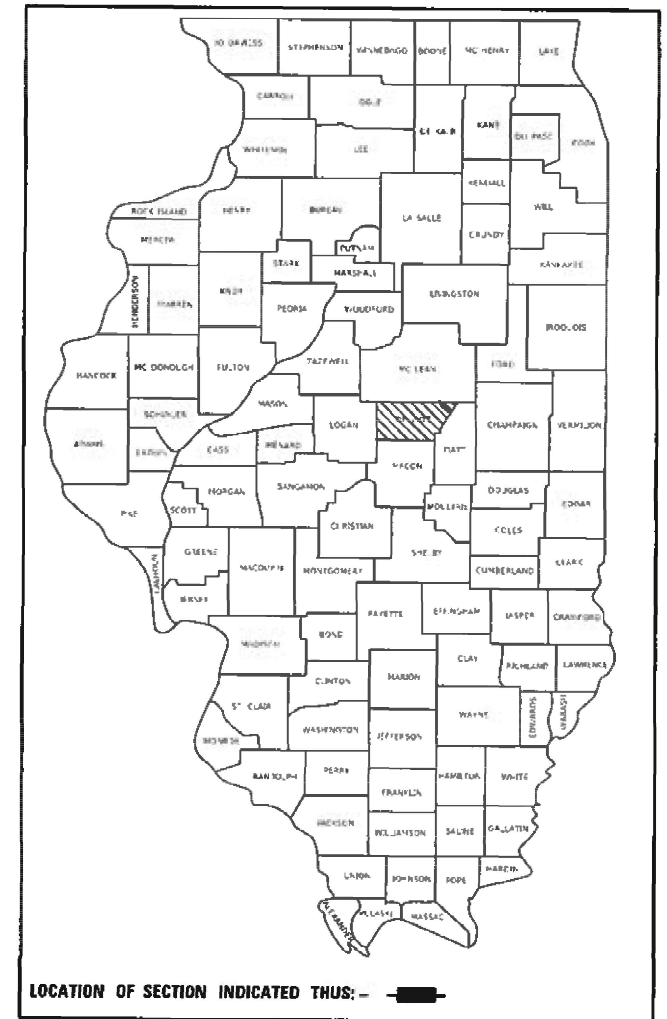

STATE OF ILLINOIS
DEPARTMENT OF TRANSPORTATION

SUBMITTED 1/13 2021
Kenneth A. Barnett swm
REGIONAL ENGINEER

March 19, 2021
Scott A. Elk
ENGINEER OF DESIGN AND ENVIRONMENT

March 19, 2021
James J. Gu
DIRECTOR OF HIGHWAYS PROJECT IMPLEMENTATION 13

**PRINTED BY THE AUTHORITY
OF THE STATE OF ILLINOIS**

SUMMARY OF QUANTITIES

LOCATION OF WORK: FAI 74 (1-74)

RURAL

INTERSTATE

STA. 635+97.34 TO STA. 909+40.45

DEWITT COUNTY

FUNDING BREAKOUT: 100% STATE

CONSTRUCTION TYPE CODE: 0005

CODE NO.	ITEM	UNIT	TOTAL QUANTITY	
4040001	FIBER-MODIFIED ASPHALT CRACK SEALING	FOOT	52,665.0	52,665.0
4040018	MICRO-SURFACING, SINGLE PASS	SQ YD	17,555.0	17,555.0
40600290	BITUMINOUS MATERIALS (TACK COAT)	POUND	3,950.0	3,950.0
67100100	MOBILIZATION	L SUM	1.0	1.0
70100420	TRAFFIC CONTROL AND PROTECTION STANDARD 701411	EACH	8.0	8.0
70100800	TRAFFIC CONTROL AND PROTECTION STANDARD 701401	L SUM	1.0	1.0
70107025	CHANGEABLE MESSAGE SIGN	CAL DAY	26.0	26.0 tables
70300100	SHORT TERM PAVEMENT MARKING	FOOT	4,917.0	4,917.0
70300150	SHORT TERM PAVEMENT MARKING REMOVAL	SQ FT	1,639.0	1,639.0
* 78000400	THERMOPLASTIC PAVEMENT MARKING - LINE 6"	FOOT	12,292.0	12,292.0
* 78100100	RAISED REFLECTIVE PAVEMENT MARKER	EACH	1,230.0	1,230.0
78300200	RAISED REFLECTIVE PAVEMENT MARKER REMOVAL	EACH	1,230.0	1,230.0
78300201	PAVEMENT MARKING REMOVAL - GRINDING	SQ FT	4,098.0	4,098.0
X2700001	TEMPORARY RUMBLE STRIPS (SPECIAL)	EACH	16.0	16.0
* DENOTES SPECIALTY ITEM				

MODEL: I:\MODEL\MHFE
 FILE NAME: P:\pub\mcom\m.dwt\illinc\gov\PIWIDOT\Documents\IDOT_Offices\Bartec\3\Projects\0570F04\CADD\Bartec\0570F04-rpt-S00.dgn

USER NAME = DietzCB	DESIGNED -	REVISED -
	DRAWN -	REVISED -
PLOT SCALE = 40,0000 */ in.	CHECKED -	REVISED -
PLOT DATE = 1/14/2021	DATE -	REVISED -

**STATE OF ILLINOIS
DEPARTMENT OF TRANSPORTATION**

SUMMARY OF QUANTITIES

SCALE: SHEET 1 OF 2 SHEETS STA. TO STA.

F.A.J RTE.	SECTION	COUNTY	TOTAL SHEETS	SHEET NO.
74	CM21-5007	DEWITT	10	3
CONTRACT NO. 70F04				
ILLINOIS FED. AID PROJECT				

1 EXISTING TYPICAL SECTION

	STATION	TO	STATION	
	EB 635+97.34		EB 655+70.00	②
③	EB 662+48.70		EB 694+39.70	③
②	EB 707+35.06		EB 829+77.00	②
②	EB 832+65.00		EB 861+42.00	②
②	EB 863+56.00		EB 909+40.45	
	WB 635+97.34		WB 666+29.87	②
③	WB 679+25.15		WB 711+16.23	③
②	WB 717+94.93		WB 826+04.00	②
②	WB 832+37.00		WB 860+39.00	②
②	WB 863+12.00		WB 909+40.45	

OMISSIONS FROM SECTION

	STATION	TO	STATION
EB SN 020-0026	743+92.71		751+15.28
EB SN 020-0028	773+25.54		777+91.00
EB SN 020-0030	805+47.98		810+55.06
EB SN 020-0032	814+24.34		819+45.54
EB SN 020-0036	863+56.96		869+00.13
WB SN 020-0027	742+97.25		750+21.27
WB SN 020-0029	773+13.29		777+79.13
WB SN 020-0031	805+57.96		810+65.04
WB SN 020-0033	814+25.19		819+45.15
WB SN 020-0037	863+56.93		868+99.31

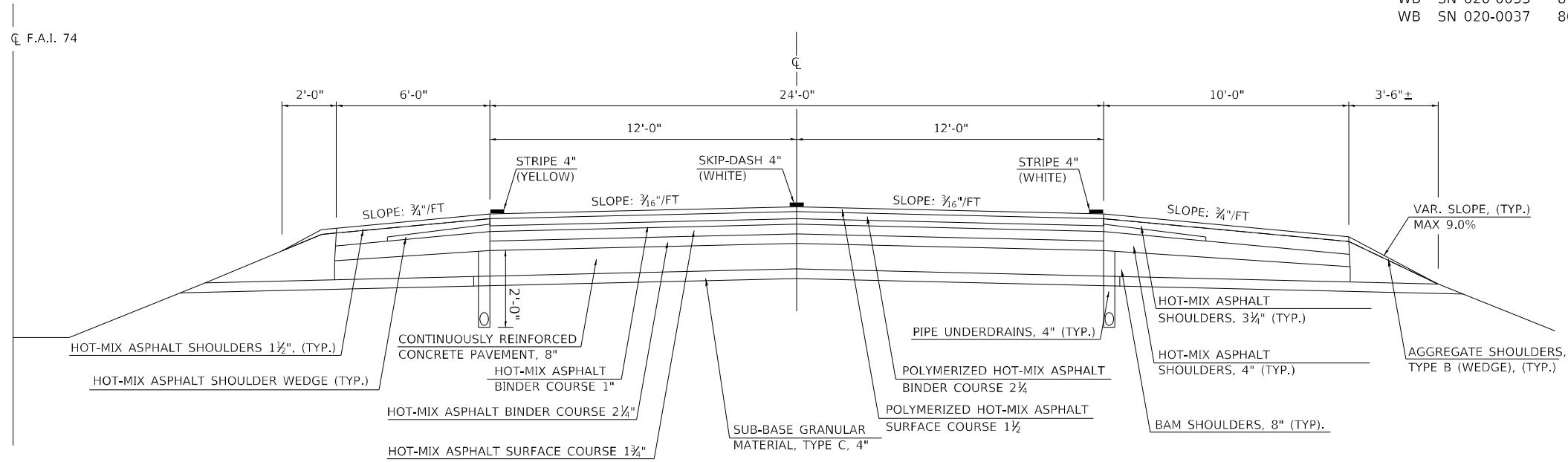

1 PROPOSED TYPICAL SECTION

	STATION	TO	STATION	
	EB 635+97.34		EB 655+70.00	②
③	EB 662+48.70		EB 694+39.70	③
②	EB 707+35.06		EB 829+77.00	②
②	EB 832+65.00		EB 861+42.00	②
②	EB 863+56.00		EB 909+40.45	
	WB 635+97.34		WB 666+29.87	②
③	WB 679+25.15		WB 711+16.23	③
②	WB 717+94.93		WB 826+04.00	②
②	WB 832+37.00		WB 860+39.00	②
②	WB 863+12.00		WB 909+40.45	

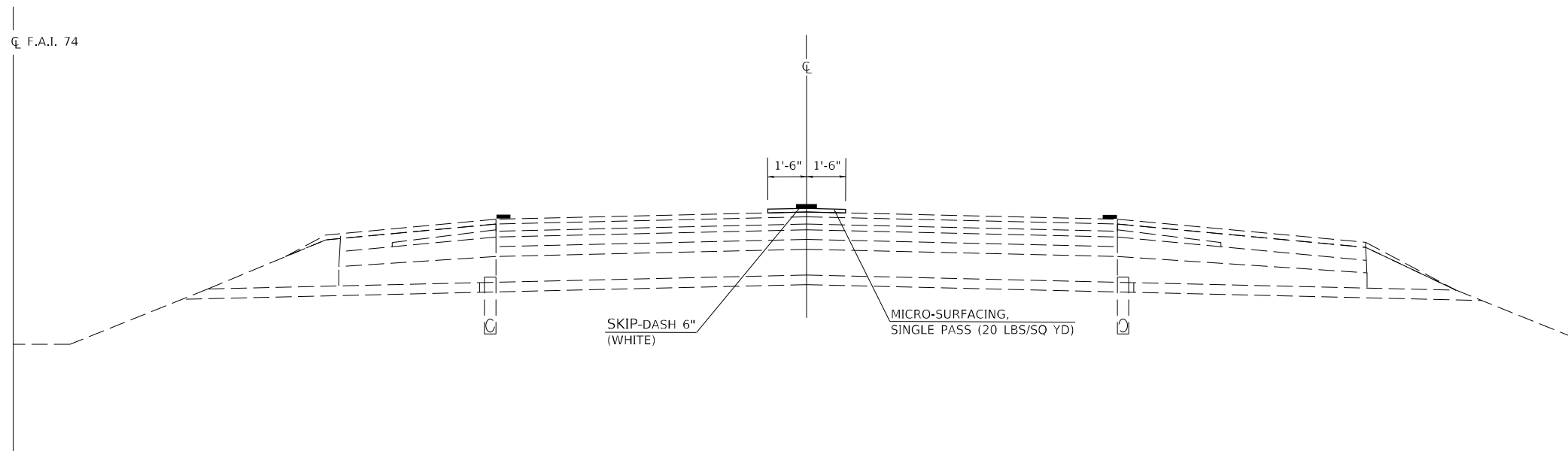

MODEL: \\MODEL\NAME
 FILE NAME: \\MODEL\NAME.dwg
 PROJECT: \\PROJECT\PROJECTNAME\PROJECTNAME.dwg
 OFFICE: \\OFFICE\OFFICE\OFFICE\OFFICE.dwg
 DATE: 1/14/2021

USER NAME = DietzCB	DESIGNED -	REVISED -
	DRAWN -	REVISED -
PLOT SCALE = 40,0000 * / in.	CHECKED -	REVISED -
PLOT DATE = 1/14/2021	DATE -	REVISED -

STATE OF ILLINOIS
DEPARTMENT OF TRANSPORTATION

TYPICAL CROSS SECTIONS

SCALE: SHEET 1 OF 3 SHEETS STA. TO STA.

F.A.J. RTE.	SECTION	COUNTY	TOTAL SHEETS	SHEET NO.
74	CM21-5007	DEWITT	10	5
CONTRACT NO. 70F04				
ILLINOIS FED. AID PROJECT				

3 EXISTING TYPICAL SECTION

	STATION	TO	STATION	
②	EB 659+74.37		EB 662+48.70	①
①	EB 694+39.70		EB 697+85.06	②
②	WB 675+79.87		WB 679+25.15	①
①	WB 711+16.23		WB 713+90.56	②

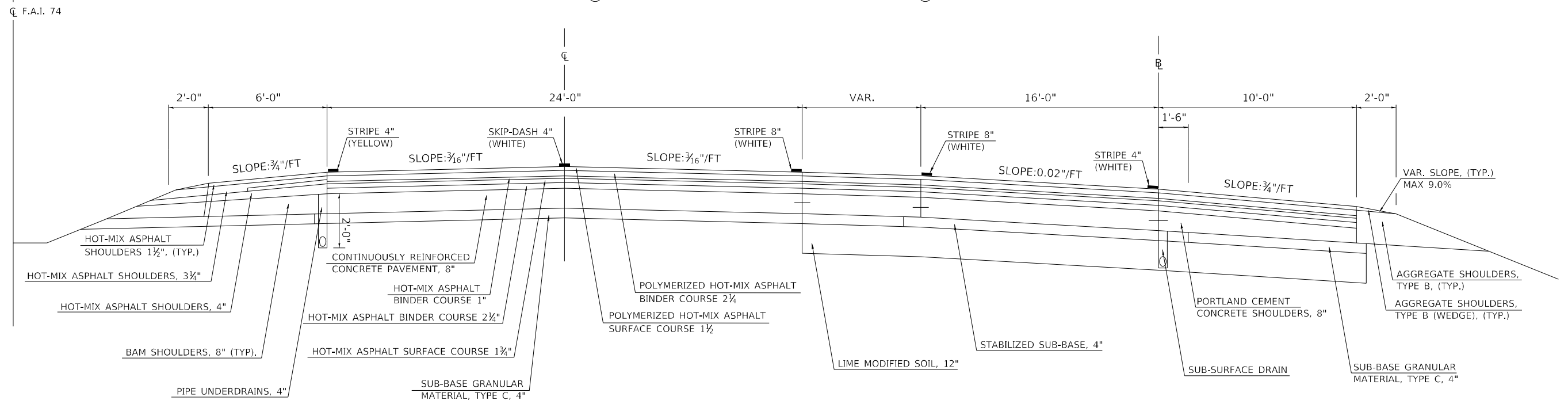

3 PROPOSED TYPICAL SECTION

	STATION	TO	STATION	
②	EB 659+74.37		EB 662+48.70	①
①	EB 694+39.70		EB 697+85.06	②
②	WB 675+79.87		WB 679+25.15	①
①	WB 711+16.23		WB 713+90.56	②

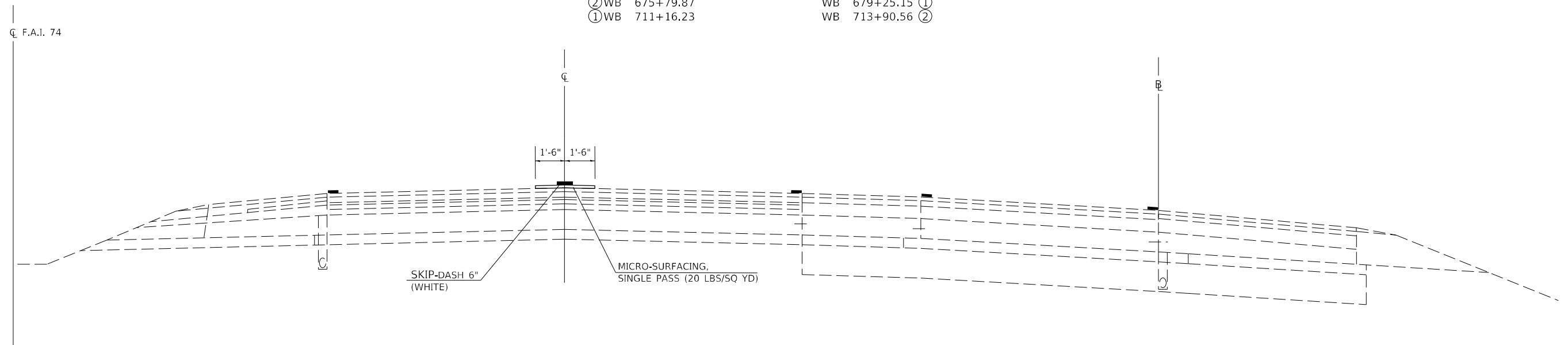

MODEL: \\MODEL\MAME
 FILE NAME: \\p14\mcom\m.d\illinois.gov\PWDOT\Documents\DOT_Offices\District 5\Projects\0570F04\CD\03\03\CAD\Process\0570F04-03-01-Typical.dgn

USER NAME = DietzCB	DESIGNED -	REVISED -
	DRAWN -	REVISED -
PLOT SCALE = 40,0000 * / in.	CHECKED -	REVISED -
PLOT DATE = 1/14/2021	DATE -	REVISED -

STATE OF ILLINOIS
DEPARTMENT OF TRANSPORTATION

TYPICAL CROSS SECTIONS			
SCALE:	SHEET 3	OF 3	SHEETS
	STA.		TO STA.

F.A.J. RTE.	SECTION	COUNTY	TOTAL SHEETS	SHEET NO.
74	CM21-5007	DEWITT	10	7
CONTRACT NO. 70F04				
ILLINOIS FED. AID PROJECT				

SCHEDULE OF QUANTITIES

LOCATION	DESCRIPTION	STATION	TO	STATION	LENGTH (FOOT)	404000001 FIBER-MODIFIED ASPHALT CRACK SEALING (FOOT)	40400118 MICRO- SURFACING SINGLE PASS (SQ YD)	40600290 BITUMINOUS MATERIALS (TACK COAT)* (POUND)	70300100 SHORT TERM PAVEMENT MARKING (FOOT)	70300150 SHORT TERM PAVEMENT MARKING REMOVAL (SQ FT)	78000400 THERMOPLASTIC PAVEMENT MARKING - LINE 6" (FOOT)	78100100 RAISED REFLECTIVE PAVEMENT MARKER (EACH)	78300200 RAISED REFLECTIVE PAVEMENT MARKER REMOVAL (EACH)	78300201 PAVEMENT MARKING REMOVAL- GRINDING (SQ FT)	X7830074 GROOVING FOR RECESSED PAVEMENT MARKING 7" (FOOT)
EB I-74	CENTERLINE	635+97.34		743+92.71	10,795.4	10,795.4	3,598.5	809.7	1,079.5	359.8	2,698.8	269.9	269.9	899.6	2,698.8
EB I-74	CENTERLINE	751+15.28		773+25.54	2,210.3	2,210.3	736.8	165.8	221.0	73.7	552.6	55.3	55.3	184.2	552.6
EB I-74	CENTERLINE	777+91.00		805+47.98	2,757.0	2,757.0	919.0	206.8	275.7	91.9	689.2	68.9	68.9	229.7	689.2
EB I-74	CENTERLINE	810+55.06		814+24.34	369.3	369.3	123.1	27.7	36.9	12.3	92.3	9.2	9.2	30.8	92.3
EB I-74	CENTERLINE	819+45.54		863+56.96	4,411.4	4,411.4	1,470.5	330.9	441.1	147.0	1,102.9	110.3	110.3	367.6	1,102.9
EB I-74	CENTERLINE	869+00.13		909+40.45	4,040.3	4,040.3	1,346.8	303.0	404.0	134.7	1,010.1	101.0	101.0	336.7	1,010.1
WB I-74	CENTERLINE	909+40.45		868+99.31	4,041.1	4,041.1	1,347.0	303.1	404.1	134.7	1,010.3	101.0	101.0	336.8	1,010.3
WB I-74	CENTERLINE	863+56.93		819+45.15	4,411.8	4,411.8	1,470.6	330.9	441.2	147.1	1,102.9	110.3	110.3	367.6	1,102.9
WB I-74	CENTERLINE	814+25.19		810+65.04	360.2	360.2	120.1	27.0	36.0	12.0	90.0	9.0	9.0	30.0	90.0
WB I-74	CENTERLINE	805+57.96		777+79.13	2,778.8	2,778.8	926.3	208.4	277.9	92.6	694.7	69.5	69.5	231.6	694.7
WB I-74	CENTERLINE	773+13.29		750+21.27	2,292.0	2,292.0	764.0	171.9	229.2	76.4	573.0	57.3	57.3	191.0	573.0
WB I-74	CENTERLINE	742+97.25		635+97.34	10,699.9	10,699.9	3,566.6	802.5	1,070.0	356.7	2,675.0	267.5	267.5	891.7	2,675.0
EB I-74	IL 54 OFF RAMP				288.0	288.0	96.0	21.6							
EB I-74	IL 54 ON RAMP				214.0	214.0	71.3	16.1							
EB I-74	REST AREA OFF RAMP				288.0	288.0	96.0	21.6							
EB I-74	REST AREA ON RAMP				768.0	768.0	256.0	57.6							
WB I-74	REST AREA OFF RAMP				302.0	302.0	100.7	22.7							
WB I-74	REST AREA ON RAMP				731.0	731.0	243.7	54.8							
WB I-74	IL 54 OFF RAMP				273.0	273.0	91.0	20.5							
WB I-74	IL 54 ON RAMP				633.0	633.0	211.0	47.5							
					TOTAL	52,664.5	17,554.8	3,949.8	4,916.7	1,638.9	12,291.9	1,229.2	1,229.2	4,097.3	12,291.9
					ROUND TO	52,665.0	17,555.0	3,950.0	4,917.0	1,639.0	12,292.0	1,230.0	1,230.0	4,098.0	12,292.0

*RATE = 0.225 LBS/SQ YD

LENGTH FOR RAMP JOINTS WERE MEASURED FROM PAINTED GORE TIP TO END OF JOINT

TEMPORARY RUMBLE STRIPS			
X2700001			
TEMPORARY RUMBLE STRIPS (SPECIAL)			
APPROX. LOCATION	LANE		(EACH)
± 1.5 MI BEFORE TAPER	EBDL		2
± 1.5 MI BEFORE TAPER	EBPL		2
± 3 MI BEFORE TAPER	EBDL		2
± 3 MI BEFORE TAPER	EBPL		2
± 1.5 MI BEFORE TAPER	WBDL		2
± 1.5 MI BEFORE TAPER	WBPL		2
± 3 MI BEFORE TAPER	WBDL		2
± 3 MI BEFORE TAPER	WBPL		2
	TOTAL		16

CHANGEABLE MESSAGE SIGN		
70107025		
CHANGEABLE MESSAGE SIGN		
DESCRIPTION		(EACH)
EB I-74 ADVANCE NOTICE		3
WB I-74 ADVANCE NOTICE		3
EB DURING CONSTRUCTION, ± 1.5 MI BEFORE TAPER		10
WB DURING CONSTRUCTION, ± 1.5 MI BEFORE TAPER		10
TOTAL		26

MODEL: I:\MODEL\MHFE FILE NAME: P:\pub\mcom\m.dwt\illinc\gov\PIWDOT\Documents\DOT_Offices\District_5\Projects\0570F04\CAD\Drawn\CAD\Faces\0570F04-Plt-Schedule.dgn

USER NAME = DietzCB	DESIGNED -	REVISED -
	DRAWN -	REVISED -
PLOT SCALE = 40,0000 * / in.	CHECKED -	REVISED -
PLOT DATE = 1/14/2021	DATE -	REVISED -

**STATE OF ILLINOIS
DEPARTMENT OF TRANSPORTATION**

SCHEDULE OF QUANTITIES

SCALE: SHEET 1 OF 1 SHEETS STA. TO STA.

F.A.I RTE.	SECTION	COUNTY	TOTAL SHEETS	SHEET NO.
74	CM21-5007	DEWITT	10	8
CONTRACT NO. 70F04				
ILLINOIS FED. AID PROJECT				

DETAIL FOR TEMPORARY RUMBLE STRIPS (SPECIAL)

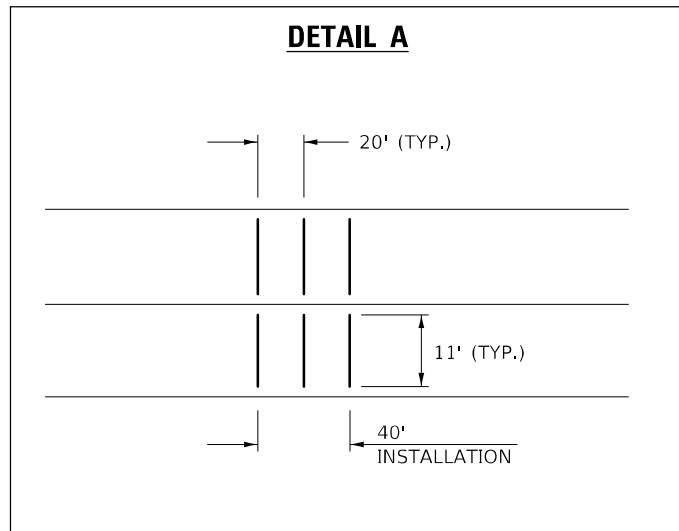
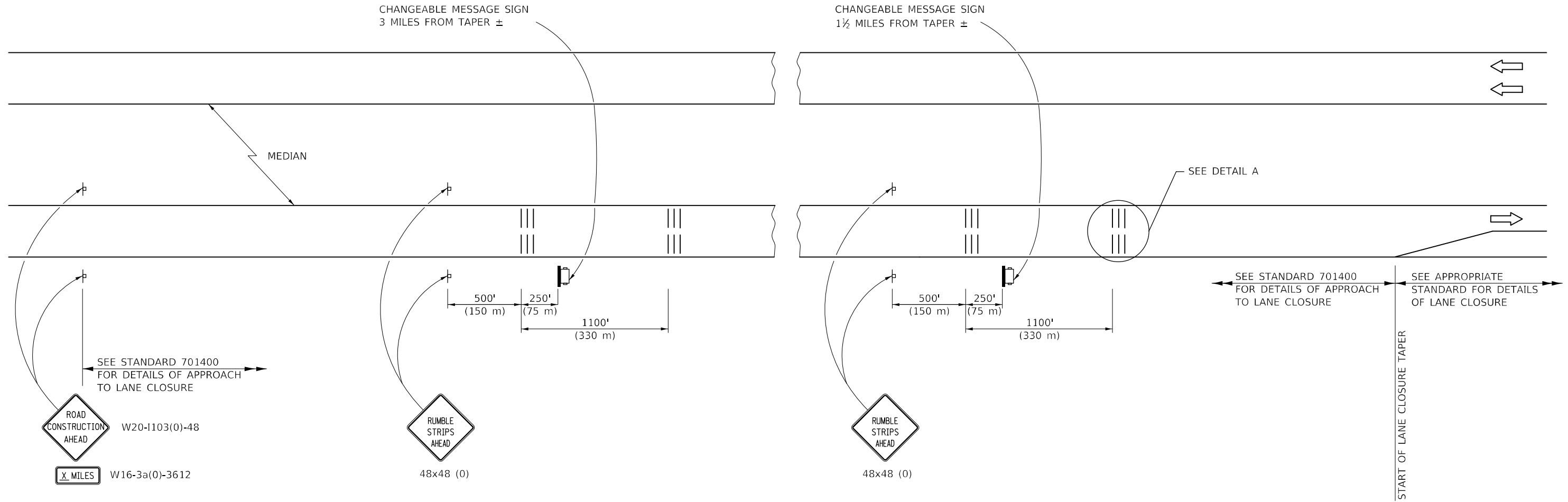

SYMBOLS

- SIGN
- TEMPORARY RUMBLE STRIPS (SPECIAL)
- TRAILER MOUNTED SIGN

GENERAL NOTES

REMOVE THE TEMPORARY RUMBLE STRIPS (SPECIAL) PRIOR TO THE REMOVAL OF THE ADVANCED WARNING SIGNS.

ALL DIMENSIONS ARE IN INCHES (MILLIMETERS) UNLESS OTHERWISE SHOWN.

MODEL: \\MODEL\NAME
 FILE: NAME: \\...

USER NAME = DietzCB	DESIGNED -	REVISED -
	DRAWN -	REVISED -
PLOT SCALE = 40,0000 * / in.	CHECKED -	REVISED -
PLOT DATE = 1/14/2021	DATE -	REVISED -

**STATE OF ILLINOIS
DEPARTMENT OF TRANSPORTATION**

DETAIL FOR TEMPORARY RUMBLE STRIPS (SPECIAL)

SCALE: NONE SHEET 1 OF 1 SHEETS STA. TO STA.

F.A.I. RTE.	SECTION	COUNTY	TOTAL SHEETS	SHEET NO.
74	CM21-5007	DEWITT	10	9
CONTRACT NO. 70F04				
ILLINOIS FED. AID PROJECT				

CENTERLINE INTERSTATE OR MULTI-LANE TWO WAY DIVIDED HIGHWAY

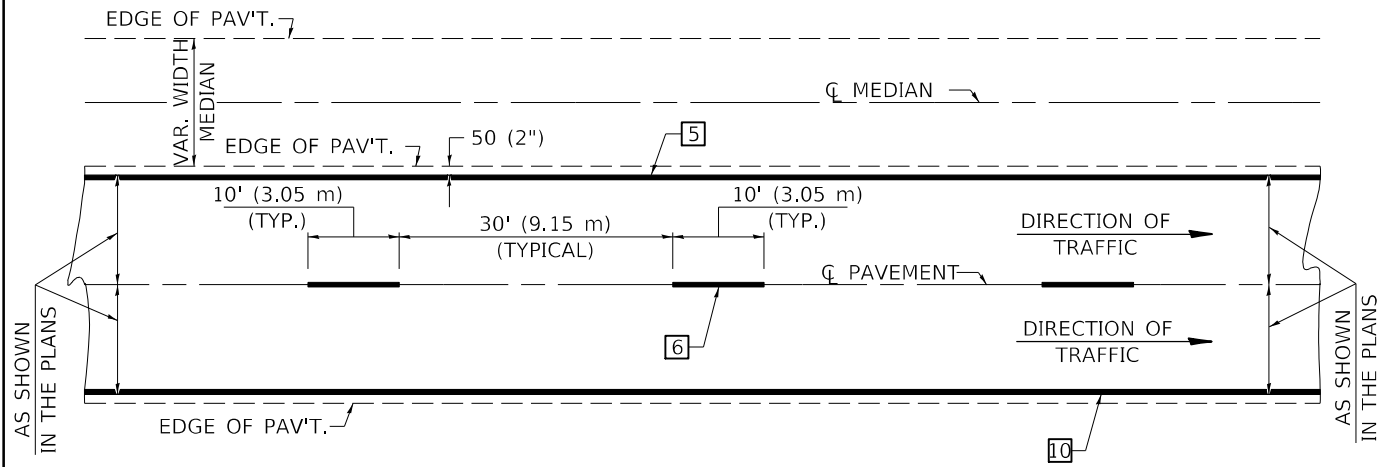

NOTE: PAVEMENT MARKINGS ARE TO BE EXTENDED THROUGH OMISSIONS WHEN APPLICABLE.

NOTE: SEE ARTICLES 780.04 & 781.03 FOR LOCATION OF STRIPES AND MARKERS RELATIVE TO EDGES OR JOINTS.

FOR RAISED REFLECTIVE PAVEMENT MARKERS, REFER TO STANDARD 781001.

TYPICAL PAVEMENT MARKING LEGEND

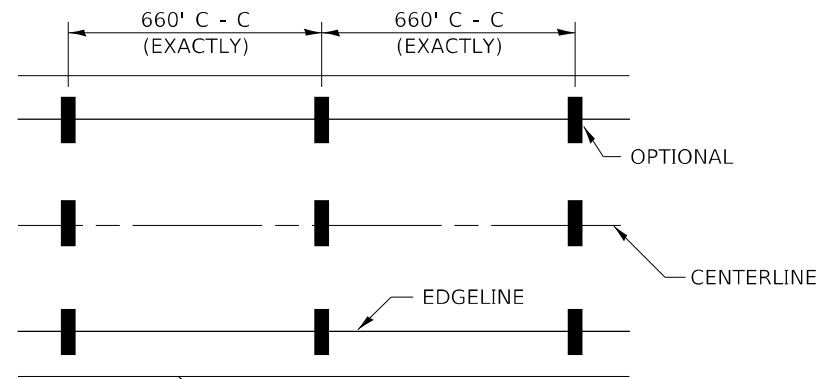

- 1 4" (100) SKIP-DASH (YELLOW)
- 2 4" (100) SOLID (YELLOW)
- 3 12" (300) DIAGONAL (YELLOW)
- 4 4" (100) DOUBLE YELLOW (NARROW)
- 5 6" (150) SOLID (YELLOW)
- 6 6" (150) SKIP-DASH (WHITE)
- 7 4" (100) SKIP-DASH (WHITE)
- 8 4" (100) SOLID (WHITE)
- 9 12" (300) DIAGONAL (WHITE)
- 10 6" (150) SOLID (WHITE)
- 11 24" (600) STOP BAR (WHITE)
- 12 8" (200) SOLID (WHITE)
- 13 6" (150) LANE LINE EXTENSIONS (WHITE)

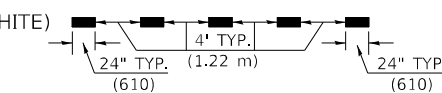
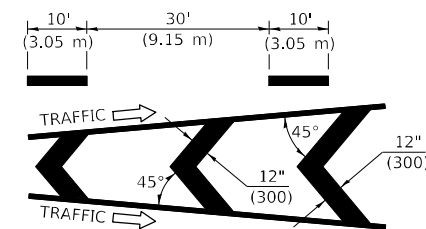
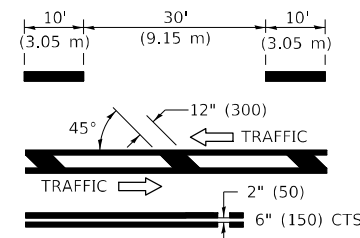

TYPICAL EXIT RAMP TERMINAL

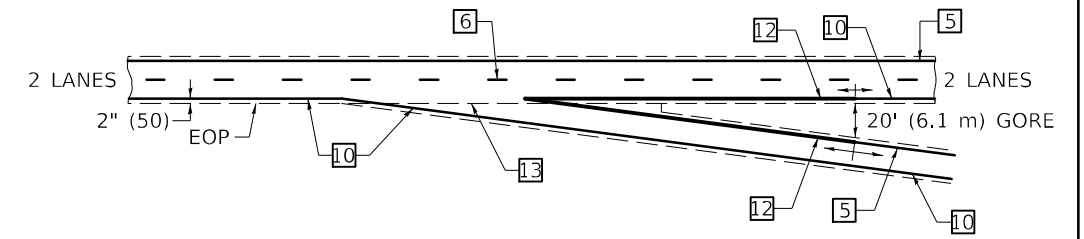

EXIT RAMP TERMINAL with EXCLUSIVE (auxiliary) LANE

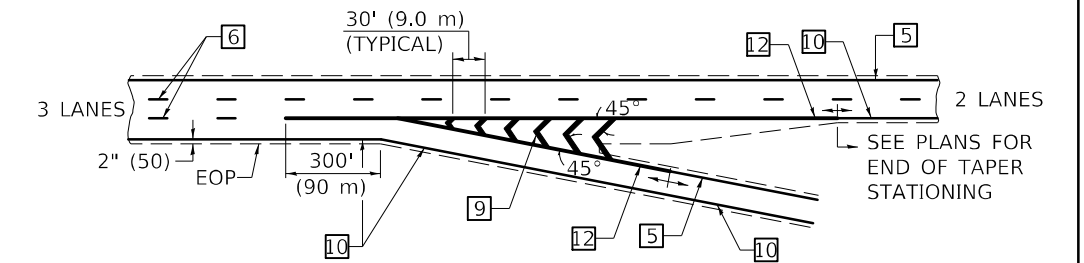

TYPICAL ENTRANCE RAMP TERMINAL

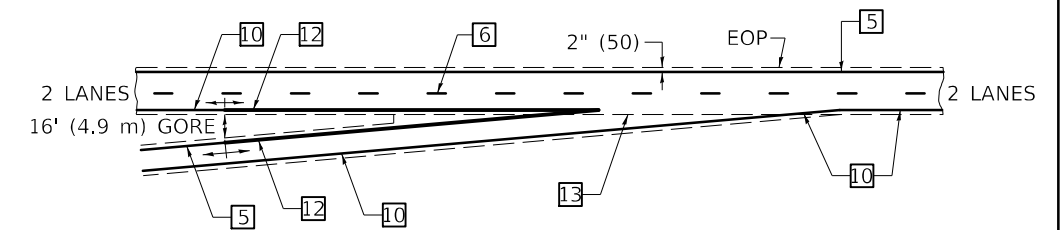

ENTRANCE RAMP TERMINAL with EXCLUSIVE LANE

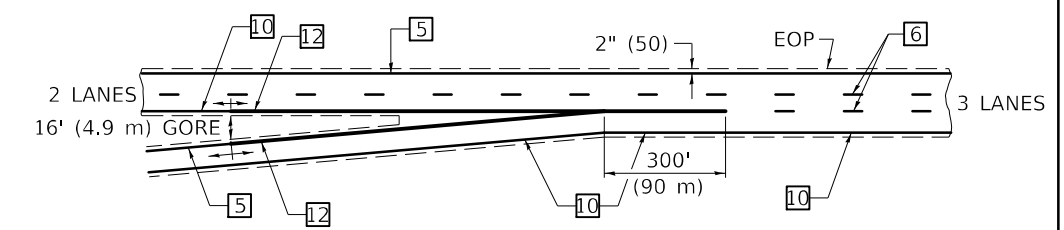

IT WILL BE NECESSARY TO HAVE A REPRESENTATIVE OF THE STATE POLICE PRESENT SO THAT THE ACCURACY OF MEASUREMENT CAN BE ATTESTED TO IN COURT.

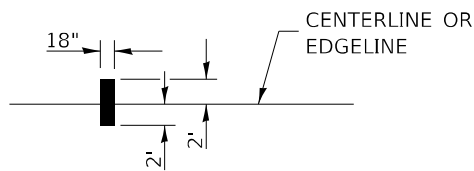

AERIAL SPEED CHECK ZONES

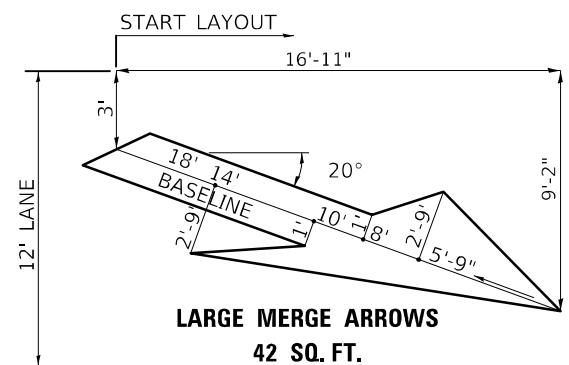

LARGE MERGE ARROWS
42 SQ. FT.

Note: All dimensions are in INCHES (millimeters) unless otherwise shown.

DISTRICT 5 DETAIL NO. 7800BBBB

USER NAME = DietzCB	DESIGNED -	REVISED - 11/06
	DRAWN -	REVISED - 12/20
PLOT SCALE = 40,0000 * / in.	CHECKED -	REVISED -
PLOT DATE = 1/14/2021	DATE -	REVISED -

**STATE OF ILLINOIS
DEPARTMENT OF TRANSPORTATION**

PAVEMENT MARKING (INTERSTATE & MULTI-LANE APPLICATIONS)

SCALE: SHEET 1 OF 1 SHEETS STA. TO STA.

F.A.J. RTE.	SECTION	COUNTY	TOTAL SHEETS	SHEET NO.
74	CM21-5007	DEWITT	10	10
CONTRACT NO. 70F04				
ILLINOIS FED. AID PROJECT				

MODEL: I:\MODEL\NAME: FILE NAME: PROJECT: DISTRICT: OFFICE: DATE: 3/14/2021 10:00:00 AM