

**CASEY ROAD**

MATCH LINE - STA. 8+00

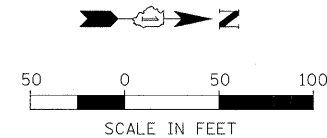

MATCH LINE - STA. 262+00

MATCH LINE - STA. 278+00

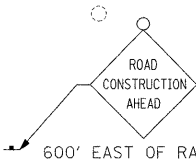
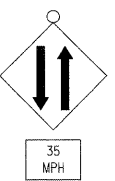
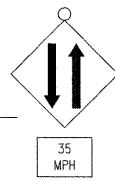
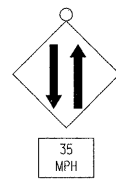
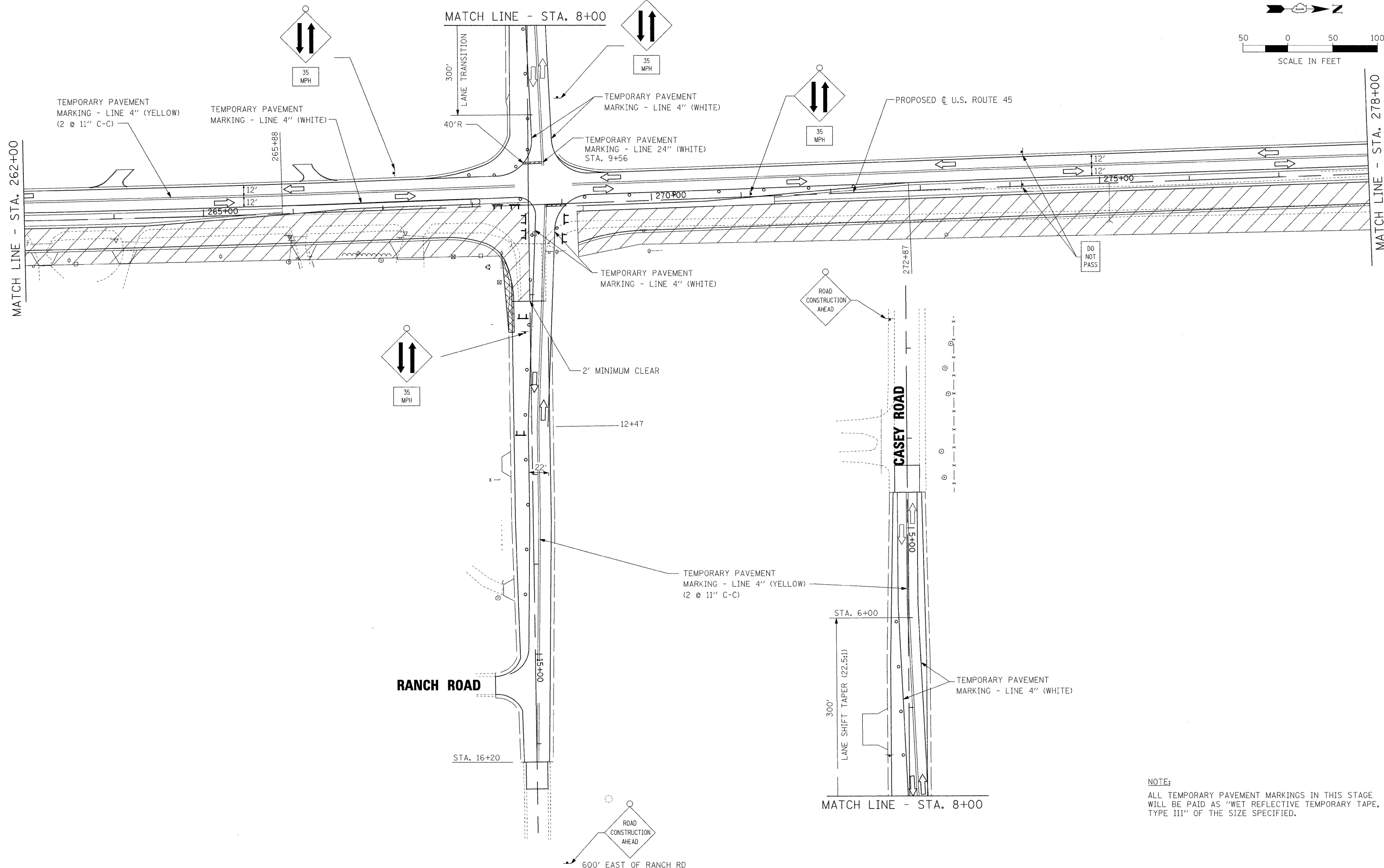

DO NOT PASS

**NOTE:**  
ALL TEMPORARY PAVEMENT MARKINGS IN THIS STAGE WILL BE PAID AS "WET REFLECTIVE TEMPORARY TAPE, TYPE III" OF THE SIZE SPECIFIED.

FILE NAME = #FILEL#	USER NAME = #USER#	DESIGNED - MAP	REVISED -
		DRAWN - JRH	REVISED -
		CHECKED - JW	REVISED -
		DATE - 12-12-08	REVISED -

**STATE OF ILLINOIS  
DEPARTMENT OF TRANSPORTATION**

**MAINTENANCE OF TRAFFIC - STAGE 2**

SCALE: 1"=50'    SHEET NO. 3 OF 5 SHEETS    STA. 262+00 TO STA. 278+00

F.A.P. RTE.	SECTION	COUNTY	TOTAL SHEETS	SHEET NO.
344	(46-1S&47)WRS-3	LAKE	176	42
U.S. ROUTE 45 RECONSTRUCTION			CONTRACT NO. 60957	
FED. ROAD DIST. NO. [ILLINOIS] FED. AID PROJECT				